

BREACH SET-UP

- Ensure that seats in the Breach are in good condition and are free of foreign objects.
- The recommended installation range for the breach are as shown

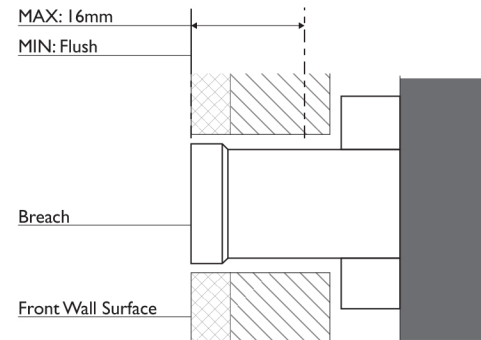

1

- Apply Teflon Tape to Threaded Elbow.
- Place O-Ring into the groove on the rear of the Back Plate and place over the Threaded Elbow.
- Screw Spout Adapter onto Threaded Elbow by hand and tighten firmly using Allen Key.
- Push Wall Outlet onto Spout Adapter.
- Fasten Grub Screws using the Allen Key Provided.

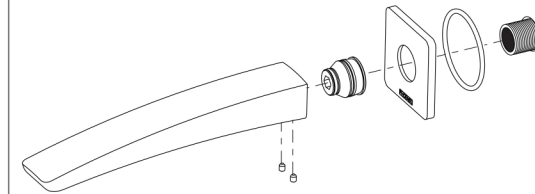

2

Firmly screw Spindle into the Breach.

DO NOT OVERTIGHTEN

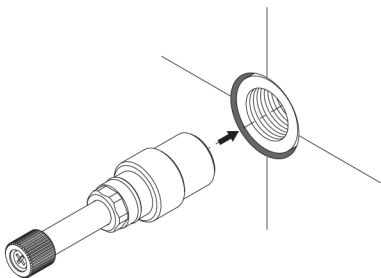

3

Fit Fibre Washer around the Spindle and then firmly fasten the Bonnet onto the Spindle using a spanner.

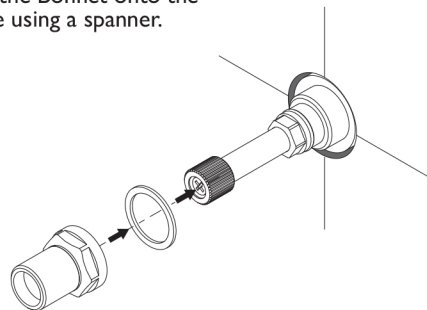

4

Fit O-Ring to the groove in the rear of the Dress Plate.

Fit Dress Plate over the Spindle.

Firmly fasten Flange onto the Spindle to secure the Dress Plate.

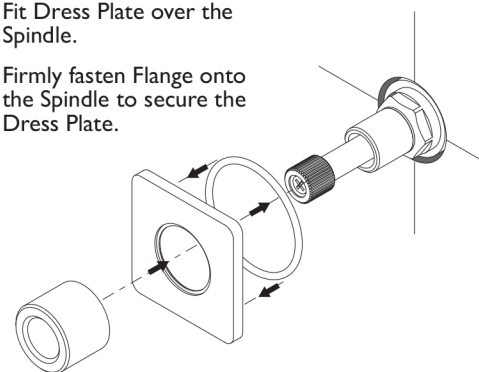

5

Fit Handle to Spindle and fasten with the Grub Screw using the Allen Key provided.

Push Screw Plug into hole.

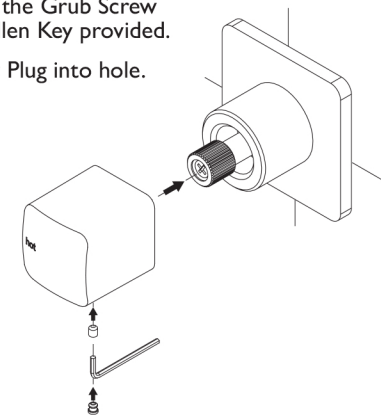

recommended
working pressure
**150-500
KPa**
maximum hot
water temperature
**75
degrees**