

1

Apply Teflon Tape to Threaded Elbow

Place Back Plate over the Threaded Elbow

Screw Spout Adapter onto Threaded Elbow and tighten firmly

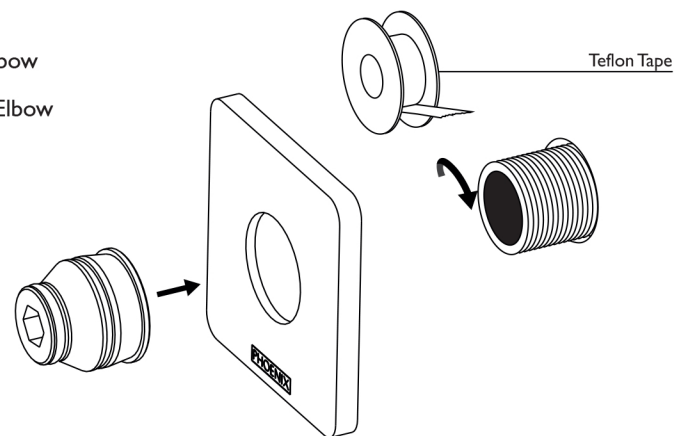

2

Push Wall Outlet onto Spout Adapter.

Fasten Grub Screws using the Allen Key Provided.

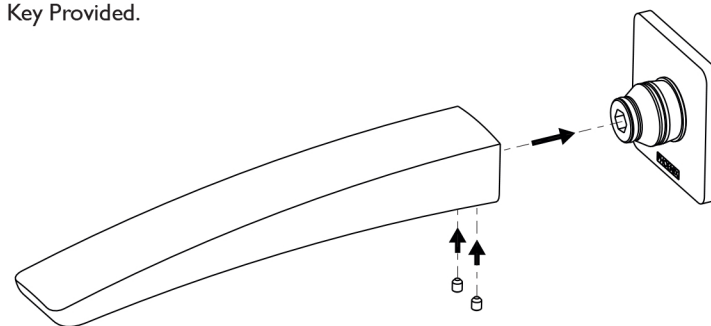

recommended  
working pressure

**150-500  
KPa**



maximum hot  
water temperature

**75  
degrees**