

BREACH SET-UP

- Ensure that seats in the Breach are in good condition and are free of foreign objects.

- The recommended installation range for the breach are as shown:

MAX: 16mm inwards from the Front Wall Surface

MIN: Flush with the Front Wall Surface

- Reseat if required.

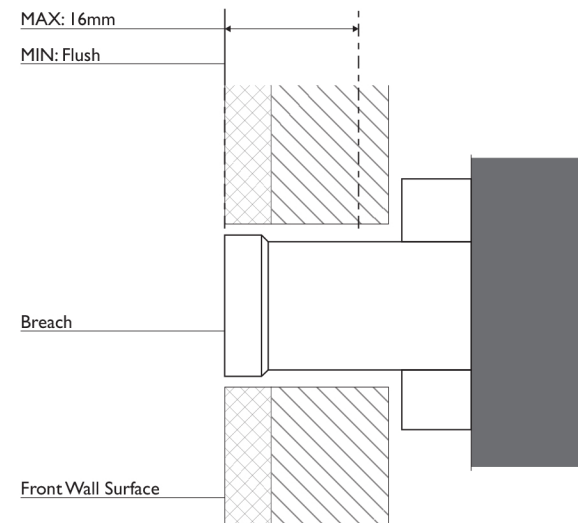

1

Firmly screw Spindle into the Breach.

DO NOT OVERTIGHTEN

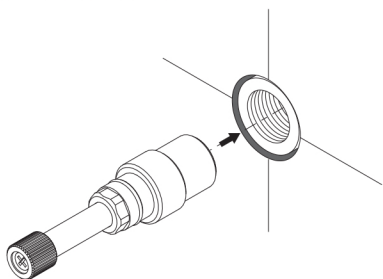

2

Fit Fibre Washer around the Spindle and then firmly fasten the Bonnet onto the Spindle using a spanner.

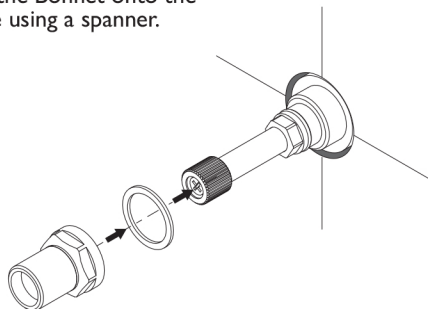

3

Fit O-Ring to the groove in the rear of the Dress Plate.

Fit Dress Plate over the Spindle.

Firmly fasten Flange onto the Spindle to secure the Dress Plate.

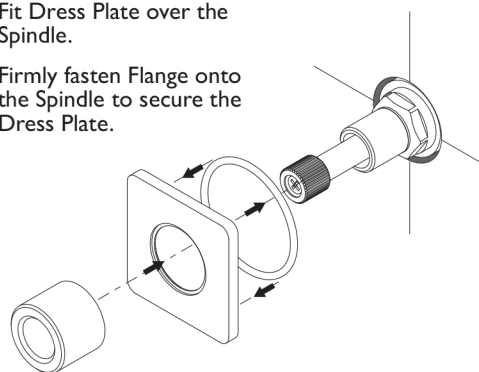

4

Fit Handle to Spindle and fasten with the Grub Screw using the Allen Key provided.

Push Screw Plug into hole.

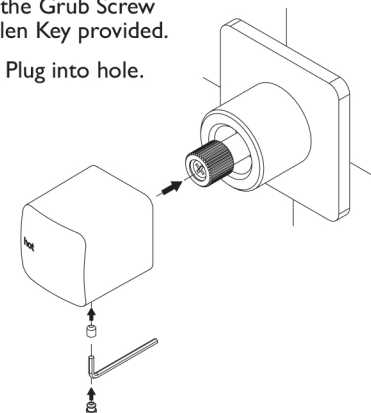

recommended
working pressure
**150-500
KPa**
maximum hot
water temperature
**75
degrees**