

1

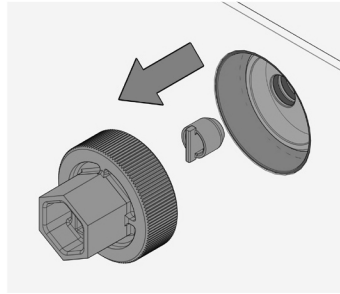

Remove Test Cap using a Flat Head Screw Driver or spanner.

Ensure that no Test Plugs are in Body

2

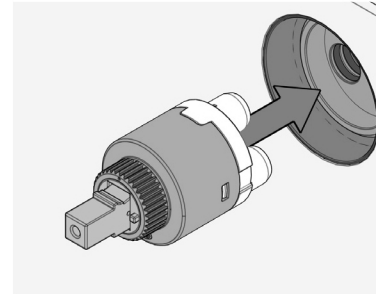

Add Grease or Soap to the three Cartridge legs.

Push Cartridge Gently Into Body

Ensure Correct Orientation. Cartridge Only Fits in One Orientation.

3

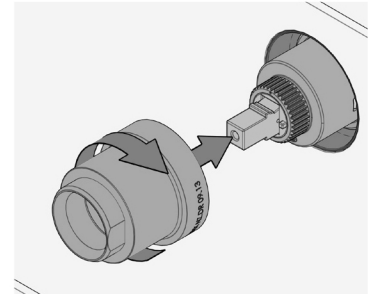

Firmly fasten Cartridge Sleeve to Mixer Body using a shifting spanner.

4

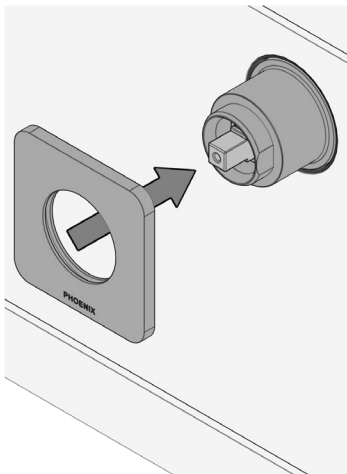

Push Dress Plate over Cartridge Locknut

5

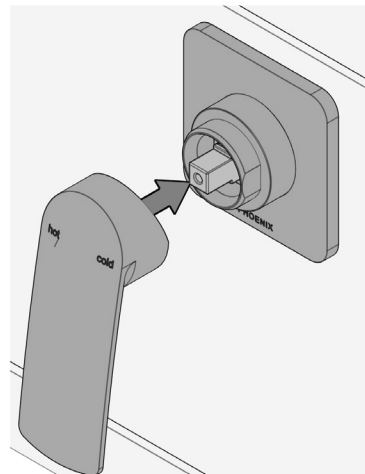

Push Handle onto Cartridge.

6

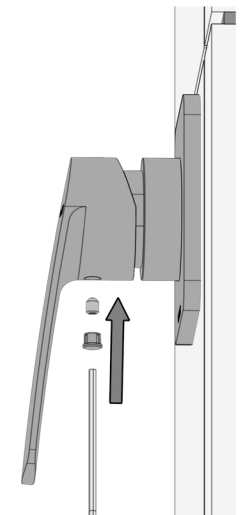

Tighten Grub Screw and push in Cap to secure handle.