

BREECH SET-UP:

Total adjustment range is from 52mm to 69mm.

Between 61mm to 70mm, handle can be installed without trimming the spindle.

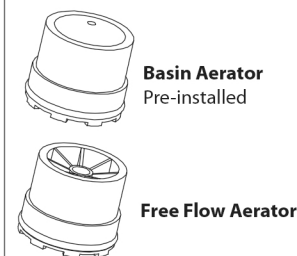
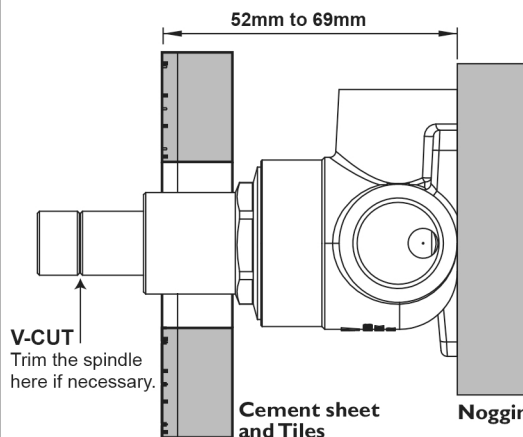

CONVERTING TO BATH FILLER:

Remove Basin Aerator from the outlet with the aerator key. Install Free Flow Aerator to the outlet.

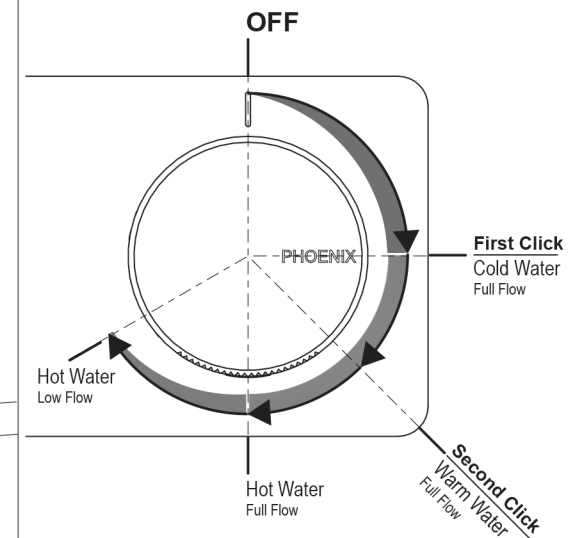
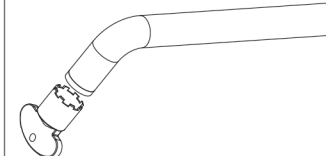

1

Mount the Mixer Breech in place using the wood screws provided. Ensure that Mixer Body is level.

Connect water supply, as shown.

Test and check for leaks.

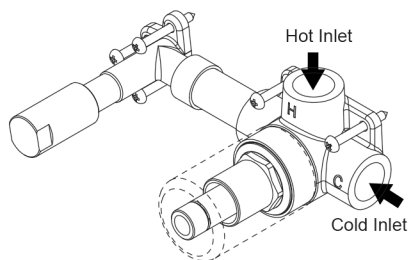

2

Create a 25mm and a 40mm round holes, 100mm apart as shown in diagram, in cement sheet and tiles.

Remove the protective cover and the testing cap. Push on the Dress Plate onto the Mixer Breech.

Fit the plastic ring to the groove in the front of the Locknut. Firmly fasten the Locknut to secure the Dress Plate.

Apply Teflon Tape to the elbow thread. Screw Outlet Adaptor to Elbow Thread with a spanner and make sure that O-Rings are attached to the Outlet Adaptor.

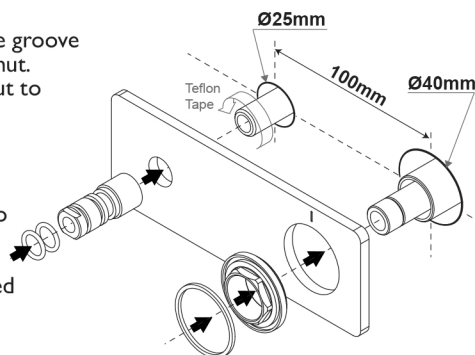

3

Check if the spindle needs to be trimmed. Mixer handle should be resting on the plastic ring.

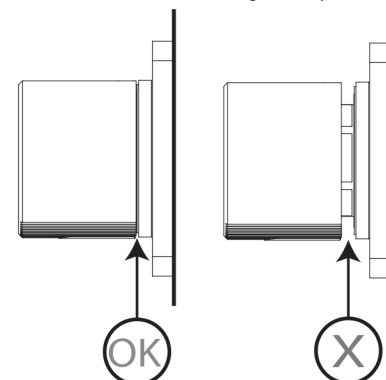

Continue to step 4.

Trim the spindle at "V-CUT" position.

4

Turn the spindle Anti-Clockwise until the cartridge is set to OFF position.

Fit the mixer handle to the spindle and fasten with the grub screw. Push the rubber plug into position.

Push the Outlet to the Outlet Adaptor and fasten Grub Screw to secure the Outlet.

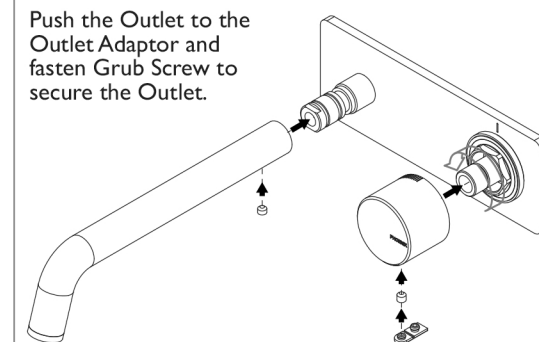

recommended working pressure

150-500 KPa

maximum hot water temperature

55 degrees

