

### ADJUSTMENT RANGE

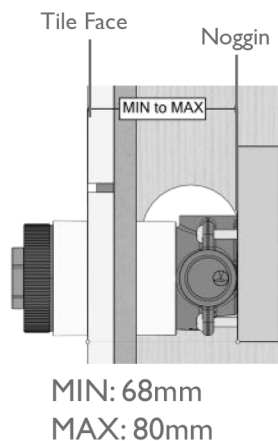

**1**

Mount the Mixer Body in place using the screws provided.

Ensure that Mixer Body is level.

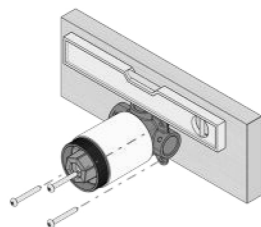

**2**

Remove Plastic Locknut. Apply Grease to Cartridge O-Rings and install Cartridge.

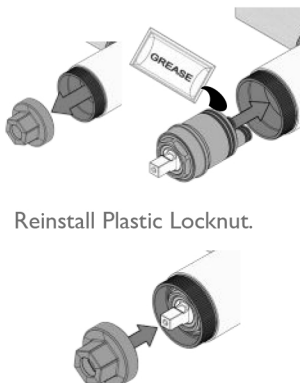

**3**

Connect water supply and water outlet. Test and check for leaks.

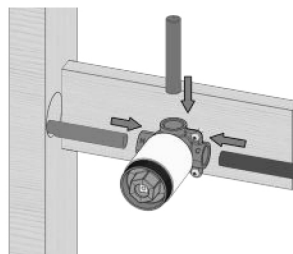

**3**

Seal waterproofing membrane up to waterproofing sleeve.

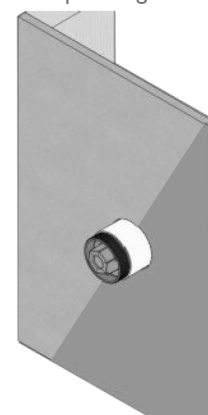

**4**

Use knife to trim Waterproofing Sleeves until flush with tile face.

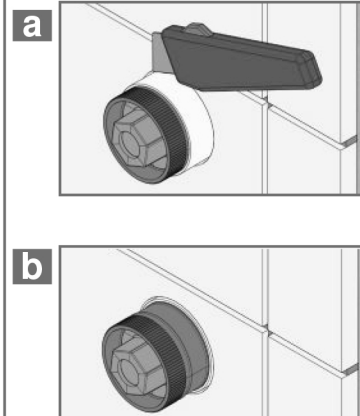

### HOLE DIMENSIONS

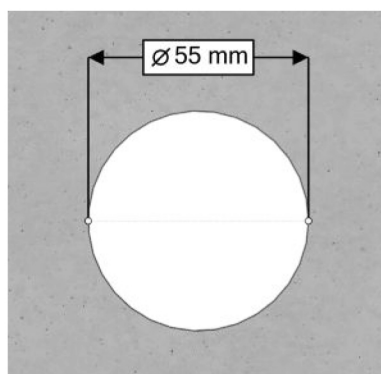

**5**

Unscrew protective cover locknut from Rough In Body.

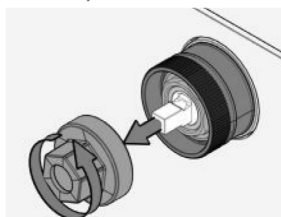

Unscrew Cartridge protective cover.

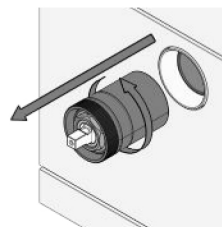

**6**

Screw Wall Mixer Flange onto Rough In Body.

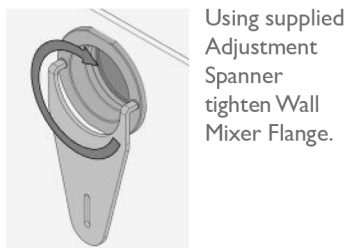
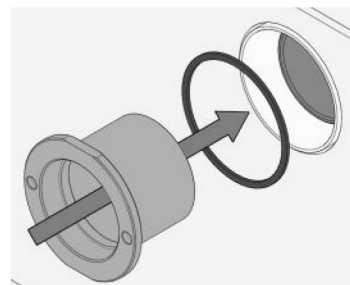

**7**

Apply supplied grease to Rubber O-Rings. Slide Cartridge into position.

Tighten Cartridge Locknut into Wall Mixer Flange.

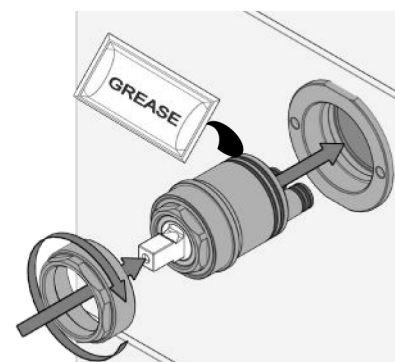

**8**

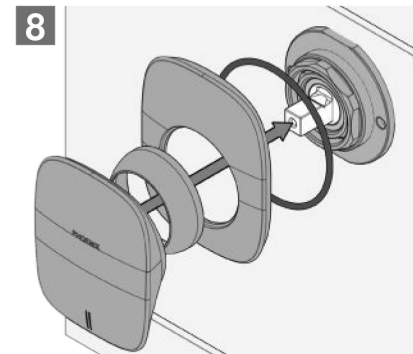

Push Dress plate onto Cartridge and tighten Mixer Dome into place.

Fix Handle into position.

Tighten Grub Screw.

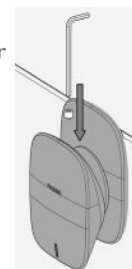

#### NOTE:

- If the pressure exceeds or is likely to exceed 550kPa, an approved pressure limiting device must be installed.
- Flush out all pipe work prior to installation.
- If the water temperature exceeds 75°C, an approved tempering valve must be fitted.
- Installation should comply with Australian standard AS3500.1 or relevant local authority requirements.
- Showers may not be suitable for use within:
  - Gravity-fed water systems
  - Some instantaneous hot water systems; or

- Pressure supply less than 150kPa;
- NOTE: The 500kPa maximum water supply pressure does not apply to fire service outlets.
- Failure to comply with the above may void all warranties.



recommended working pressure

**150-500KPa**

maximum hot water temperature

**75 degrees**

