

1

- Apply Teflon Tape to Threaded Elbow.
- Fit Dress Plate onto end of the Shower Arm.
- Firmly screw the Shower Arm onto the Threaded Elbow.
- Place the Flow Regulator between the two Rubber Washers, as shown.
- Firmly screw on the Shower Rose.

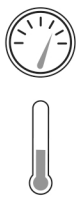
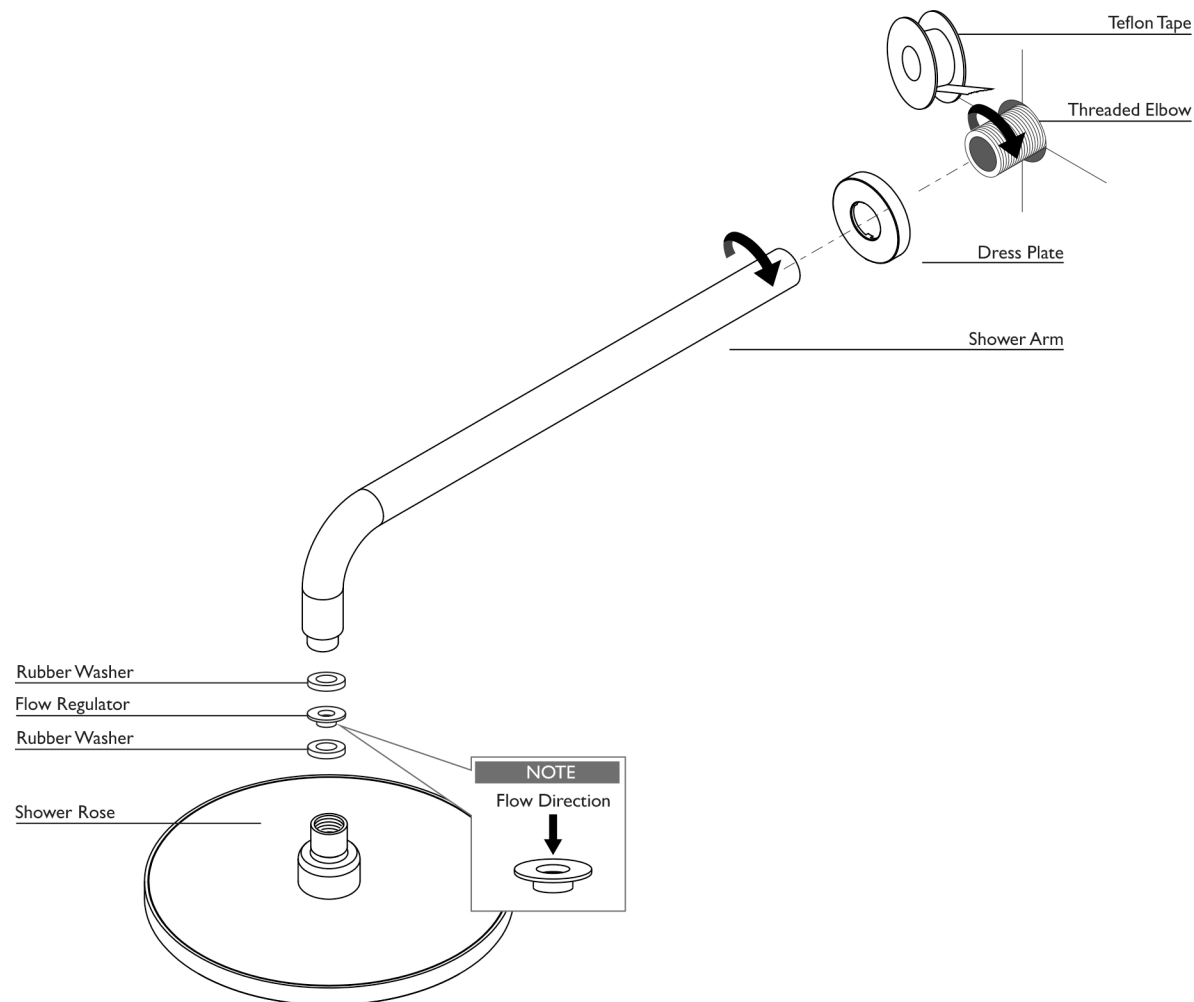

recommended
working pressure
**150-500
KPa**
maximum hot
water temperature
**75
degrees**