

1

- Apply Teflon Tape to Threaded Elbow.
- Fit O-Ring to the groove on the back of the Dress Plate.
- Gently push the Dress Plate over the Threaded Elbow.
- Firmly screw the Shower Arm onto the Threaded Elbow

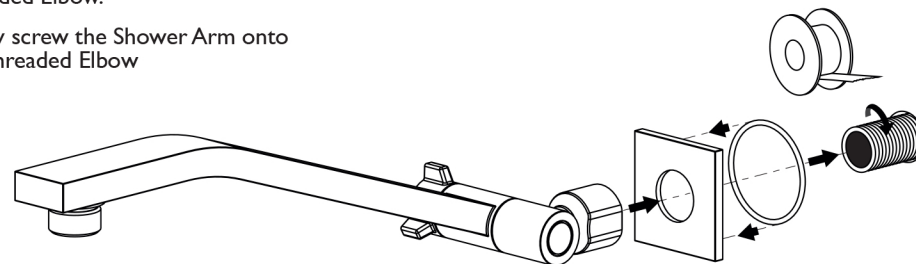

2

- Place the Flow Regulator between the two Rubber Washers, as shown.
- Firmly screw on the Shower Rose.

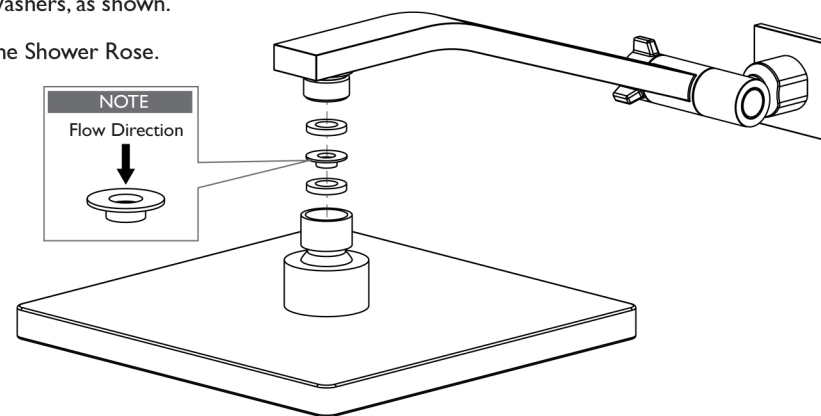

recommended
working pressure
**150-500
KPa**



maximum hot
water temperature
**75
degrees**