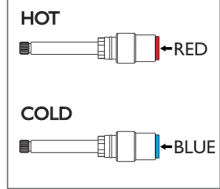
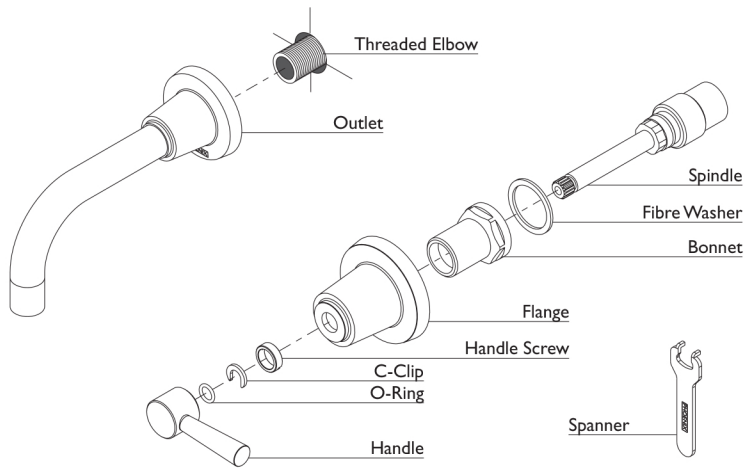

NOTE
Check the rubber seal under each spindle:

HOT
RED

COLD
BLUE

BREACH SET-UP

Ensure that seats in the Breach are in good condition and are free of foreign objects.

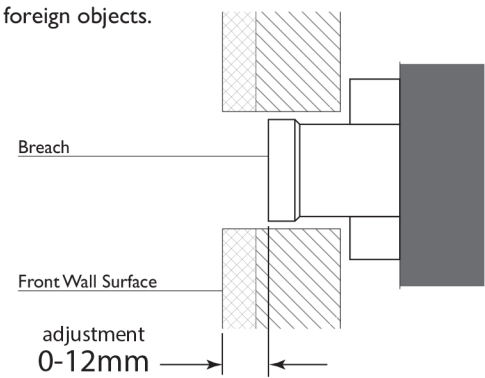

1

- Apply Teflon Tape to Threaded Elbow.
- Firmly screw the Outlet onto Threaded Elbow.

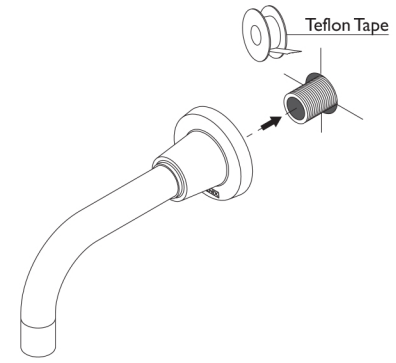

2

Firmly screw Spindle into the Breach.
DO NOT OVERTIGHTEN

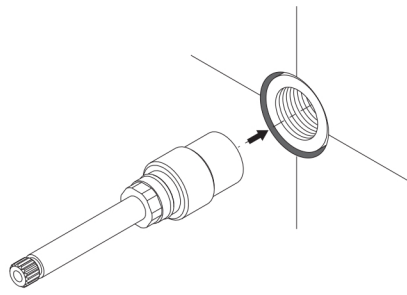

3

Fit Fibre Washer around the Spindle and then firmly fasten the Bonnet onto the Spindle using a spanner.

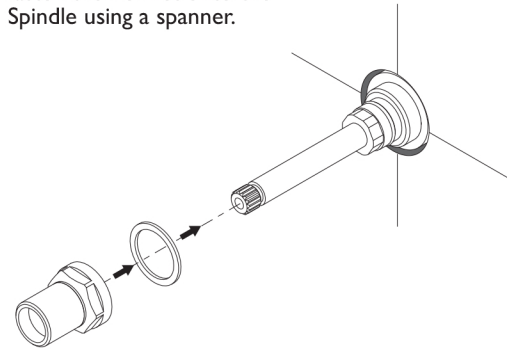

4

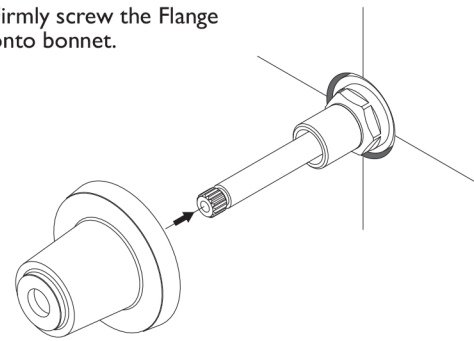

Firmly screw the Flange onto bonnet.



5

- Ensure that both Taps are in the closed position.
- Fit the Handle Screw over the Spindle.
- Fit the C-Clip into the groove in the Spindle.
- Fit the O-Ring then the Handle onto the Spindle.
- Fasten the Handle Screw using the Spanner provided.

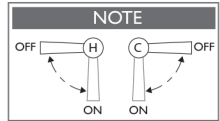
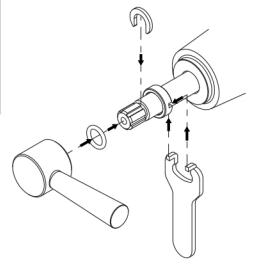
NOTE

recommended working pressure
150-500 KPa

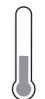

maximum hot water temperature
75 degrees