

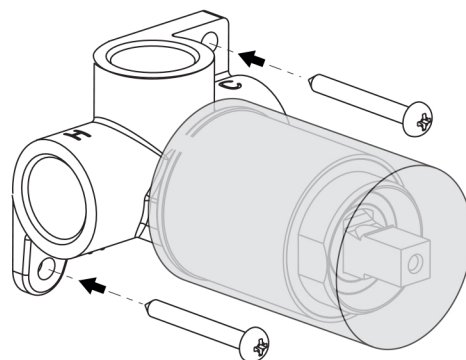

1

Mount the Mixer Body in place using the screws provided.

Ensure that Mixer Body is level.

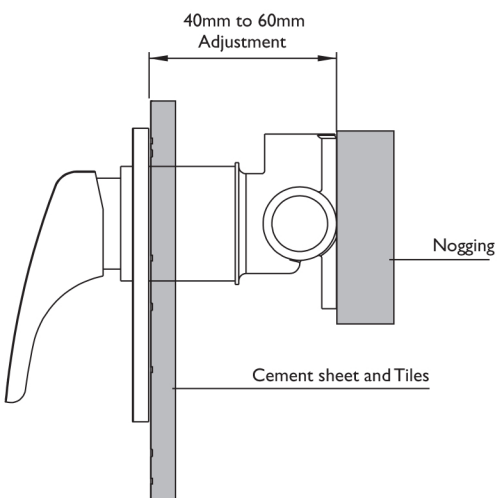

2

Connect water supply and water outlet.

Test and check for leaks.

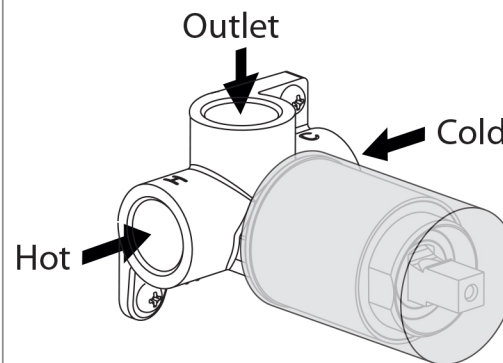

3

- Create a 54mm round hole in cement sheet and tiles.
- Remove the protective cover.
- Push on the Dress Plate onto the Mixer Body.
- Push on the Mixer Handle and fasten Grub Screw.
- Fit Screw Cap into position.

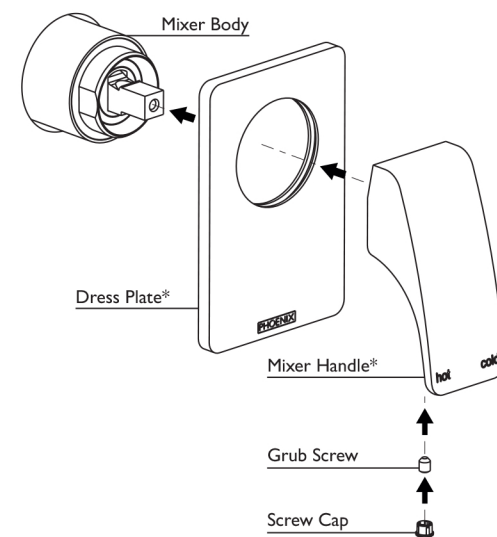

recommended
working pressure

**150-500
KPa**



maximum hot
water temperature

**75
degrees**