

1

- Apply Teflon Tape to Threaded Elbow.
- Firmly screw the Swivel Flange onto Threaded Elbow.

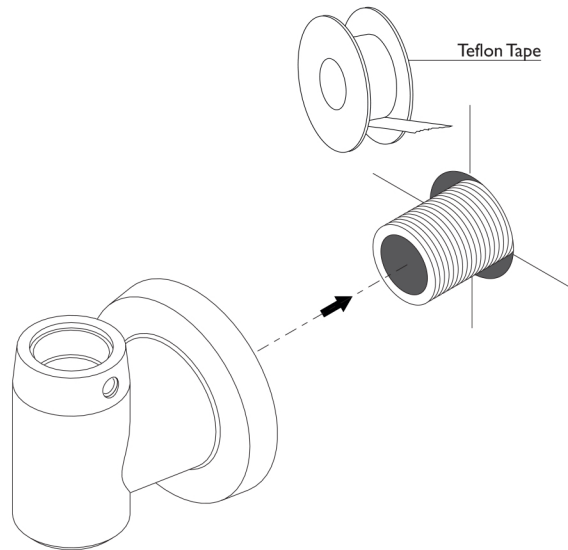

2

- Seat the Small Bearing inside the Swivel Flange.
- Push Spout Tail into the Swivel Flange.
- Fasten Grub Screw until tight and then loosen a quarter turn.

NOTE

Ensure that the hole in the Large Bearing aligns with the grub screw hole:

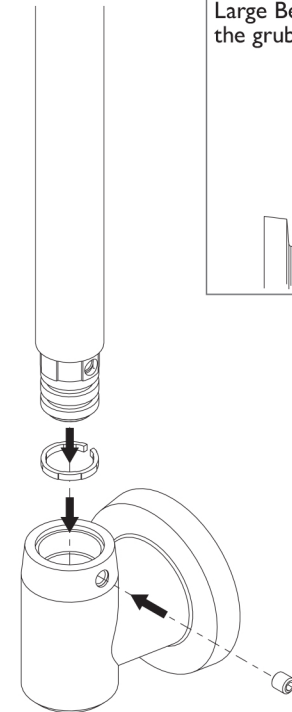

recommended
working pressure

**150-500
KPa**



maximum hot
water temperature

**75
degrees**