

BREACH SET-UP

Ensure that seats in the Breach are in good condition and are free of foreign objects.

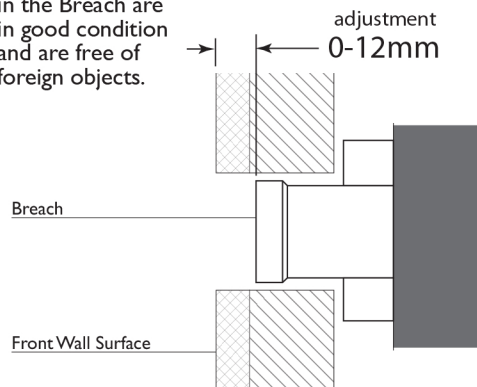

1

- Apply Teflon Tape to Threaded Elbow.
- Firmly screw the Swivel Flange onto Threaded Elbow.
- Seat the Small Bearing inside the Swivel Flange.
- Push Spout Tail into the Swivel Flange.
- Fasten Grub Screw until tight and then loosen a quarter turn.

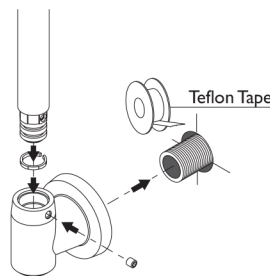

NOTE

Ensure that the hole in the Large Bearing aligns with the grub screw hole:

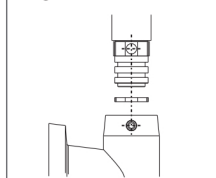

2

Fit Fibre Washer to Spindle and then firmly screw Spindle into the Breach.

Tighten Spindle with a spanner.

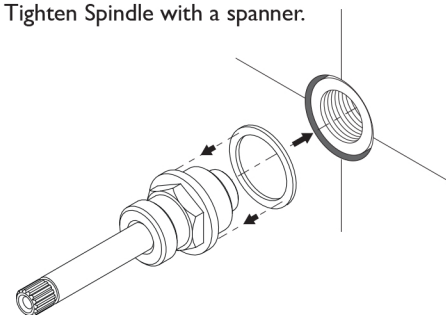

3

Firmly screw the Flange onto Spindle.

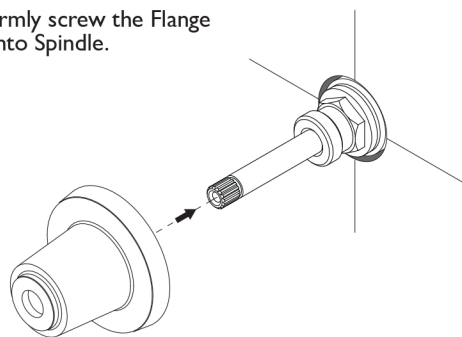

4

- Fit the Handle Screw over the Spindle Arm.
- Fit the C-Clip into the groove in the Spindle Arm.
- Fit the O-Ring then the Handle onto the Spindle Arm.
- Fasten the Handle Screw using the Spanner provided.

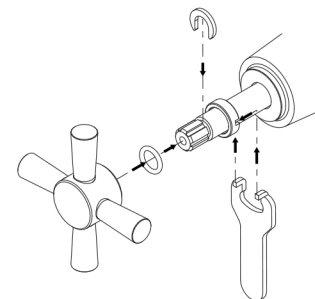

recommended working pressure

150-500 KPa

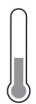

maximum hot water temperature

75 degrees