

BREACH SET-UP

Ensure that seats in the Breach are in good condition and are free of foreign objects.

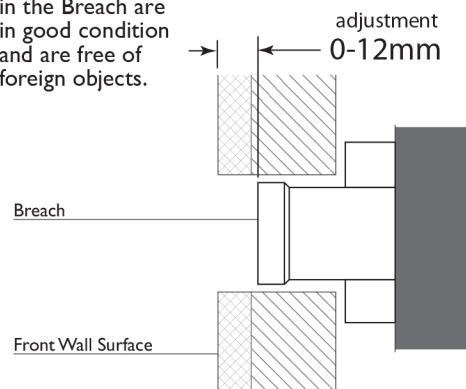

1

Fit Fibre Washer to Spindle and then firmly screw Spindle into the Breach.

Tighten Spindle with a spanner.

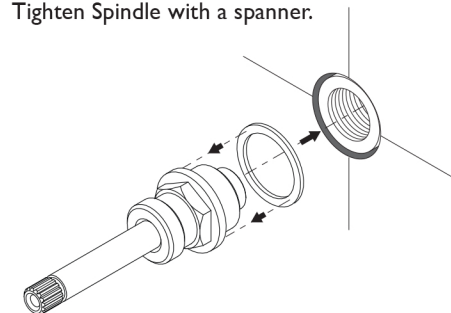

2

Firmly screw the Flange onto Spindle.

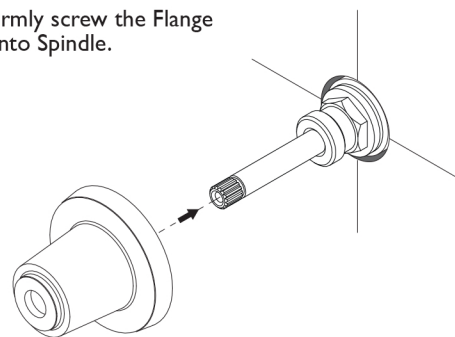

3

- Fit the Handle Screw over the Spindle Arm.
- Fit the C-Clip into the groove in the Spindle Arm.
- Fit the O-Ring then the Handle onto the Spindle Arm.
- Fasten the Handle Screw using the Spanner provided.

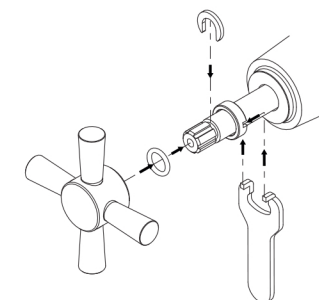

recommended working pressure

150-500 KPa

maximum hot water temperature

75 degrees

