

**NOTE**

Before drilling through the bench surface, check that there is a clear area directly underneath for the sprayer hose to retract. Allow 750mm for normal operation.

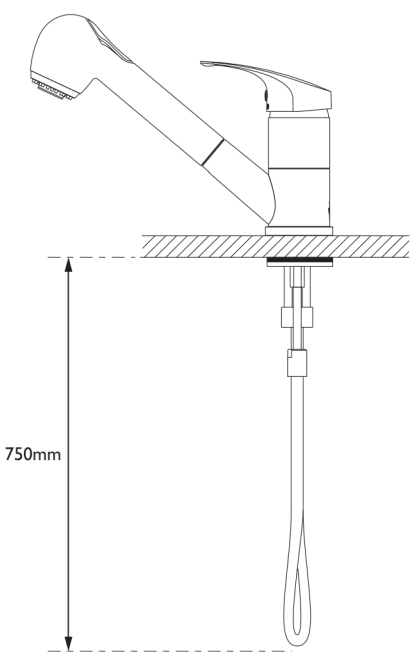

**1**

Using a 38mm hole saw, cut a neat hole through the bench top.

Remove the Inlet Boss, Lock Nut and Mounting Plates from the Threaded Inlet. Feed the Sprayer Hose through the hole and then position the mixer over the hole.

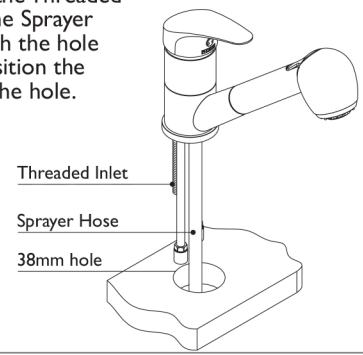
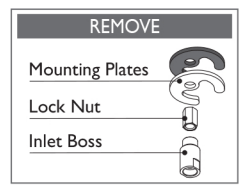

**2**

Slide the Mounting Plates on to the Threaded Inlet and fasten with Lock Nut.

Firmly fasten the Inlet Boss to the Threaded Inlet. Please ensure that the rubber gasket is still in the top of the Inlet Boss.

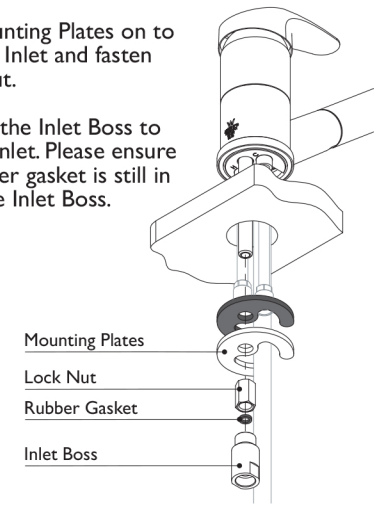

**3**

Attach the Counter Weight to the Sprayer Hose with the two screws supplied. Adjust the Counter Weight to approximately 200mm from the bottom of the Sprayer Hose.

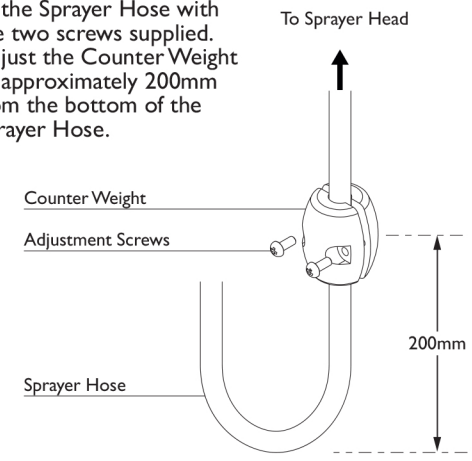

**4**

Connect the Sprayer Hose fitting to the Inlet Boss

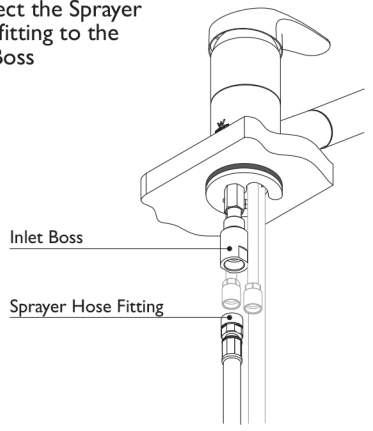

**5**

Connect Hoses to the Mixer Inlets. Ensure that the Red Marked Hot Water Hose is connected to the inlet that is marked with Red Indicator Tape.

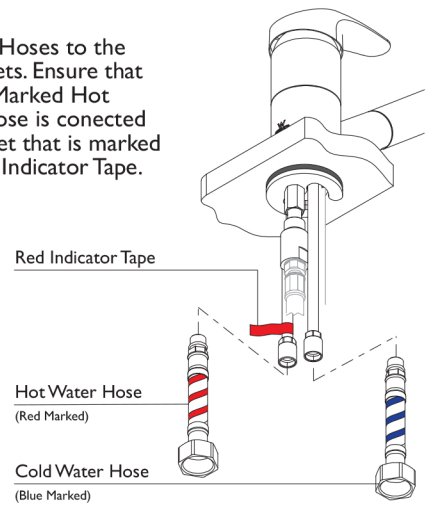

**6**

Connect Hoses to water supply. **CHECK AND TEST FOR LEAKS**

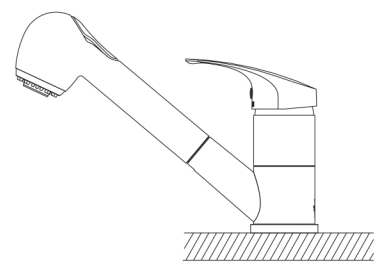

recommended working pressure  
**150-500 KPa**  
maximum hot water temperature  
**75 degrees**