

1

Carefully drill 2 x 25mm diameter holes through the bench top at 200mm centres.

When marking out hole centres, double check dimensions of the breach before drilling.

NOTE: Maximum bench thickness is 35mm

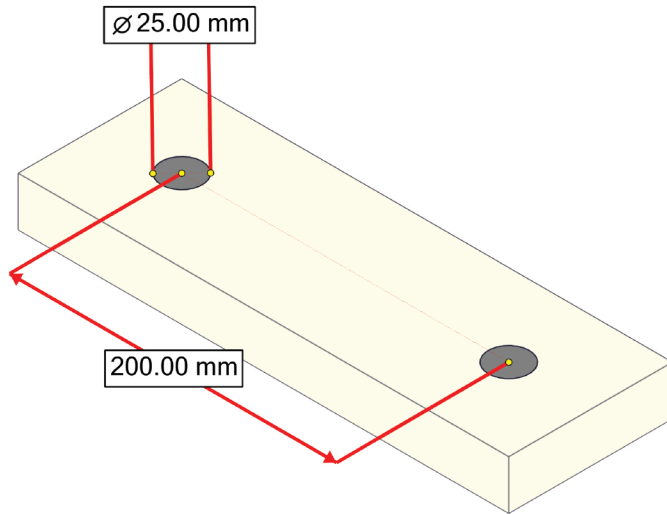

2

Thread Mixer Body through benchtop as shown.

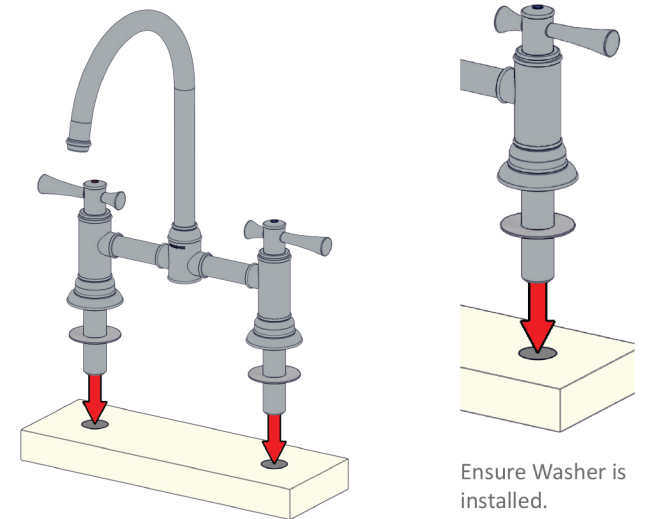

3

From underneath the bench, fit locknut to each extended tail.

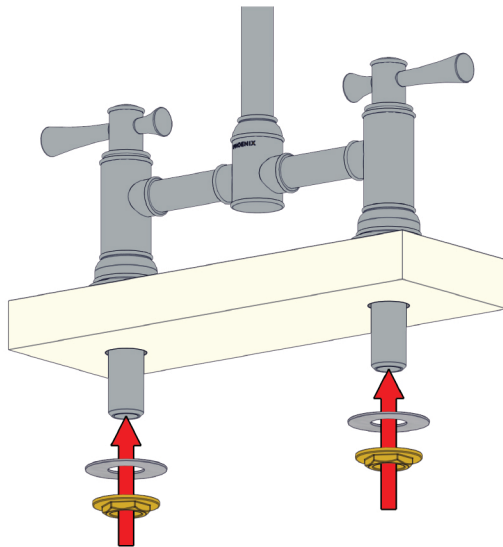

4

Connect HOT and COLD Hoses to extended tails. CHECK FOR LEAKS!

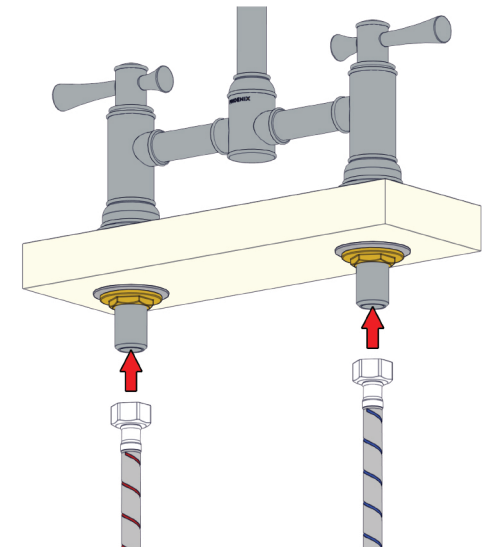

recommended working pressure

150-500KPa

maximum hot water temperature

75 degrees