



IMPORTANT

Maintenance and Care

- Chrome plated surfaces should be cleaned with mild liquid detergent or soap and water.
- Do not** use cream cleaners or citrus based cleaning products, as they are abrasive.
- Use of unsuitable cleaning agents may damage the surface. Any damage caused in this way will not be covered by warranty.

INSTALLATION INSTRUCTIONS

- 1 Place Mounting Plate ② to desired position on the wall. Mark hole locations.
- 2 Using a 6mm drill bit to drill holes and press Plastic Wall Plug ① into wall hole until flush with surface. Fasten Mounting Plate ② to the wall with Screws ③ supplied.
- 3 Fit Accessory ⑥ onto Mounting Plate ② and fasten Grub Screw ④.

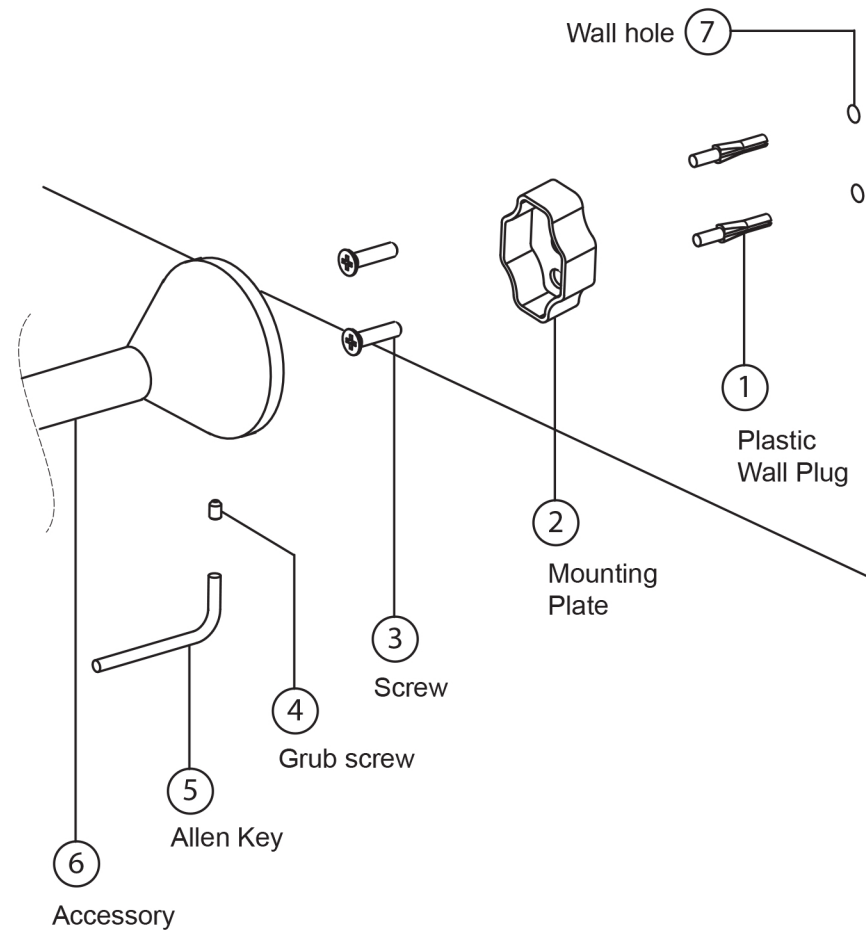

recommended
working pressure

**150-500
KPa**

maximum hot
water temperature

**75
degrees**

