

User Manual

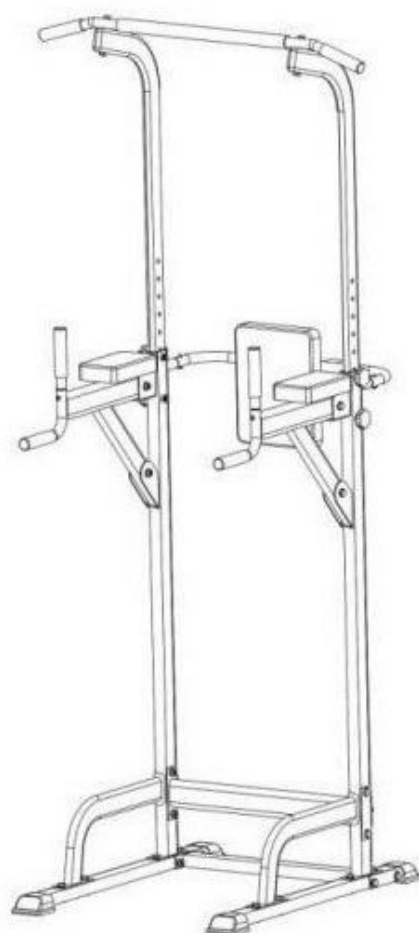

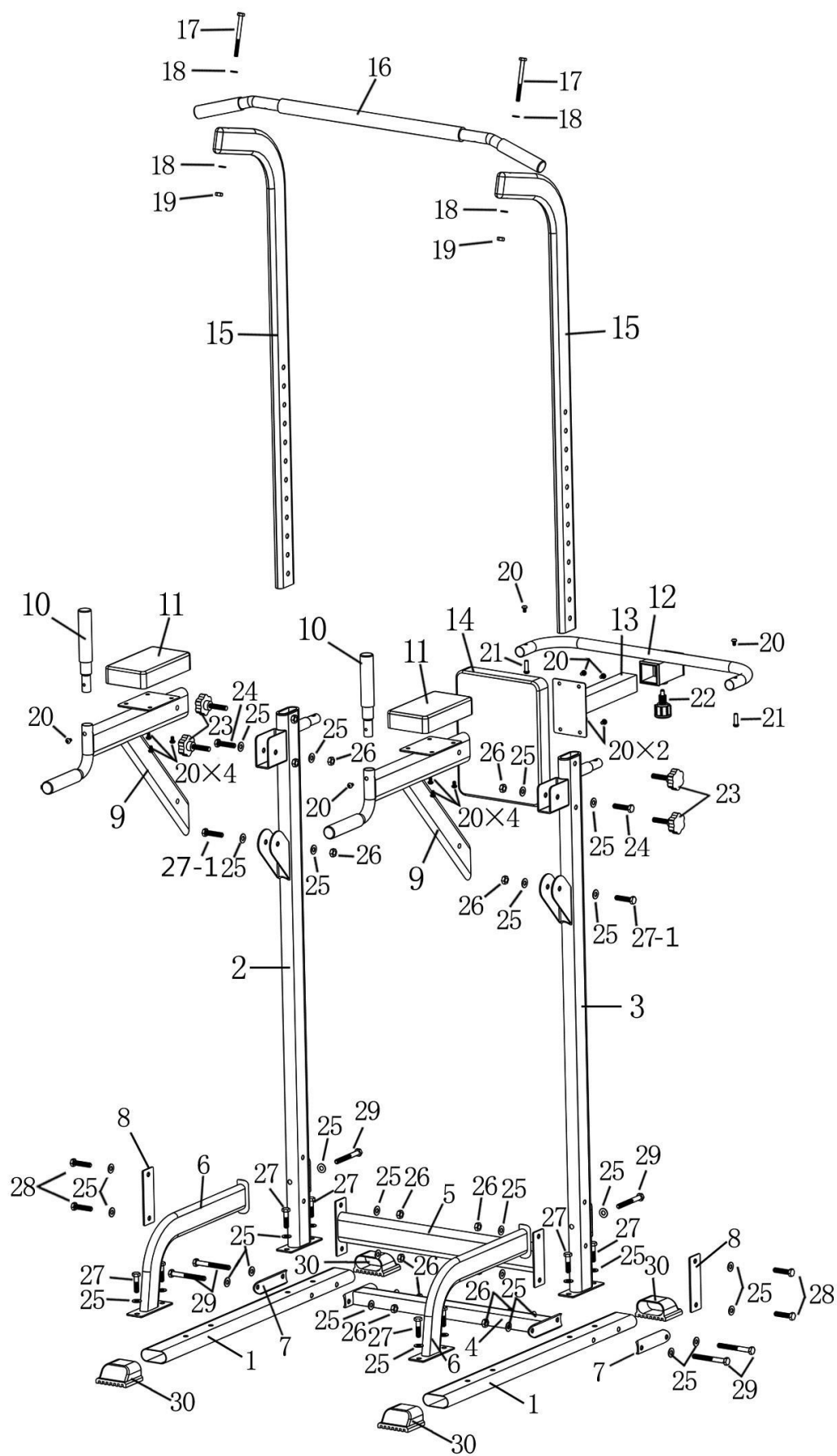

Fittings

	Fittings	Quantity
1	Base	2
2	Left holder	1
3	Right holder	1
4	Connect tube A	1
5	Connect tube B	1
6	Support tube	2
7	Arc connect piece	2
8	Connect piece	2
9	Dip piece	2
10	Handle	2
11	Cushion for arms	2
12	"U" connect tube	1
13	Cushion adjust tube	1
14	Cushion	1
15	Height adjust tube	2
16	Horizontal bar piece	1
17	Screw M8*90	2
18	Washer $\Phi 8$	4
19	Nut M8	2
20	Screw M6*10	16
21	Cylinder screw	2
22	Elastic lock pin screw	1
23	Adjust screw	4
24	Screw M10*50	2
25	Washer $\Phi 10$	34
26	Nut M10	12
27	Screw M10*35	8
27-1	Screw M10*40	2
28	Screw M10*50	4
29	Screw M10*90	6
30	Tube cover	4

Step 1

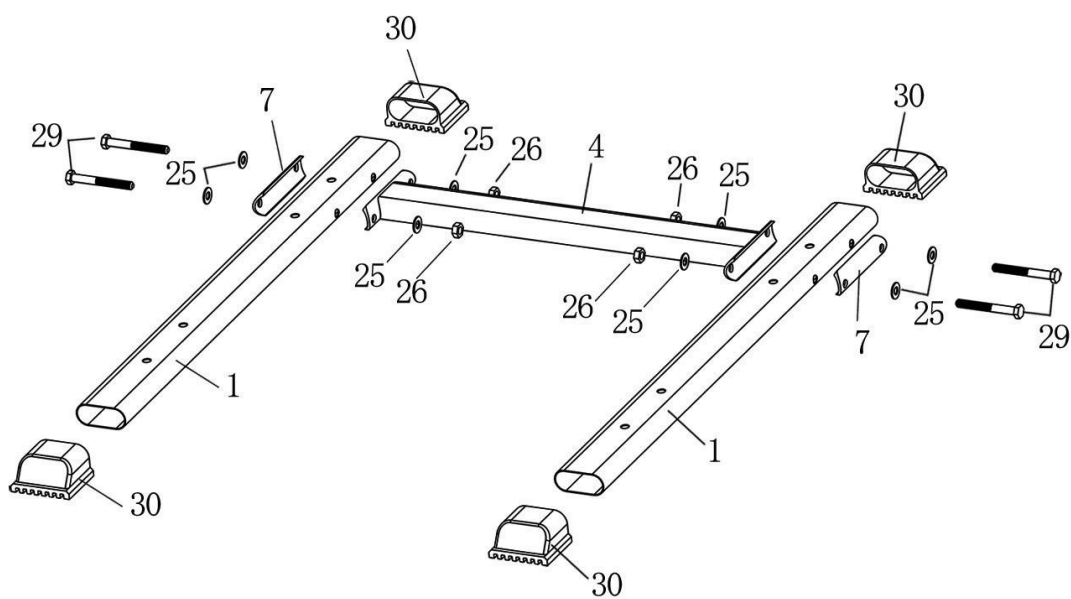

- 1.Insert the tube cover(30) into two ends of the base(1).
- 2.Assemble base(1), connect tube A(4),arc connect piece(7) together with screw(29),washer(25),nut(26).

Notice:Do not tighten the screws firstly.

Step 2

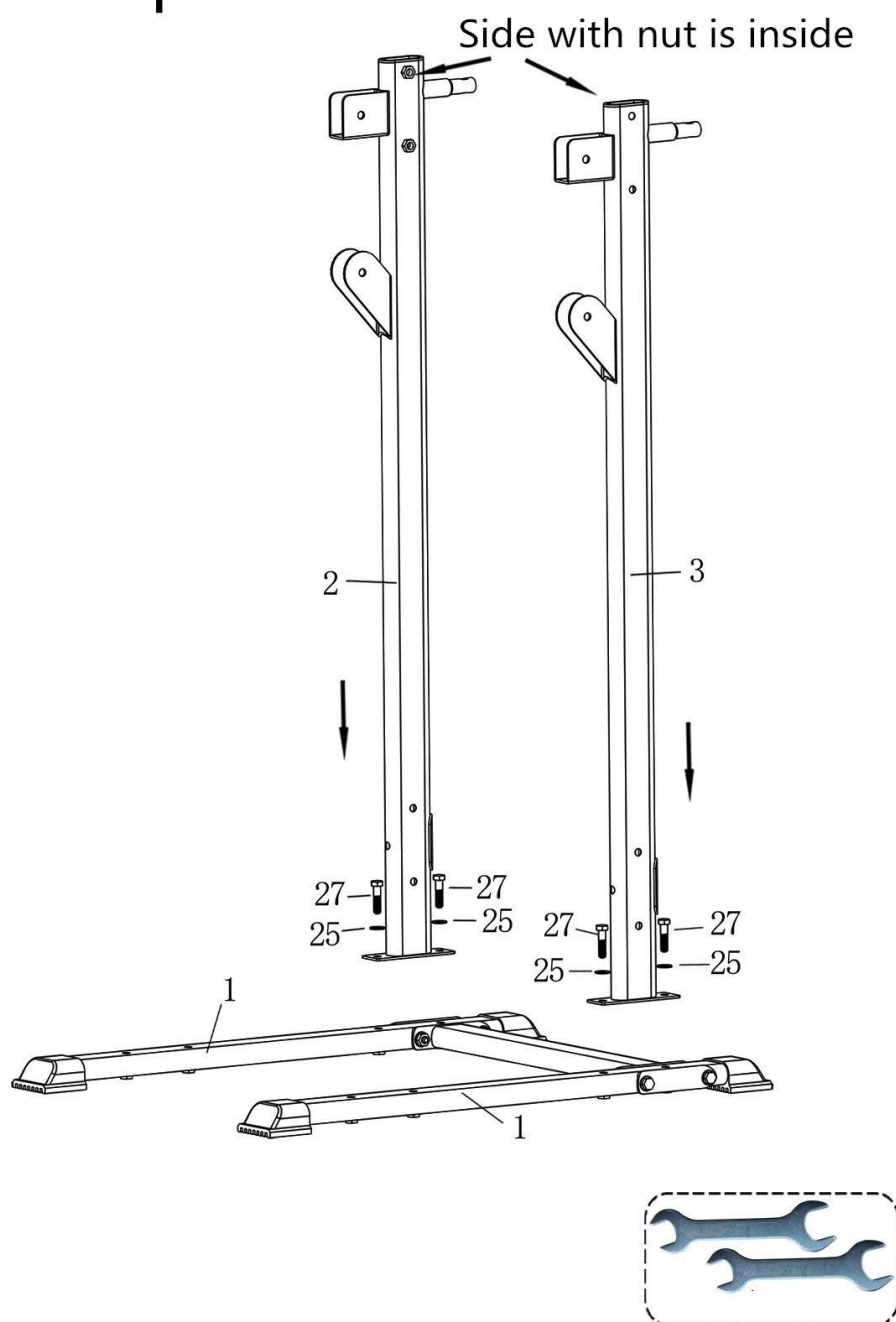

Assemble left holder(2),right holder(3),base(1)
with screw(27),washer(25).

Notice:Do not tighten the screws firstly.

Step 3

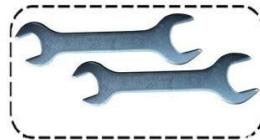
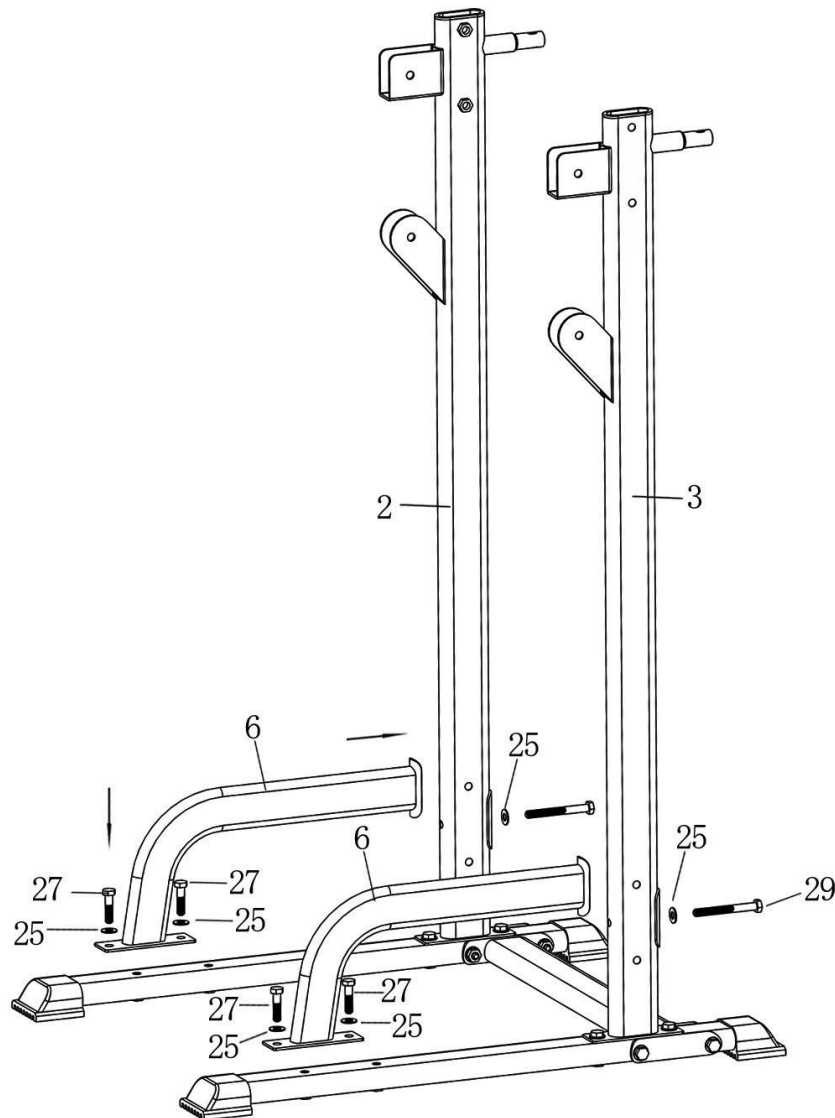

- 1.Connect base(1),support tube(6) with screw(27),washer(25).
- 2.Connect support tube(6) ,left holder(2),right holder(3) with screw(29),washer(25)

Notice:Do not tighten the screws firstly.

Step 4

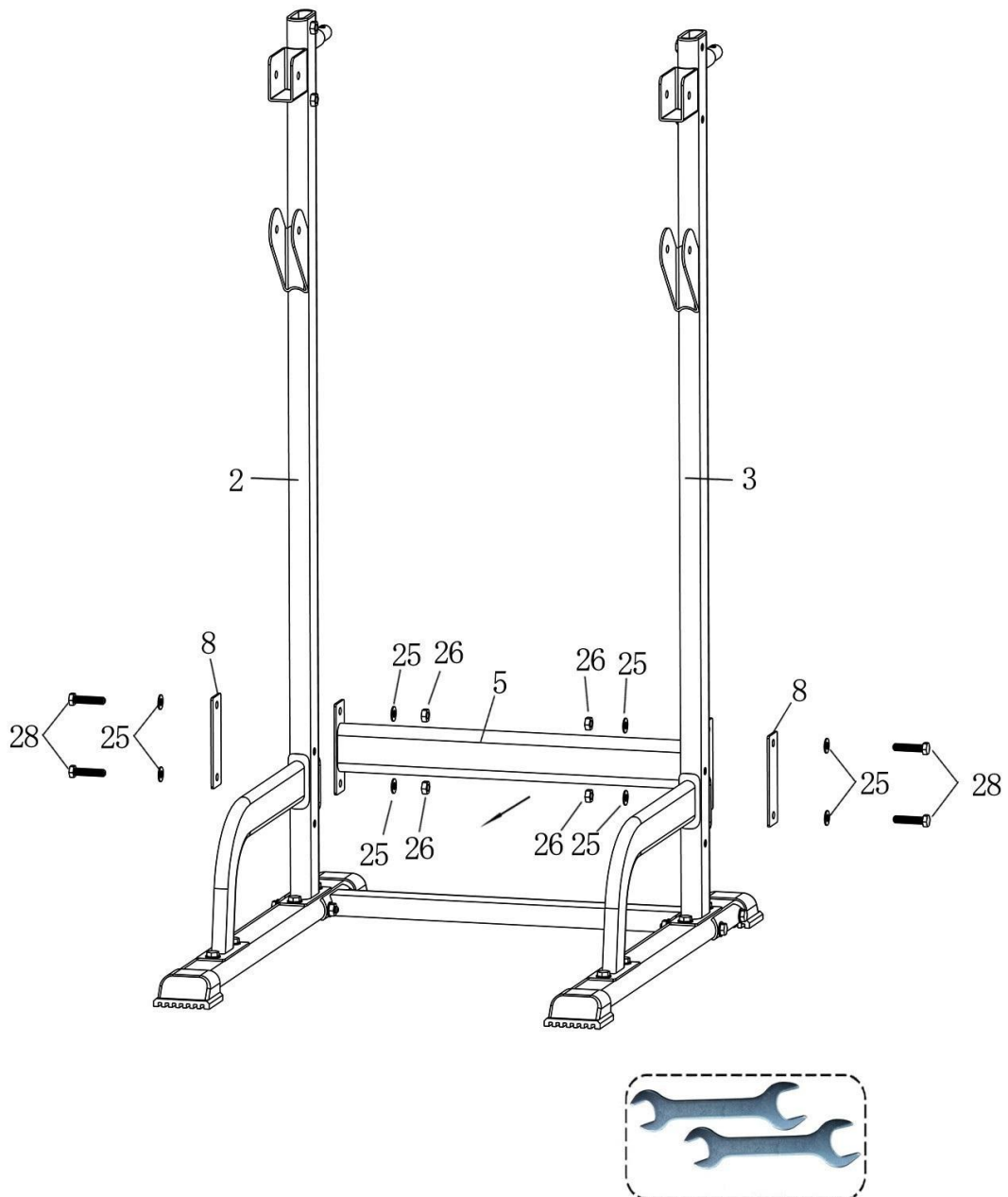

Connect left holder(2) and right holder(3), connect tube B(5) and connect piece(8) together with screw(28),washer(25),nut(26).

Notice: Do not tighten the screws firstly.

Step 5

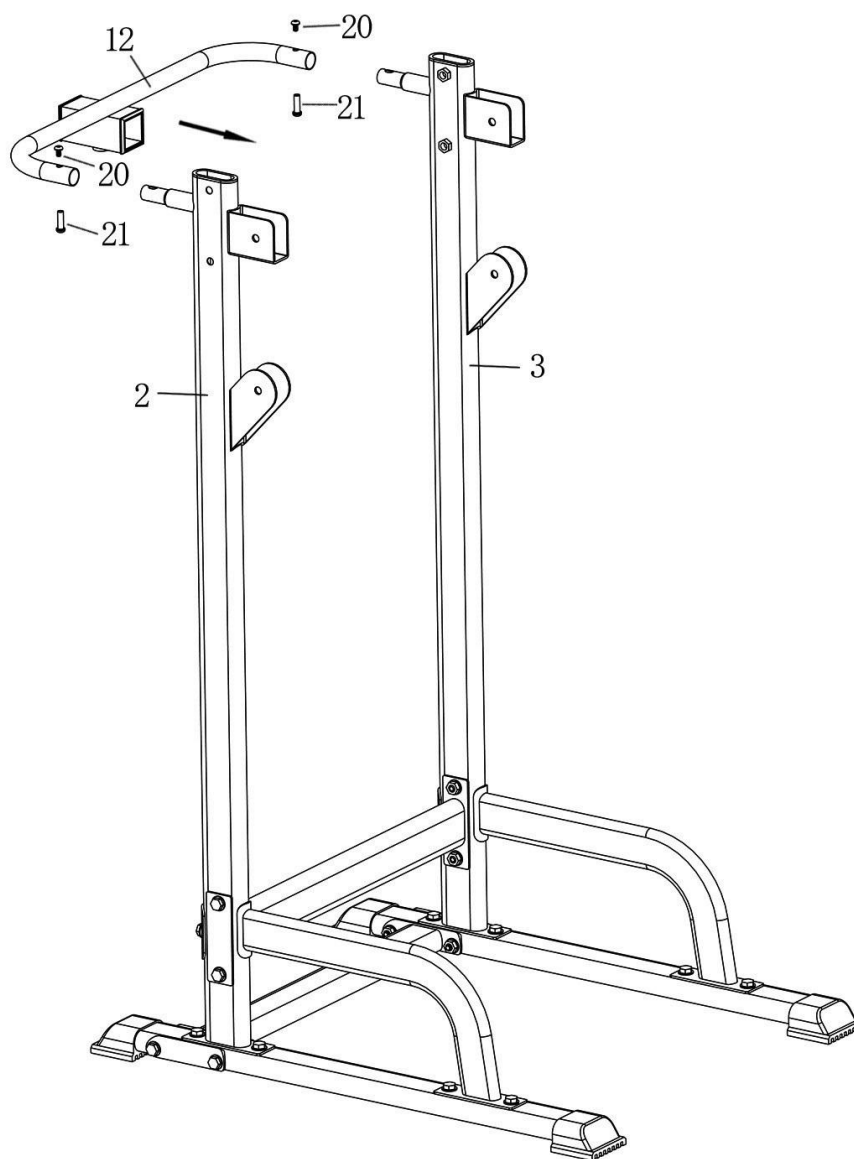

Install "U"connect tube(12) into left holder(2) and right holder(3),
Locking and fixing with screw(20) and cylinder screw(21).

Step 6

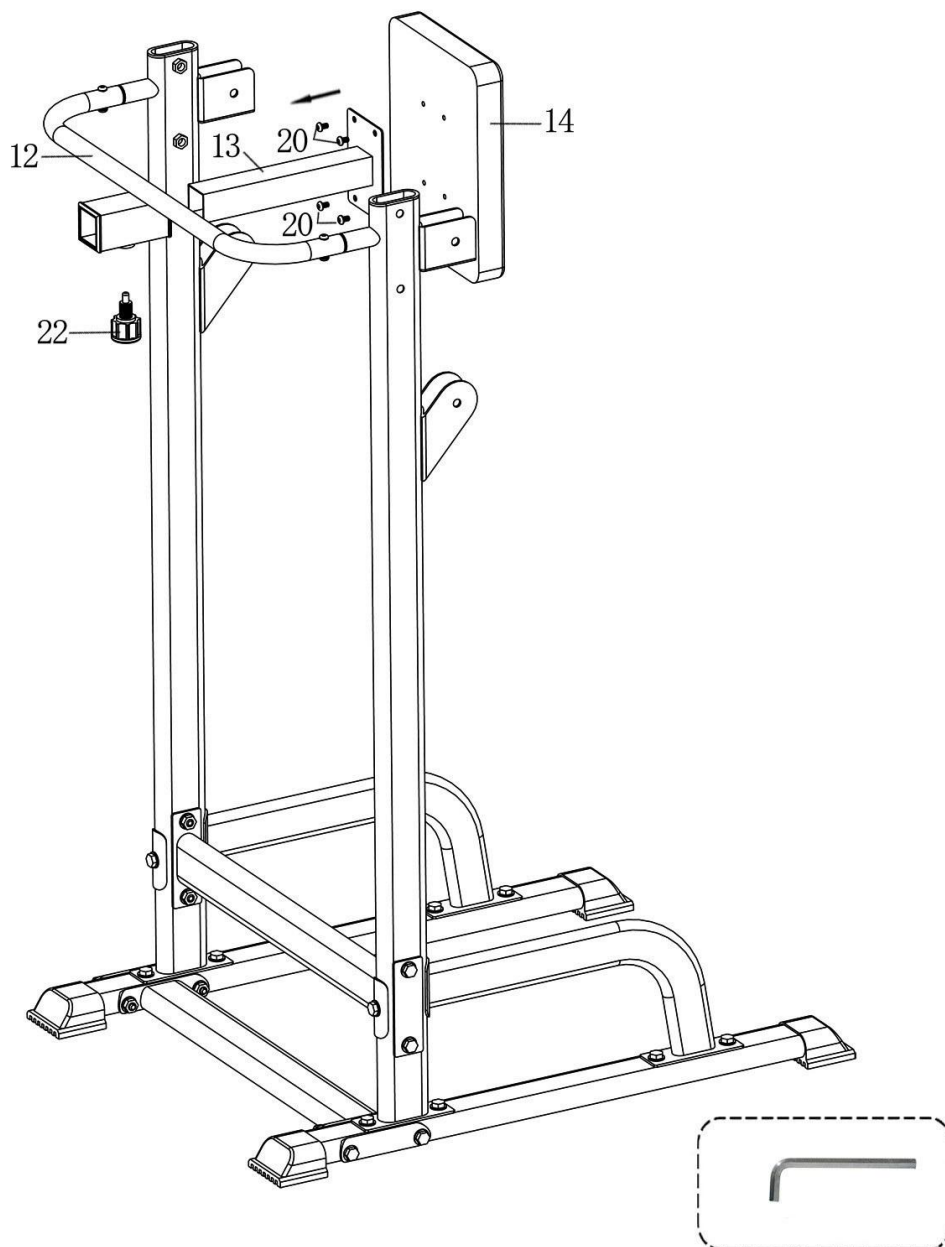

Locking cushion adjust tube (13) and cushion(14) together with screw(20),then insert into 'U'connect tube(12), lock with elastic lock pin screw(22).
Notice:when you need to adjust the cushion, loose elastic lock pin screw(22)firstly,then pull down.

Step 7

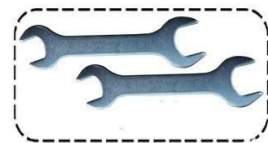
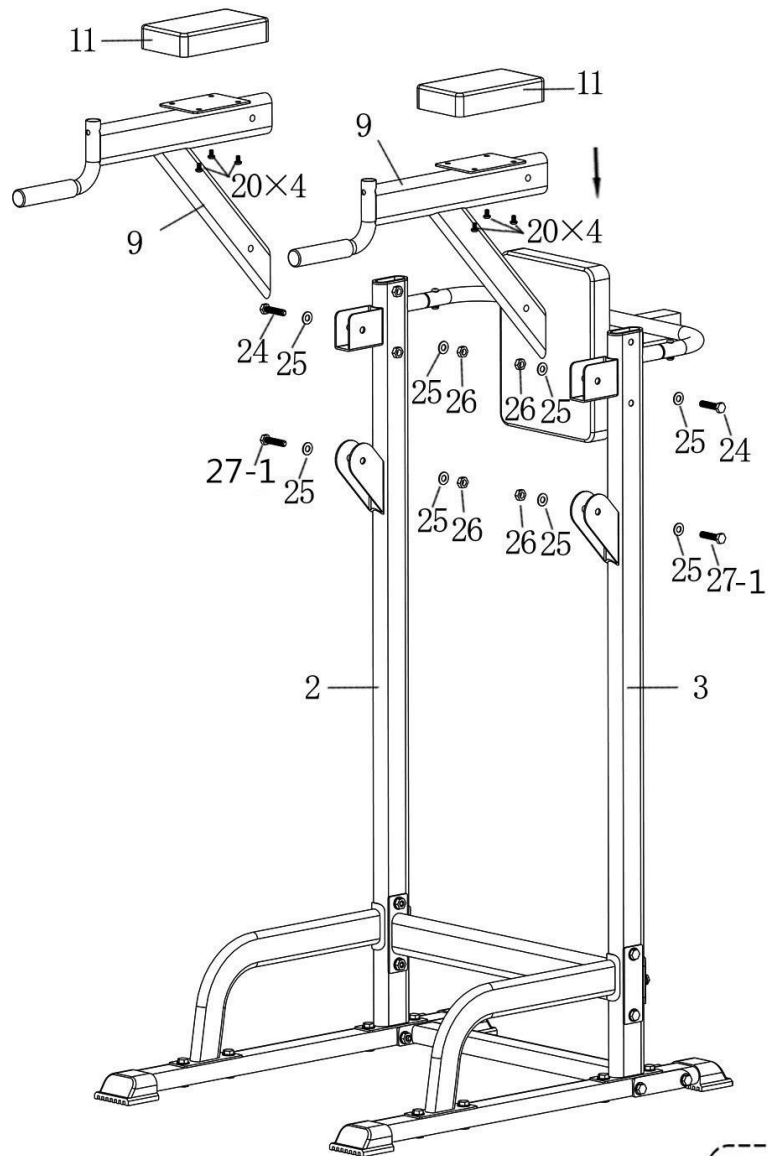

Install cushion for arms(11) in dip piece(9),lock with screw(20). Then install into left holder(2) and right holder(3), lock with screw (24,27 -1),washer(25), nut(26).

Step 8

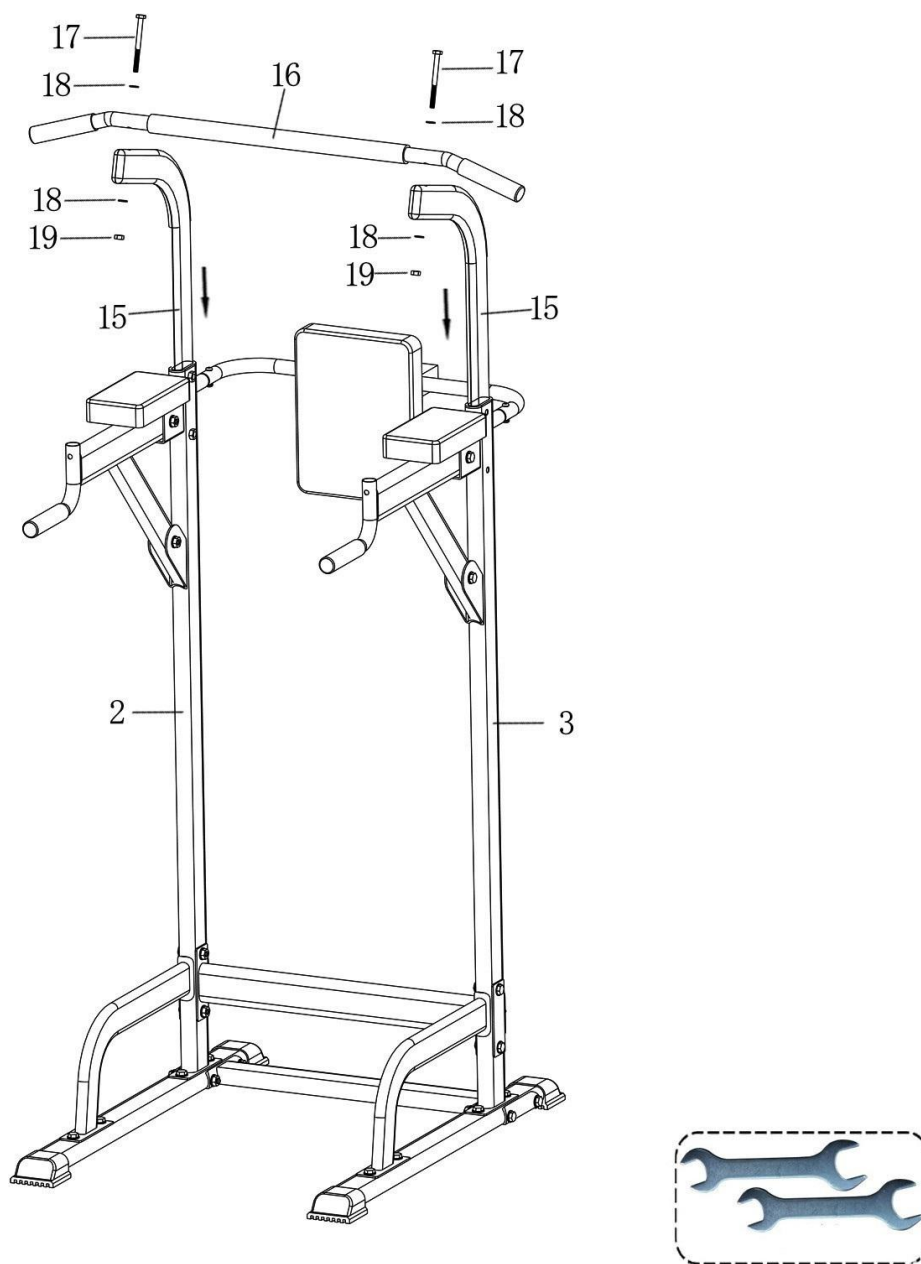

- 1.Insert height adjust tube(15) into left holder(2) and right holder(3).
- 2.Install and lock horizontal bar(16) and height adjust tube(15) together with screw(17), washer(18),nut(19).

Step 9

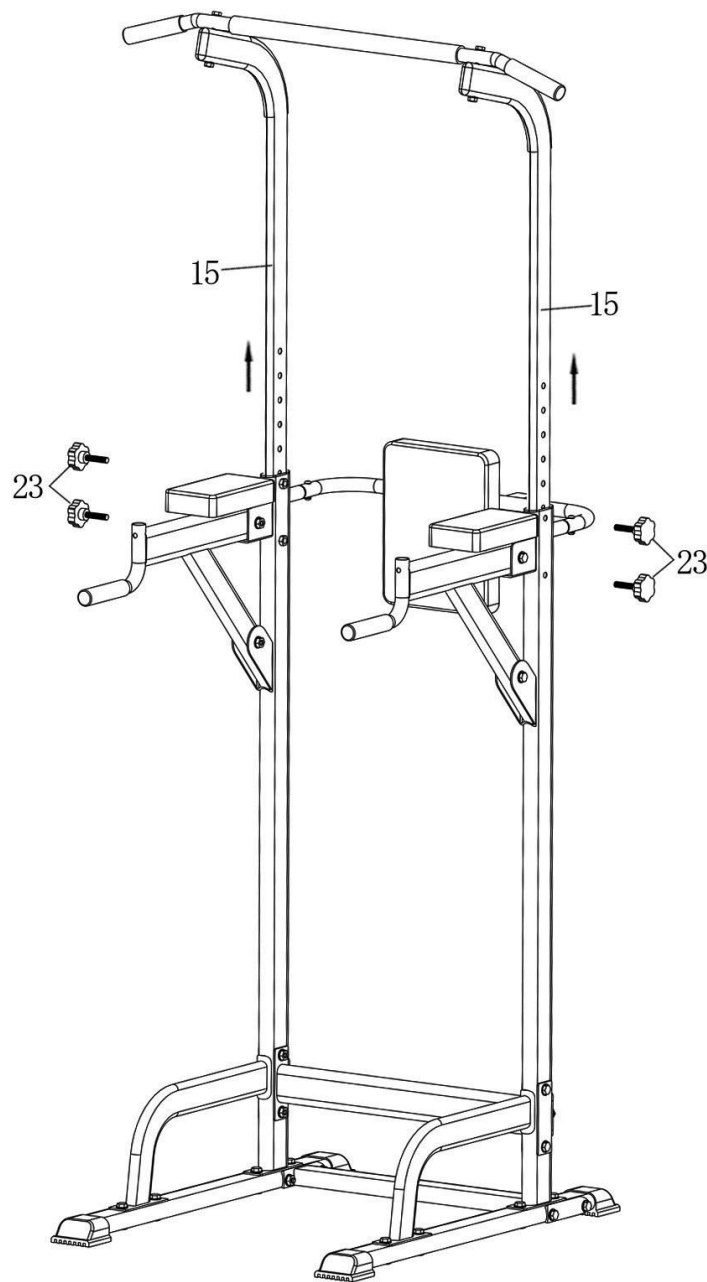

Raise height adjust tube (15) to the position you need.
Locking and fixing with adjust screw(23).

Step 10

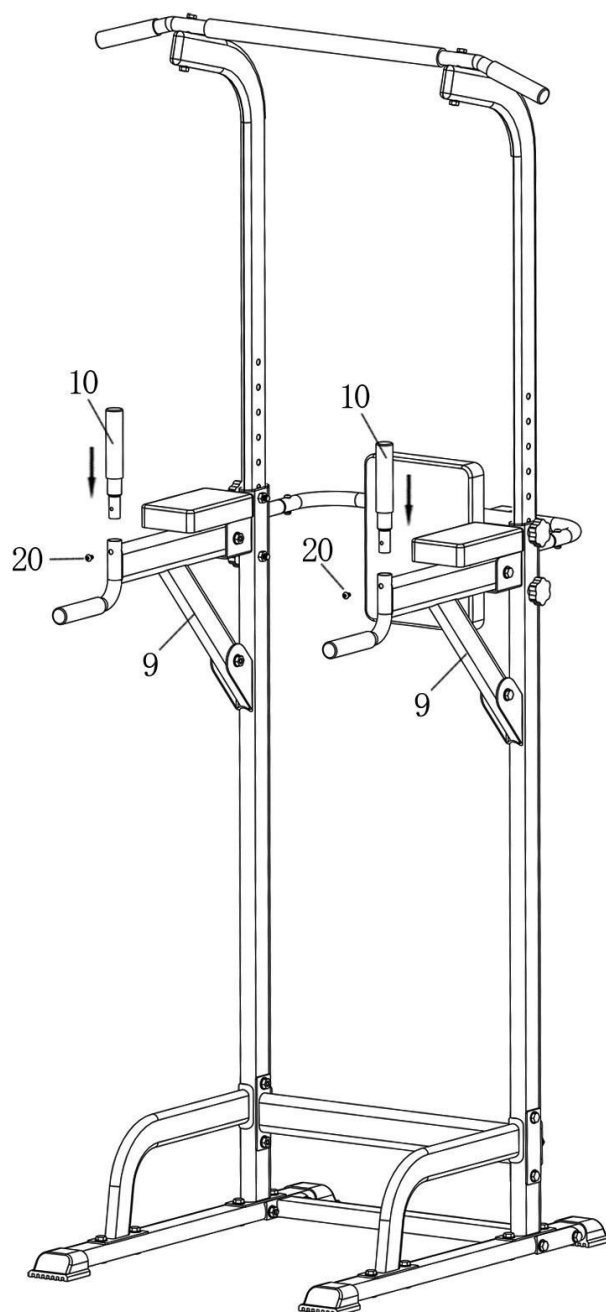

Insert handles(10) into dip piece,lock with screw(20).
Notice: lock all screws, the installation is complete.