

ASSEMBLY INSTRUCTIONS

PAGE: 1/6

MODEL : UH 7149

Before you begin, please follow assembly instructions carefully, then follow them step by step.

Read instruction carefully . See Furniture Parts list and Hardware List for guidance . Be sure you have all parts before you start assembling .
Place and assemble furniture on a clean flat soft surface , such as carpet or rug to prevent being scratched .

PART LIST		QTY
1	TOP PANEL	1 PC
2	BOTTOM PANEL	1 PC
3	SIDE PANEL (L)	1 PC
4	SIDE PANEL (R)	1 PC
5	CENTER PANEL (L)	1 PC
6	CENTER PANEL (R)	1 PC
7	BONE PANEL	6 PCS
8	BACK PANEL	1 PC
9	DRAWER FRONT (L)	3 PCS
10	DRAWER FRONT (CENTER)	3 PCS
11	DRAWER FRONT (R)	3 PCS
12	DRAWER SIDE	18 PCS
13	DRAWER BACK	9 PCS
14	DRAWER BOTTOM	9 PCS
15	LEG	4 PCS

HARDWARE		
A	MINI FIX A1 A2 A3	8 PCS
B	M8 X 30MM WOOD DOWEL	40 PCS
C	M6 X 50MM CSK CAP WOOD SCREW	8 PCS
D	5/8 NAIL	98 PCS
E	ALLEN KEY M4	1 PC
F	ONE HOLE L BRACKET (2MM)	12 PCS
G	M3.5 X 16MM C.B SCREW	132 PCS
H	M4 X 38MM C.B SCREW	72 PCS
I	14" DRAWER SLIDE I1 (L/R) I2 (L/R)	9 SETS
J	JCBC Screw M6 x 70	8 PCS
K	SPRING WASHER M6	8 PCS
L	FLAT WASHER M6	8 PCS
M	ANTI-TIPPING PACK WITH AI M1 M2 M3 M4	2 SETS
N	WALL PLUG (NOT INCLUDED)	-

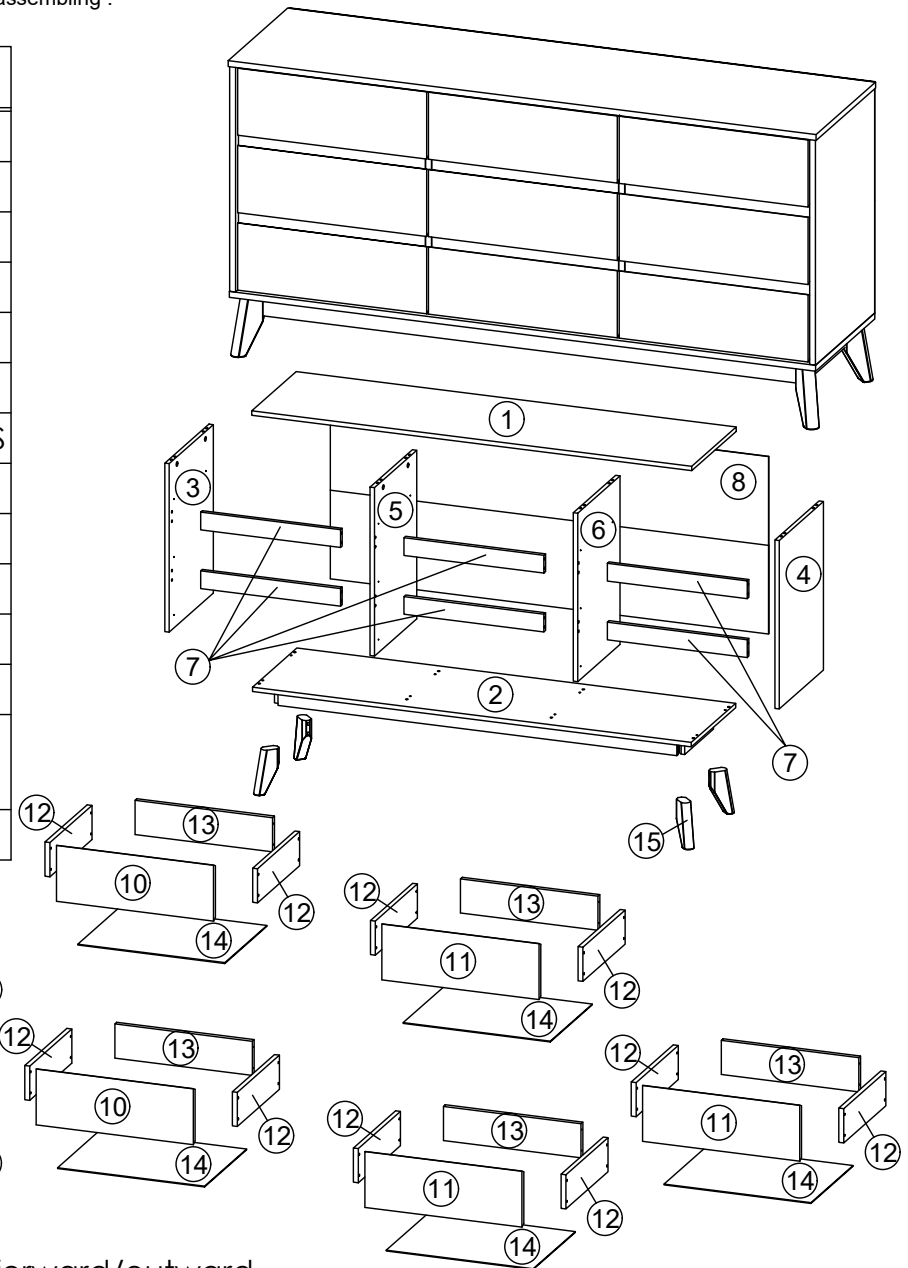

SELF-PREPARED TOOLS: Tools below are NOT included in package.



SCREWDRIVER



HAMMER

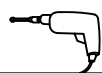

POWER DRILL

Reminder:

The maximum recommended weight for this product is 40kg

Please ensure that all surfaces and edges with colours/laminations are facing forward/outward.

ASSEMBLY INSTRUCTIONS

PAGE: 2/6

STEP 1

Insert hardware **A2** onto panel **(1)**.
(Repeat 8 times.)

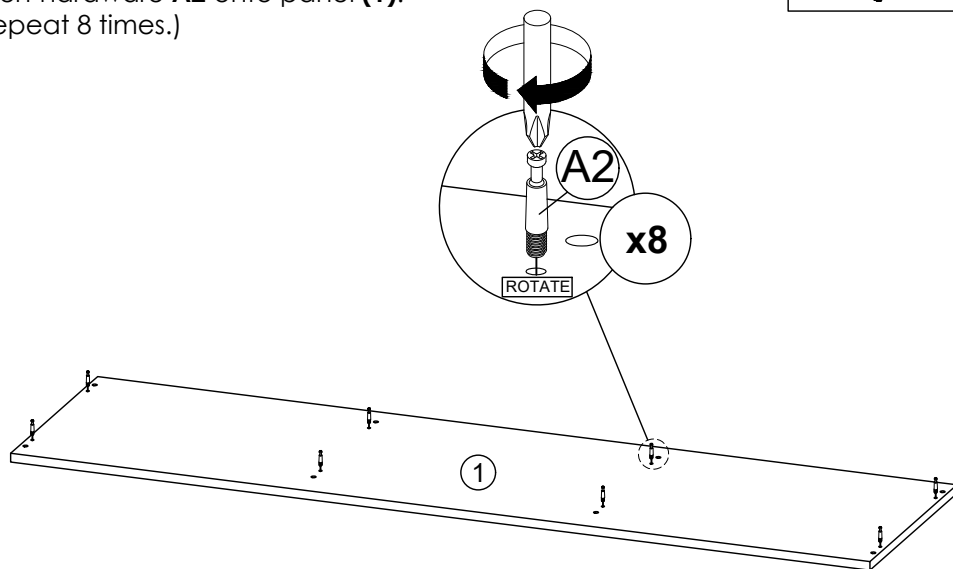

MODEL : UH 7149

STEP 2

- Insert hardware **A1** onto panel **(3), (4), (5)** and **(6)**.
(Repeat 2 times on each panel.)
- Insert hardware **B** onto panel **(3), (4), (5)** and **(6)**.
(Repeat 4 times on each panel.)

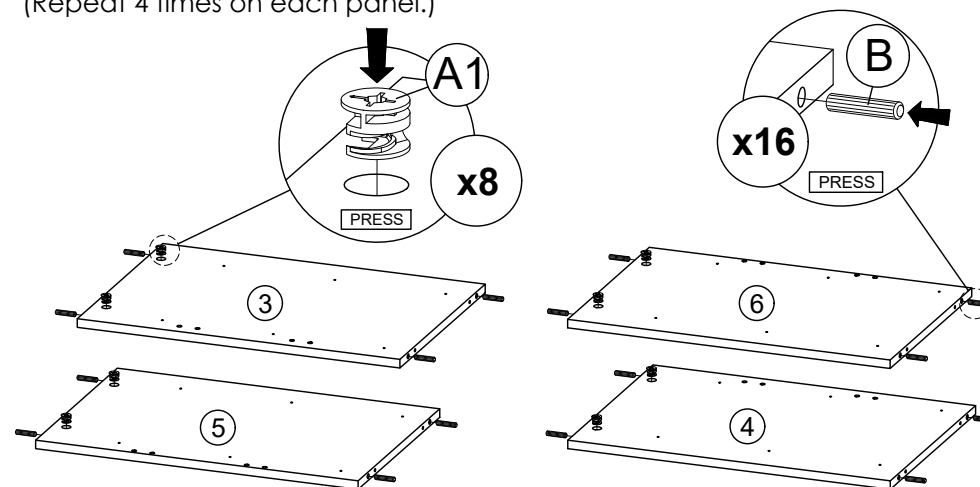

* Ensure the arrows on hardware **A1** point towards mounting positions.

STEP 3

Fix hardware **I1 (L)** into panel **(3)** and **(6)** with hardware **G**.
(Repeat 3 times for each hardware.)

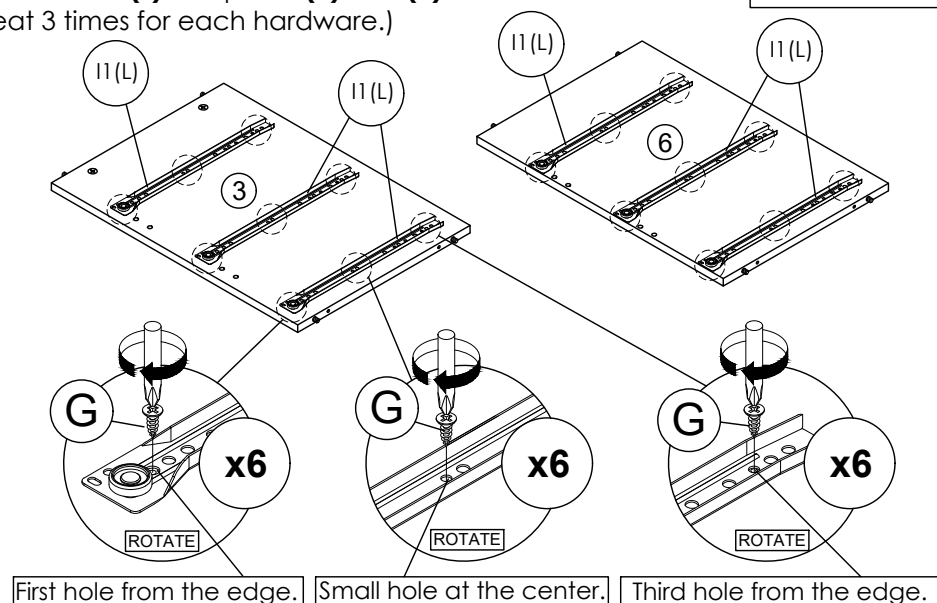

STEP 4

Fix hardware **I1 (R)** into panel **(4)** and **(5)** with hardware **G**.
(Repeat 3 times for each hardware.)

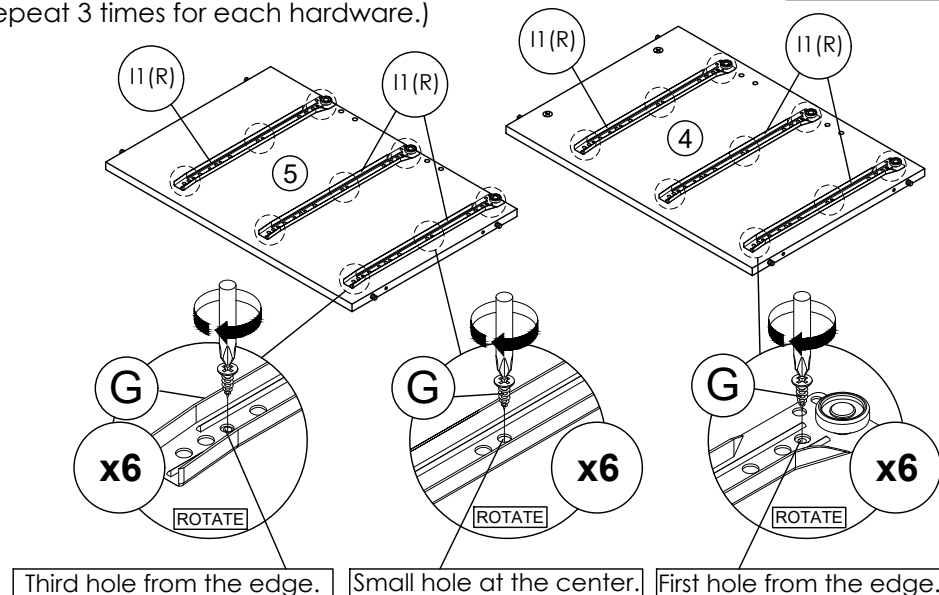
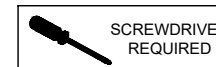

ASSEMBLY INSTRUCTIONS

PAGE: 3/6

STEP 5

Fix hardware **I1 (L/R)** into panel **(5)** and **(6)** with hardware **G**.
(Repeat 3 times for each hardware.)

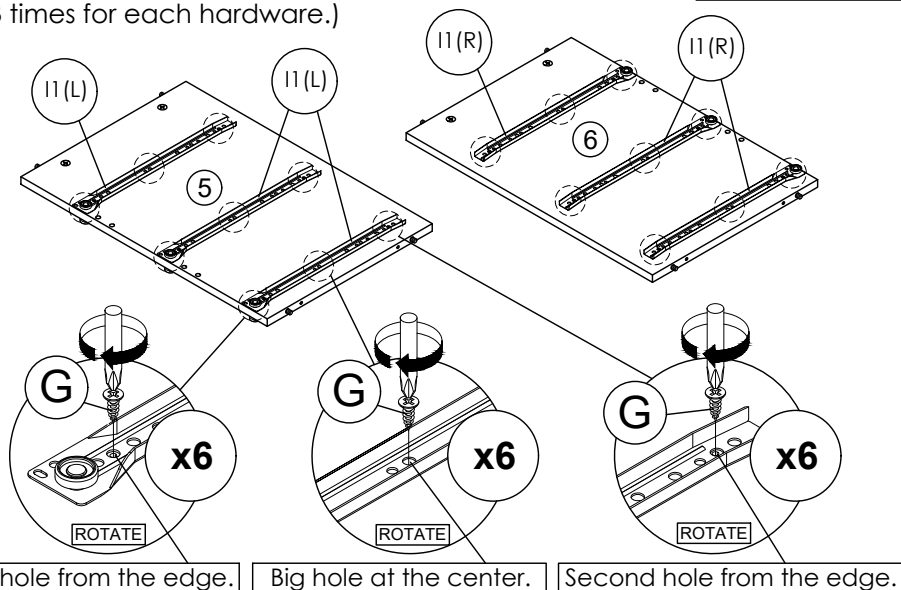

MODEL : UH 7149

STEP 6

- Assemble hardware **F** to panel **(7)** with hardware **G**.
(Repeat 2 times on each panel.)
- Insert hardware **B** onto panel **(7)**.
(Repeat 4 times on each panel.)

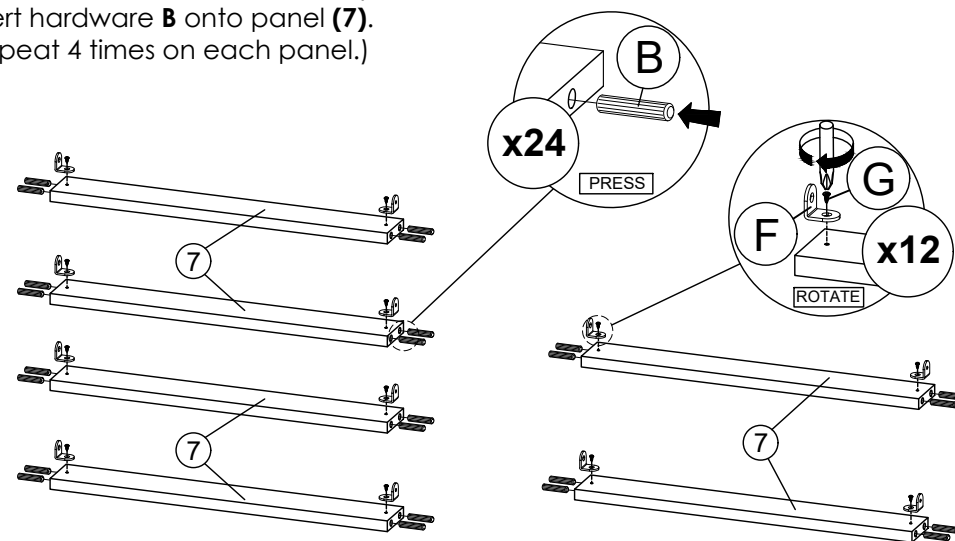

STEP 7

Attach panel **(7)** to panel **(3), (4), (5)** and **(6)**.
(Repeat 6 times.)

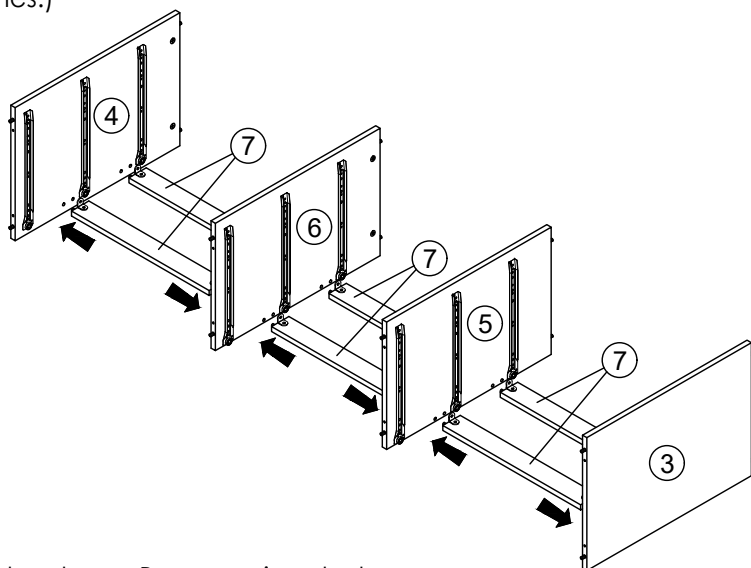

* In this step hardware **B** are pre-inserted.

STEP 8

- Attach panel **(3), (4), (5)** and **(6)** to panel **(1)**.
- Insert all hardware **A2** into **A1**.
- Rotate all **A1** until tight.
- Apply **A3** onto all **A1**.
(Repeat 8 times.)

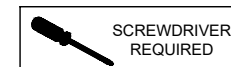

OR

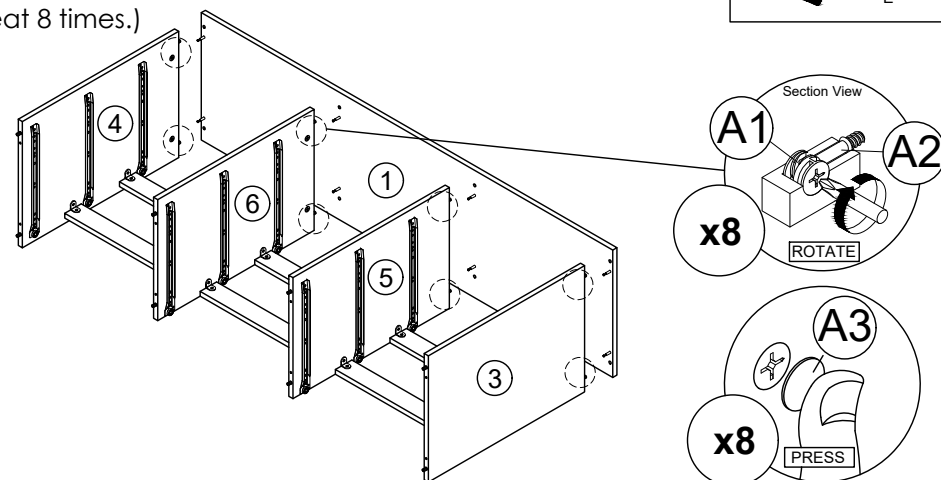

* In this step hardware **A1, A2** and **B** are pre-inserted.

ASSEMBLY INSTRUCTIONS

PAGE: 4/6

MODEL : UH 7149

STEP 9

Connect panel (2) to panel (3), (4), (5) and (6) by using hardware C and E.
(Repeat 8 times.)

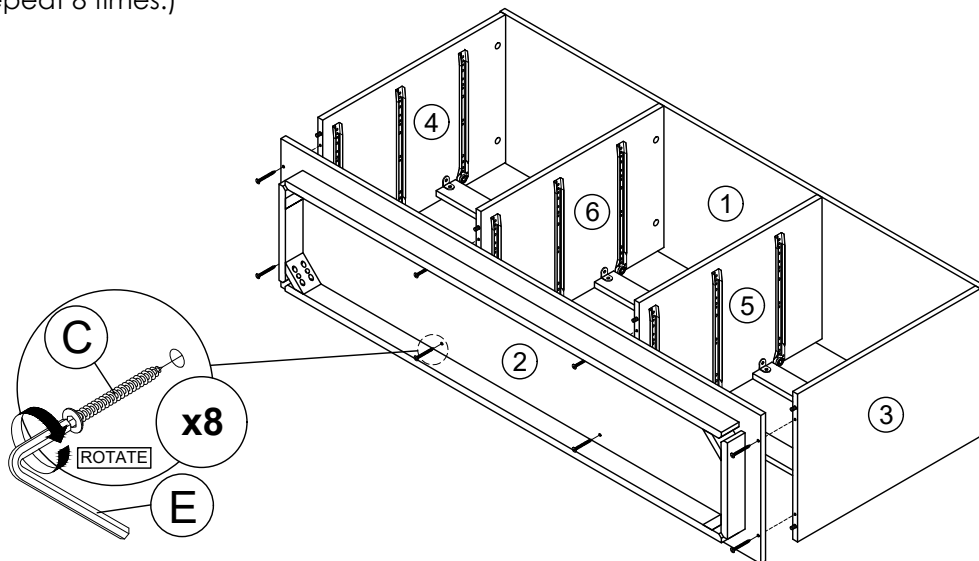

* In this step hardware B are pre-inserted.

STEP 11

Assemble part 15 into panel (2) by using hardware E, J, K and L.
(Repeat 2 times for each Leg.)

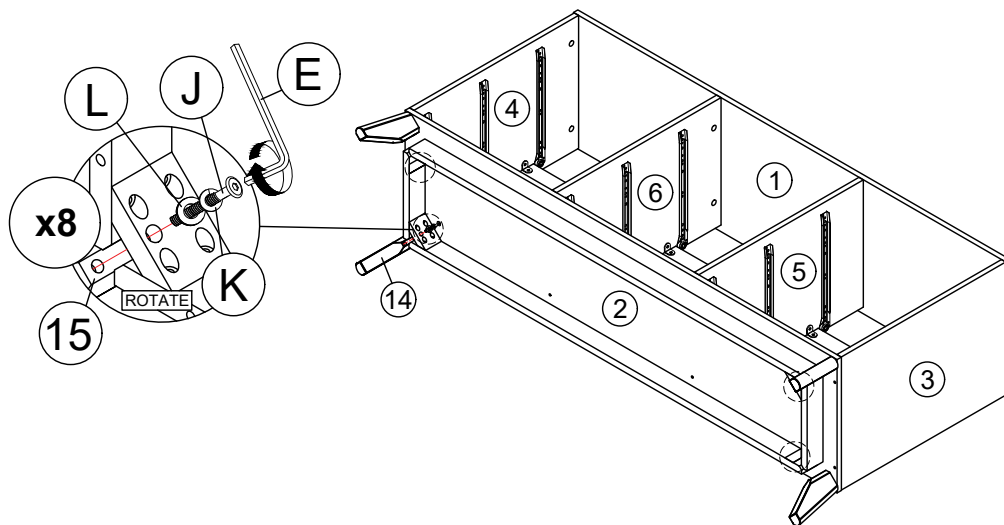

STEP 10

Assemble hardware F on panel (7) to panel (3), (4), (5) and (6)
by using hardware G.
(Repeat 1 times on each side panel.)

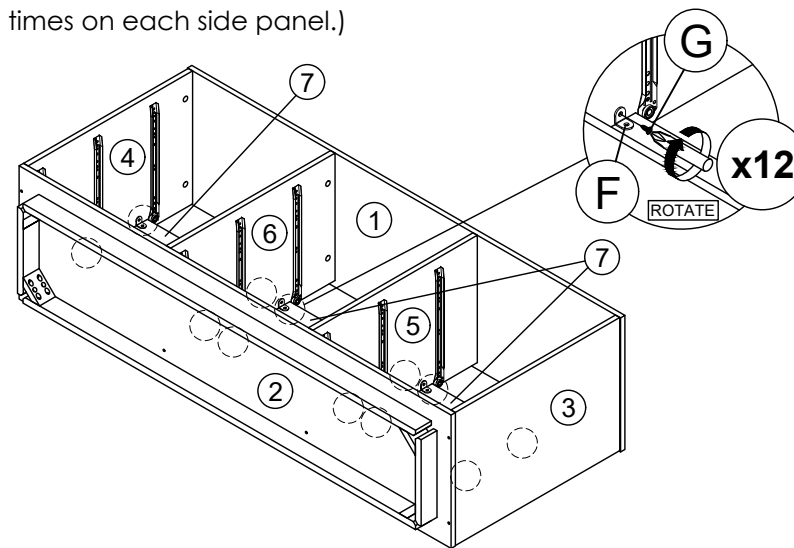

STEP 12

Assemble panel (8) to entire body with hardware D.
(Repeat 26 times.)

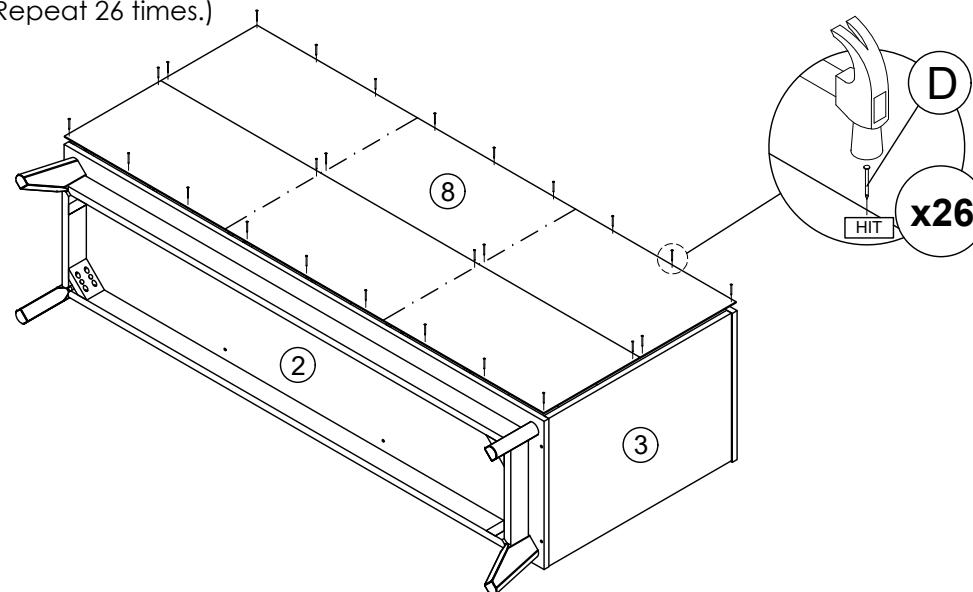

ASSEMBLY INSTRUCTIONS

PAGE: 5/6

STEP 13

Assemble panel **(12)** with panel **(9)** or **(10)** or **(11)** and **(13)** by using hardware **H**.

(Repeat 8 times for each drawer.)

* In this step only show one of the drawers.

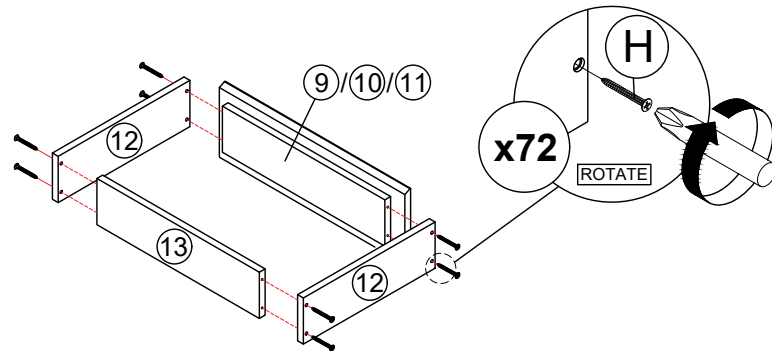

MODEL : UH 7149

STEP 14

Assemble panel **(14)** to entire body with hardware **D**.

(Repeat 8 times for each drawer.)

* In this step only show one of the drawers.

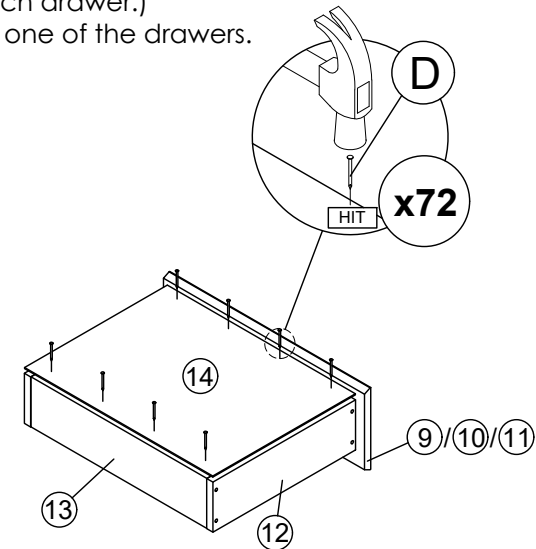

STEP 15

Assemble hardware **I2 (L/R)** to panel **(14)** by using hardware **G**.

(Repeat 3 times for each hardware.)

* In this step only show one of the drawers.

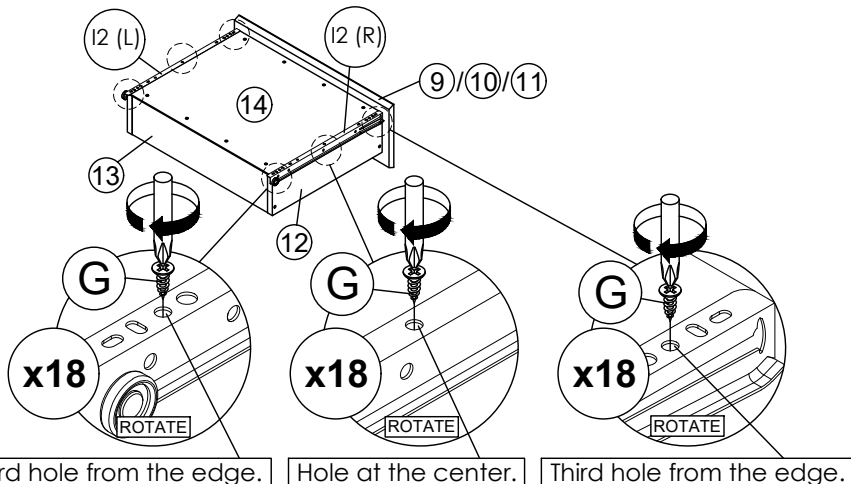

*Hardware **I2 (L/R)** shall be leaning against panel **(9)** or **(10)** or **(11)** when assembling.

STEP 16

Put all the drawer in place along the drawer slides.

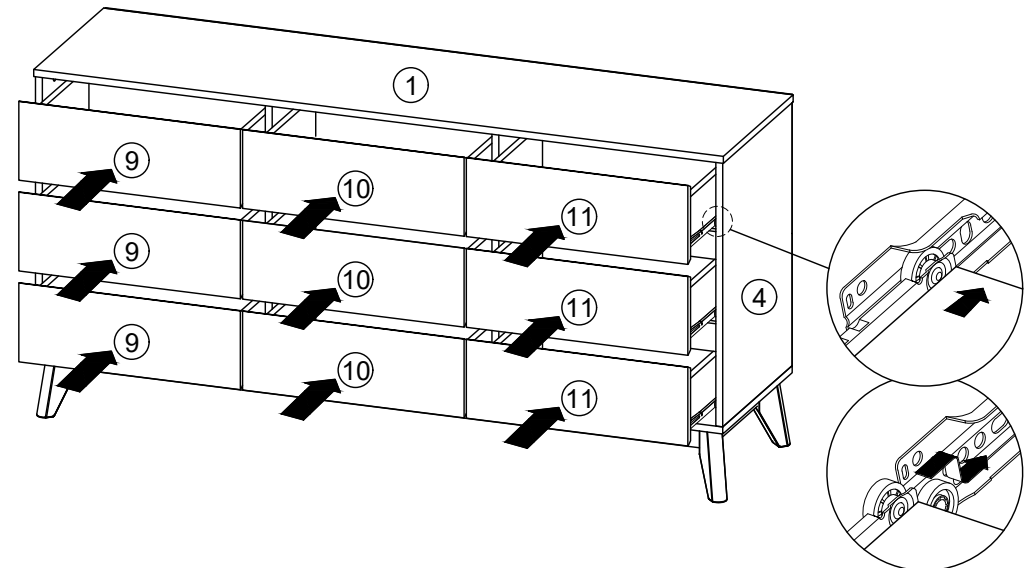

ASSEMBLY INSTRUCTIONS

PAGE: 6/6

MODEL : UH 7149

STEP 17

Assemble hardware **M1** into panel **(1)** and **(8)** by using hardware **M2**.
(Repeat 2 times.)

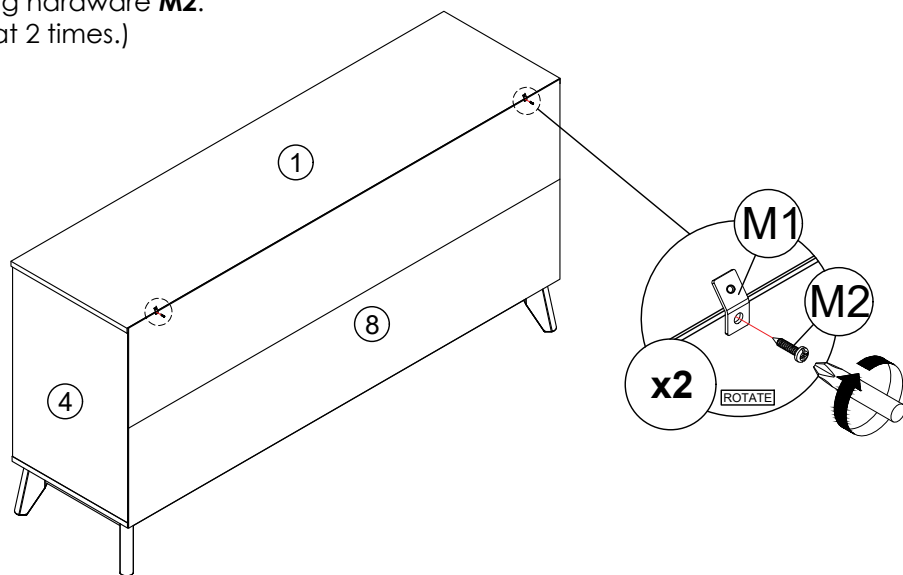

STEP 18

- Mark and use the power drill to drill a hole on the wall.
- Hit hardware **N** into the wall.
(Repeat 2 times.)

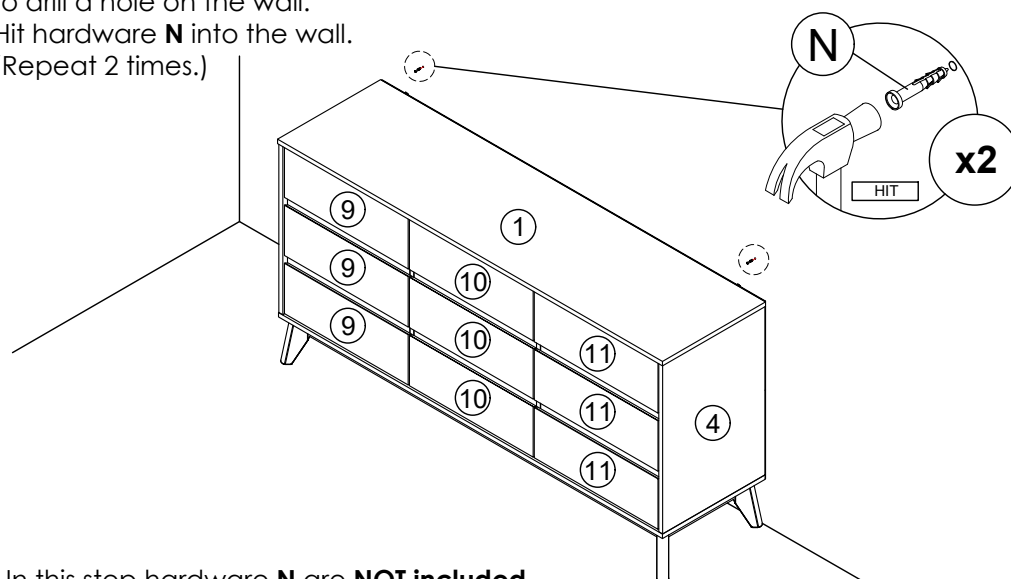

* In this step hardware **N** are **NOT** included.

STEP 19

Assemble hardware **M1** into **N** by using hardware **M3**.
(Repeat 2 times.)

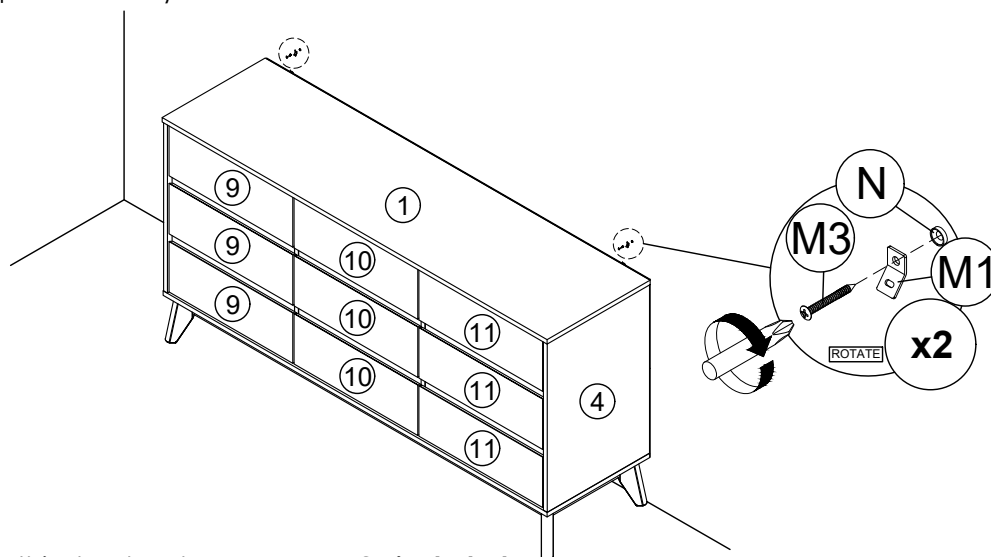

* In this step hardware **N** are **NOT** included.

STEP 20

- Connect both of the hardware **M1** by using hardware **M4**.
- Tighten the hardware **M4**.
(Repeat 2 times.)

