

Parts and Hardware

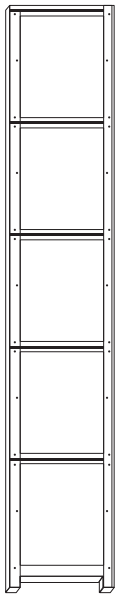

1 1pc
Frame (right side)

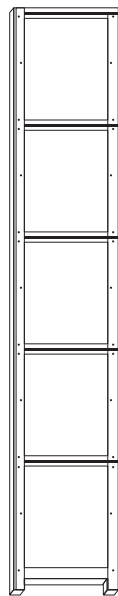

2 1pc
Frame (left side)

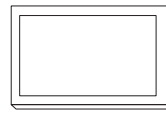

3 5pcs
Door panel



4 5pcs
Rear panel

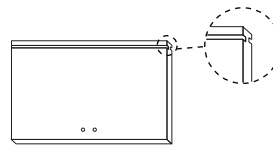

5 5pcs
Shelf panel

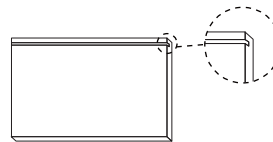

11 1pc
Top panel



6 5pcs
Magnetic door catch



7 5pcs
Door knob



8 20pcs
Metal rod connector



9 5pcs
Door gasket



10 4pcs
Foot pad



A 10pcs
Small screw



B 5pcs
Medium screw



C 24pcs
Large screw



D 1pc
Allen key

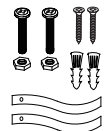

E 1 set
Wall lock kit

NOTE

1. Beware of burrs and sharp edges of the panels. Wear gloves if necessary.
2. A screwdriver (not included) is required for the assembly process.
3. It is recommended to carry out the assembly process with the product laying flat on the ground to prevent it from accidentally falling down and also for easier assembly.

Step 1

Part A
10pcs



x5

Assemble 5 sets

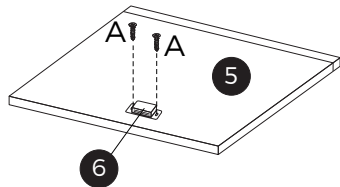

Magnetic door catch installation on shelf panel.

Step 2

Part C
10pcs

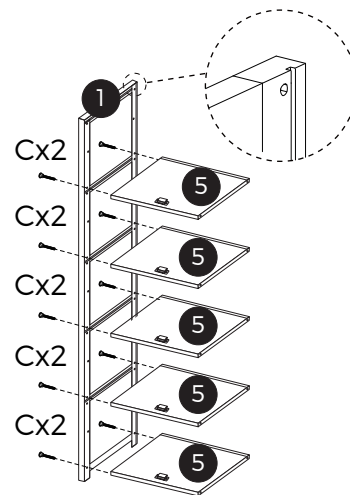
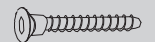

Ensure the frame grooves are facing to the rear when attaching the shelf panels.

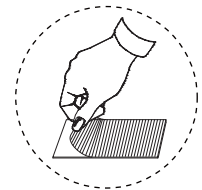

Remove all protection films from the panels before assembly.

Frame (right side) assembly

Step 3

Part C
2pcs

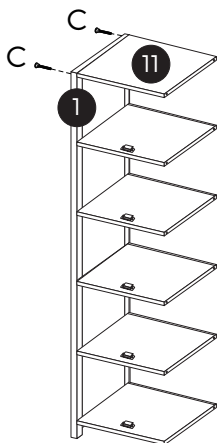
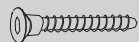

Top panel assembly

Step 4

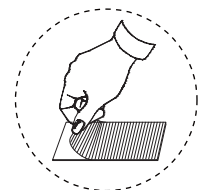
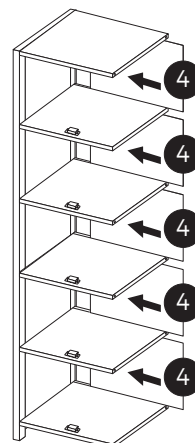

Remove all protection films from the panels before assembly.

Rear panels assembly

Step 5

Part C
12pcs

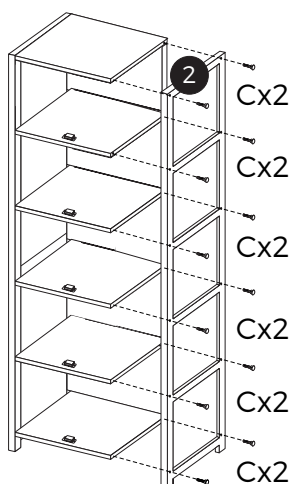
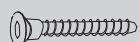

Remove all protection films from the panels before assembly.

Frame (left side) assembly

Step 6

Part B
5pcs



x5

Assemble 5 sets

Door panel hardware installation

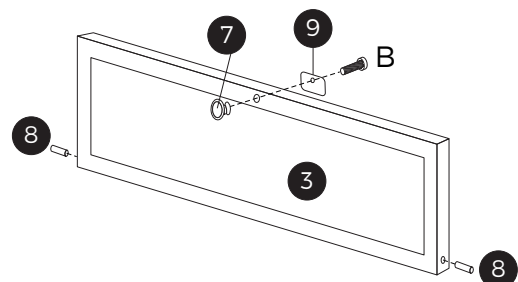

Secure the door knob on each door panel with the gasket and medium screw. Repeat for other panels. Then insert the metal rod connectors into each end of the door panel.

Step 7

ATTENTION •

If there is a problem in installing the door panels, loosen the screws A (from Step 2) to enable the door panels to be fitted properly. Then tighten all screws.

Door panels assembly

Insert the metal rod connectors into the frame and the door panel metal rod connectors into the grooves of the frame.

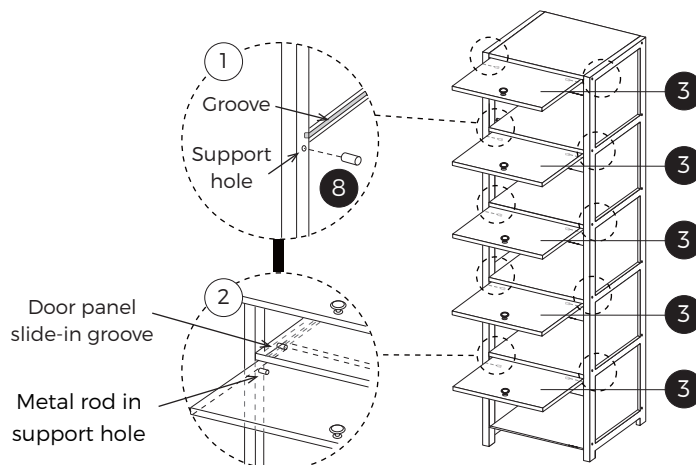

Step 8

Moisture-proof foot protectors installation

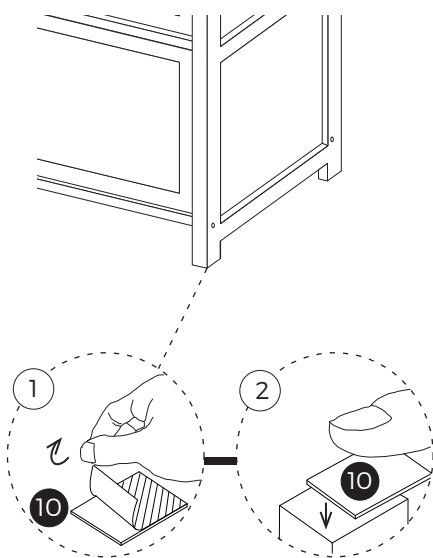

Step 9

Part E Wall lock kit



! WARNING •

It is very important to secure this furniture with an anchoring device for your safety in use.

Pre-drill holes in the wall

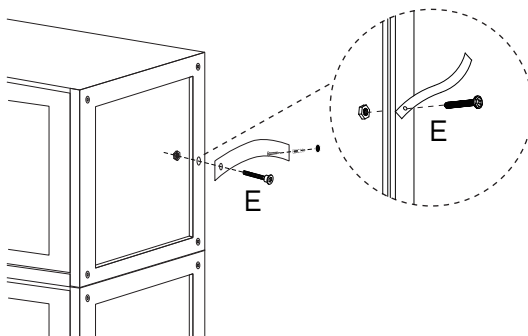

Wall-locked installation

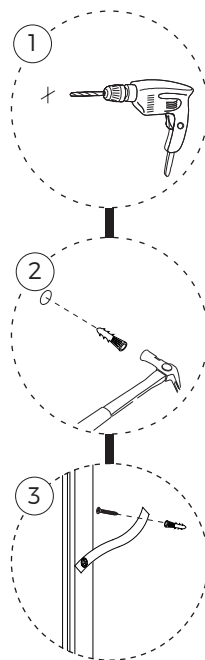

ATTENTION •

• Notice:

Recommended weight capacity:

Shelf: **12kg per shelf**

Assembly must be done by adults. Check the product regularly for any damage. Keep away from any hazardous contents.

• **Caution:** Do not place the bamboo product in extremely dry or humid environments. Bamboo is prone to cracking in moisture content under 6% or above 16%.

CARE AND MAINTENANCE OF BAMBOO FURNITURE

GENERAL

- Periodically check all screws, bolts and joints connections and tighten them if necessary.
- Periodically check for any damage and deteriorated parts and components and seek repairs or replacements if needed.
- Do not allow any liquids to remain on the furniture as this may cause stains and allow the liquid to be absorbed into the finishes and materials.
- In some cases, this may also cause warping and/or cracking of the materials and finishes. Use coasters and placemats for all food and beverages.
- Do not place hot items, such as dishes, pots and cups, directly on the furniture. Use coasters and placemats for all food and beverages.
- Keep sharp and pointed objects away from furniture to avoid damaging the surface and finish.
- Do not place the furniture near hot objects, heating vents or heating equipment.
- Do not place the furniture in moist areas such as bathrooms to prevent water damage.

CLEANING AND CARE

- Dust the furniture regularly using a soft cloth or microfibre duster to prevent dust build-up. Consider using a vacuum cleaner to thoroughly clean it.
- Only wipe and clean with a soft, damp cloth with a mild cleaning detergent. Use a toothbrush to clean hard-to-reach spots.
- Allow the washed furniture to dry in the shade rather than in the sun which can dry out bamboo too quickly.
- Do not use a jet wash as this can damage the material.
- Do not use chemicals with bamboo furniture as it may cause unnecessary staining.
- If there are stains or liquid spills, clean it immediately to reduce the likelihood of the stain settling in and becoming permanent.

ENVIRONMENTAL

- Do not expose the furniture to direct sunlight. Use curtains and blinds to shield the furniture if direct sunlight is unavoidable.
- In dry or hot indoor conditions, wipe the furniture with a cool, damp sponge often to prevent cracking.
- Bamboo furniture is prone to damage and fade with prolonged exposure to extremely high or low humidity conditions. Do not place them in such extreme conditions.
- Bamboo is porous and susceptible to moulding where placed around moist areas. As an optional protection for bamboo furniture, apply a bamboo sealant/varnish on it for durable protection against scratches, water, UV rays and other weather elements.

HANDLING

- Do not drag, push or pull furniture when moving them. Lift them up to avoid damage to the furniture legs and scratches on floors.
- Do not sit on wet bamboo furniture as this will cause it to stretch or sag.
- Avoid sitting or standing on armrests or use the furniture as a stepping stool for safety reasons.
- Do not exceed the recommended weight capacities of the furniture specified.
- Do not use the furniture for any purpose other than what is intended for.

! WARNING



Children have died from furniture tipover.

- ALWAYS secure this furniture with an anchor device.
- NEVER allow children to stand, climb or hang on drawers, doors, or shelves.