

Kiture

Assembly Instruction

DCH-MACO-%-2PC

Ax1



Ex8

SPRING WASHER



M8x12x2mm

Bx2



FRONT LEG

Fx4



M8x70mm

Cx2



REAR LEG

Hx1



M8

Dx8

FLAT WASHER



M8x22x2mm

K x 4



M8x 55 mm

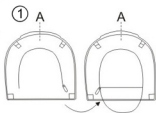

UNZIP

The chair legs are under the seat

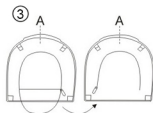
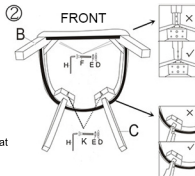

FASTEN ZIPPER

- 1.First have four legs with bolts and washers 80% tightened ;
- 2.Secondly place the chair upright and sit on to level leg positions ;
- 3.Proceed to tighten all bolts securely if the chair is leveled;

WARNING:

DO NOT STAND ON THE PRODUCT, DO NOT USE THIS PRODUCT AS A STEP LADDER.
DO NOT USE THIS PRODUCT UNLESS ALL BOLTS, SCREWS AND KNOBS ARE FIRMLY SECURED.
PLEASE DO NOT USE KNIFE TO OPEN ANY PARTS OF THE BOX OR PRODUCT.

Please Note:

- 1.We suggest you spend a short time reading through this instruction and then follow the simple step by step instructions.
- 2.Don't discard any of the packaging until you have checked that you have all the parts and the pack of things.
- 3.Assemble this item on a carpet
- 4.We strongly advise that all the fittings are only finger tightened during install assembly only upon completion of the assembly should all fittings points be fully tightened
- 5.We strongly recommend a period check on all fixing points to make sure they remain fully tightenedAmy@:
- 6.Keep away from direct sunlight

