

# STANDING DESK

MODEL: SD-LEG-M2-BK/H

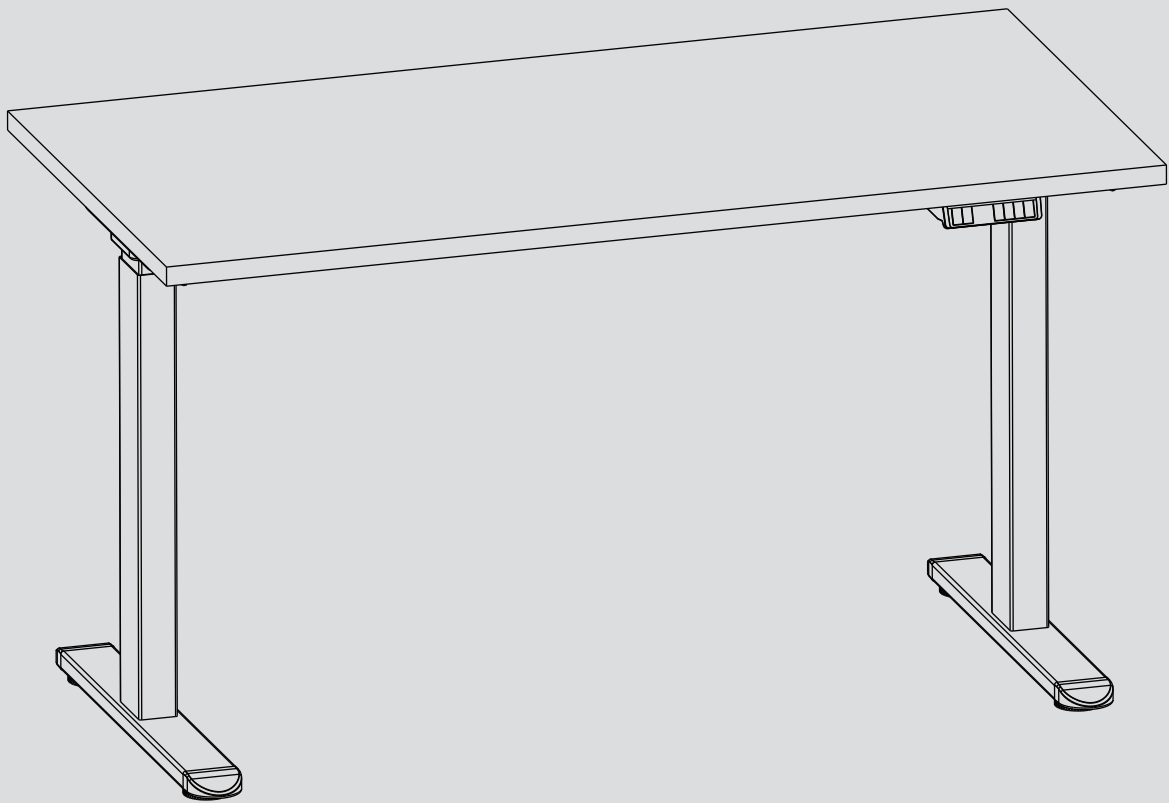

Instruction video



# USER MANUAL

Please read this manual carefully before assembling and using the product. Please retain this manual for future reference.

# SAFETY INFORMATION

Basic precautions should always be followed when using this product. Read all instructions before the desk.

**Failure to comply with or observe all instructions and warnings regarding the use of this product may result in serious property damage or body injury.**

**DANGER:** To reduce the risk of electric shock, always unplug the electrical outlet before cleaning, or before putting on or removing parts.

---



## WARNINGS

- Ensure that the handset is fixed horizontally under the desk top when operation.
- Ensure that there are no obstruction in the path of the desk.
- Ensure that the tabletop is not touching any walls.
- Ensure that all power cords are of appropriate lengths to accommodate the change in height.
- Keep children away from electrical height-adjustable desk, control units and handsets. There is a risk of injury and electric shock.
- Keep all electrical components away from liquids.
- Do not sit or stand on the desk frame.
- Do not crawl or lie under the desk frame.
- Do not place any object taller than 51cm underneath the desk.
- Do not open any of the components, such as the legs, control box or switch. There is a danger of electric shock.
- In the event of a power outage or if the power cord is unplugged, a manual reset may be necessary. Please see section on OPERATING INSTRUCTIONS.

# PARTS AND HARDWARE

## PARTS

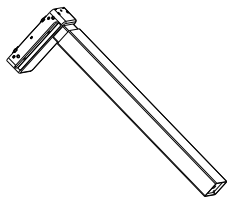

① Leg x2

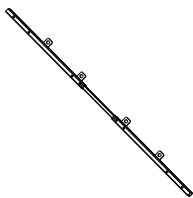

② Beam x2

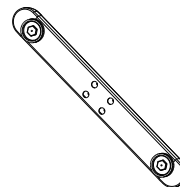

③ Foot x2

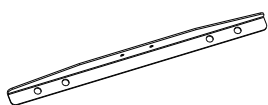

④ Bracket x2

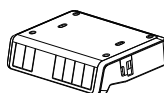

⑤ Drive Draft x1

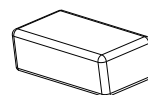

⑥ Motor x1

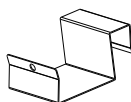

⑦ Gear box spacer x1

## HARDWARE

A



Rubber cushion  
x12

B



Plastic pad  
x12

C



5mm Allen key  
x1

D



4mm Allen key  
x12

E



ST3.5\*19 Screw  
x2+1

F



ST4.8\*25 screw  
x12+1

G



ST4.8\*19 Screw  
x2+1

H



M6\*40 screw  
x8+1

I



M8\*50 screw  
x4

J



M6\*12 screw  
x4

# ASSEMBLY STEPS

(Attention: Some steps need 2 persons to operate.)

## STEP 1

Loose 4 screws on the beam(2)

D



4mm Allen key

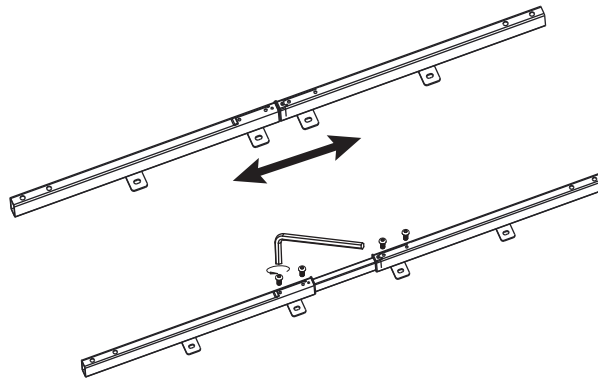

Attach the legs (1) to the beam (2) with four M8x50mm screws (I) and fasten them with the 5mm Allen key (9).

I

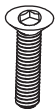

M8\*50 screw

C



5mm Allen key

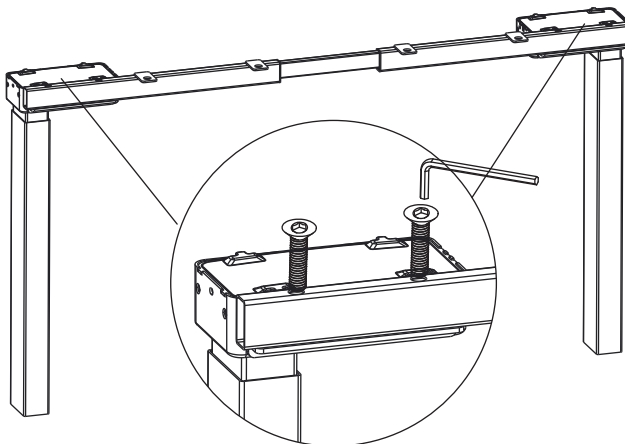

## STEP 2

Attach the feet (3) to the legs (1) with eight M6x40mm screws (H) and fasten them with the 5mm Allen key (C).

H

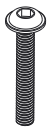

M6\*40 screw x8

C



5mm Allen key

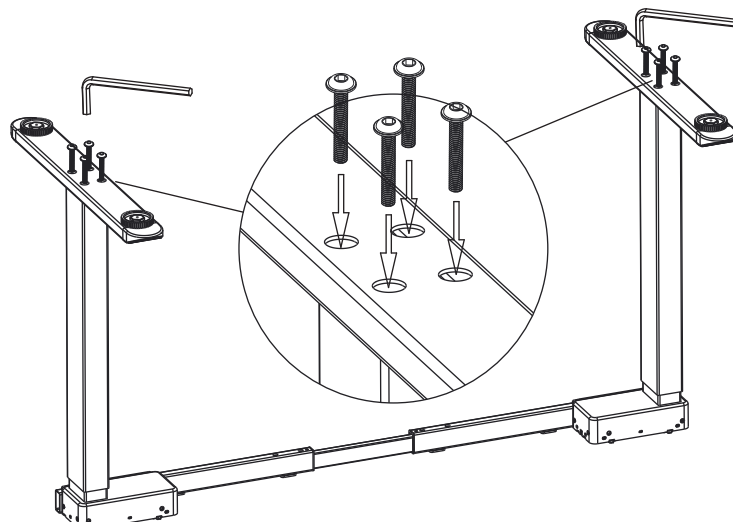

# ASSEMBLY STEPS

(Attention: Some steps need 2 persons to operate.)

## STEP 3

Attach the brackets (4) to the beam (2) with four M6x12mm screws (J) with the 4mm Allen key (D)

E



M6\*12 screw

B



4mm Allen key

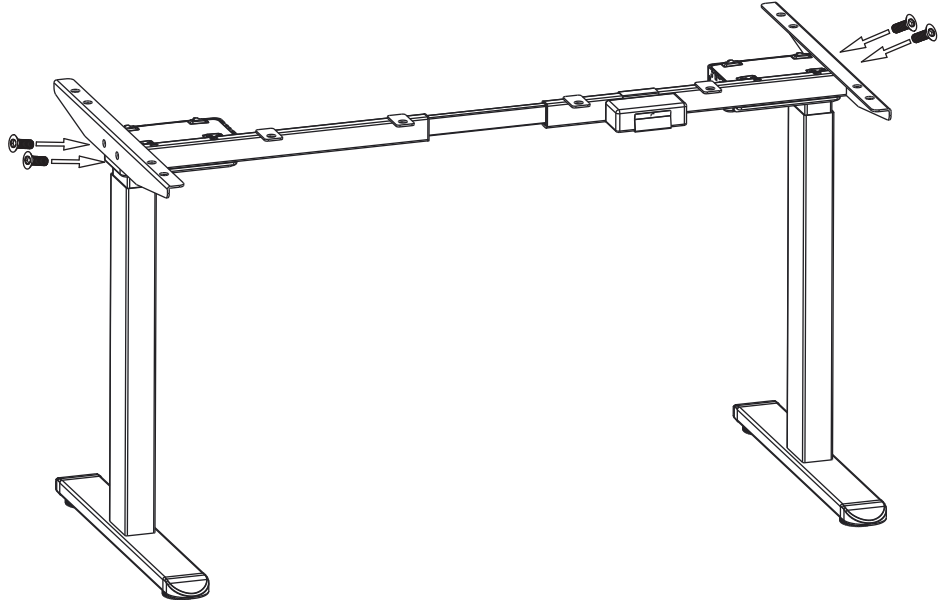

## STEP 4

Next, attach the rubber cushions (A) and plastic pads (B) to the brackets (4) and beam (2).

A



Rubber cushion

A



Plastic pad

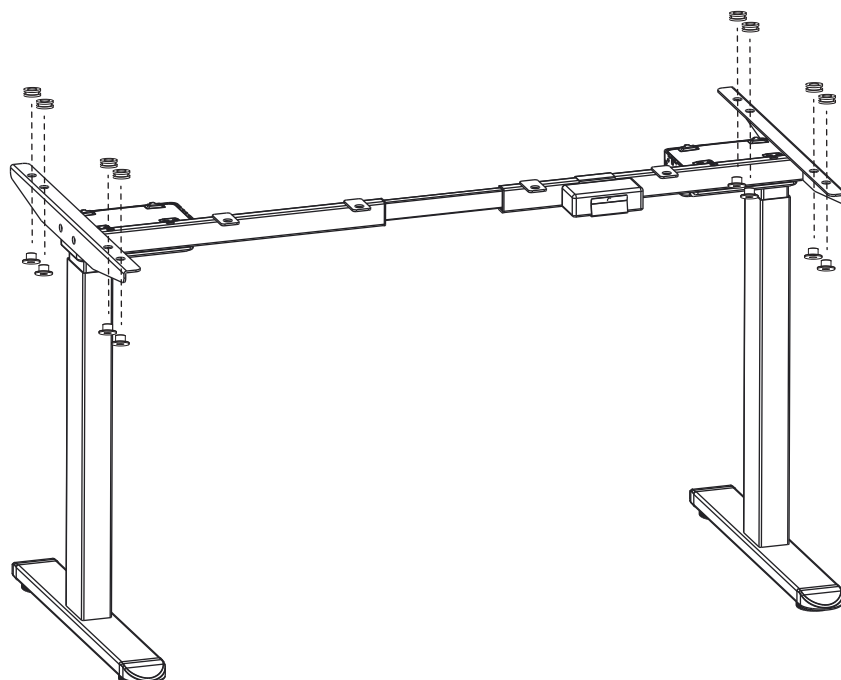

# ASSEMBLY STEPS

(Attention: Some steps need 2 persons to operate.)

## STEP 5

Place the adaptor holder (7) on the beam and put the adaptor (6) in it.

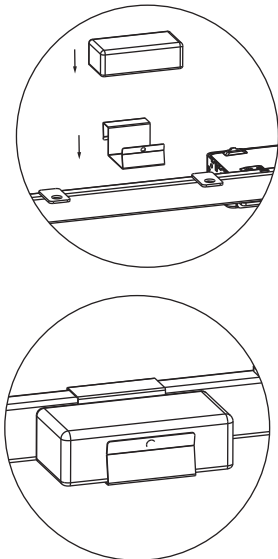
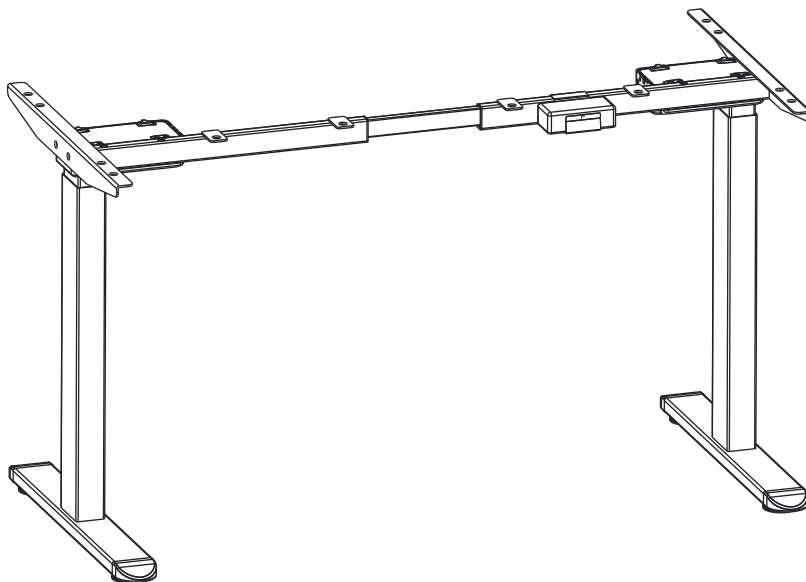

## STEP 5

A. Turn the desk frame over and place it on the tabletop.

Attention: This step needs two persons to operate.

Please notice that do not let the adaptor holder(7) and adaptor (6) fall off.

B. Adjust the length to suit tabletop. (Align the holes of the brackets (4) with the holes of the tabletop.)

C. Attach the tabletop to desk frame using ST4.8\*25 screws (F).

Attention: There are pre-drilled holes on the desktop in bracket side but no holes in beam side.

Whether connect the beam (2) with desktop depends on personal choice.

D. Tight the screws which are loosen in STEP 5-B, and connect the controller (5) with tabletop by ST3.5\*19 screws (E).

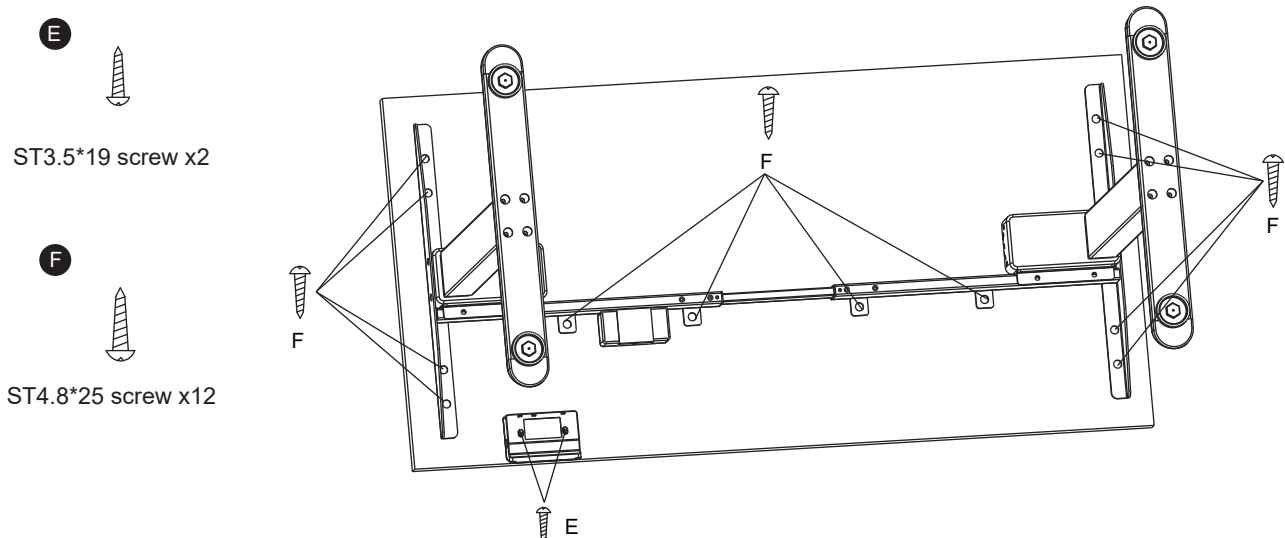

# ASSEMBLY STEPS

(Attention: Some steps need 2 persons to operate.)

## STEP 6

Connect the controller (5) to the adaptor (6). Then connect the controller (5) to the legs. Finally, connect the power plug to the adaptor (6).

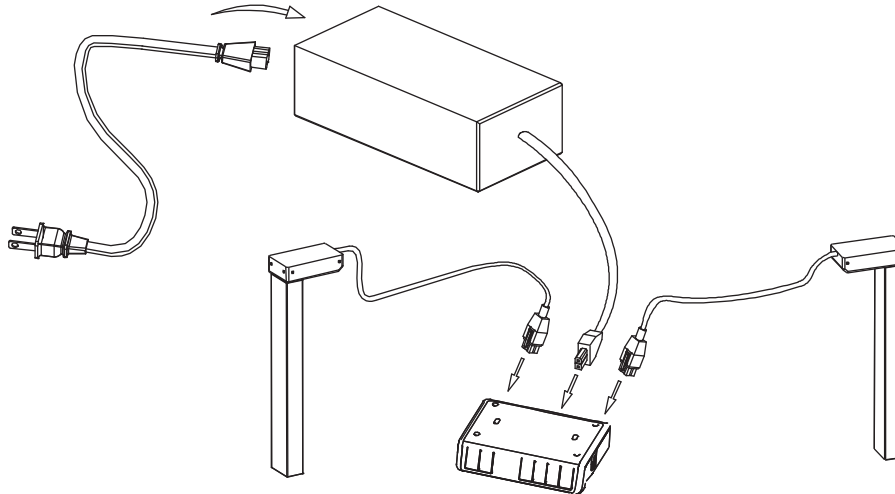

## STEP 7

The earphones holder is an optional attachment.  
Use two ST4.8\*19 screws(G).

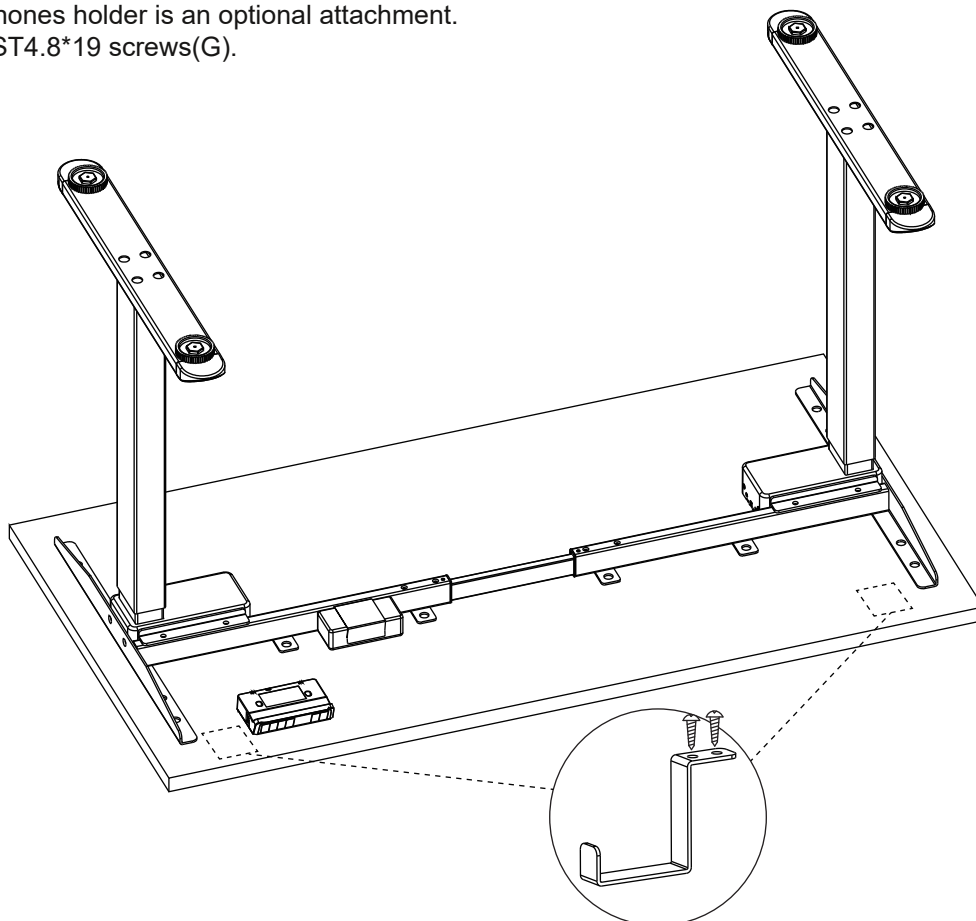

# OPERATING INSTRUCTIONS

## ACTIVATION AND RESET

After assembly, the control system of the standing desk needs to be activated before use.

NOTE: If the desk frame does not seem to be working properly, most of the issues can be rectified with the same activation process.



CAUTION: Do not operate the desk frame unless the handset /control box have been fixed horizontally under the desktop.

- 1.Unlock the handset if it is locked.
- 2.Press the ↓ button until the frame stops at its lowest height. Then release the button.
- 3.Press the ↓ button again for 5 seconds or more until a beep alert is heard.
- 4.Press the ↑ button once to engage the motor. The standing desk is now activated and ready for use.
- 5.If there are still other abnormal conditions after trying all the above operations, pls disconnect the power supply first and unplug all the cables for more than 10 minutes, then switch on the power and reset the operation again.

- ▶ <↑> UP
- ▶ <↓> DOWN
- ▶ <S> Settingbutton
- ▶ <1> Height memory button1
- ▶ <2> Height memory button2
- ▶ <3> Height memory button2

## USB AND TYPE-C CHARGER

The desk frame has one USB (Output 5V 3A / 9V 2A / 12V 1.5A) and one Type-C charger (Output 5V 3A / 9V 2A / 12V 1.5A).

Applicable models for TYPE C:       

**Attention:**For safety purpose (over current protection), the USB and TYPE C charger cannot work when the table is lifting.

## ANTI-COLLISION

For the single motor desk frame, the anti-collision sensitivity is preset at '0'.

Anti-collision closed: 0

Anti-collision sensitivity: least sensitive 1 to most sensitive 8

- 1.Long press S for 15 seconds or more until the display shows S-X and X flashes.
- 2.Press ↑ or ↓ to change the display to S-2.
- 3.Then short press S to enter into sensitivity interface.
- 4.Press ↑ or ↓ to change the anti-collision sensitivity
- 5.Short press S to finish setting.

## LOCK/UNLOCK

LOCK: Press S and ↑ at the same time and hold for 5 seconds until the display shows LOC. The system is locked and will not be able to move ↑ or ↓.

UNLOCK: Press S and ↓ at the same time and hold for 5 seconds until the display changes to a numeral. The system is now unlocked and will be able to move up or down.

## MEMORY

Adjust the desk to the desired height and then short press S until the display shows S-. Press the number button between 1 and 3 to preset the height to the corresponding button. The short press the number button and the desk will move according to the preset height.

## SET/CANCEL HIGH AND LOW LIMITS

To set the high and low limits, press ↑ and ↓ together at the target height and hold for 5 seconds until a beep alert is heard. This means the high or low limit is set successfully. High limits can only be set at the upper half of the height range and likewise with the low limits. To cancel the limits, press ↑ and ↓ together and hold for 5 seconds until a beep alert is heard. This means the limits are cancelled successfully. If the system is reset, all the limits will also be cancelled.

## TIMER

Press 1 and 3 together until the display shows X.XH. Then press ↑ or ↓ to adjust the timing in 0.5 hr segments. The setting will be withdrawn if there is no input for 2 seconds. During this time, a decimal point will flash, indicating that the timer is running. When the timer has reached its setting, the buzzer will beep 5 times and the handset will automatically be woken up.

## METRIC AND IMPERIAL DIGITAL DISPLAY CONVERSION

For the digit on the display, it is set based on metric digit. Following are the steps to exchange the digit between metric and imperial digit.

- 1.Long press S for 15 seconds or more until the display shows **S-X** and **X** flashes.
- 2.Press **↑** or **↓** to change the display to **S-I**.
- 3.Then short press S to enter into changing interface.
- 4.Press **↑** or **↓** to change, "0" is for metric display and "1" is for imperial display.
- 5.Short press S to finish setting.

## ERROR CODES

ERROR CODE		POSSIBLE CAUSE	ACTION
E01	E01	The main supply voltage over 45V.	Change the adapter.
E02	E02	Rod height difference between the two legs is more than 1 cm.	Initialise the frame. Reset the operation.
E04	E04	Handset connection or communication error occurred.	Change the handset.
E05	E05	The sensor encounters an obstacle and stops functioning.	1.Check whether control box is fixed horizontally beneath the tabletop. 2.Check to ensure screws are fully secures with control box and tabletop. 3.Move any obstruction away from under the desk.
E06	E06	The main power supply failed to start, below 20V.	Change the adapter.
E07	E07	Protection when the main power supply is running, below 20V.	Reconnect power and reset.
E08	E08	Frame tilts when running.	Initialize the frame. Reset the operation.
H0t	HOT	1.Temperature of motor is high. 2.Running time exceeds 2 min within 18 mins.	1.Wait for motor to cool. 2.Let system rest for at least 18 mins.
E11	E11	The Motor 1 is not connected.	Check power cable of motor.
E12	E12	Error in the Motor 1 current sampling channel.	Change the handset.
E13	E13	The Motor 1 is out of phase and has phase line disconnection.	Check power cable of motor.
E14	E14	The Motor 1 Hall sensor error, or Hall wire disconnected.	Check power cable of motor.
E15	E15	Short-Circuit inside the Motor 1.	Change the motor.
E16	E16	Locked-Rotor inside the Motor 1.	Initialize the frame. Reset the operation.
E17	E17	The Motor 1 runs in the wrong direction.	Switch the motor wire.
E18	E18	Weight on Motor 1 is over the limit.	Reduce the weight by removing items.
E21	E21	The Motor 2 is not connected.	Check power cable of motor.
E22	E22	Error in the Motor 2 current sampling channel.	Change the control box.
E23	E23	The Motor 2 is out of phase and has phase line disconnection.	Check the motor to determine whether the phase line connection is abnormal.
E24	E24	The Motor 2 Hall sensor error, or Hall wire disconnected.	Check the Hall signal, or change the power cable of motor.
E25	E25	Short-Circuit inside the Motor 2.	Change the motor.
E26	E26	Locked-Rotor inside the Motor 2.	Initialize the frame. Reset the operation.
E27	E27	The Motor 2 runs in the wrong direction.	Change the motor wire or Hall wire.
E28	E28	Weight on Motor 2 is over the limit.	Reduce the weight by removing items.
E40	E40	The handset is disconnected in series.	Check power cable of motor.
E41	E41	Error in the serial signal.	Change the handset.
E42	E42	EEPROM error.	Change the handset.
E43	E43	Error in Anti-Collision Sensor.	Change the handset.
RSt	RST		Reset the operation.