

Star Mini Wall Top Assemblies/ Concealed Mixer Tap
Installation Manual

Parts list

1. Screw
2. Decorated knob
3. Handle
4. Screw
5. Connector
6. Base
7. O-ring
8. Ceramic cartridge Hot (with red gasket)
9. Ceramic cartridge Cold (with blue gasket)

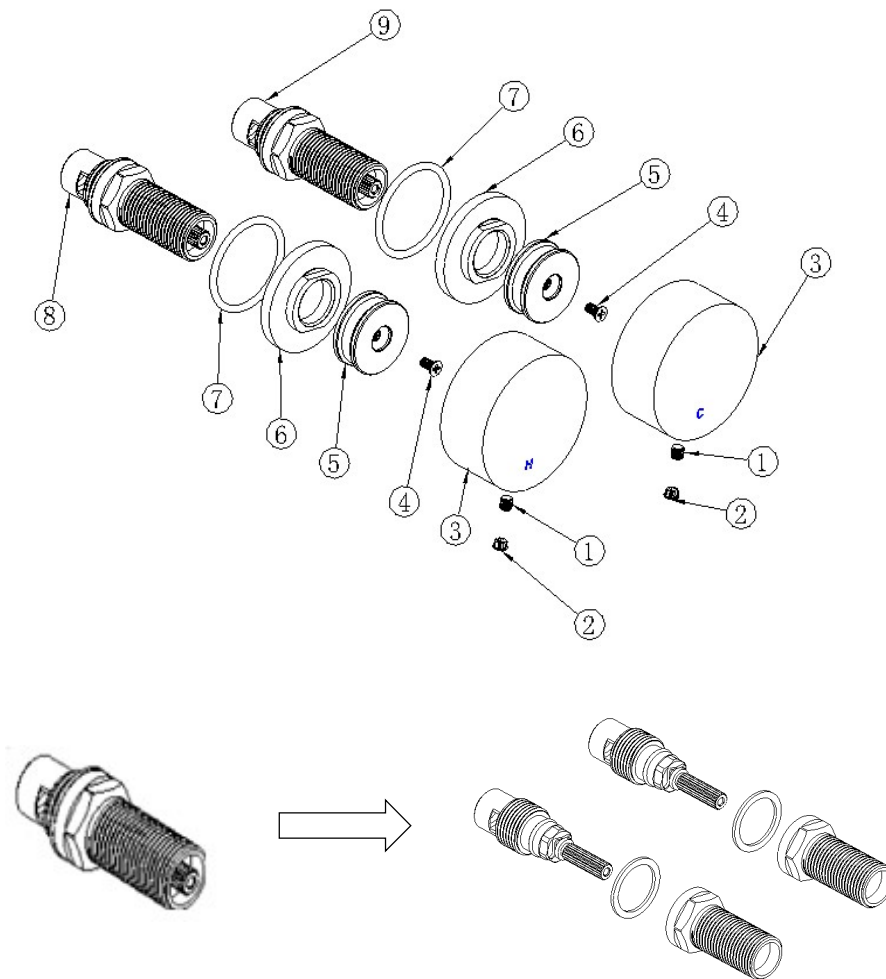

Star Mini Wall Top Assemblies/ Concealed Mixer Tap Installation Manual

End face of tap body connection thread

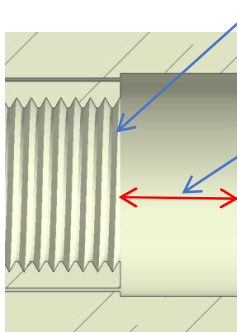

17-35mm

Make sure that the distance between the end surface of the body connection thread and the finished wall is between 17-35mm

Finished wall

Step 1

With red gasket.

With blue gasket.

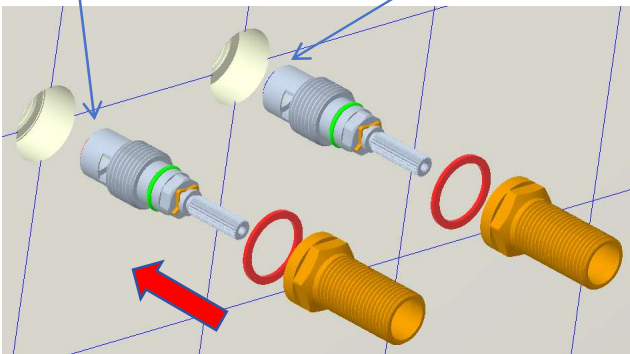

Tighten valve body (parts 8 and 9) first.

Place the gasket and tighten the threaded pipe joint.

Step 2

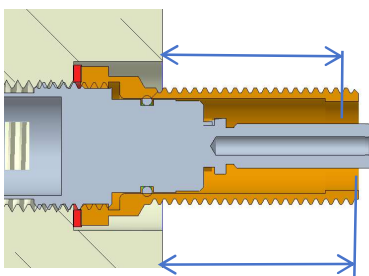
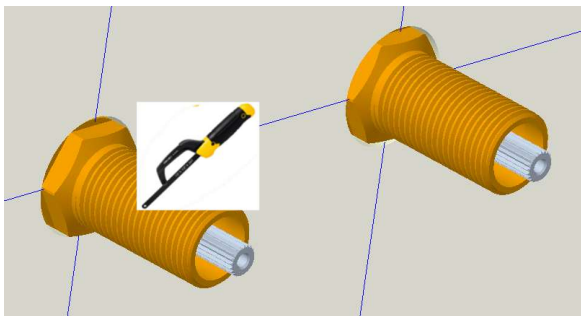

10-15mm

Ensure that the distance between the end face of the threaded pipe joint and the finished wall is between 10 to 15mm.

18 to 20mm.

The distance between the end face of the lever and the finished wall will need to be between 18 to 20mm.

Star Mini Wall Top Assemblies/ Concealed Mixer Tap
Installation Manual

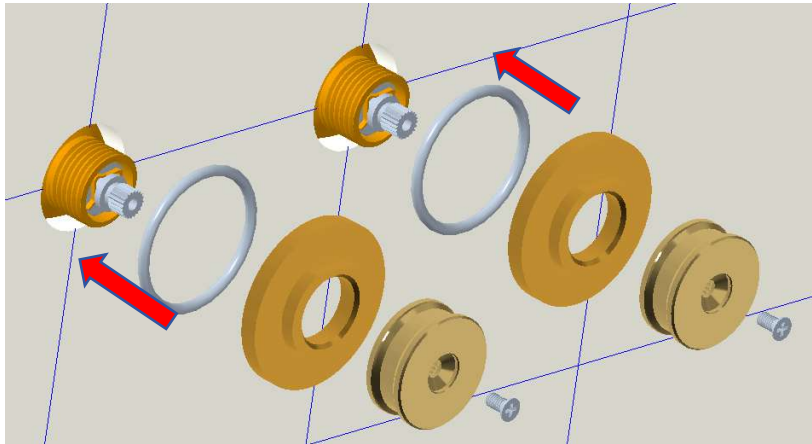

Step 3

Tighten the base (part 6)
And fasten the Connector (part 5)

Step 4

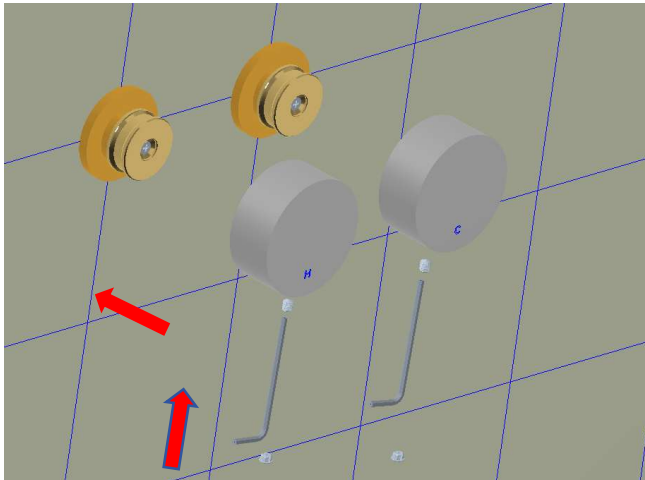

Fasten the handles (parts 3) with screws
and install Decorated knob (parts 2)

