



Modern National

Twin Shower/Shower Column/Wall Shower
Installation Manual

GENERAL INFORMATION

- Installation must only be completed by a licensed plumber or trades-person.
- When installing mixer, all pipes must be flushed clean before installation.
- The water pressure must be tested frequently. If the water pressure exceeds 1000Kpa, an approved pressure reducing valve should be fitted.
- Ensure when fitting isolating taps to the hot and cold inlet that connections are in accordance with the Australian national plumbing code AS3500.
- Make certain that hoses are not twisted or stretched, under tension or bent to a radius less than 25mm when being installed.
- If the water temperature exceeds 75°C, an approved water tempering valve must be fitted.
- Soft fabric must only be used to clean the taps. Do not use acid or alkaline material for cleaning.
- Cartridge and diverter are tested in factory. Please do not self-assemble and disassemble our products. Doing so voids the original manufacturing warranty.
- Underground components should pass a 30 minute water test under 0.8Mpa before closing the tiles to ensure there is no water leak.
- Underground pipes should be installed strictly according to the manual. The exchange of cold water and hot water pipes is not allowed.
- When inside temperature under 0°C, close the water angle valve and open the tap to let the water flow out completely to avoid tap break during freezing period and water leak when temperature goes up.
- CAUTION: When turning on the tap, please turn to cold first before adjusting to suitable temperature to avoid scald.
- Failure to comply with all the above instructions will void all warranties.
- Gloves are required during installing the tap.
- For domestic use only.

Warranty: 15 year warranty applies for significant manufacturing defects and 15 year warranty on ceramic cartridges. 12 month warranty on washers, o-rings and other perishable components. Some product warranties may be affected by misuse or local conditions or failure to have a registered plumber install the product.

All of the following conditions apply to the warranty and require that:

- 1.The item has been installed per the instructions provided.
- 2.The failure is due to a fault or defect in manufacture of the product.
- 3.Proof of purchase is provided(including purchase date).

The warranty does not include faults caused by:

- 1.Unsuitable or improper use.
- 2.Incorrect installation or installation not in accordance with the provided instructions.
- 3.Normal wear and tear.
- 4.Inadequate or lack of maintenance.
- 5.Chemical, electrochemical, or electrical influences, "hard" water or other environmental factors.
- 6.The impacts of harsh detergents or abrasive cleaners.

Pressure Rating: Mains Pressure - Equal

Maximum operating pressure: 600kpa

Minimum operating pressure: 150kpa

TWIN SHOWER

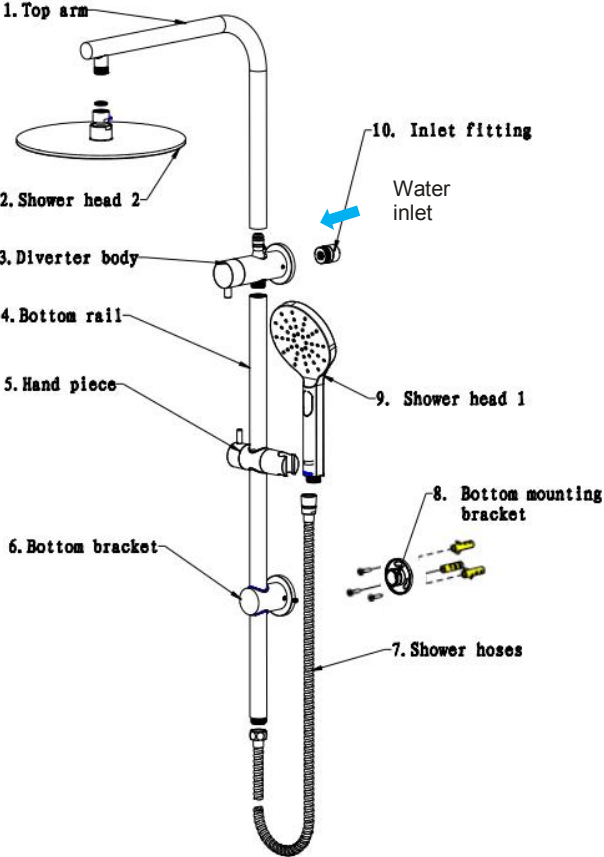

1. Determine the desired height from the finished floor to the G 1/2" outlet (this is done at the rough-in stage before finishing the wall).
2. Measure the location of the bottom mount from the top outlet location (the bottom bracket is adjustable as per **Fig. A**) drill out the mounting holes and install the bottom mounting bracket (part 8).
3. Screw the shower inlet fitting (part 10) to the exposed G 1/2" fitting (as per **Fig. B.**) now install the top arm (part 1) and bottom rail (part 4). into the diverter body (part 3). as per **Fig. B.**
4. Slide the bottom bracket (part 6) over the rail, now place the diverter body onto the inlet fitting (part 10) and adjust the bottom bracket to meet the bottom mounting bracket (part 5) once both the top and bottom mounts are correct, tighten the mounting bracket grub screws as per **Fig. C.**
5. Attach the shower head (part 2), shower hose (part 7) and hand piece (part 9) as per **Fig. D.**

Fig. A

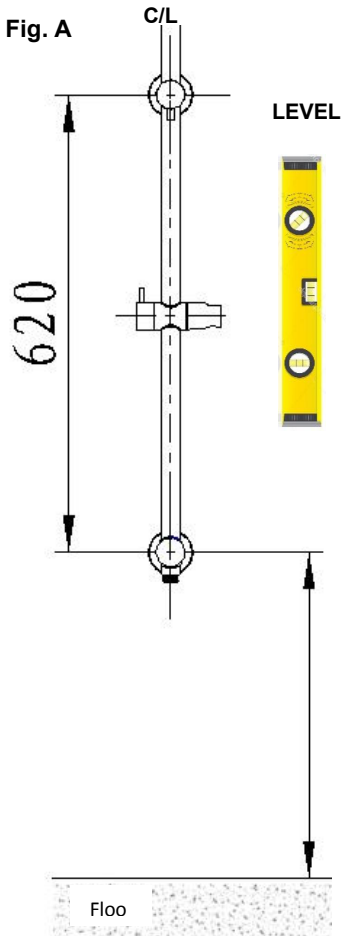

Fig. B

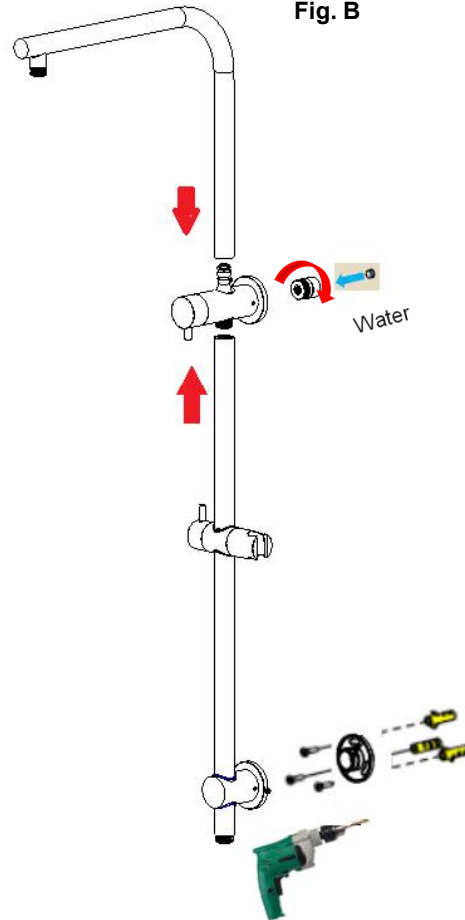

Fig. C

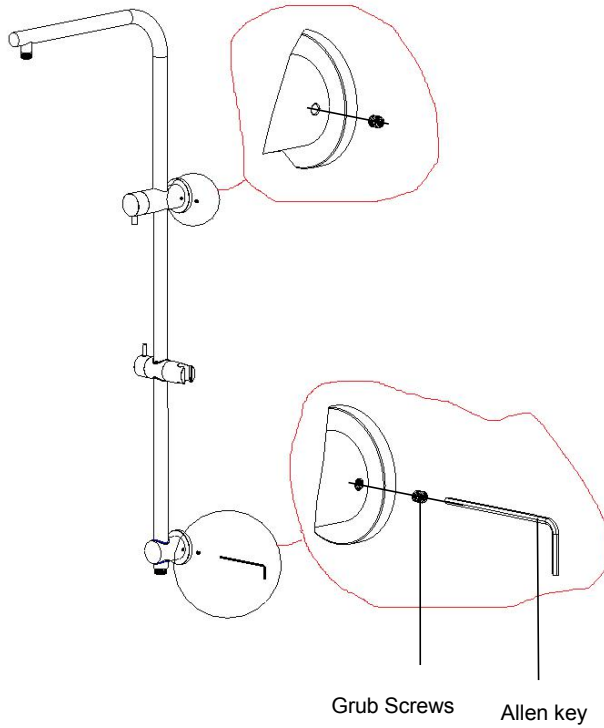
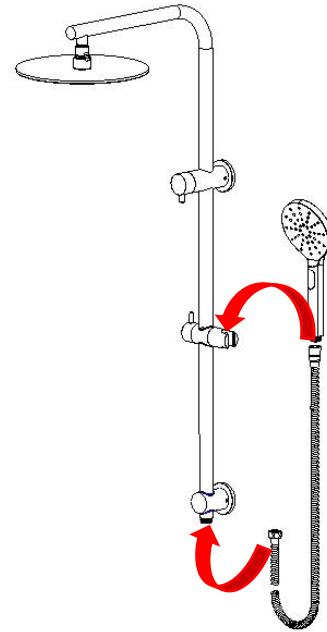

Fig. D



SHOWER COLUMN

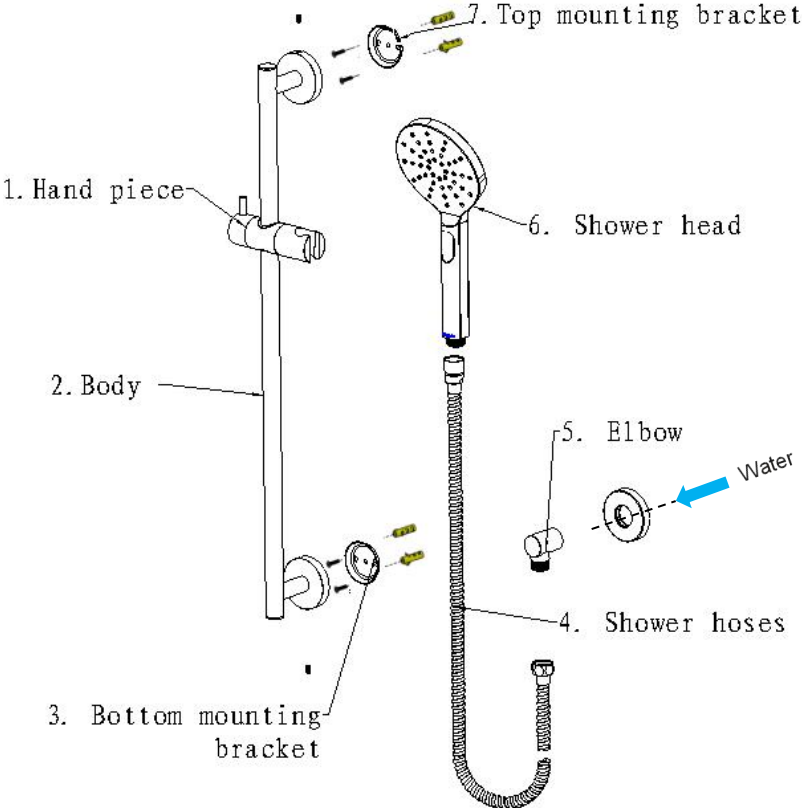

Fig. A

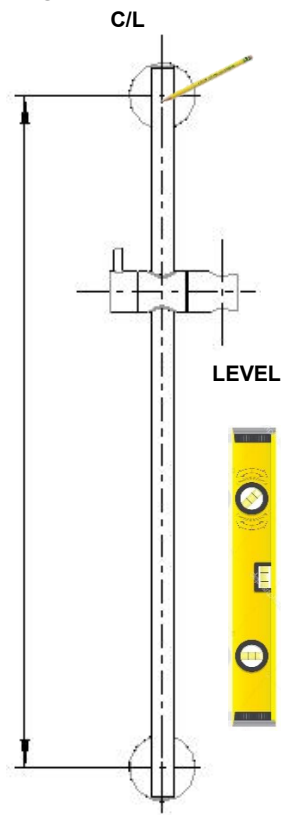

Fig. B

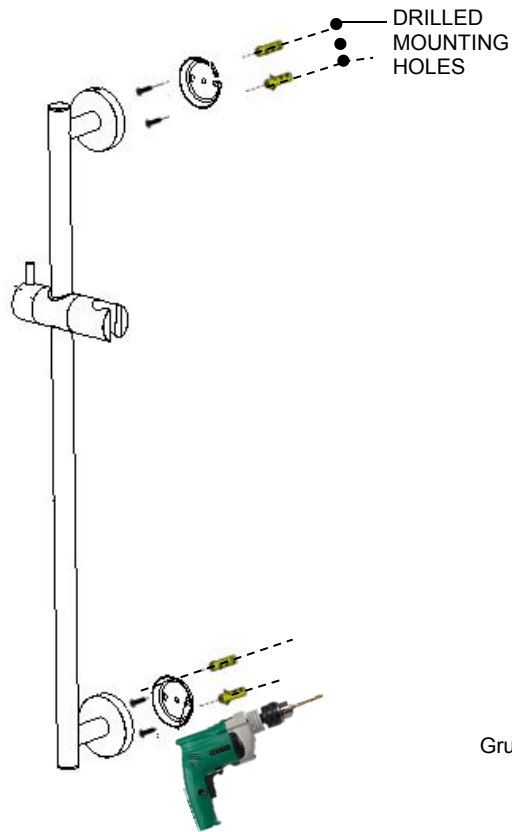
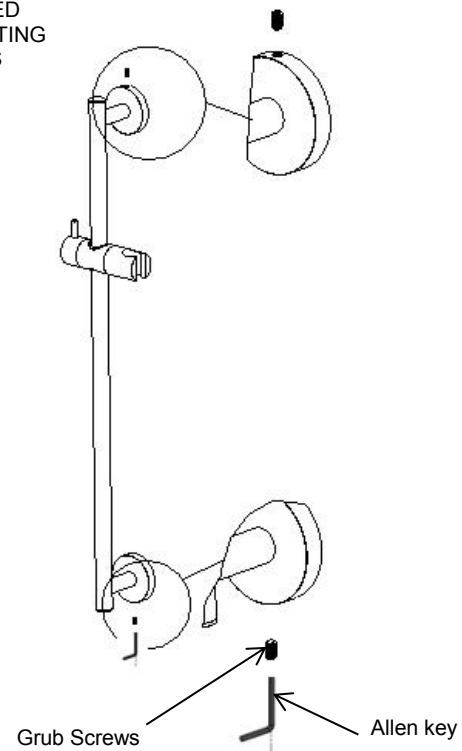
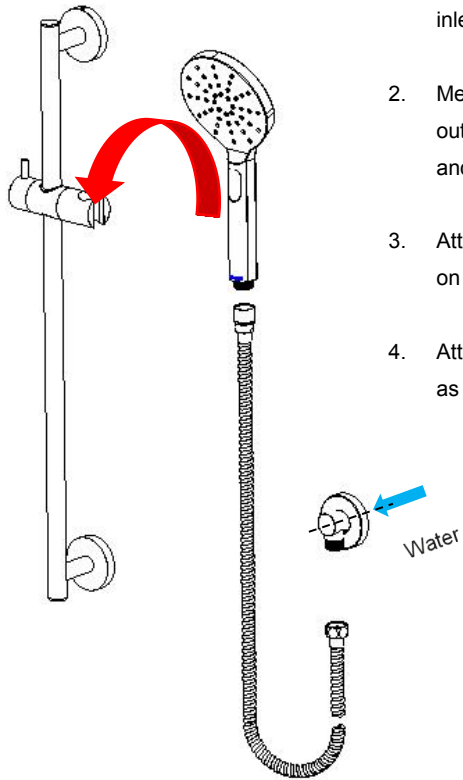

Fig. C





1. Determine the desired height from the finished floor to the G1/2B outlet for the inlet elbow (this is done at the rough-in stage before finishing the wall).
2. Measure the location of the bottom and top mount location as per Fig. A, drill out the mounting holes and install the bottom and top mounting bracket (part 3 and part 7) as per Fig. B.
3. Attach the bottom and top mounts to the mounting brackets that are installed on the wall and tighten the grub screws, as per Fig. C.
4. Attach the shower head (part 6), shower hose (part 4) and hand piece (part 1) as per Fig. D.

WALL SHOWER

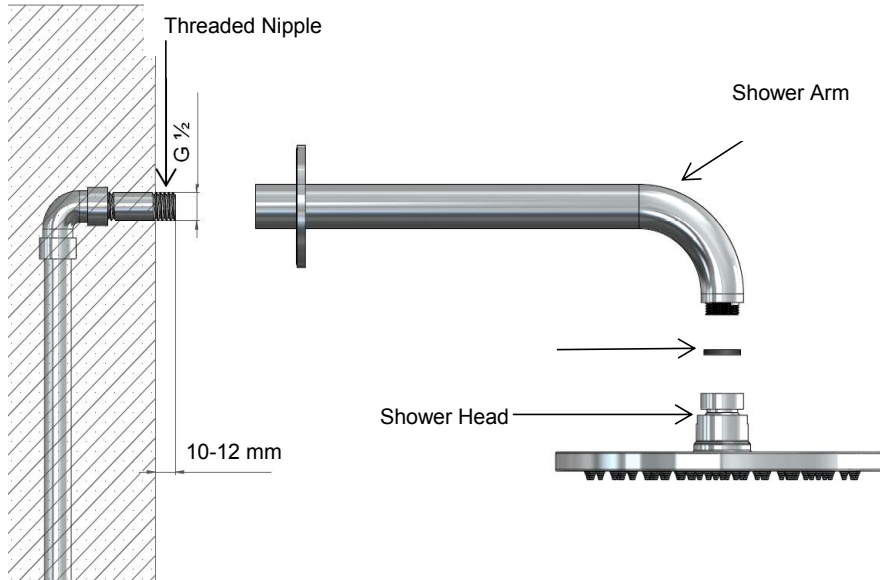

1. Check that the G 1/2" thread is the correct length. Cut to length if required ensuring the shower arm will finish flush with the wall. Apply thread tape (if required).

2. Slide the back plate over the shower arm (before screwing the arm onto the thread).

3. Screw the shower arm onto the G 1/2" thread ensuring that when it finishes it is level and at the correct end position.

4. Attach the shower head, ensuring the rubber seal and flow restrictor is installed (these may be loose in the box).



For further information
email admin@modernnational.com.au
modernnational.com.au