

LED BATHROOM MIRROR INSTALLATION GUIDE

▲ Warning:

For safety considerations, we kindly request that you thoroughly review this installation and user guide prior to installing and using the product.

It is imperative that a licensed electrician performs the installation.

We recommend consulting a qualified electrician to ensure the installation location complies with the necessary standards.

Please conduct an inspection of the package contents for any signs of damage that may have occurred during shipping.

In the event of any damage, please promptly get in touch with the reseller or supplier to initiate a warranty claim. It is important to note that once the product is installed, neither the supplier nor the resellers bear any liability for potential damage.

Handling Recommendations: Avoid placing the shaving cabinet on a hard surface, and always lift it with two people or more.

For cleaning and maintenance, wipe the mirror surface with a few drops of methylated spirits or isopropyl alcohol.

Warranty:

Customers can contact us for refund or replace your product if there are defective due to faulty materials, craft or function within one year of purchase or delivery.

This is not applicable should:-

1. Damage is caused by not carrying out the recommended appliance maintenance.
2. Accidental damage, faults caused by negligent use or care, misuse, neglect, careless operation or handling of the appliance is not by our operating manual.
3. Use of the device for anything other than regular domestic household purposes.
4. Faulty installation.

If you are in any doubt as to what is covered by your guarantee, please contact us.

5

UNIVERSAL USER MANUAL

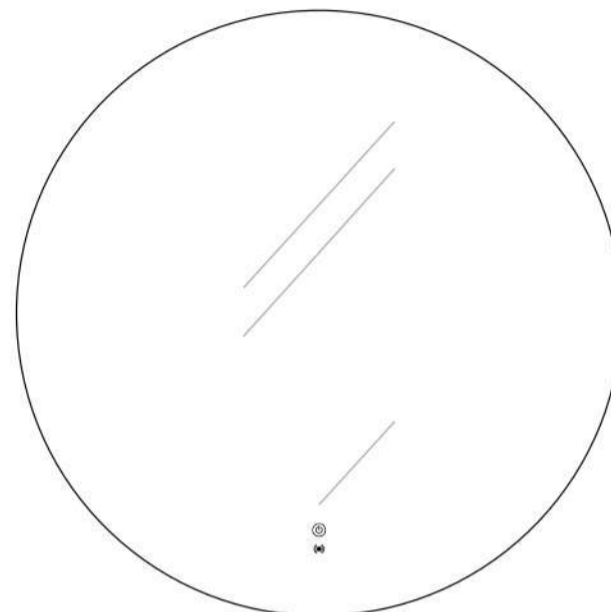

LED BATHROOM MIRROR

LED BATHROOM MIRROR OPERATION INSTRUCTION

Touchless control:

- Motion sensor proximity Radar controls the entire device on/off.

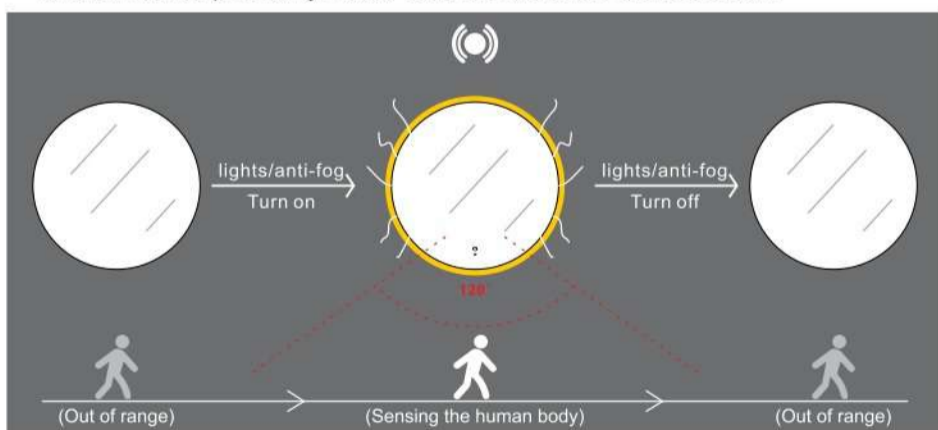

Colour Temperature Adjustment:

- You can manually switch the colour temperature.

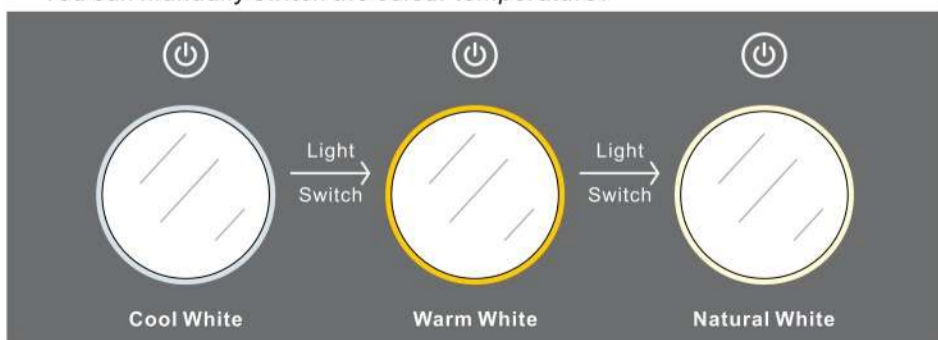

- ▲ **Memory function:** Set the color temperature you want, after 10s, it will keep your setting. When restart in the next time, it returns to be the previous state of use.

- ▲ **On/Off keying:** You can turn off the radar sensing control by holding down the button.

- ▲ **Touchless control:** Turn on LED light when close to radar sensor less than 100-150CM, The LED light will be turned off when keep away from the sensor.

- ▲ **Energy saving function:** All LED light will be turned off one hour later automatically if you forget to close them.

6

LED BATHROOM MIRROR AFTER-SALE GUIDE

Specifications:

Connection	Plug-wiring
Mounting Way	Wall-mounted
Color Temperature	3000~6000K
Switch Type	Touch ON/OFF
Voltage	220~240V
Light Color	Warm white/Natural white/Cool white
Memory Function	Yes
CRI	>80

7

LED BATHROOM MIRROR INSTALLATION GUIDE

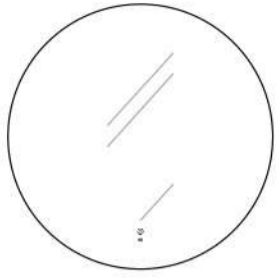

Front

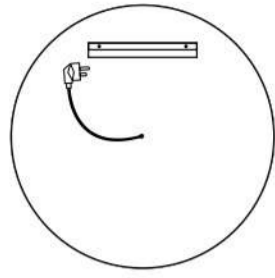

Back

PACKAGE CONTENTS



a



b



c

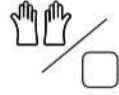

d

Piece	Description	Quantity
a	LED Bathroom mirror	1
b	Wall Anchors & Screws	3
c	Hanging Panel	1
d	Working Gloves / Lens Wiping Cloth	1

TOOLS REQUIRED



DRILL



DRILL BITS



MEASURE TAPE



PENCIL

1

LED BATHROOM MIRROR INSTALLATION GUIDE

IMPORTANT SAFETY INSTRUCTIONS

Pre-Installation

PLANNING INSTALLATION

Compare all parts with the part listed in the package contents section if any part appears missing or damaged. Do not install and use this light. Contact customer service.

WARNING: RISK OF ELECTRICAL SHOCK

- Turn off electrical power at fuse or circuit breaker box before wiring fixture to the power supply.
- Turn off the power when you perform any maintenance.
- Please verify that the supply voltage is correct by comparing it with the luminaire label information.
- Make all electrical and grounded connections under the National Electrical Code, and any applicable local code requirement.

CAUTION: RISK OF INJURY

- Wear gloves and safety glasses when removing luminaire from the carton, installing, servicing or performing maintenance.
- Avoid direct eye exposure to the light source while it is on.
- Account for small parts and destroy packing material, as these may be hazardous to children.
- Mirrors are heavy. Get assistance lifting the unit. This installation is most straightforward when performed by two people.

WARNING: RISK OF BURN

- Allow fixture to cool before handling. Do not touch enclosure or light source.
- Follow all lamp manufacturer's warnings, recommendations and restrictions for driver type, burning position, mounting locations/methods, replacement, and recycling.

CAUTION: RISK OF FIRE

- Keep combustible and other materials that can burn away from luminaire and lamp/lens.

2

LED BATHROOM MIRROR INSTALLATION GUIDE

ELECTRIC CONNECTIONS

ALL WIRING SHOULD BE DONE BY A QUALIFIED LICENCED ELECTRICIAN

- ▲ **A WARNING:** Shut off power before wiring the mirror.
- ▲ **A WARNING:** When used in bathrooms and in all other locations as required by the National Electrical Code, the electrical selector must be connected to a 220-240V (grounded dirt interrupter) protection circuit.
- ▲ **A CAUTION:** Requires 220-240VAC 50/60Hz

The electric wire comes through the access hole in the back of the mirror.

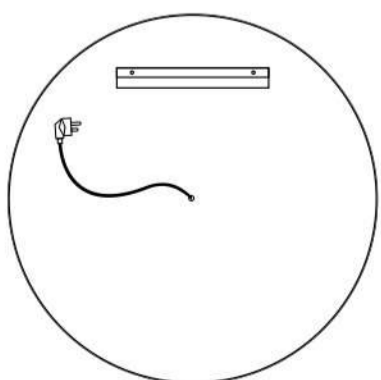

Plug-in

Make connections
Neutral to White
Live to Black

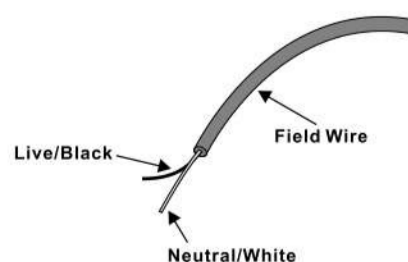

Hard wiring

3

LED BATHROOM MIRROR INSTALLATION GUIDE

1

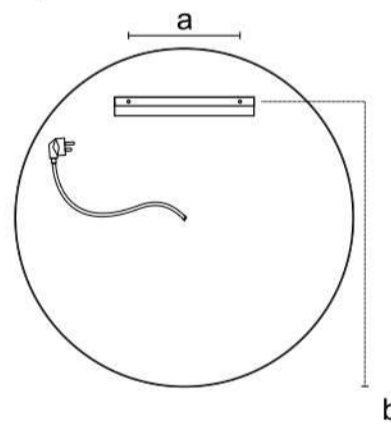

This part of PF frame can be use as hanger.

2

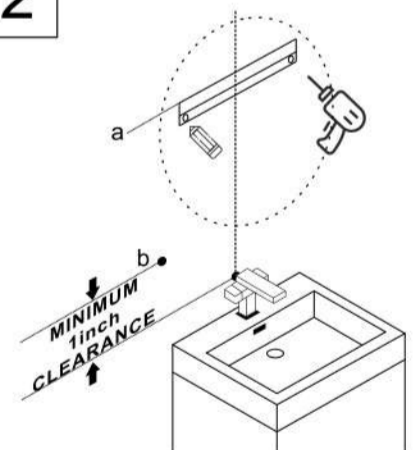

1. Record pre-installation position, size and hole position of hanging plate.
2. Drill a hole in the wall with a drill.

3

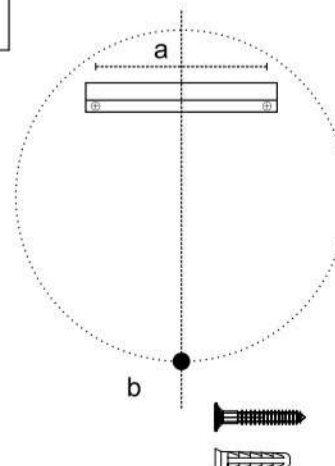

Screw the hanging plate to the wall.

4

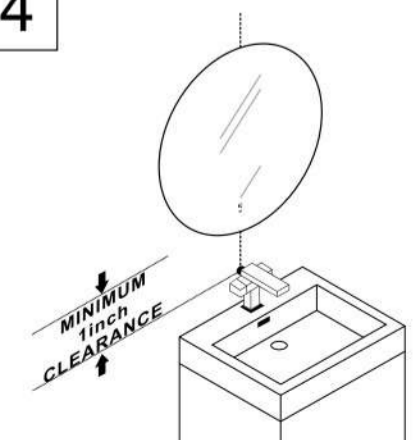

Make sure the mirror hangers snap into the wall hanging plate.

4