

Sit Stand Desk Frame

Model Number: PD-JB-S2

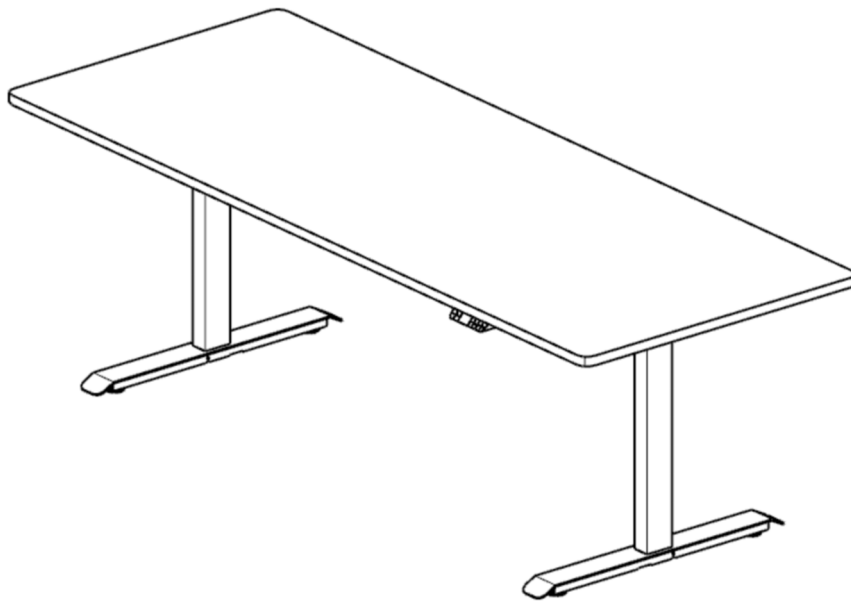

The Reset procedure must be completed before the first running after table is installed or parts replaced.

If the Reset process is interrupted, the system will stop running and will need to be reinitialized to operate again.

Tools Needed



Socket Head wrench



Electric Drill

User Notes

1. As with all power-operated products, please follow instructions closely and handle with care.
2. when moving tables, please adjust the table to the lowest height , do not drag or tilt the table on one leg as misalignment may occur.
3. Please ensure the weight on the table does not exceed weight limit (**100kg absolute maximum, 80Kg recommend maximum including tabletop weight**).
4. The input voltage should be within 100-240v.
5. Table should be level and aligned at all times.
6. If, after trouble shooting the problem persists, please contact customer service for further assistance.

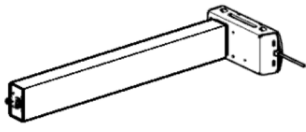

A*2

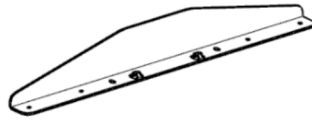

B*2

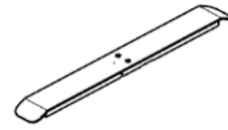

C*2

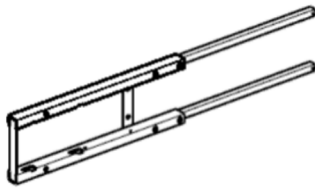

D*1

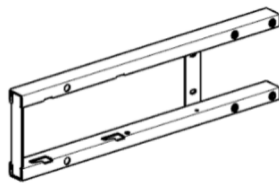

E*1



F*2

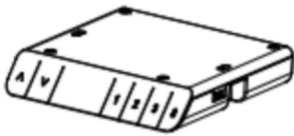

G*1

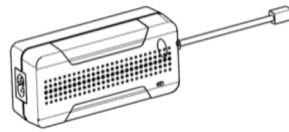

H*1



I*1



K*5



N*11



M*3



O*13



P*5



R*1



S*1

1

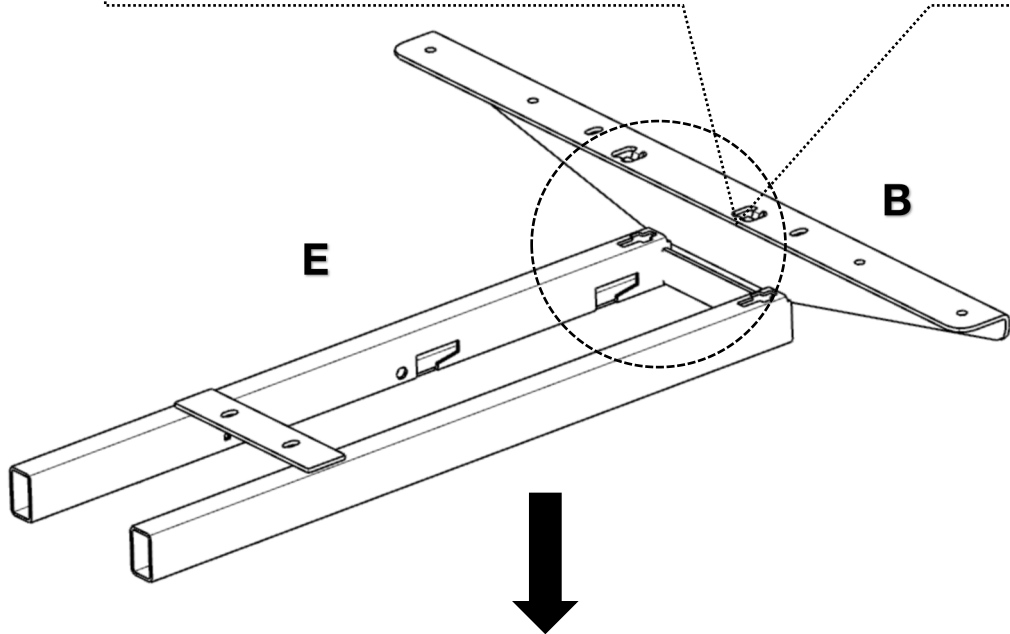
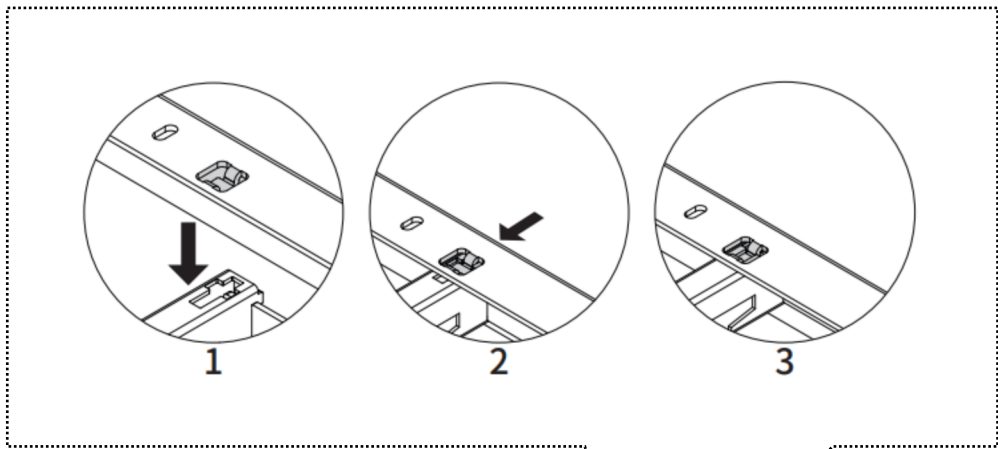

Place Beam (B) on the crossframe (E),
insert and push in.
Repeat on the other side with Part D

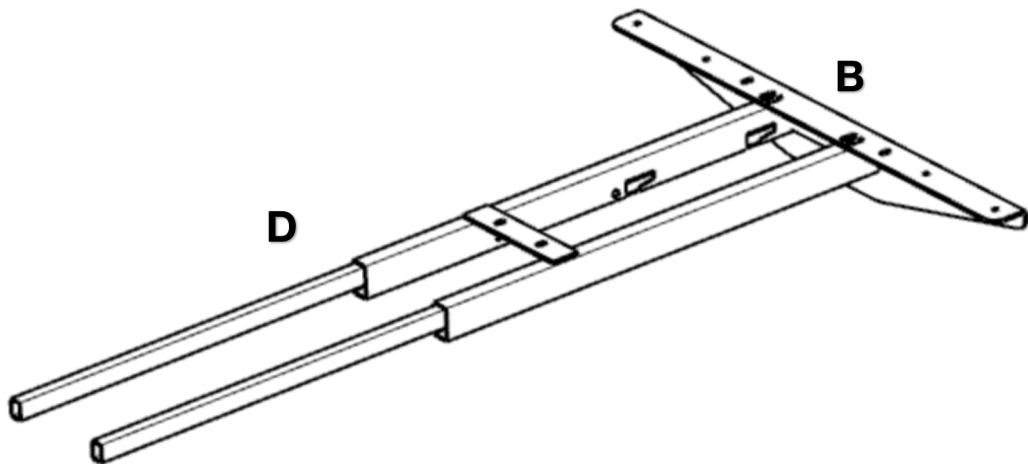

2

Use wrench(R) to untighten the Bolts (Q), extend the inner rail to insert Part E

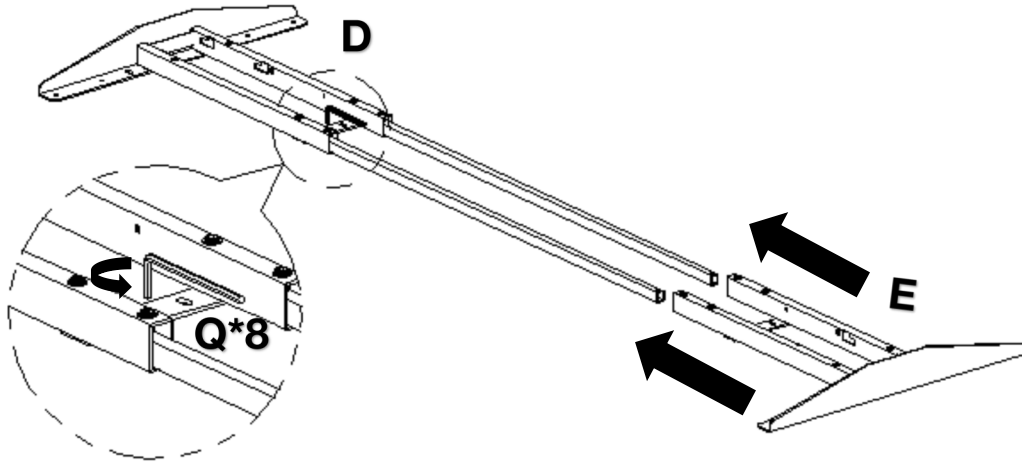

3

Extend and place the frames to align the pre-drilled holes on the desktop

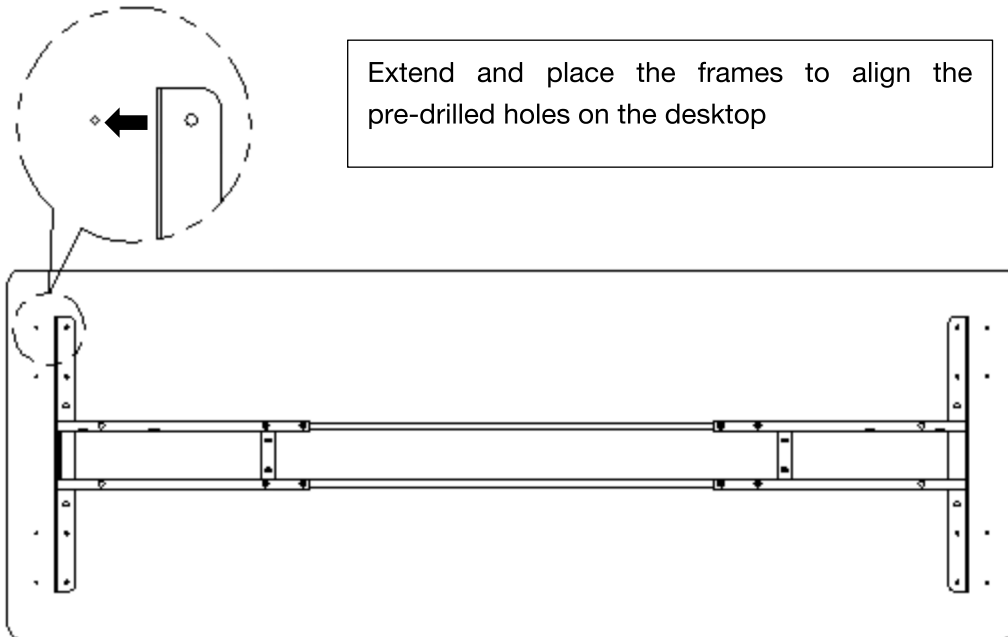

4

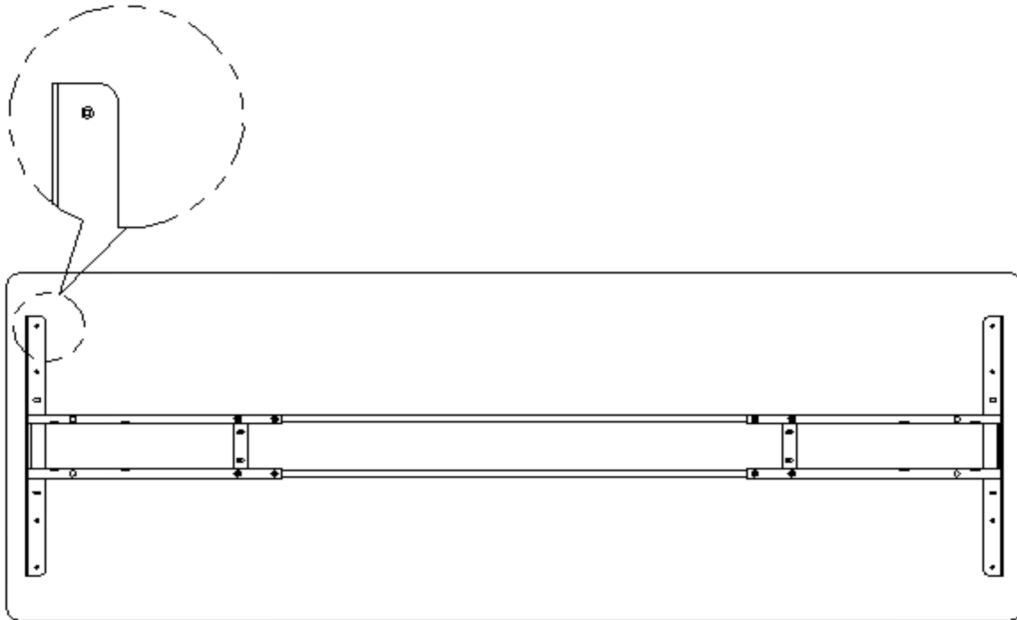

Use electric drill to secure screws(O) on the beams, repeat on the other side.

Then, tighten the Bolts(Q) on both side of Part D and E

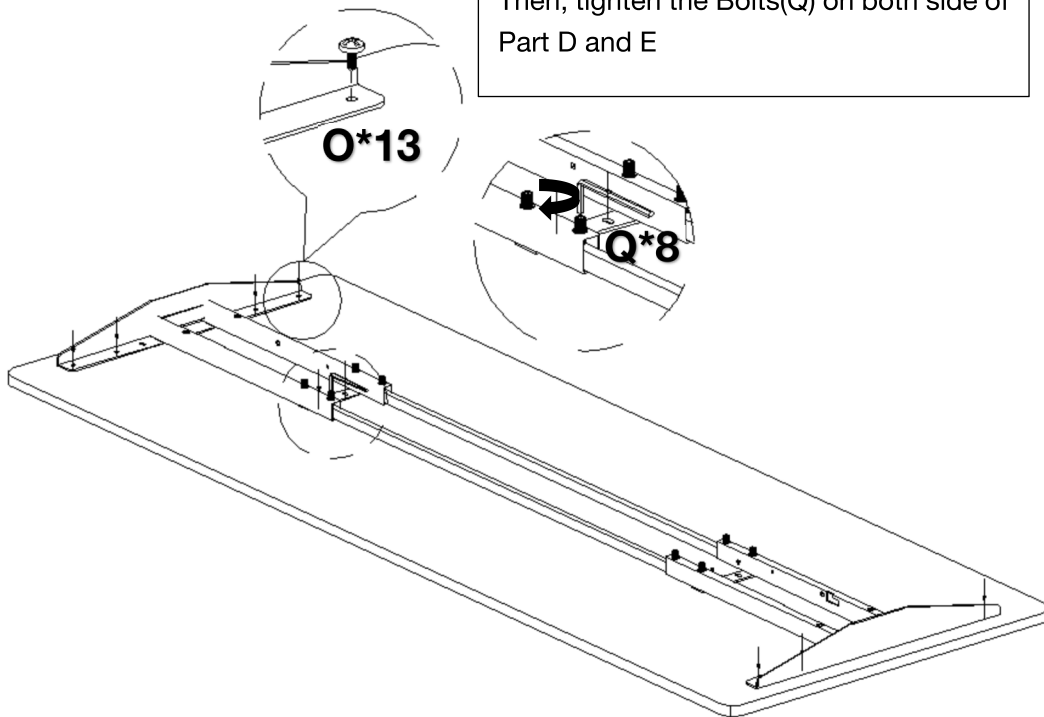

5

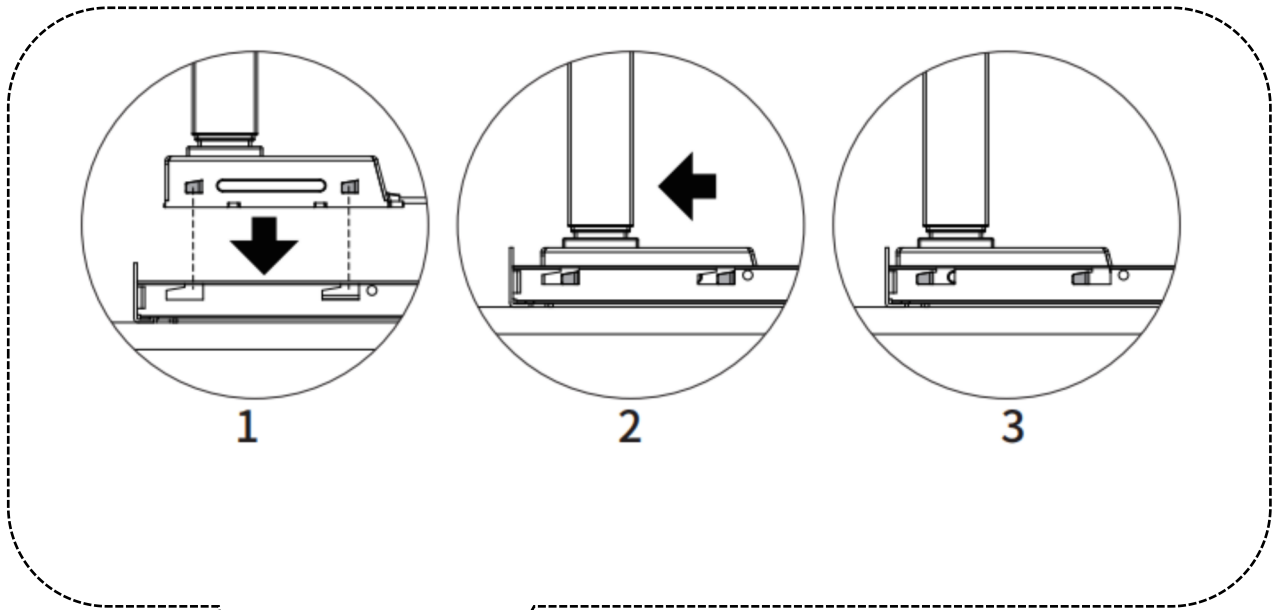

Place Leg (A) into Part D and slide
Repeat on the other side

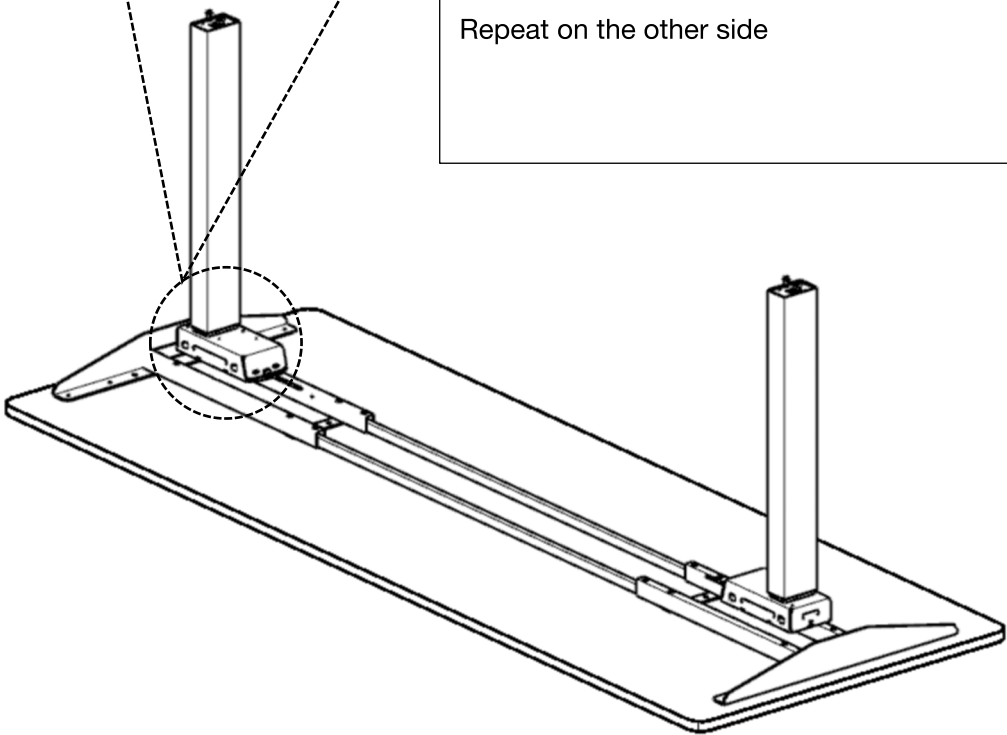

6

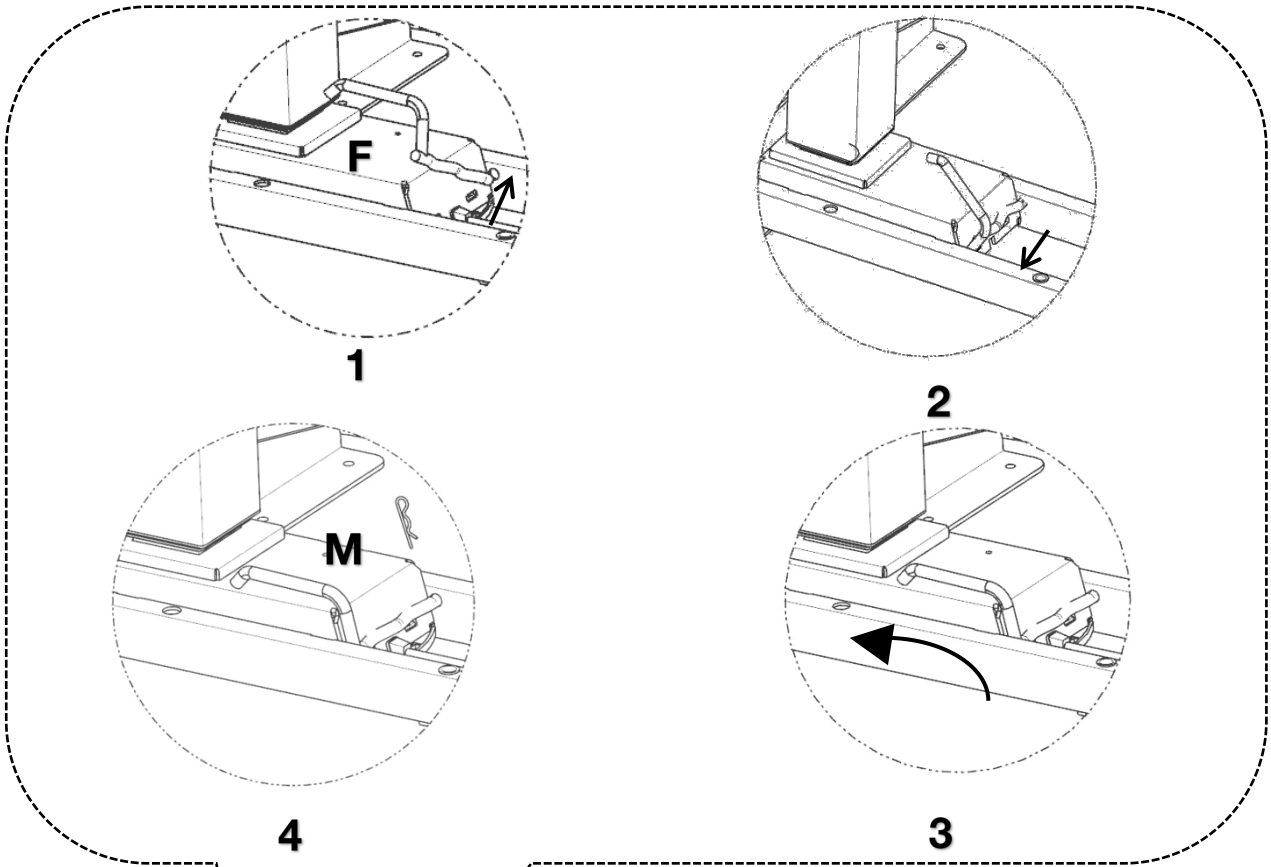

Insert steel bar (F) into the cutout from Part D, press down to lock it. Then, place safety pin (M) into the steel bar.

Repeat on the other side.

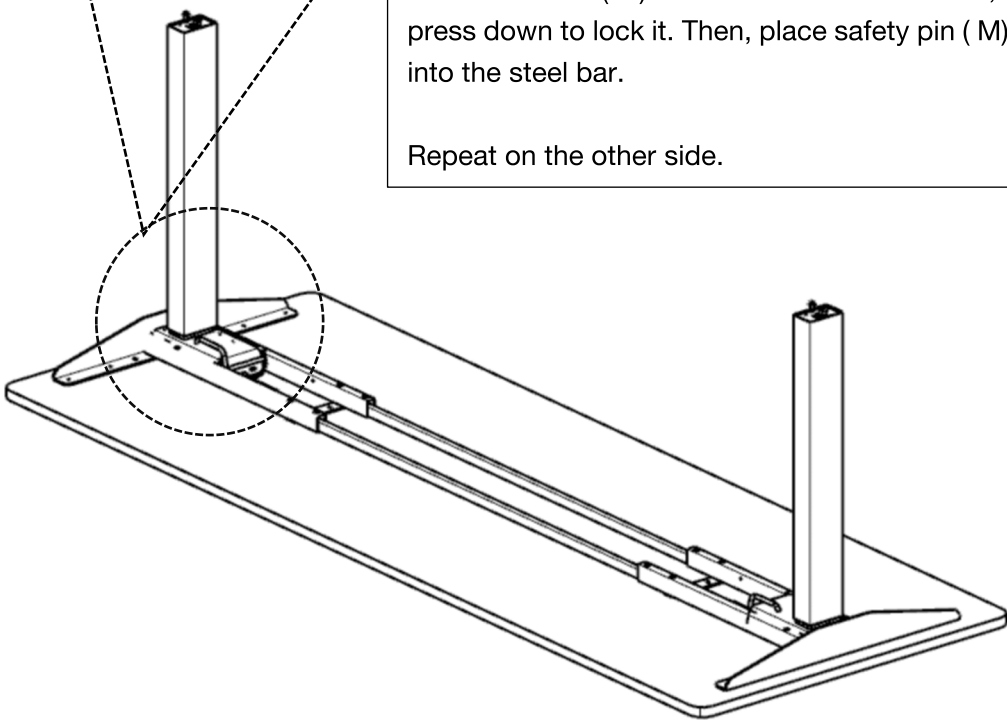

7

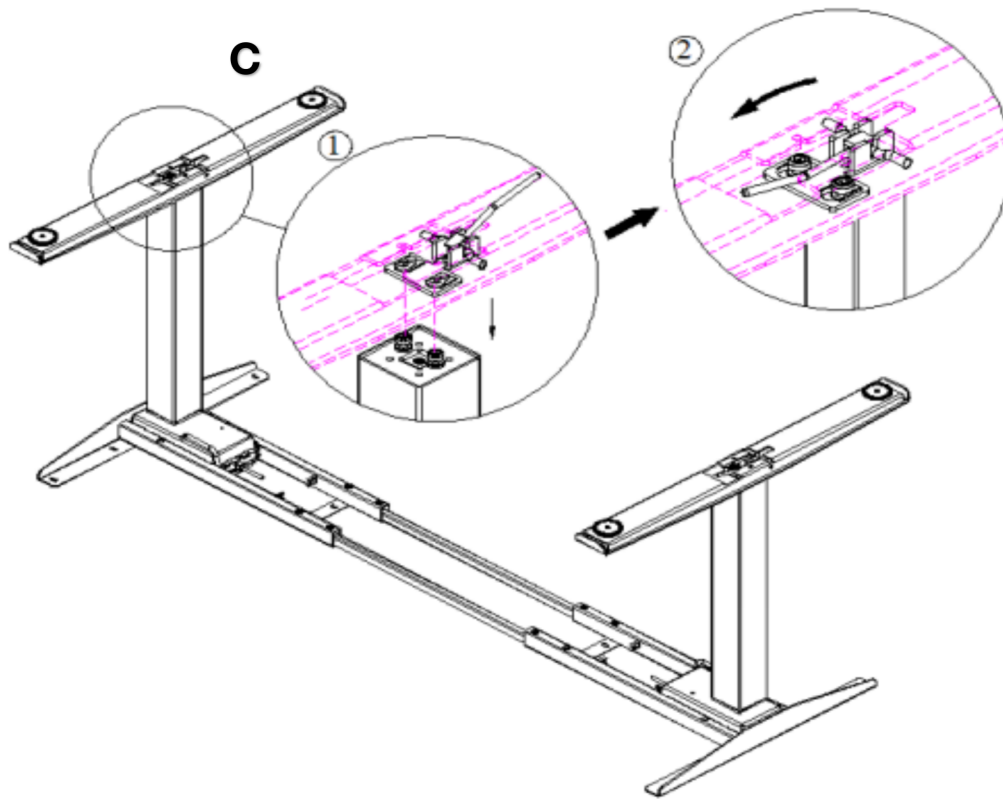

Place the footbeam (C) on top of the leg (A).

Release the handle, align the footbeam with two bolts on the leg.

Press down the handle to lock the footbeam.

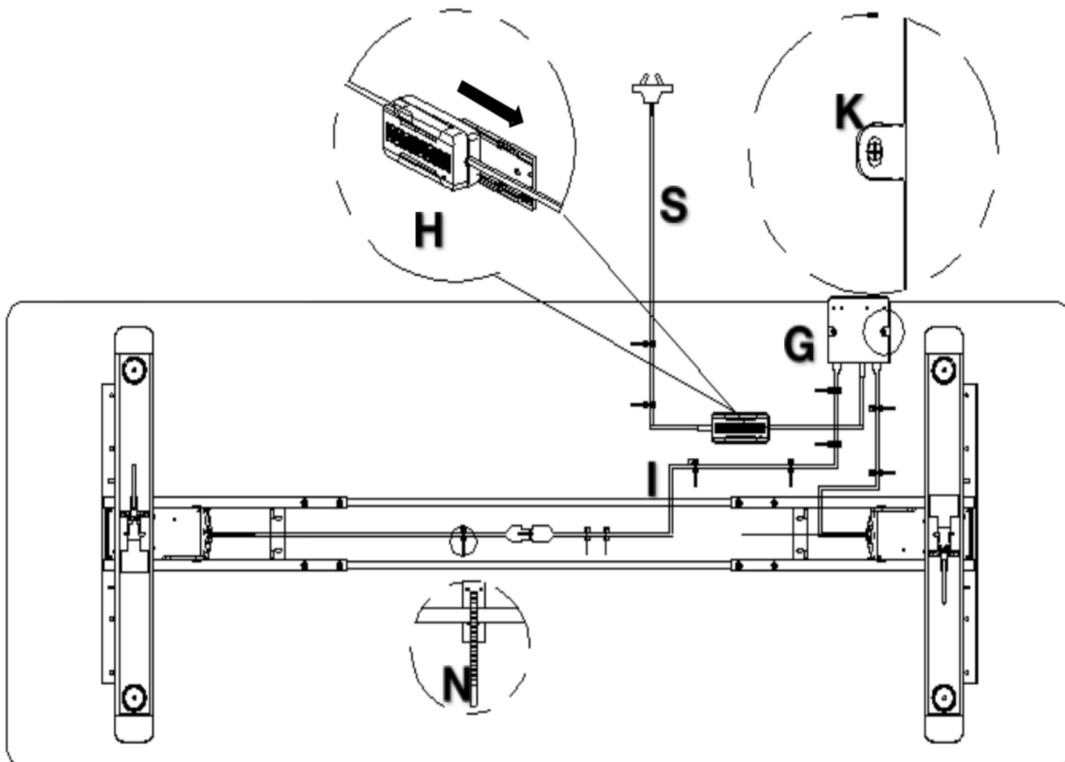

Use Electric drill to secure Control Box (G) with screws (K) at right or left side of table as you preferred position.

Use extend line (I) to connect left or right leg, and connect to control box (G).

Use the sticky slide clips to attach on the power box (H) and desktop surface at your preferred position, then connect the power line (S) to control box (G).

Tidy up all the lines with sticky cards (N).

Digital Handset Operation Instruction

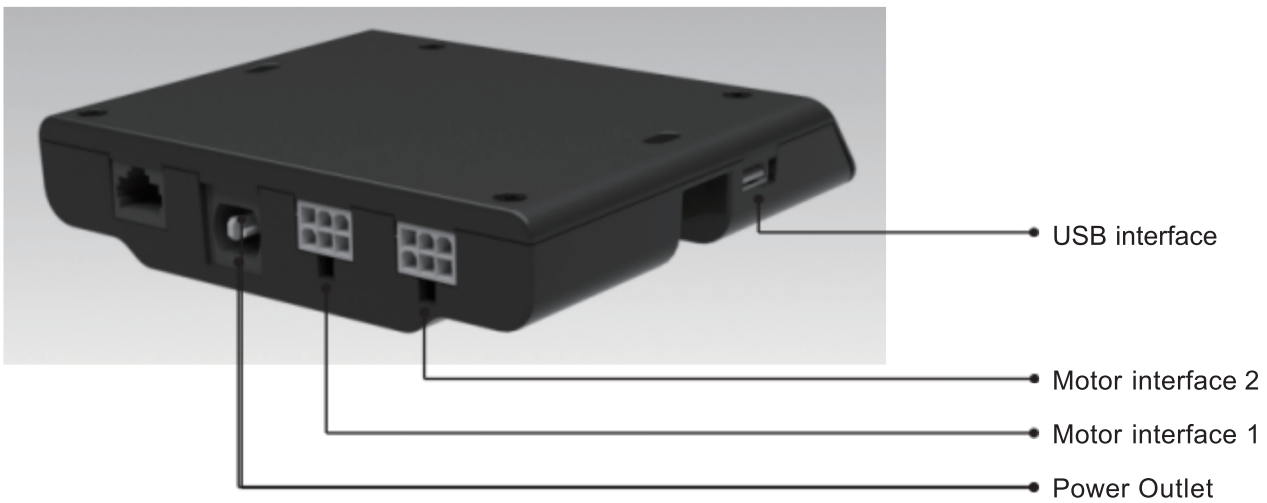
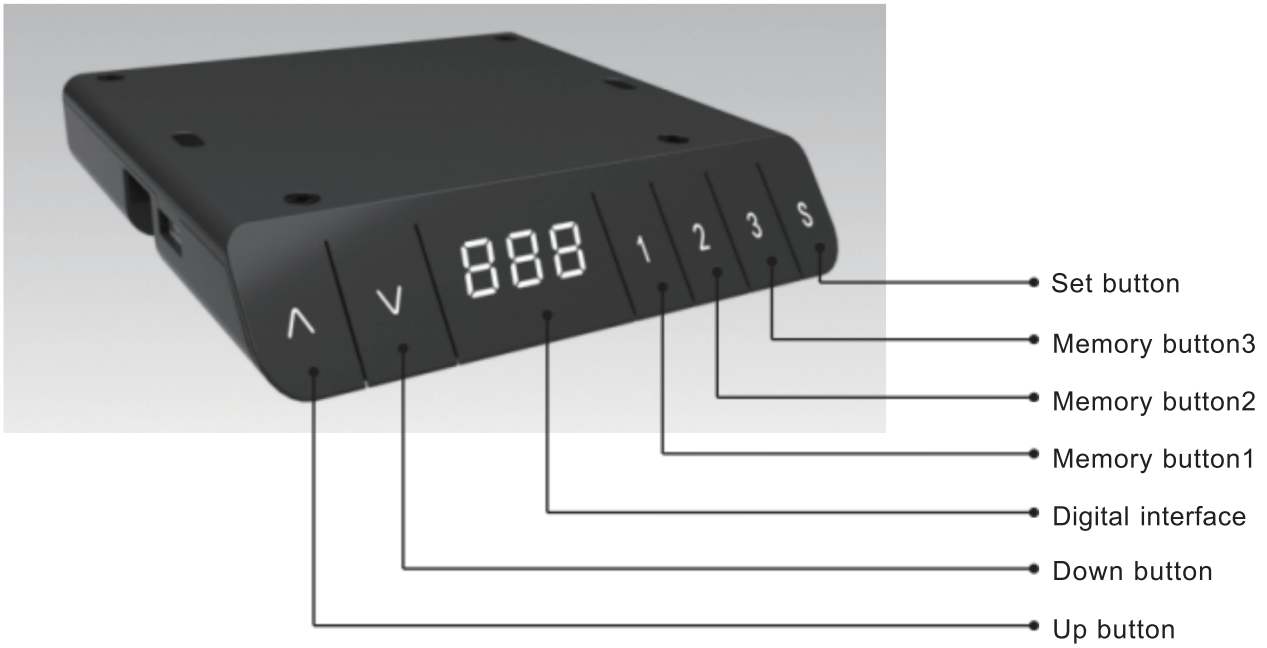

• Description of Handset Operation :

1. Reset Procedure :

Step	Operation	Motion
1	Press and hold \wedge & \vee simultaneously for more than 3seconds	Legs begin to move down at half speed of normal operation
2	Keep pressing \wedge & \vee	Legs move down to the lowest position and rebound 2-5 mm, then stop
3	Release \wedge & \vee together	Reset is completed

1. The Reset procedure must be completed before the first running after table is installed or parts replaced.

2. If the Reset process is interrupted, the system will stop running and will need to be reinitialized to operate again.

2. Move up and down :

Step	Operation	Motion
1	Press and hold \wedge	Legs move up
2	Press and hold \vee	Legs move down

3. Set memory positions 1/2/3:

Step	Operation	Motion
1	Press and hold \wedge or \vee , then release	Run the legs to the position you want the table top to be
2	Click button S, then click button 1, 2 or 3 within next 3 seconds, press S to save	Position 1, 2 or 3 is saved

Memory setting will be cleared after reset procedure

4. Operation on Saved Memory Position:

Step	Operation	Motion
1	Quickly Click button 1 or 2 or 3	Legs return to the corresponding position saved

5. Operation for One-Touch Mode:

Step	Operation	Motion
1	Touch and hold button S more than 6 seconds	The captions shown on the screen“ _ _ _ ”
2	Release button S,touch button 1 within 3 seconds	The screen displays "H-0" or "H-1" subtitles, indicating that one-touch move up and down function is off or on
3	Touch ^ or v to change the current function of turn on or off	“H-0”express function turn off ; “H-1” express function turn on
4	Touch and hold button S 2 seconds	One-key move up and down function is off or on finished

By default, one key move up and down function is off.

6. Switch the display unit

Step	Operation	Motion
1	Press and hold button S, then press and hold v , for about 3 seconds	The height information will be changed between centimeters and inches
2	Release the buttons	completed

In inch format, the minimum height variation as the legs move up or down is 0.5inches, while in centimeter format is 1 centimeter

7. Verify the display data to table height

Step	Operation	Motion
1	Set the table at any height, recommended at the bottom position	Measure the table actual height and write down the number in inches or in centimeters
2	Press and hold button S, then press and hold \wedge , for about 3 seconds	The first number starts flashing on the screen
3	Release the buttons, then click \wedge or \vee to change the first number	The first number is being increased or decreased to the first number you measured
4	Click button S	The second number starts flashing on the screen
5	Click \wedge or \vee to change the number	The second number is being increased or decreased to the second number you measured
6	Click button S	The third number starts flashing on the screen
7	Click \wedge or \vee to change the number	The third number is being increased or decreased to the third number you measured
8	Click button S	Completed

Check the switch display format in inches or in centimeters and switch to the unit you like and match to the actual measurement. In inch format, the minimum adjustable height is 0.5inches, while in centimeter format is 1 centimeter.

8. Maximum or Minimum Desk Height

8.1 Lock the maximum height

Step	Operation	Motion
1	Press and hold \wedge or \vee , then release	Run the legs to the position you want the table top to be
2	Press and hold button S, then press and hold 3, for about 3 seconds	Letter "L" is indicated on the screen. That means the position is locked at the highest position that the table can be moved to
3	Release the buttons	Completed

- 1. Legs aren't able to run above the locked position**
- 2. Memory position(s) are/is above the locked position will be lost even after the table is unlocked, you need to follow SET MEMORY POSITIONS again to reset these memory positions.**
- 3. Reset procedure will not unlock the top limit.**

8.2 Lock the minimum height

Step	Operation	Motion
1	Press and hold \wedge or \vee , then release	Run the legs to the position you want the table top to be
2	Press and hold button S, then press and hold 1, for about 3 seconds	Letter“L”is indicated on the screen. That means the position is locked at the highest position that the table can be moved to
3	Release the buttons	Completed

1. Legs aren't able to run below the locked position

2. Memory position(s) are/is above the locked position will be lost even after the table is unlocked, you need to follow SET MEMORY POSITIONS again to reset these memory positions .

3. Initialize switch will not unlock the bottom limit.

9. Clear Maximum and Minimum Height

Step	Operation	Motion
1	Press and hold button S, then press and hold 2, keep about 3 seconds	Letter“-C-”is indicated on the screen. That means the table's unlocked and can be moved in full range
2	Release the buttons	Completed

10. Error code

Error code	Error reason	Decision criteria	Troubleshooting solution
E01	Leg malfunction	The leg is disconnected from the control box, displaying E01	1.Legs loosed to the control box, check the cable connection, ensure the connection. 2.Inner parts of legs are broken, replace the legs
E02	Frequent operations	Continuous lifting for 2 minutes, displaying E02	Work system is 2 minutes of work and 18 minutes of rest. When E02 occurs, the lifting operation is invalid. Wait for about 18 minutes to return to normal.
E03	Table top overload	The desktop load exceeds the control box rating load, and the screen displays E03	The objects piled up on the desktop are too heavy, so the objects piled up on the desktop should be reduced
E04	Control box malfunction	Control box malfunction, displaying E04	1.Under extreme environment, operating will cause the control box malfunction, initial procedure needed 2.Discontinue the initialize process will cause the control box malfunction, reinitialize needed.
E05	Button of switch stuck	The handset lasted 30 seconds, and the key value was unchanged. The screen displayed E05	1.Button of switch stuck, check the status of the button, if stuck then toggle the button to restore. 2.Replace the switch
E11	Unstable voltage& current	Voltage supply not stable	1.Power cable loose connection to power supply, check it. 2.Power supply not in normal work condition.