

# Monaco

**MO0009CR**

Chrome Raised Wall Mounted Shower Arm

All dimensions in mm

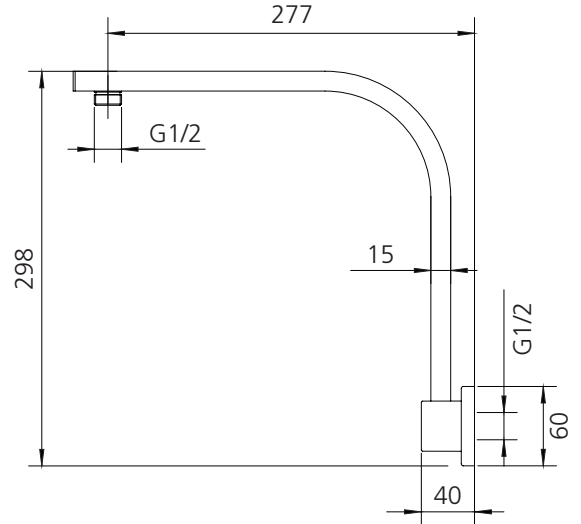

## Specifications /

<b>WELs rating</b>	NA
<b>Temperature rating (min / max)</b>	1°C - 65°C
<b>Pressure rating (min / max)</b>	150 kPa - 500 kPa
<b>Finish</b>	Chrome (electroplating)
<b>Materials</b>	Brass
<b>Water supply</b>	Mains
<b>Connections</b>	G 1/2 Female
<b>Mounting methods</b>	Wall mounted
<b>Product weight</b>	0.81kg
<b>Parts List</b>	Shower arm x1, flange x1
<b>Warranty</b>	5 years replacement parts and finish; 1 year labour (refer to <a href="http://oliveri.com.au">oliveri.com.au</a> )
<b>Maintenance and care instructions</b>	All surfaces should be cleaned with mild liquid detergent or soap and water. Do not use cream cleaners or citrus based cleaning products, as they are abrasive. Use of unsuitable cleaning agents may damage the surface. Any damage caused in this way will not be covered by warranty.

