

ASSEMBLY INSTRUCTION

DESCRIPTION:

6197

ALLIONA 2 DOOR 4 DRAWER WARDROBE

3.5 HR

APPROXIMATE ASSEMBLY TIME

3 PERSON ASSEMBLY

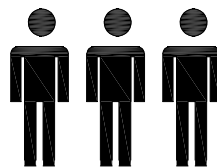

FLOOR AREA
2.5M X 2.7M

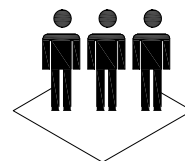

REQUIRED ASSEMBLY SPACE

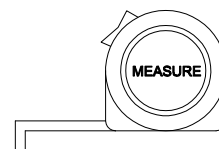
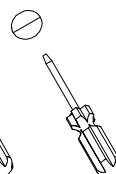
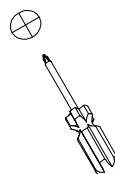
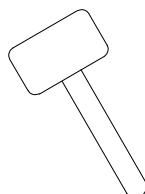

REQUIRED ASSEMBLY TOOLS (NOT PROVIDED)

ASSEMBLED DIMENSION

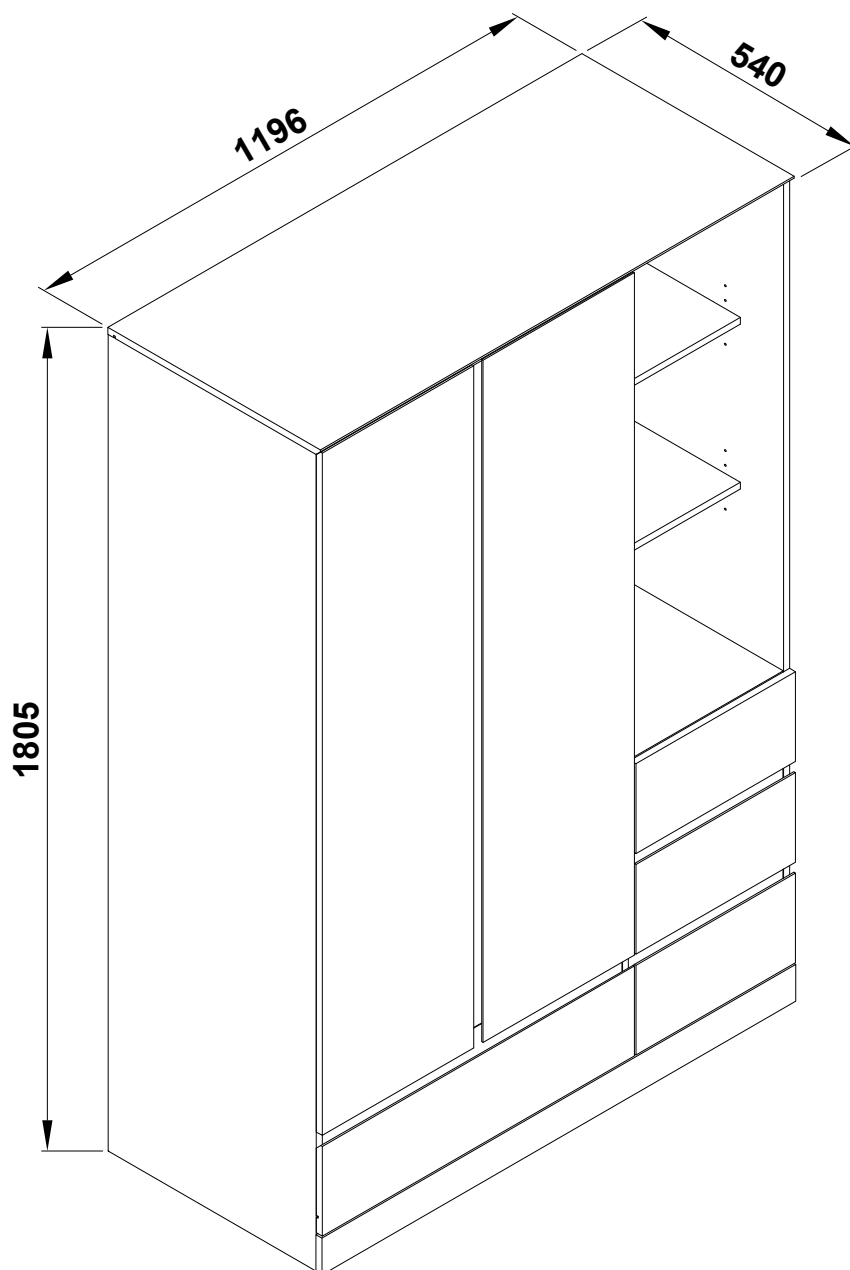



**WARNING : ENSURE THE WALL STRAP IS ATTACHED
TO AVOID SERIOUS INJURY OR DEATH.**

To avoid any serious or fatal injury, a wall strap has been provided with this product to prevent toppling. Always secure this product with an anchor device to the wall or suitable surface. Wall fixing hardware are not included since different surface materials require different attachments. Please seek professional advice if you are in doubt of what fixing device to use.

**Your product has been provided with a permanent safety
label that should never be removed for safety reasons.**



For more information please visit www.productsafety.gov.au

ASSEMBLY INSTRUCTION

DESCRIPTION:

6197

ALLIONA 2 DOOR 4 DRAWER WARDROBE

PART LIST

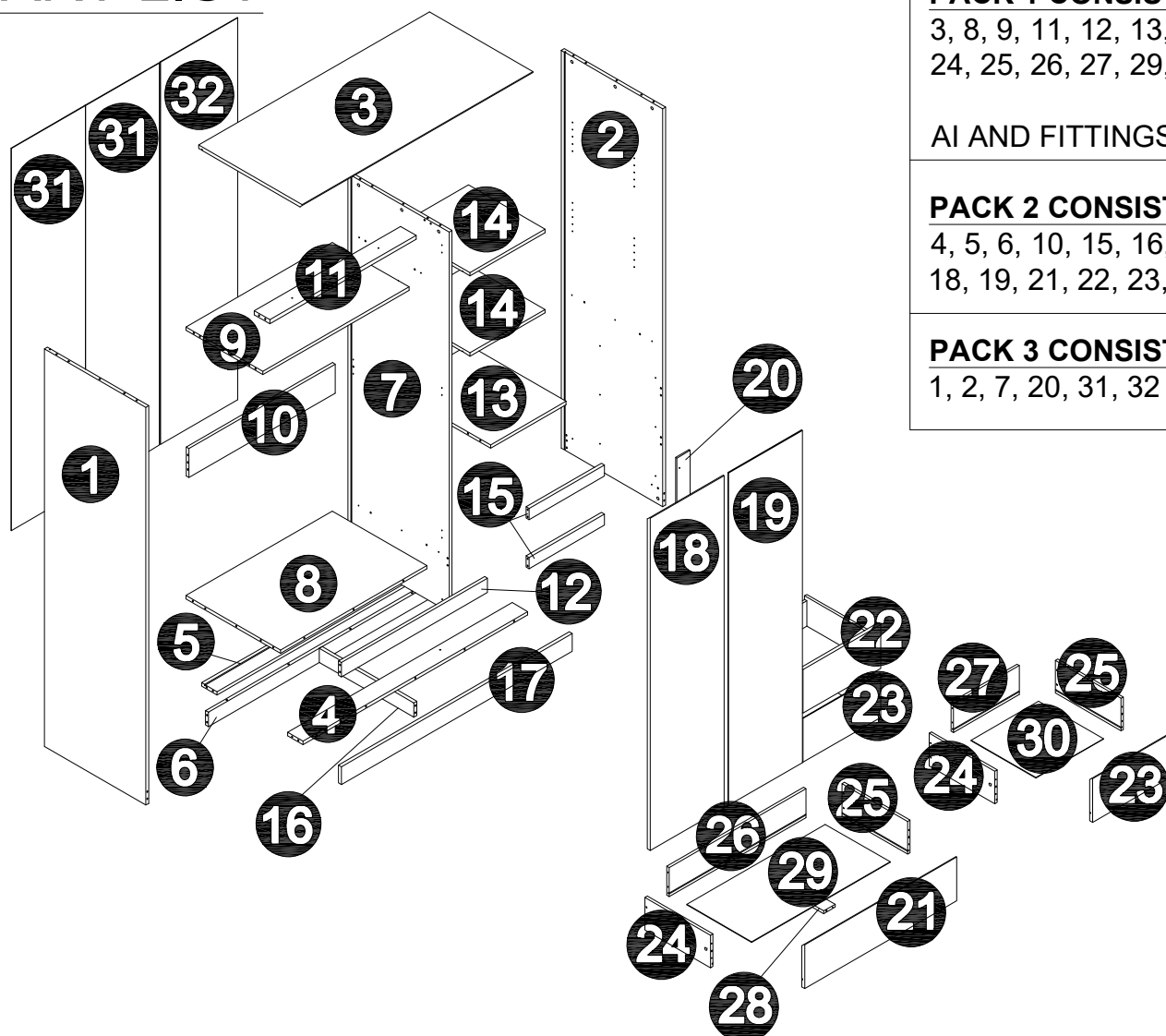

PACK 1 CONSIST OF
3, 8, 9, 11, 12, 13, 14,
24, 25, 26, 27, 29, 30

AI AND FITTINGS

PACK 2 CONSIST OF
4, 5, 6, 10, 15, 16, 17,
18, 19, 21, 22, 23, 28

PACK 3 CONSIST OF
1, 2, 7, 20, 31, 32

NO.	PART LIST	QTY	NO.	PART LIST	QTY
(1)	PART 1	1	(17)	PART 17	1
(2)	PART 2	1	(18)	PART 18	1
(3)	PART 3	1	(19)	PART 19	1
(4)	PART 4	1	(20)	PART 20	1
(5)	PART 5	1	(21)	PART 21	1
(6)	PART 6	1	(22)	PART 22	1
(7)	PART 7	1	(23)	PART 23	2
(8)	PART 8	1	(24)	PART 24	4
(9)	PART 9	1	(25)	PART 25	4
(10)	PART 10	1	(26)	PART 26	1
(11)	PART 11	1	(27)	PART 27	3
(12)	PART 12	1	(28)	PART 28	1
(13)	PART 13	1	(29)	PART 29	1
(14)	PART 14	2	(30)	PART 30	3
(15)	PART 15	2	(31)	PART 31	2
(16)	PART 16	1	(32)	PART 32	1

ASSEMBLY INSTRUCTION

DESCRIPTION:

6197

ALLIONA 2 DOOR 4 DRAWER WARDROBE

HARDWARE LIST

4 CM

3 CM

2 CM

1 CM

0 CM



X16
M3.5 X 12MM

A
SCREW

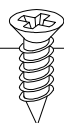

X36
M3.5 X 15MM

B
SCREW

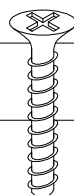

X2
M4.7 X 25MM

C
SCREW



X16
M6 X 9MM

D
SCREW

5 CM

4 CM

3 CM

2 CM

1 CM

0 CM

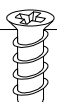

X12
M6 X 13MM

E
SCREW

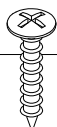

X7
M4 X 16MM

F
SCREW

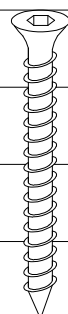

X18
M6 X 40MM

G
SCREW



X18
Ø6 X 20MM

H
**WOOD
DOWEL**

ASSEMBLY INSTRUCTION

DESCRIPTION:

6197

ALLIONA 2 DOOR 4 DRAWER WARDROBE

HARDWARE LIST

3 CM

2 CM

1 CM

0 CM

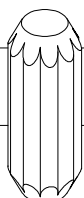

X57

Ø8 X 25MM

J

**WOOD
DOWEL**

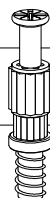

X50

20 X 5MM

K

**BOLT
DOWEL**



X40

Ø15 X 12MM

L

CAM



X10

Ø15 X 9MM

M

CAM

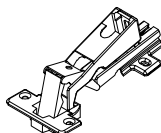

X6 SETS

N

**METAL HINGES (5/8")
W / SPRING 165
DEGREE**

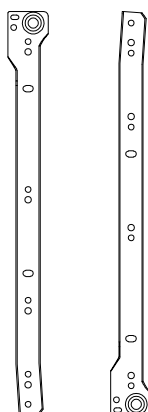

X4 SETS

P1 & P2

**DRAWER SLIDE
(350MM)**

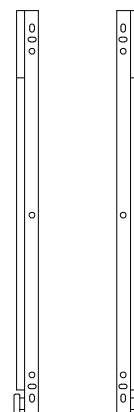

X4 SETS

Q1 & Q2

**DRAWER SLIDE
(350MM)**

ASSEMBLY INSTRUCTION

DESCRIPTION:

6197

ALLIONA 2 DOOR 4 DRAWER WARDROBE

HARDWARE LIST

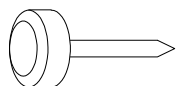

X8

R

**PLASTIC LEG
STUD**

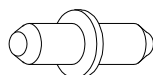

X8

S

**METAL ADJUSTABLE
SHELF STUD**



X1

T

**43 X 3MM CHROME
RAIL (752MM)**



X2

U

**43 X 318 ALUMINIUM
BRACKET (16MM)**

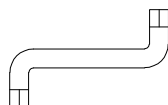

X1

V

ALLEN KEY M4

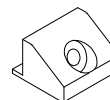

X16

W

**BACKPLY
STOPPER**

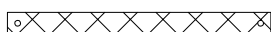

X2

X

**PP STRAP 12 X 150 X
1.2MM BLK 2 HOLE
WITH EYELEY**

Top Tips before you start!

1. Please check that all parts are present before you start the assembly of your furniture, as once assembled, the furniture is exempt from our home approval policy.
2. For ease and speed of assembly, we recommend that before you commence each step of the assembly, that you identify all the parts required for the step.
3. For larger items, please ensure that you have sufficient space and people (as indicated on page 1) to assemble your product safely.
4. We recommend that, where possible, all items are assembled near to the area in which they will be placed in use, to avoid moving the product unnecessarily once assembled.
5. For the protection of your furniture, particularly items of high gloss finish, we recommend that the product is placed on a protected surface during assembly to prevent any damage.
6. During assembly please take care not to over-tighten any fittings, as this may damage the product.

Care and Maintenance of your Furniture

- Please periodically check all fittings and re-tighten as necessary.
- Please do not drag or pull your furniture.
- Wipe occasionally with a soft cloth slightly dampened with water. Then buff with a dry clean soft cloth.
- Never allow any kind of liquid to remain on your furniture. Absorption can cause wood to warp or finishes to de-laminate.
- Please do not sit or stand on this item.

Special Tips for Fitting Minifix Cam (Cam-Lock), and Minifix Bolt (Cam-Bolts)

CAM-BOLT

Tighten until shoulder is flush with panel. Do not overtighten or undertighten (see example below).

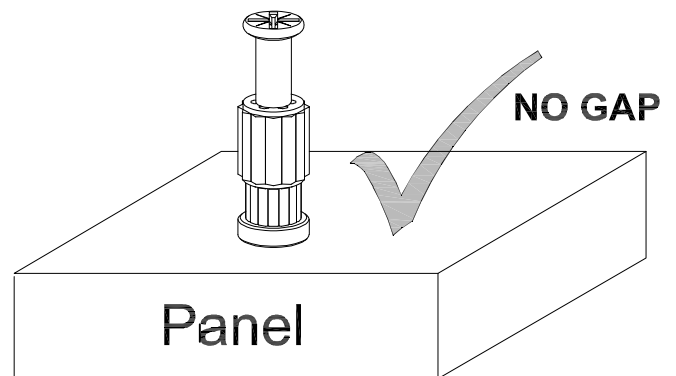
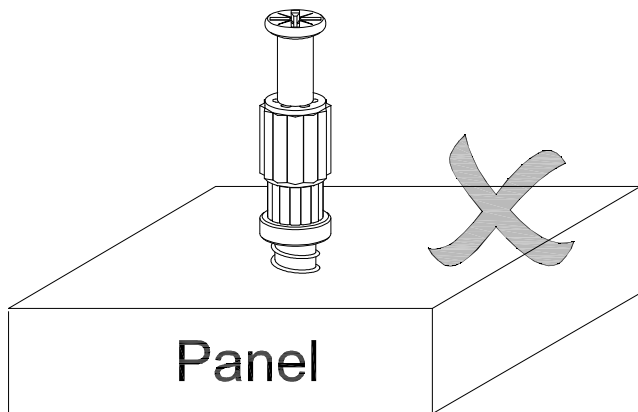
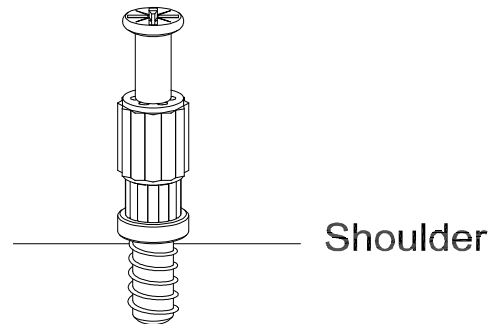

CAM-LOCK

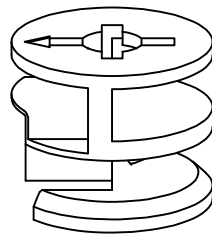

WHEN TIGHTENING CAM-LOCK
Turn The Cam-Lock Clockwise Until
The Arrow Points In The Position as Below !

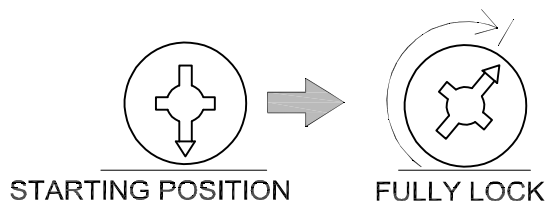

See this Arrow Points !

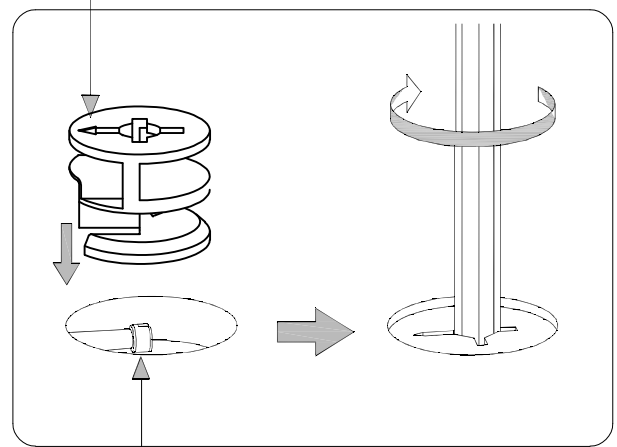

Bolt's head needs to be in centre !

ASSEMBLY INSTRUCTION

DESCRIPTION:

6197

ALLIONA 2 DOOR 4 DRAWER WARDROBE

STEP 1

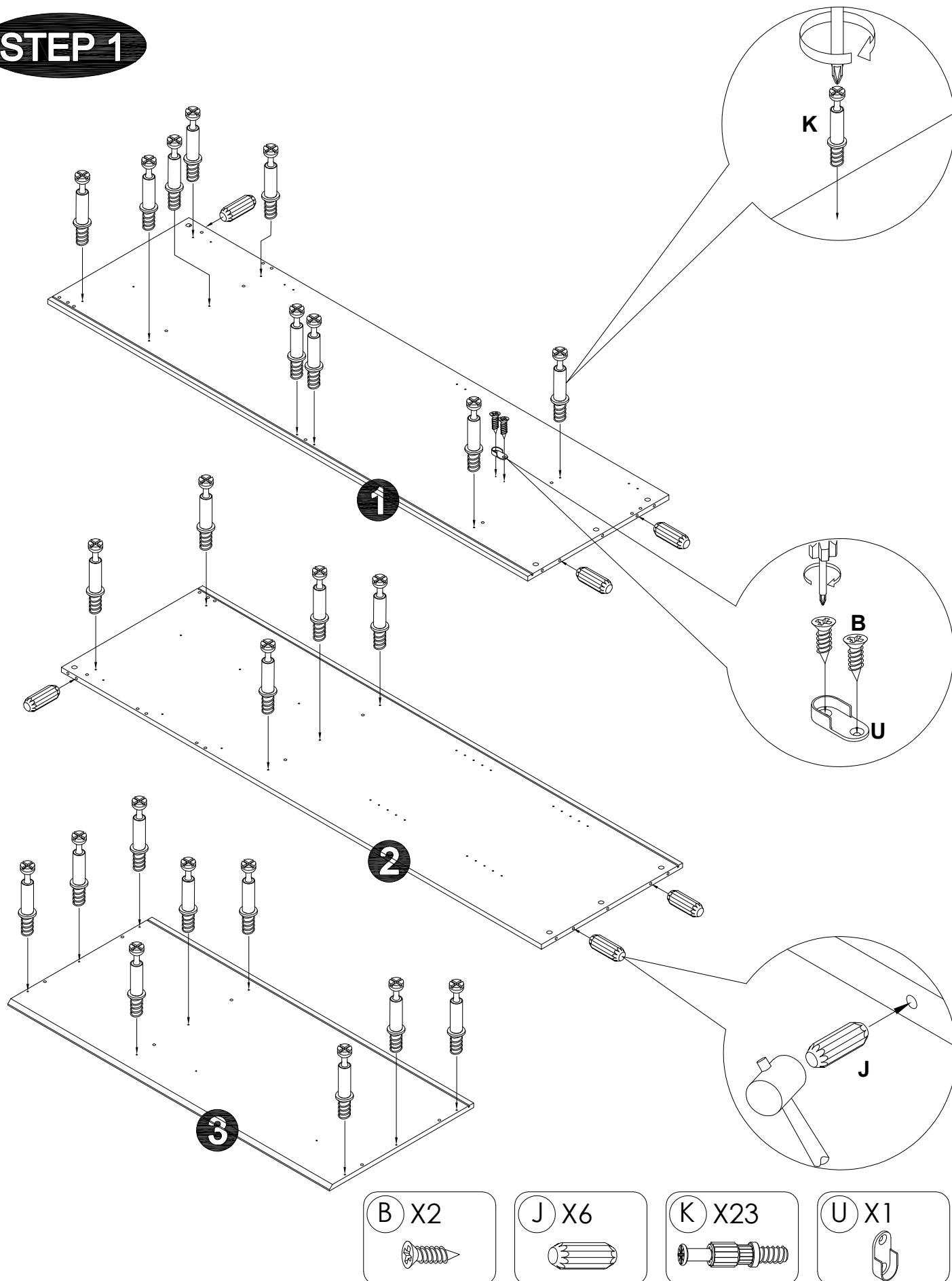

ASSEMBLY INSTRUCTION

DESCRIPTION:

6197

ALLIONA 2 DOOR 4 DRAWER WARDROBE

STEP 2

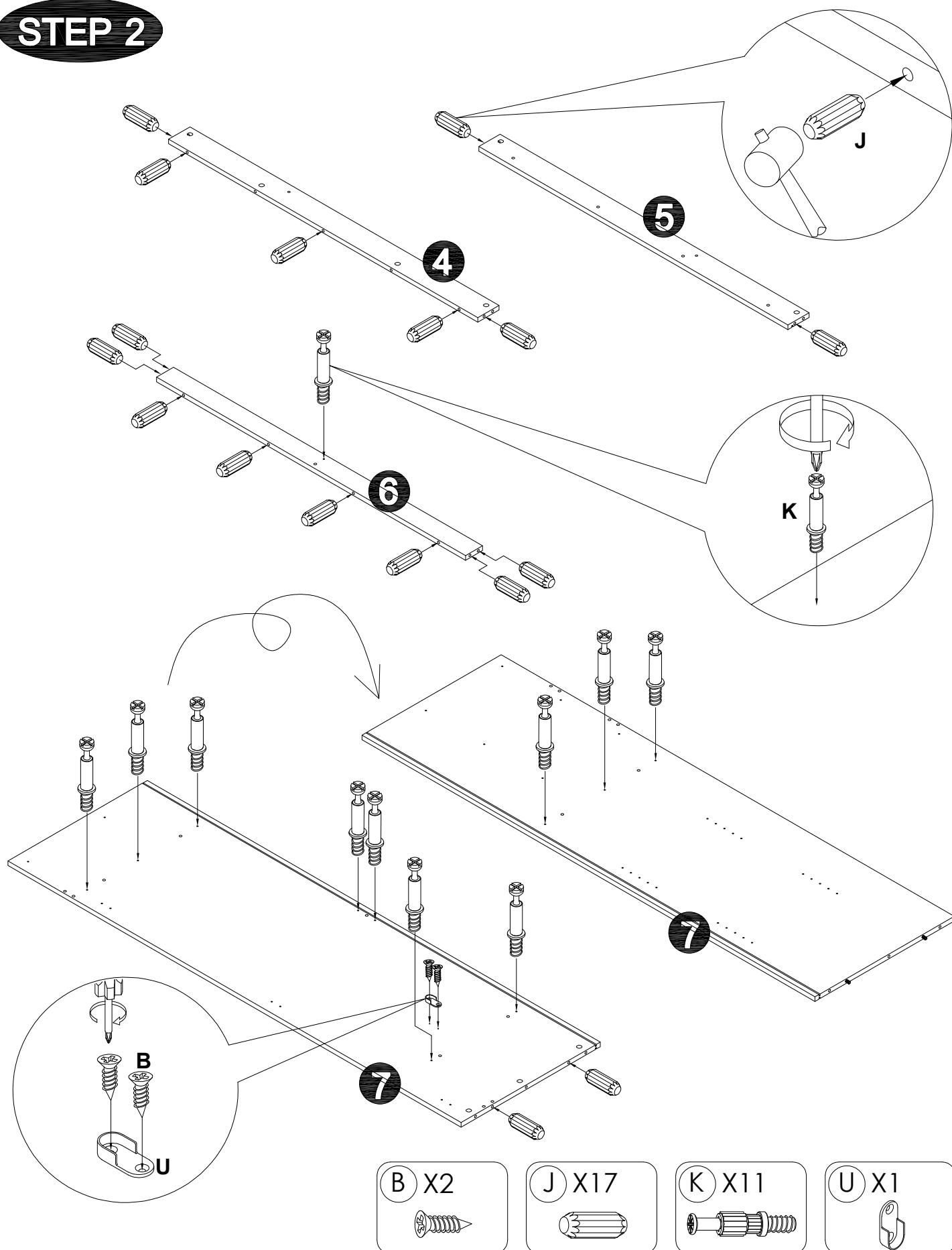

ASSEMBLY INSTRUCTION

DESCRIPTION:

6197

ALLIONA 2 DOOR 4 DRAWER WARDROBE

STEP 3

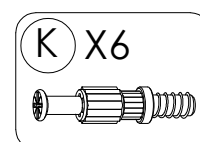
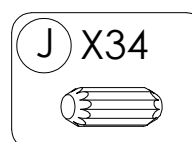
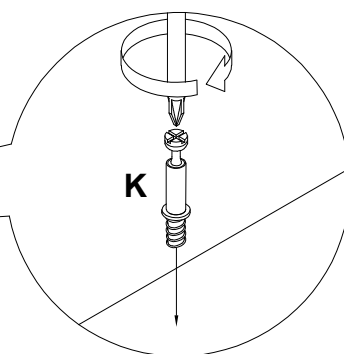
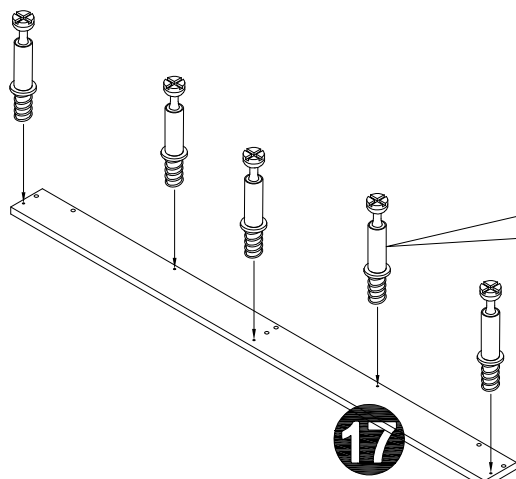
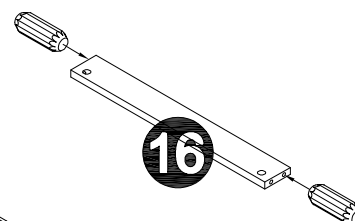
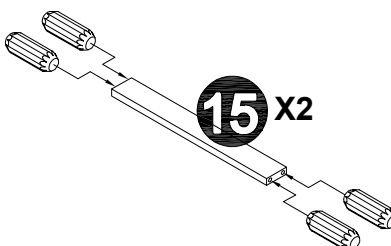
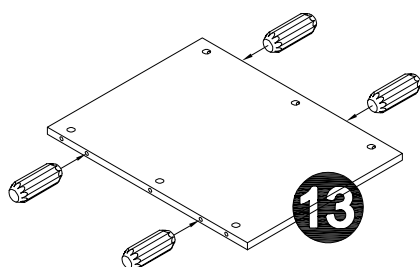
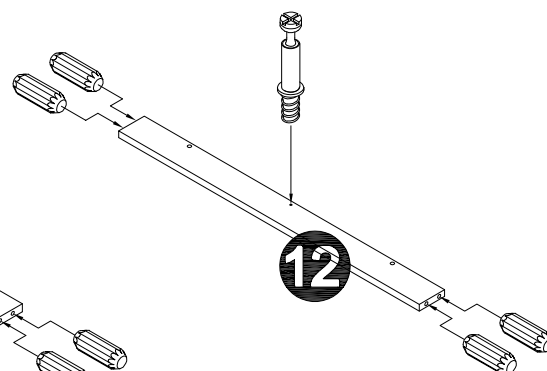
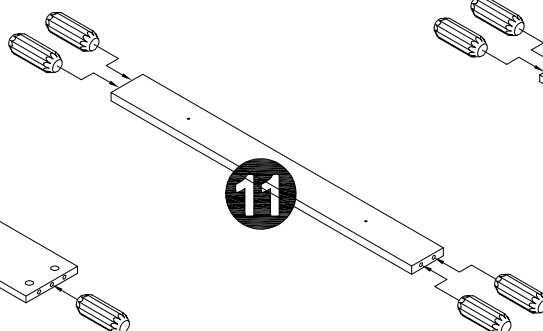
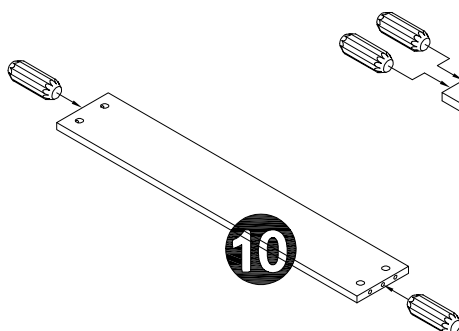
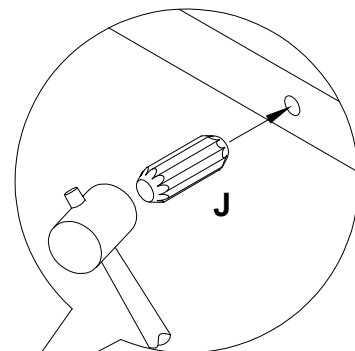
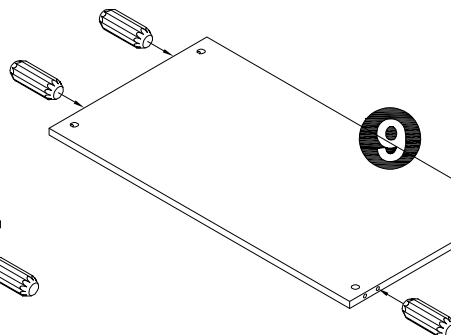
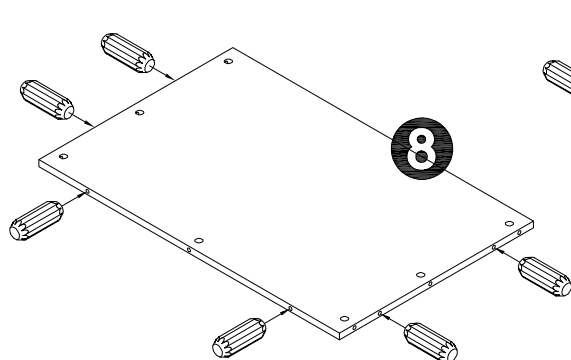

ASSEMBLY INSTRUCTION

DESCRIPTION:

6197

ALLIONA 2 DOOR 4 DRAWER WARDROBE

STEP 4

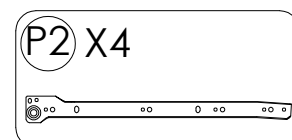
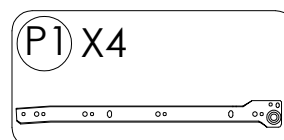
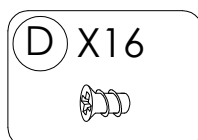
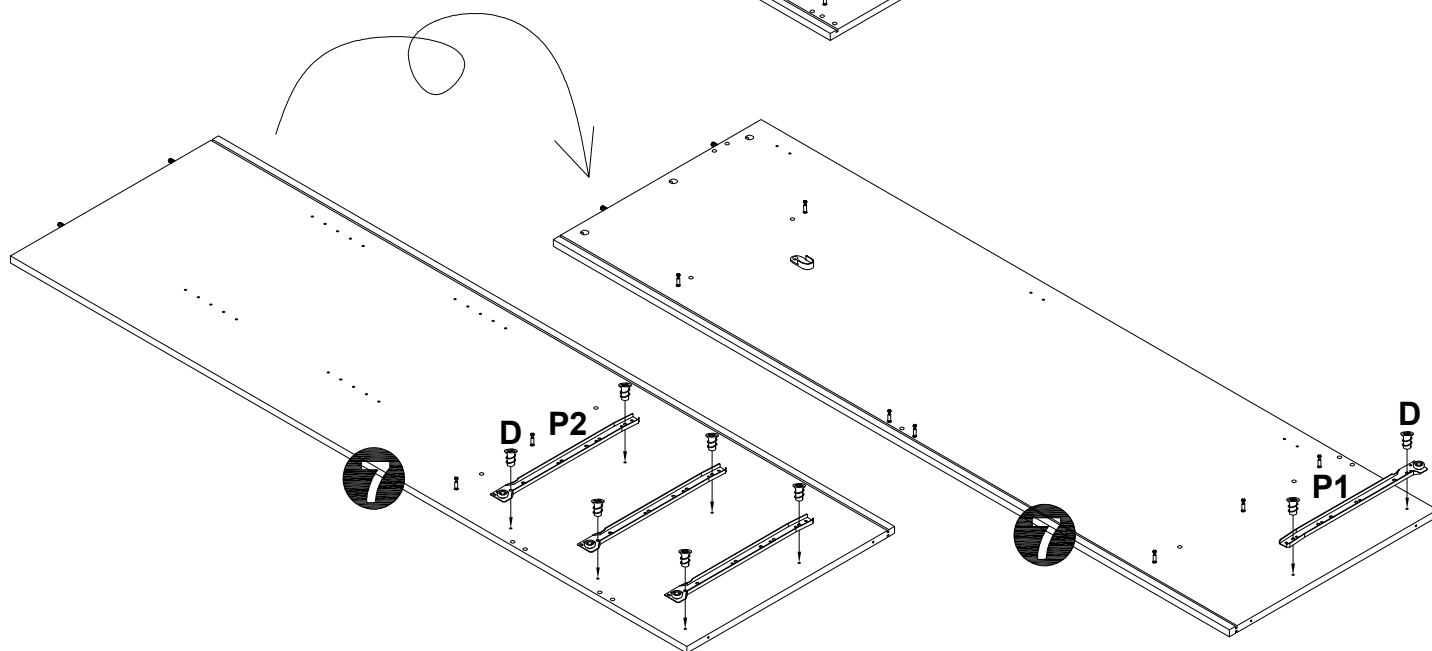
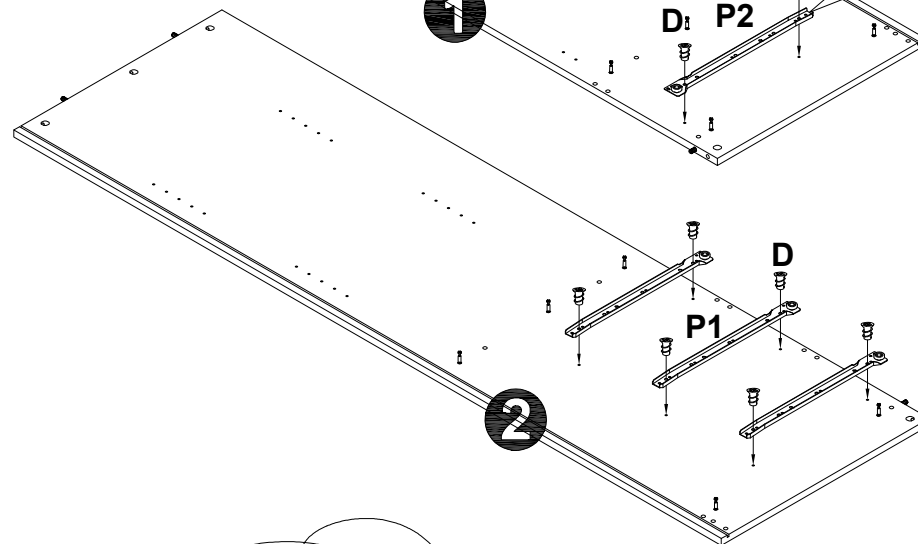
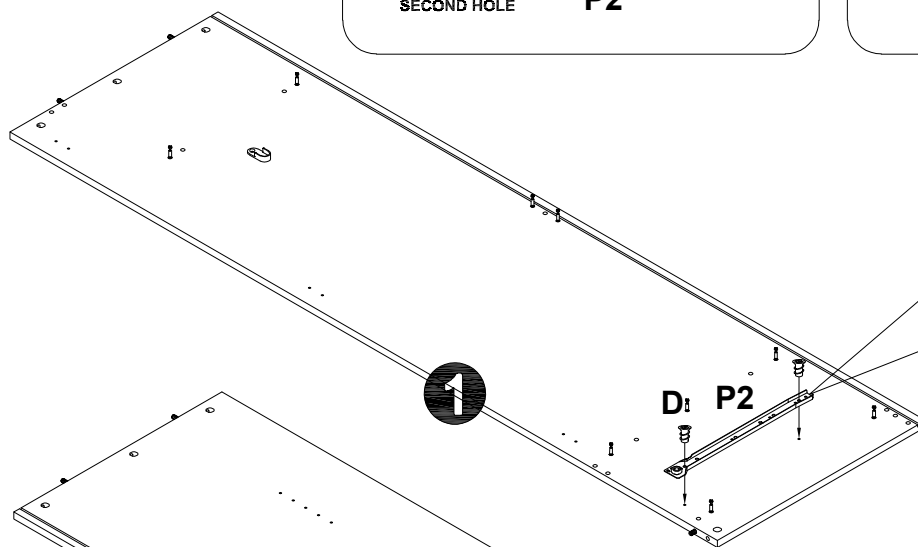
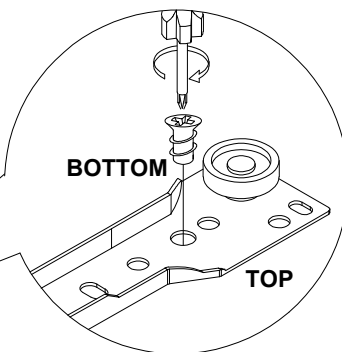
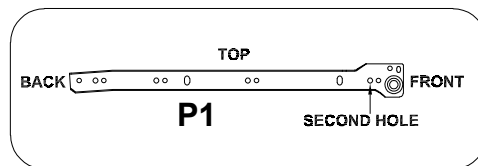
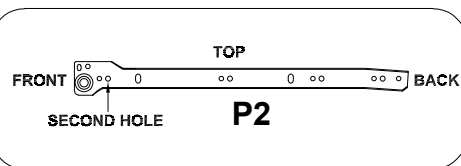

ASSEMBLY INSTRUCTION

DESCRIPTION:

6197

ALLIONA 2 DOOR 4 DRAWER WARDROBE

STEP 5

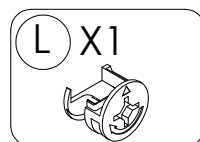
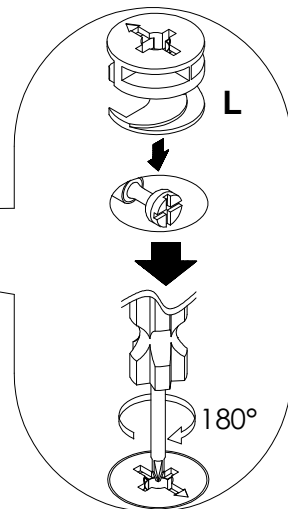
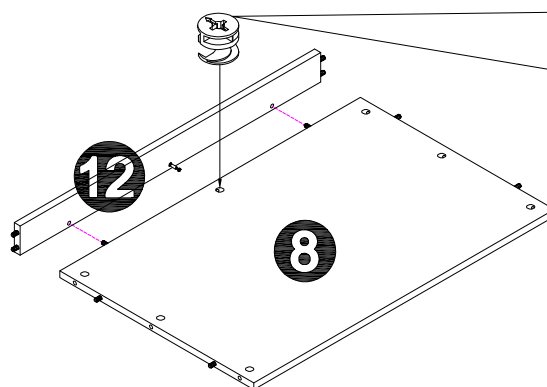

STEP 6

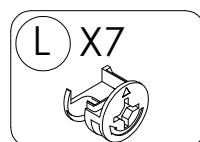
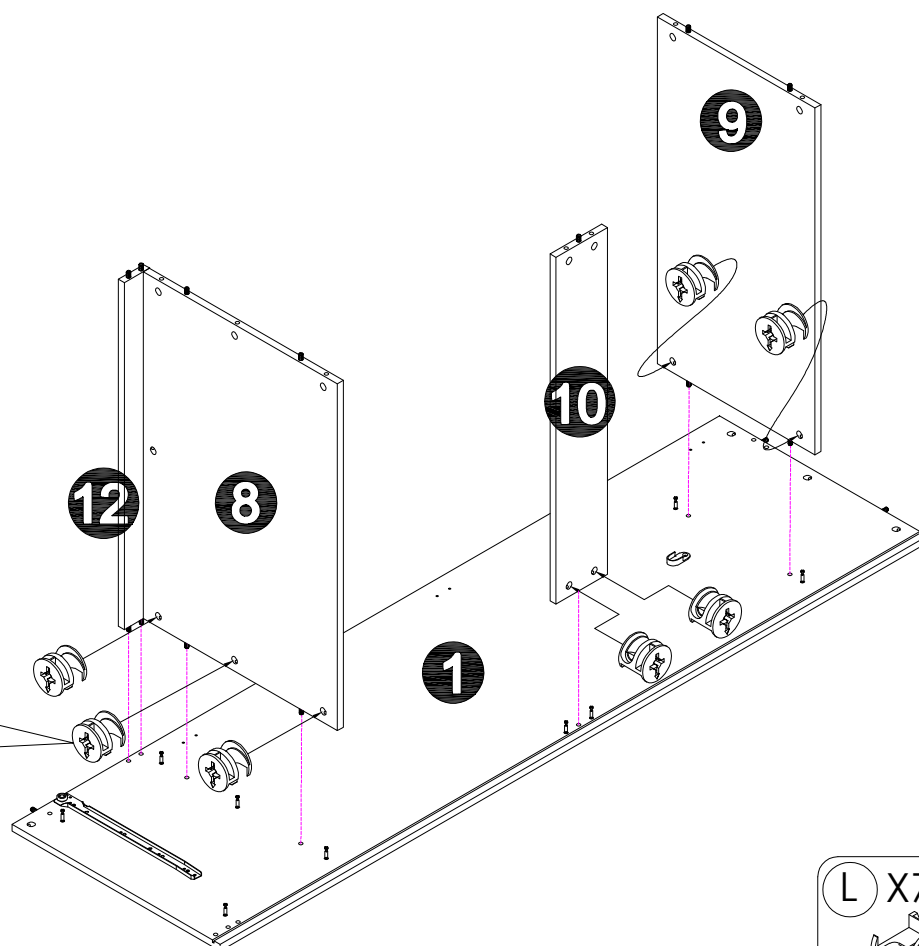
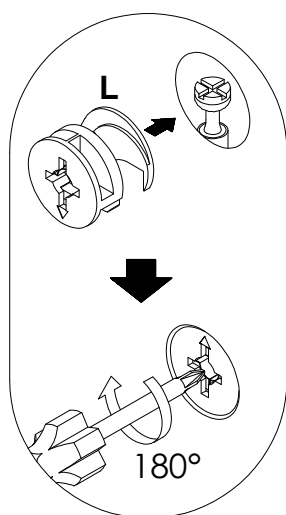

ASSEMBLY INSTRUCTION

DESCRIPTION:

6197

ALLIONA 2 DOOR 4 DRAWER WARDROBE

STEP 7

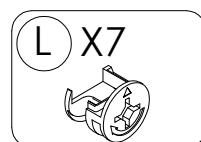
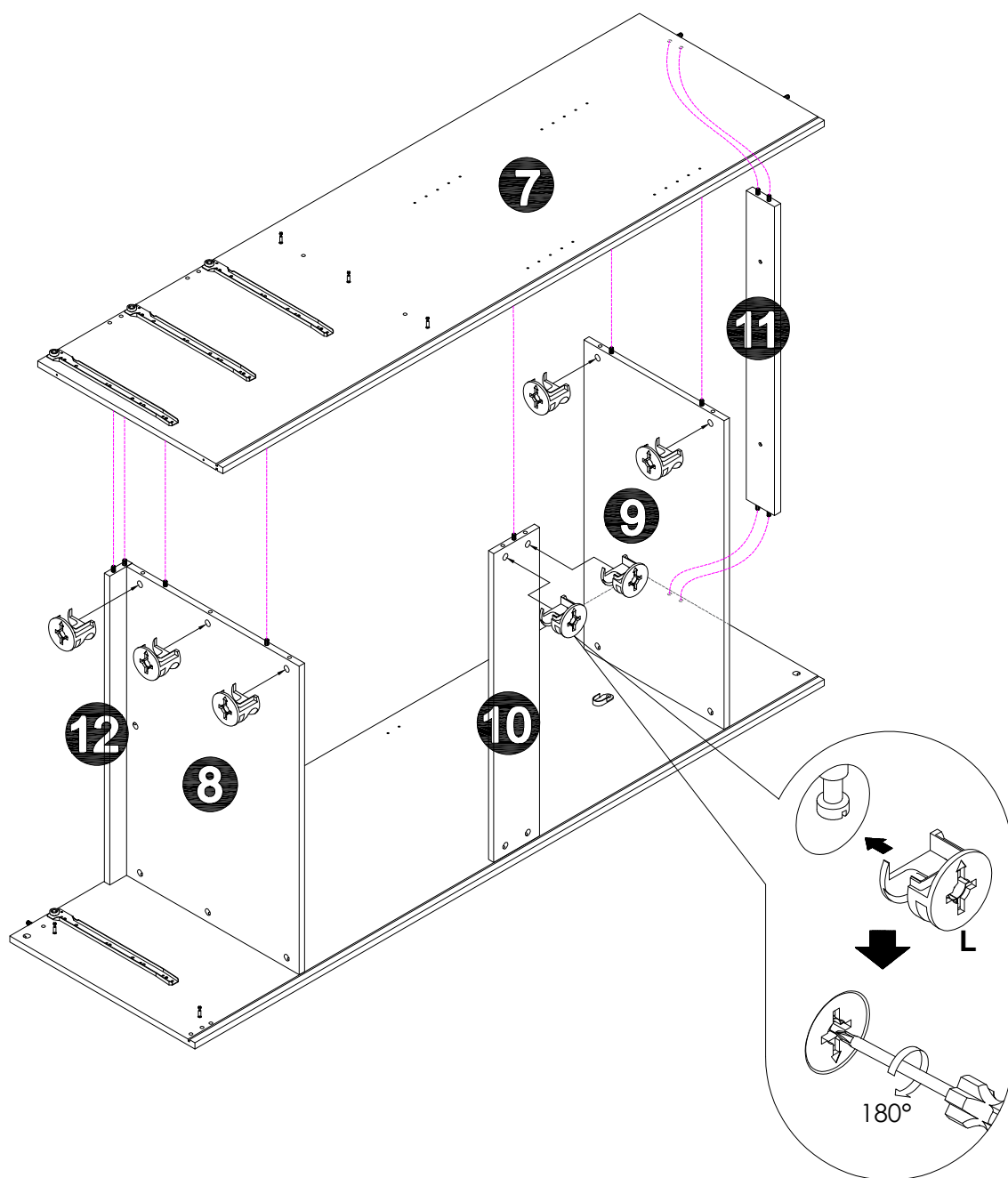

ASSEMBLY INSTRUCTION

DESCRIPTION:

6197

ALLIONA 2 DOOR 4 DRAWER WARDROBE

STEP 8

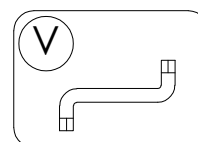
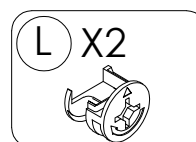
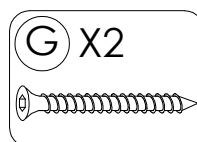
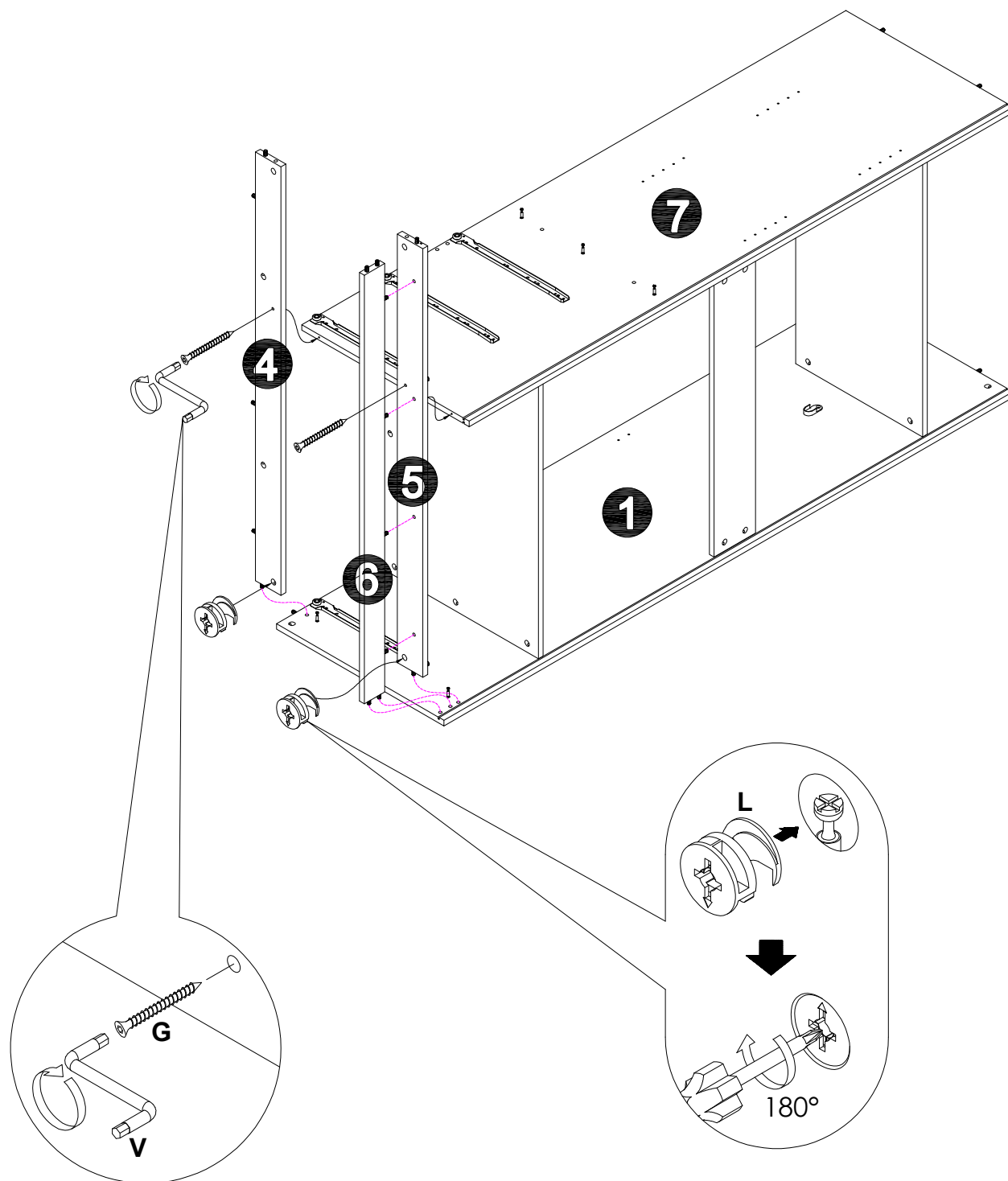

ASSEMBLY INSTRUCTION

DESCRIPTION:

6197

ALLIONA 2 DOOR 4 DRAWER WARDROBE

STEP 9

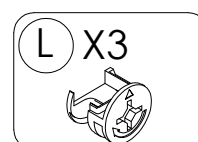
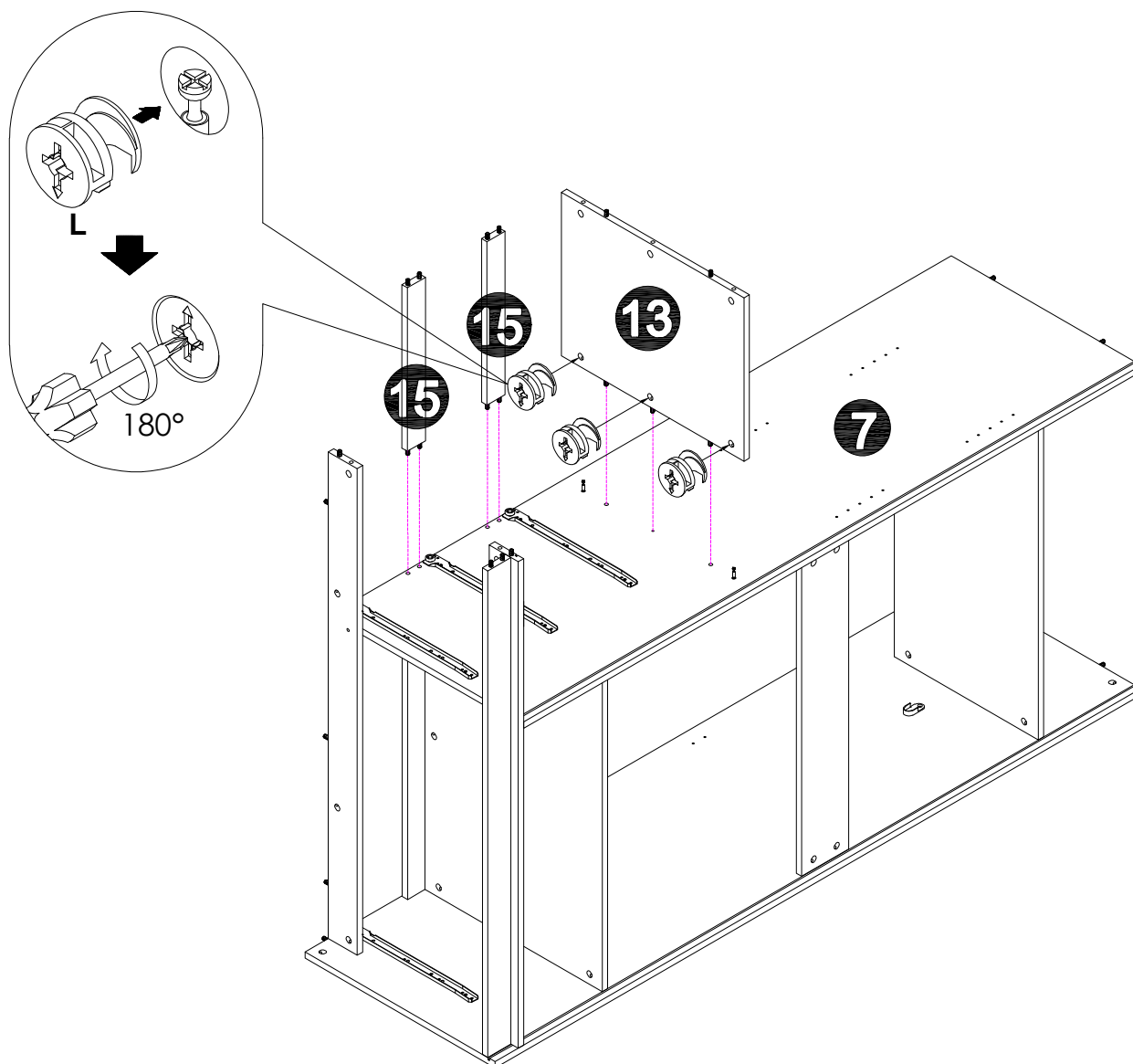

ASSEMBLY INSTRUCTION

DESCRIPTION:

6197

ALLIONA 2 DOOR 4 DRAWER WARDROBE

STEP 10

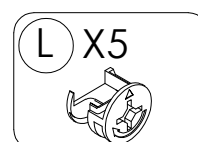
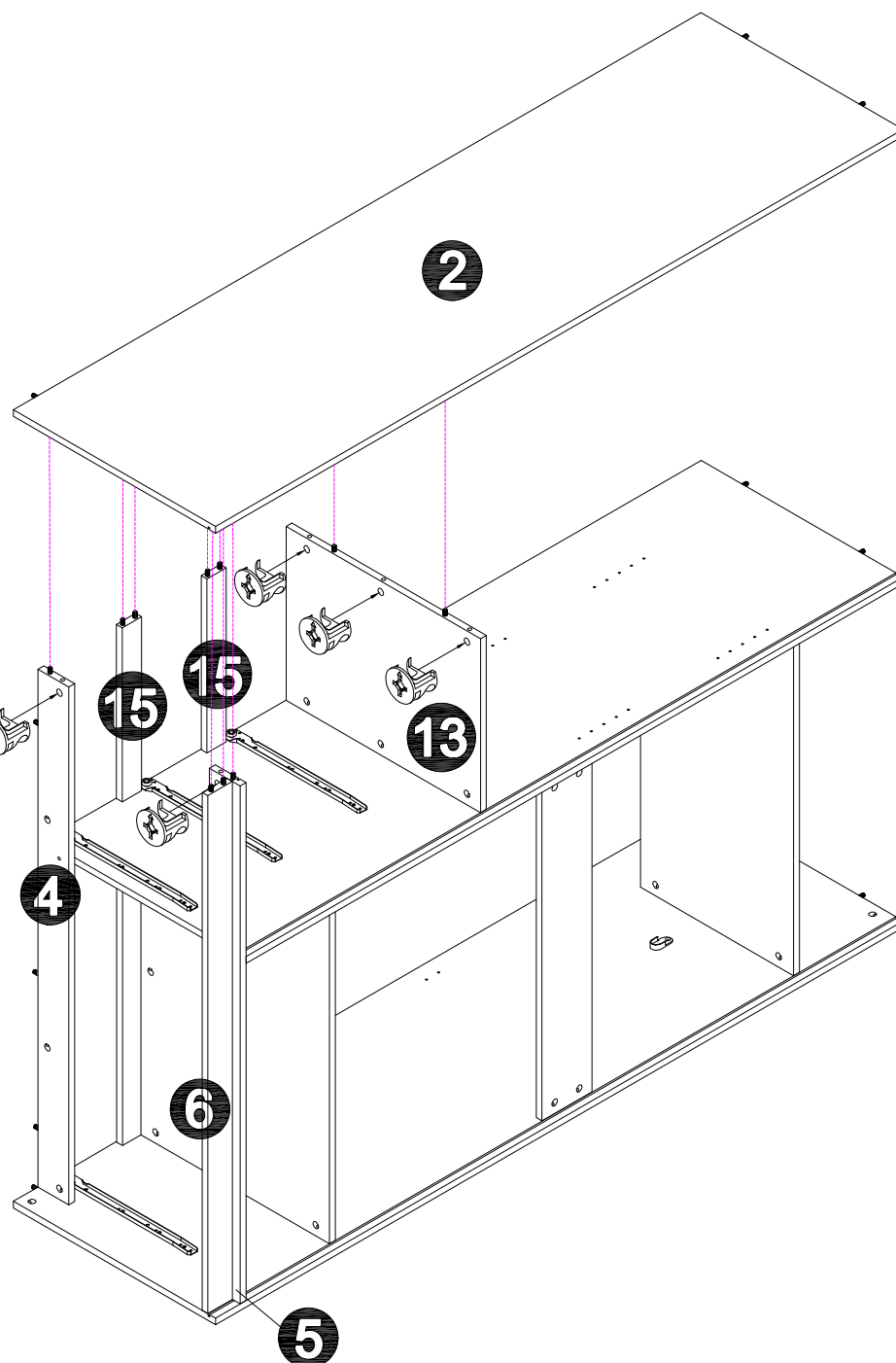
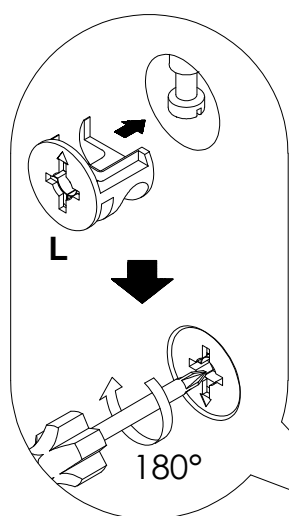

ASSEMBLY INSTRUCTION

DESCRIPTION:

6197

ALLIONA 2 DOOR 4 DRAWER WARDROBE

STEP 11

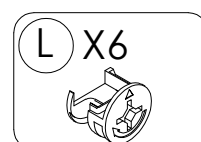
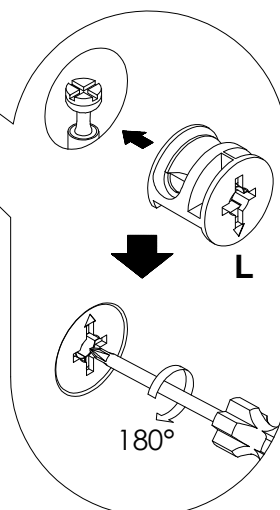
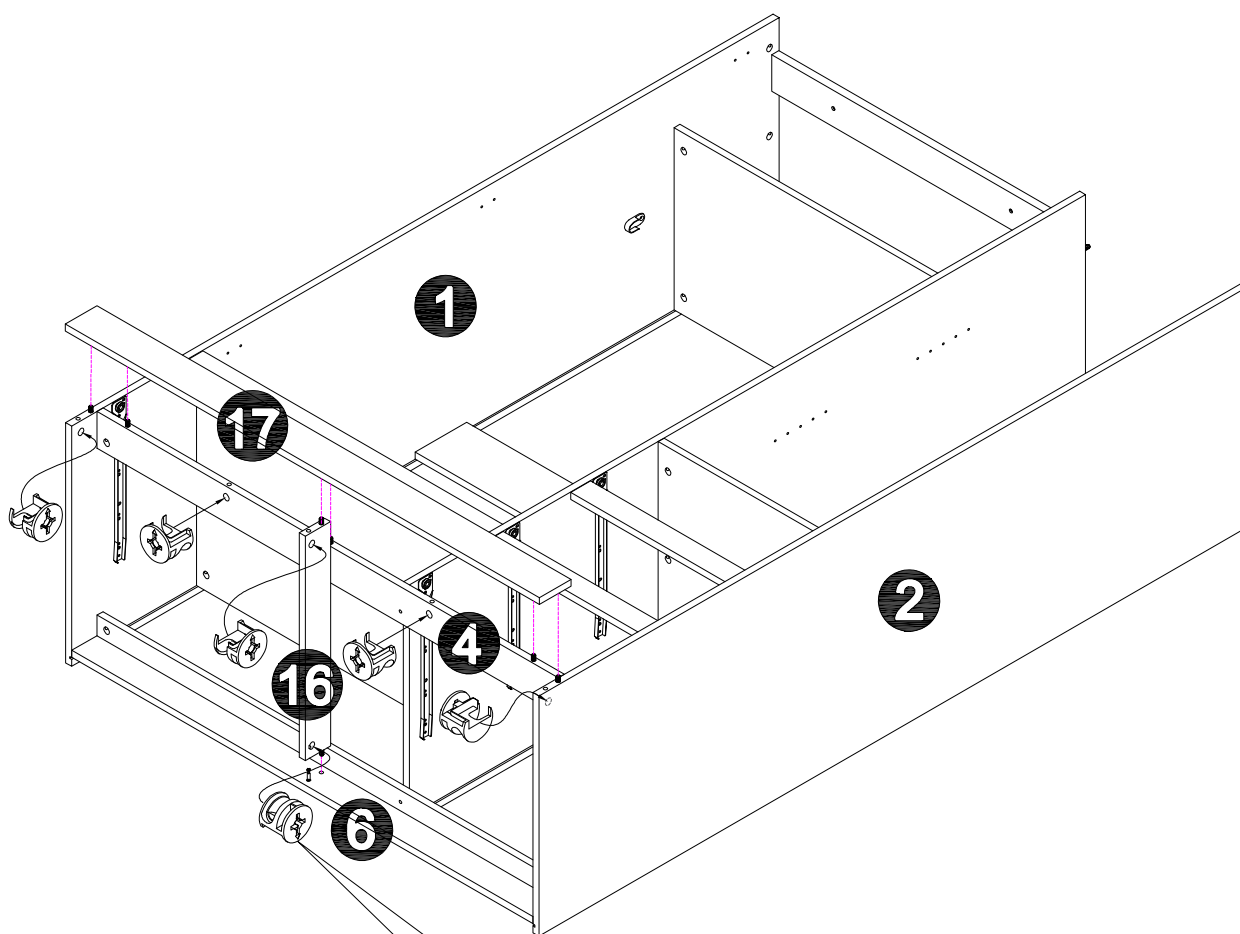

ASSEMBLY INSTRUCTION

DESCRIPTION:

6197

ALLIONA 2 DOOR 4 DRAWER WARDROBE

STEP 12

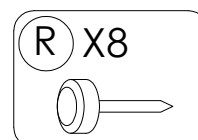
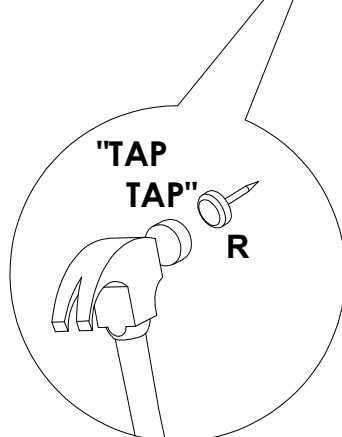
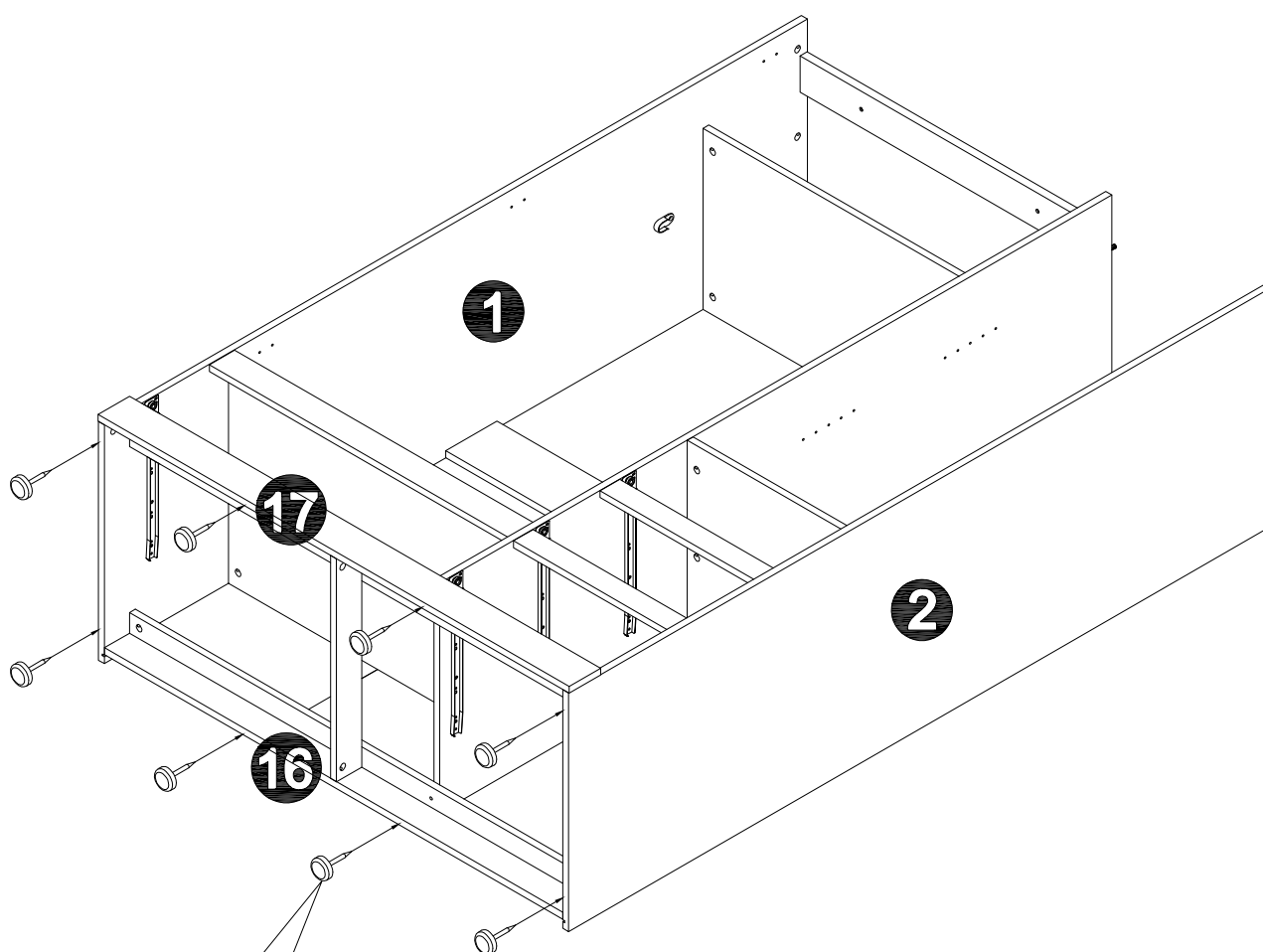

ASSEMBLY INSTRUCTION

DESCRIPTION:

6197

ALLIONA 2 DOOR 4 DRAWER WARDROBE

STEP 13

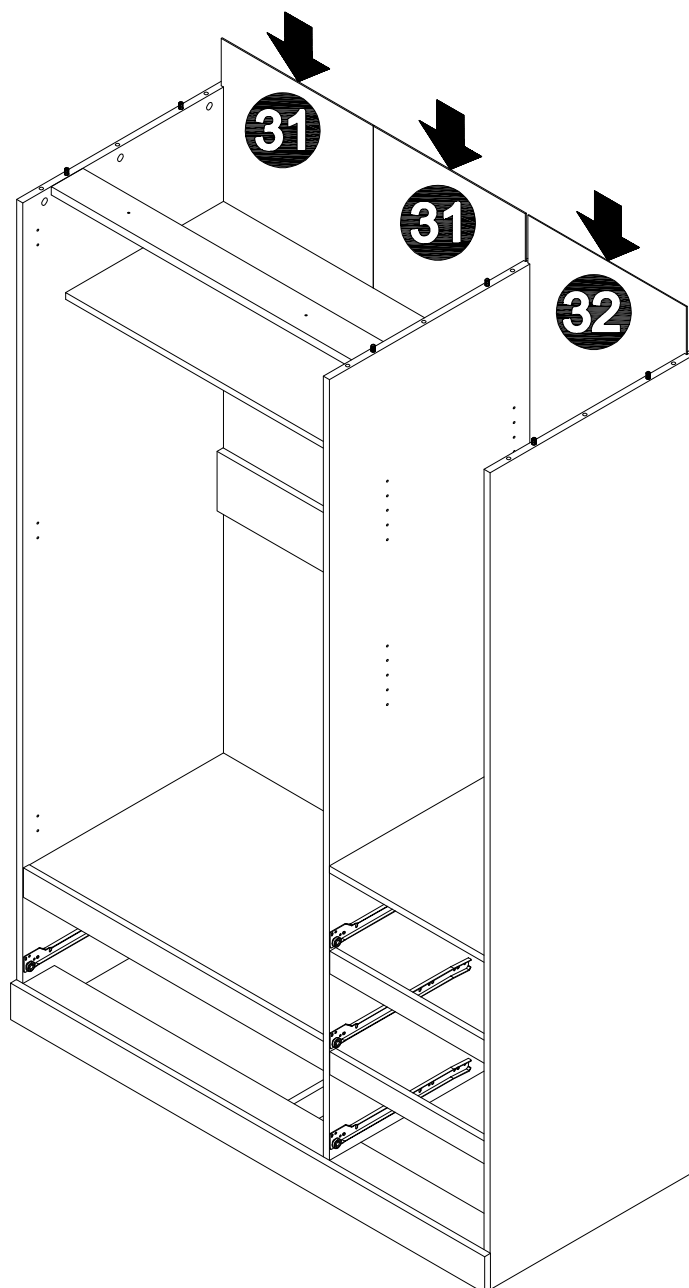

ASSEMBLY INSTRUCTION

DESCRIPTION:

6197

ALLIONA 2 DOOR 4 DRAWER WARDROBE

STEP 14

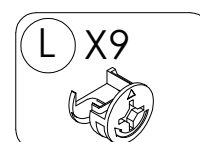
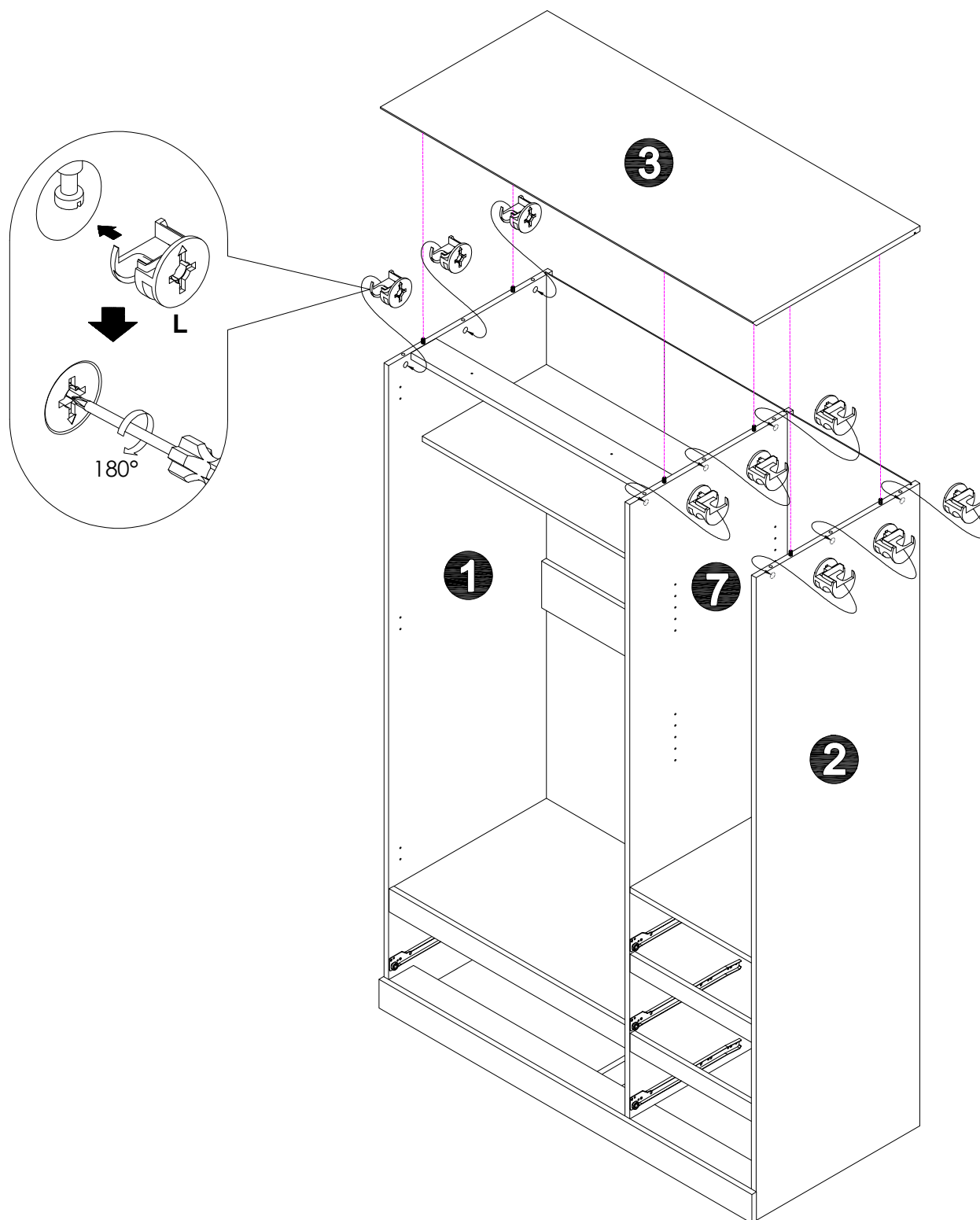

ASSEMBLY INSTRUCTION

DESCRIPTION:

6197

ALLIONA 2 DOOR 4 DRAWER WARDROBE

STEP 15

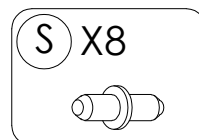
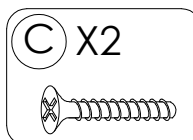
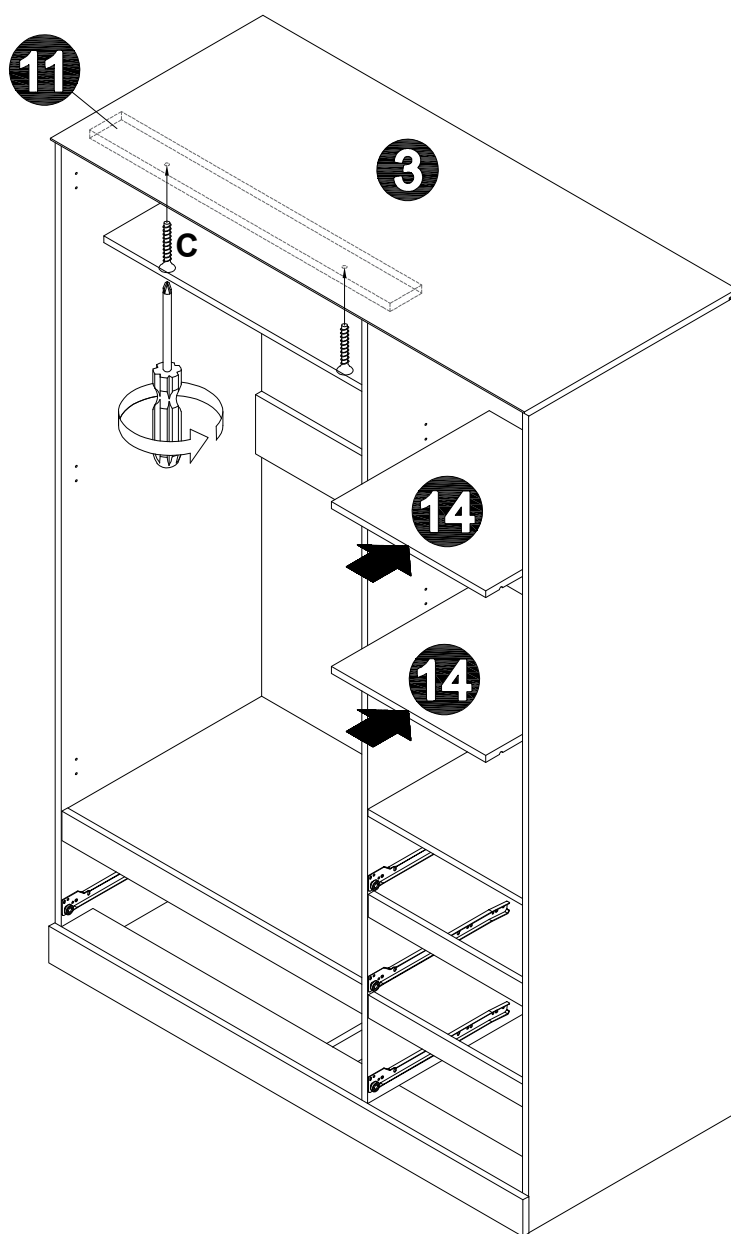
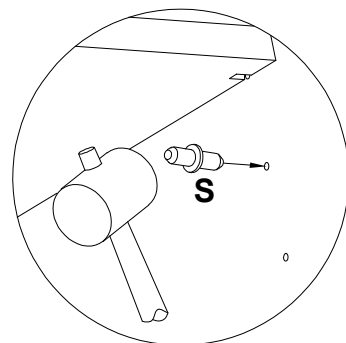

ASSEMBLY INSTRUCTION

DESCRIPTION:

6197

ALLIONA 2 DOOR 4 DRAWER WARDROBE

STEP 16

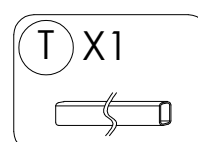
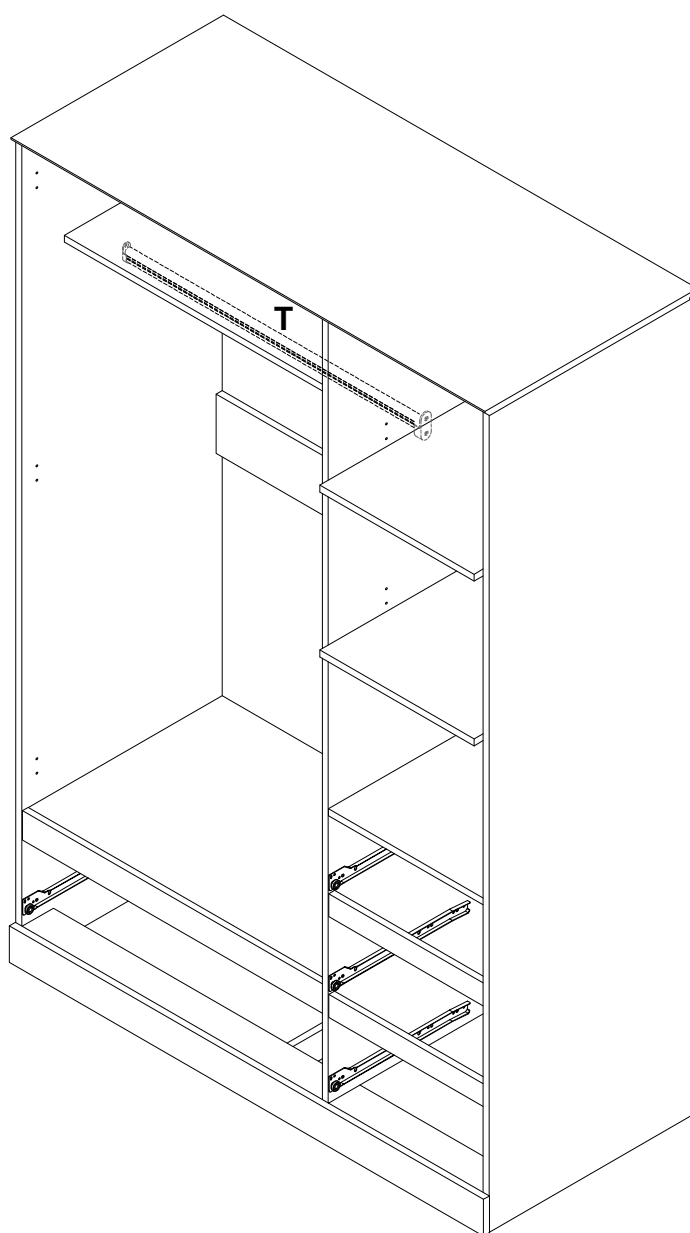
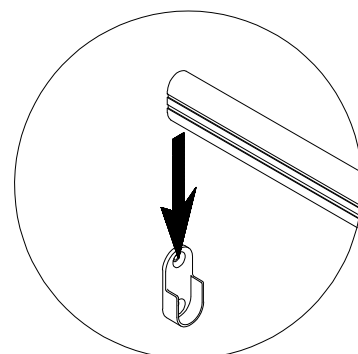

ASSEMBLY INSTRUCTION

DESCRIPTION:

6197

ALLIONA 2 DOOR 4 DRAWER WARDROBE

STEP 17

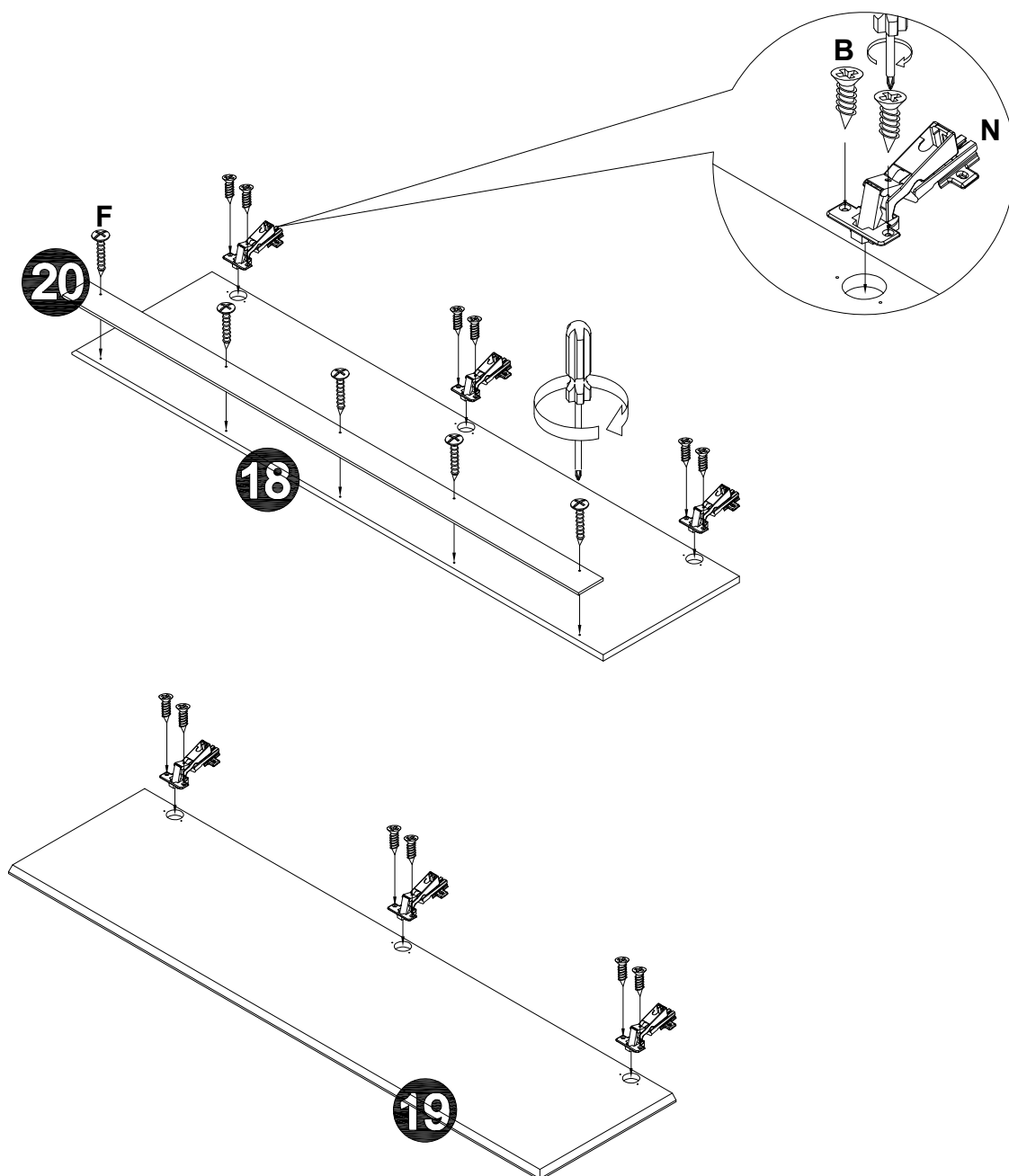

B X12



F X5



N X6



ASSEMBLY INSTRUCTION

DESCRIPTION:

6197

ALLIONA 2 DOOR 4 DRAWER WARDROBE

STEP 18

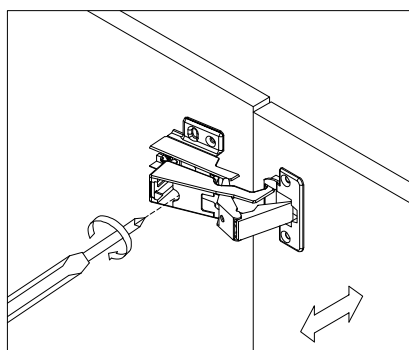
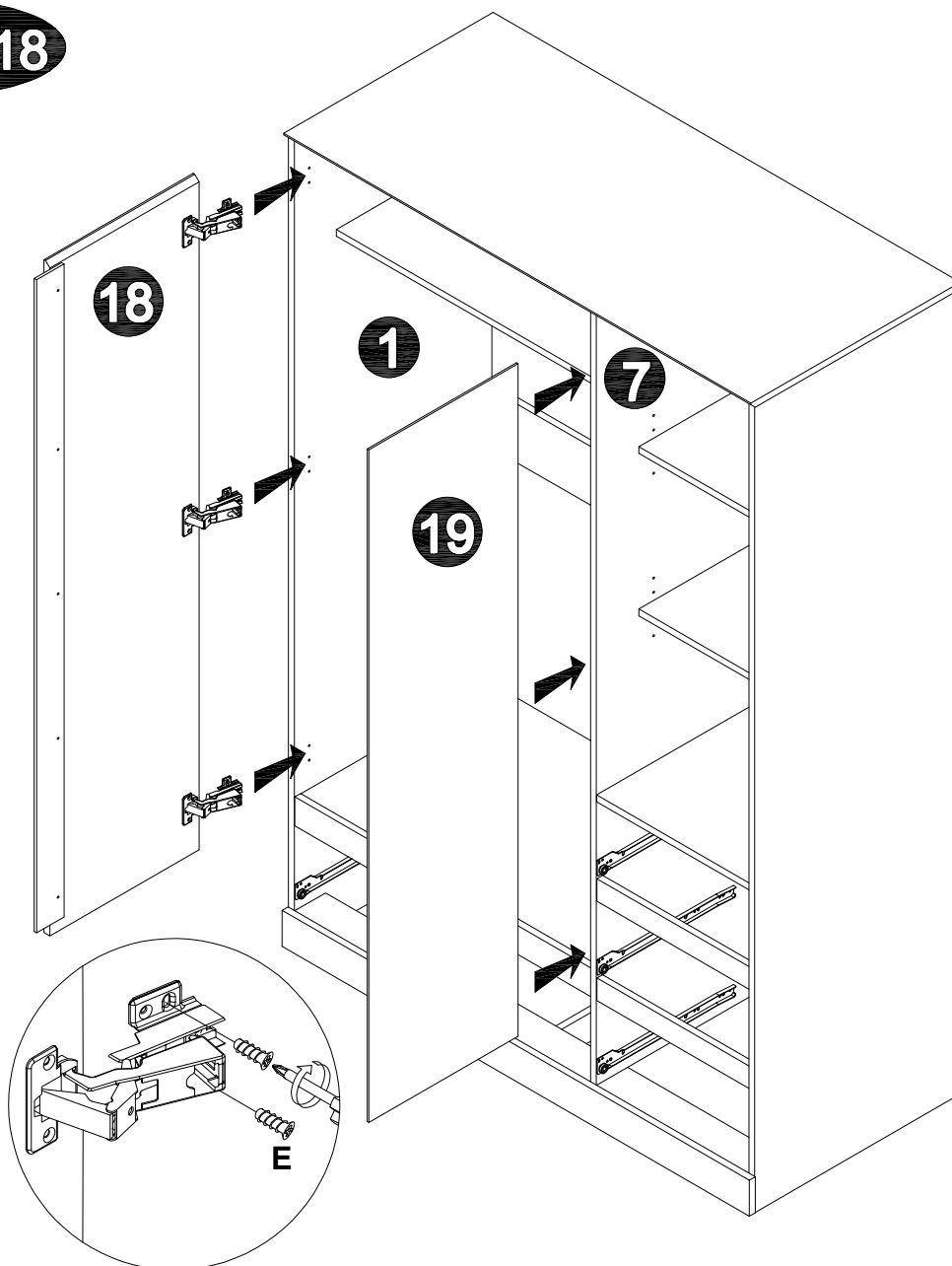

A. Lateral adjustment
by screw adjusting

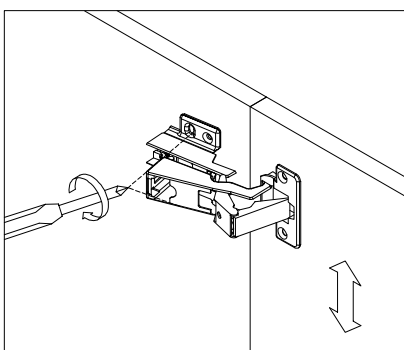

B. Vertical adjustment via
slot in the mounting plate

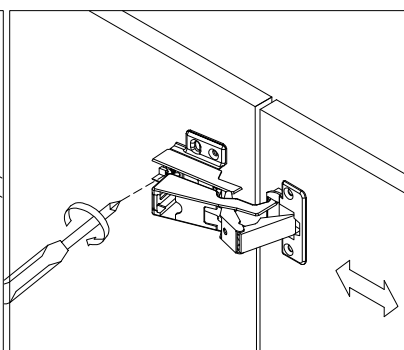

C. Front-to-Back by the slacking
the hinge arm mounting screw

E X12



ASSEMBLY INSTRUCTION

DESCRIPTION:

6197

ALLIONA 2 DOOR 4 DRAWER WARDROBE

STEP 19

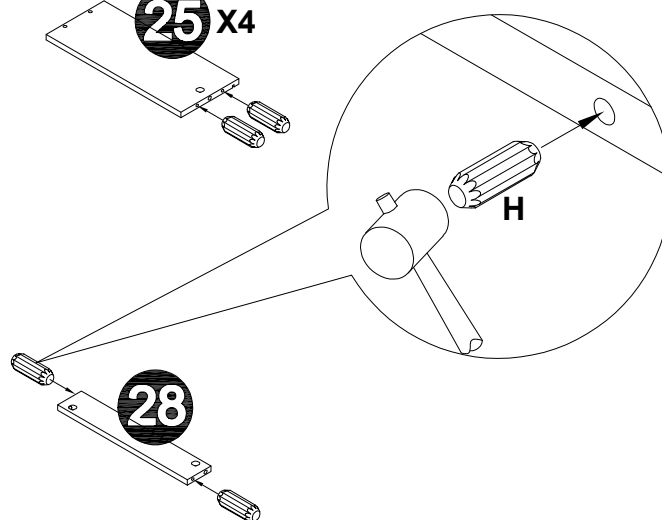
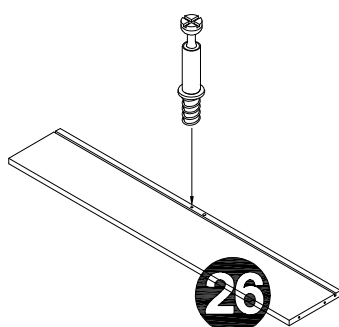
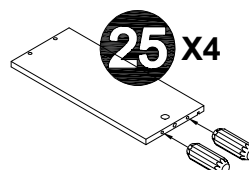
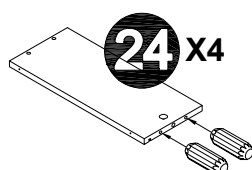
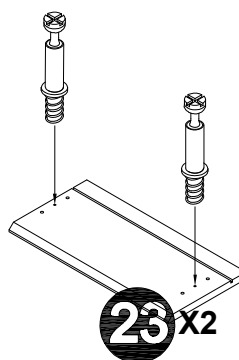
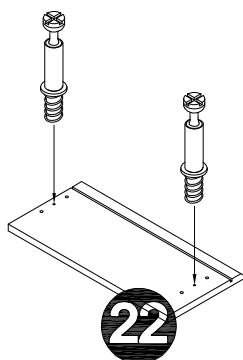
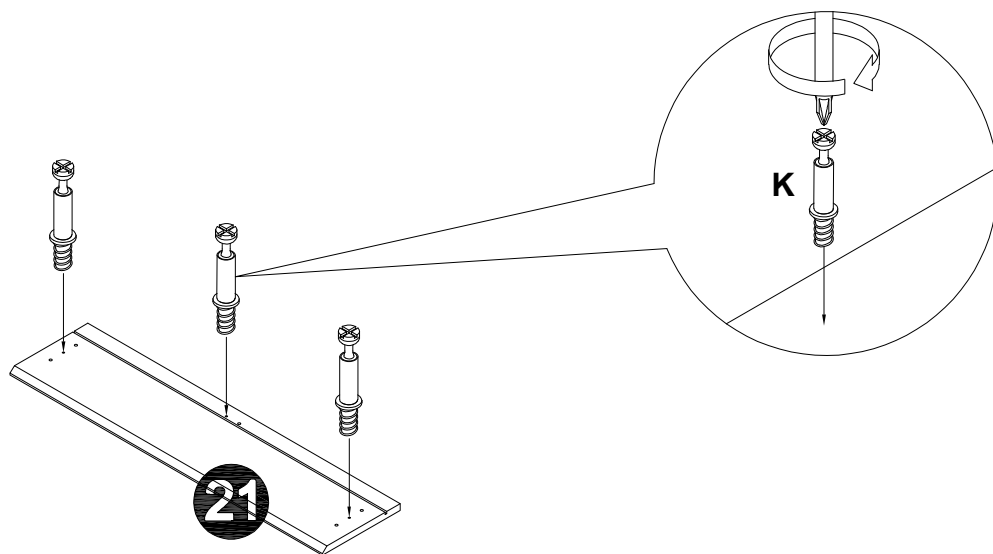

H X18



K X10



ASSEMBLY INSTRUCTION

DESCRIPTION:

6197

ALLIONA 2 DOOR 4 DRAWER WARDROBE

STEP 20

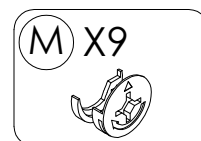
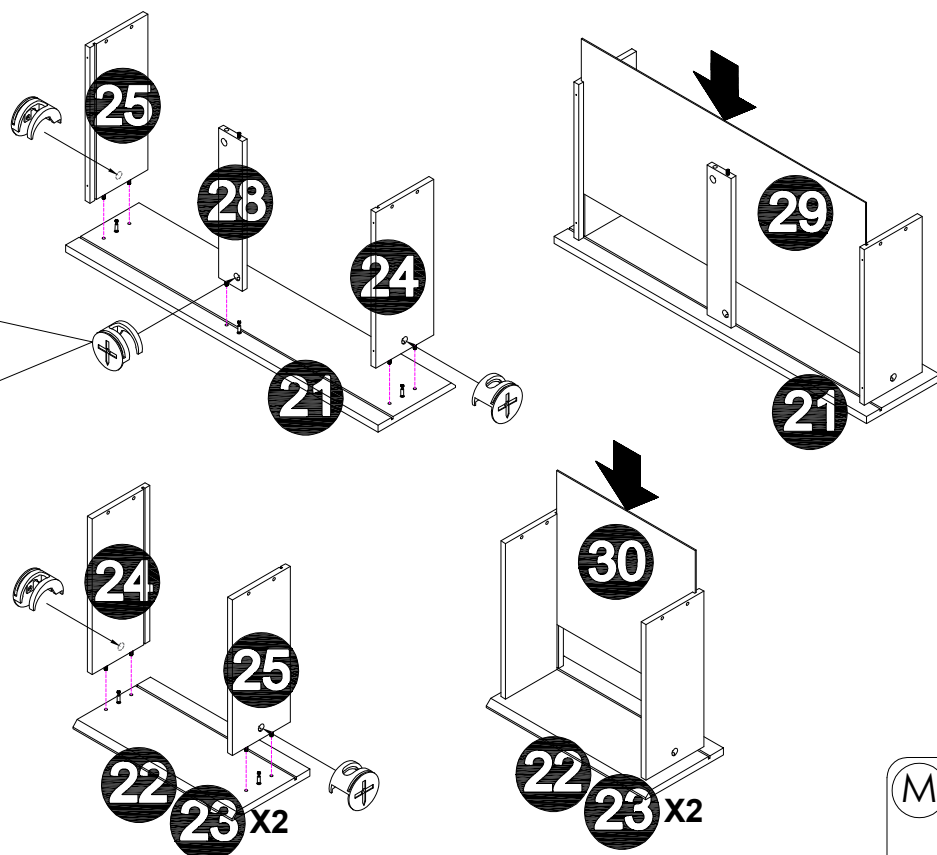
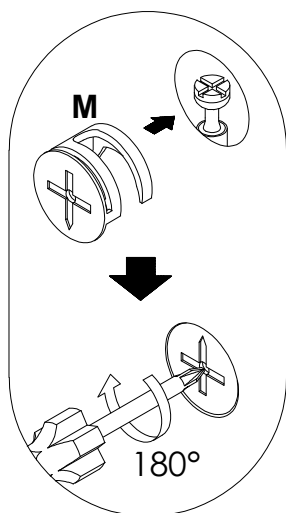

STEP 21

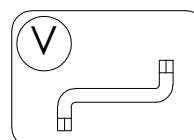
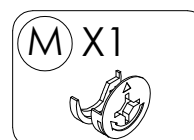
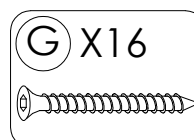
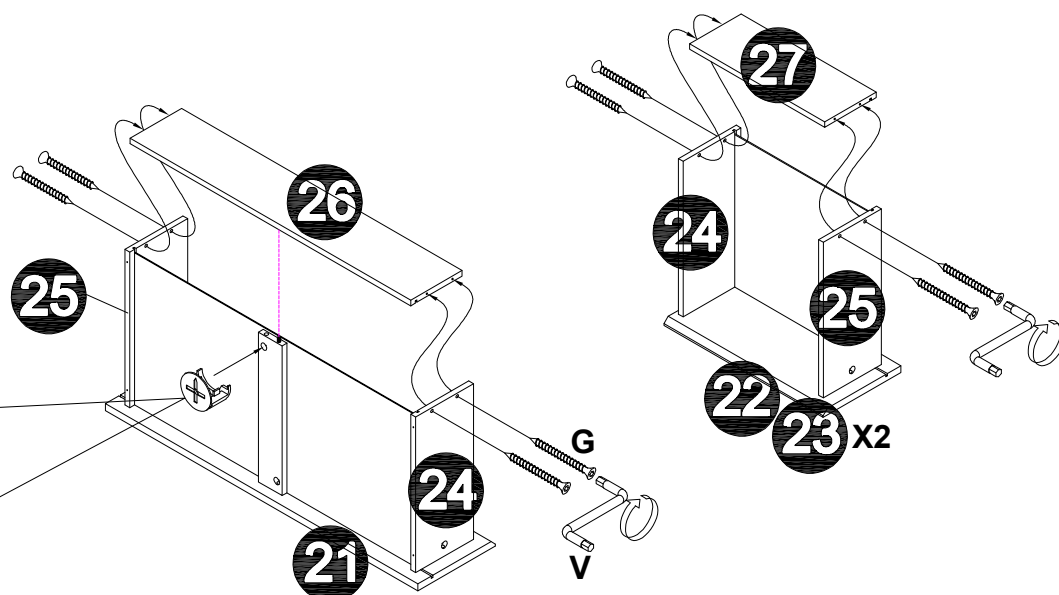
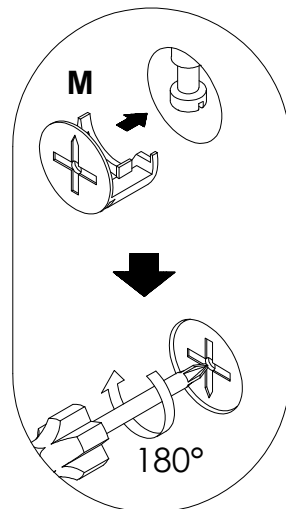

ASSEMBLY INSTRUCTION

DESCRIPTION:

6197

ALLIONA 2 DOOR 4 DRAWER WARDROBE

STEP 22

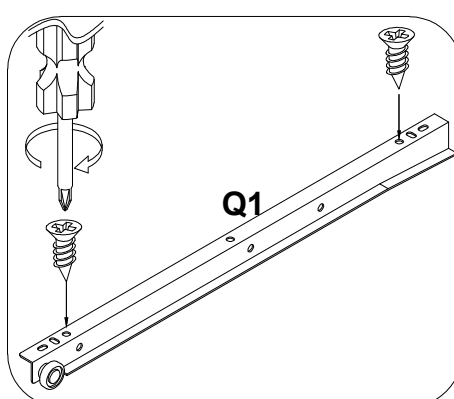
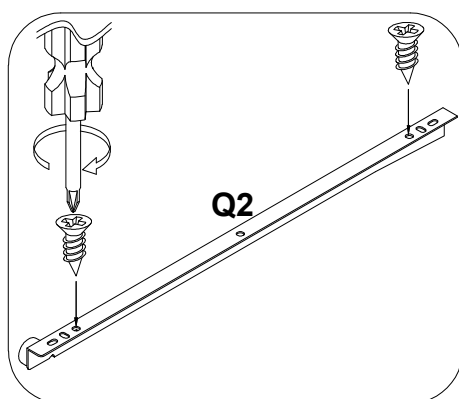
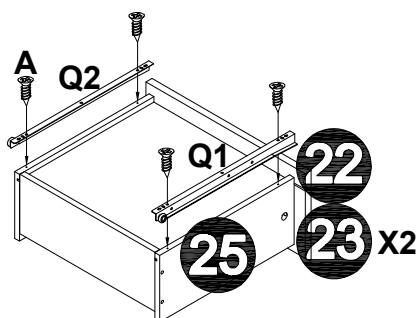
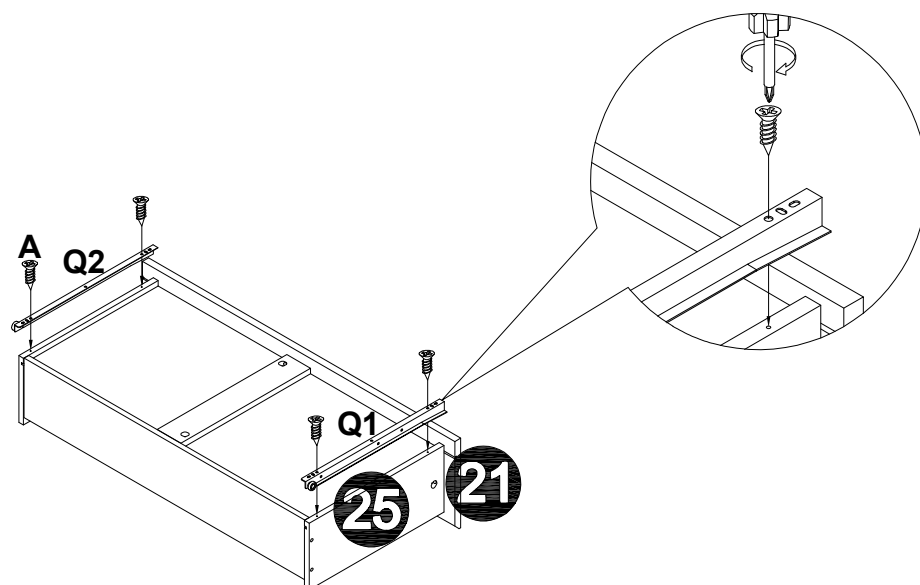

A X16



Q1 X4

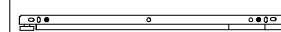

Q2 X4

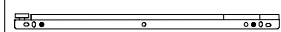

ASSEMBLY INSTRUCTION

DESCRIPTION:

6197

ALLIONA 2 DOOR 4 DRAWER WARDROBE

STEP 23

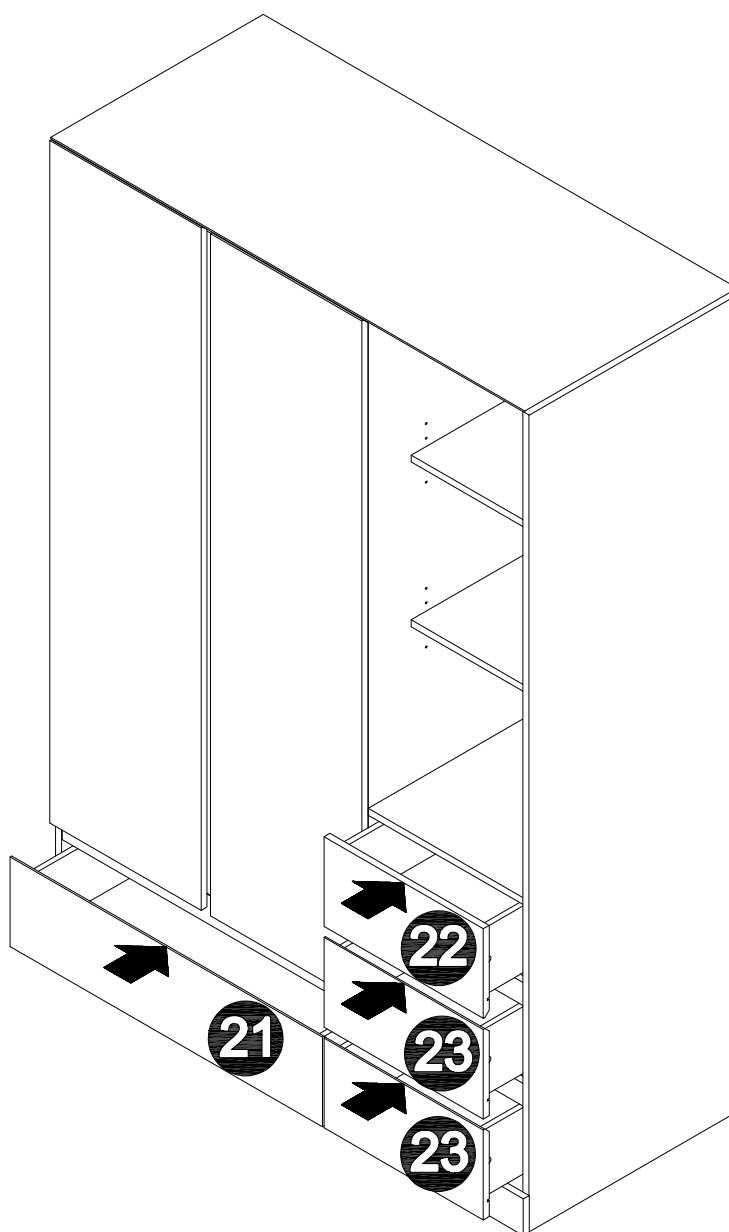

ASSEMBLY INSTRUCTION

DESCRIPTION:

6197

ALLIONA 2 DOOR 4 DRAWER WARDROBE

STEP 24

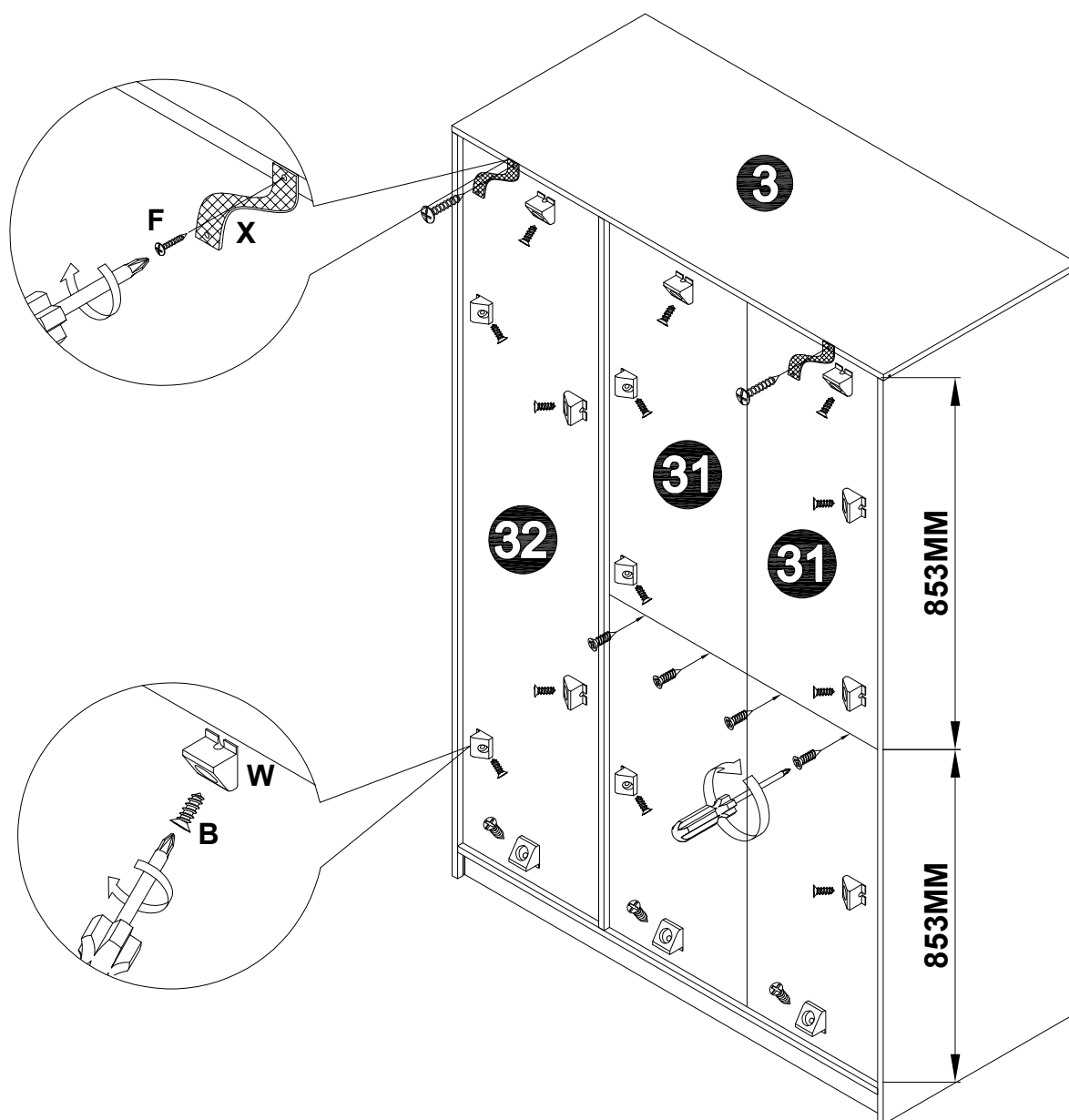

B X20



F X2

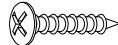

W X16



X X2



ASSEMBLY INSTRUCTION

DESCRIPTION:

6197

ALLIONA 2 DOOR 4 DRAWER WARDROBE

STEP 25

WALL

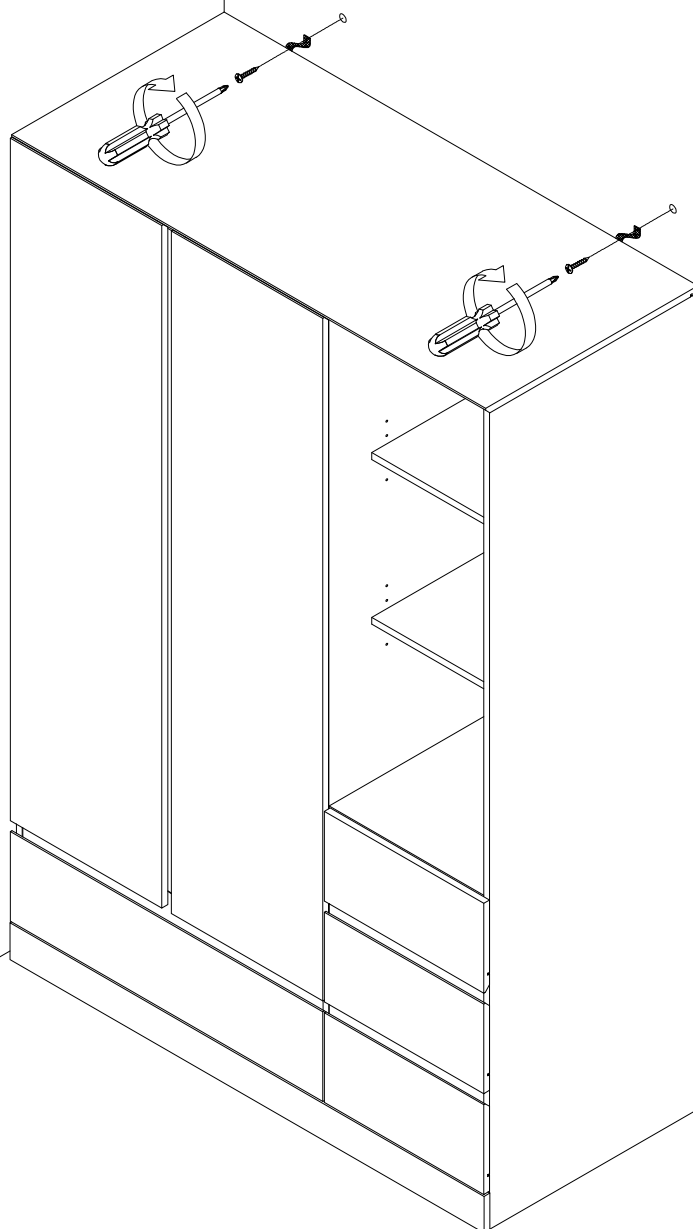

NOTE :
WALL PLUG & SCREW ARE
NOT SUPPLIED WITH THIS
PRODUCT AS DIFFERENT WALL
MATERIALS REQUIRE DIFFERENT
TYPES OF FIXING HARDWARE &
YOU MUST USE SUITABLE FIXING
HARDWARE FOR TYPE OF WALL
YOU INTEND TO MOUNT THIS
PRODUCT TO WALL.

ASSEMBLY IS COMPELETE

Different wall materials require different types of fixing devices. Use fixing devices suitable for the walls in your home, sold separately. Please seek professional advice if you are in doubt of what fixing should be use..

! WARNING



Children have died from furniture tipover.

- ALWAYS secure it with an anchor device.
- NEVER allow children to stand, climb or hang on drawers, or shelves.
- NEVER open more than one drawer at a time.
- Place heavy items down low.

NEVER put a TV on this furniture



This is a permanent label. Do not remove!

WARNING, PLEASE READ TO Reduce the risk to toppling furniture

- NEVER open more than one drawer at the time.
- NEVER allow children to stand, climb or hang on furniture. It may topple and cause serious injury or death.
- Do not place toys or other child appealing items on top of this furniture.
- ALWAYS anchor this product to a wall or other suitable surface. check anchors regularly.
- Place heavy items in lower drawers
- Use of anti toppling restraints may only reduce, but will not eliminate the risk to tip over.

NEVER put a TV on this product.
For more information please visit www.productsafety.gov.au

Screw and wall plugs are not provided, please use appropriate fixtures for your wall.

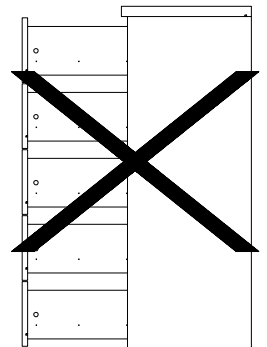

CAUTION :
PLEASE DO NOT FULLY OPEN
DRAWERS SIMULTANEOUSLY
AS IT WILL CAUSE THE DRAWER
CHEST TO FALL DOWN.