

# ASSEMBLY INSTRUCTION

## DESCRIPTION

1106

## CLIFTON SIDEBORD

1.5 hr

APPROXIMATE ASSEMBLY TIME

2 PERSON ASSEMBLY

FLOOR AREA  
2MX1.6M

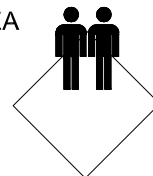
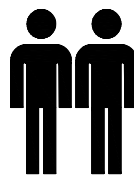

REQUIRED ASSEMBLY SPACE

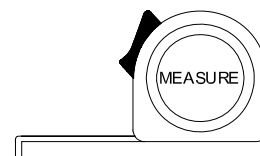
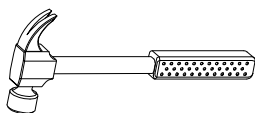

REQUIRED ASSEMBLY TOOLS

ASSEMBLED DIMENSIONS

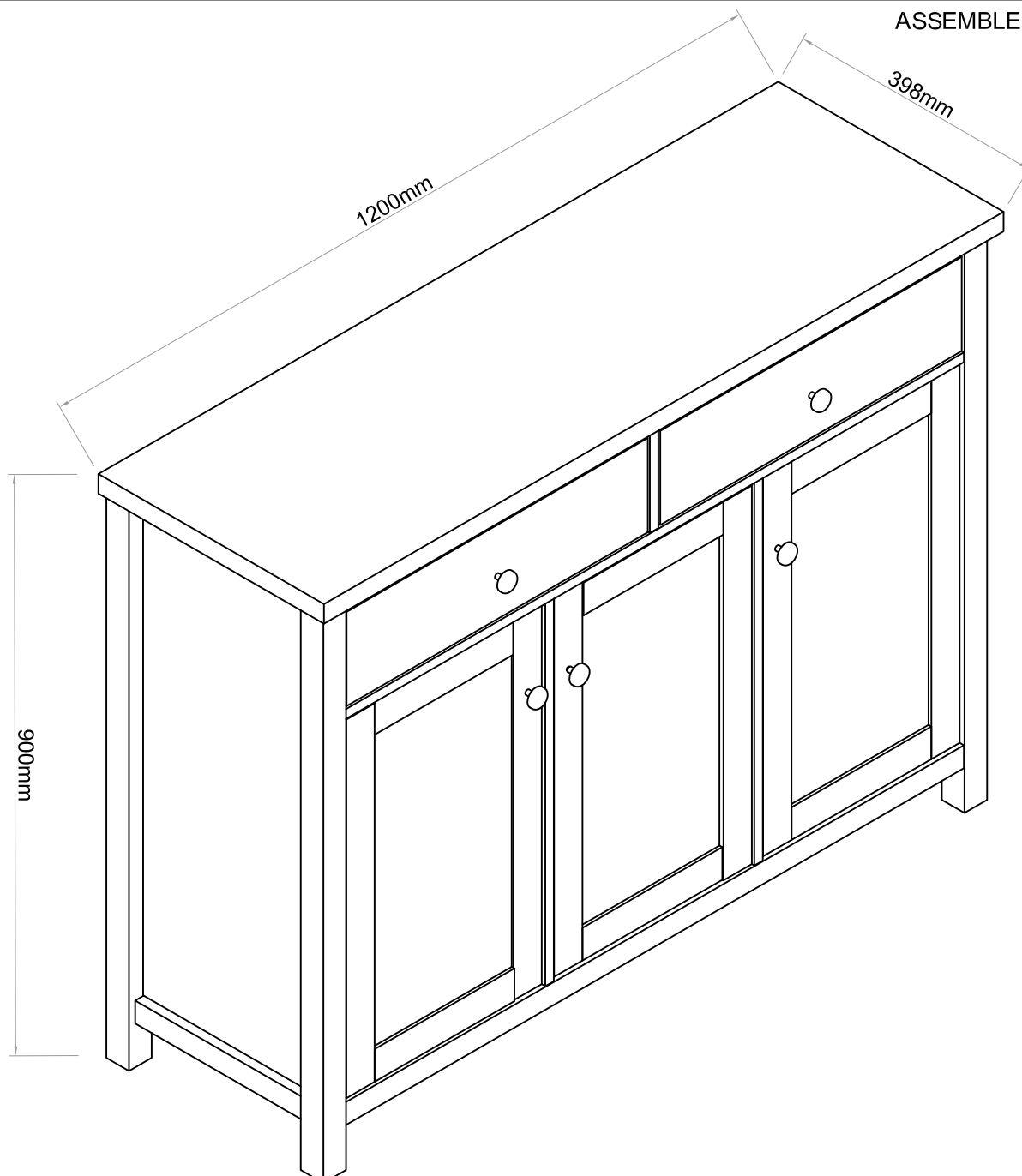

# ASSEMBLY INSTRUCTION

## DESCRIPTION

1106

## CLIFTON SIDEBORD

### PARTS LIST

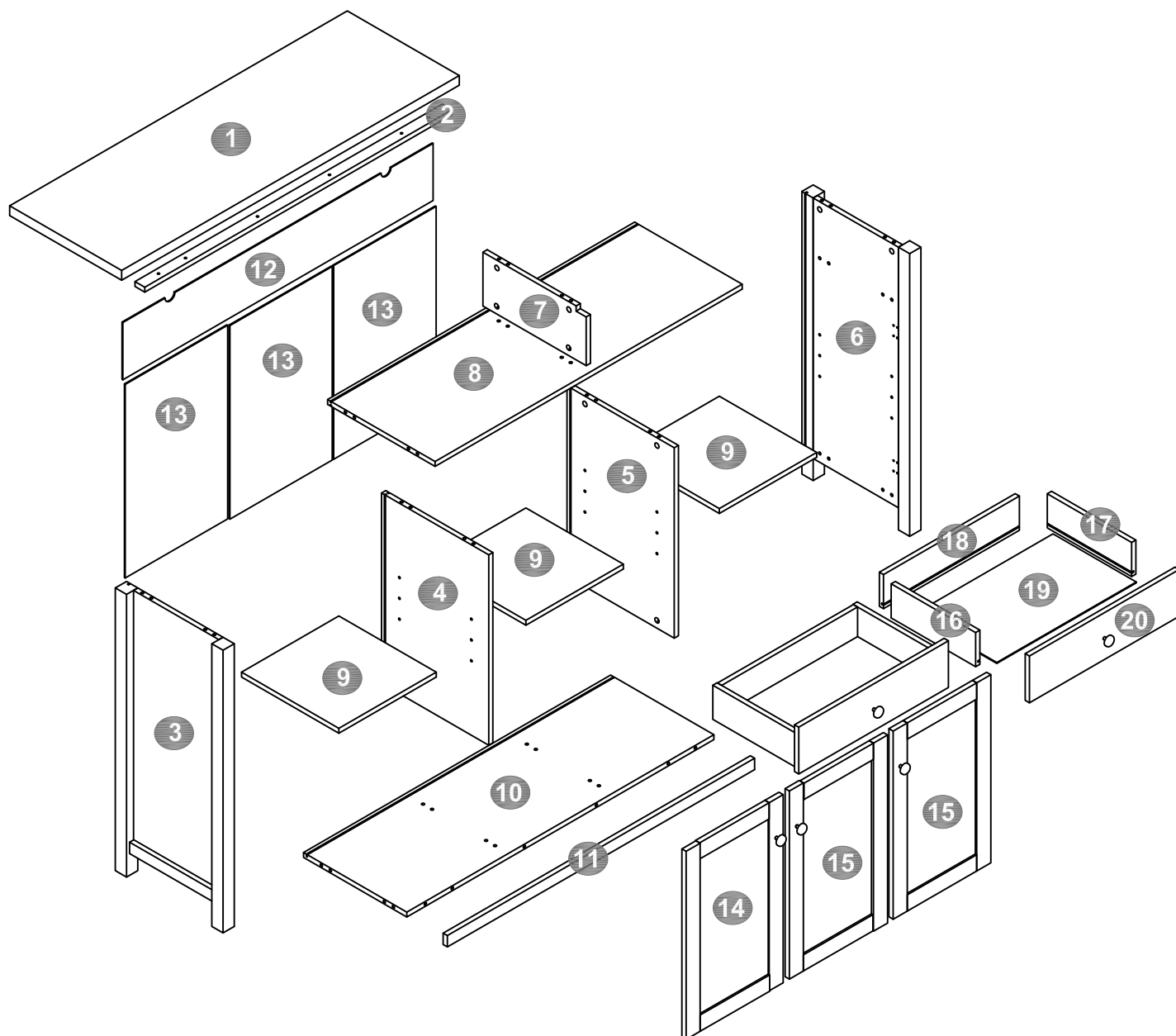

NO.PARTS LIST	QTY	NO.PARTS LI	QTY
(1) Part1	1	(12) Part12	1
(2) Part2	1	(13) Part13	3
(3) Part3	1	(14) Part14	1
(4) Part4	1	(15) Part15	2
(5) Part5	1	(16) Part16	2
(6) Part6	1	(17) Part17	2
(7) Part7	1	(18) Part18	2
(8) Part8	1	(19) Part19	2
(9) Part9	3	(20) Part20	2
(10) Part10	1		
(11) Part11	1		

## CLIFTON SIDEBORD

# ASSEMBLY INSTRUCTION

## DESCRIPTION

1106

CLIFTON SIDEBORD

### Top Tips before you start!

1. Please check that all parts are present before you start the assembly of your furniture, as once assembled, the furniture is exempt from our home approval policy.
2. For ease and speed of assembly, we recommend that before you commence each step of the assembly, that you identify all the parts required for that step.
3. For larger items, please ensure that you have sufficient space and people (as indicated on page 1) to assemble your product safely.
4. We recommend that, where possible, all items are assembled near to the area in which they will be placed in use, to avoid moving the product unnecessarily once assembled.
5. For the protection of your furniture, particularly items of high gloss finish, we recommend that the product is placed on a protected surface during assembly to prevent any damage.
6. During assembly please take care not to over-tighten any fittings, as this may damage the product.

### Care and Maintenance of your Furniture

- Please periodically check all fittings and re-tighten as necessary.
- Please do not drag or pull your furniture.
- Wipe occasionally with a soft cloth slightly dampened with water. Then buff with a dry clean soft cloth.
- Never allow any kind of liquid to remain on your furniture. Absorption can cause wood to warp or finishes to de-laminate.
- Please do not sit or stand on this item.

# ASSEMBLY INSTRUCTION

## DESCRIPTION

1106

CLIFTON SIDEBORD

## SPECIAL TIPS FOR FITTING CAM-LOCKS AND CAM-BOLTS

### CAM-LOCK

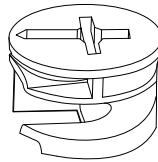

Align with long point of cross

#### WHEN FITTING CAMS

ENSURE STARTING POSITION IS CORRECT  
BEFORE YOU INSERT CONNECTING CAM-BOLTS  
TURN CLOCKWISE UNTIL SECURE

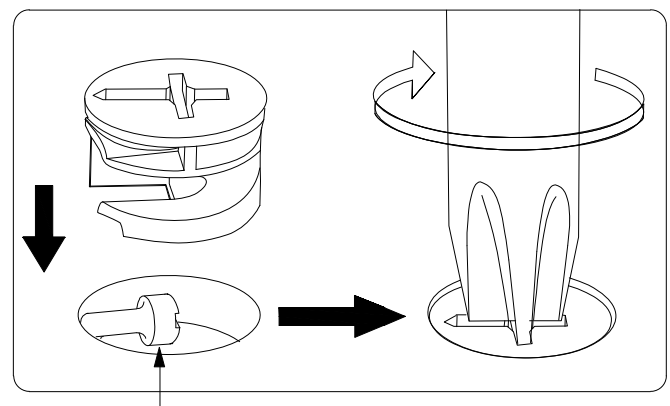
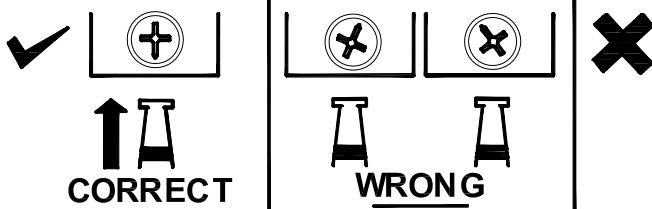

Lock head needs to be in centre

### CAM-BOLT

Tighten until shoulder is flush  
with panel. Do not overtighten  
or undertighten (see example  
below)

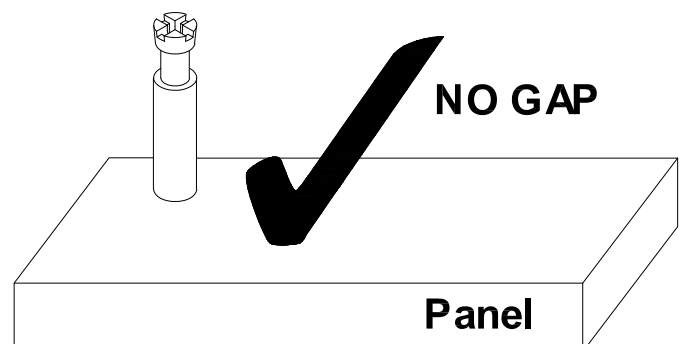
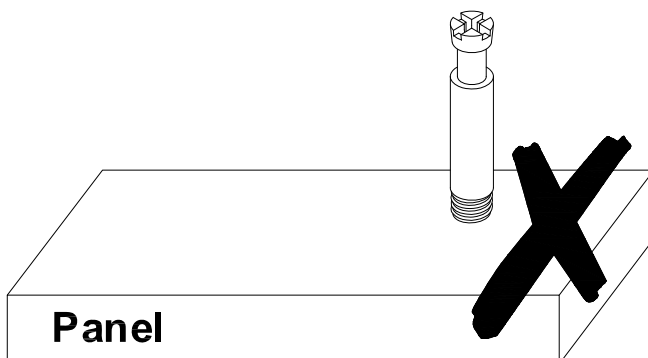
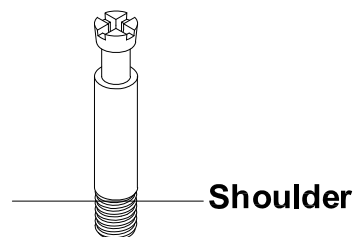

**DESCRIPTION**

**1106**

**CLIFTON SIDEBOARD**

The diagram illustrates the assembly of the table base.   
**Step 3:** The base plate (3) is attached to the legs (4) using screws (5). Callout A shows a screw being inserted into the base plate. Callout B shows a screw being inserted into the leg. Callout C shows a screw being inserted into the base plate.   
**Step 6:** The base plate (6) is attached to the legs (7) using screws (8) and a cam bolt (9). Callout D shows a cam bolt being inserted into the base plate. Callout E shows a screw being inserted into the leg. Callout F shows a screw being inserted into the base plate.   
**Callouts:**   
 A: Shows a screw being inserted into the base plate.   
 B: Shows a screw being inserted into the leg.   
 C: Shows a screw being inserted into the base plate.   
 D: Shows a cam bolt being inserted into the base plate.   
 E: Shows a screw being inserted into the leg.   
 F: Shows a screw being inserted into the base plate.



# ASSEMBLY INSTRUCTION

DESCRIPTION

1106

CLIFTON SIDEBORD

## STEP 2

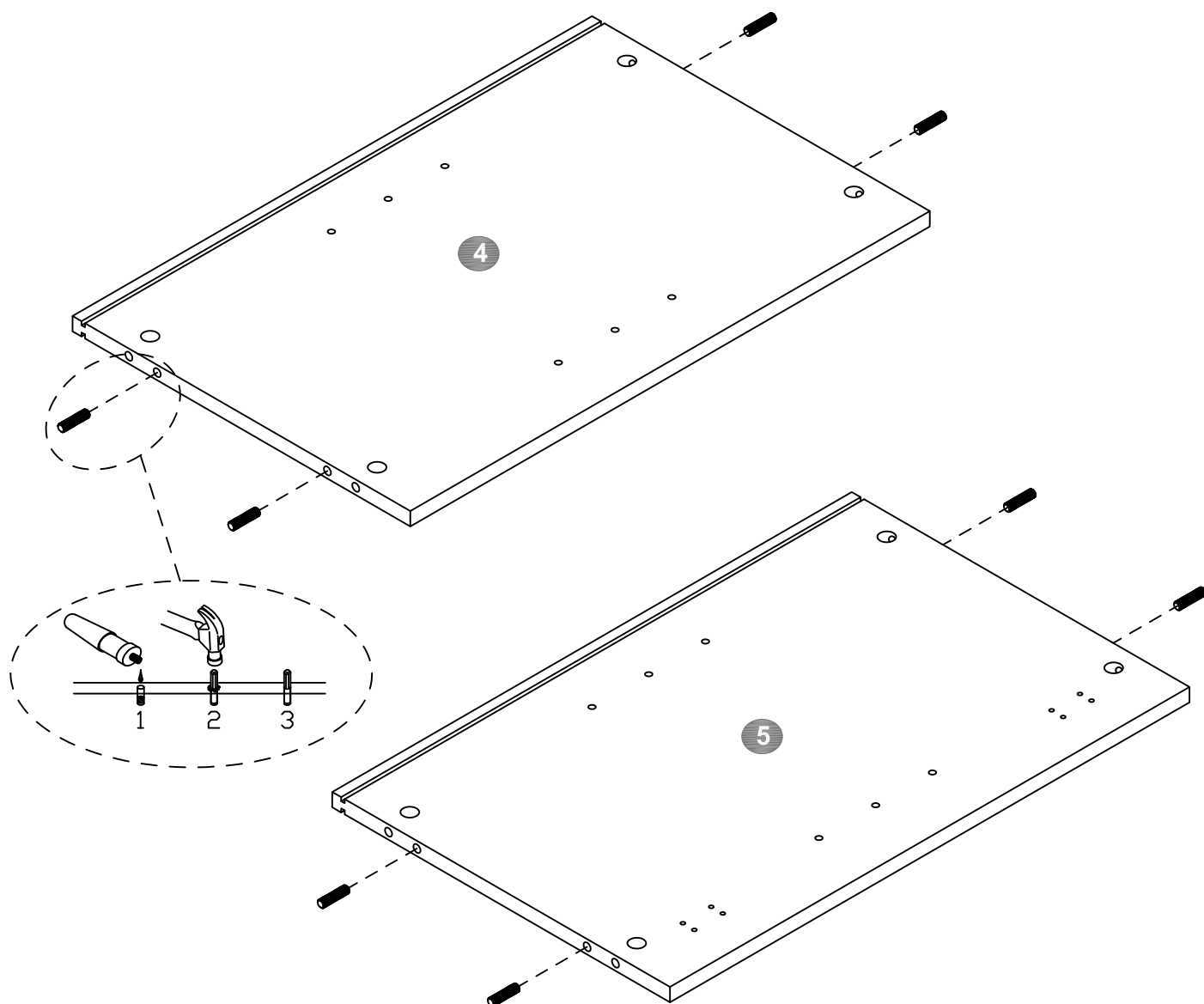

8X  
C

# ASSEMBLY INSTRUCTION

DESCRIPTION

1106

CLIFTON SIDEBORD

## STEP 3

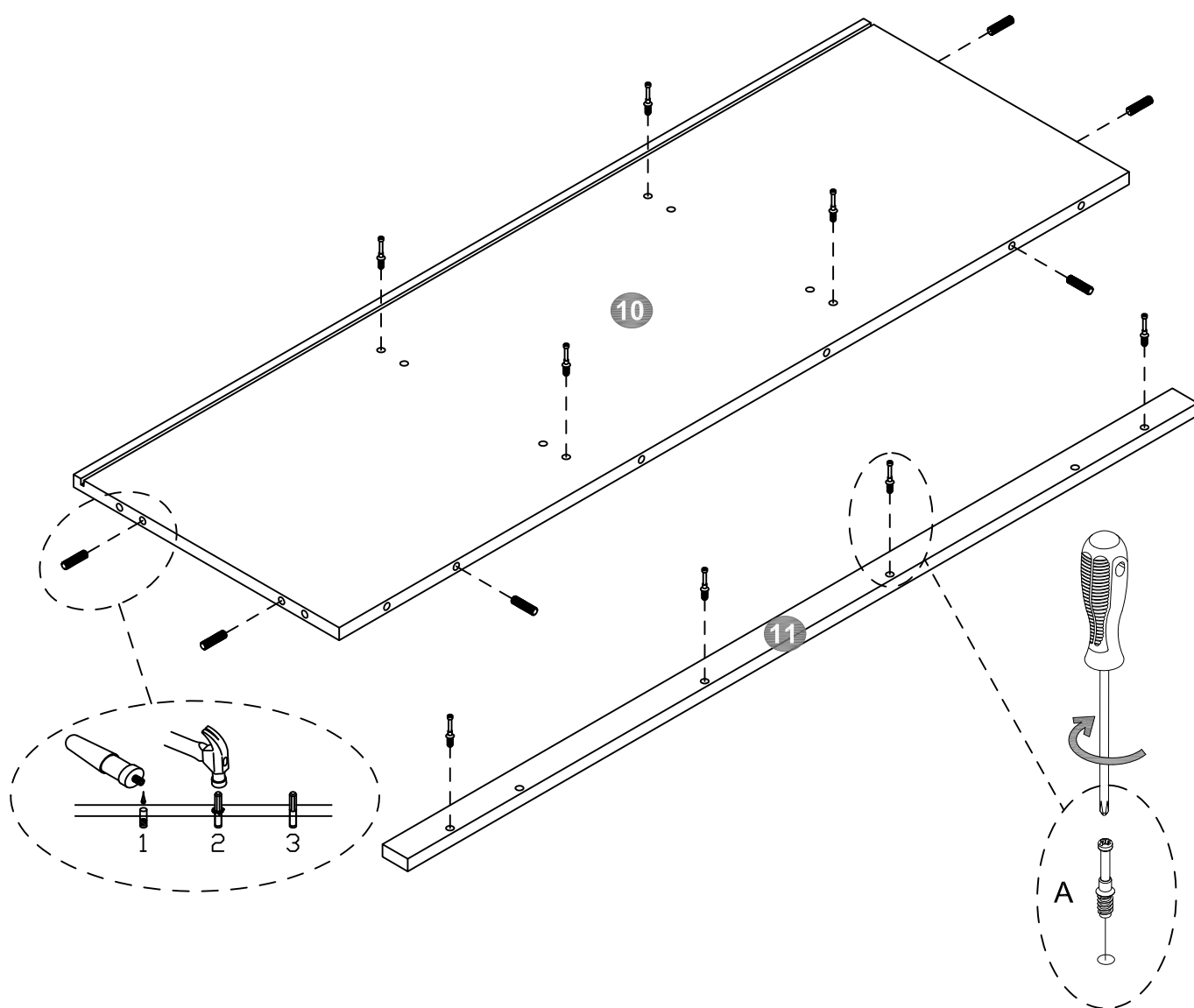

8X

A



6X

C



# ASSEMBLY INSTRUCTION

DESCRIPTION  
1106  
CLIFTON SIDEBORD

## STEP 4

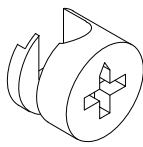
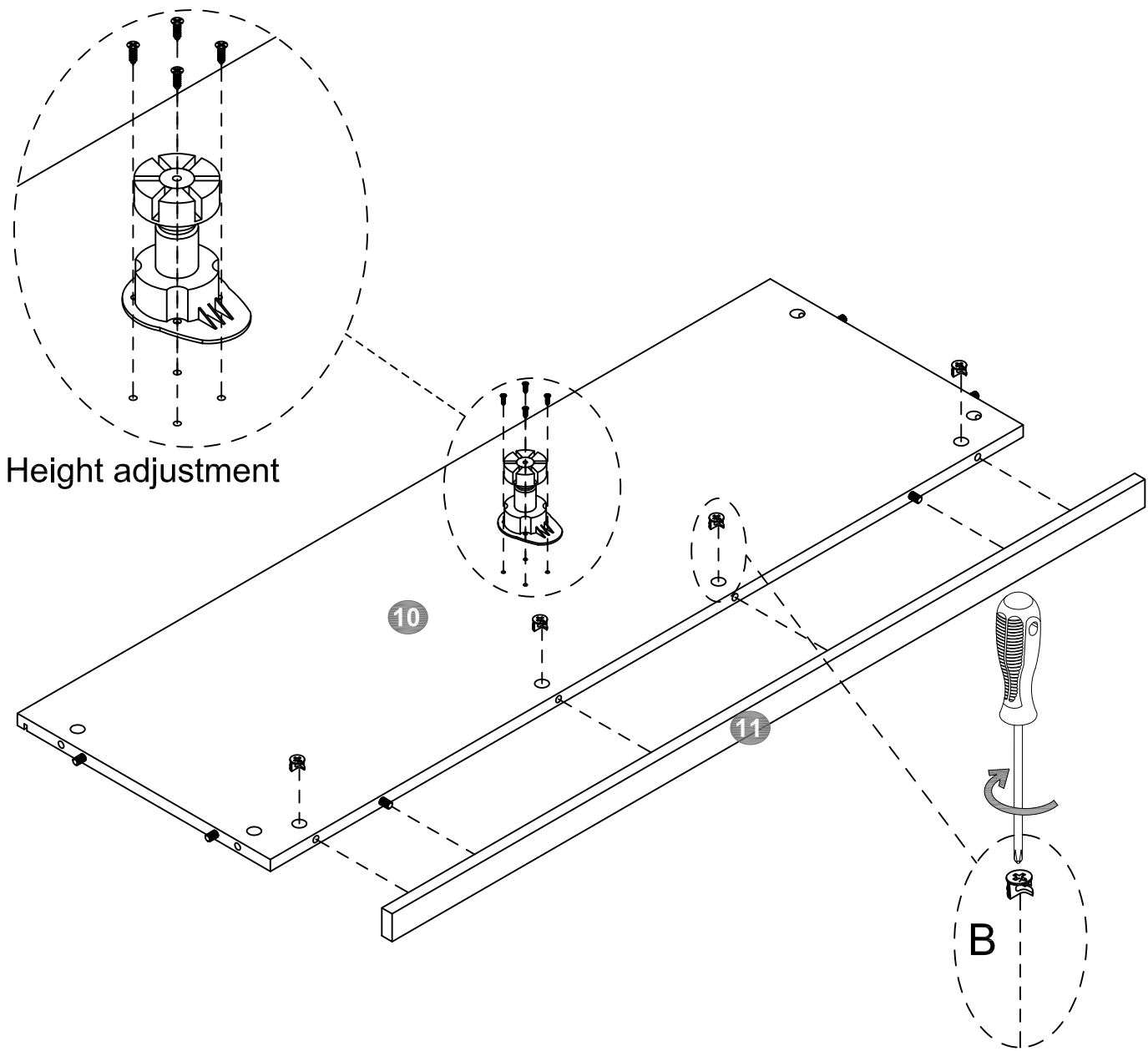

4X  
B



4X  
F

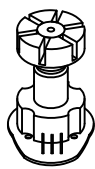

1X  
W

# ASSEMBLY INSTRUCTION

## DESCRIPTION

1106

## CLIFTON SIDEBORD

### STEP 5

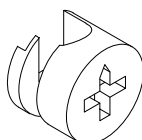
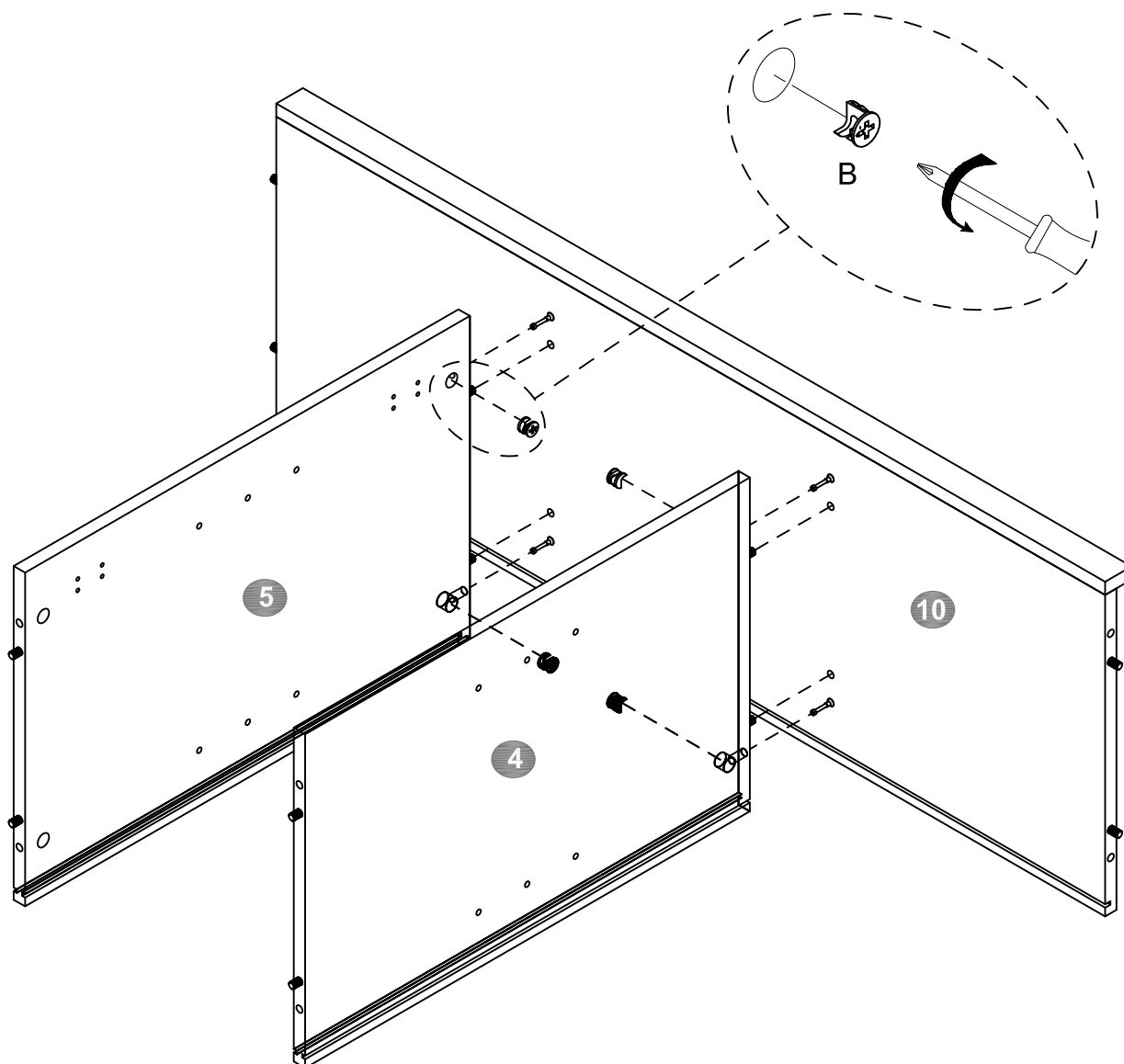

4X

B

# ASSEMBLY INSTRUCTION

## DESCRIPTION

1106

CLIFTON SIDEBORD

### STEP 6

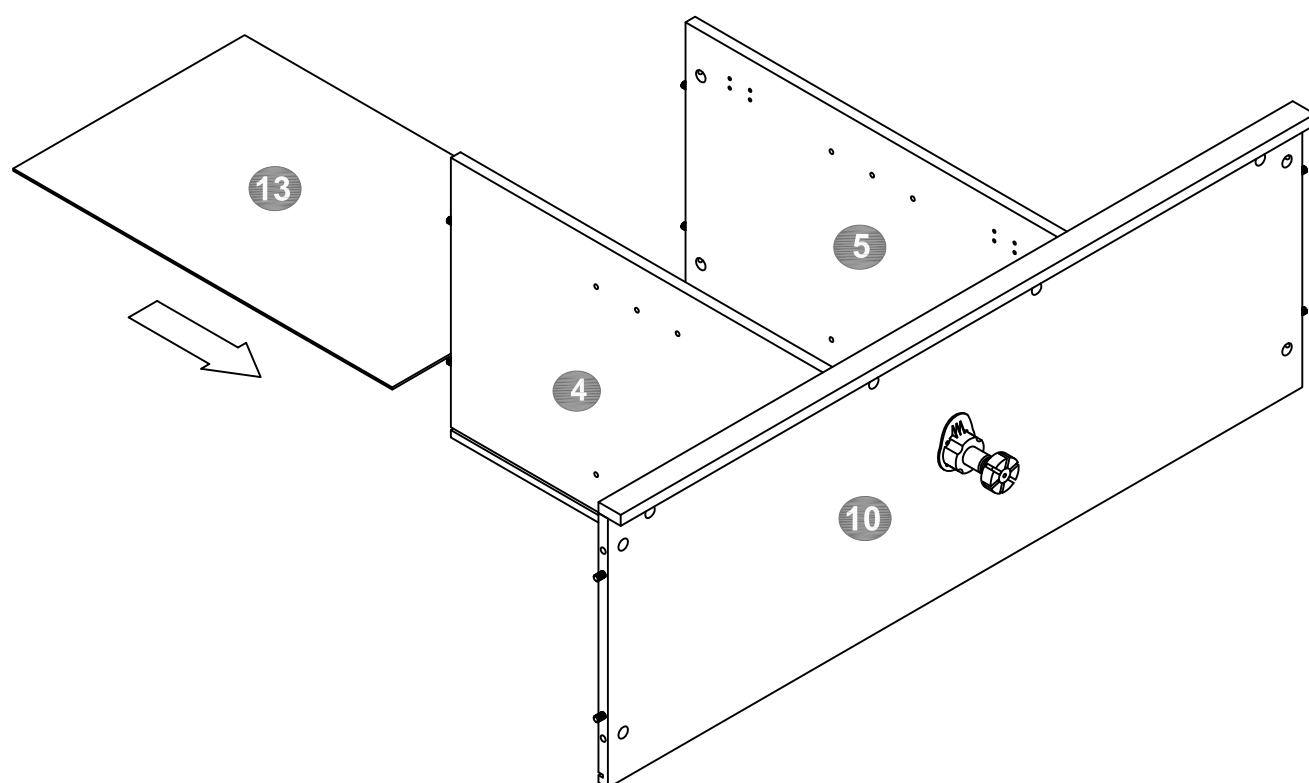

# ASSEMBLY INSTRUCTION

DESCRIPTION  
1106  
CLIFTON SIDEBORD

## STEP 7

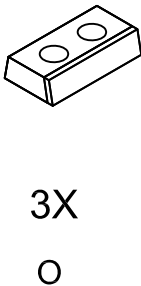
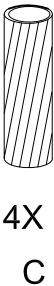
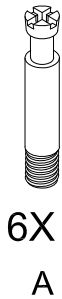
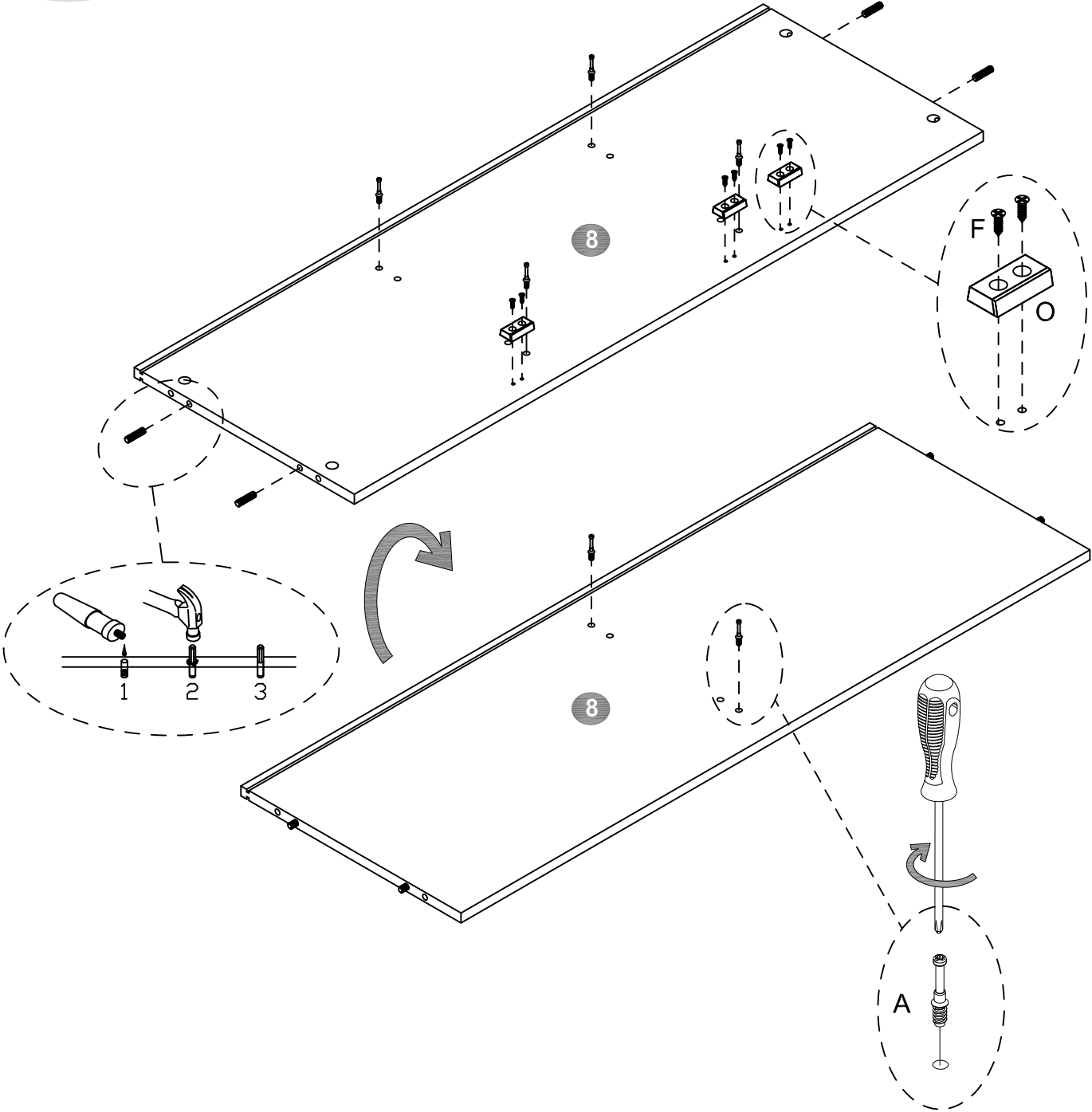

# ASSEMBLY INSTRUCTION

DESCRIPTION  
1106  
CLIFTON SIDEBOARD

## STEP 8

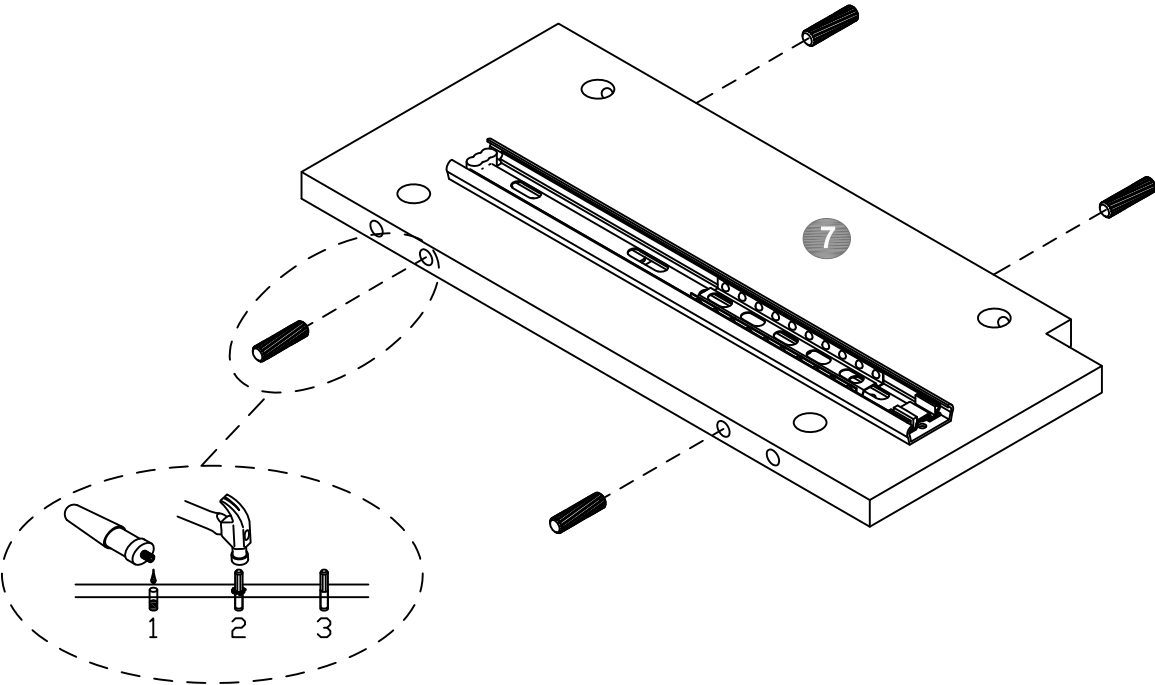

4X  
C

# ASSEMBLY INSTRUCTION

## DESCRIPTION

1106

CLIFTON SIDEBORD

### STEP 9

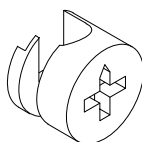
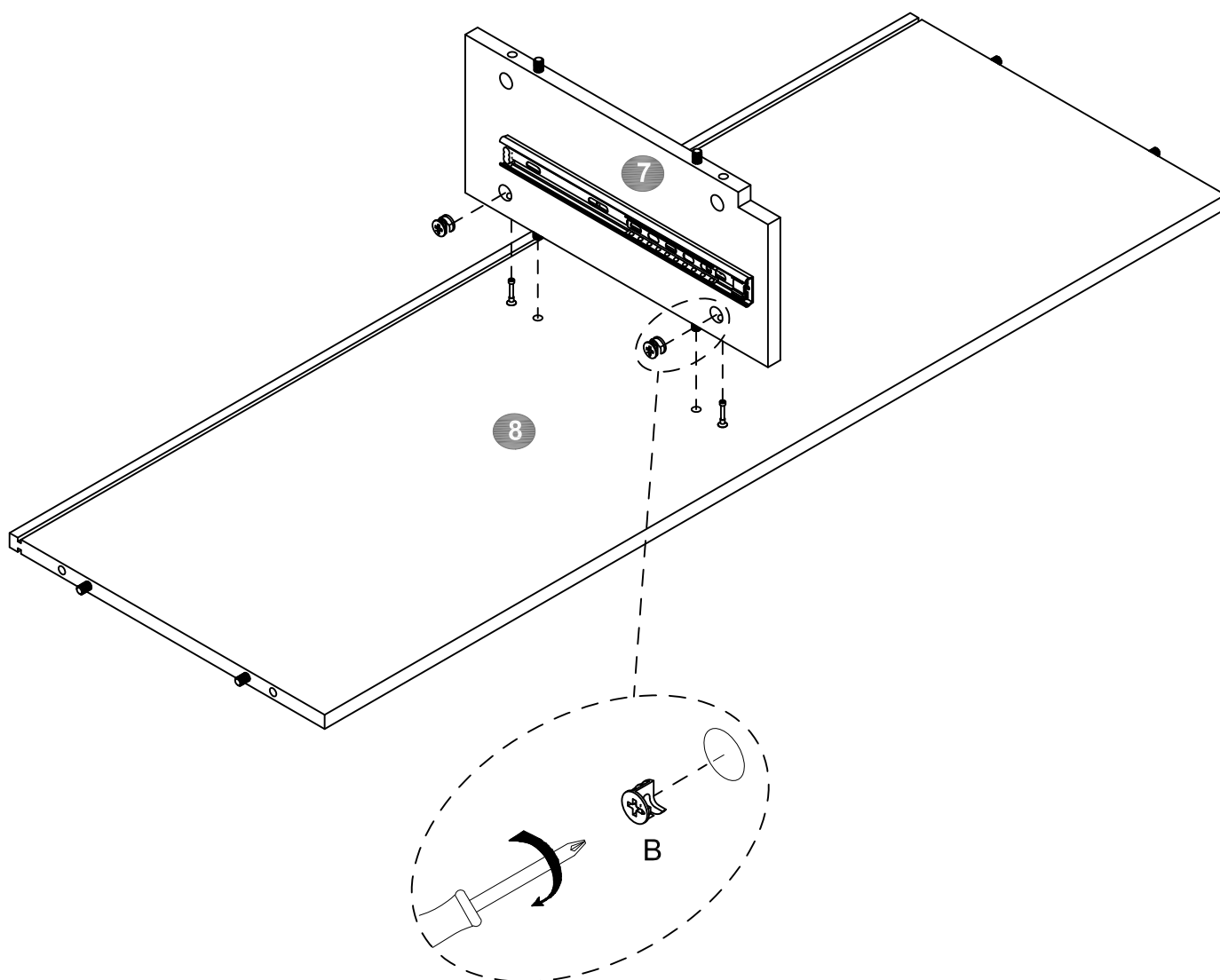

2X

B

# ASSEMBLY INSTRUCTION

## DESCRIPTION

1106

## CLIFTON SIDEBORD

### STEP 10

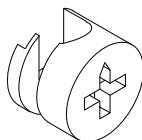
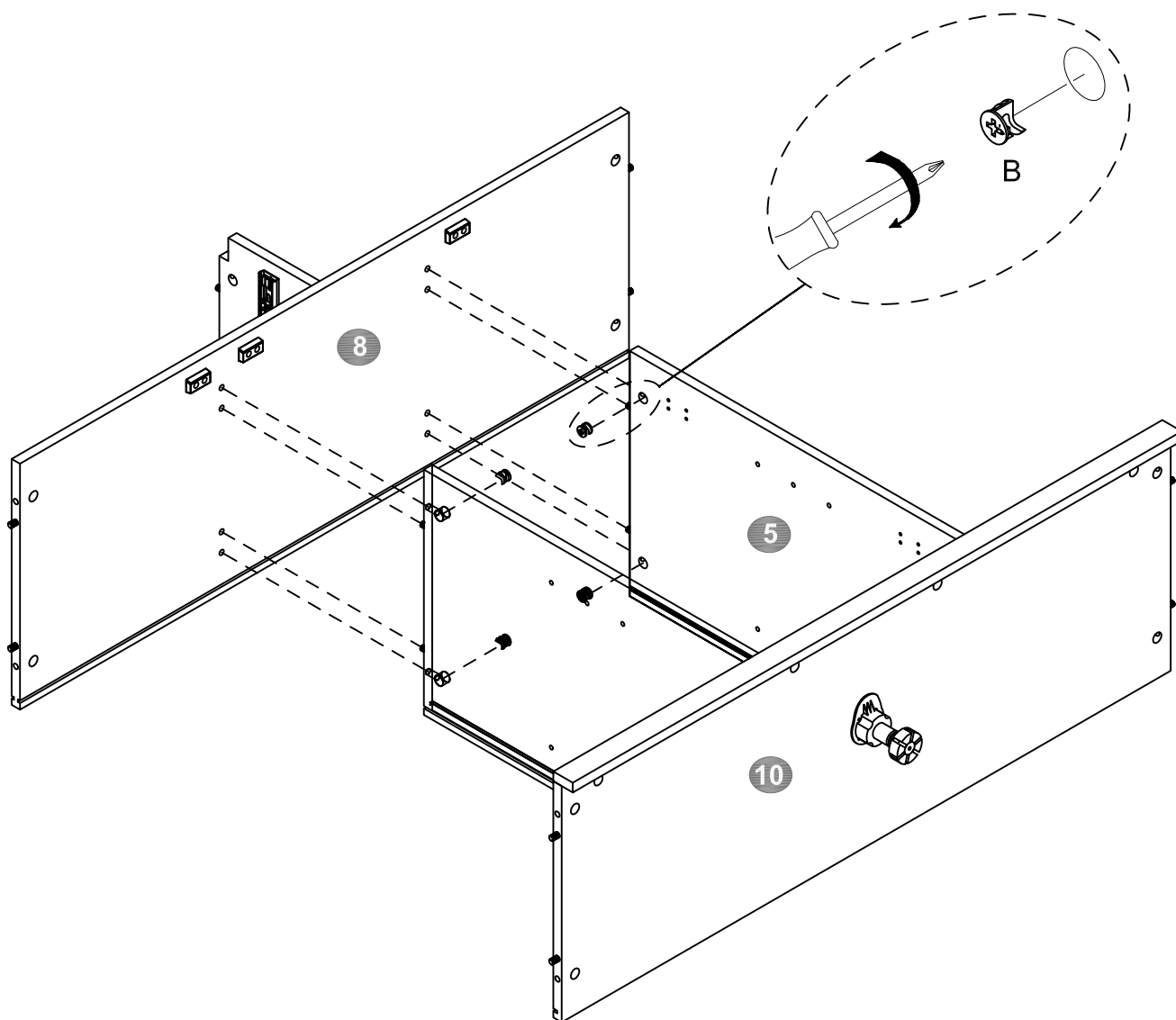

4X

B

# ASSEMBLY INSTRUCTION

## DESCRIPTION

1106

CLIFTON SIDEBORD

### STEP 11

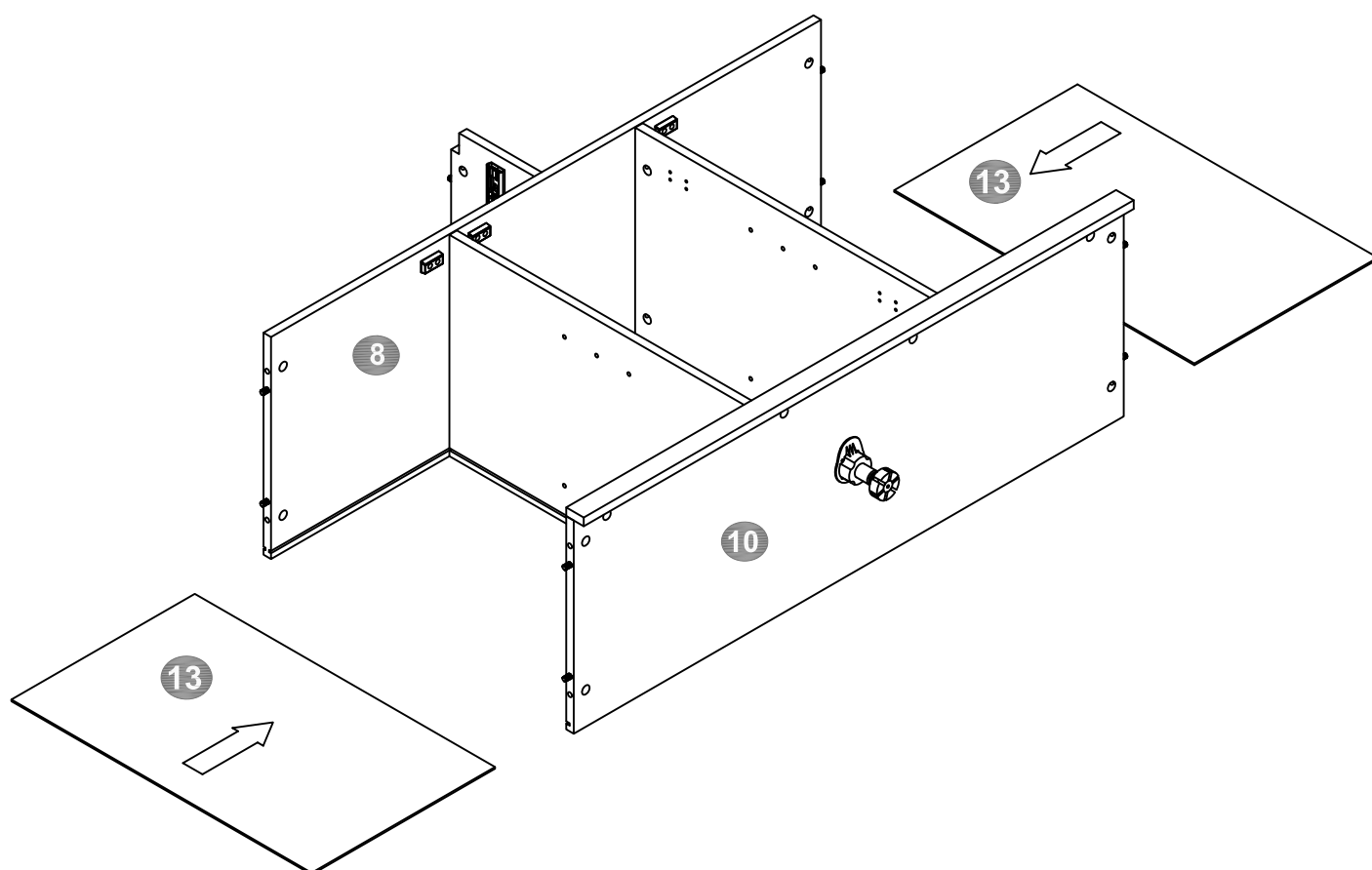



# ASSEMBLY INSTRUCTION

DESCRIPTION

1106

CLIFTON SIDEBORD

## STEP 12

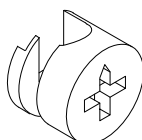
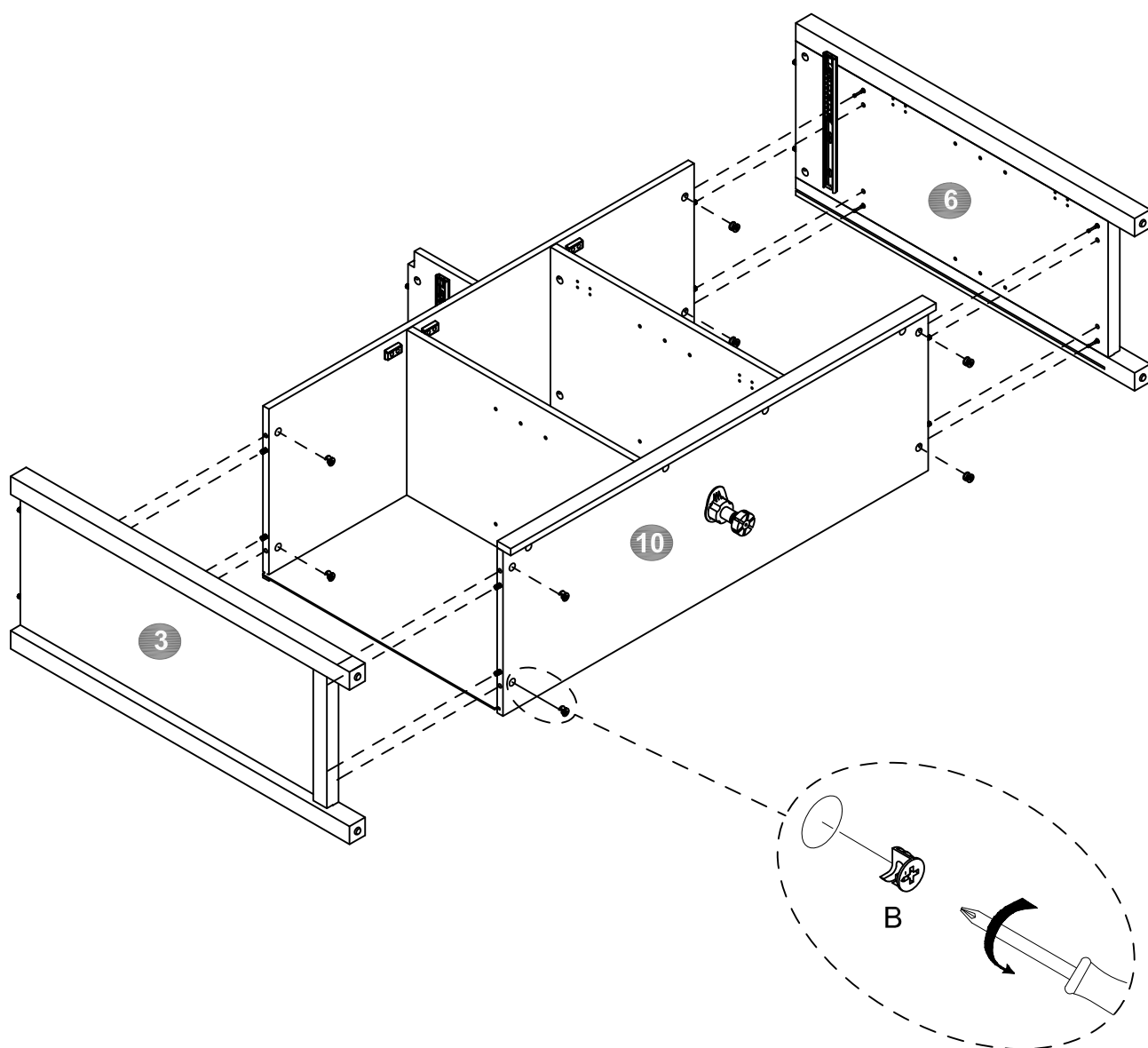

8X

B

# ASSEMBLY INSTRUCTION

## DESCRIPTION

1106

## CLIFTON SIDEBORD

### STEP 13

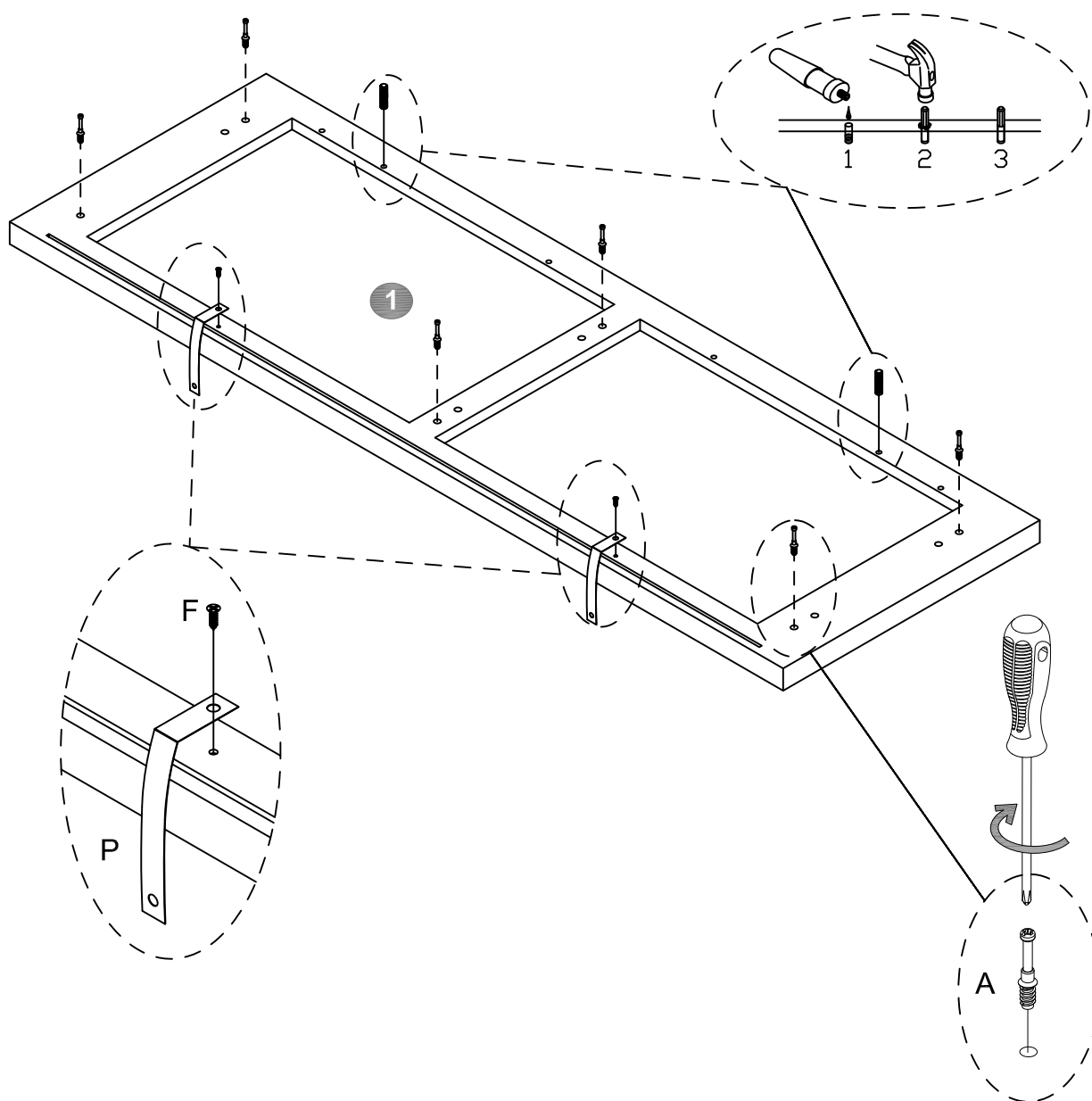

6X  
A



2X  
C



2X  
F



2X  
P

# ASSEMBLY INSTRUCTION

## DESCRIPTION

1106

## CLIFTON SIDEBORD

### STEP 14

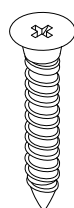
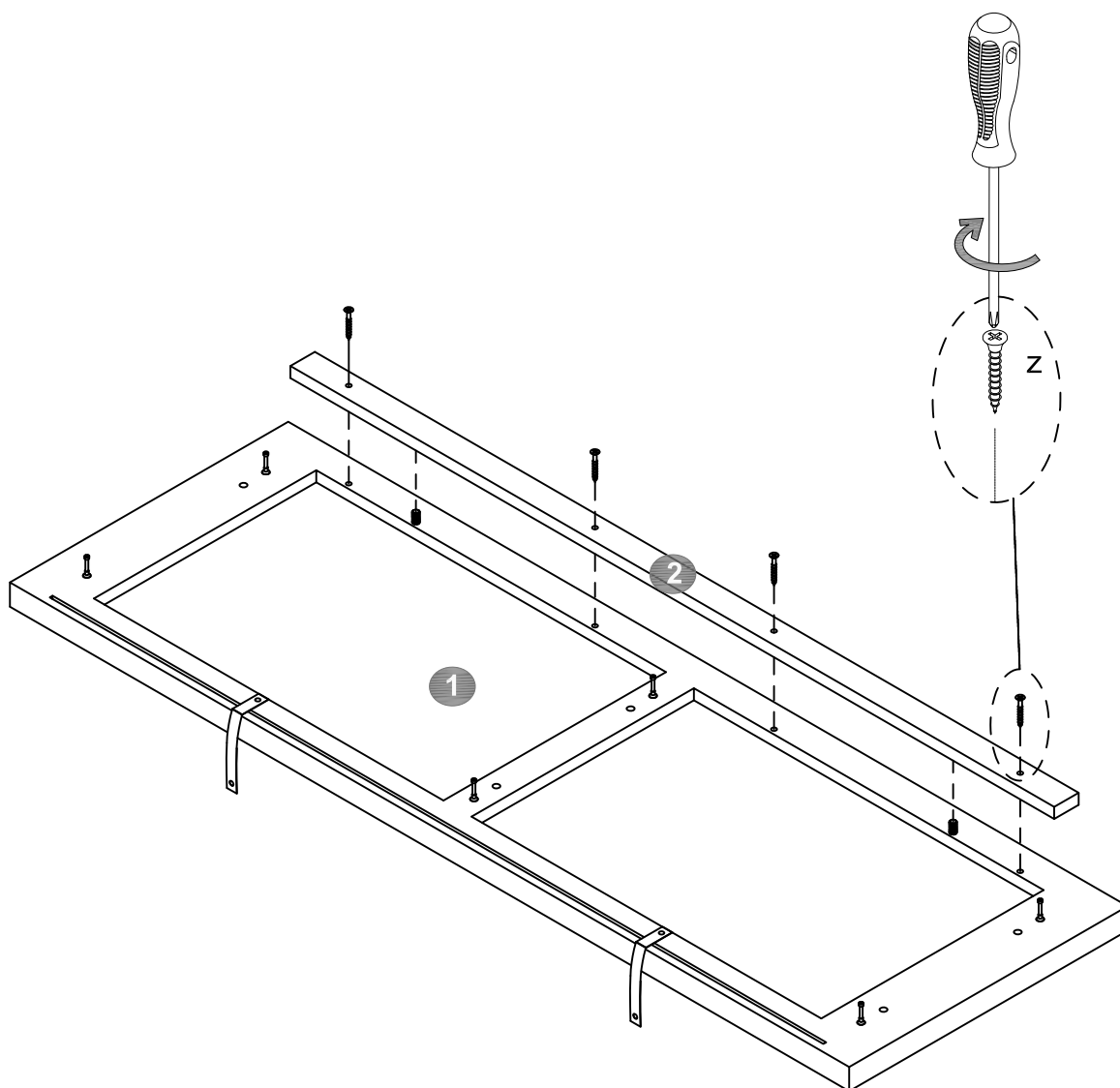

4X

Z

# ASSEMBLY INSTRUCTION

## DESCRIPTION

1106

## CLIFTON SIDEBORD

### STEP 15

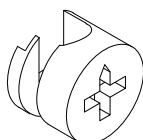
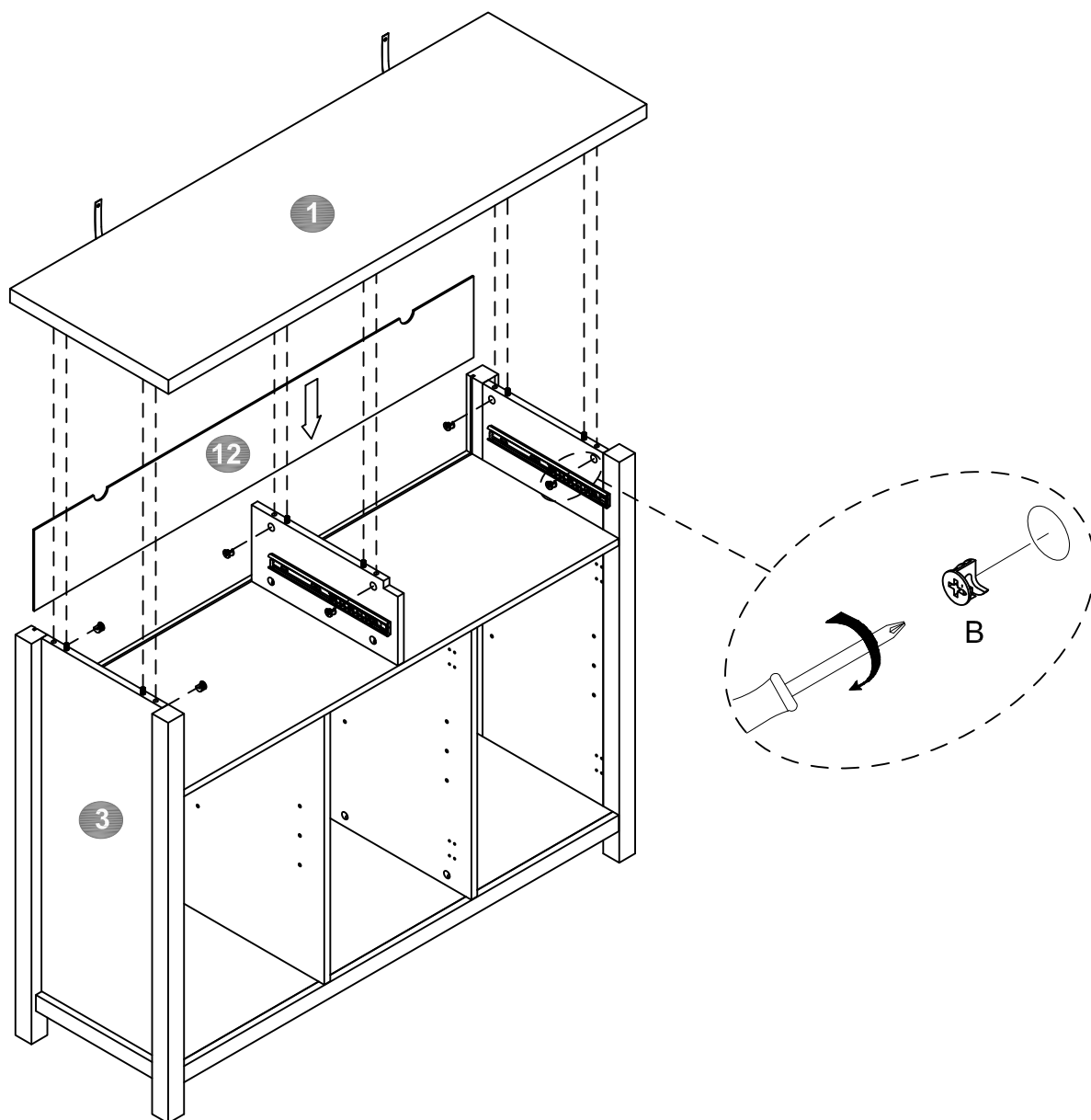

6X

B

# ASSEMBLY INSTRUCTION

## DESCRIPTION

1106

## CLIFTON SIDEBORD

### STEP 16

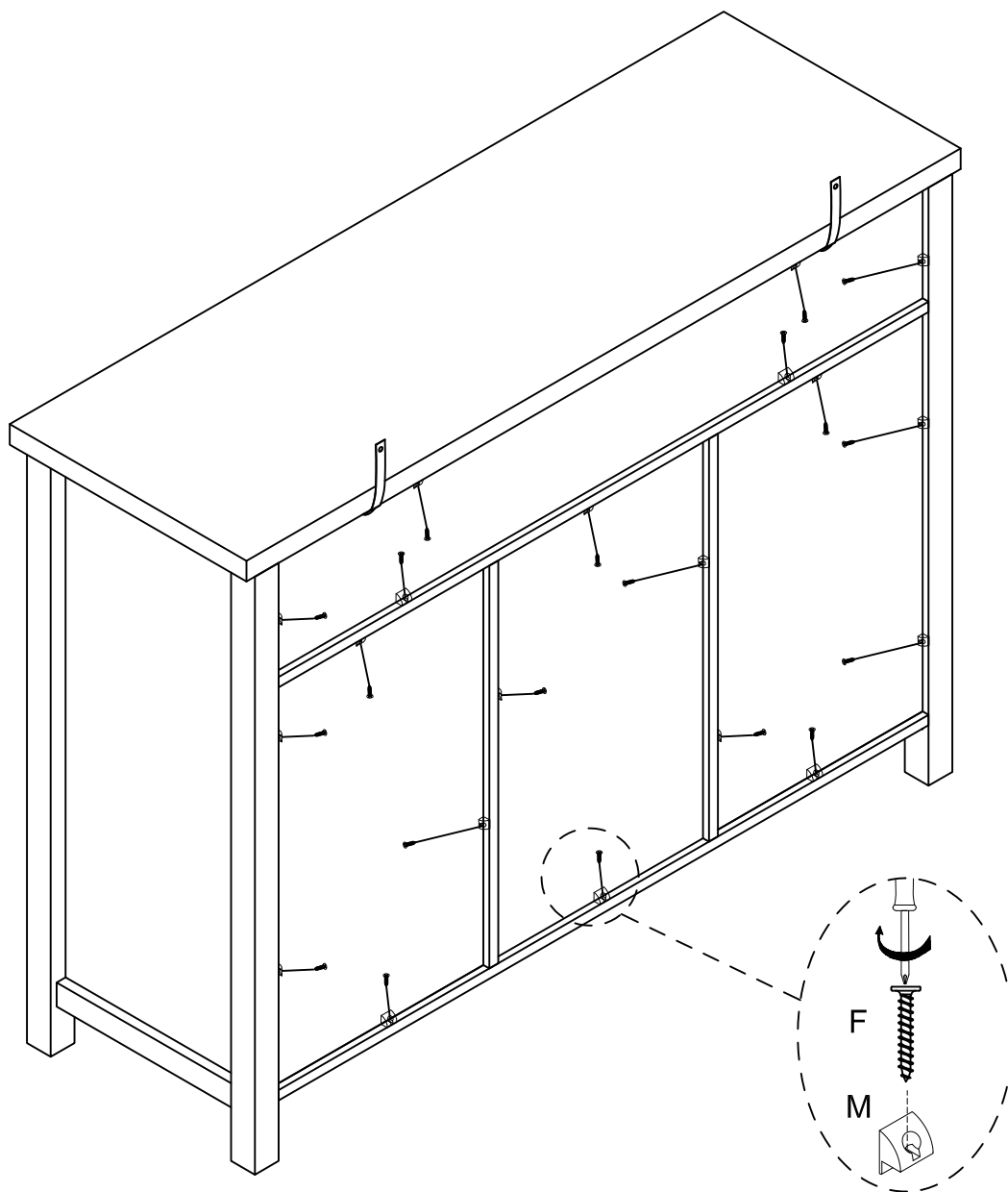

20X

F

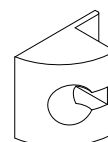

20X

M

# ASSEMBLY INSTRUCTION

## DESCRIPTION

1106

## CLIFTON SIDEBORD

### STEP 17

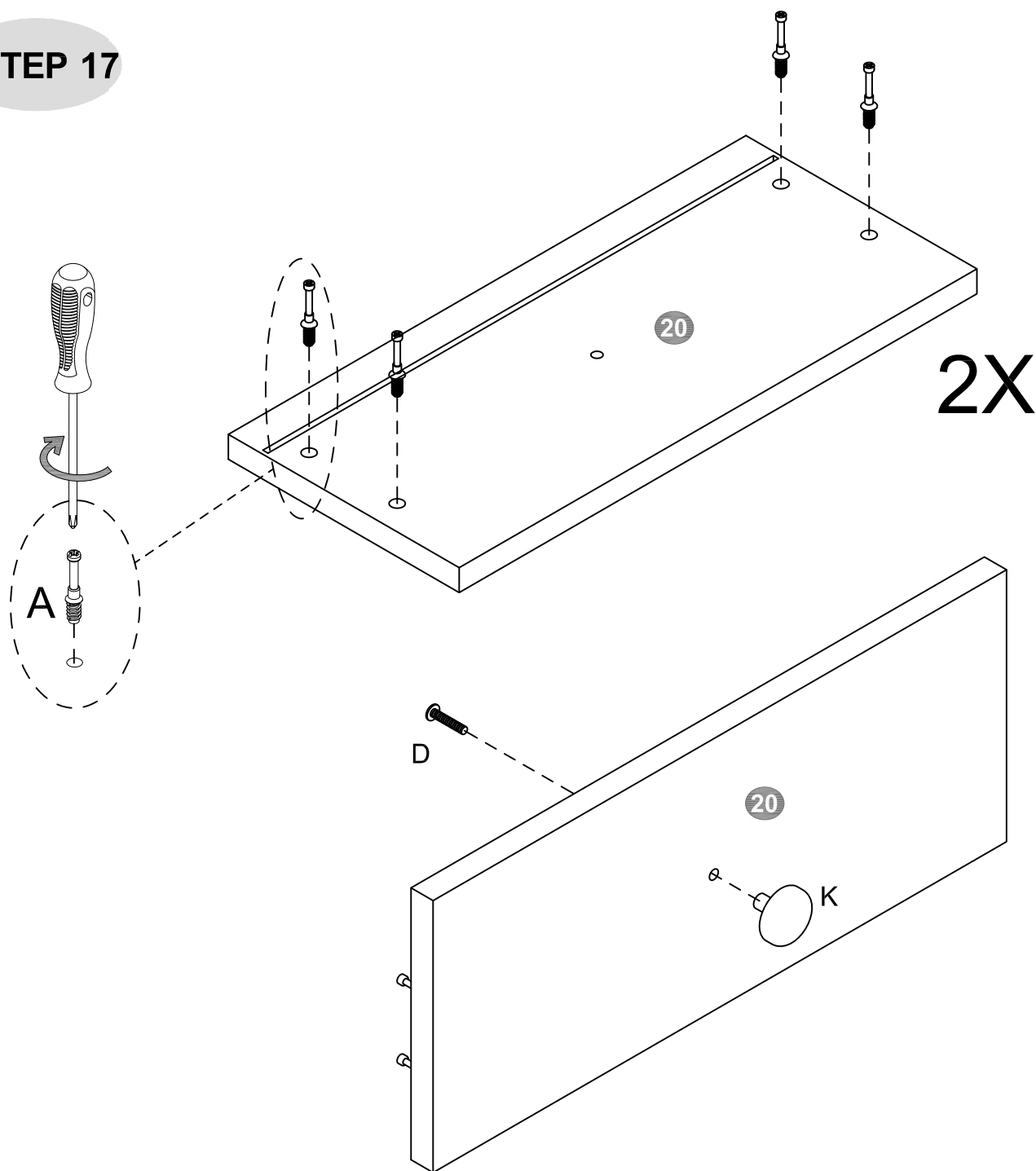

8X  
A

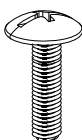

2X  
D



2X  
K

# ASSEMBLY INSTRUCTION

## DESCRIPTION

1106

CLIFTON SIDEBORD

### STEP 18

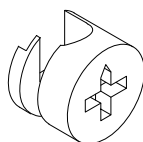
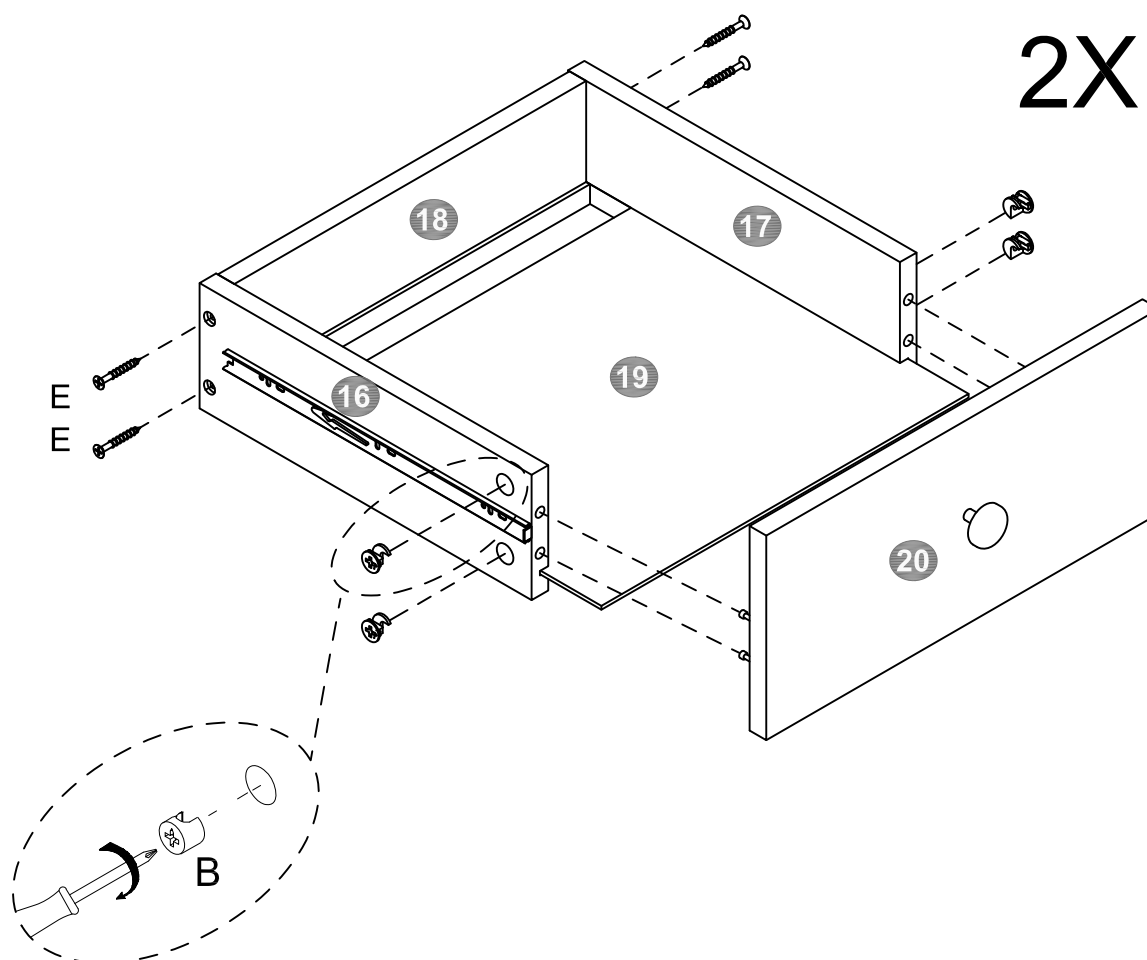

8X  
B

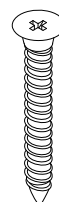

8X  
E

# ASSEMBLY INSTRUCTION

DESCRIPTION

1106

CLIFTON SIDEBORD

## STEP 19

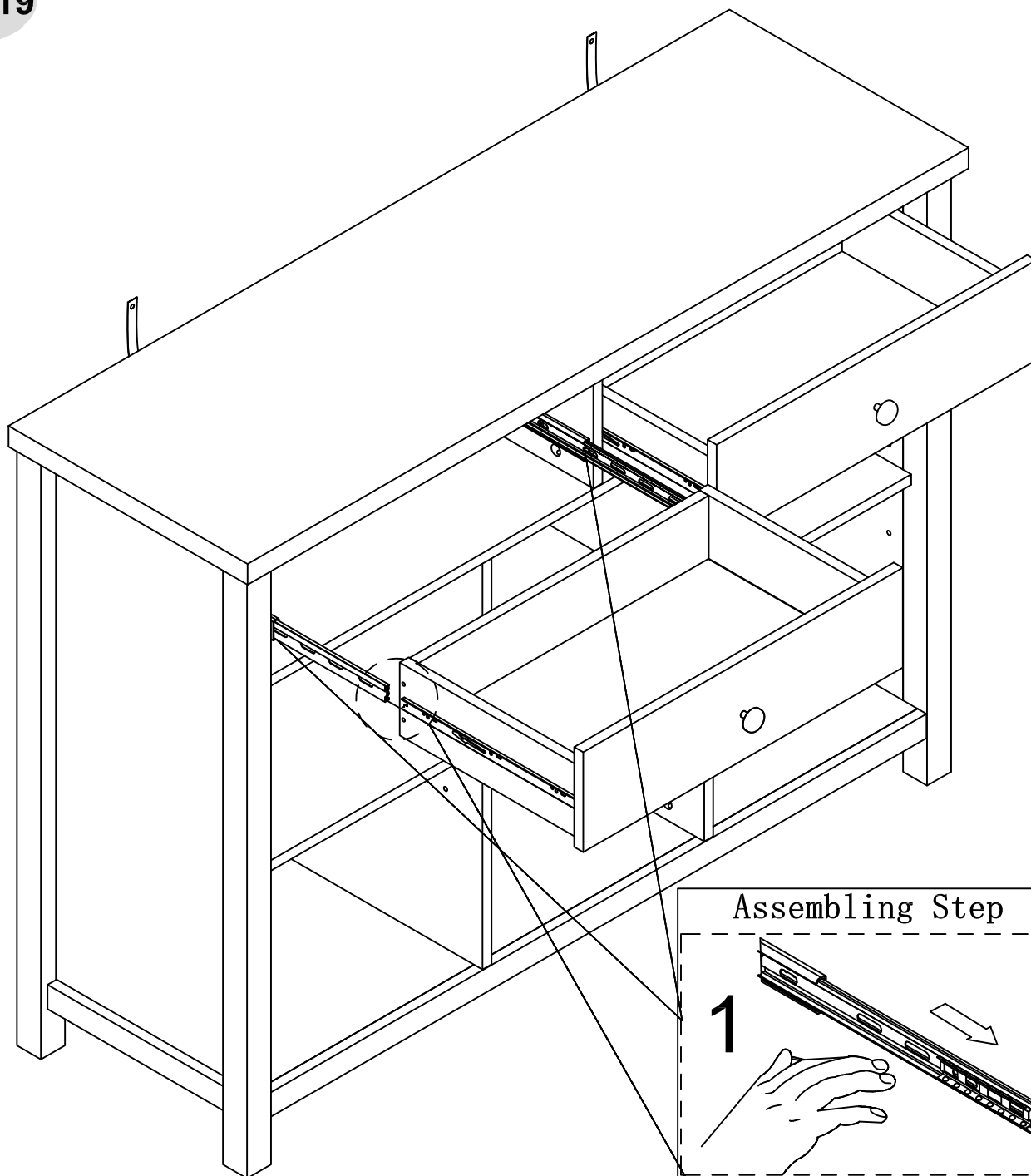

### Disassembling Step

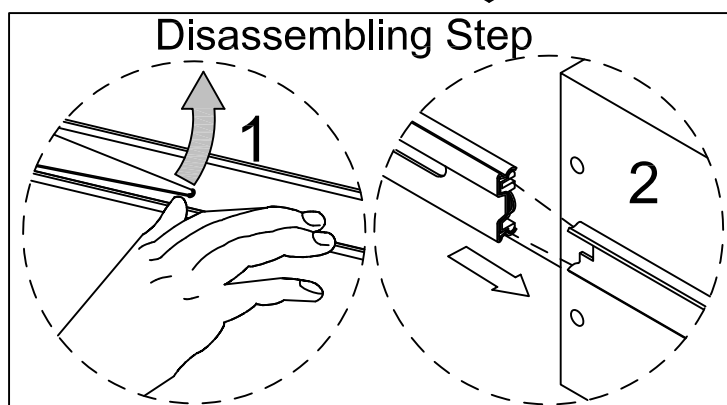

### Assembling Step

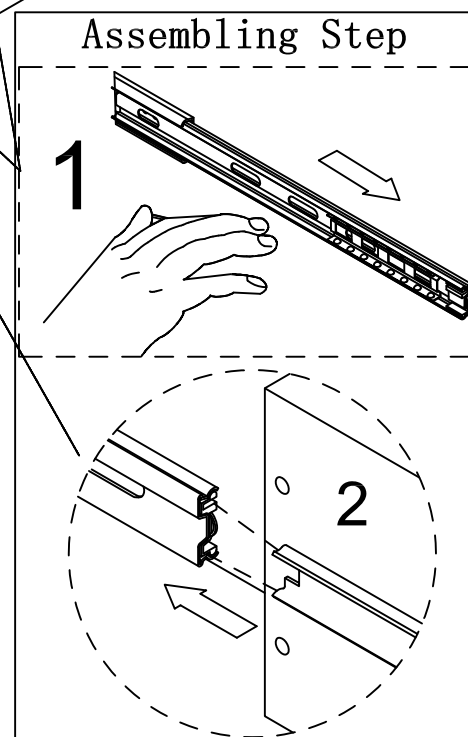



# ASSEMBLY INSTRUCTION

## DESCRIPTION

1106

## CLIFTON SIDEBORD

### STEP 20

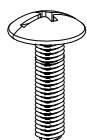
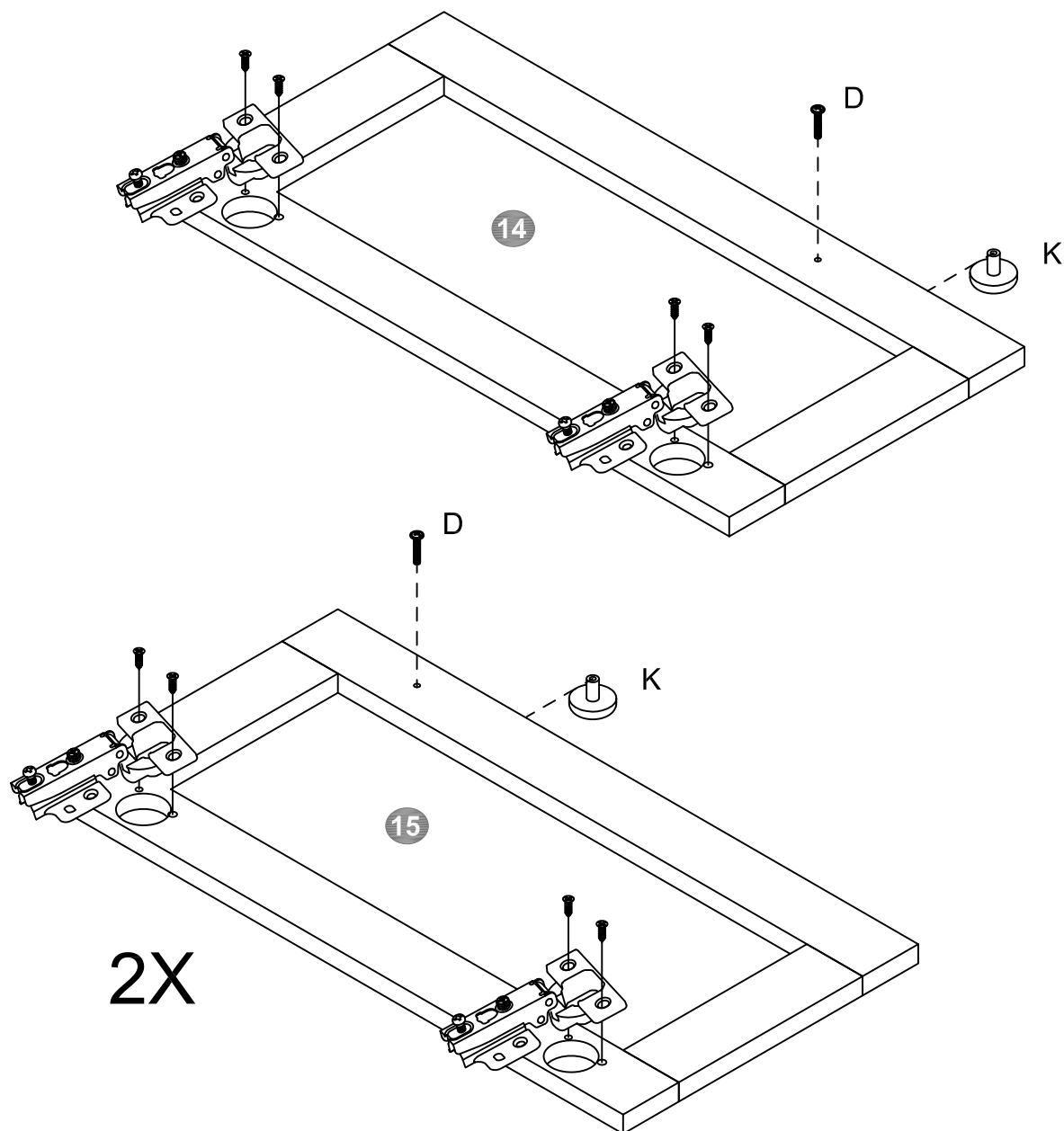

3X

D

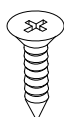

12X

F



3X

K

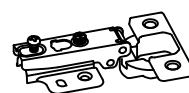

6X

N

# ASSEMBLY INSTRUCTION

## DESCRIPTION

1106

## CLIFTON SIDEBORD

### STEP 21

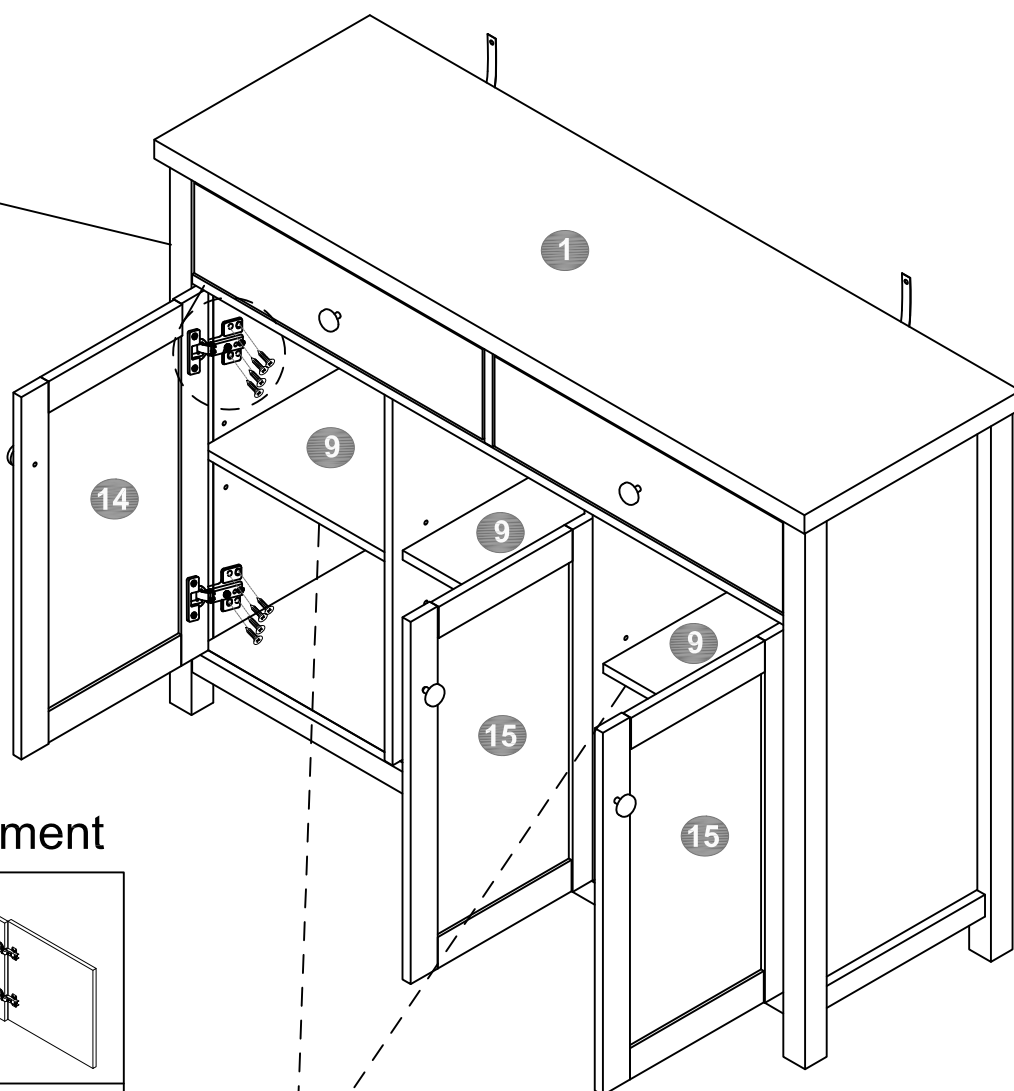
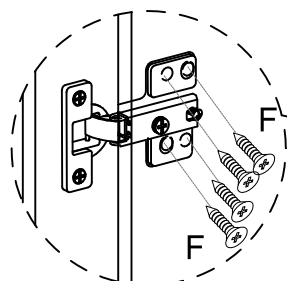

### Doors Adjustment

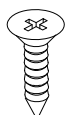
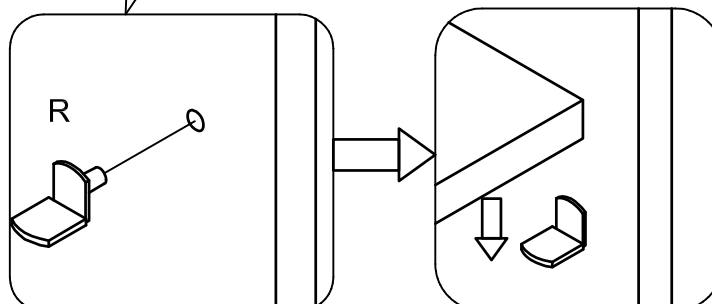
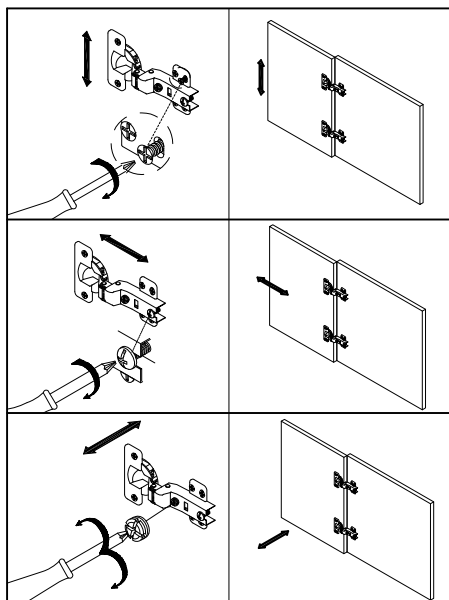

24X

F



12X

R

# ASSEMBLY INSTRUCTION

## DESCRIPTION

1106

## CLIFTON SIDEBORD

### STEP 22 FITTING OF ANTI-TIP

#### STEP 1:

**Make a mark on the wall through the strap.**

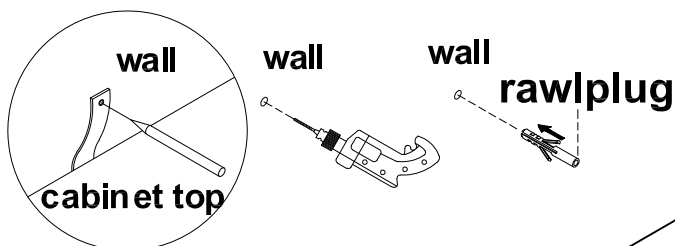

#### STEP 2:

**Insert screw through strap into hole in wall**

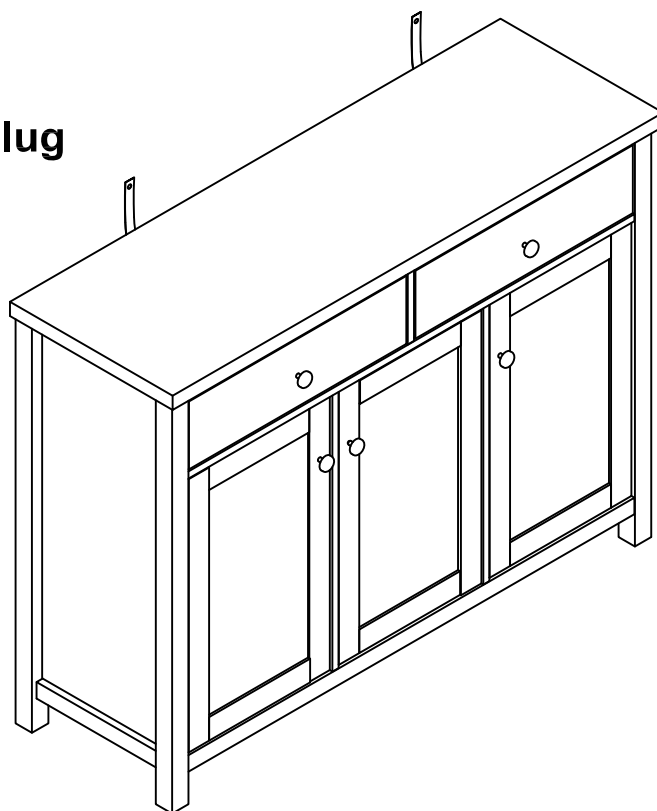
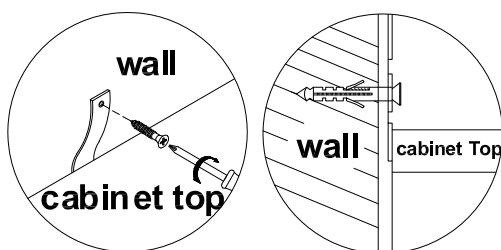

**Drill a hole in the wall and insert the rawlplug**

NOTE: wall fixings are not supplied with this product as different wall materials require different types of fixing devices (such as Rawl plugs on brick work). you must use fixing devices suitable for the type of wall you intend to mount this product. Please ensure that the head of any screw used has a diameter greater than the diameter of the mounting hole on the product and that the fixing is safe and secure before use.

The screw supplied is to fix the bracket to the cabinet.