

Assembly Instructions

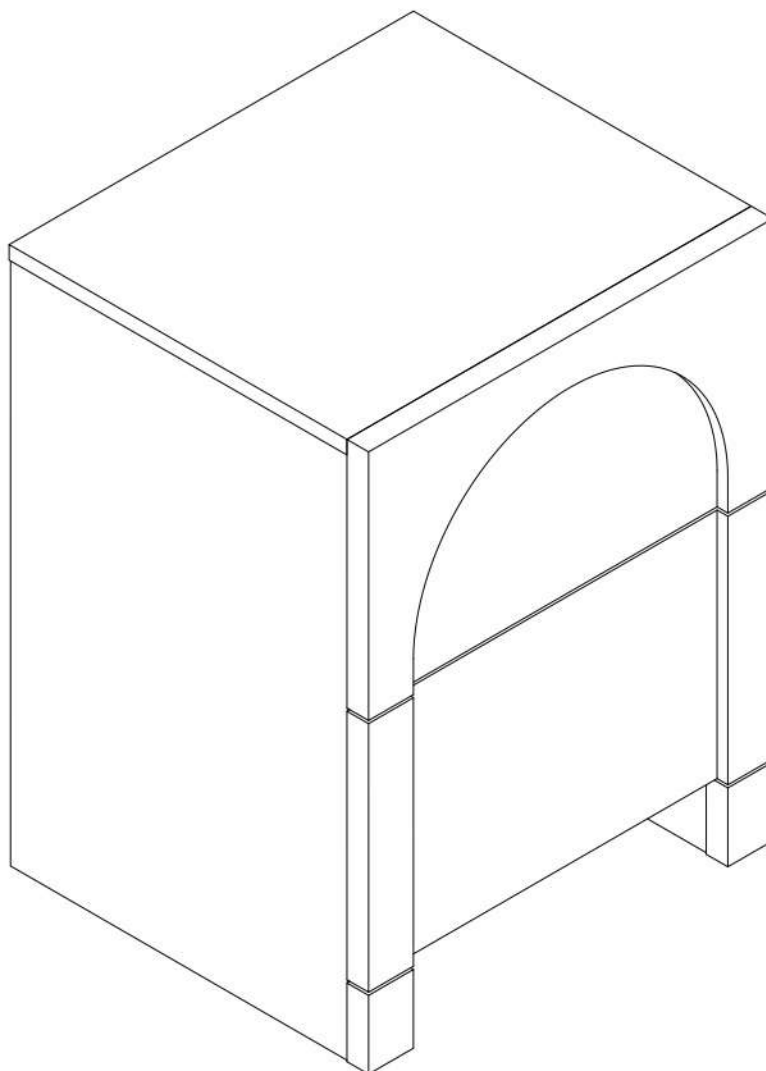

Product Code
ARH-BS-WHT

Dimensions(W x D x H)
450*400*600mm

Important

Please read through instruction carefully
Before assembly and keep for future reference.

Important Tips and Maintenance

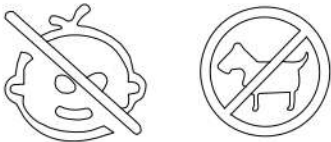
- 

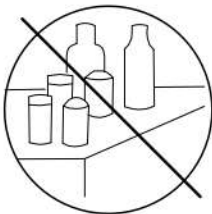
1. Keep children and animals away from working area as smaller parts may cause choking if swallowed.
- 

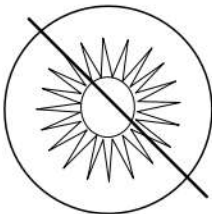
2. Never place liquids or anything damp upon furniture as it will mark. Ensure a coaster or running is beneath.
- 

3. To avoid fading, keep furniture out of direct sunlight.
- 

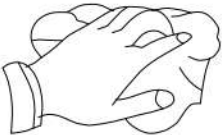
4. Never use ammonia based cleaning products as it will damage the finish.
- 

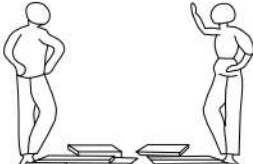
5. Use a soft or dry cloth when wiping or cleaning surfaces.
- 

6. Two person are required.
- 

7. Lay a soft matt down to protect the furniture piece before and during assembly.

So your relationship is strong. But is it flat-pack furniture strong? Unless you're an aerospace engineer, assembling furniture can be slightly stressful. We recommend meditating quietly, pouring yourself a herbal tea (or slightly less herbal wine) and tackling things one step at a time. If you feel a passive aggressive remark coming on, try a compliment instead. E.g. "You're so good looking."

This 10-step assembly should take around 39 minutes with an Allen key-or 25 minutes with an electric drill.

Designed for everyday

Component Hardware

Please check you have all the fittings
part or tools are listed in below.

No. A
Quantity:28 Pcs
Cam
φ15*12mm



No. B
Quantity:28 Pcs
Cam Lock Dowel
φ7*25



No. C
Quantity:2 Sets
Runner
L=250mm

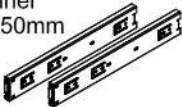

No. D
Quantity:8 Pcs
Screw
φ3.5*35mm



No. E
Quantity:14Pcs
Wooden Dowel
Ø8*30mm



No. F
Quantity:28 Pcs
Screw
φ3.5*14mm



No. G
Quantity:28Pcs
Cover
φ20mm



No. H
Quantity:1 Pair
Gloves



No. I
Quantity:4 Pcs



φ3*18mm

No. J
Quantity:1 Pc
Key
5mm



Component Panels & part List

Please check you have all the panels are listed below.

1. Top Panel-----x1
2. Bottom-----x1
3. Side Panel-Left-----x1
4. Side Panel-Right-----x1
5. Back Panel-----x1
6. Back Baseboard-----x1
7. Bottom support-Left-----x1
8. Baseboard-Right-----x1
9. Decorative Panel-Front-----x2
10. Drawer Panel-Down-----x1
11. Drawer Panel-Upper-----x1
12. Drawer Back Panel-----x2
13. Drawer Side Panel-Left-----x2
14. Drawer Side Panel-Right-----x2
15. Drawer Bottom Panel-----x2

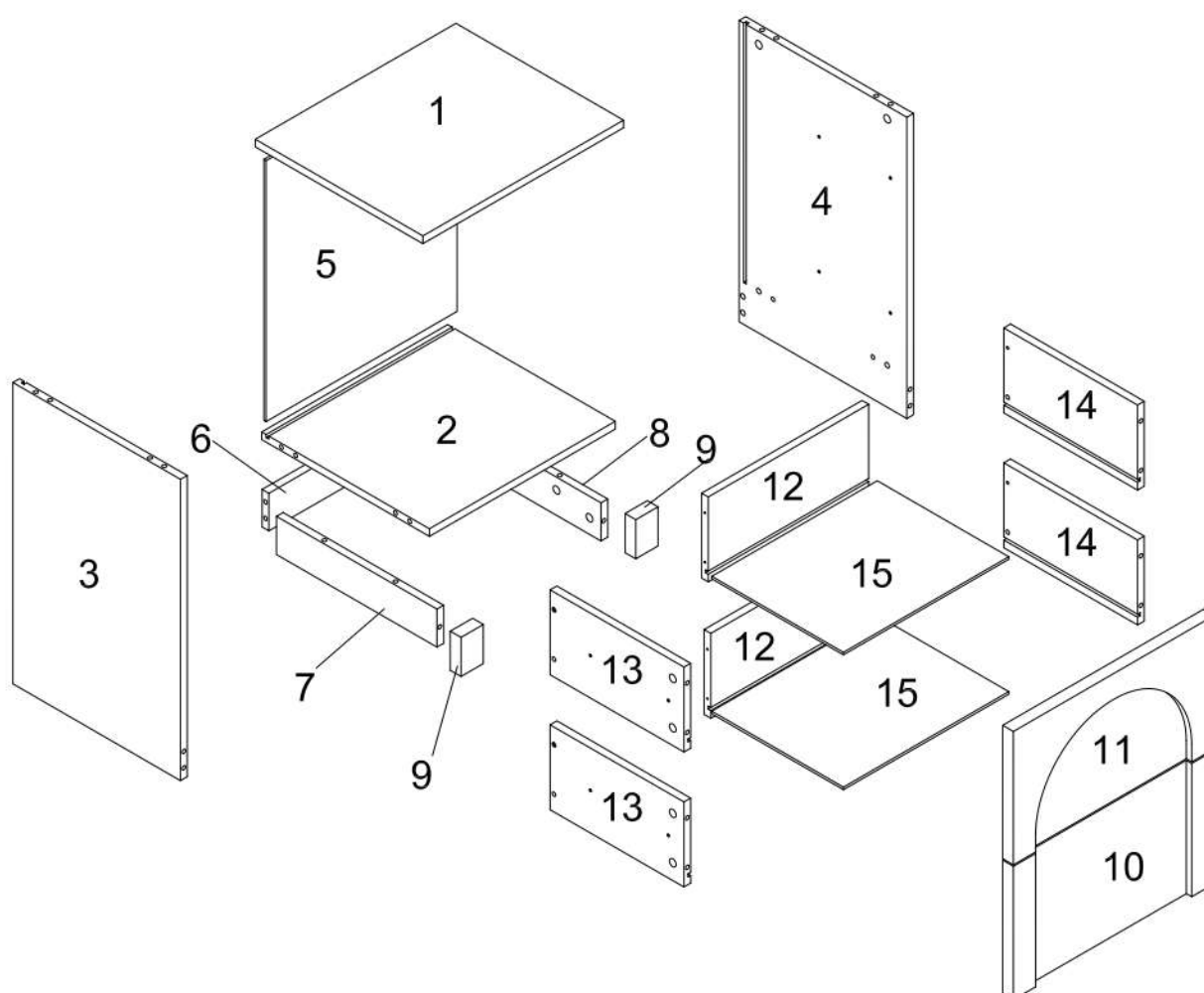

STEP 1

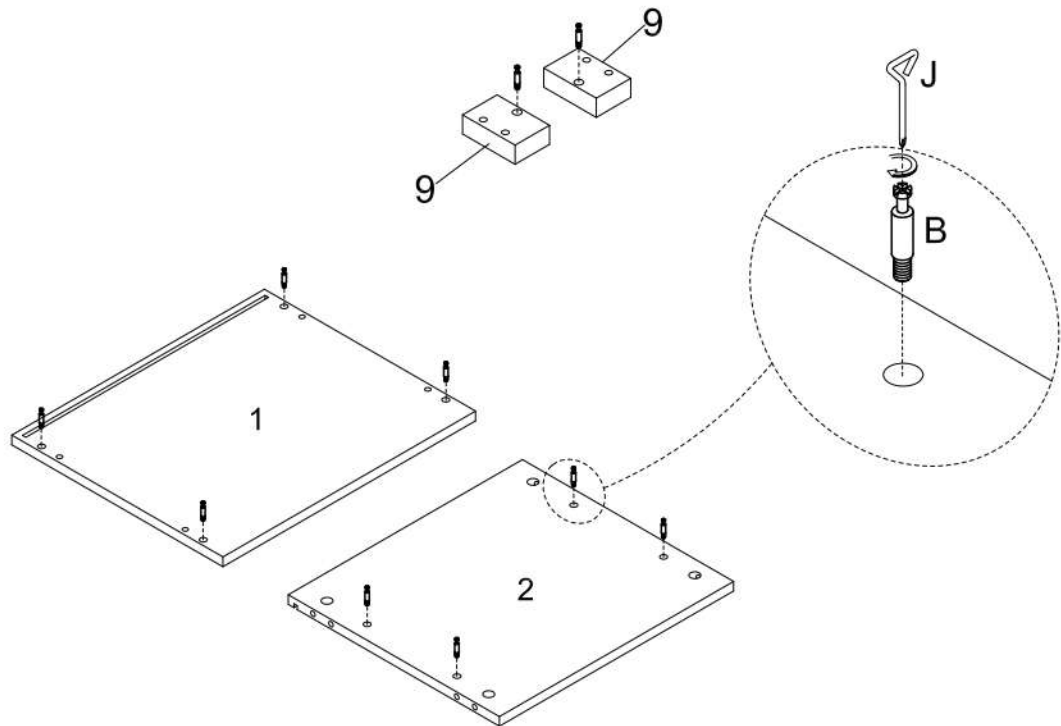

No. B
Quantity:10 Pcs



No. J
Quantity:1 Pc



STEP 2

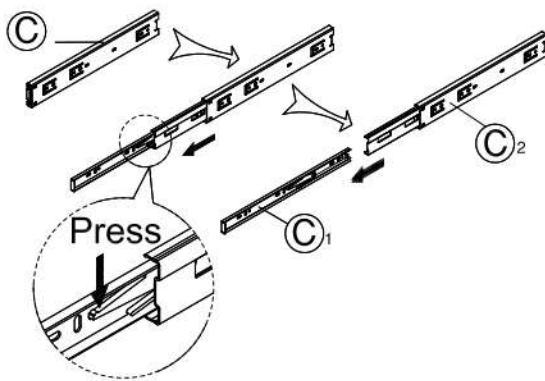

NOTE:Please through the hole in the center.



Last Third Hole

Second Hole

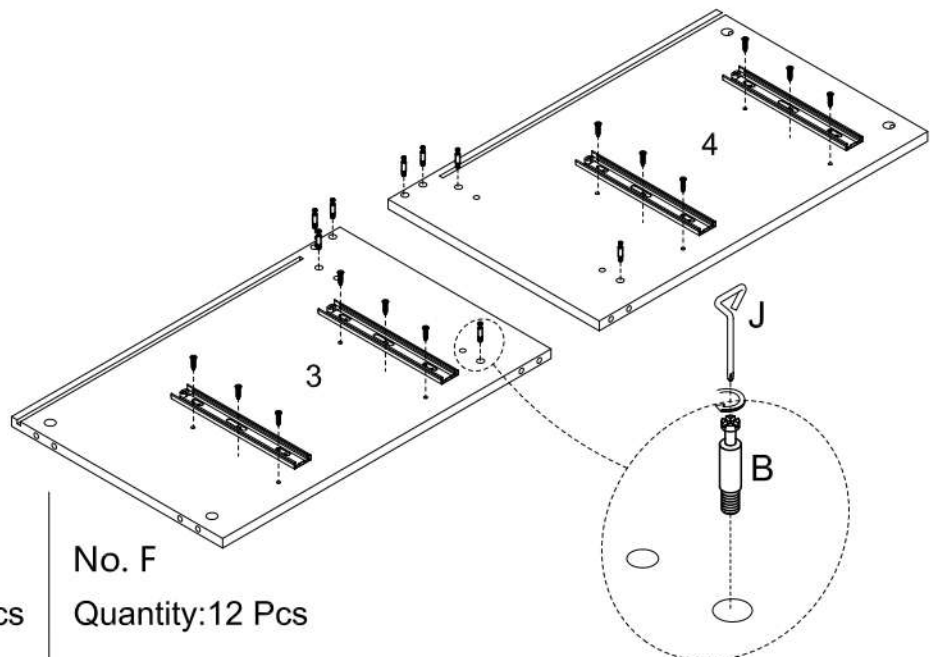

No. B
Quantity:8 Pcs



No. C
Quantity:4 Pcs



C₂

No. F
Quantity:12 Pcs



STEP 3

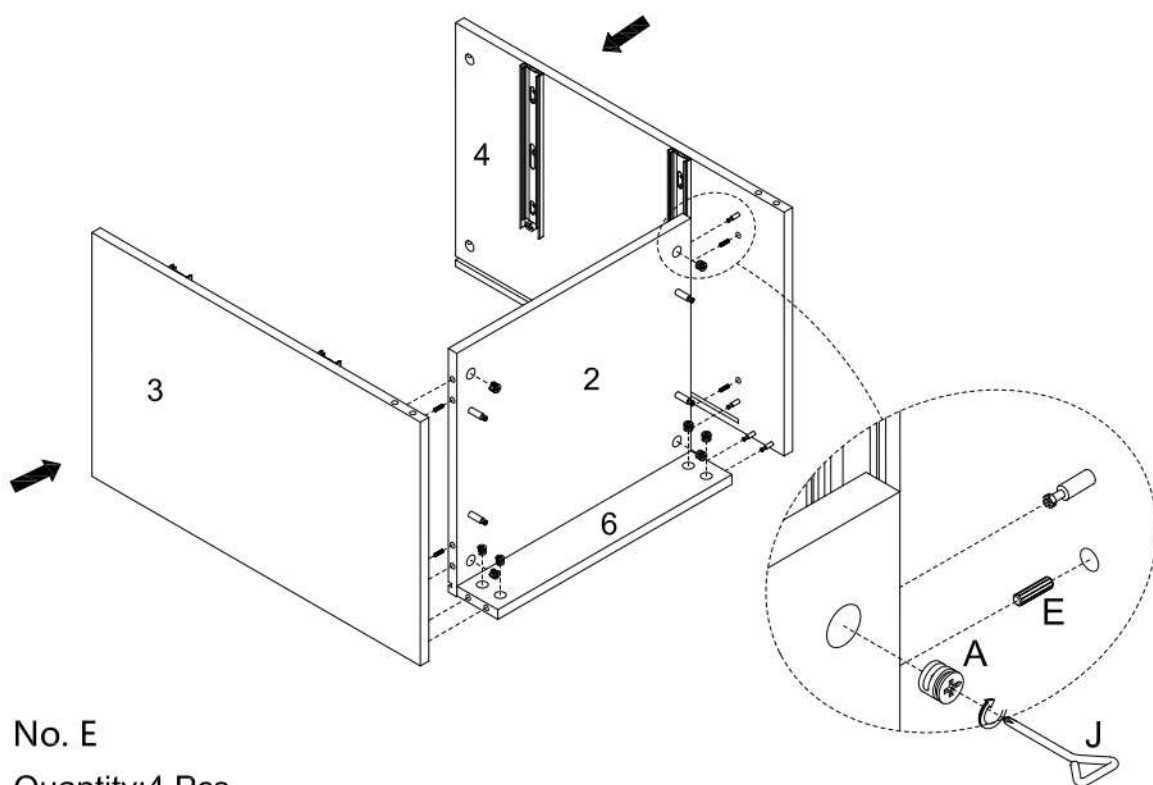

No. A
Quantity:8 Pcs



No. E
Quantity:4 Pcs



STEP 4

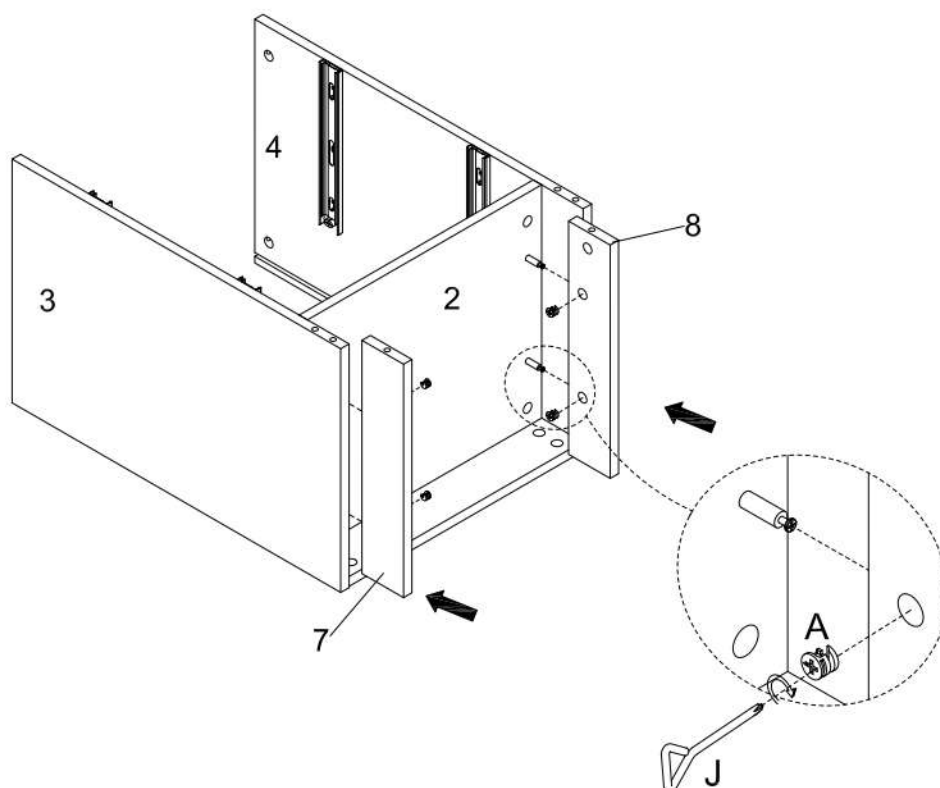

No. A
Quantity:4 Pcs



STEP 5

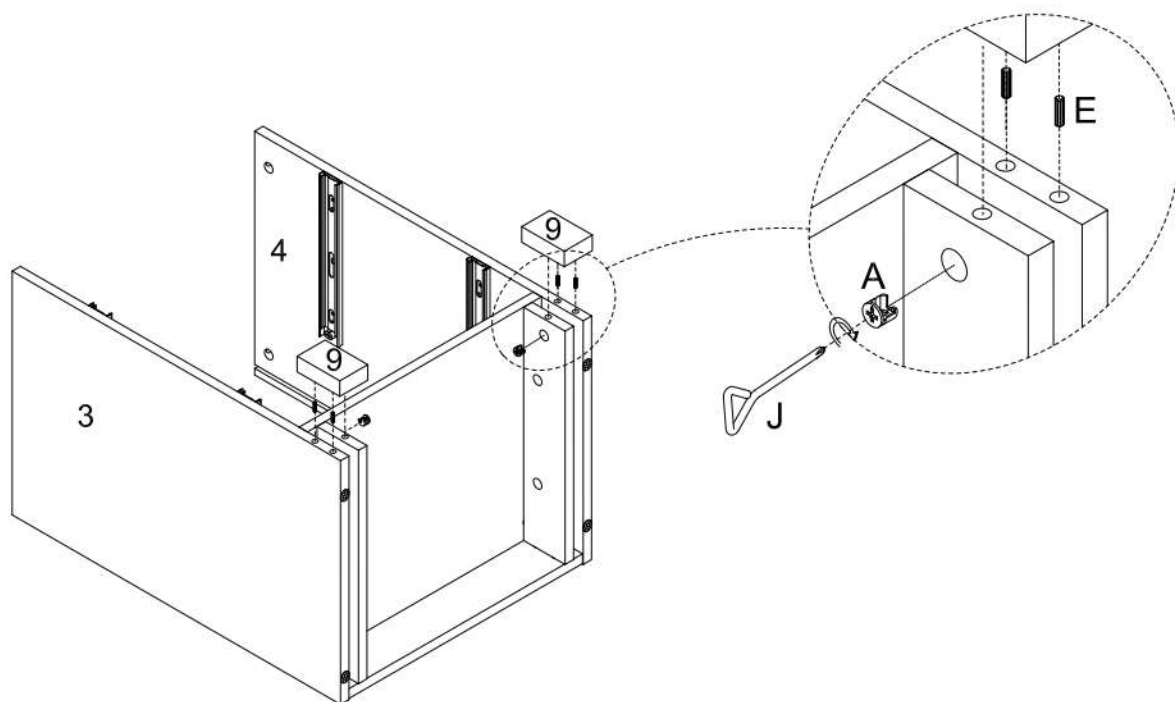

No. A
Quantity:2 Pcs



No. E
Quantity:4 Pcs



STEP 6

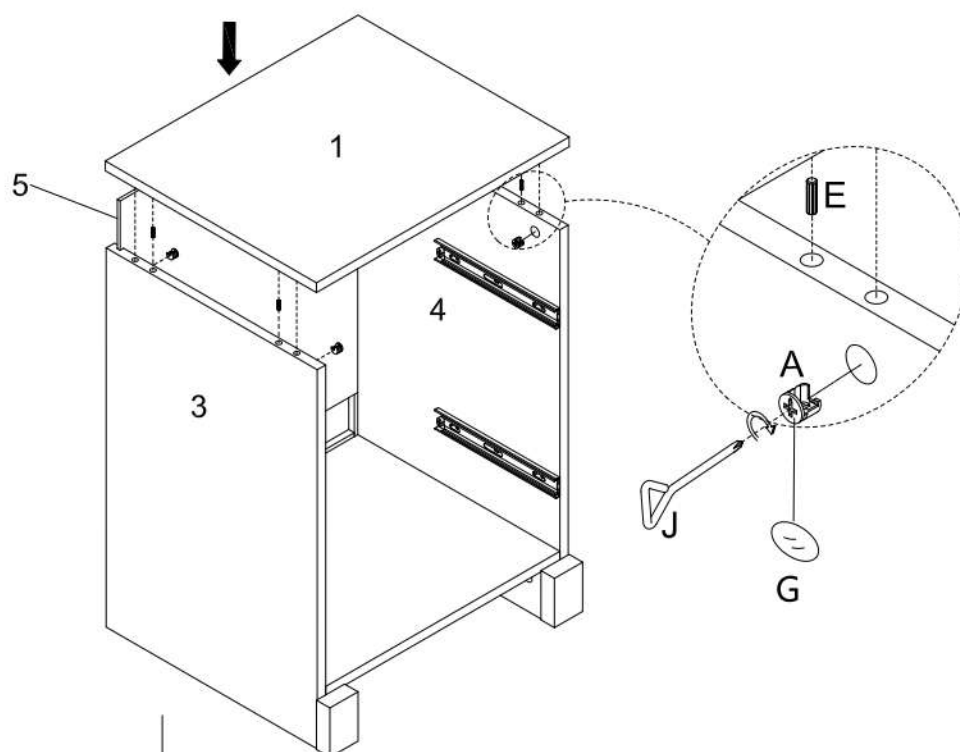

No. A
Quantity:4 Pcs



No. E
Quantity:4 Pcs



No. G
Quantity:18 Pcs



STEP 7

All drawers in the same way for installing drawer box.

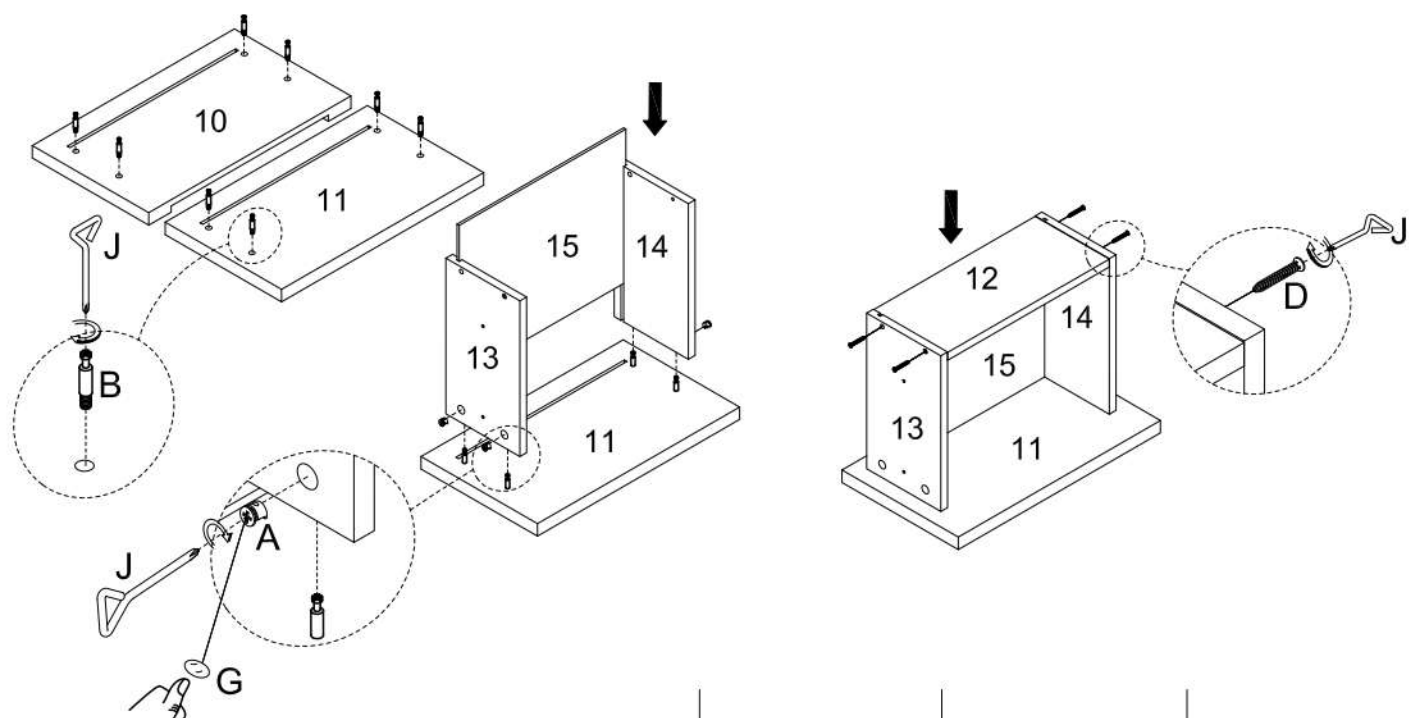

No. A

Quantity:8 Pcs



No. B

Quantity:8 Pcs



No. D

Quantity:8 Pcs



No. G

Quantity:8 Pcs



STEP 8

All drawers in the same way for installing runner.

NOTE:Please through the hole in the center.

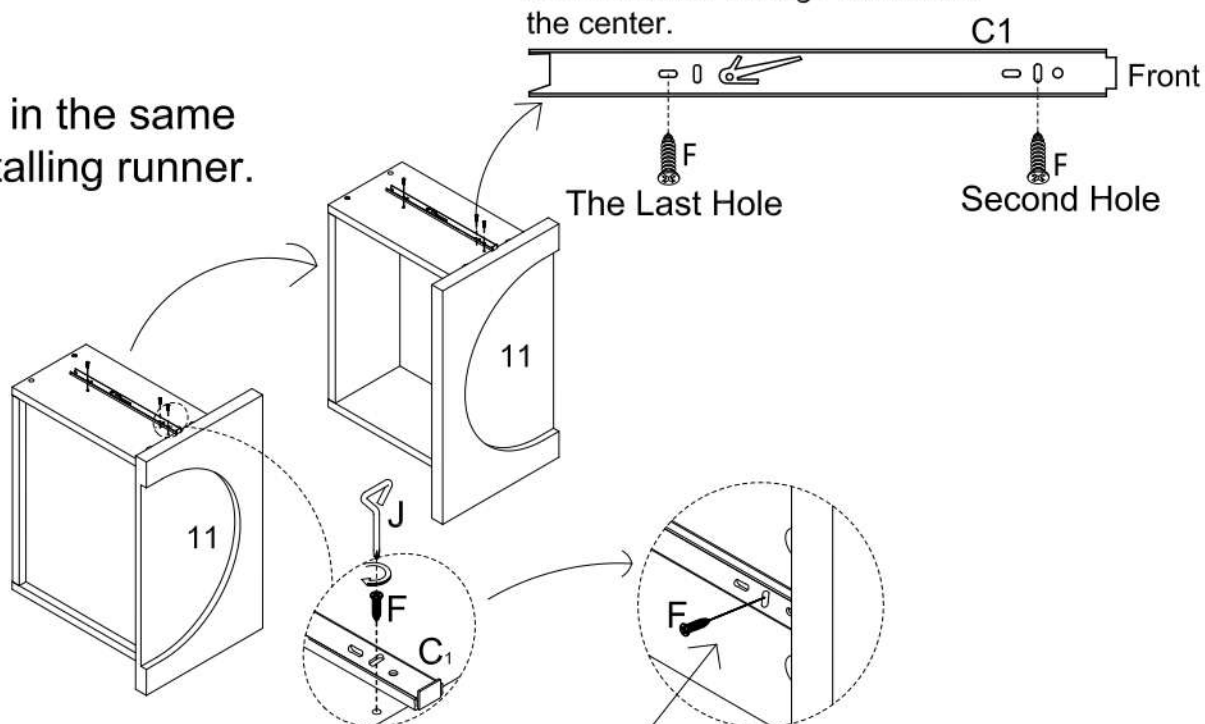

No. C

Quantity:4 Pcs

C₁



No. F

Quantity:12 Pcs



This screw can adjust the gap between the higher and lower, the position of screw remains the same, just loosen the slide rail up and down.

STEP 9

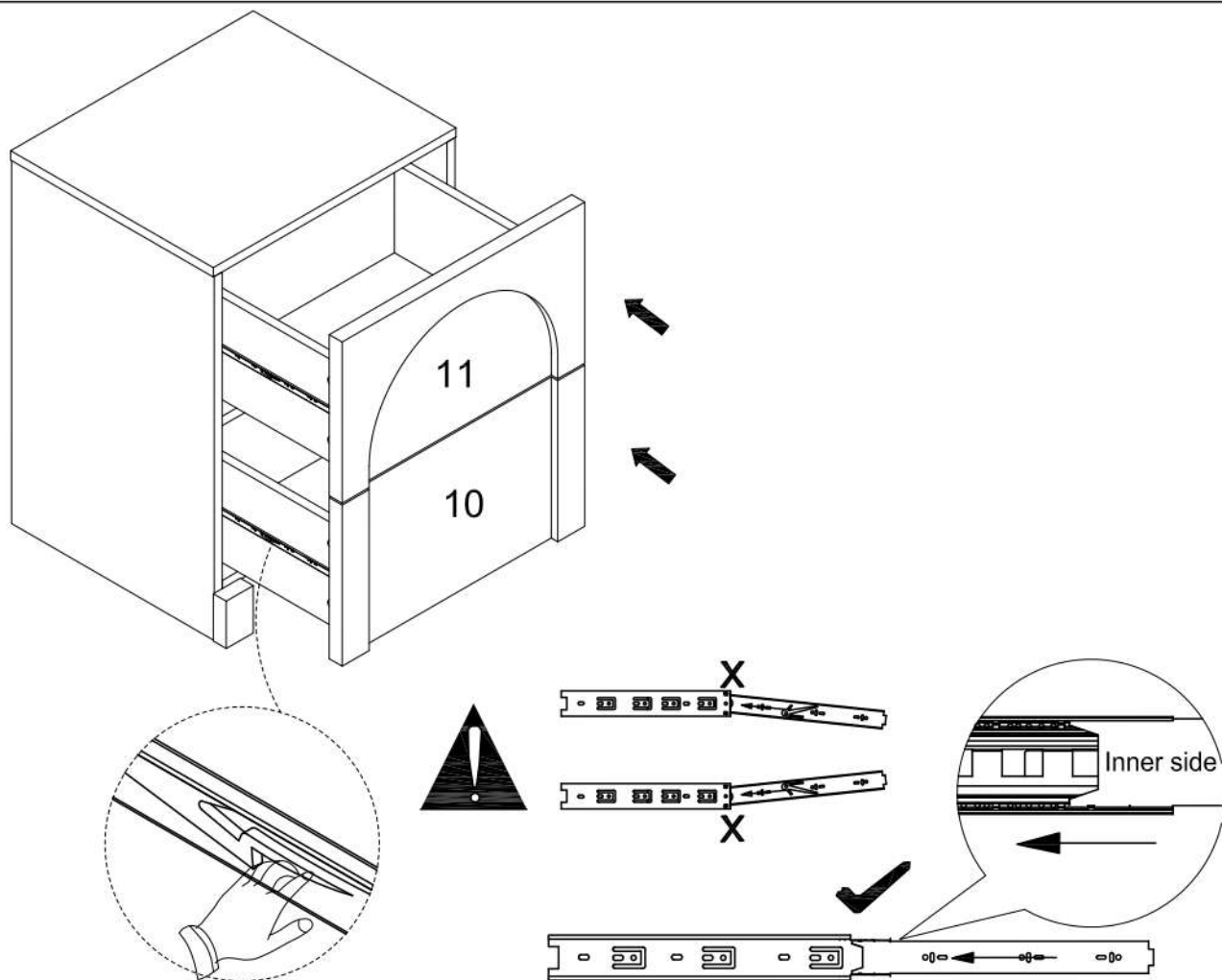

STEP 10

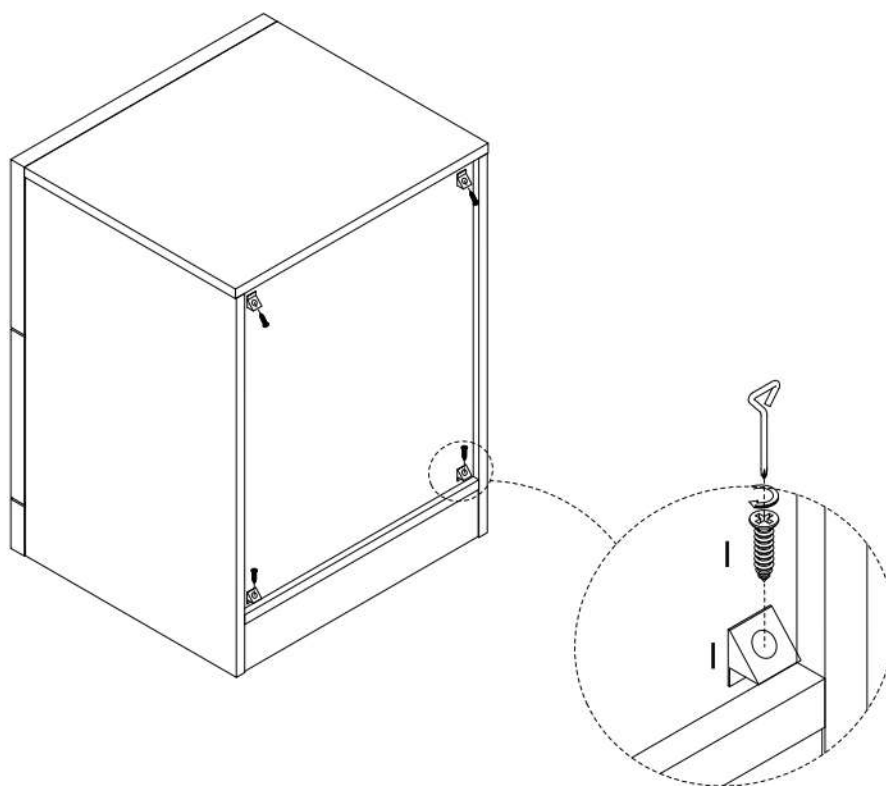

No. 1

Quantity: 4 Pcs

