

ASSEMBLY INSTRUCTIONS
SOPHIE NATURAL
EXTENSION DINING TABLE

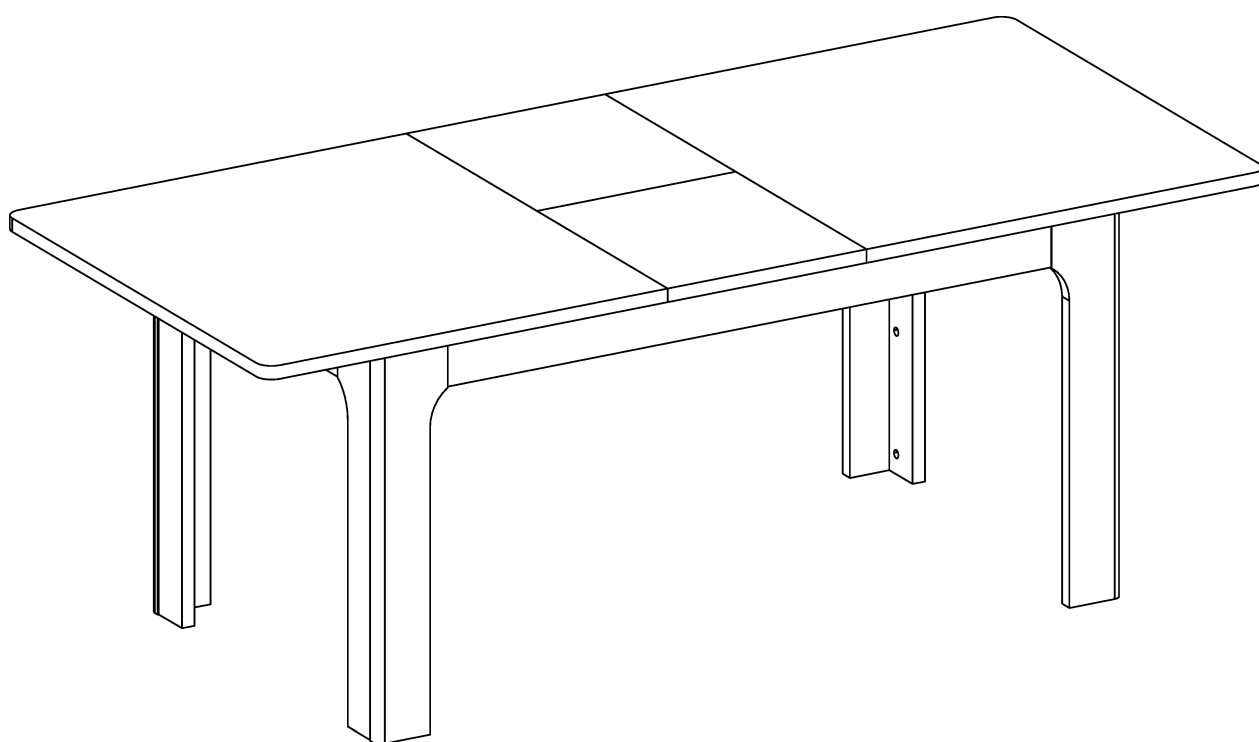

Two people required

www.templeandwebster.com.au

Keep these instructions for future reference

Assemble the furniture on a soft level surface to avoid damaging the furniture or your floor.

Parts of the assembly will be easier with 2 people.

We recommend furniture be assembled near where they will be placed, to avoid moving the product unnecessarily once assembled.

If there is a need to move the furniture, please remove all loose items and have extra hands to help lift the furniture to the desired location. Dragging the furniture will damage both the furniture and the floor.

Regularly check and re-tighten (if necessary) all bolts on furniture that you have assembled yourself.

Warning: In order to prevent overturning, this product must be used with the wall attachment device provided.

Do not stand on the Furniture

Care and Maintenance of your Furniture

Wipe clean with a damp cloth. Use only water or a gentle detergent.
Wipe dry with a clean cloth.

Tools Required

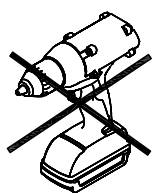

DO NOT USE

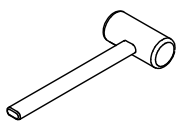

Mallet

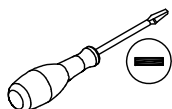

Flat head Screwdriver

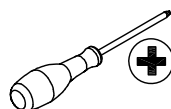

Cross Screwdriver

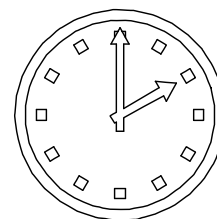

60 min

Part List

- | | |
|--------------------|---------------------------|
| 1 Left Top Panel | 9 Front Side Pillar |
| 2 Right Top Panel | 10 Side Support |
| 3 Middle Top Panel | 11 Divider Support |
| 4 Side Panel | 12 Right Divider Panel |
| 5 Front Panel | 13 Left Divider Panel |
| 6 Left Leg | 14 Rotary Support Panel |
| 7 Right Leg | 15 Bottom Divider Support |
| 8 Rear Side Pillar | |

people Required

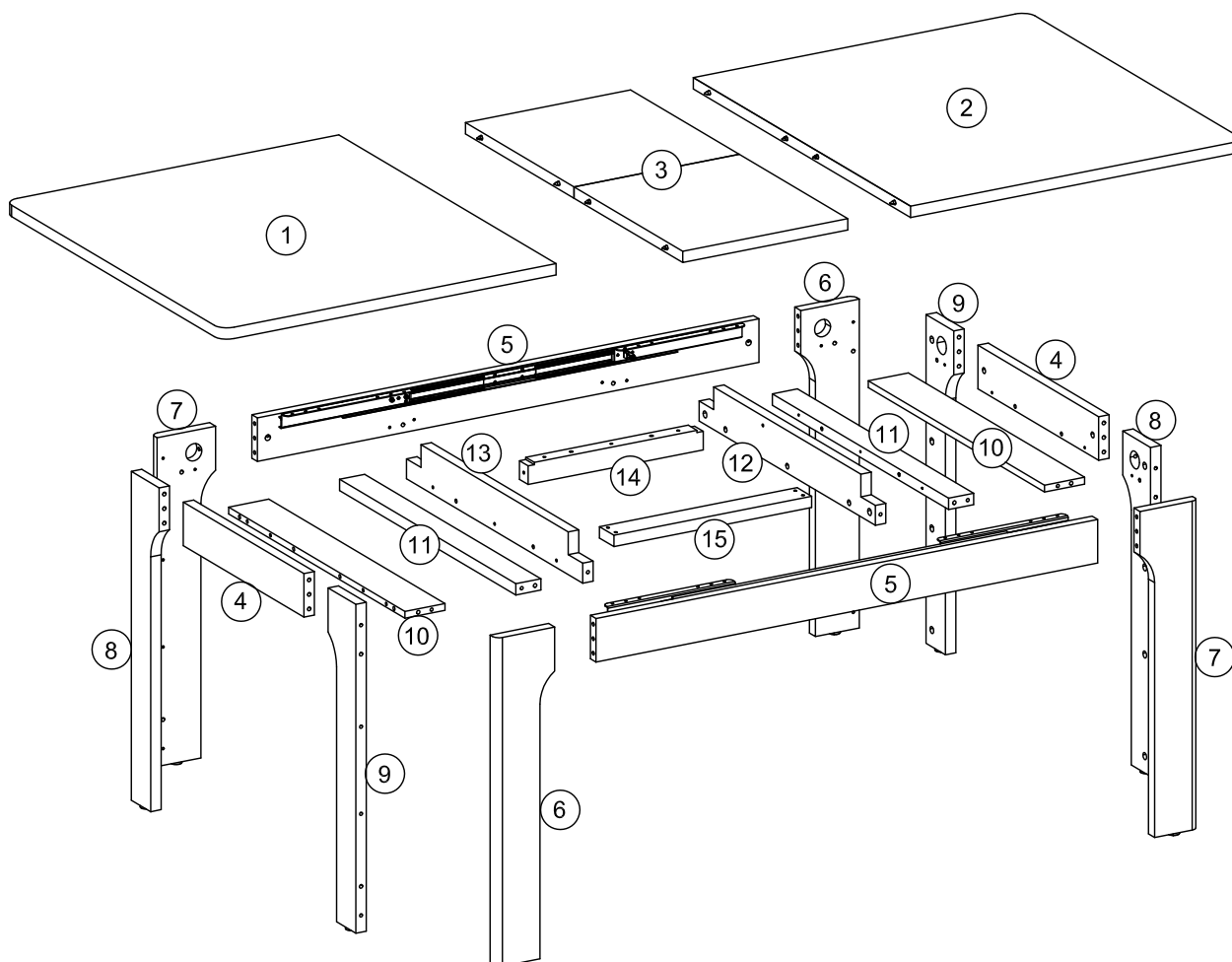

Hardware/Fittings

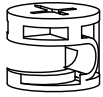

Ø15x12 mm Cam Lock x 36

A

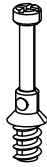

Ø7.5x32 mm Cam Bolt x 36

B

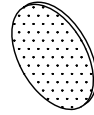

Ø20 mm Cam Sticker x 36

C



Ø8x32 mm Plastic Dowel x 30

D

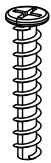

Ø10x33.5 mm Screw x 13

E



Ø4x10 mm Screw x 24

F



Fix Pin x 2

G



Ø8x40 mm Wooden Dowel x 16

H



Nut x 8

I

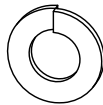

Washer Plate x 8

J



Threaded Bar x 8

K

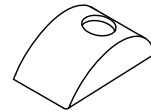

Half Moon Washer x 8

L

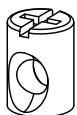

Barrel Nut x 8

M

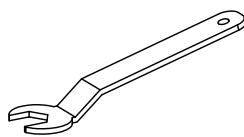

Spanner x 1

N



Nail Leg x 8

O

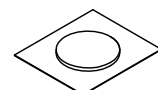

Buffer x 4

P

1

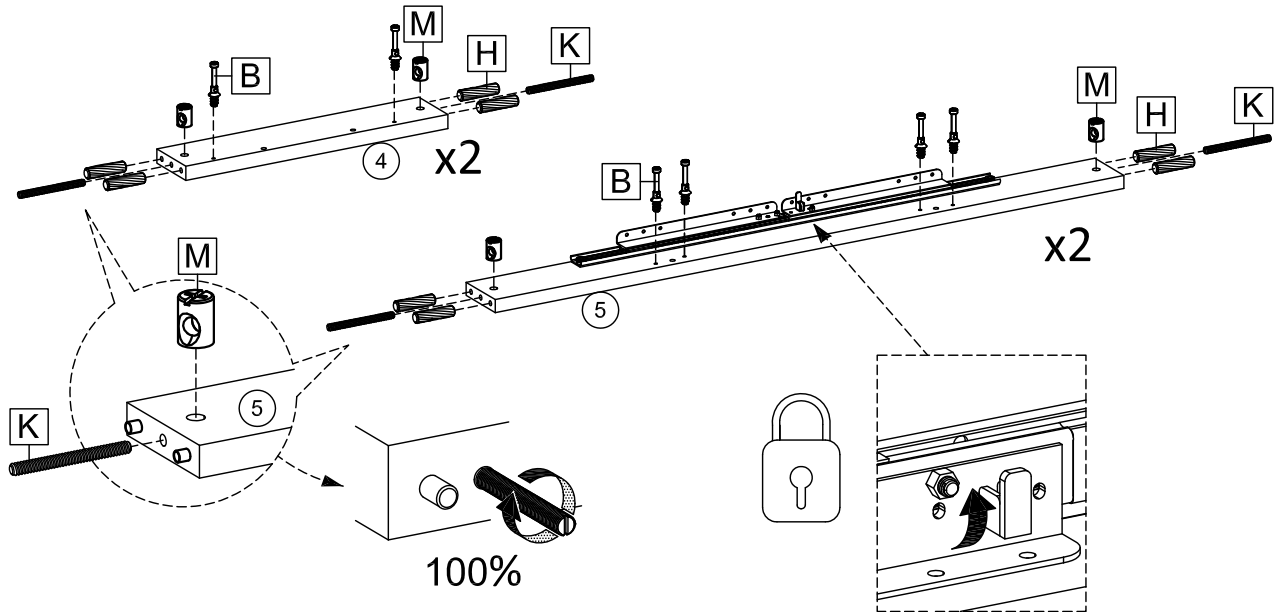
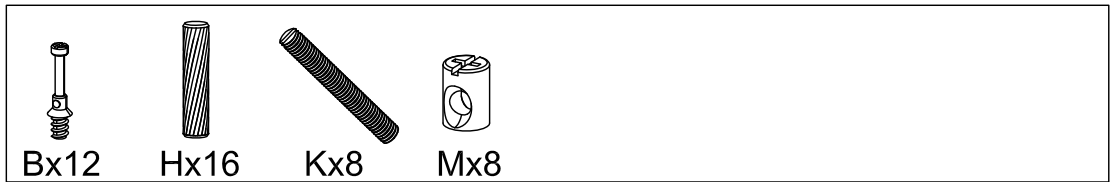

Screw 12 x Cam Bolts (B) into Side Panel (4) and Front Panel (5).
 Insert Barrel Nut (M) and Threaded Bar (K) into Side Panel (4) and Front Panel (5) as shown.
 Insert 16 x Wooden Dowel (H) into Side Panel (4) and Front Panel (5).
 If necessary, gently tap the Plastic dowels and Wooden dowels with a mallet.

2

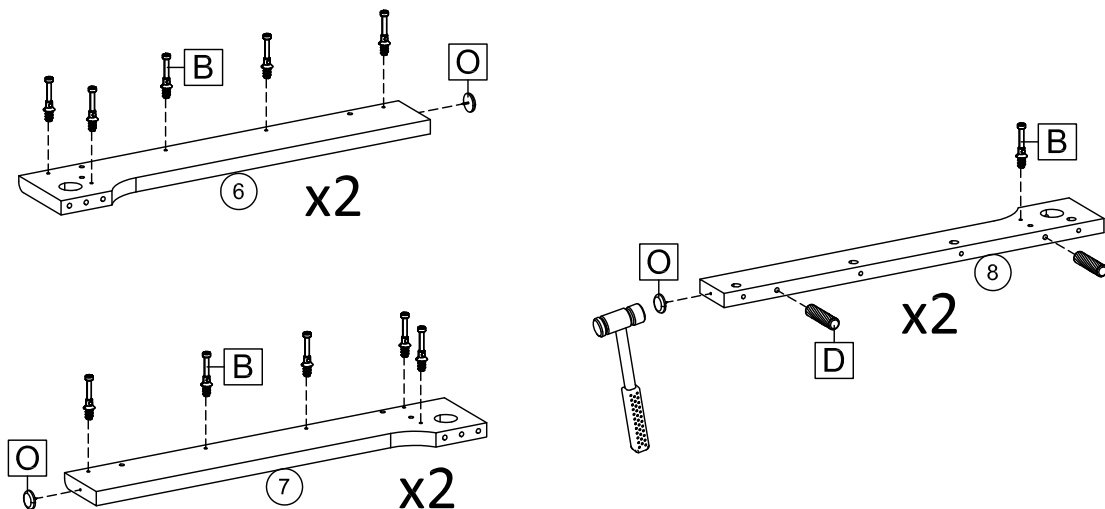
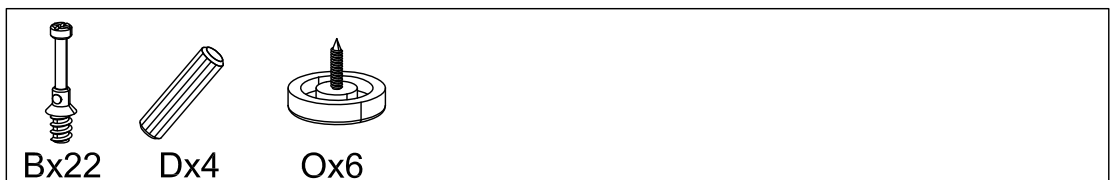

Screw 22 x Cam Bolts (B) into Left Leg (6), Right Leg (7) and Rear Side Pillar (8).
 Attach 6 x Nail Leg (O) into Left Leg (6), Right Leg (7) and Rear Side Pillar (8).
 Insert 4 x Plastic Dowel (D) into Rear Side Pillar (8).
 If necessary, gently tap the Plastic dowels and Nail Leg with a mallet.

3

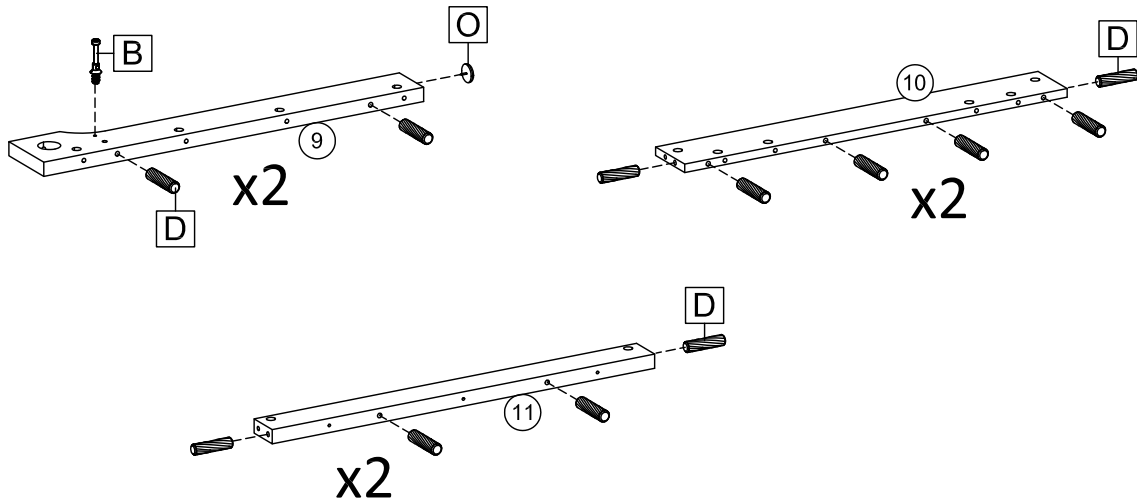
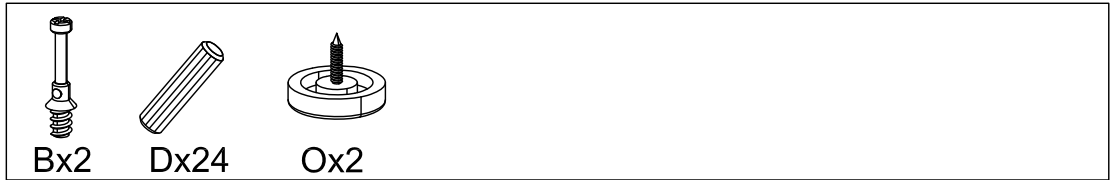

Screw 2 x Cam Bolts (B) into Front Side Pillar (9).
 Attach 1 x Nail Leg (O) into Front Side Pillar (9).
 Insert 24 x Plastic Dowel (D) into Front Side Pillar (9), Side Support (10) and Divider Support (11).
 If necessary, gently tap the Plastic dowels and Nail Leg with a mallet.

4

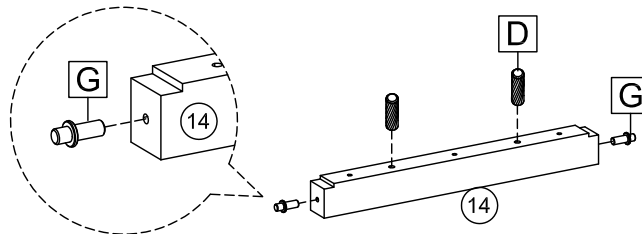

Insert 2 x Plastic Dowel (D) and 2 x Fix Pin (G) into Rotary Support Panel (14) as shown.
 If necessary, gently tap the Plastic dowels with a mallet.

5



Ex6

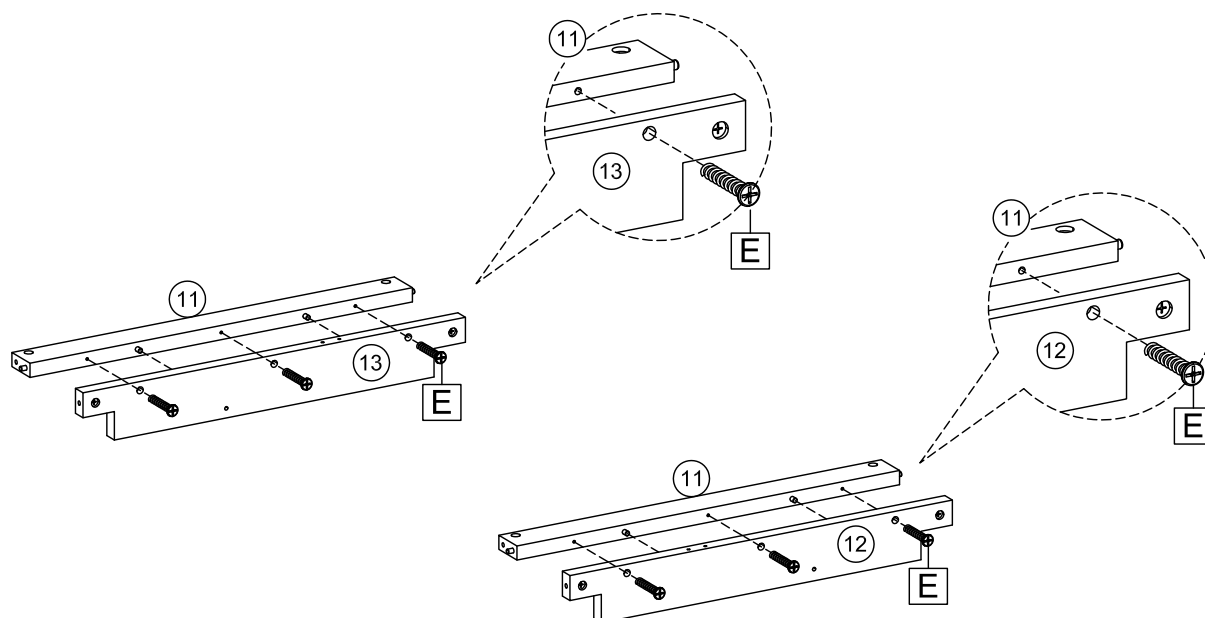

Attach Right Divider Panel (12) and Left Divider Panel (13) to Divider Support (11) using 6 x Screws (E).

6

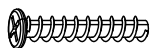

Ex4

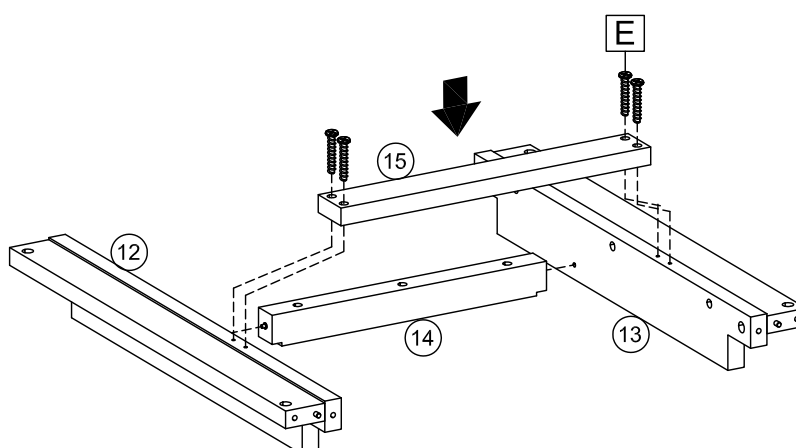

Attach Right Divider Panel (12) and Left Divider Panel (13) to Middle Top Support (14) as shown.
Attach Bottom Divider Support (15) to Right Divider Panel (12) and Left Divider Panel (13) using 4 x Screws (E).

7



Ix4



Jx4



Lx4

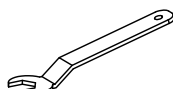

Nx1

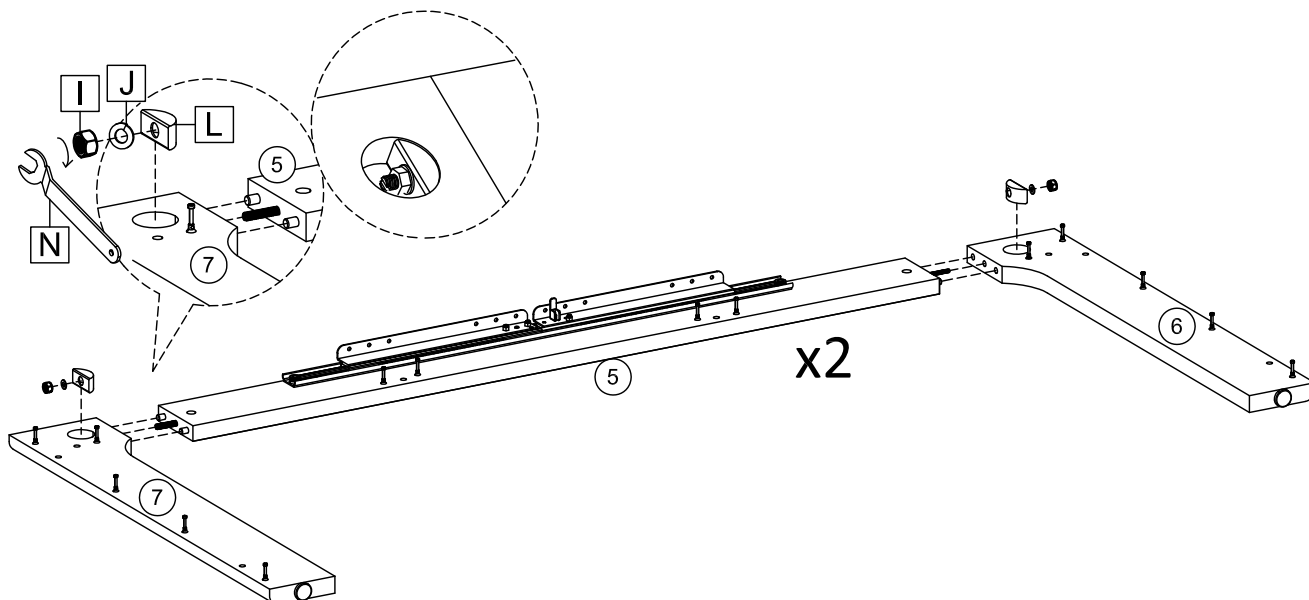

Attach Left Leg (6) and Right Leg (7) to Front Panel (5) using 4 x Nut (I), 4 x Washer Plate (J) and 4 x Half Moon Washer (L), Turn clockwise a spanner (N) to tighten.

8



Ix4



Jx4



Lx4

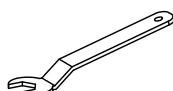

Nx1

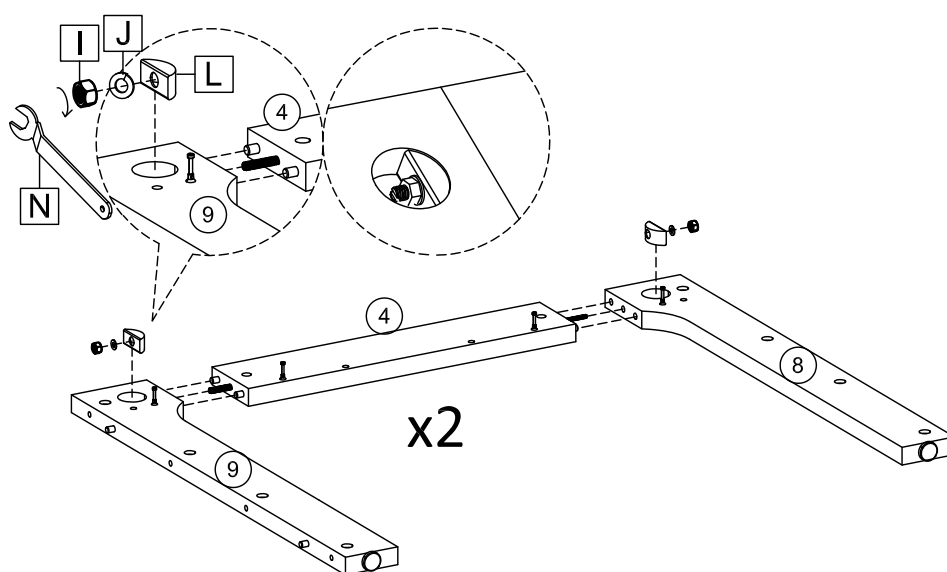

Attach Rear Side Pillar (8) and Front Side Pillar (9) to Side Panel (4) using Nut (I) Washer Plate (J) and Half Moon Washer (L), Turn clockwise a spanner (N) to tighten.

8

9



Ax8

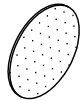

Cx8

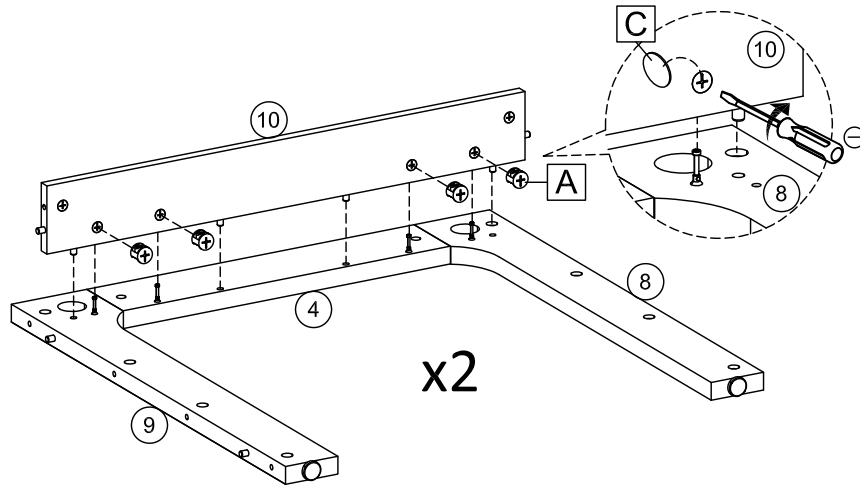

Attach Side Support (10) to Side Assembly using 8 x Cam lock (A) as shown,
Use a screwdriver to turn the Cam lock clockwise to lock.
Paste 8 x Cam Sticker (C) as shown.

10



Ax14

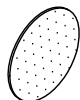

Cx14

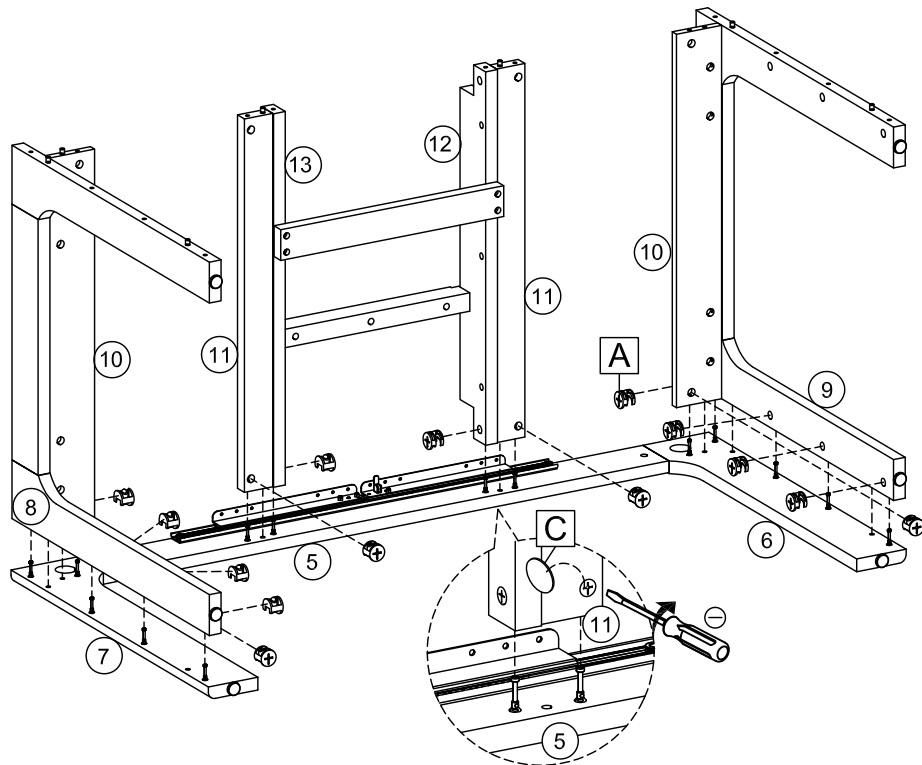

Attach 2 x Side Assembly and Divider Assembly to Front Assembly using 14 x Cam lock (A) as shown,
Use a screwdriver to turn the Cam lock clockwise to lock.
Paste 14 x Cam Sticker (C) as shown.

11



Ax14

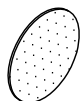

Cx14

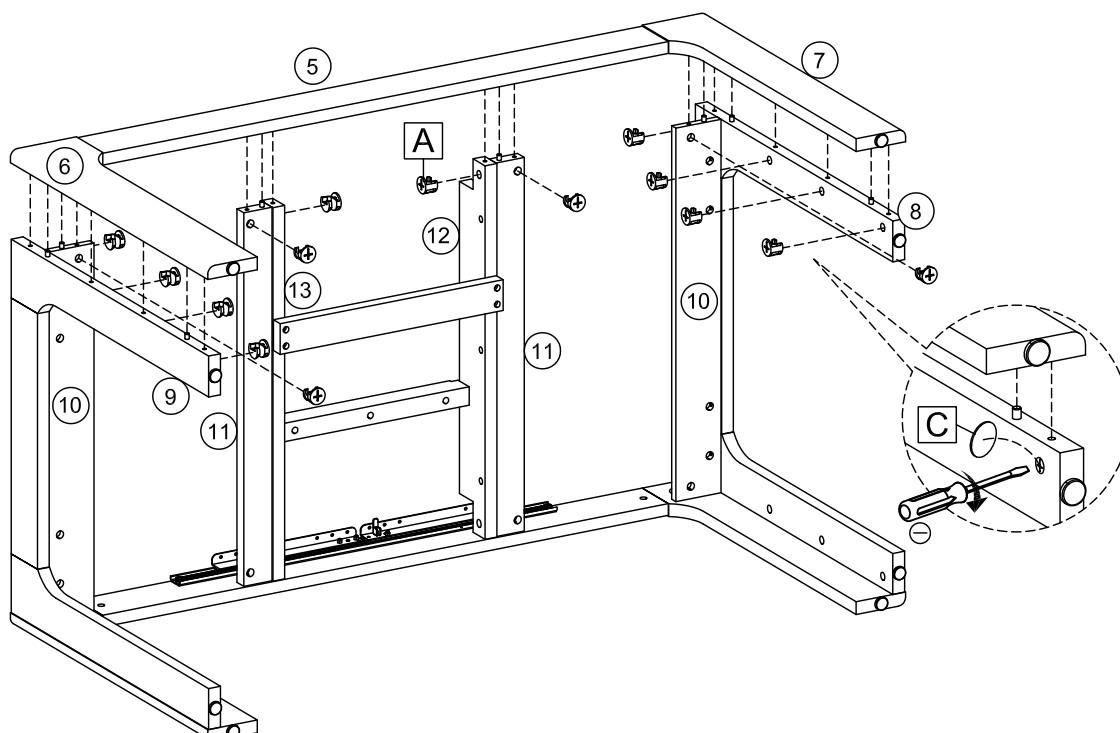

Attach Front Assembly to Case Assembly using 14 x Cam lock (A) as shown,
Use a screwdriver to turn the Cam lock clockwise to lock.
Paste 14 x Cam Sticker (C) as shown.

12

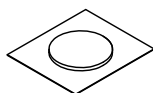

Px4

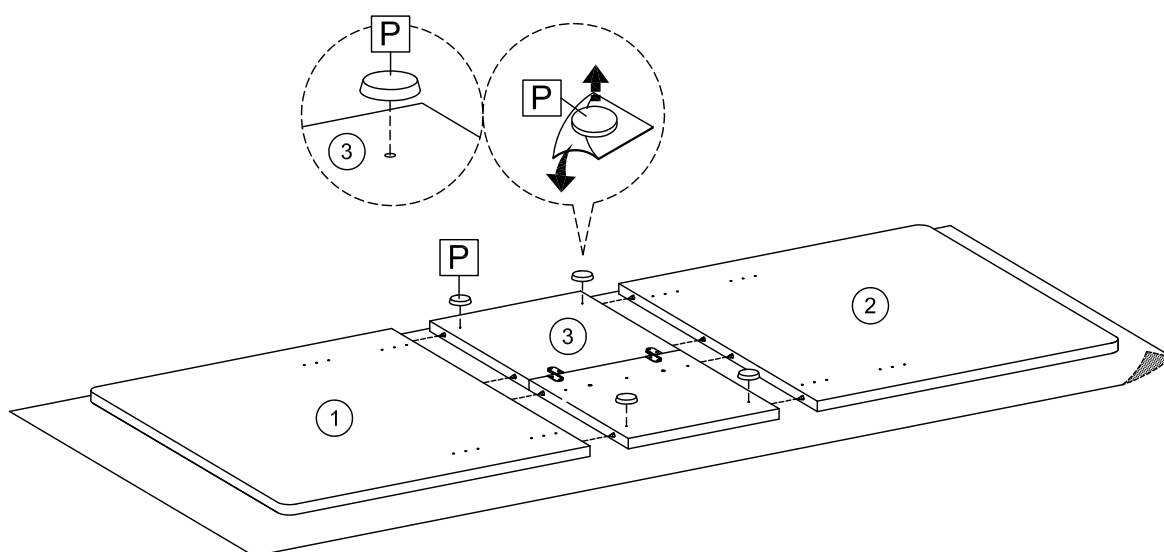

Attach Left Top Panel (1) and Right Top Panel (2) to Middle Panel (3) as shown.
Paste 4 x Buffer (P) as shown.

10

13



Ex3



Fx12

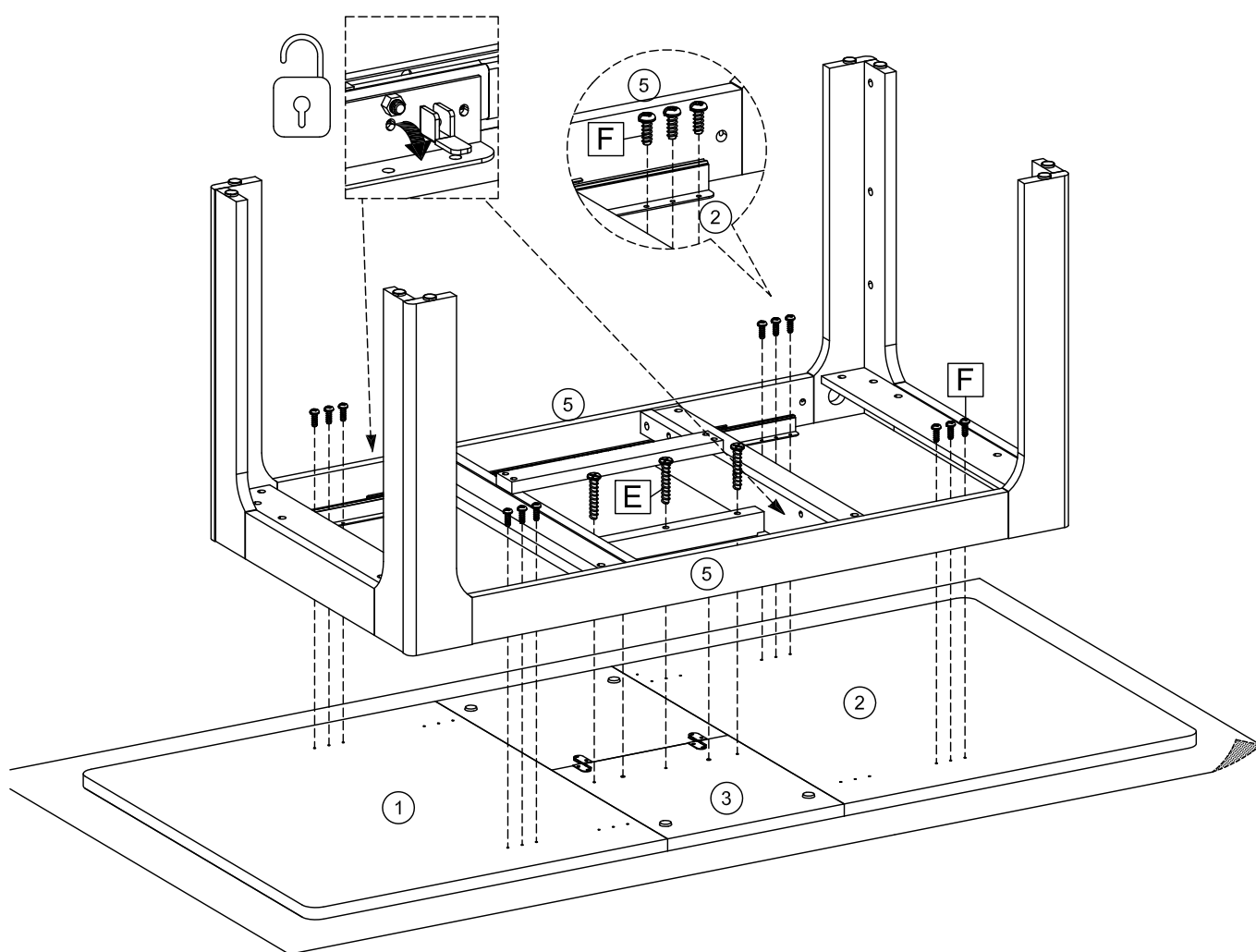

Attach Case Assembly to Top Assembly using 3 x Screws (E) and 12 x Screws (F) as shown.

14

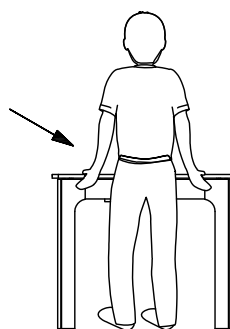
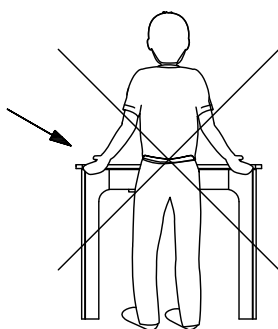
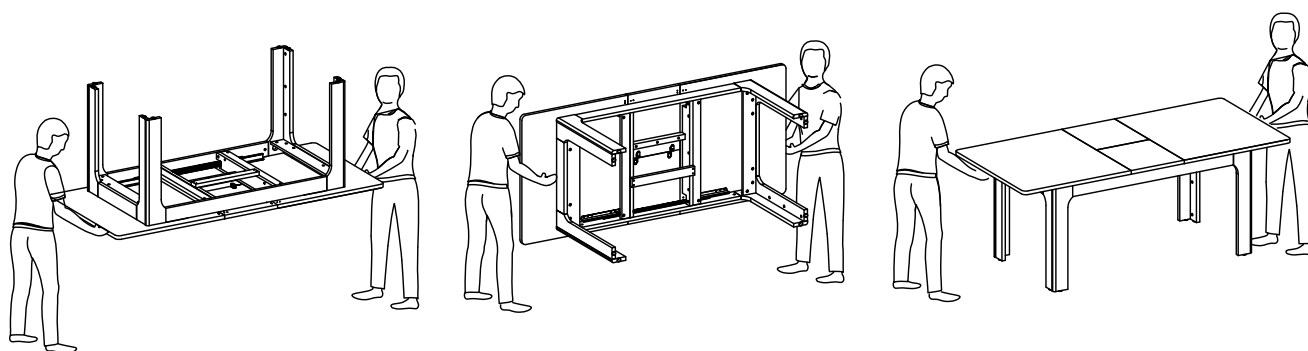
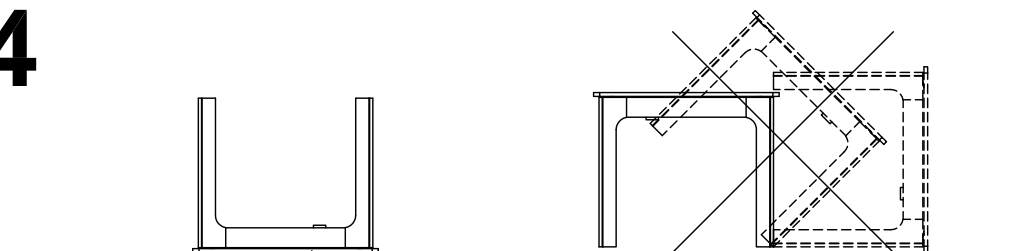

15

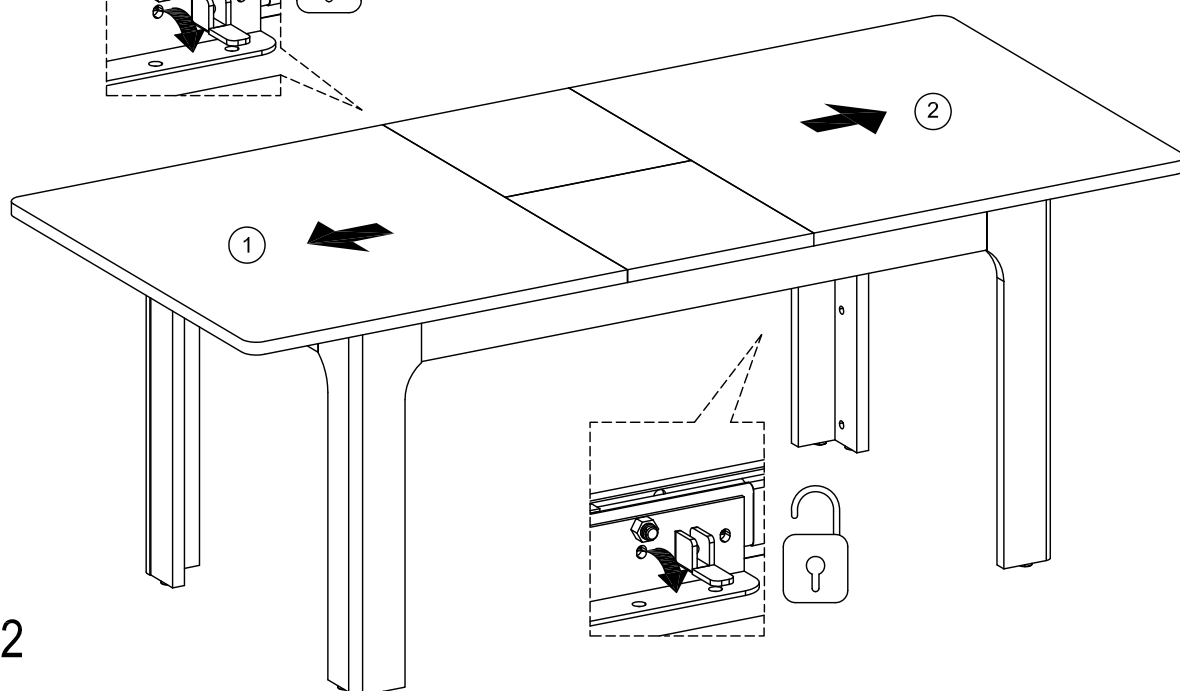
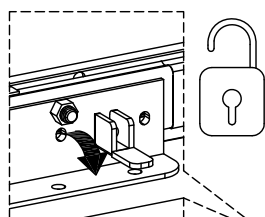

12

16



Fx12

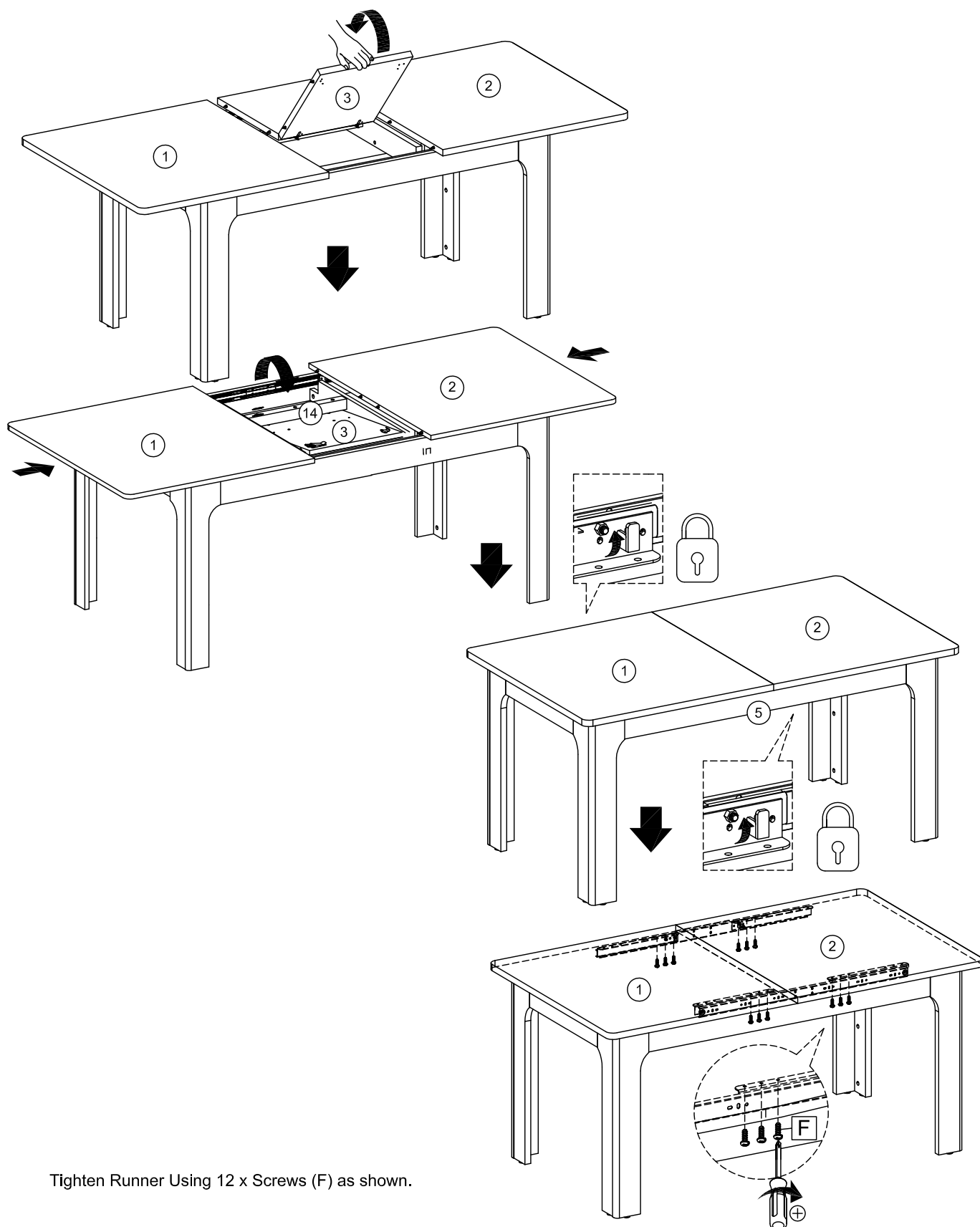

Tighten Runner Using 12 x Screws (F) as shown.

17

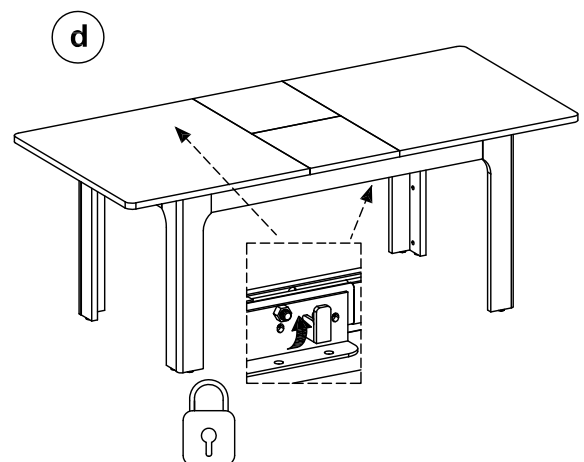
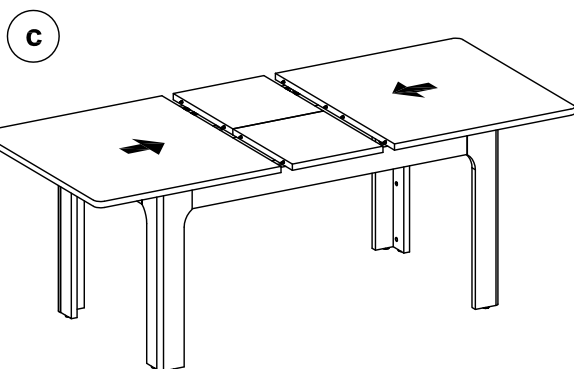
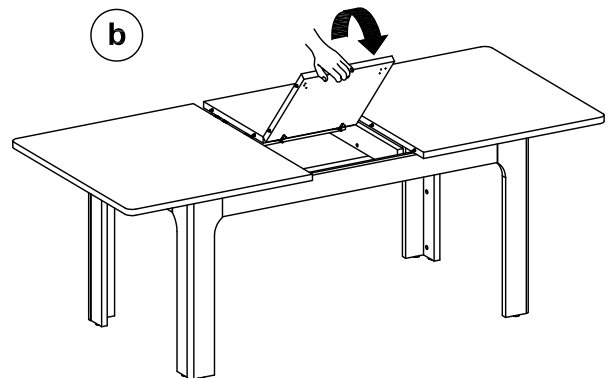
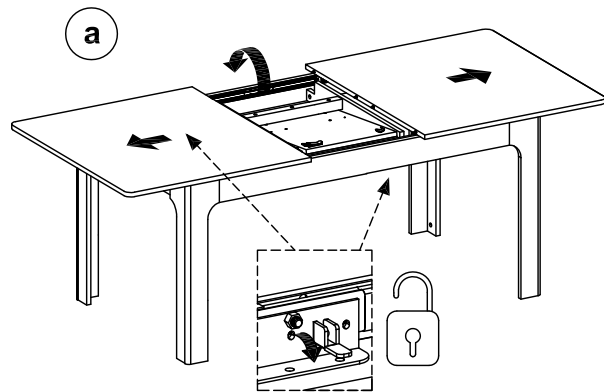
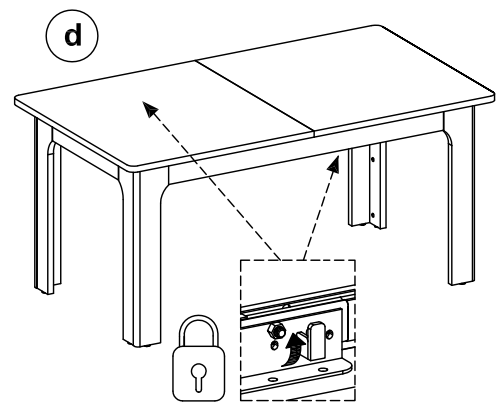
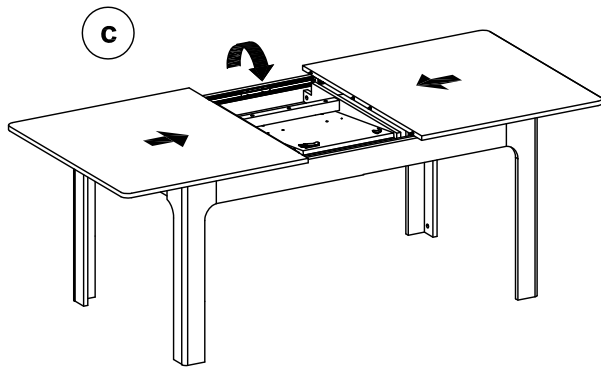
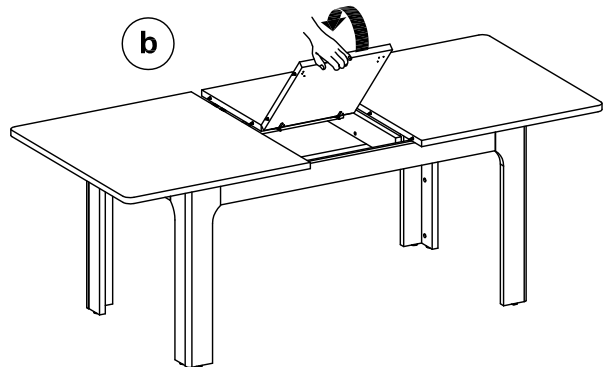
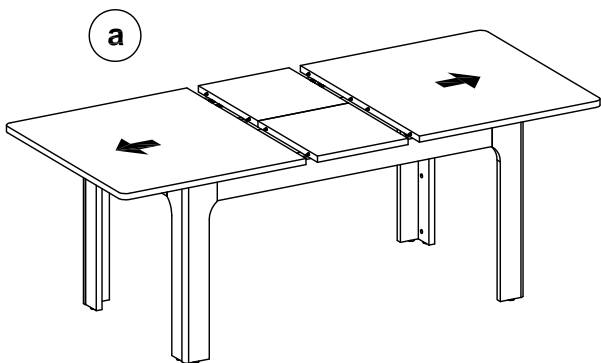

14

18

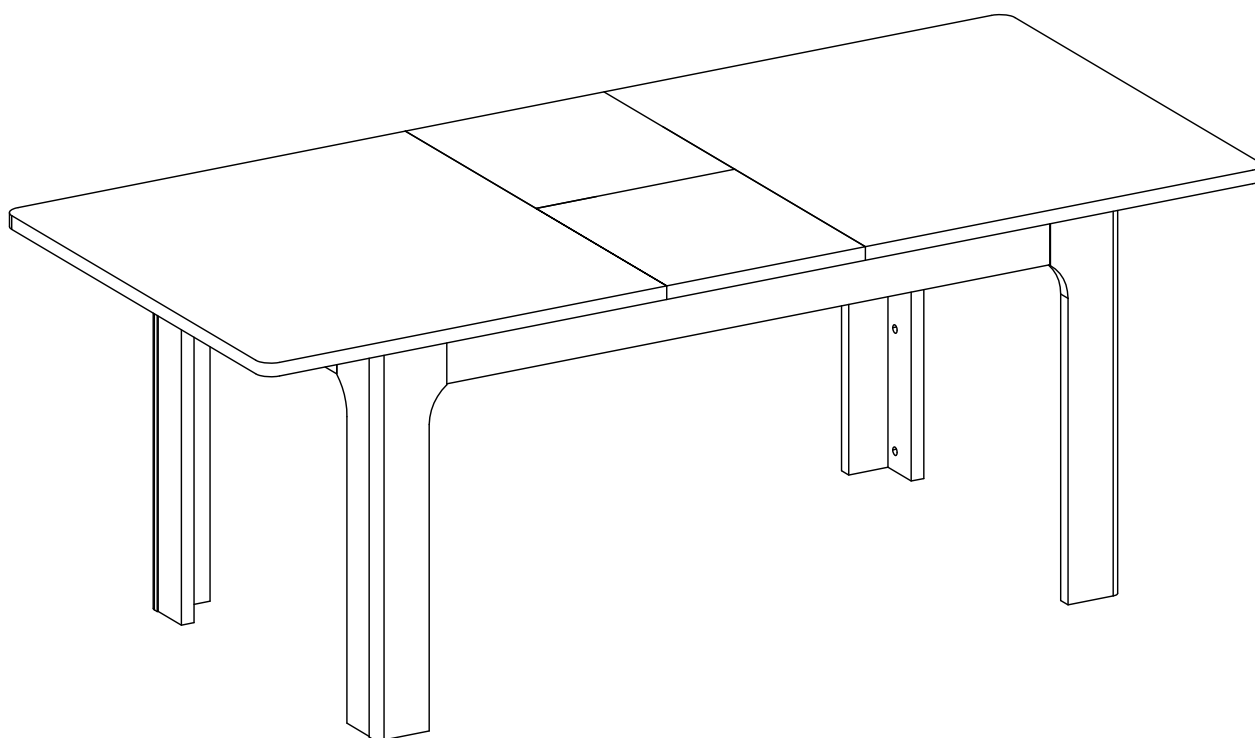

Assembly is complete.

**Please dispose of all
packaging thoughtfully**