

Thank you for purchasing this product. Before starting assembly we suggest you spend a short time reading through this leaflet, then follow the simple step by step guide. Two people are needed to assemble this product.

*Read these instructions and follow steps carefully to ensure you assemble the product correctly and avoid damages. Check that all parts and hardware have been provided before assembling the product. Place all contents on a clean, soft-flat surface to avoid scratching the product.*

**⚠ Caution:**

Only tighten bolts to 80% at first. Once all parts have been assembled fully tighten all hardware. To prevent damage to threads, do not use a power tool and do not overtighten bolts. Use two people to lift and turn the product when assembling. Do not attempt with only one person and do not roll onto legs. Keep all hardware and small parts away from children.

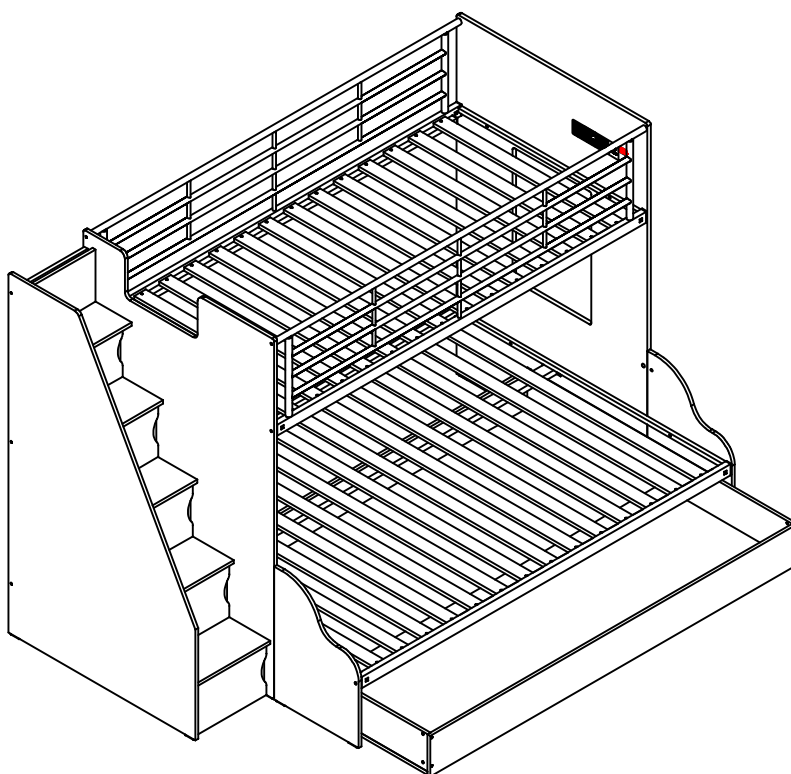
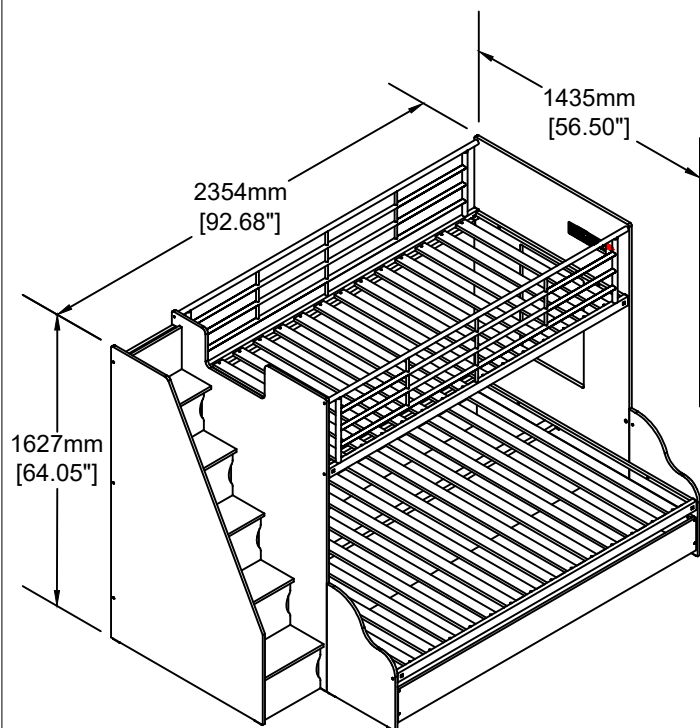

**TOP TIPS BEFORE YOU START !****IMPORTANT- READ CAREFULLY- RETAIN FOR FUTURE REFERENCE**

1. Please check that all parts & hardware are present before you start the assembly of your furniture.
2. For ease and speed of assembly, we recommend that before you commence each step of the assembly, Please identify all the parts required for that step.
3. We recommend that where possible, all items are assembled near to the area in which they will be placed in use, to Avoid moving the product unnecessarily once assembled.
4. For the protection of your furniture, particularly items of high gloss finish, we recommend that the product is placed on a Protected surface during assembly to prevent any damage.
5. During assembly please take care not to over-tighten any fittings, as this may damage the product.

**CARE AND MAINTENANCE OF YOUR FURNITURE**

- Please periodically check all fittings and re-tighten as necessary.
- To clean your item, please use a damp cloth and wipe clean.
- Never allow any kind of liquid to remain on your furniture. Absorption can cause wood to warp or finishes to de-laminate.
- Please do not place hot items (e.g hot drinks) directly on the wood surface.
- Please do not drag or pull your furniture.

**IMPORTANT INFORMATION**

1. Thickness of mattress should not exceed 228mm.
2. Children should be discouraged from playing on top of this bunk bed.
3. The bunk bed should be checked periodically by the owner to ensure that the guardrail, ladder, and other components are maintained in the correct position and state of repair and that all connectors are tight.
4. A bunk bed is not to be placed near a ceiling fan unless the distance between the closest points on the ceiling fan bunk Bed is at least 2 metres.
5. Use guardrails on both sides of upper bunk.
6. Prohibit horseplay on or under bed(s).
7. Prohibit more than one person on upper bunk.
8. Use Ladder for entering and leaving upper bunk.
9. If the bunk bed will be placed next to the wall, the guardrail that runs the full length of the bed should be placed against The wall to prevent entrapment between the bed and the wall.

**STRANGULATION HAZARD:**

10. Never attach or hang items to any part of the bunk bed that are not designed for use with the bed for example, but not limited to hook, belt and jump ropes.

#### Tools Required For Assembly

Phillips Screw Driver

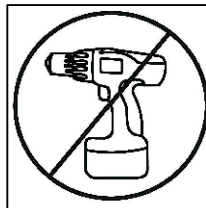
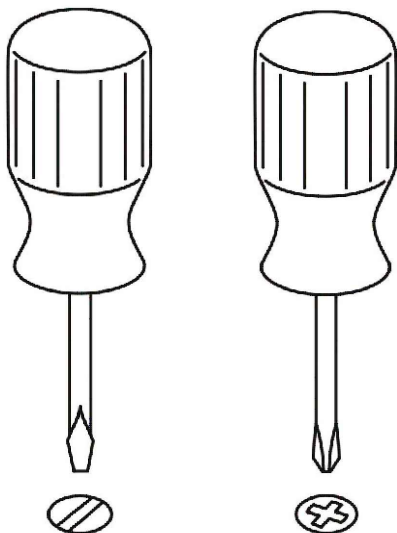

DO NOT USE POWER TOOLS TO ASSEMBLE THIS PRODUCT. USE OF POWER TOOLS WILL INVALIDATE ANY CLAIM AND MAY DAMAGE THIS PRODUCT MAKING IT UNSAFE.

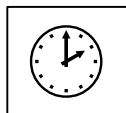

Approximately 3 hour



2 People Required

Rubber Hammer

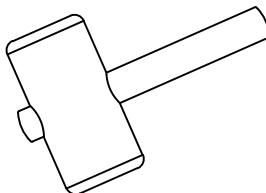

Tape Measure

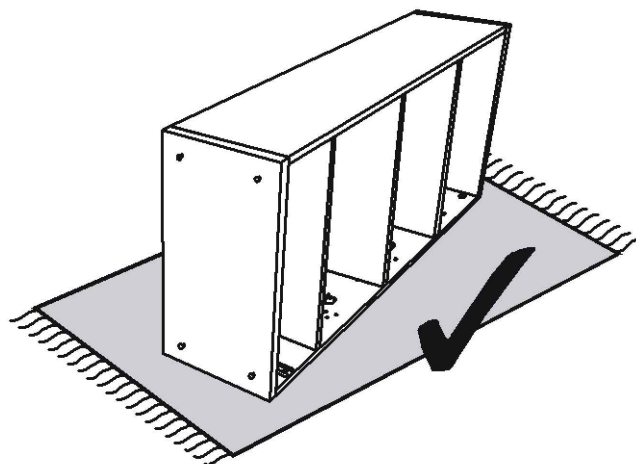
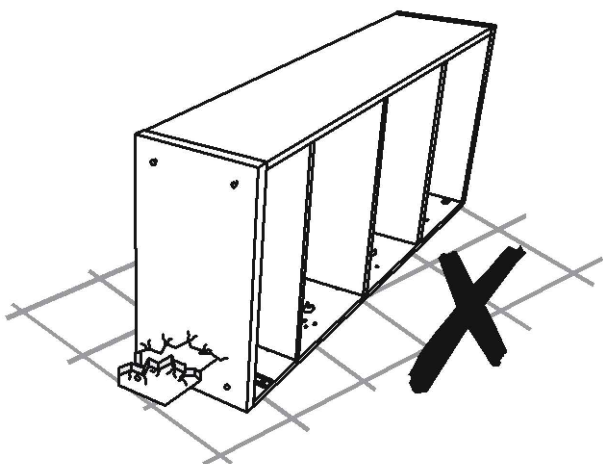
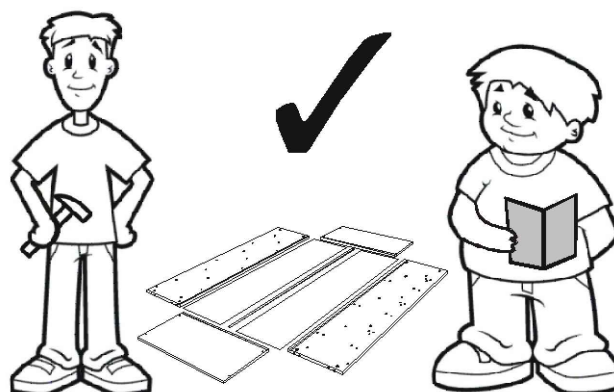
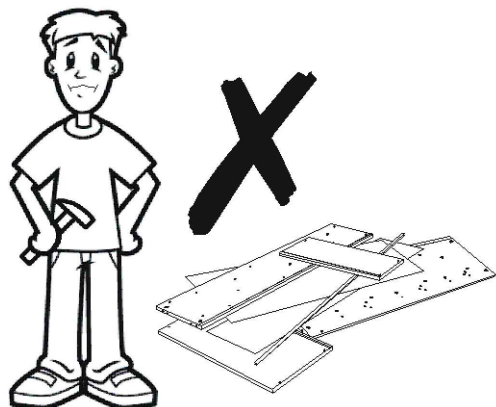
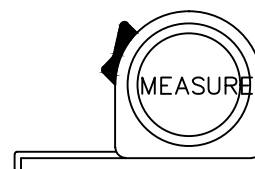

Carton 1 of 6			Carton 4 of 6		
No.	Part Name	Pcs	No.	Part Name	Pcs
16	Ladder Bottom Panel	1	07	Side Rail	2
17	Left Panel (1st Step)	1	08	Guardrail	2
18	Right Panel (1st Step)	1	09	Support Rail	2
19	Ladder Step (1st Step)	1	11	Support Rail	2
22	Ladder Step (2nd Step)	1	13	Back Support Rail	3
23	Left Panel (3rd Step)	1	38	Bottom Support Rail	1
24	Right Panel (3rd Step)	1	Carton 5 of 6		
25	Ladder Step (3rd Step)	1			
26	Left Panel (4th Step)	1	02	Back Panel (Trundle)	1
27	Right Panel (4th Step)	1	03	Left Panel (Trundle)	1
28	Ladder Step (4th Step)	1	04	Right Panel (Trundle)	1
31	Ladder Step (5th Step)	1	05	Front Panel (Trundle)	1
32	Ladder Back Panel	1	20	Left Panel (2nd Step)	1
Assembly Instructions + Fitting List			21	Right Panel (2nd Step)	1
			29	Left Panel (5th Step)	1
			30	Right Panel (5th Step)	1
Carton 2 of 6			36	Right Support Panel	1
33	Ladder Left Panel	1	37	Left Support Panel	1
34	Ladder Door	1		LVL Slats (Long)	14
35	Ladder Door	4	Carton 6 of 6		
	LVL Slats (Short)	14			
Carton 3 of 6			01	Bottom Panel (Trundle)	1
			06	Bottom Panel (Trundle)	1
14	Right End Panel	1			
15	Ladder Right Panel	1			



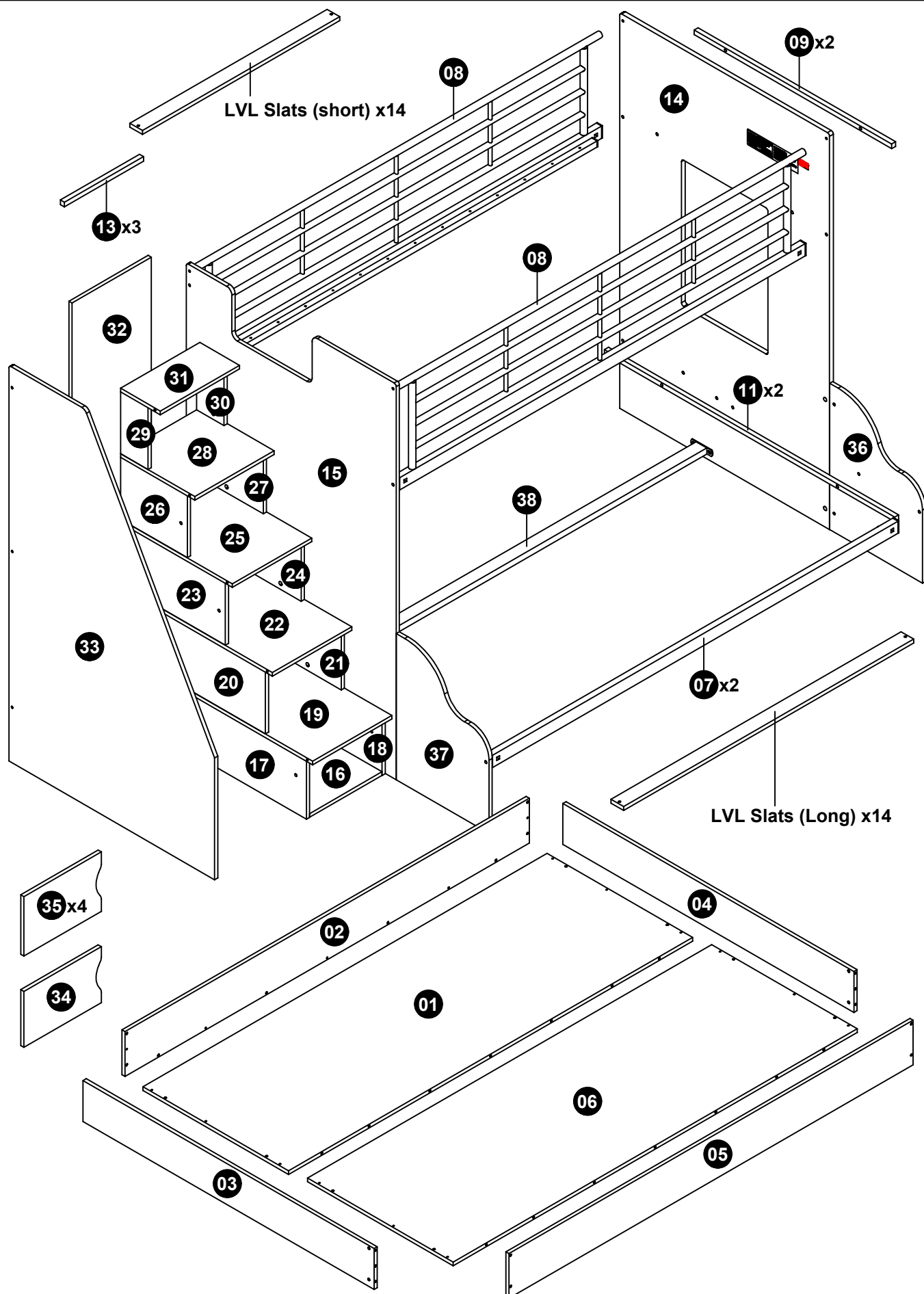

#### Carton 1 of 6

#### Fitting List

No.	Part Name		Pcs
A	Cam Stud (small)		45
B	Cam		52
C	Contractfix Dowel		7
D	M8 x 25mm Wood Dowel		88
E	45mm Chipboard Screw		5
F	38mm Chipboard Screw		17
G	14mm Chipboard Screw		64
H	Hinges Arm		10 set
J	40mm White Nylon Caster		12
K	M6 x 13mm Baller		7
L	M6 Round Nut		4
M	M8 Square Nut		8
N	M8 x 60mm Allen Bolt		8
P	M6 x 50mm Allen Bolt		4
Q	M6 x 40mm Allen Bolt		10
R	M6 x 30mm Allen Bolt		64
S	M6 x 25mm Allen Bolt		10
T	M6 x 12mm Allen Bolt		4
U	M6 Allen Wrench		2
V	M8 Allen Wrench		1
W	Felt Pads (45 x 14mm)		16
X	M6 JCN Nut		4

#### Caution

There are many small components used in the construction of this unit. These loose items should be kept away from young children whilst assembling your unit. As an extra precaution, screw cover caps should be permanently fixed in position. (Where applicable)

#### USEFUL HINTS & TIPS

Two people will be required to assemble this unit

Please keep this assembly instruction for future reference

1



G x 20



H x 10

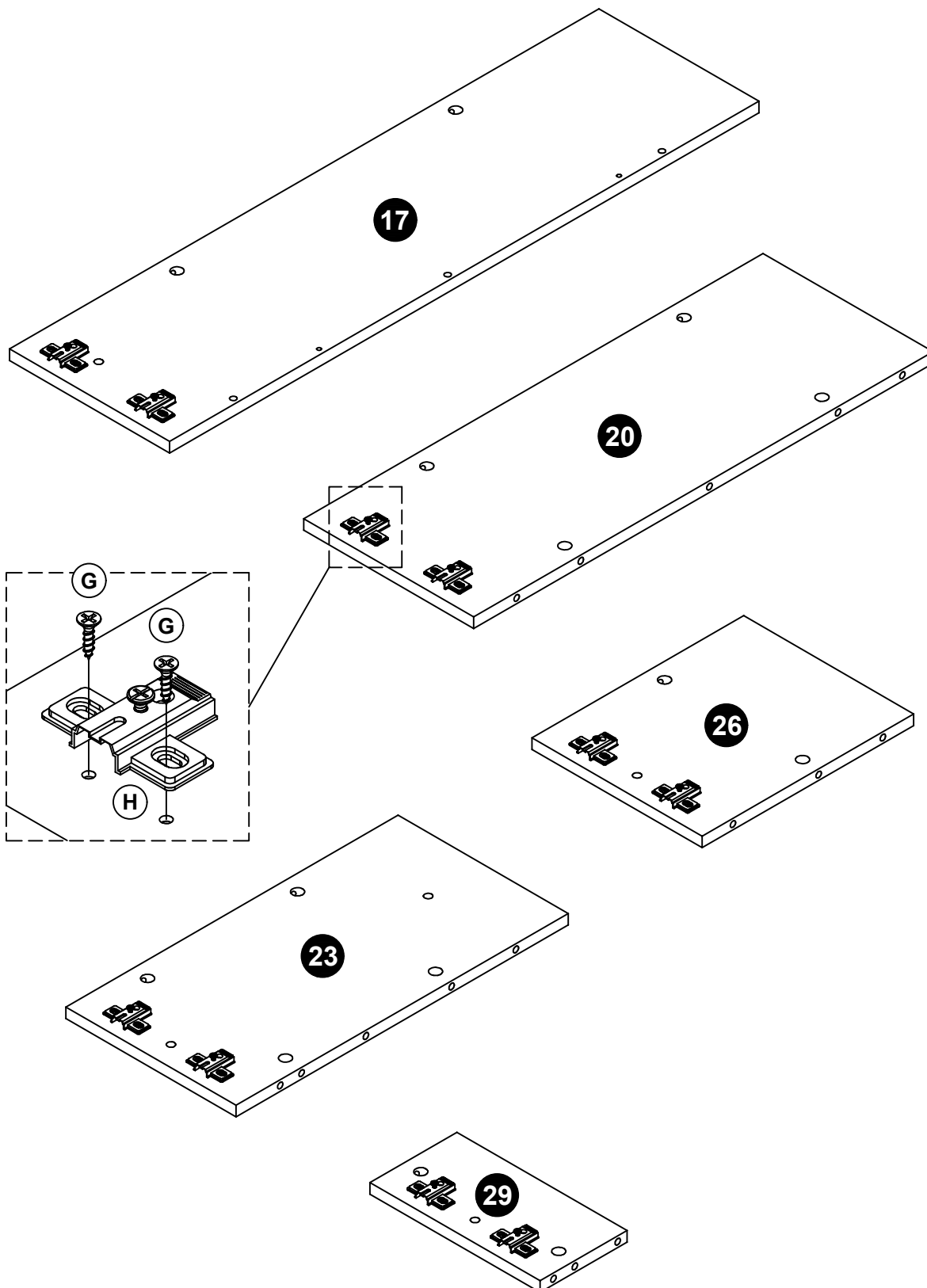

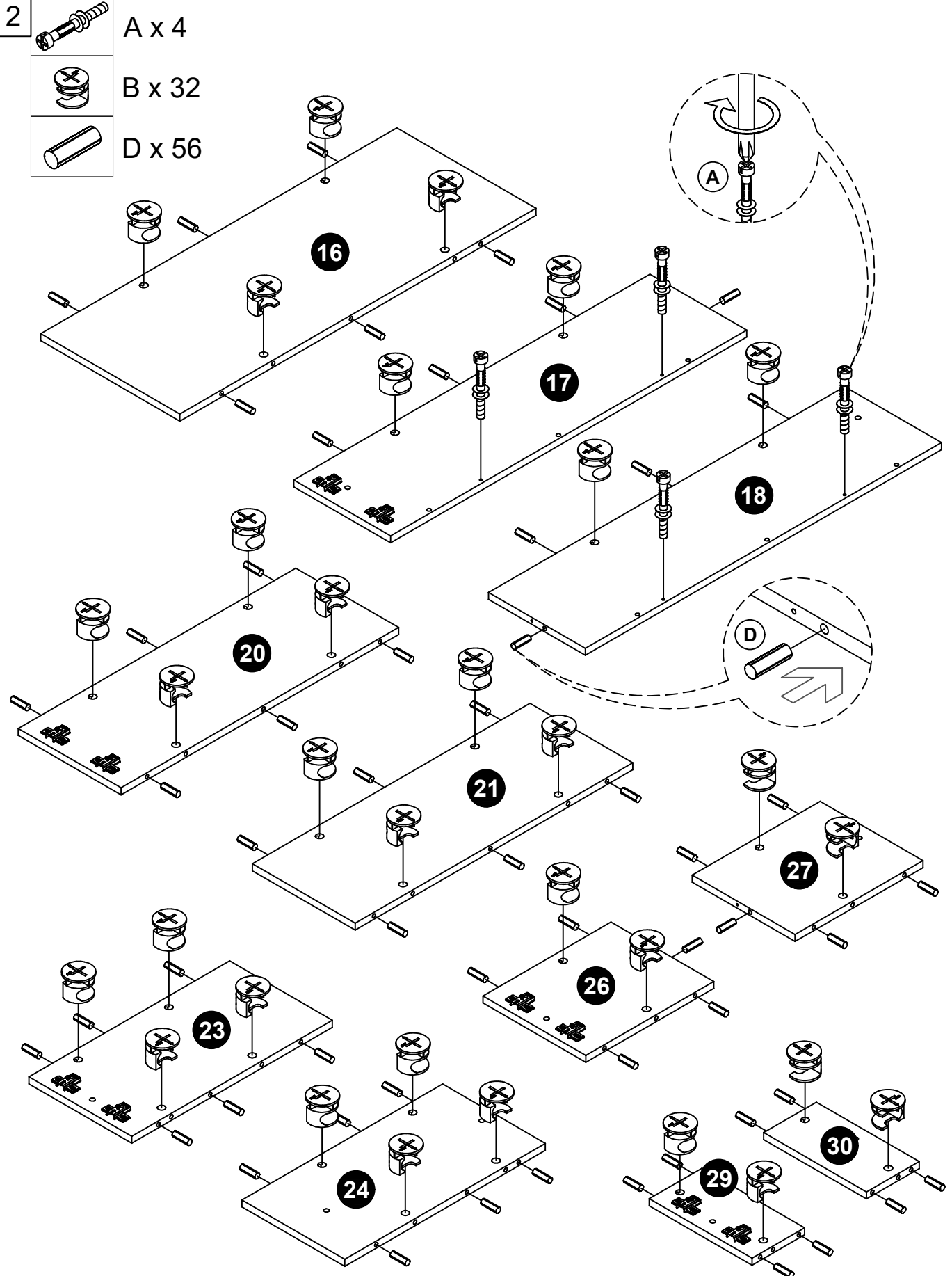

3

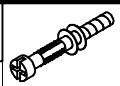

A x 16

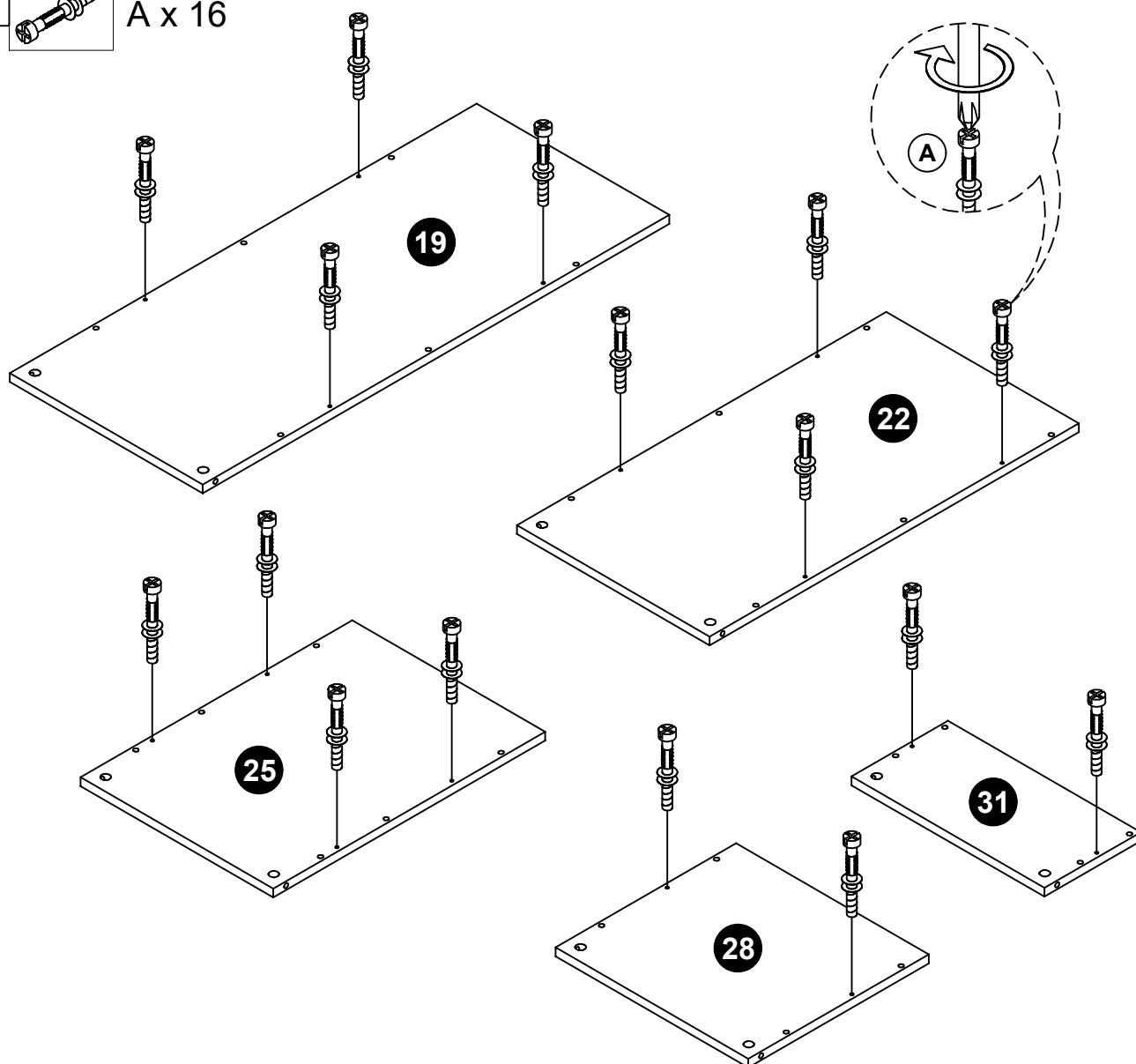

4



W x 4

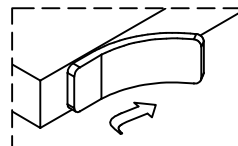
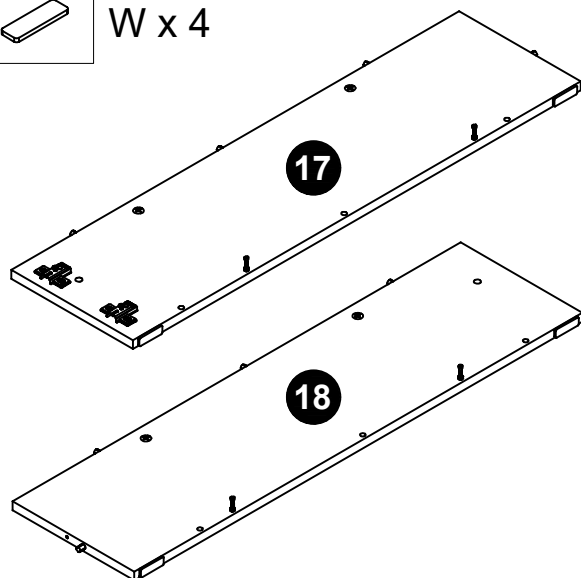

Part 17 , 18

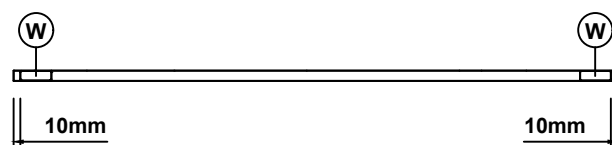

5

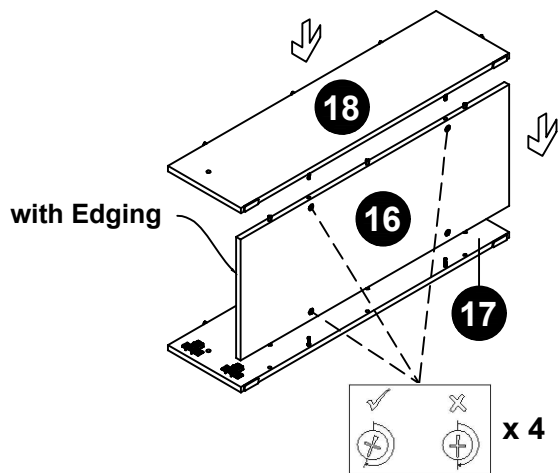

6

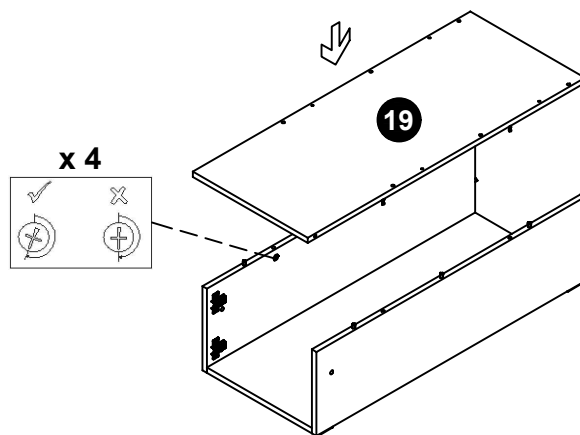

7

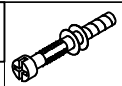

A x 4

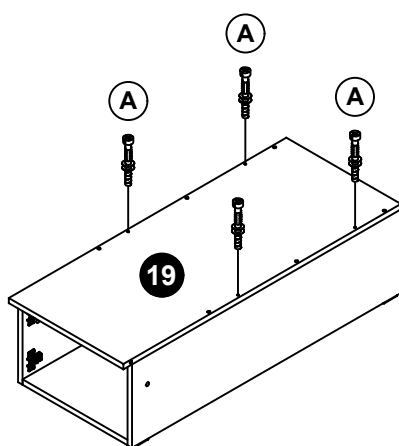

8

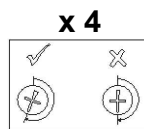

x 4

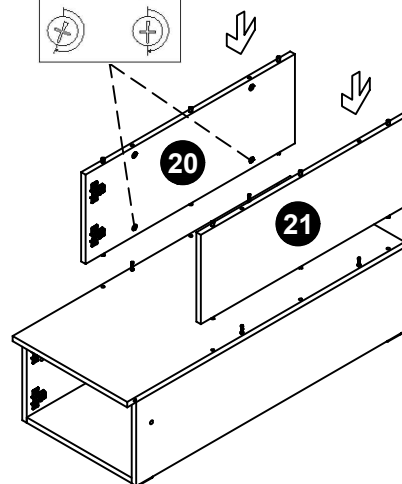

9

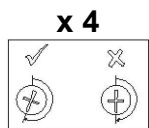

x 4

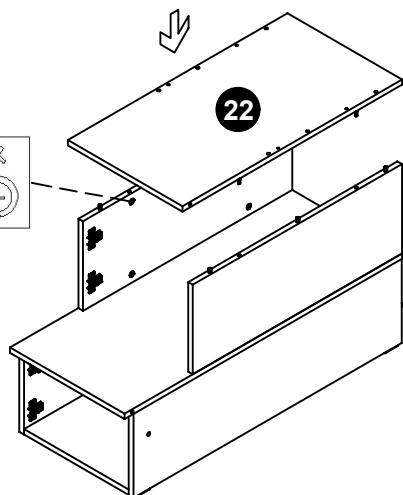

10



A x 4

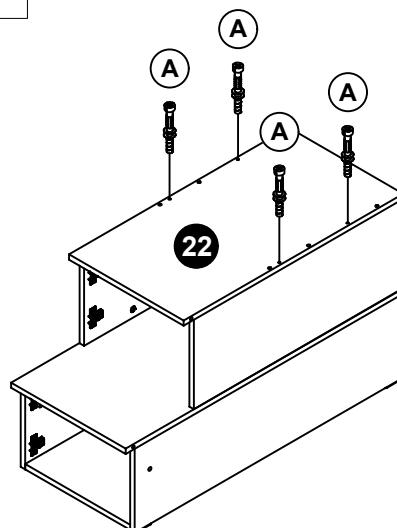

11

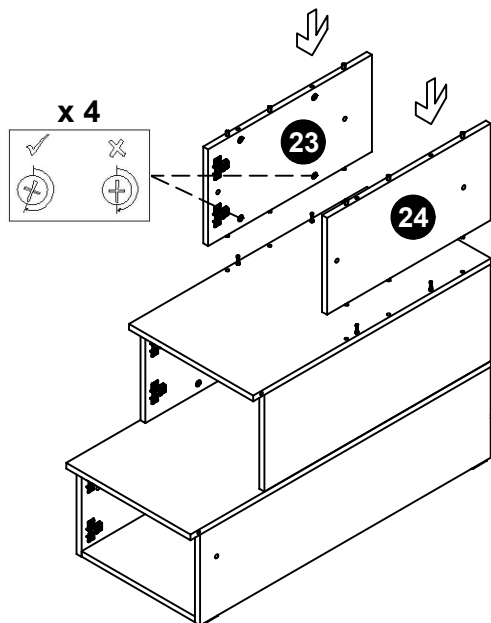

12

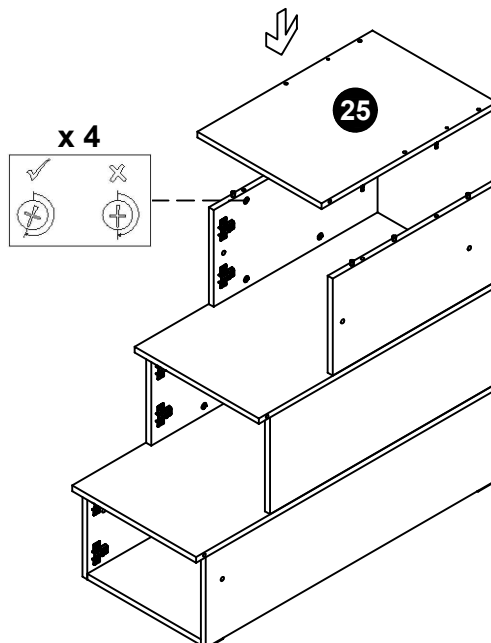

13

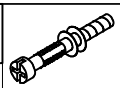

A x 2

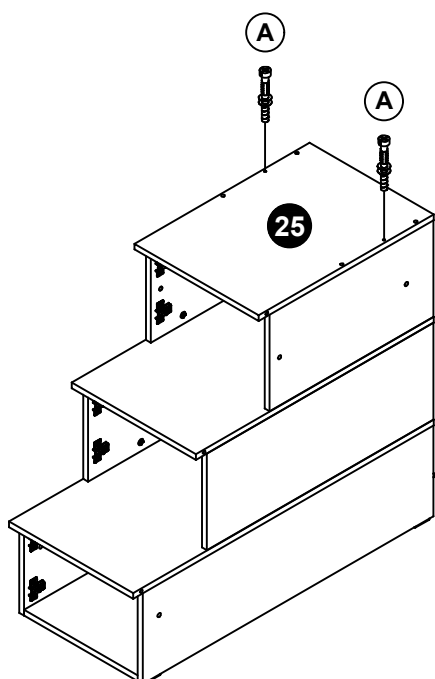

14

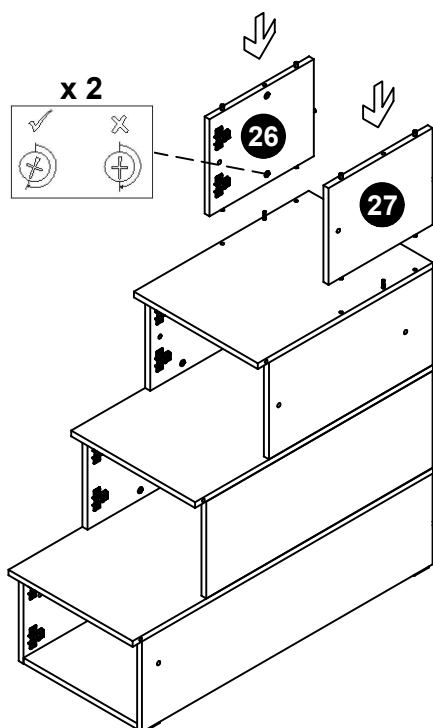



15

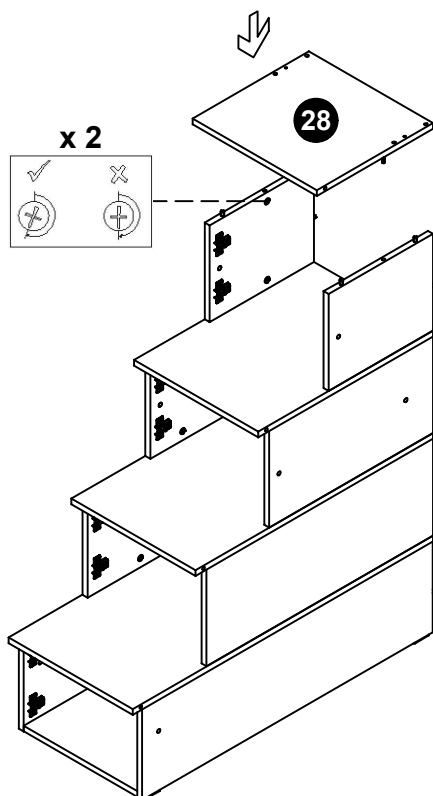

16

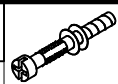

A x 2

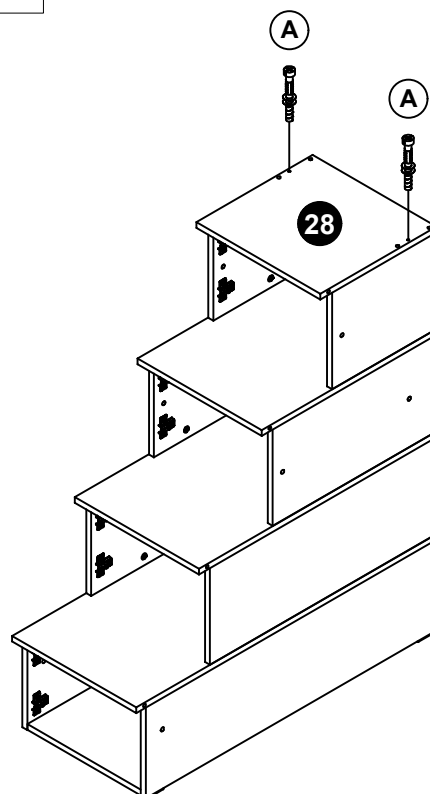

17

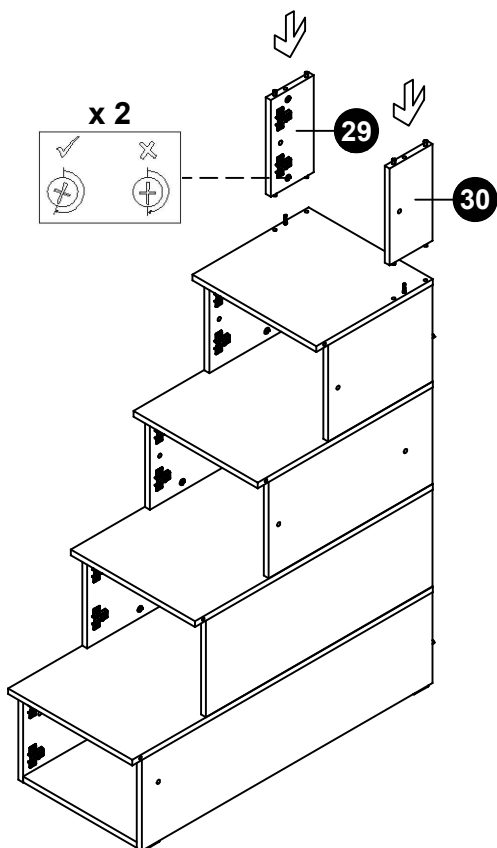

18

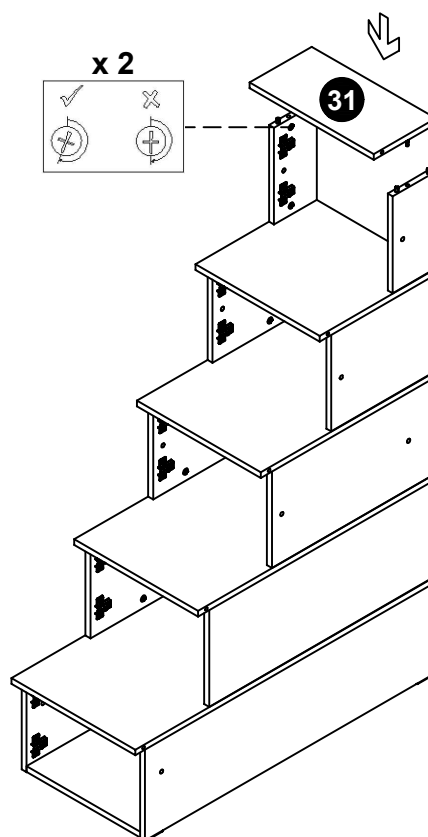

19



W x 2

Part 32

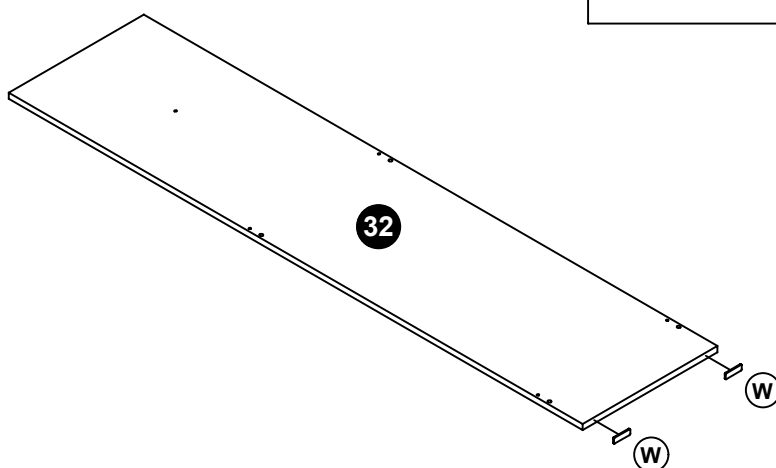
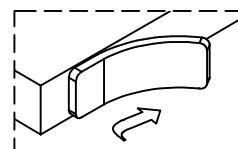
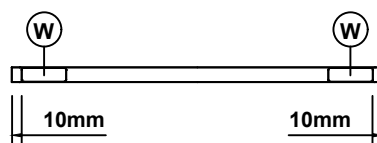

20

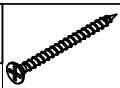

E x 5

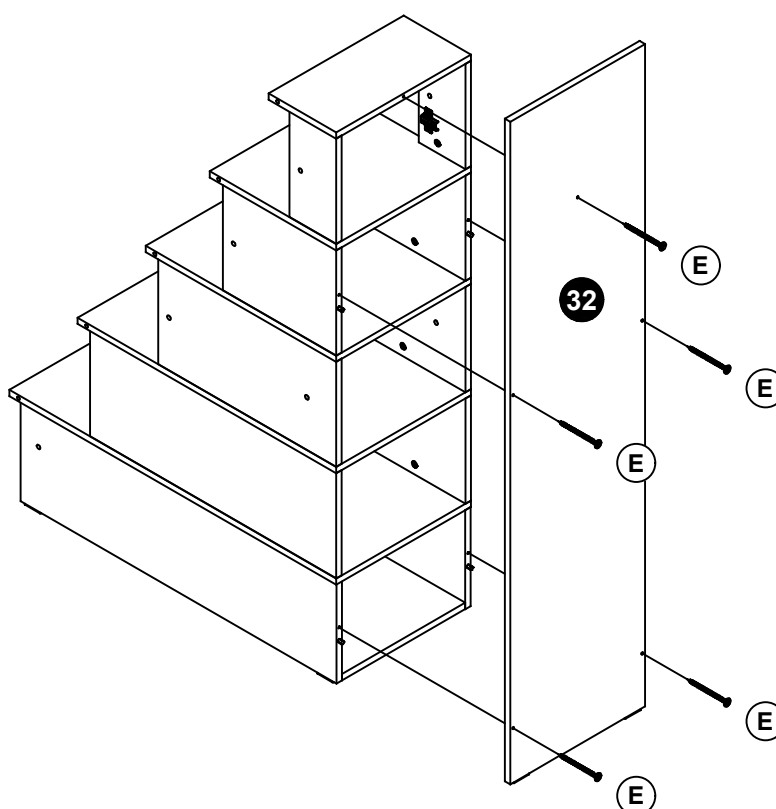

21



A x 10

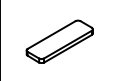

W x 6

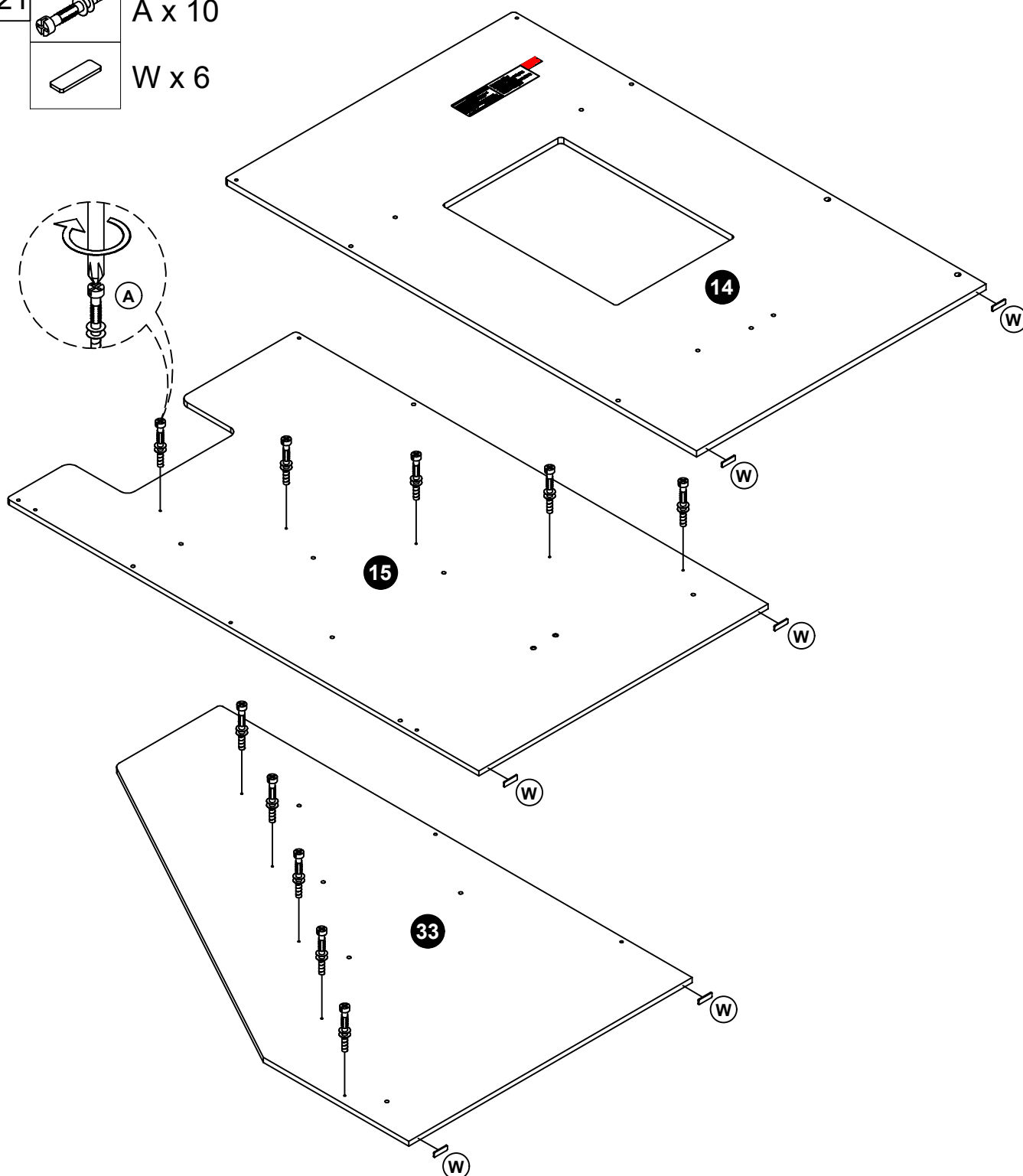

Part 14 , 15 , 33

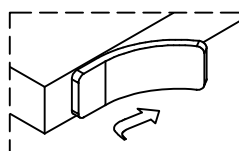
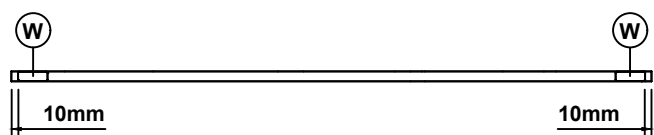

22



S x 5

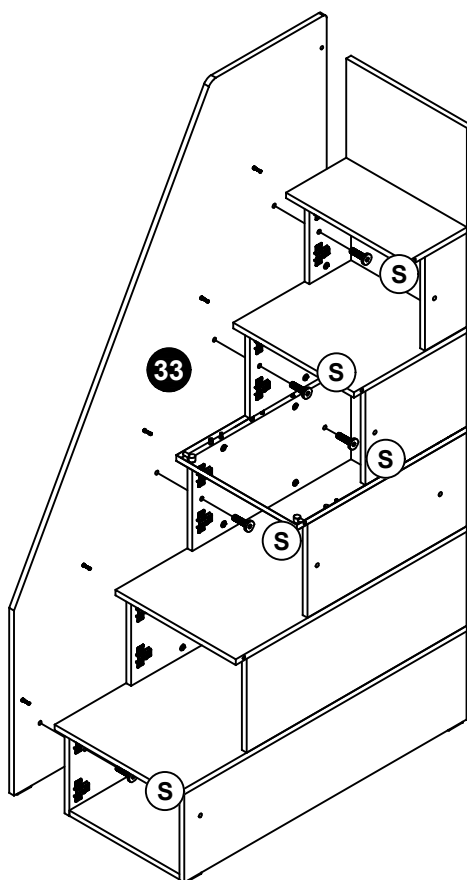

23



B x 5

x 5

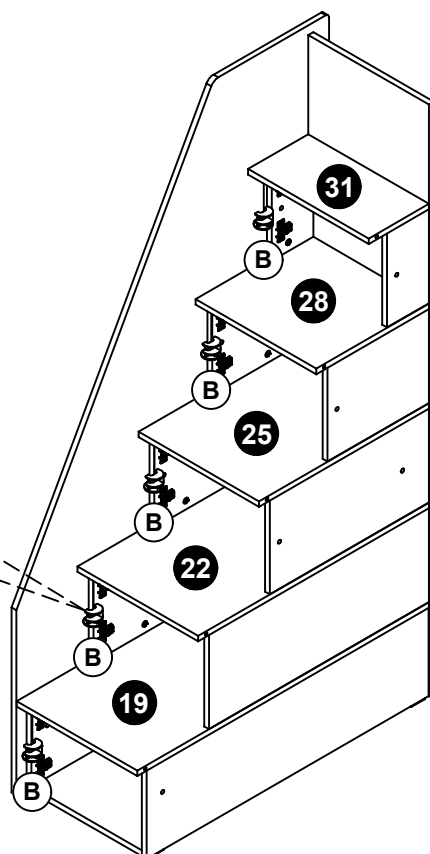
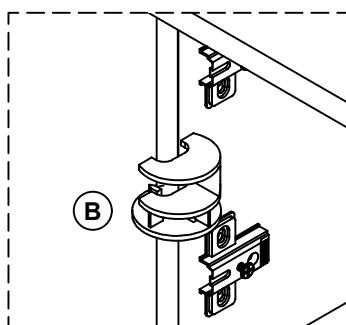
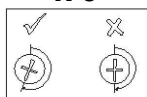

24

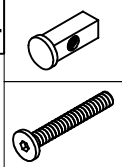

M x 2

N x 2

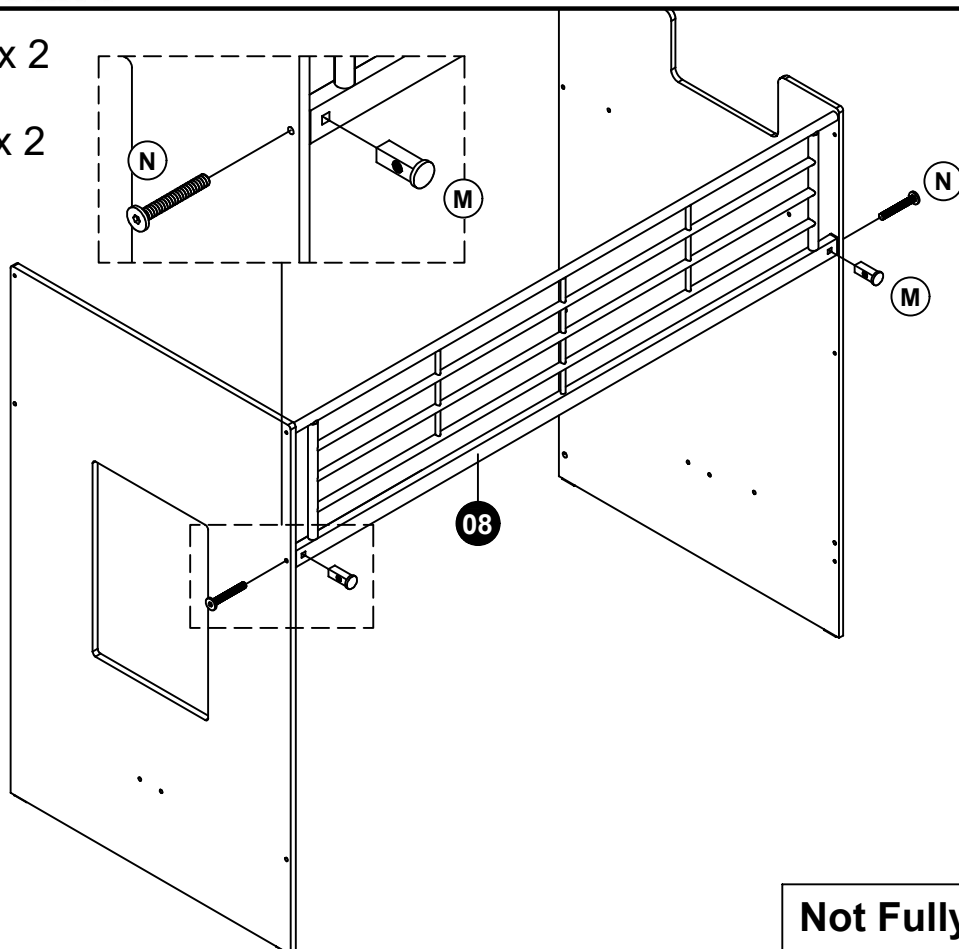

**Not Fully Tighten**

25



Q x 2

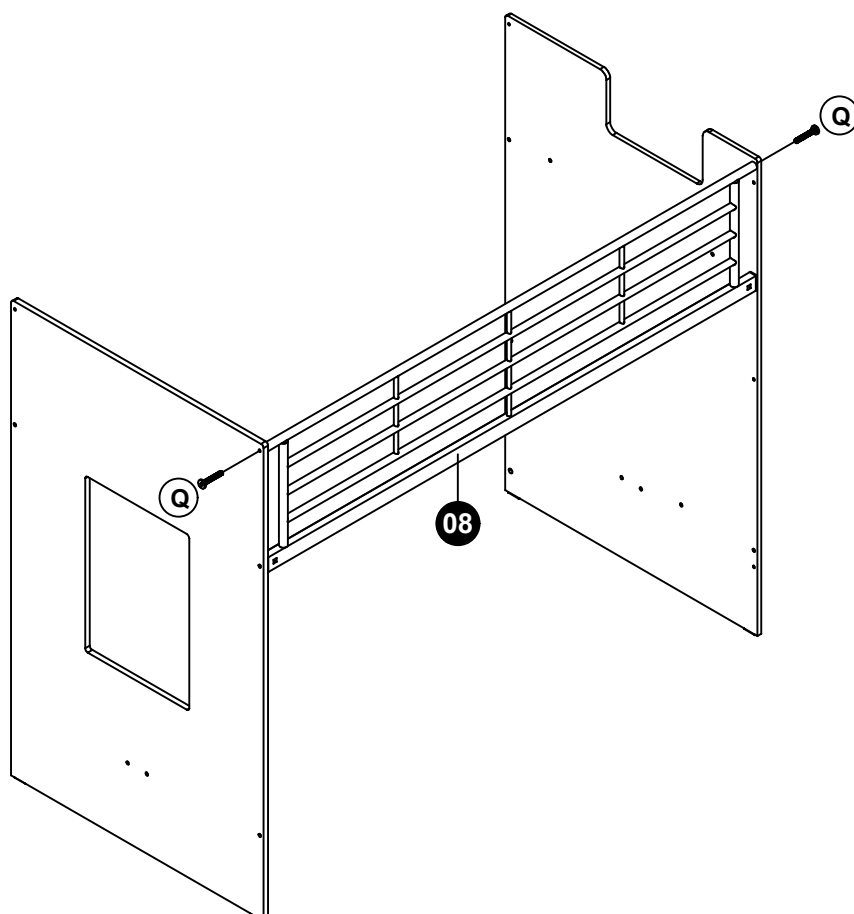

26



M x 2

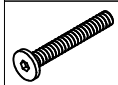

N x 2

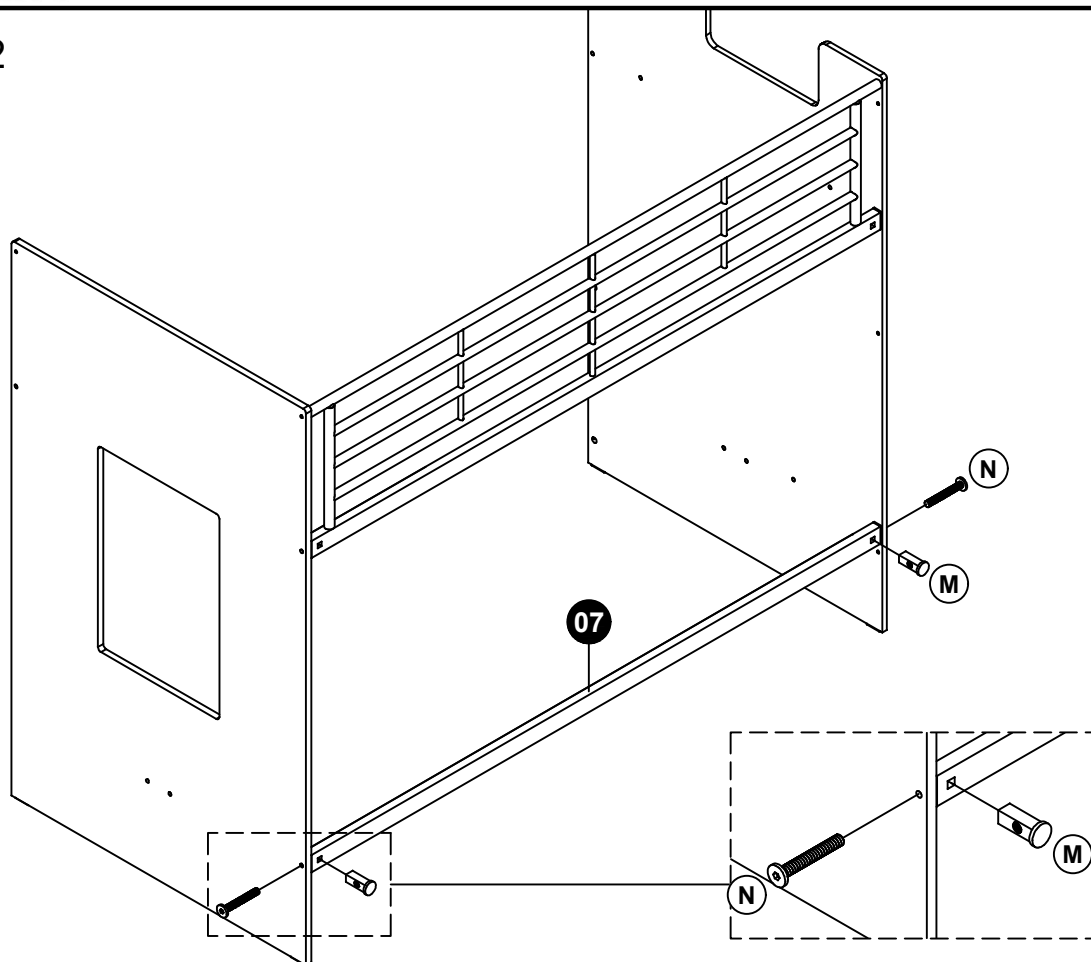

27

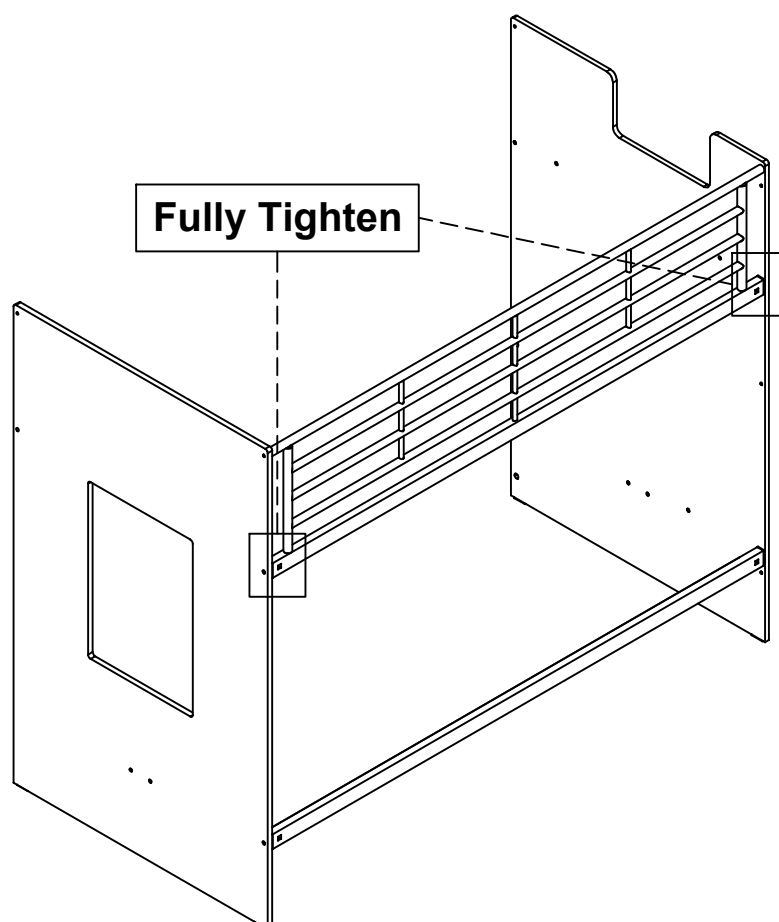

28



T x 4



X x 4

15

38

14

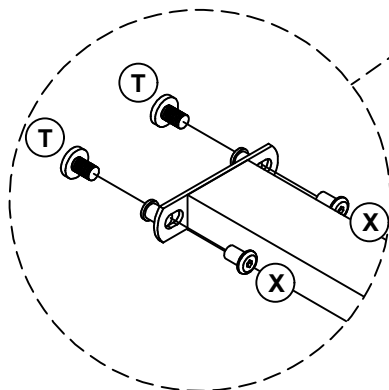

29



S x 5

15

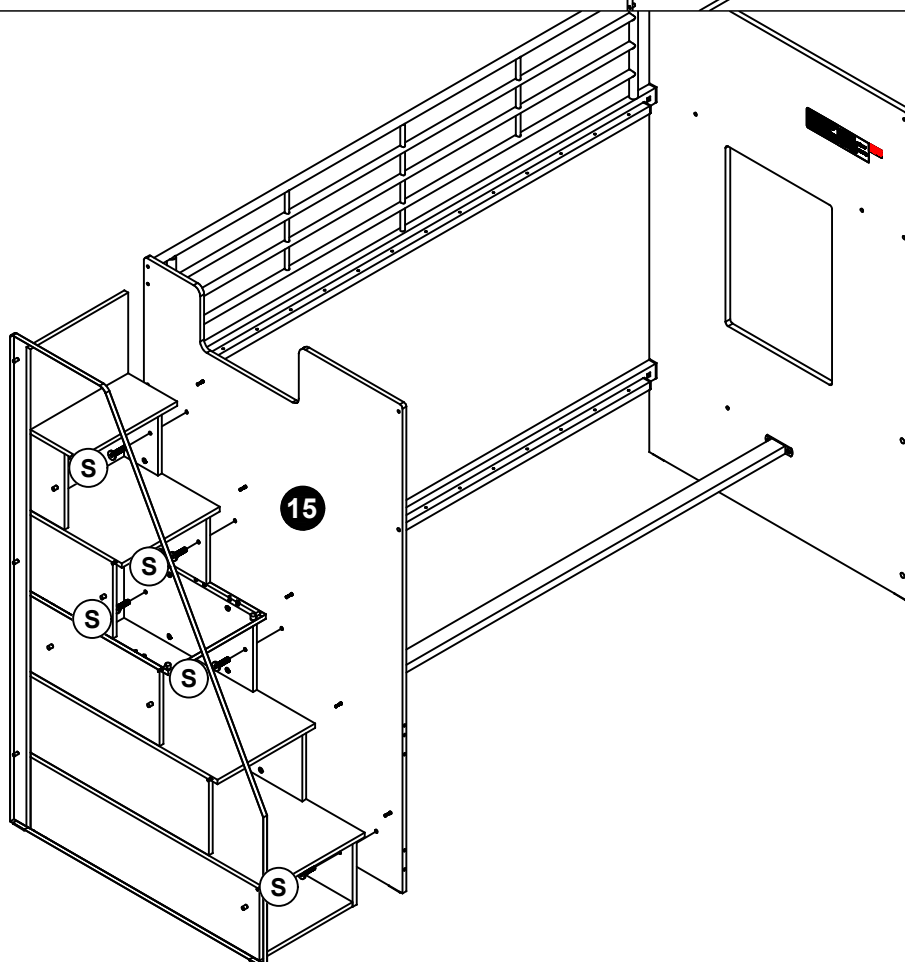



30



B x 5

x 5

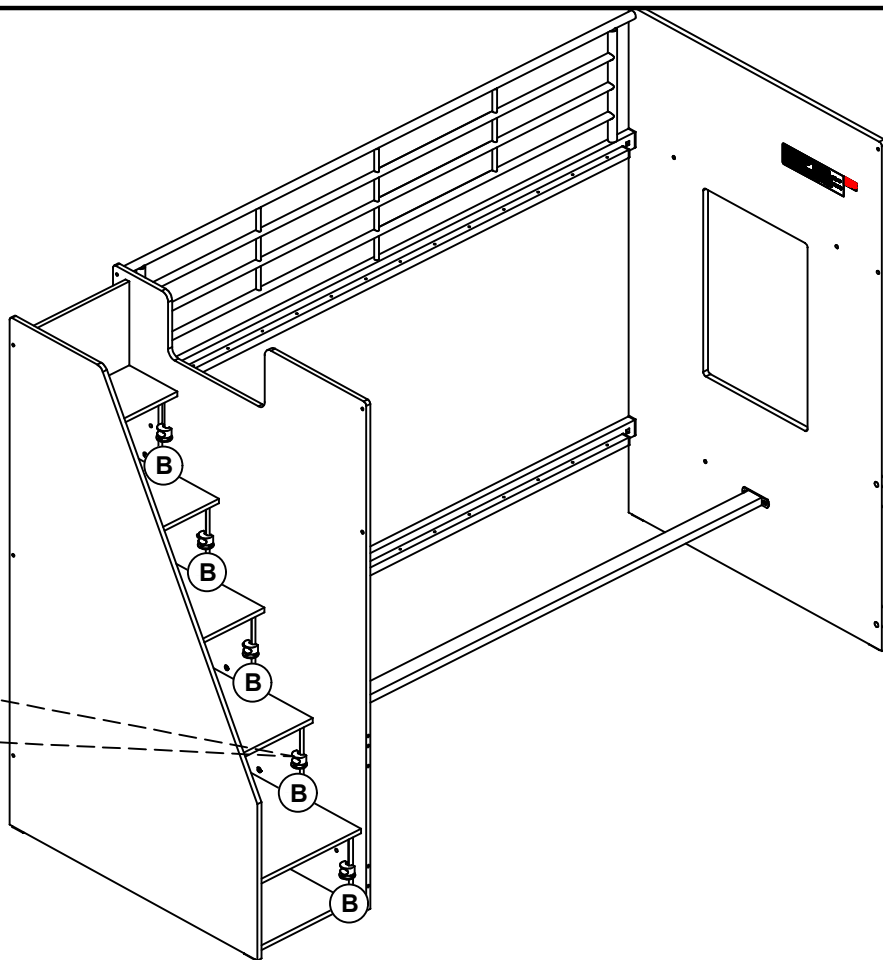
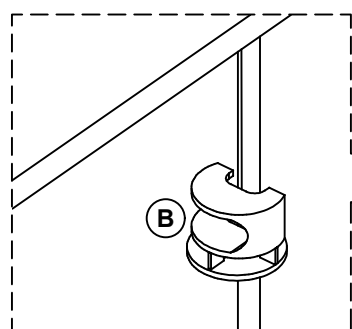
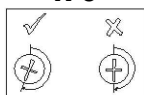

31



Q x 6

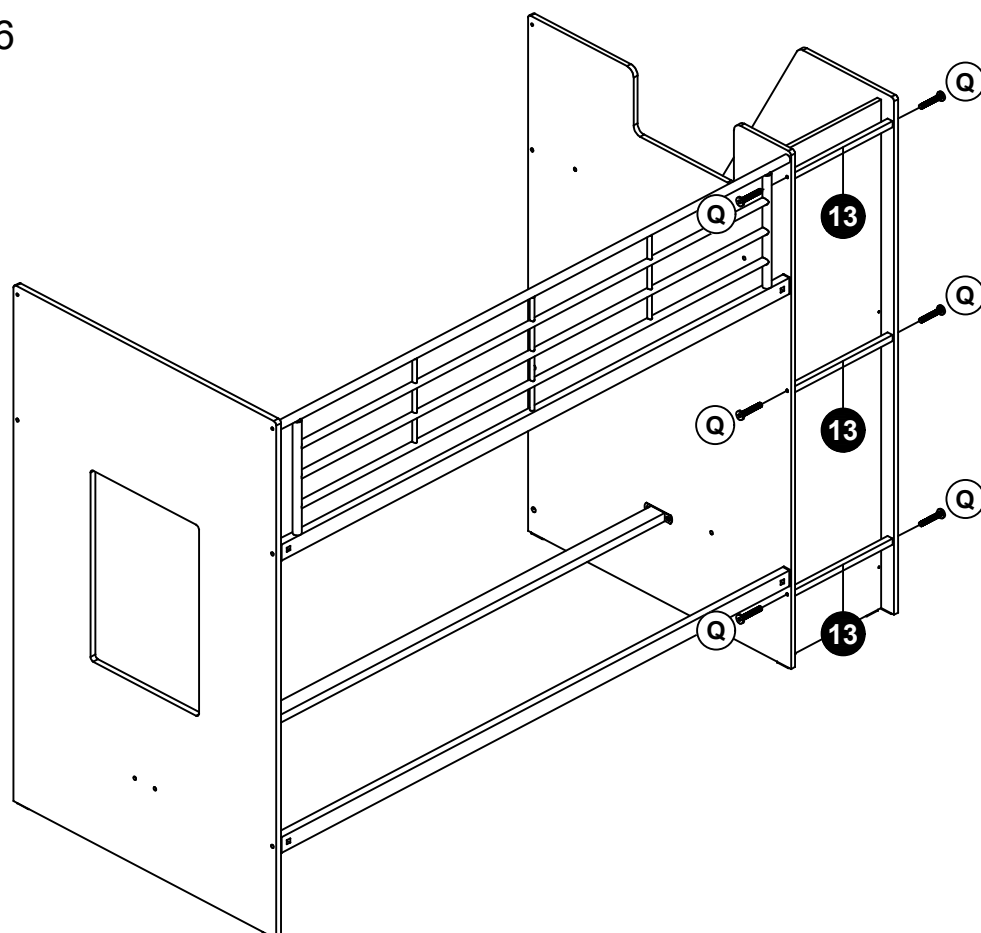

32  W x 4

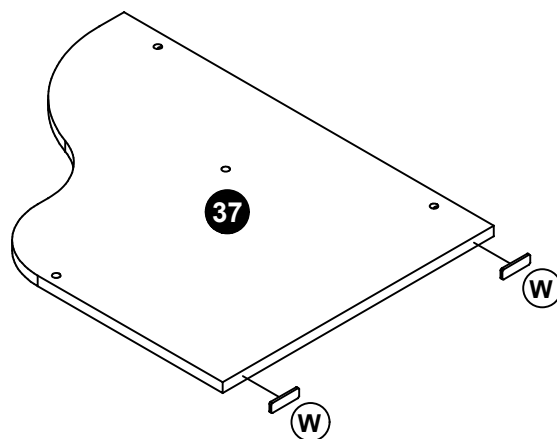
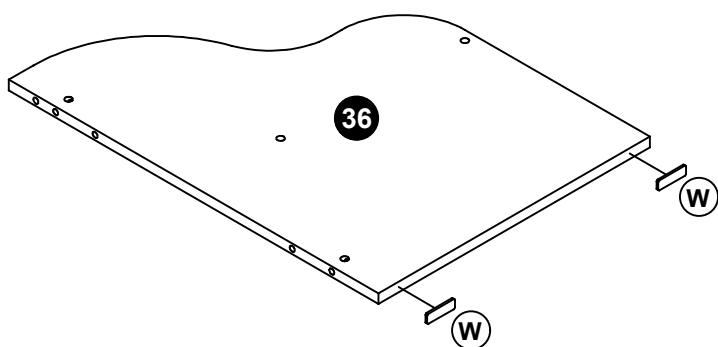

Part 36 , 37

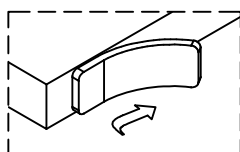
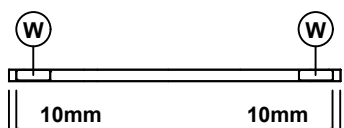

33  C x 4

 K x 4

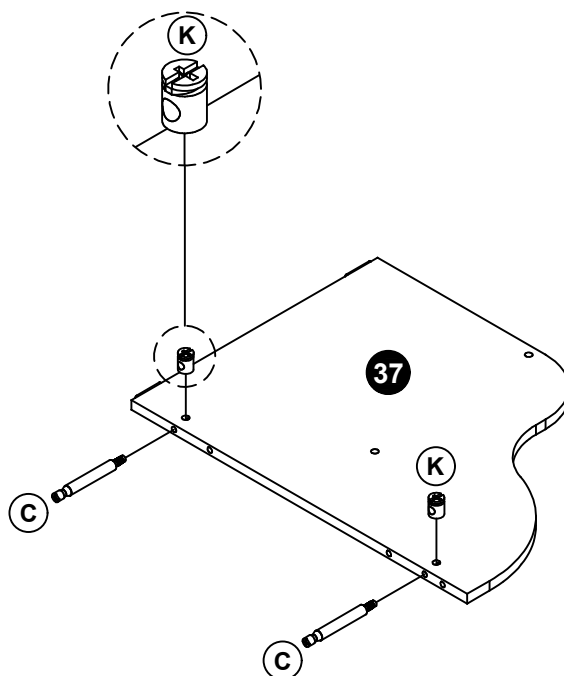
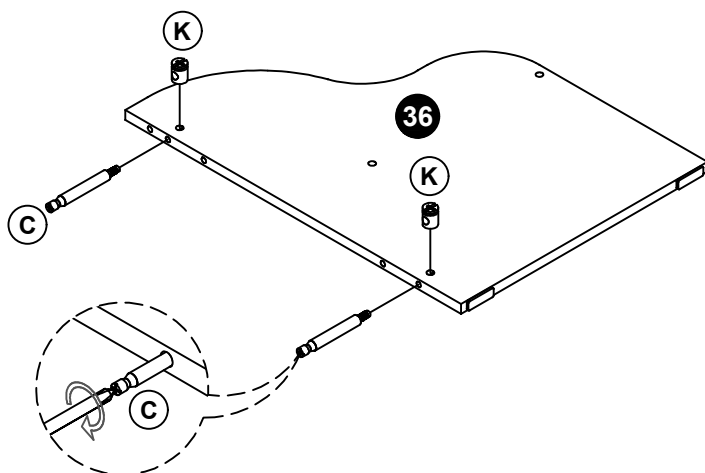

34

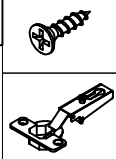

G x 20

H x 10

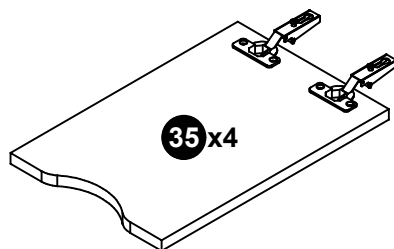
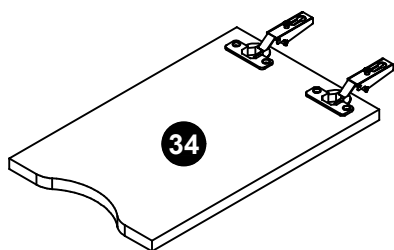
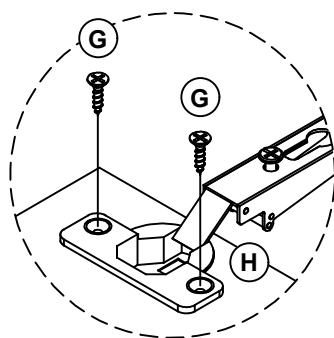

35

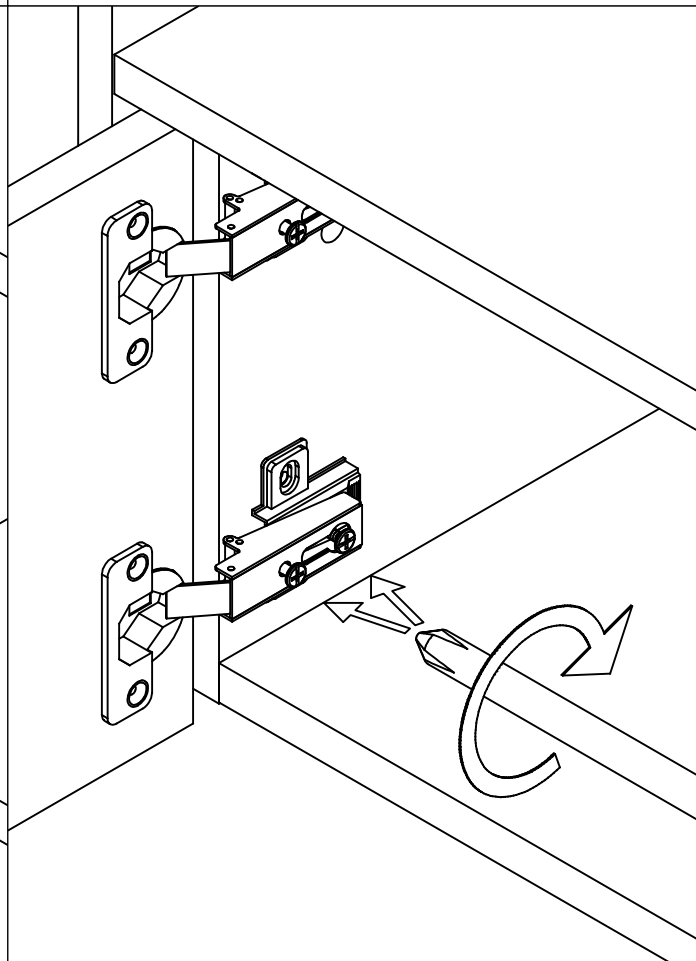
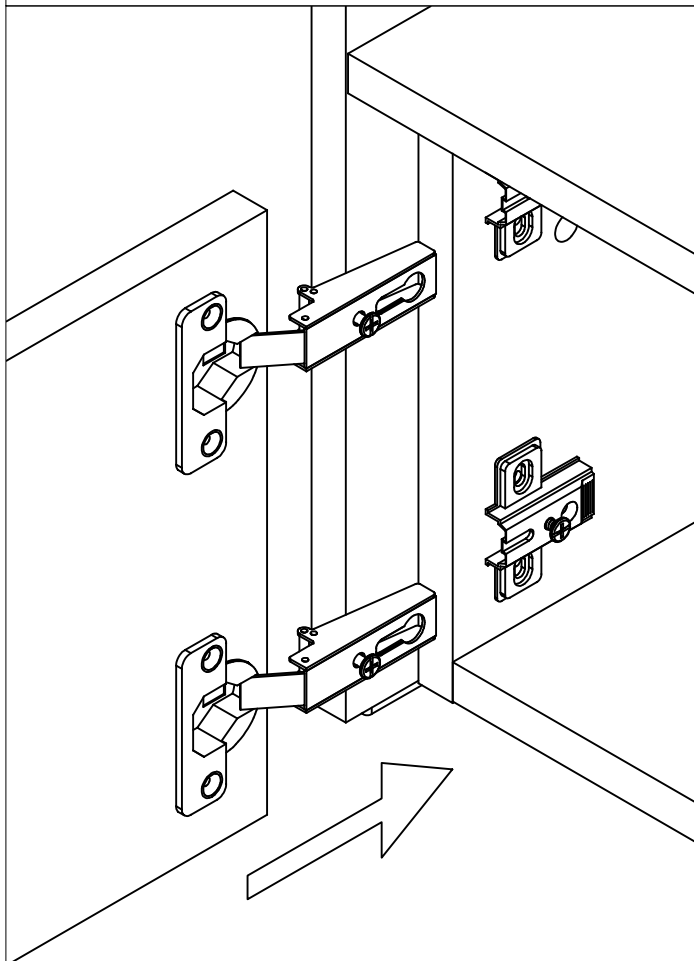
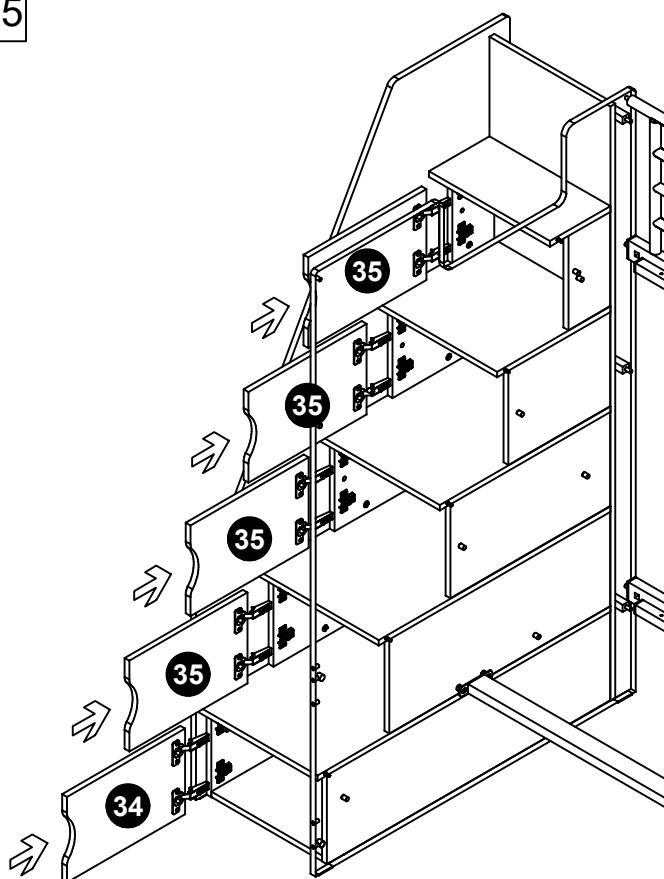

36



B x 4



D x 6

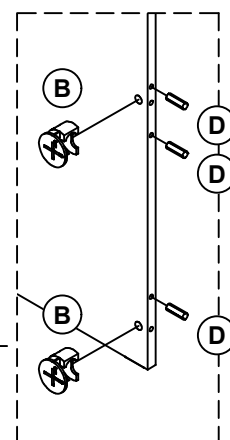
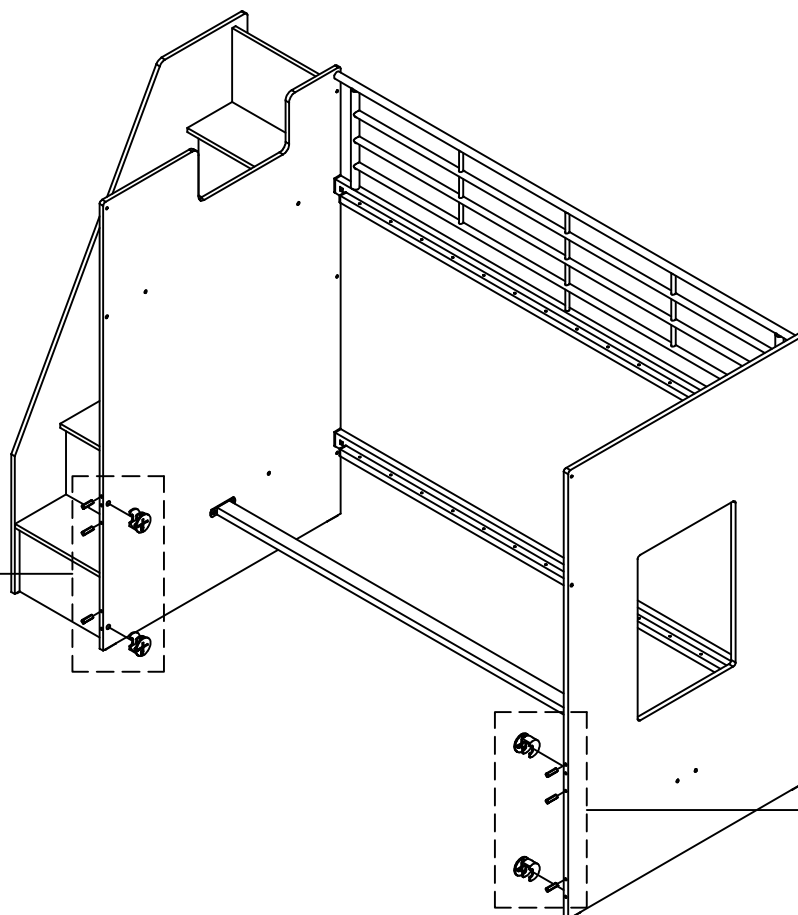
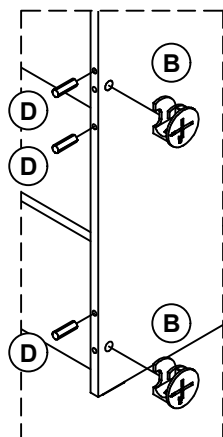

37

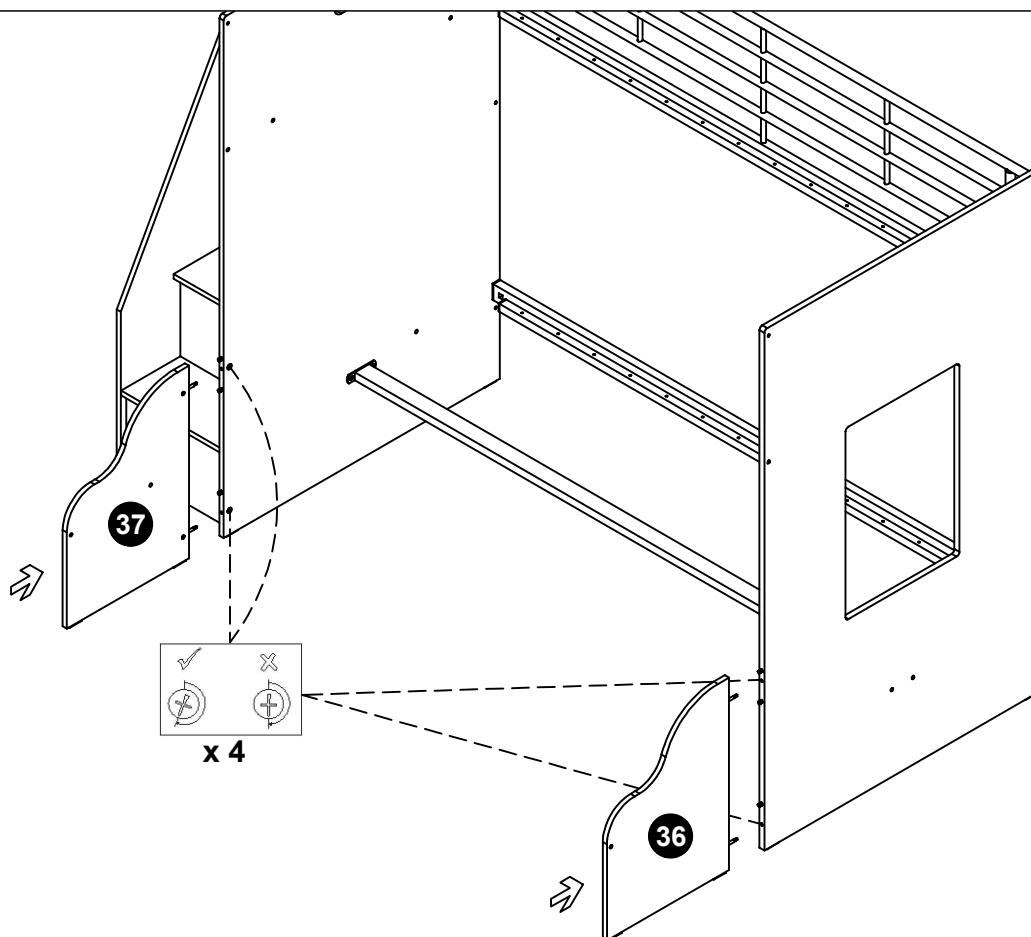

38

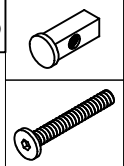

M x 2

N x 2

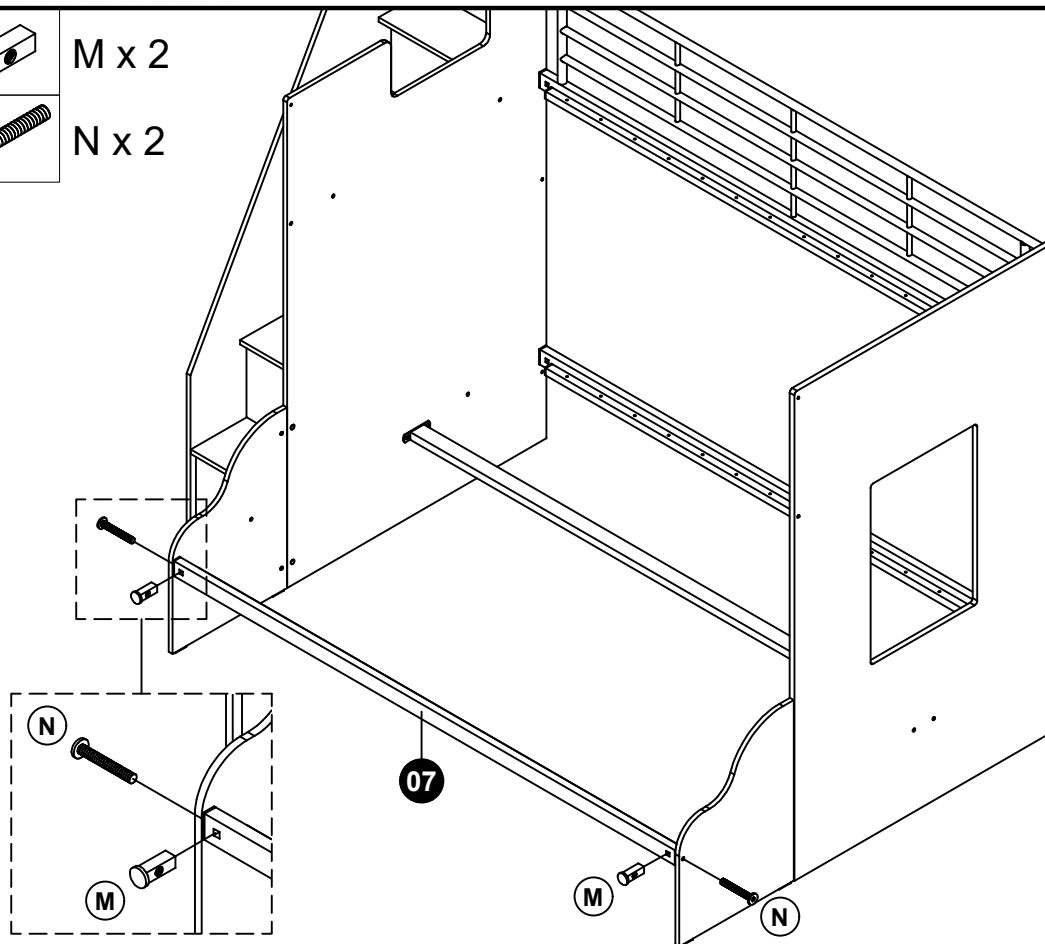

39

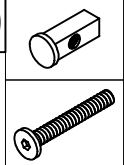

M x 2

N x 2

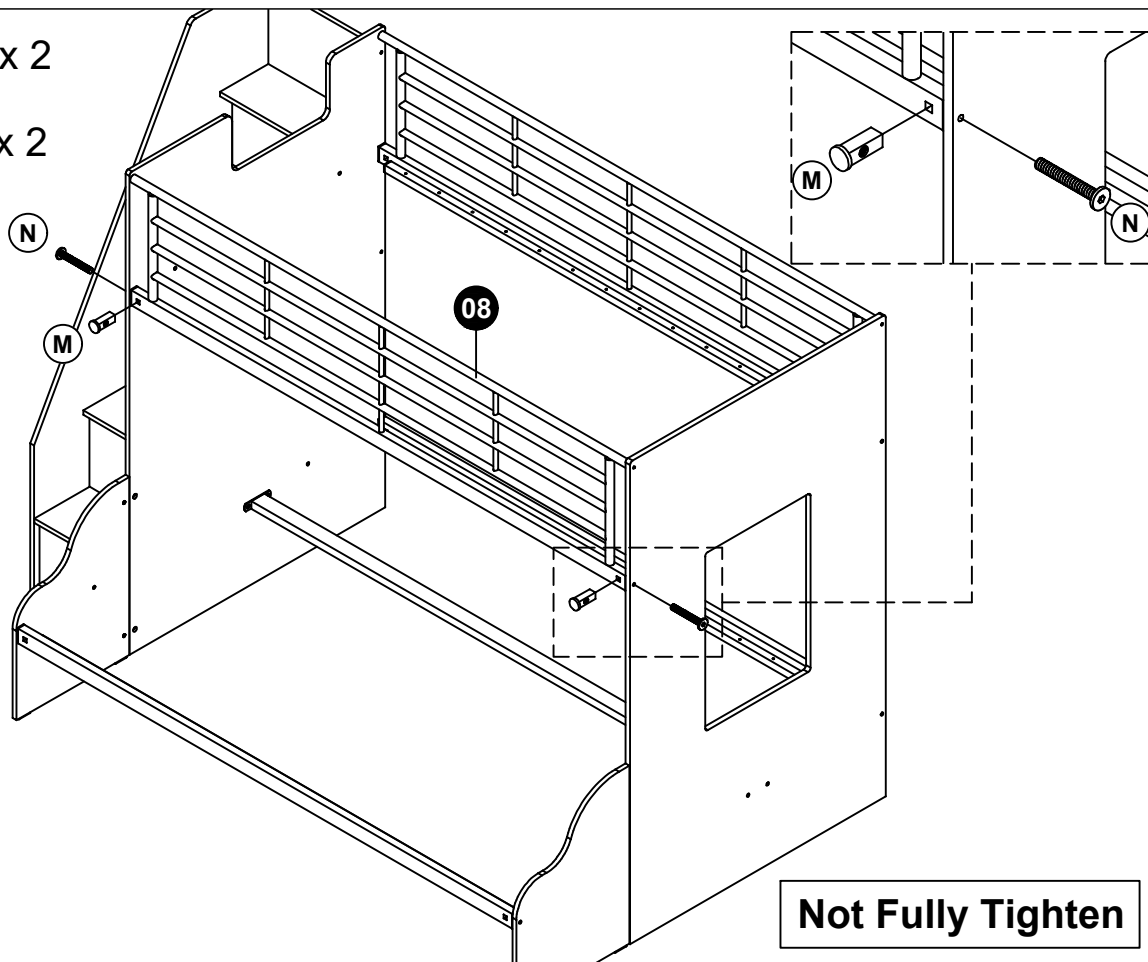

**Not Fully Tighten**

40



Q x 2

Q

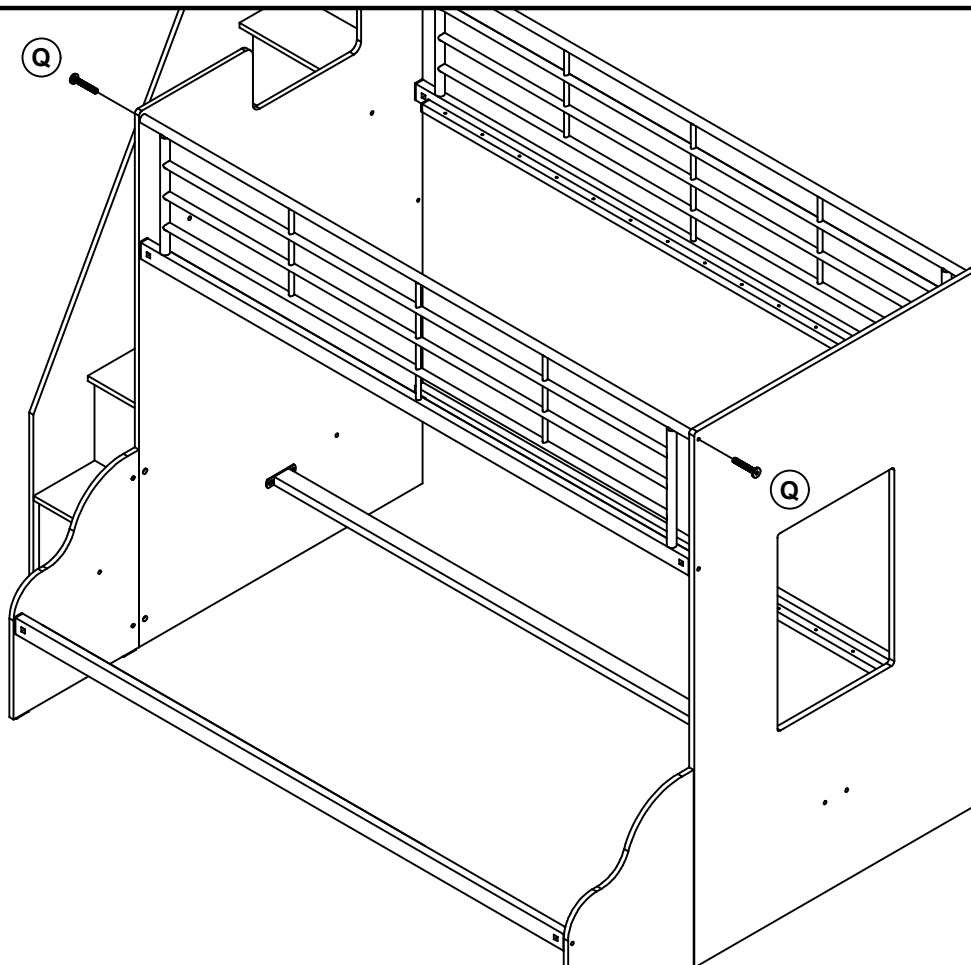

41

Fully Tighten

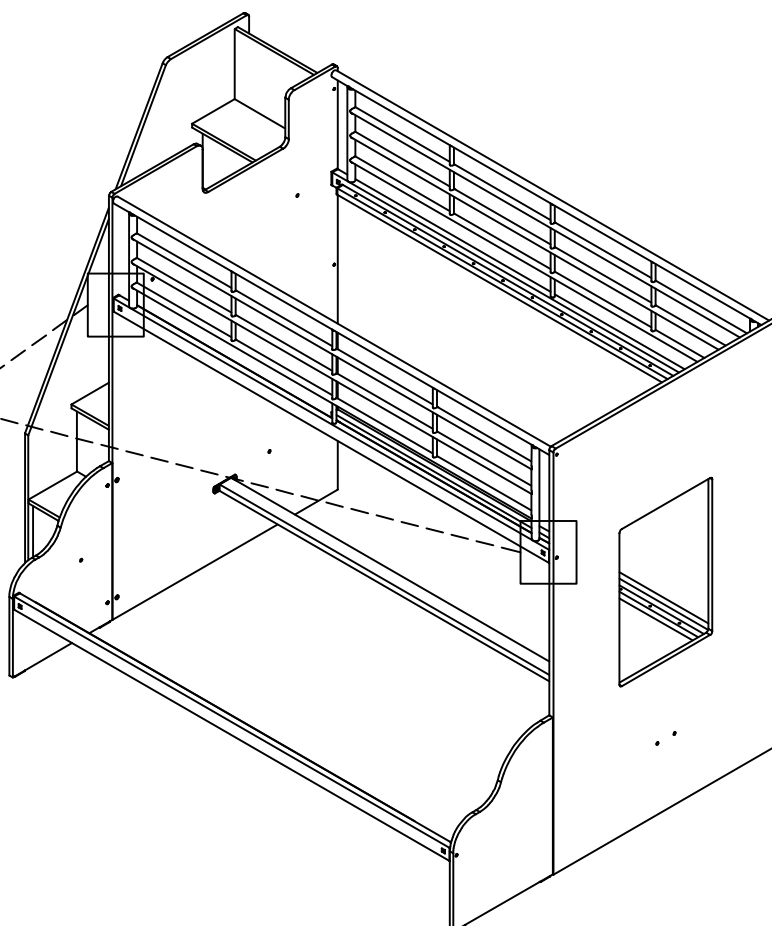

42  R x 4

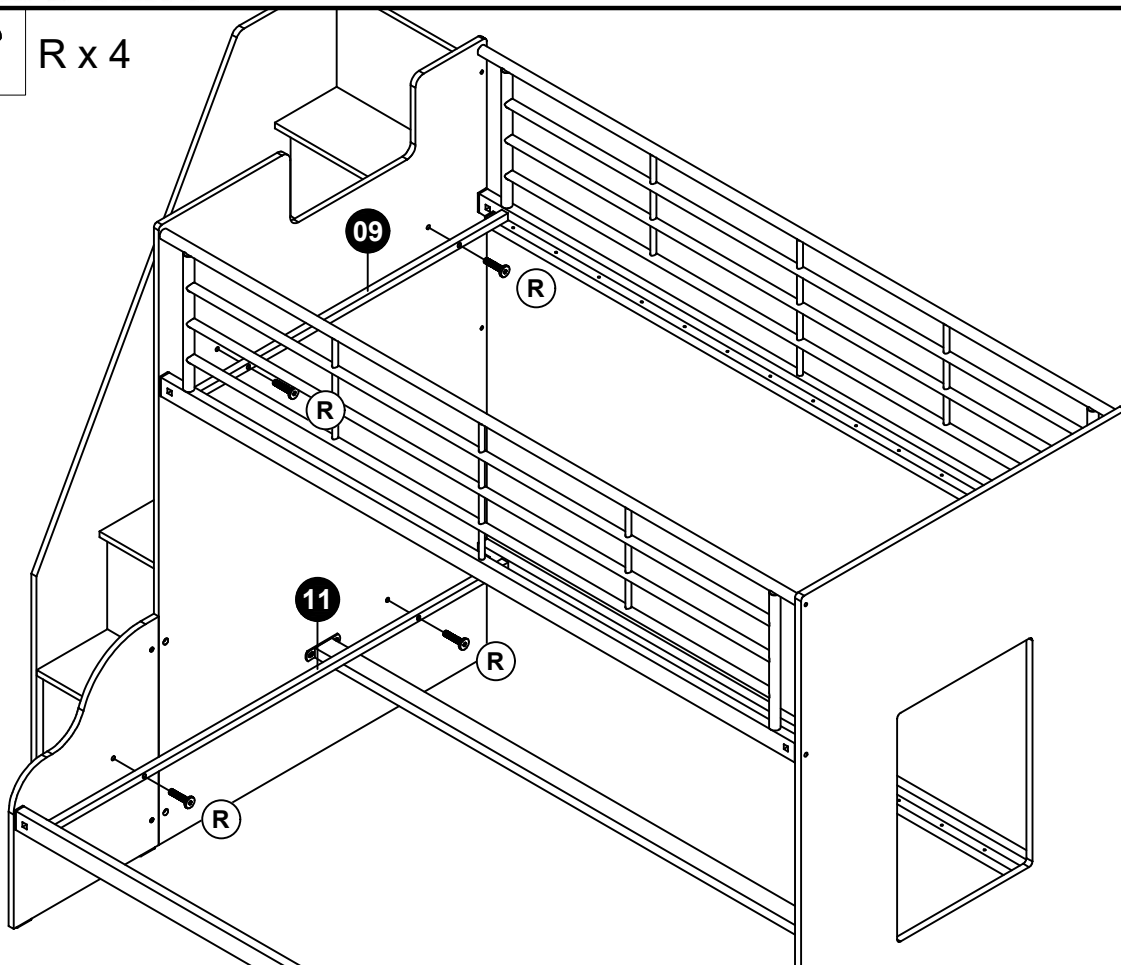

43  R x 4

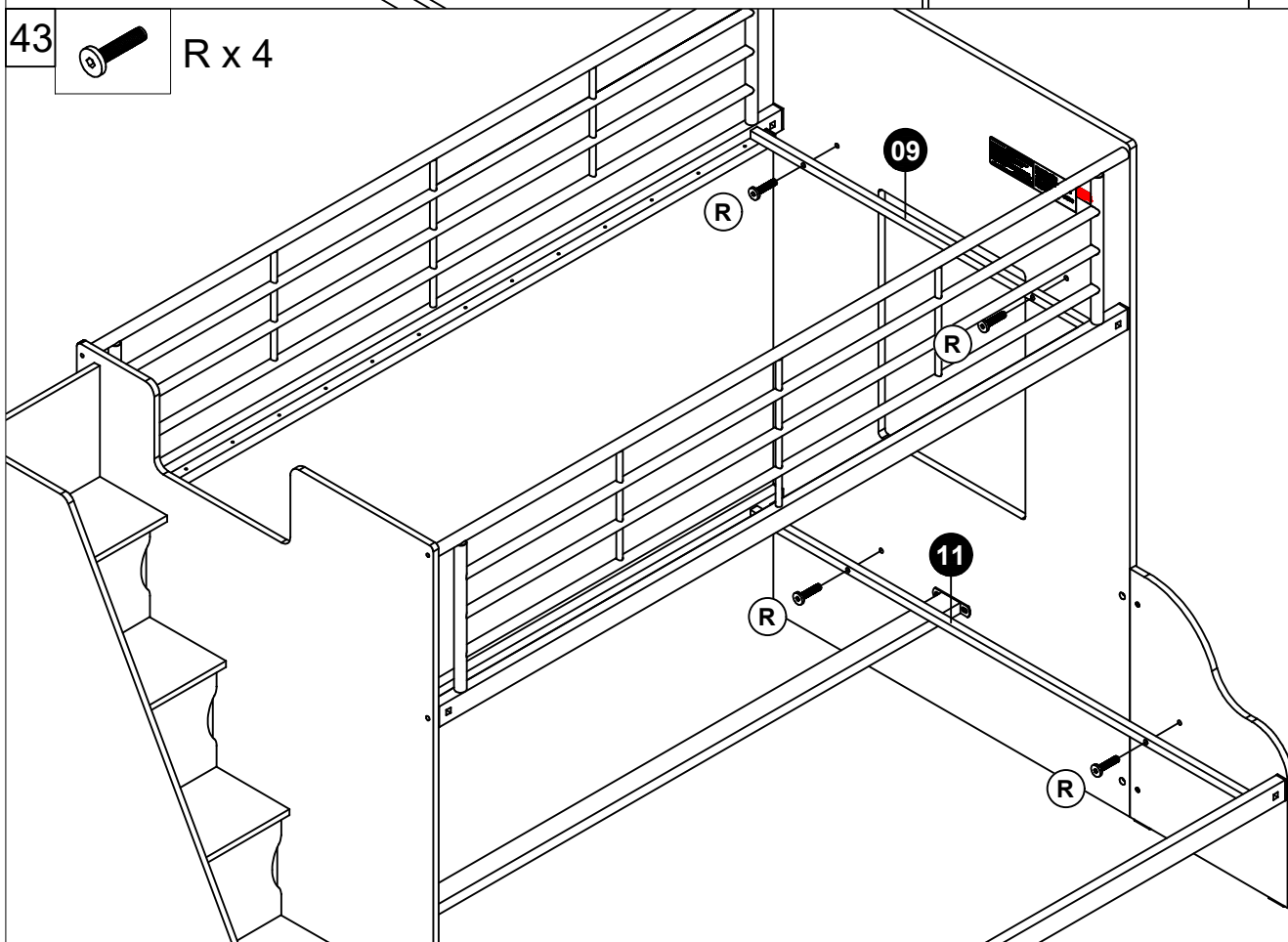



44



R x 28

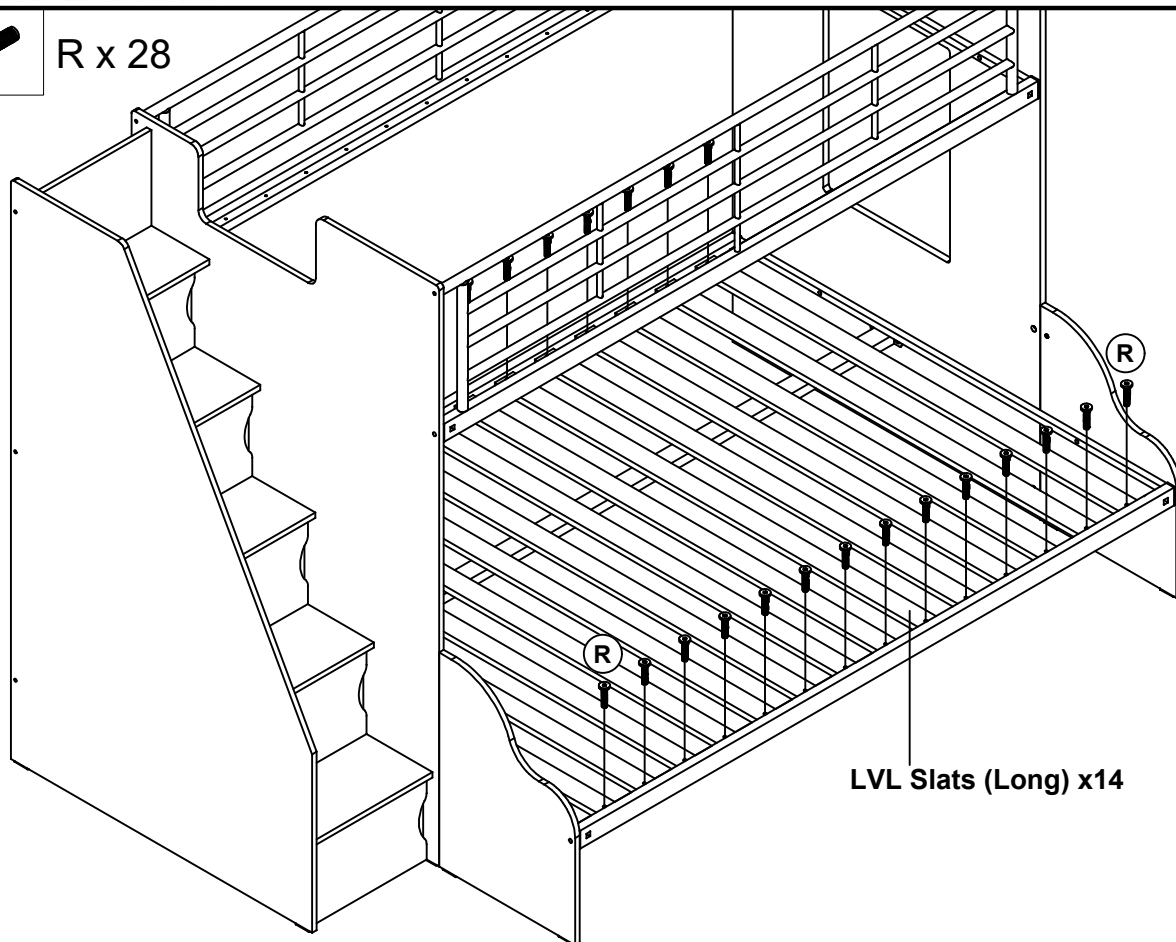

45



R x 28

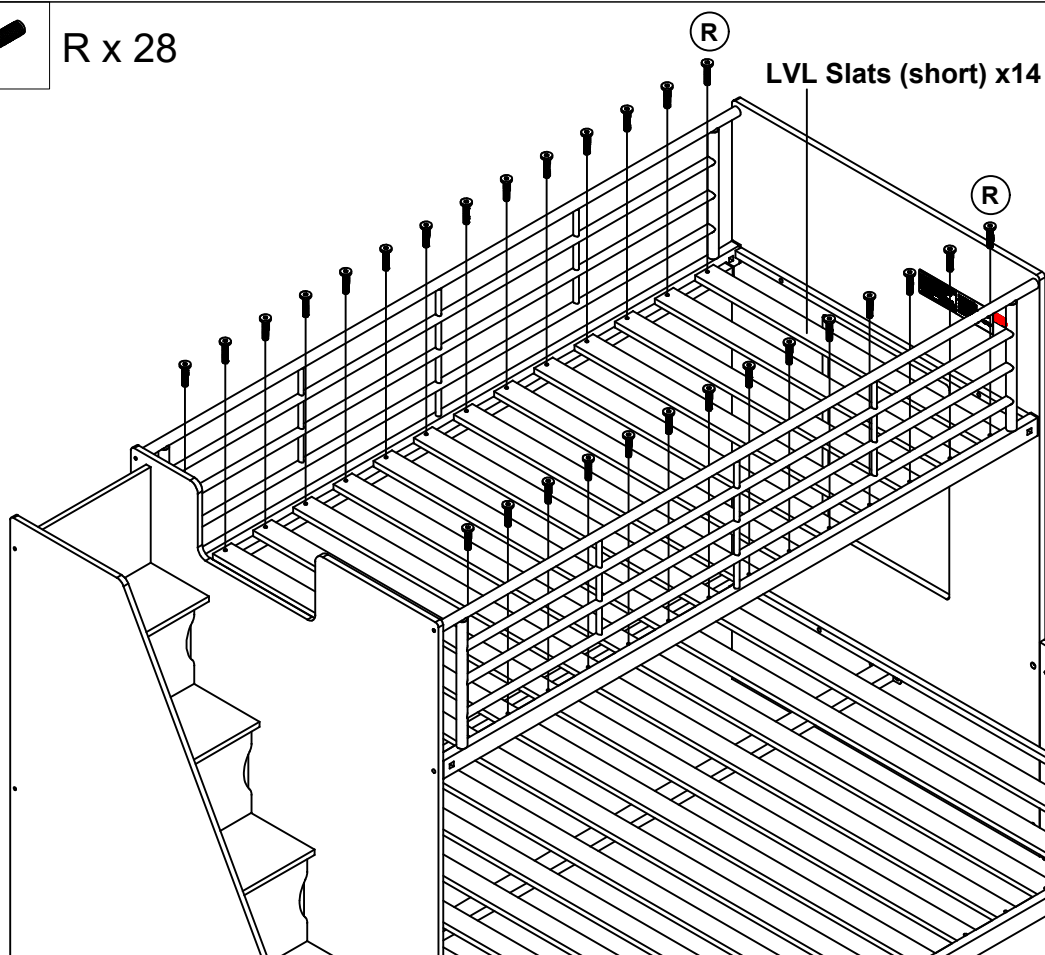

46



A x 3



K x 3



B x 6



C x 3



D x 26

#### WHEN FITTING CAMS

ENSURE STARTING POSITION IS CORRECT  
BEFORE YOU INSERT CONNECTING BOLT  
TURN CLOCKWISE UNTIL SECURE

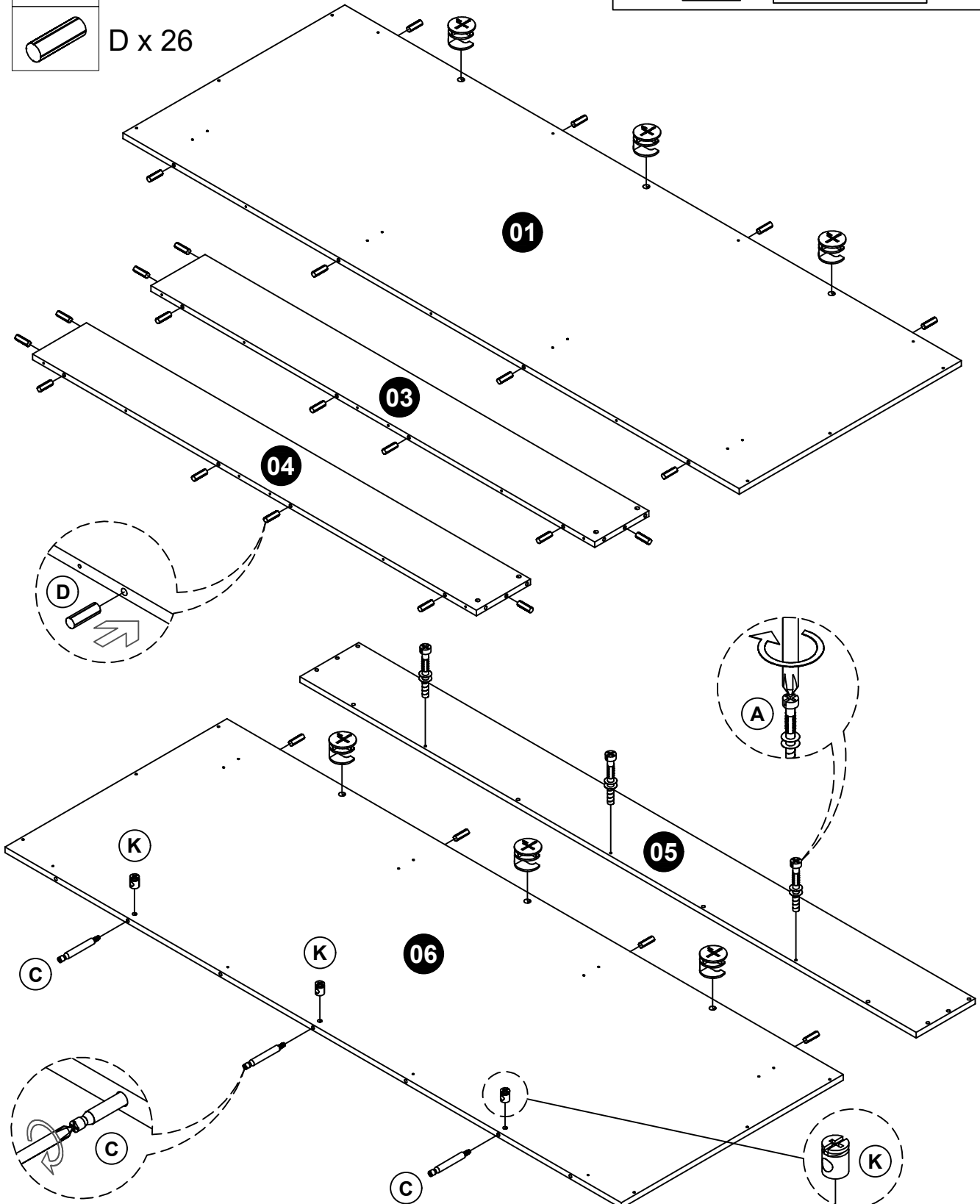
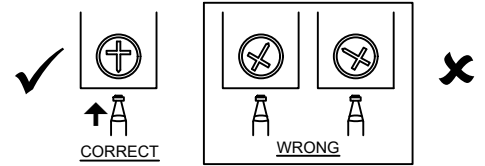

47

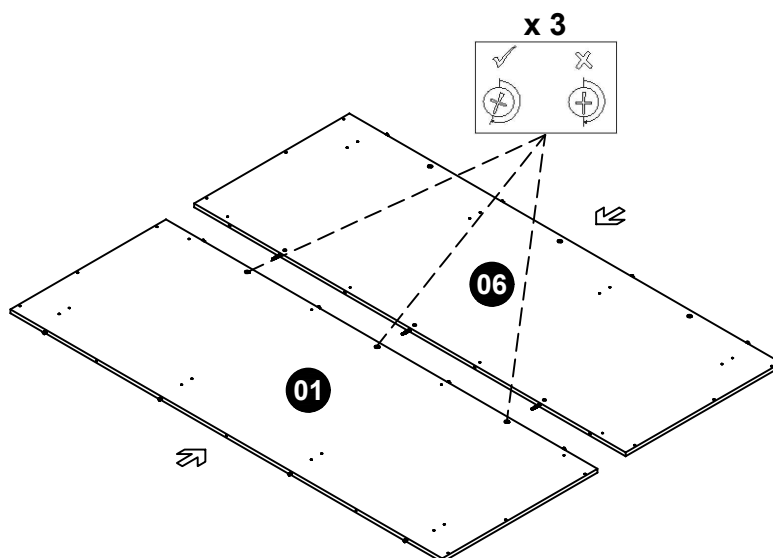

48



G x 24



J x 12

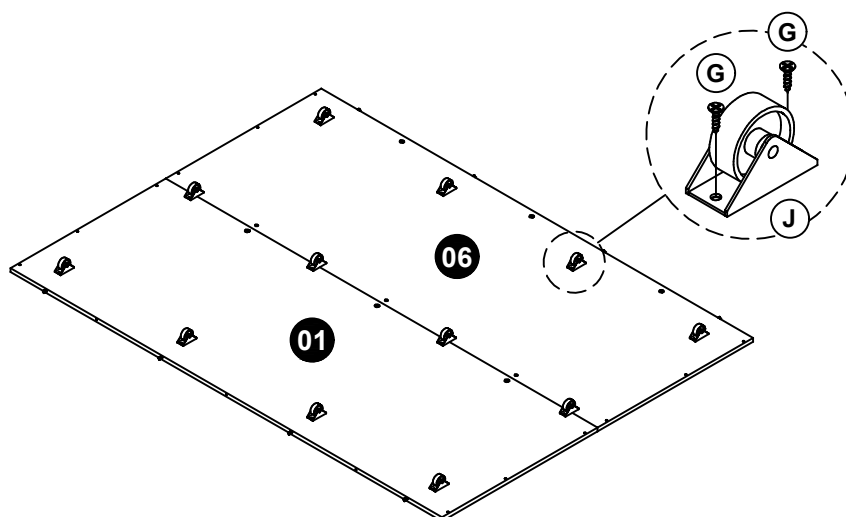

49



F x 12

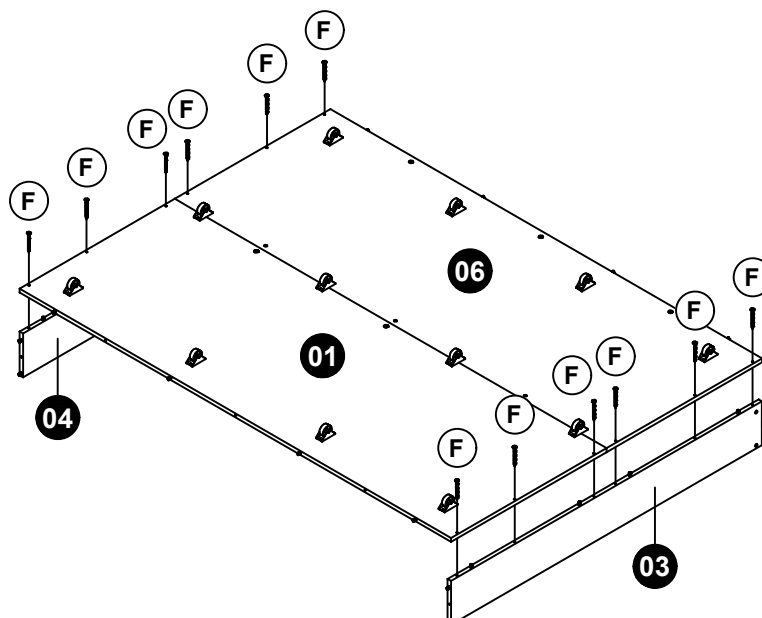

50



F x 5

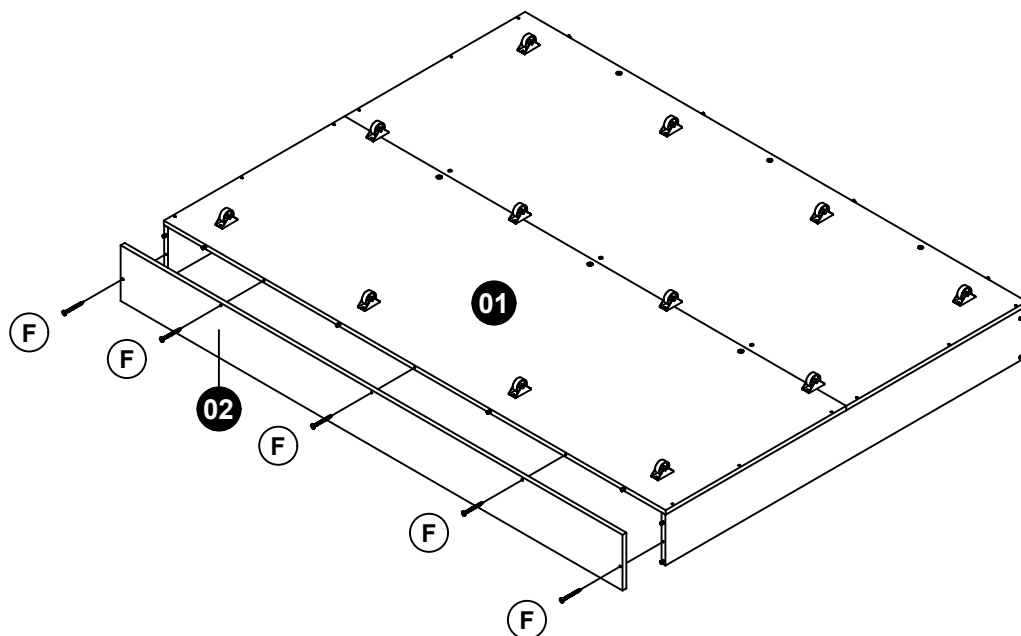

51

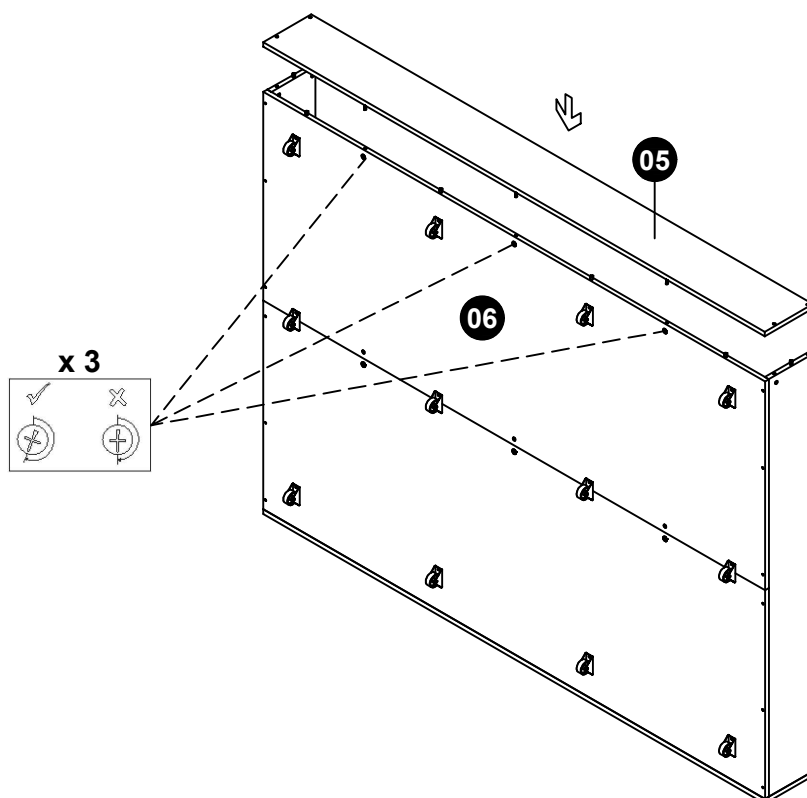

52



L x 4



P x 4

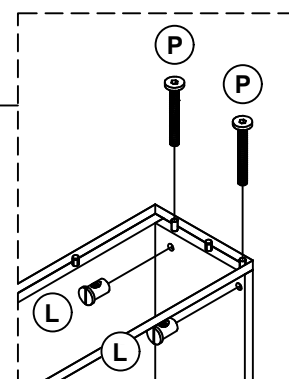
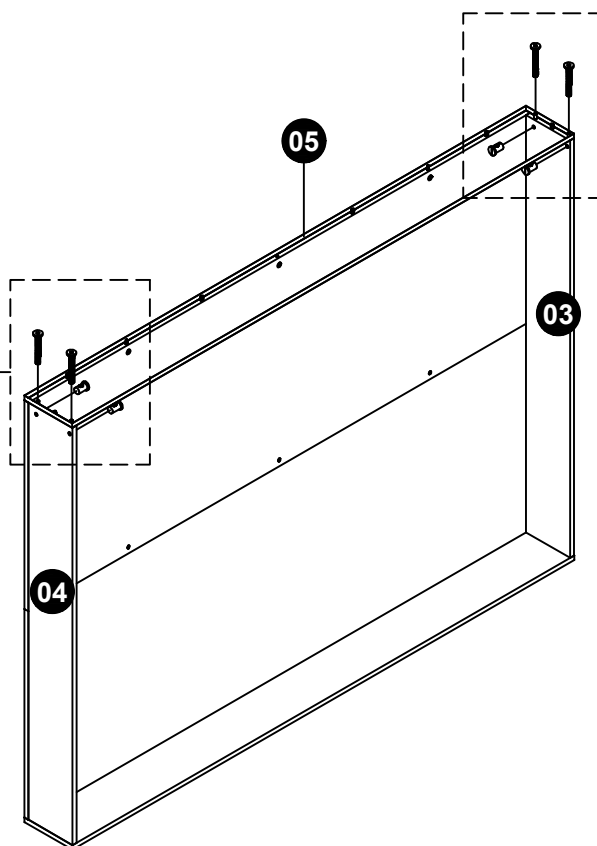
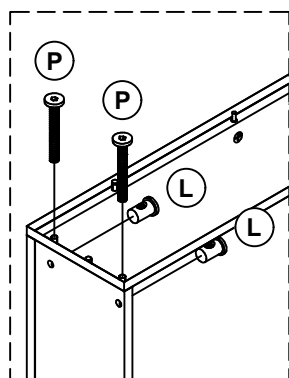

53

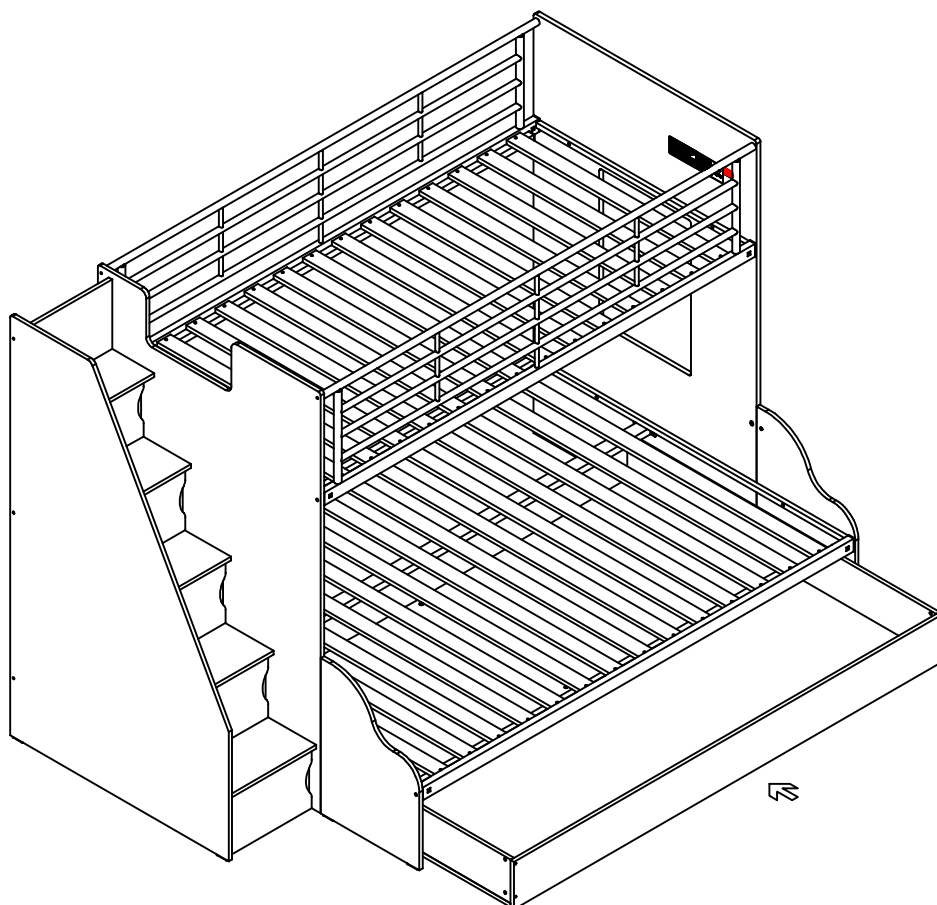

# Adjusting Possibilities

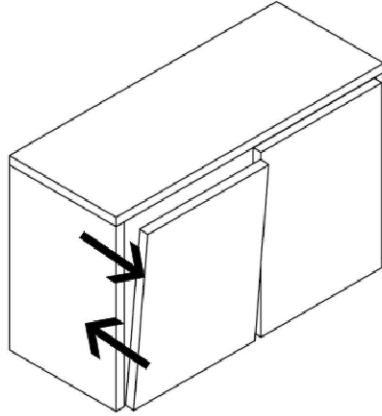
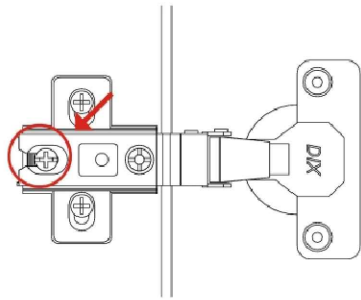

**Depth Adjustment**  
after loosening the hinge  
arm mounting screw

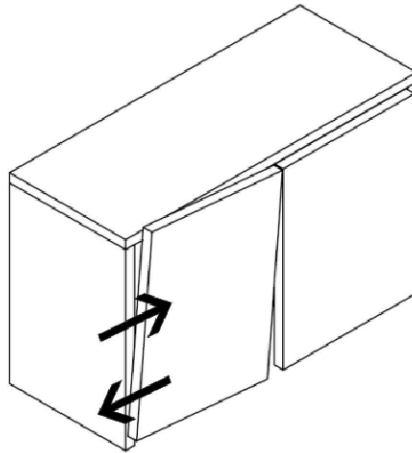
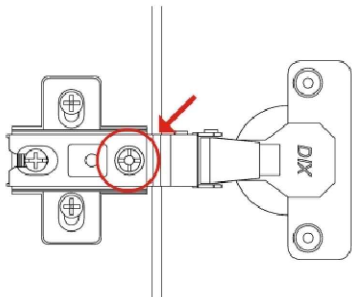

**Lateral Adjustment**  
by adjusting screw

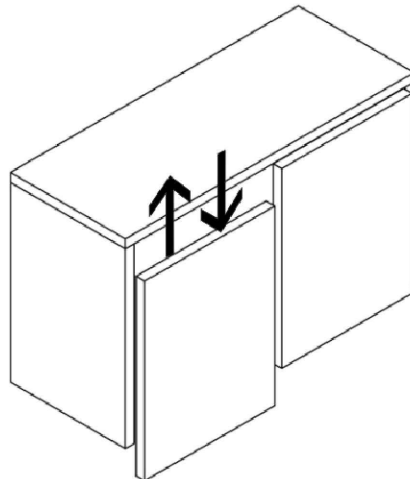
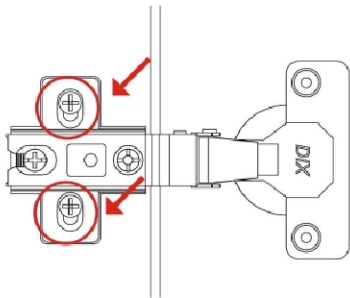

**Vertical Adjustment**  
via mounting plate (via  
slots or, if in two pieces,  
via screw)

