

## **ASSEMBLY INSTRUCTIONS**

### **Shanley Oak Bookshelf With Cabinet**

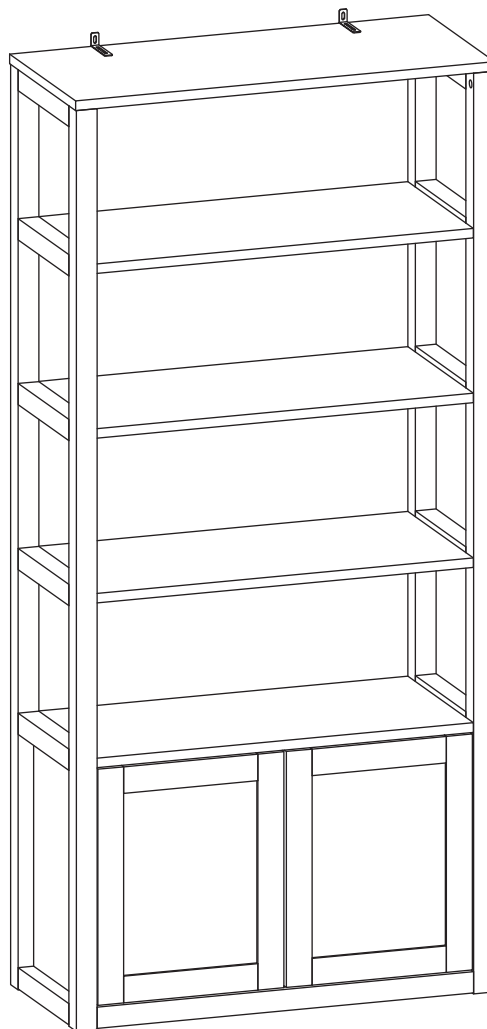

**Two people required**

**[www.templeandwebster.com.au](http://www.templeandwebster.com.au)**

## Keep these instructions for future reference

Assemble the furniture on a soft level surface to avoid damaging the furniture or your floor.

Parts of the assembly will be easier with 2 people.

We recommend furniture be assembled near where they will be placed, to avoid moving the product unnecessarily once assembled.

If there is a need to move the furniture, please remove all loose items and have extra hands to help lift the furniture to the desired location. Dragging the furniture will damage both the furniture and the floor.

Regularly check and re-tighten (if necessary) all bolts on furniture that you have assembled yourself.

**Warning:** In order to prevent overturning, this product must be used with the wall attachment device provided.

## Care and Maintenance of your Furniture

Always use coasters or placemats to protect the table surface, remove any liquid spills immediately using a clean cloth or kitchen roll sheet & mild detergent.

## Do not stand on the Furniture



## **WARNING:**

It is **STRONGLY RECOMMENDED** that you **ANCHOR** this product.

Toppling furniture can cause serious injuries and death.

This product has been supplied with a bracket. To prevent your furniture from tipping forward it is strongly recommended that you securely attach this product to a wall or other solid surface, using the brackets provided and appropriate fixings.

## **IMPORTANT:**

Regularly check that anchors are securely maintained.

Use safety drawer locks to prevent children climbing.

Stability of tall items may be affected by thick pile carpet or uneven floors.

Do not place unanchored televisions on furniture.

## **CAUTION:**

For your safety when attaching the anchor fixings, please note the following:

- Check for any electrical wires or plumbing inside the wall before drilling any holes (if you are unsure, please seek professional advice from a qualified tradesperson)
- Walls are constructed from different materials, for example, masonry (solid brick) or plasterboard lined cavity walls (hollow). It is important that you use the appropriate wall fixings for your wall type. If unsure, please seek professional advice on how to attach this safety bracket to your specific wall.
- Your local hardware store will have the necessary drills and fixings and can offer advice if needed. If in doubt, engage the services of a qualified tradesperson to install and anchor the product.

# Tools Required

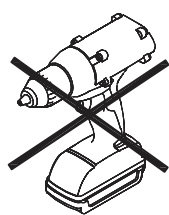

DO NOT USE

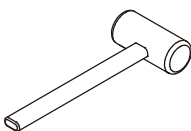

Mallet

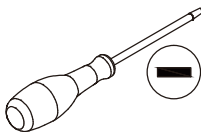

Flat Head Screwdriver

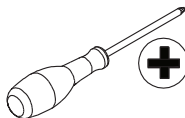

Cross Screwdriver

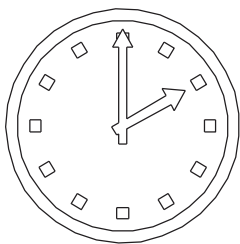

60 min

# Parts List

Top Panel (P1);  
Left Side (P2);  
Right Side (P3);  
Shelf (P4)x3;  
Shelf (P5);  
Movable Shelf (P6);

Bottom Panel (P7);  
Bottom front rail (P8);  
Back Panel (P9);  
Left Door (P10);  
Right Door (P11).

# People Required



TWO PERSON RECOMMENDED

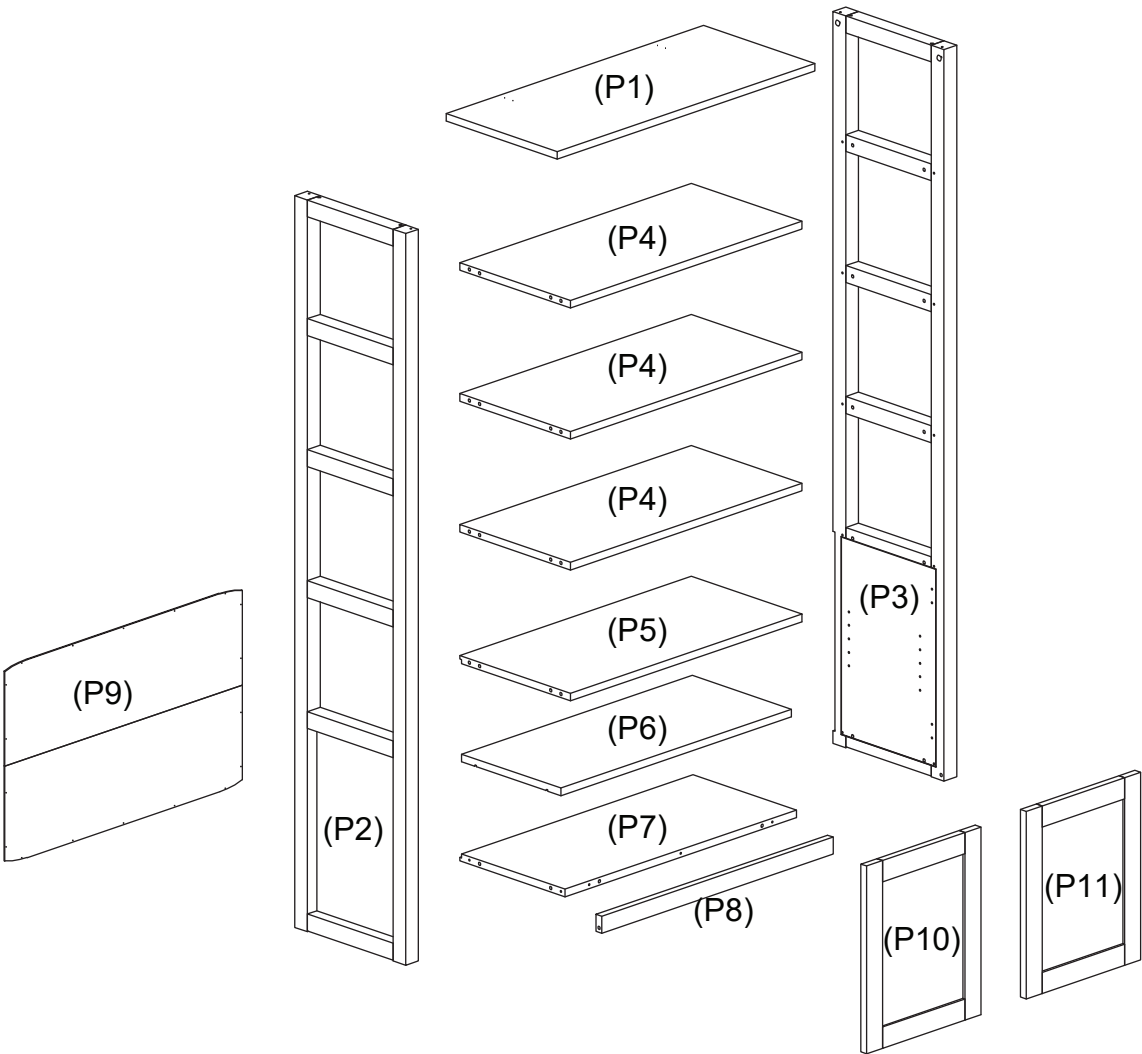

## Hardware/Fittings

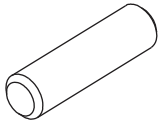

Ø 8x30mm  
Wood Dowel x 26

①

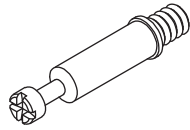

Ø 6x34mm  
Connecting Bolt x 27

②



Ø 15x12mm  
Locking nut x 27

③

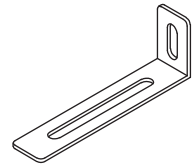

75x25x15mm  
Bracket x 2

④



Ø 3.5x16mm  
Screw x 26

⑤

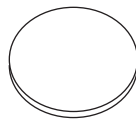

Ø 25x3mm  
Felt Foot x 4

⑥

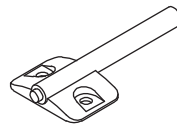

Push To Open x 2

⑦

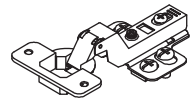

Hinge x 4

⑧



Ø 3.5x16mm  
Screw x 10

⑨

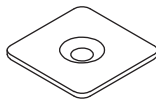

20x20mm  
Door Bumper x 2

⑩



Ø 5x16mm  
Shelf Support x 4

⑪

# 1

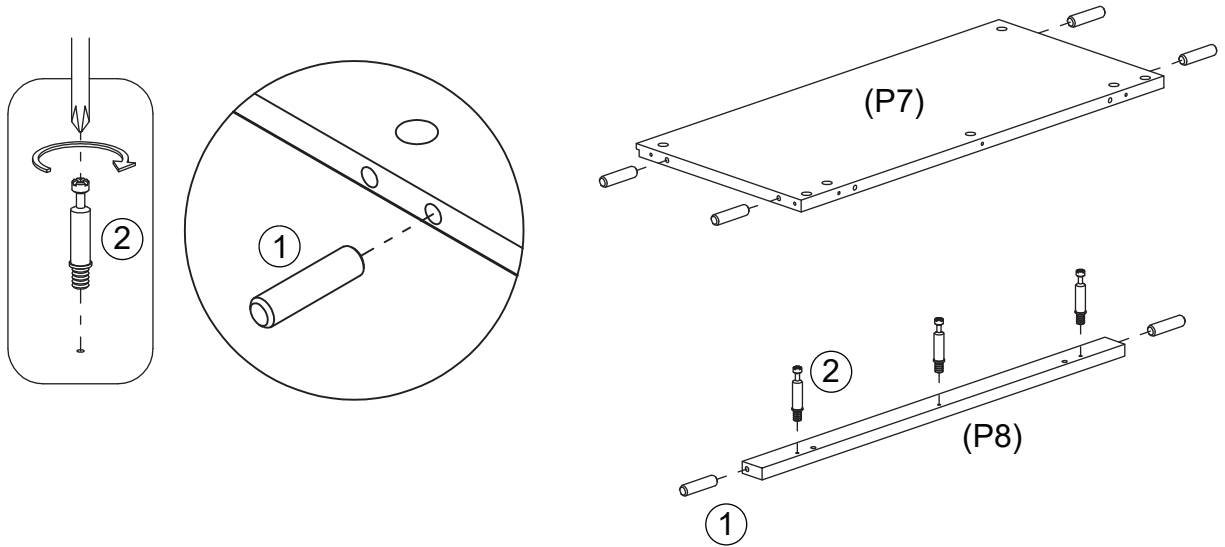
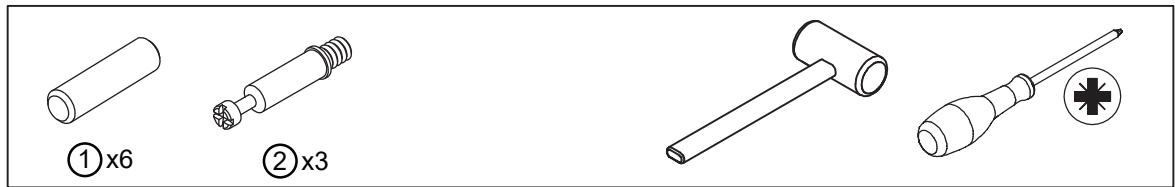

Screw 3 x Bolts (2) into Bottom Front rail (P8).  
 Insert 6 x Wood Dowels (1) into Bottom Panel (P7) and Bottom Front Rail (P8).  
 If necessary, gently tap the wood dowels with a mallet.

# 2

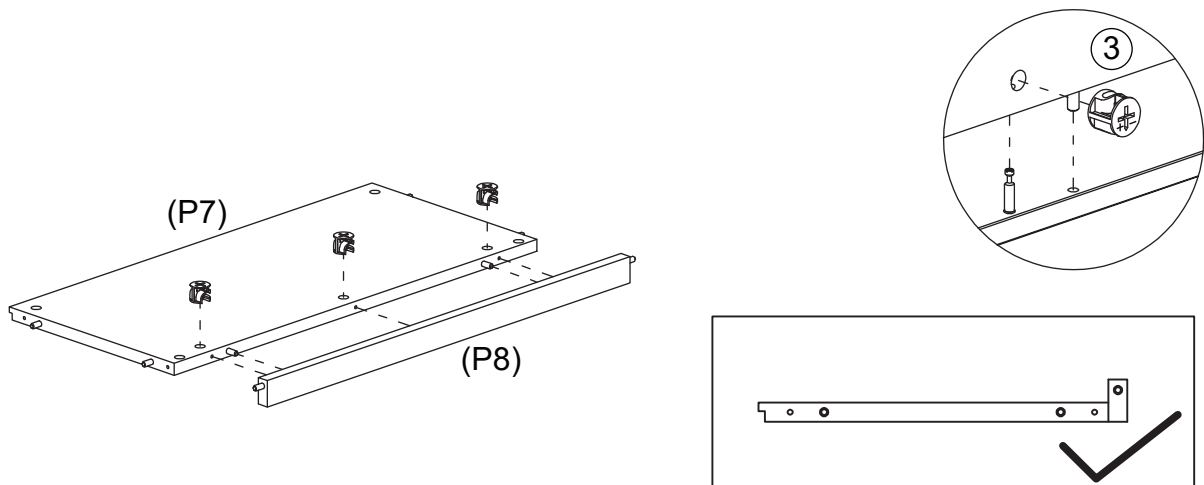

Attach Bottom Front Rail (P8) to Bottom Panel (P7) using 3 x Locking Nuts (3).  
 Use a screwdriver to turn the nuts clockwise to lock.

# 3

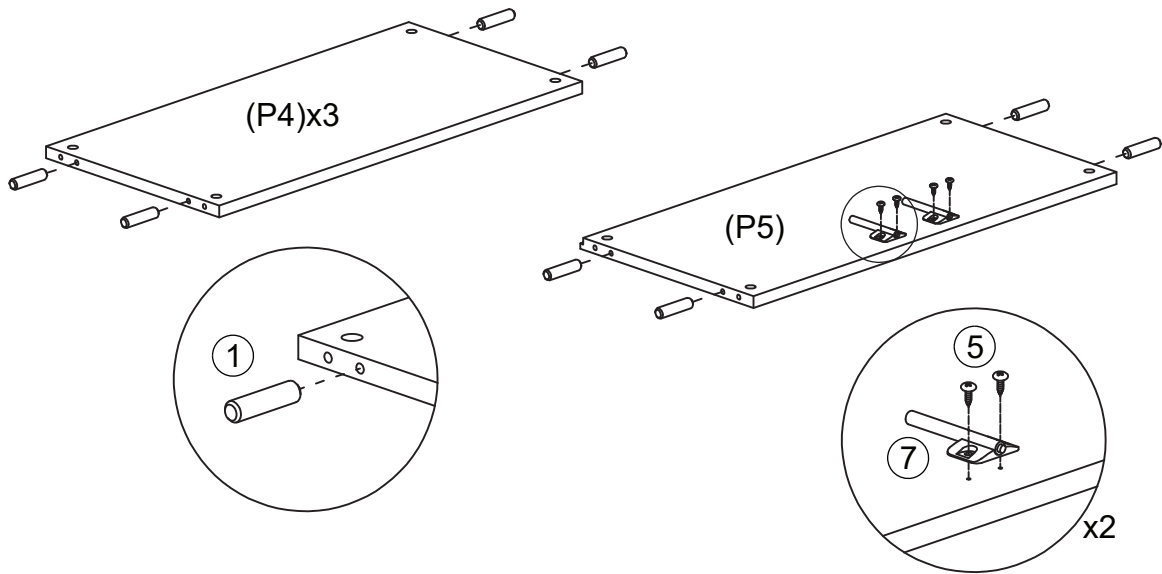
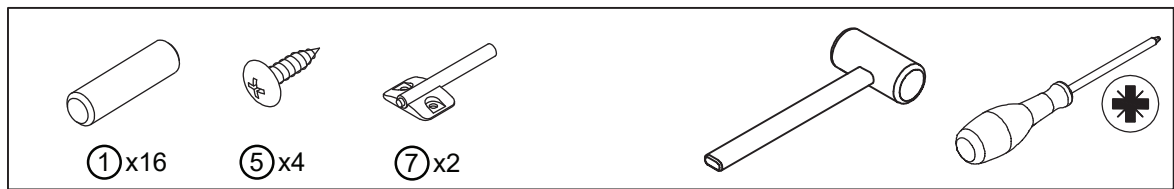

Insert 16 x Wood Dowels ① into Shelf (P5) and 3 x Shelf (P4).  
If necessary, gently tap the wood dowels with a mallet.  
Fix 2 x Push to open ⑦ to Shelf (P5) with 4 x screw ⑤ using a screwdriver.

# 4

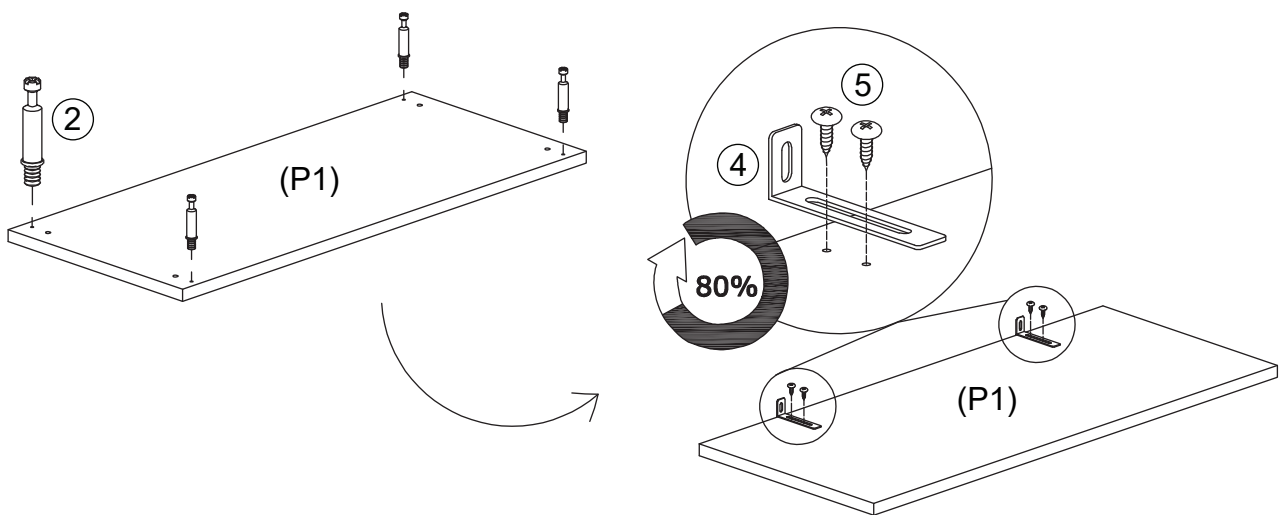
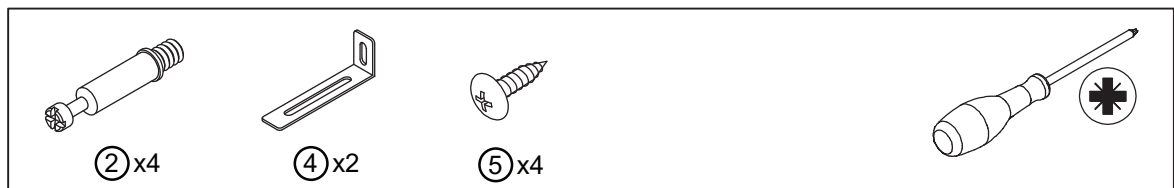

Screw 4 x Bolts ② into Top Panel (P1).  
Loosely attach 2 x Brackets ④ to Top Panel (P1) with 4 x screws ⑤ using a screwdriver.

# 5

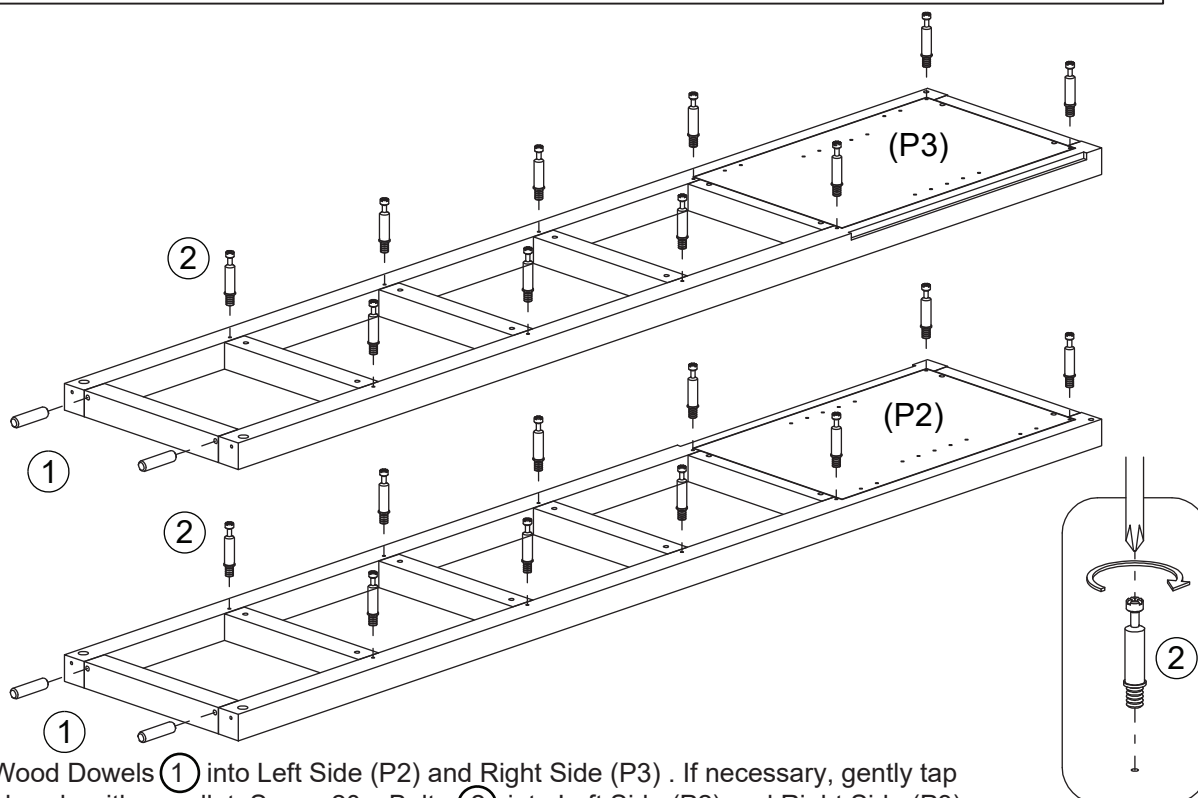

Insert 4x Wood Dowels ① into Left Side (P2) and Right Side (P3) . If necessary, gently tap the wood dowels with a mallet. Screw 20 x Bolts ② into Left Side (P2) and Right Side (P3).

# 6

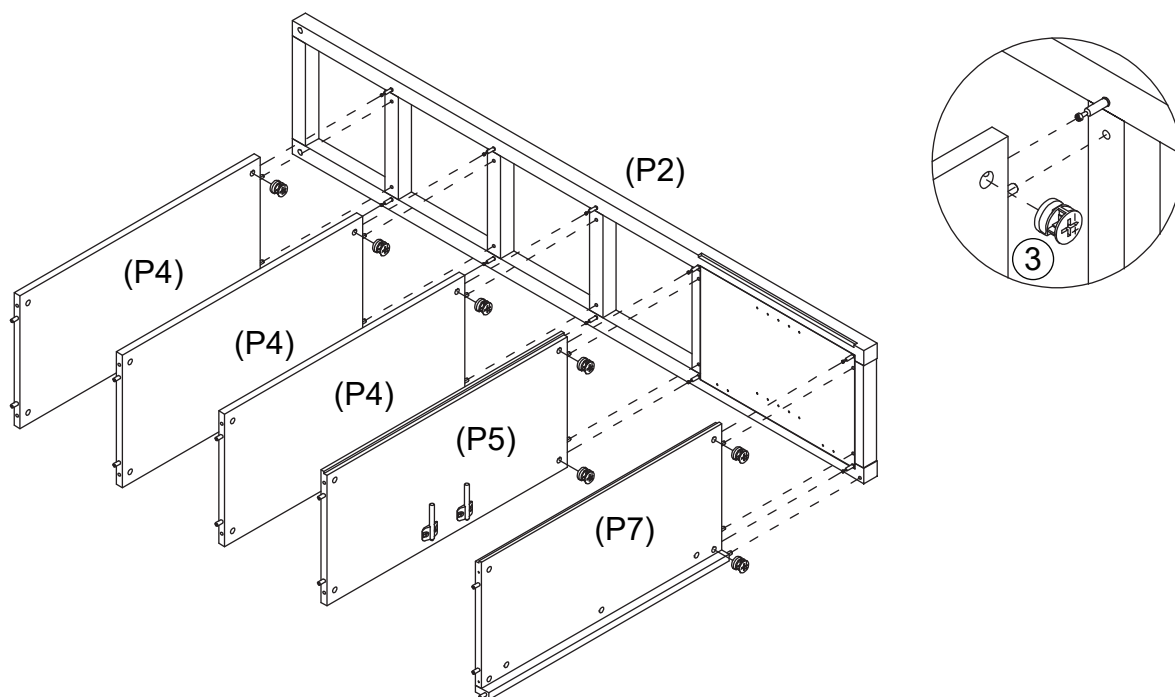
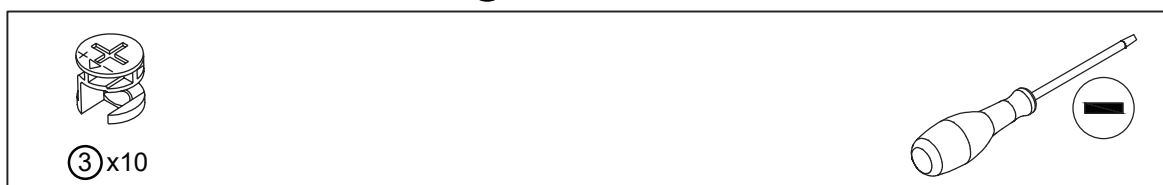

Attach 3 x Shelf (P4), Shelf (P5) and Bottom Panel (P7) to Left Side (P2) with 10 x Locking Nuts ③ . Use a screwdriver to turn the nuts clockwise to lock.



# 7



③ x10

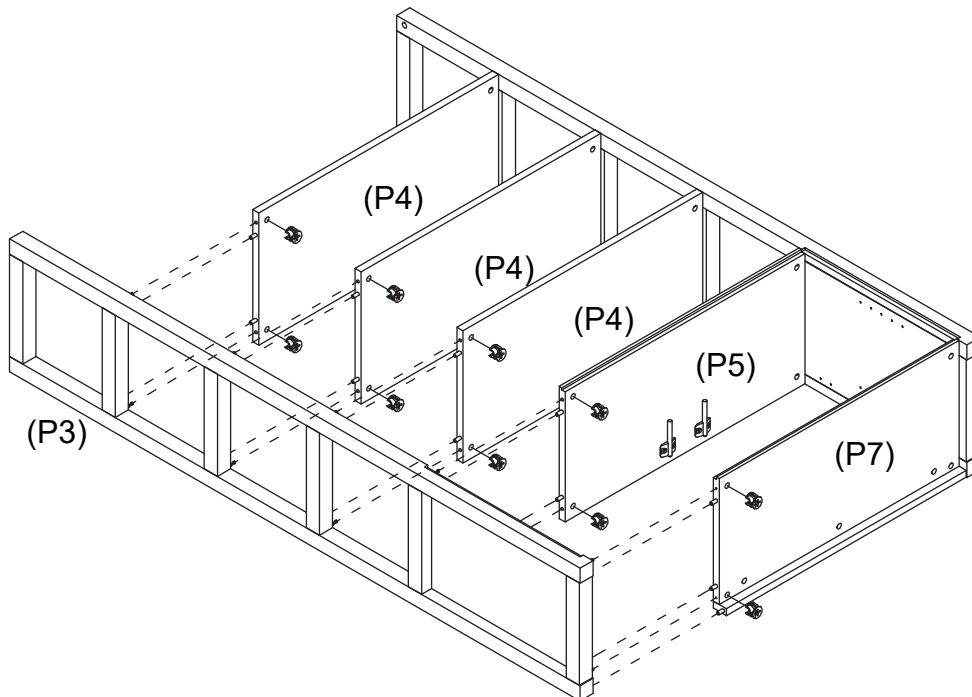
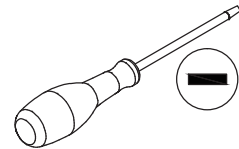

Attach 3 x Shelf (P4), Shelf (P5) and Bottom Panel (P7) to Right Side (P3) with 10 x Locking Nuts ③. Use a screwdriver to turn the nuts clockwise to lock.

# 8



③ x4

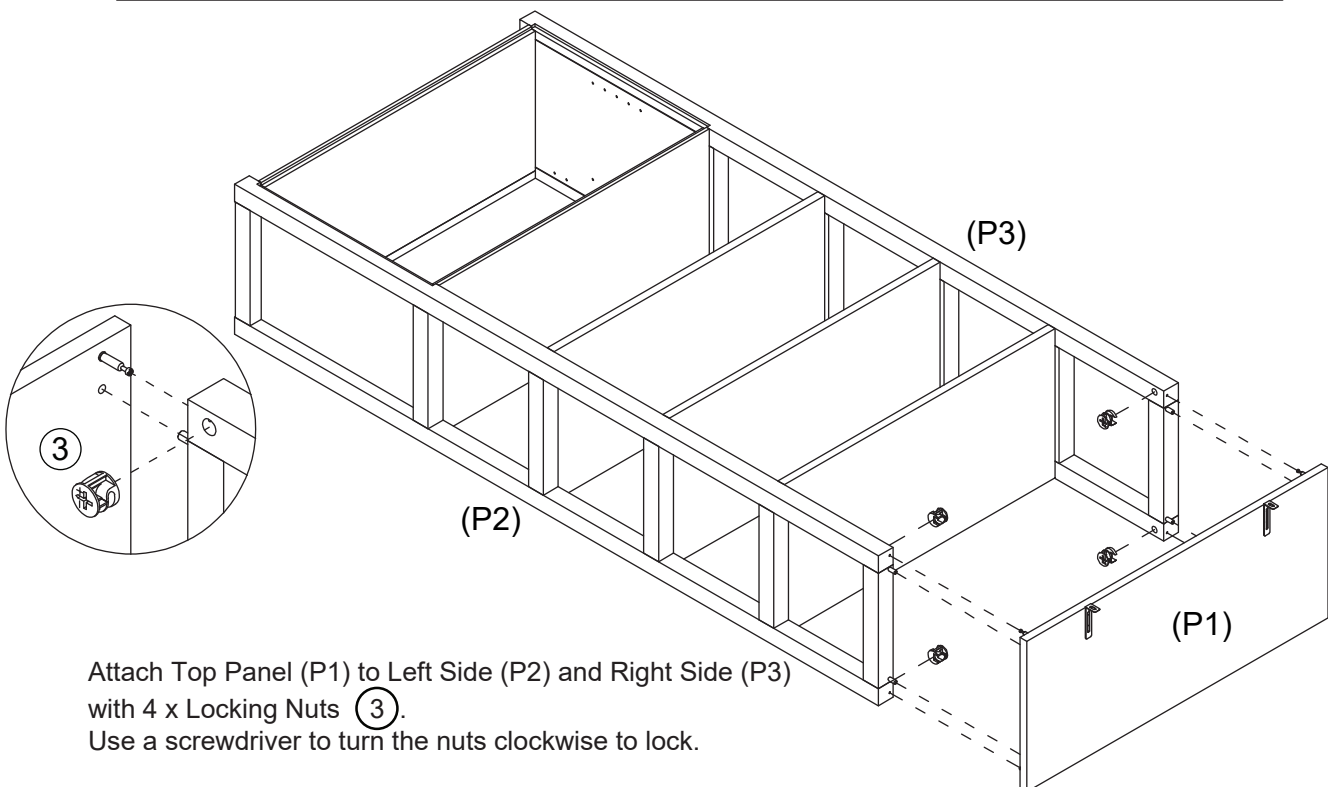
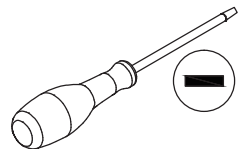

Attach Top Panel (P1) to Left Side (P2) and Right Side (P3) with 4 x Locking Nuts ③. Use a screwdriver to turn the nuts clockwise to lock.

# 9

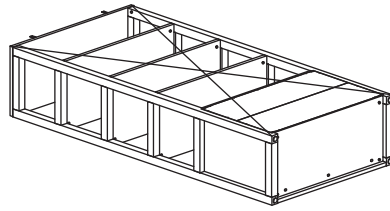

  
AA = BB

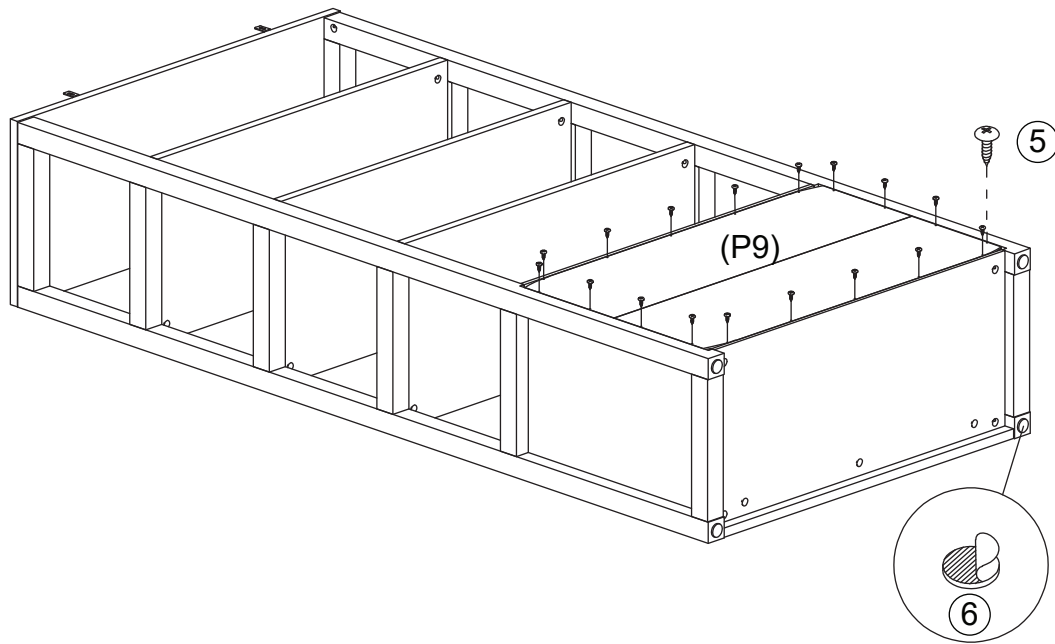

Attach 4 x Felt Foot (6) to the Left Side (P2) and Right Side(P3).

Place Back Panel (P9) onto the back as shown.

If necessary, adjust the assembly so that the diagonal measurements of the assembly are equal.

Fix the Back Panel (P9) to the Bottom, Left, Right Sides, Shelf, using 18 x Screws (5) as shown.

With help, carefully turn the Bookshelf over.

# 10

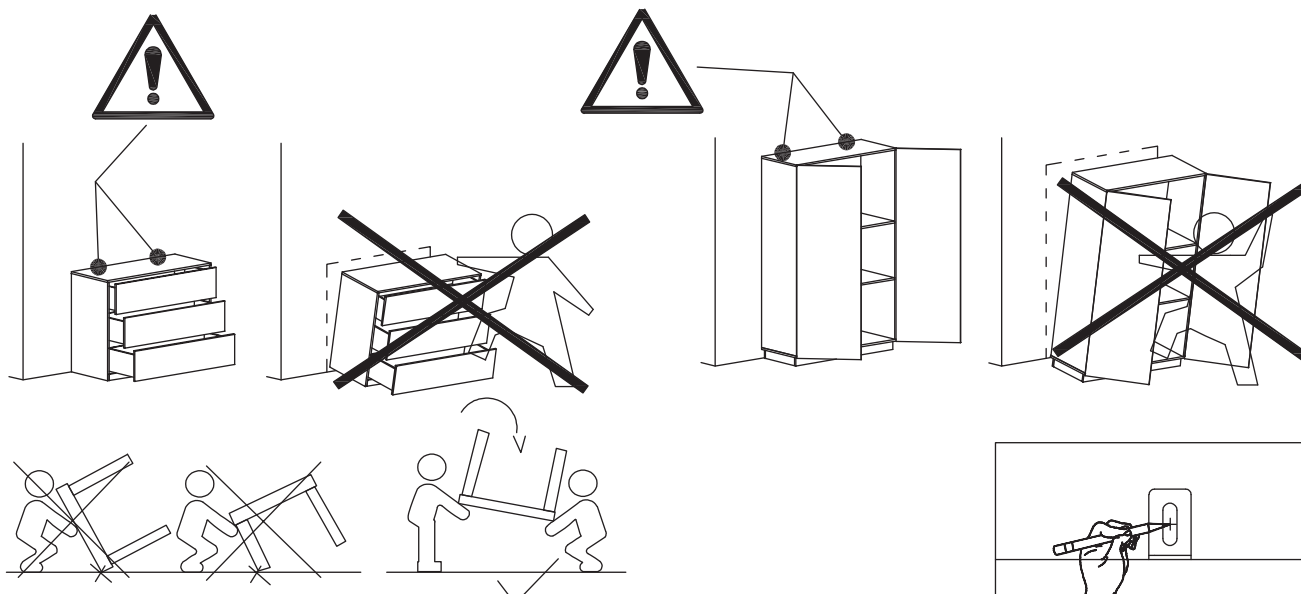
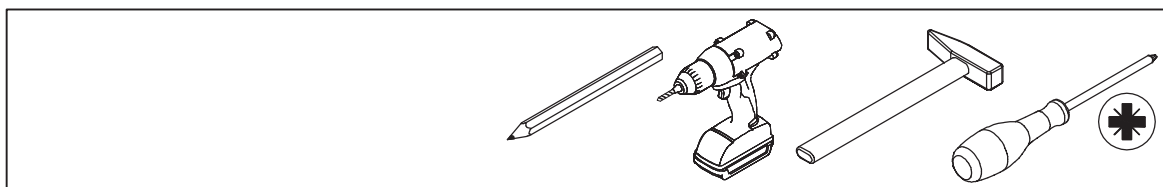

With help, carefully turn the Bookshelf over.

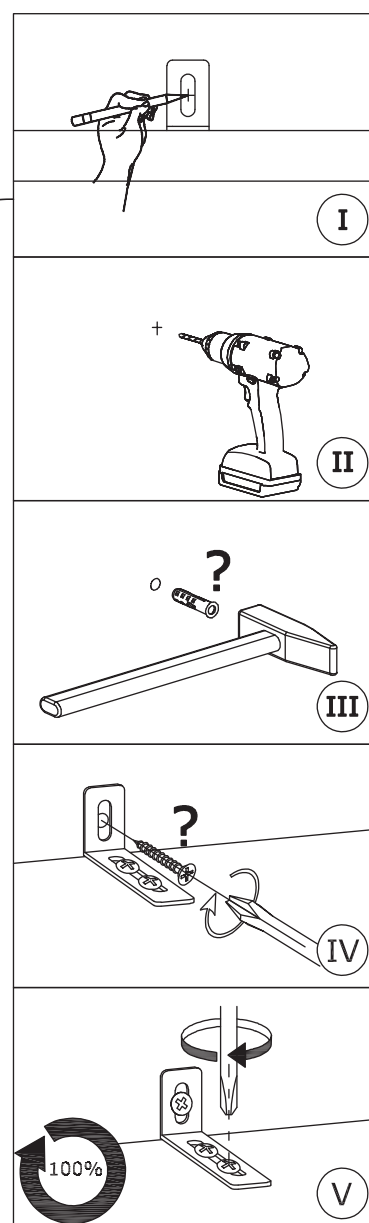
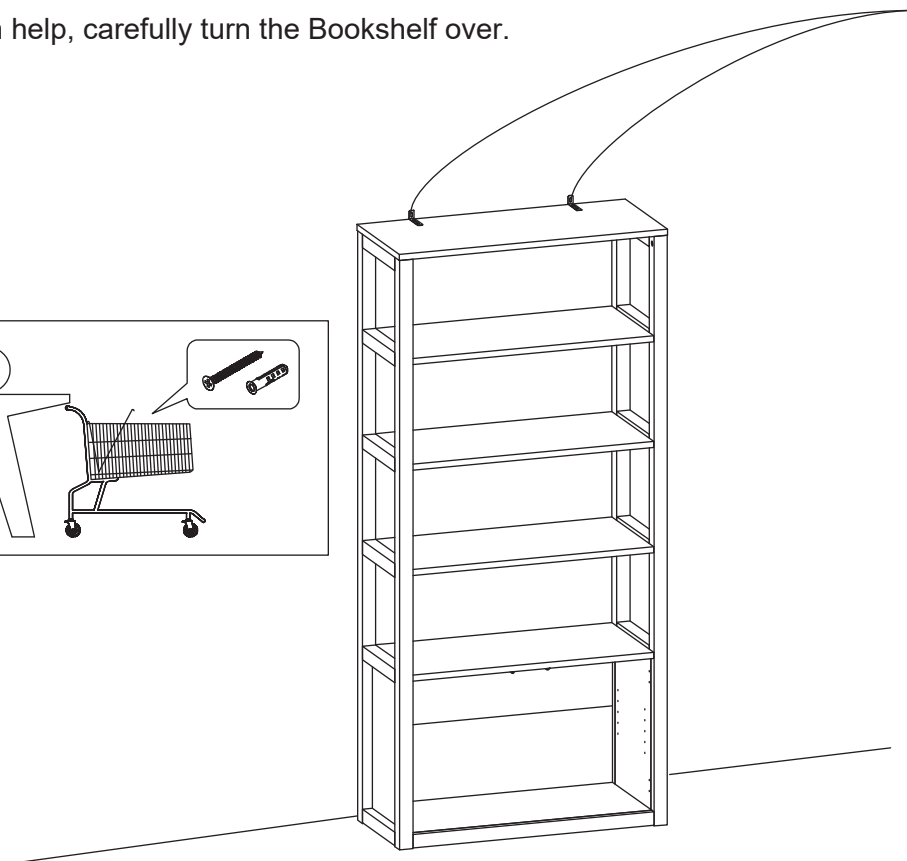
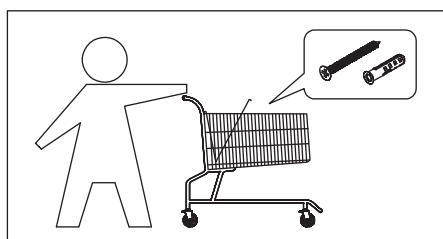

- I. With help, move the Bookshelf into position. Mark drilling points on the wall.
- II. If necessary, remove the Bookshelf and drill holes with sizes suitable for your wall fixings.
- III. Install wall fixings in the holes.
- IV. Reposition Bookshelf and fix the wall brackets to the wall with appropriate wall fixing screws.
- V. Fasten the wall brackets to the top panel.

# 11



⑪ x4

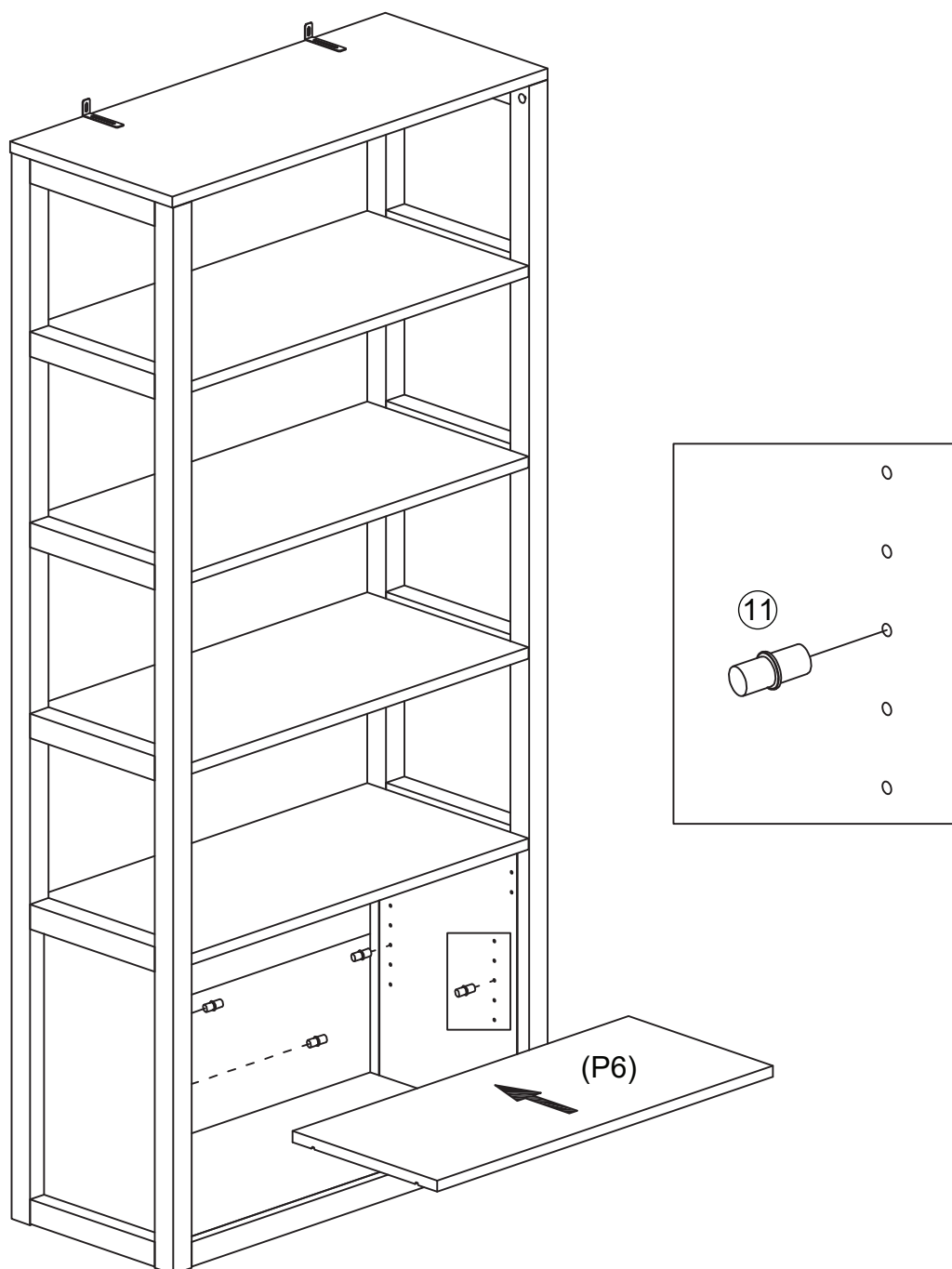

Insert 4 x Shelf Supports ⑪ into desired locations on the side panels.  
Gently place the Shelf (P6) as shown.

# 12

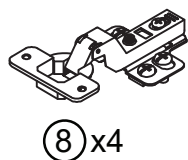

⑧ x4



⑨ x10

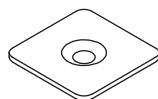

⑩ x2

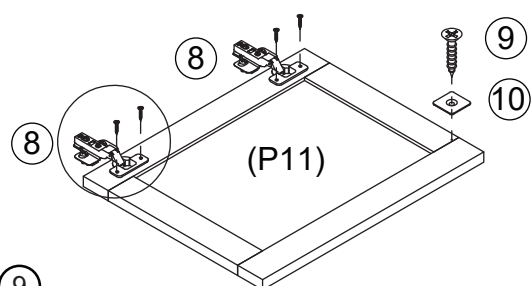
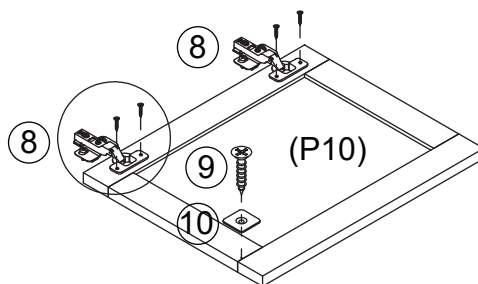
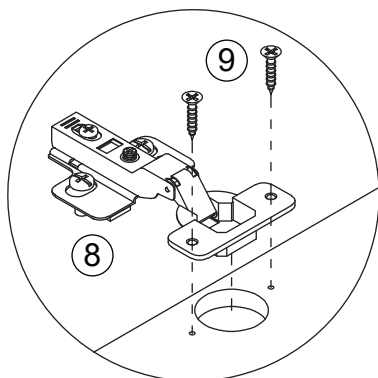
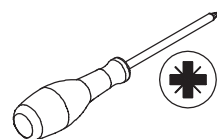

Fix 4 x Hinges ⑧ to Door (P10)(P11) using 8 x Screws ⑨ .

Fix 2 x Door Bumper ⑩ to Door (P10)(P11) using 2 x Screws ⑨ .

# 13

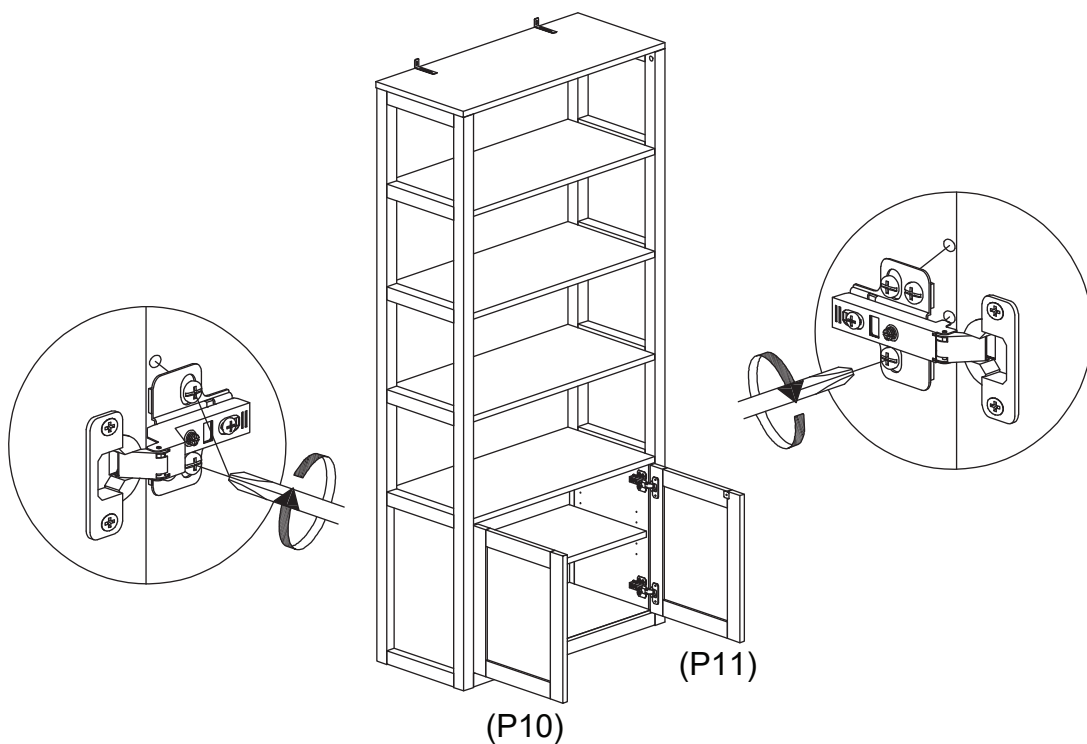
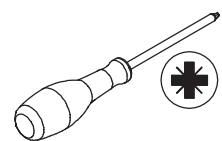

Attach the door on the Bookshelf as shown.

If adjustment is necessary, please follow the steps below:

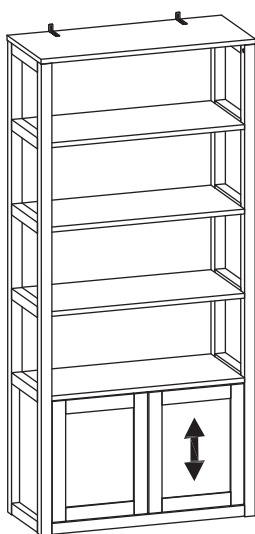

To move doors up or down:  
loosen or tighten the screws on the hinge plate, as shown.

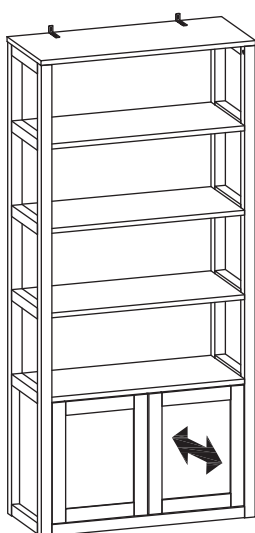
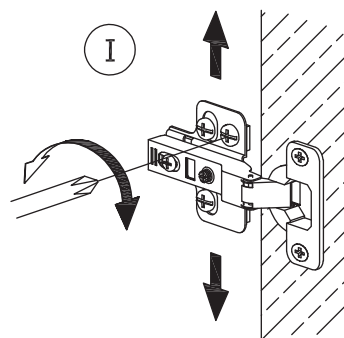

To move doors in or out:  
loosen or tighten the screws on the hinge plate, as shown.

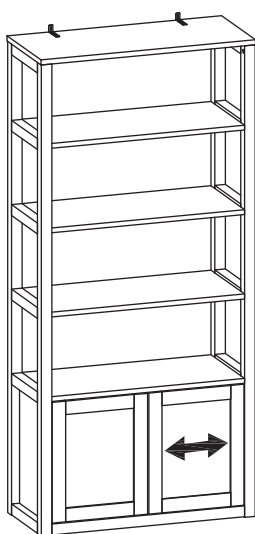
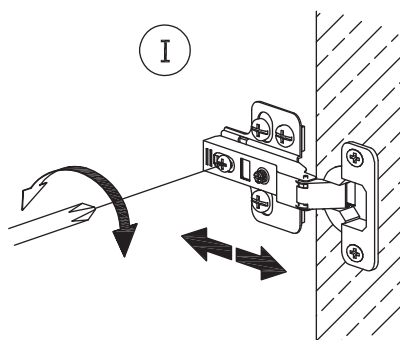

To move doors left or right:  
Loosen or tighten the screws to suit, as shown.

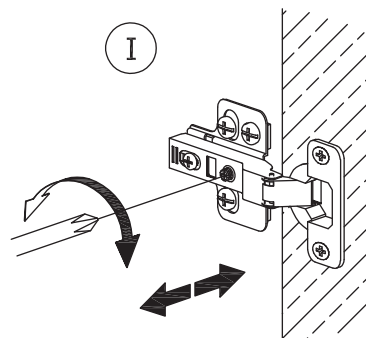

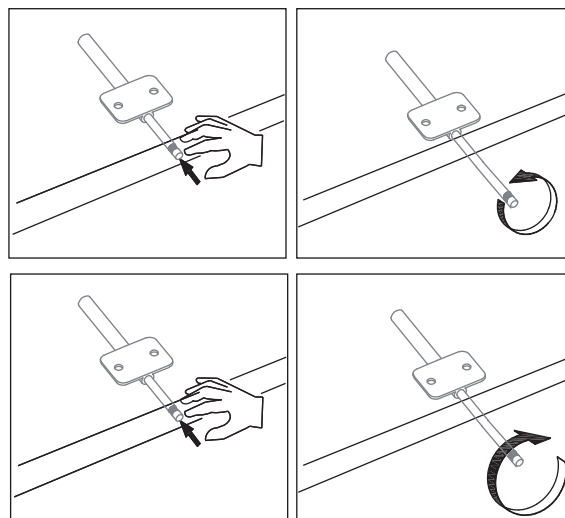
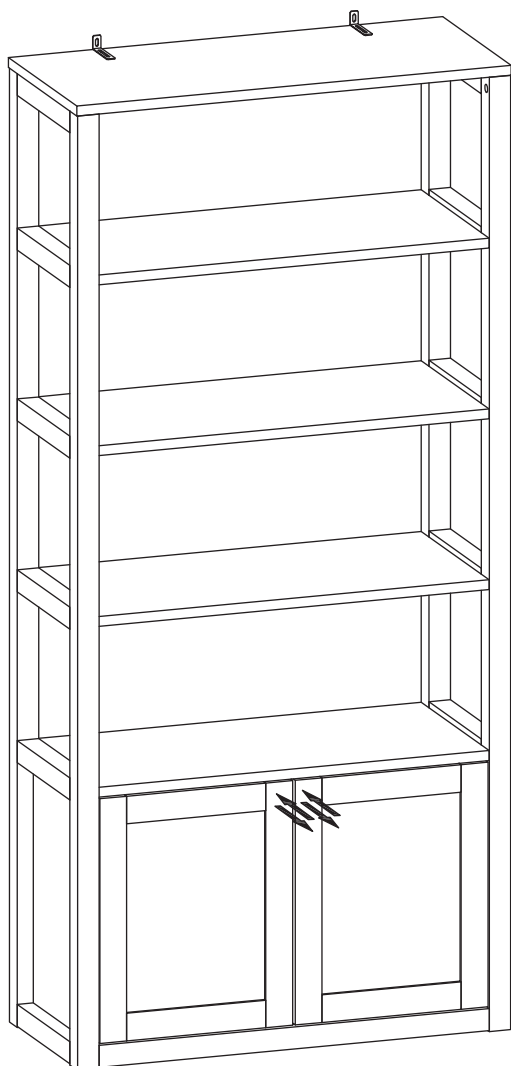

To adjust the push-to-open latches, please follow the steps below:  
 Push and release the piston once to allow the piston to extend.  
 Turn the piston clockwise or anti-clockwise to adjust the position of the piston.  
 Push the piston once to retract the piston.

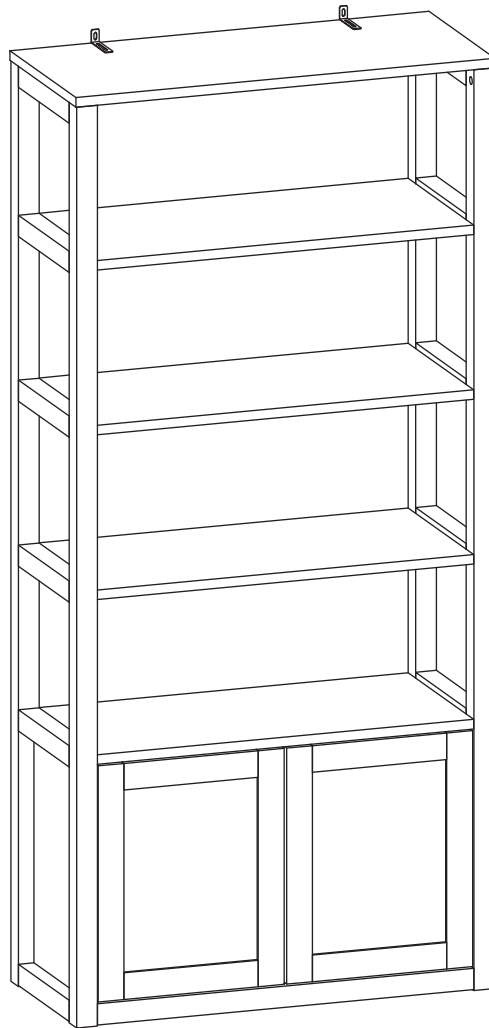

Assembly is complete.