

TEMPLE & WEBSTER

ASSEMBLY INSTRUCTIONS

VIBLKBCW

"Read these instructions and follow steps carefully to ensure you assemble the product correctly and avoid damages. Check that all parts and hardware have been provided before assembling the product. Place all contents on a clean, soft-flat surface to avoid scratching the product."



"CAUTION:
Only tighten bolts to 80% at first. Once all parts have been assembled, fully tighten all hardware.
To prevent damage to threads, do not use a power tool and do not over tighten bolts.
Use two people to lift and turn the product when assembling.
Do not attempt with only one person and do not roll onto legs.
Keep all hardware and small parts away from children."

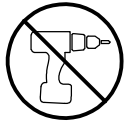

Do not use power tools to assemble this product. Only use the tools provided or recommended for use in these instructions.
The use of power tools to assemble your product may result in damages or potentially void your warranty.

| PART LIST | | |
|-----------|--------------|------|
| ITEM | DESCRIPTION | QTY |
| A | LEFT PANEL | 1PC |
| B | RIGHT PANEL | 1PC |
| C | TOP PANEL | 1PC |
| D | MIDDLE PANEL | 2PCS |
| E | BOTTOM PANEL | 1PC |
| F | RAIL | 4PCS |
| G | LEG | 4PCS |

| HARDWARE LIST | | |
|---------------|-------------|-------|
| ITEM | DESCRIPTION | QTY |
| 1 | CAM BOLT | 24PCS |
| 2 | CAM LOCK | 24PCS |
| 3 | SHORT SCREW | 1PC |
| 4 | LONG SCREW | 1PC |
| 5 | WASHER | 2PCS |
| 6 | WALL PLUG | 1PC |
| 7 | BRACKET | 1PC |

STEP 1:

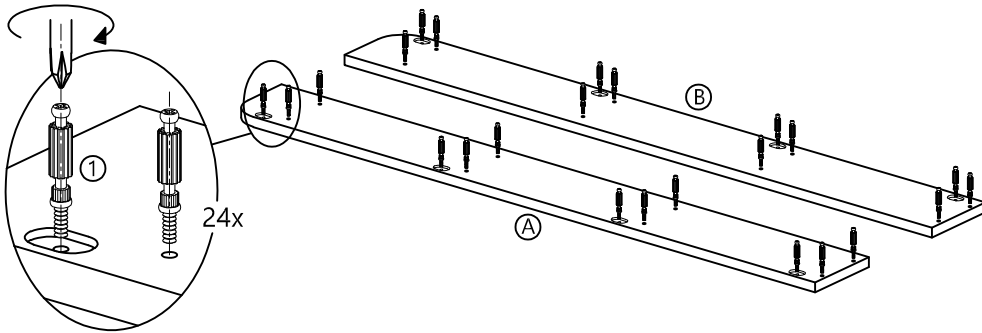

STEP 2:

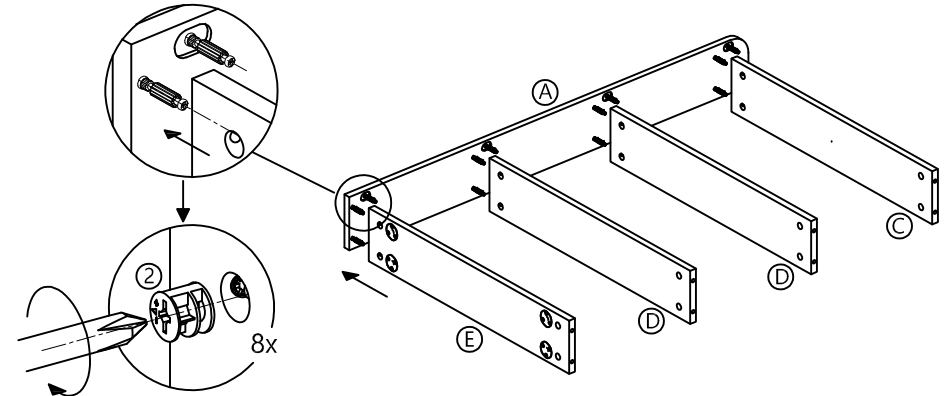

STEP 3:

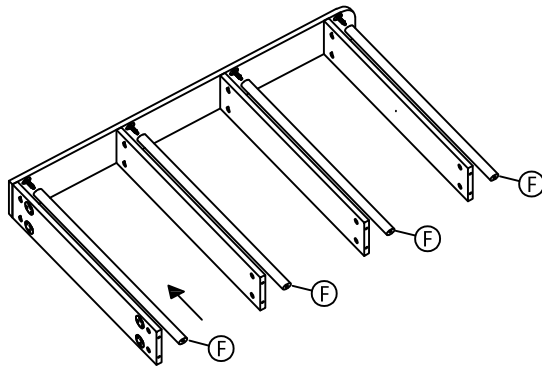

STEP 4:

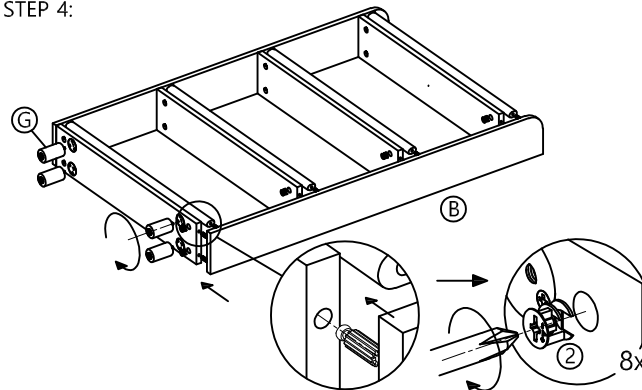

STEP 5:

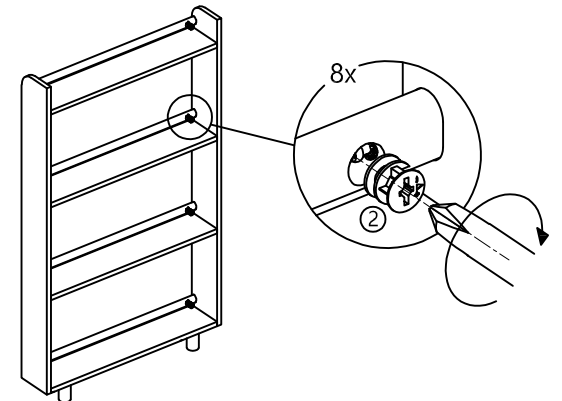

STEP 6:

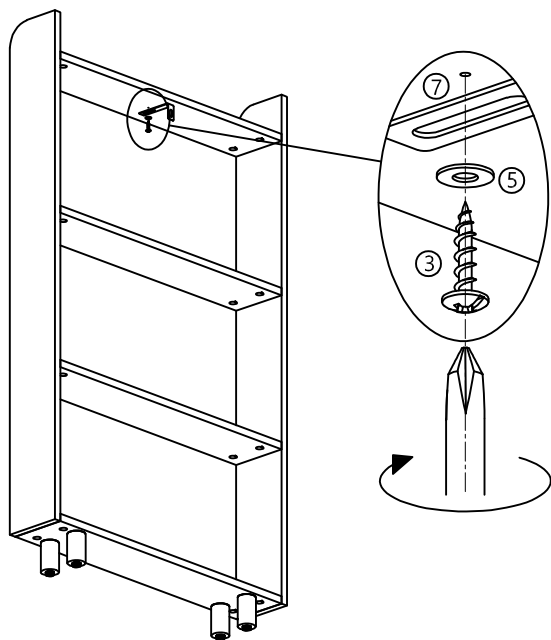

STEP 7:



With help, place the unit against the wall in its final location and mark the drill hole position.

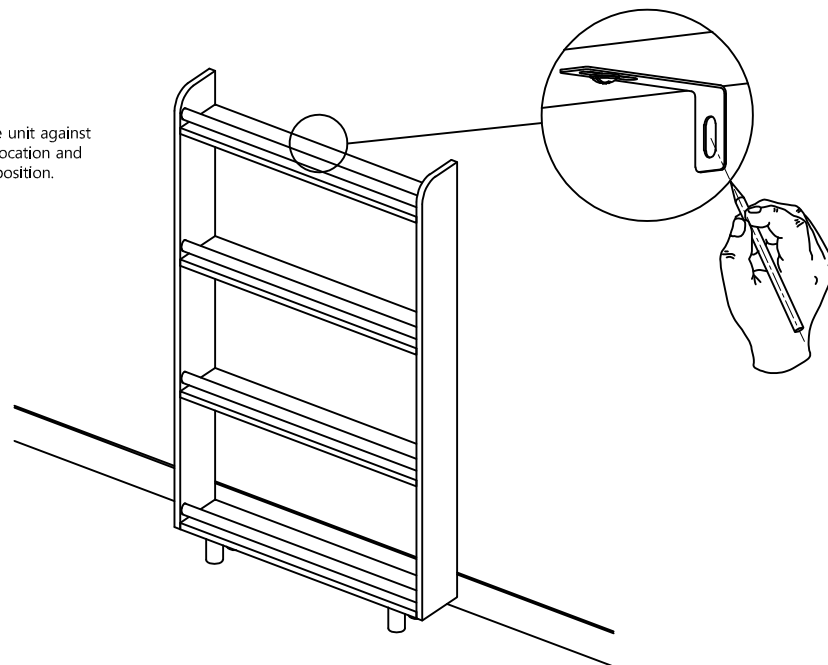

STEP 8:

For your safety when attaching the anchor fixings, please note the following:

- Check for any electrical wires or plumbing inside the wall before drilling any holes (If you are unsure, please seek professional advice on how to attach this safety strap to your specific wall)
- Walls are constructed from different materials, for example, masonry (solid brick) or plasterboard lined cavity walls (hollow). It is important that you use the appropriate wall fixings for your wall type.
- Your local hardware store will have the necessary drills and fixings and can offer advice if needed. If in doubt, engage the services of a qualified tradesperson to install and anchor the product.

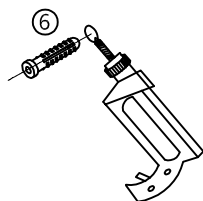

STEP 9:

