

## ASSEMBLY INSTRUCTION

### Raphael 180cm White and Oak Entertainment Unit

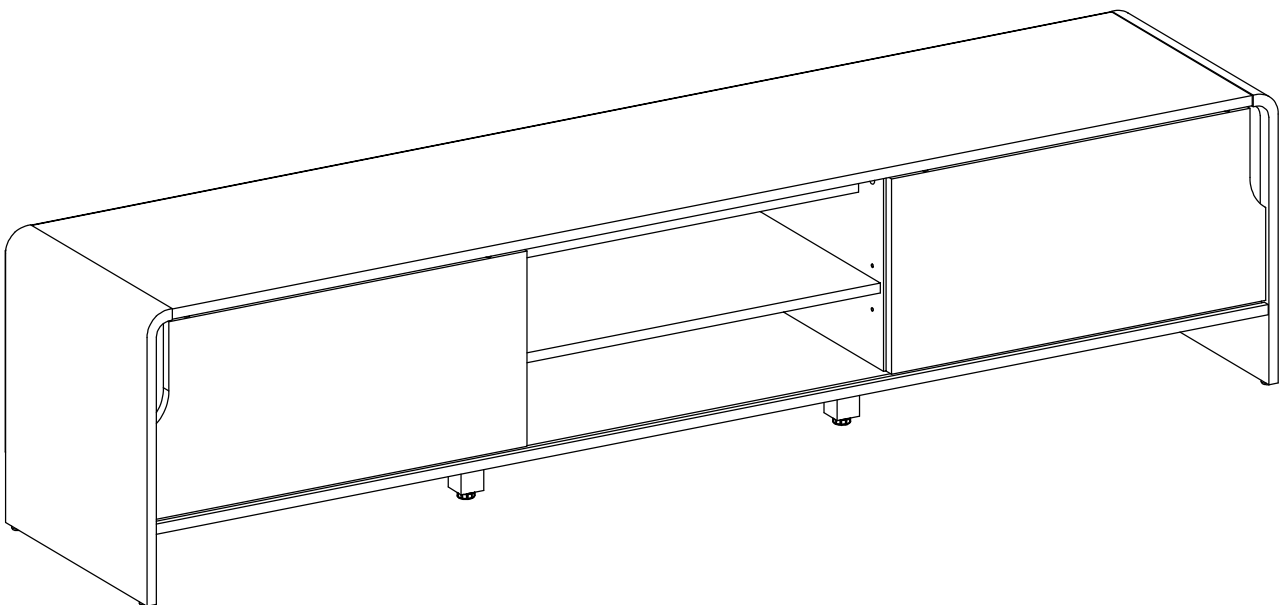

Two people required

[www.templeandwebster.com.au](http://www.templeandwebster.com.au)

## **Keep these instructions for future reference**

Assemble the furniture on a soft level surface to avoid damaging the furniture or your floor.

Parts of the assembly will be easier with 2 people.

We recommend furniture be assembled near where they will be placed, to avoid moving the product unnecessarily once assembled.

If there is a need to move the furniture, please remove all loose items and have extra hands to help lift the furniture to the desired location. Dragging the furniture will damage both the furniture and the floor.

Regularly check and re-tighten (if necessary) all bolts on furniture that you have assembled yourself.

**Warning:** In order to prevent overturning, this product must be used with the wall attachment device provided.

## **Care and Maintenance of your Furniture**

Wipe clean with a damp cloth. Use only water or a gentle detergent.  
Wipe dry with a clean cloth.

Tools Required

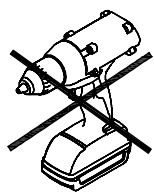

DO NOT USE

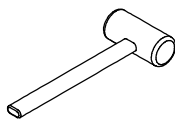

Mallet

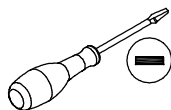

Flat head Screwdriver

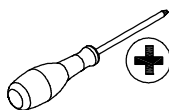

Cross Screwdriver

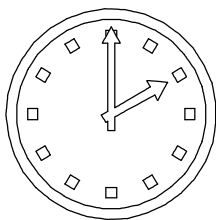

45 min

Time Required

Part List

- |   |                     |    |               |
|---|---------------------|----|---------------|
| 1 | Top Panel           | 7  | Support Panel |
| 2 | Bottom Panel        | 8  | Shelf         |
| 3 | Left Panel          | 9  | Leg           |
| 4 | Right Panel         | 10 | Back Panel    |
| 5 | Divider Left Panel  | 11 | Left Door     |
| 6 | Divider Right Panel | 12 | Right Door    |

people Required

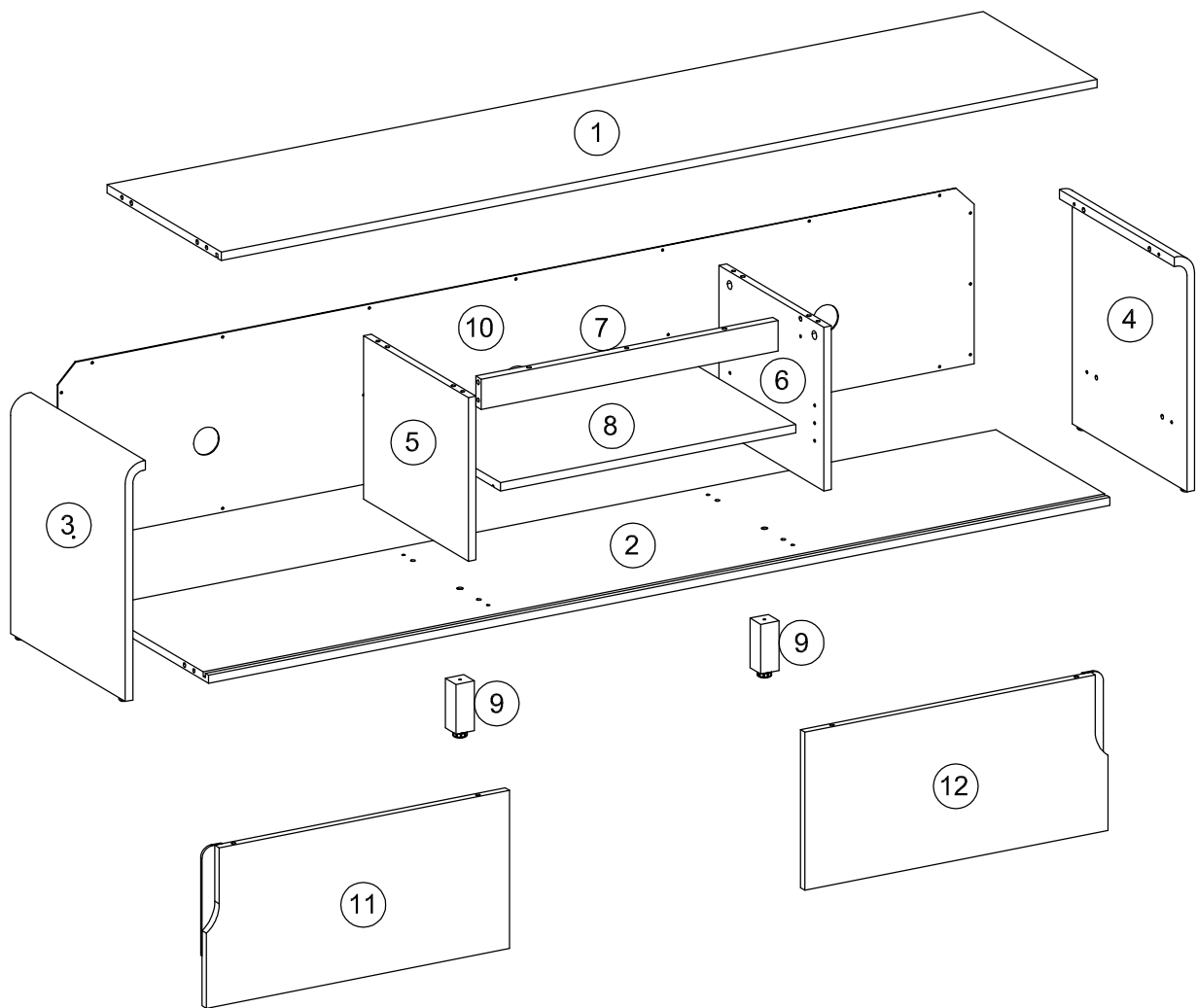
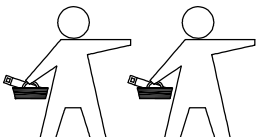

# Hardware/Fittings

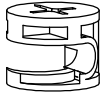

Ø15x12 mm Cam Lock x 15

**A**

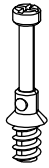

Ø7.5x32 mm Cam Bolt x 15

**B**



Ø20 mm Cam Sticker x 15

**C**



Ø8x32 mm Plastic Dowel x 20

**D**



Ø3x12 mm Screw x 22

**E**



Ø10x33.5 mm Screw x 6

**F**

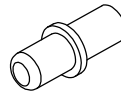

Ø7x16.5 mm Shelf Pin x 4

**G**



M5x20 mm Pin x 2

**H**



Bottom Door Pin x 4

**I**



Top Door Pin x 4

**J**

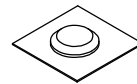

Buffer x 2

**K**

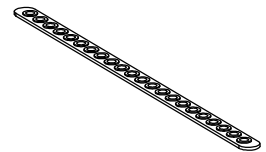

Anti-tip Bracket x 1

**L**

# 1

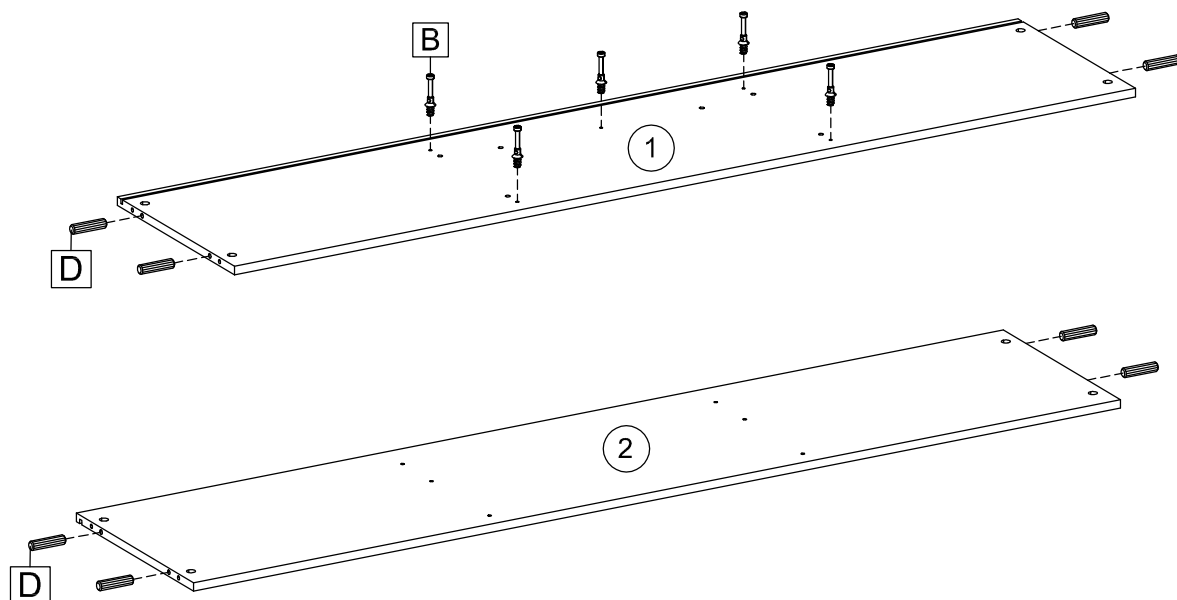

Screw 5 x Cam Bolts (B) into Top Panel (1).  
Insert Plastic Dowel (D) into Top panel (1) and Bottom panel (2),  
If necessary, gently tap the Plastic dowels with a mallet.

# 2



Screw 8 x Cam Bolts (B) into Left Panel (3) and Right Panel (4).

# 3

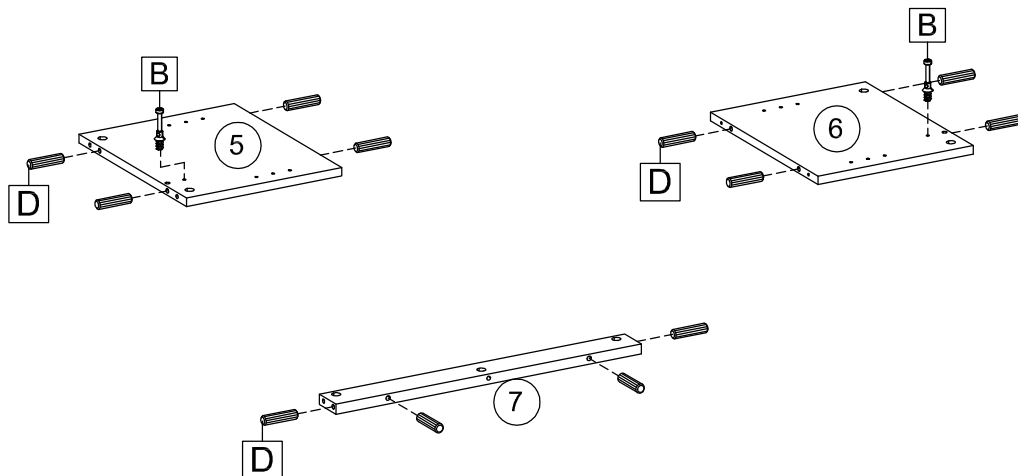
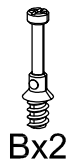

Screw 2 x Cam Bolts (B) into Divider Left Panel (5) and Divider Right Panel (6).  
Insert 12 x Plastic Dowel (D) into Divider Left Panel (5), Divider Right Panel (6) and Support Panel (7),  
If necessary, gently tap the Plastic dowels with a mallet.

# 4

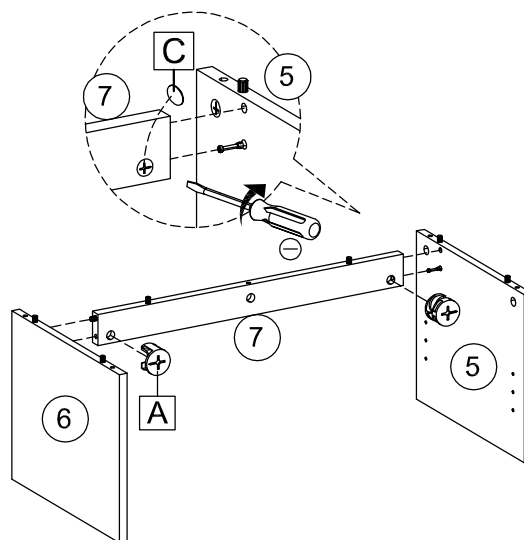

Attach Divider Left Panel (5) and Divider Right Panel (6) to Support Panel (7) using 2 x Cam lock (A),  
Use a screwdriver to turn the Cam lock clockwise to lock.  
Paste 2 x Cam Sticker (C) as shown.

# 6

# 5

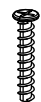

Fx2

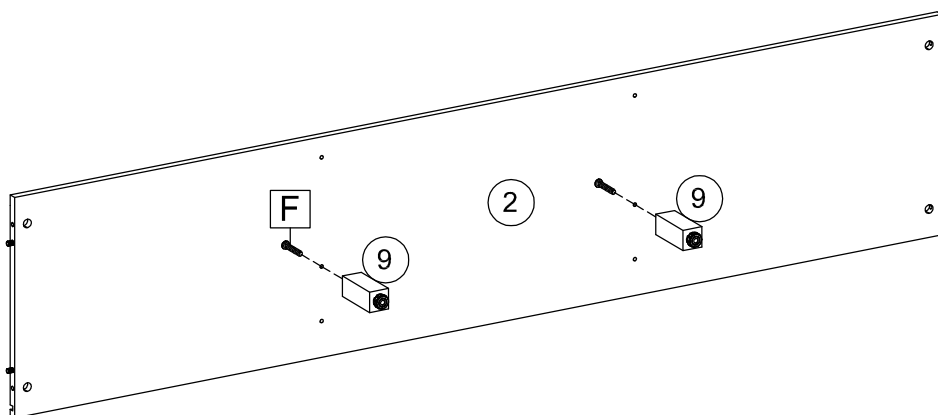

Attach Leg (9) to Bottom panel (2) using 2 x Screw (F).

# 6

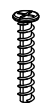

Fx4

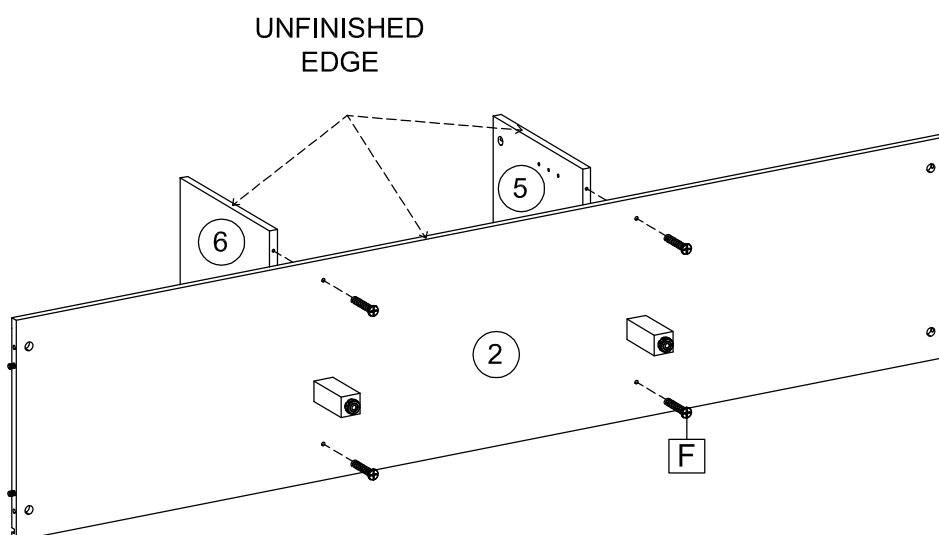

Attach Bottom panel (2) to Assembly using 4 x Screw (F).

# 7

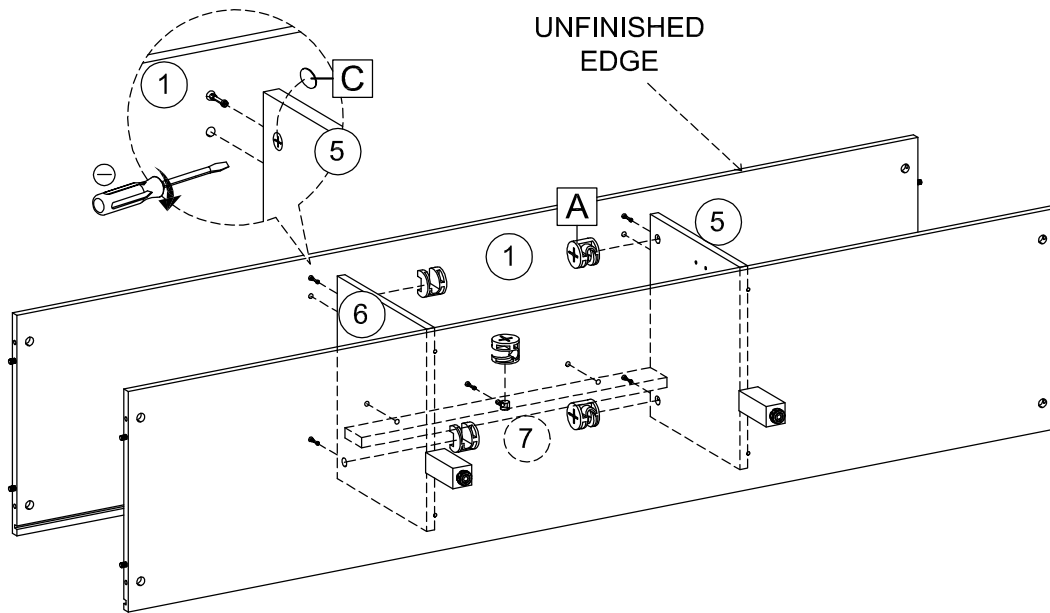

Attach Top panel (1) to Assembly using 5 x Cam lock (A),  
Use a screwdriver to turn the Cam lock clockwise to lock.  
Paste 5x Cam Sticker (C) as shown.

# 8

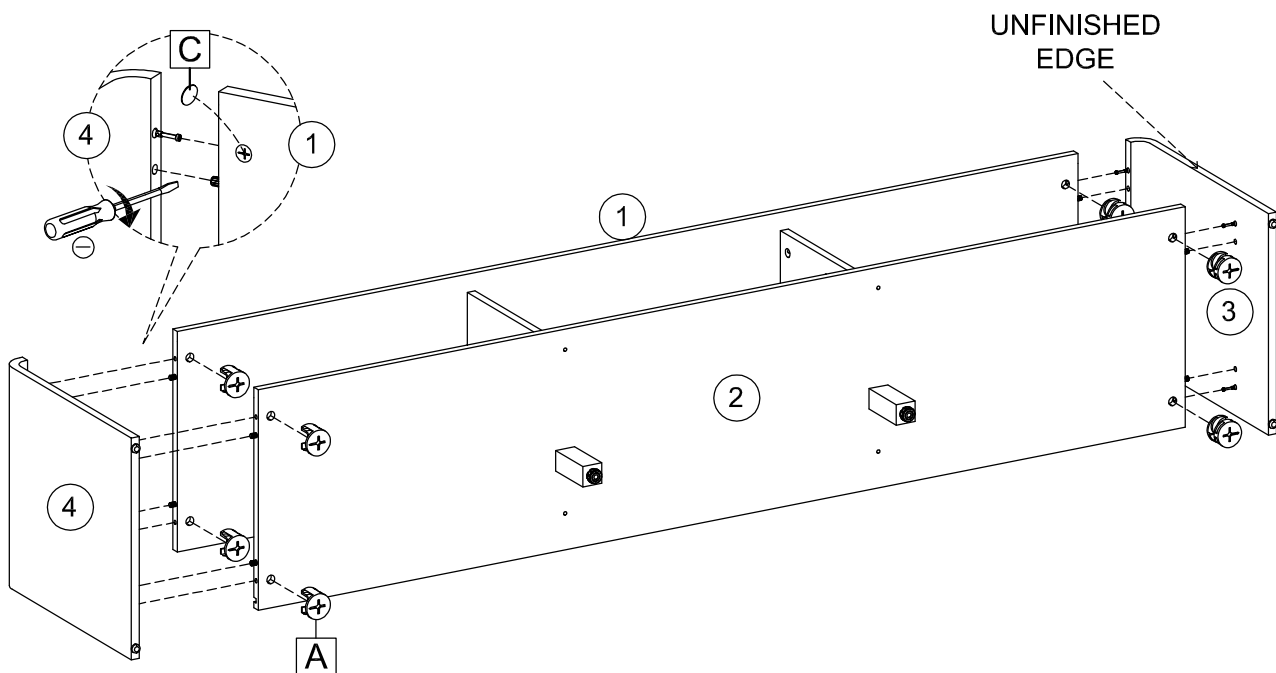

Attach Left panel (3) and Right panel (4) to Assembly using 8 x Cam lock (A),  
Use a screwdriver to turn the Cam lock clockwise to lock.  
Paste 8 x Cam Sticker (C) as shown.

# 8



# 9

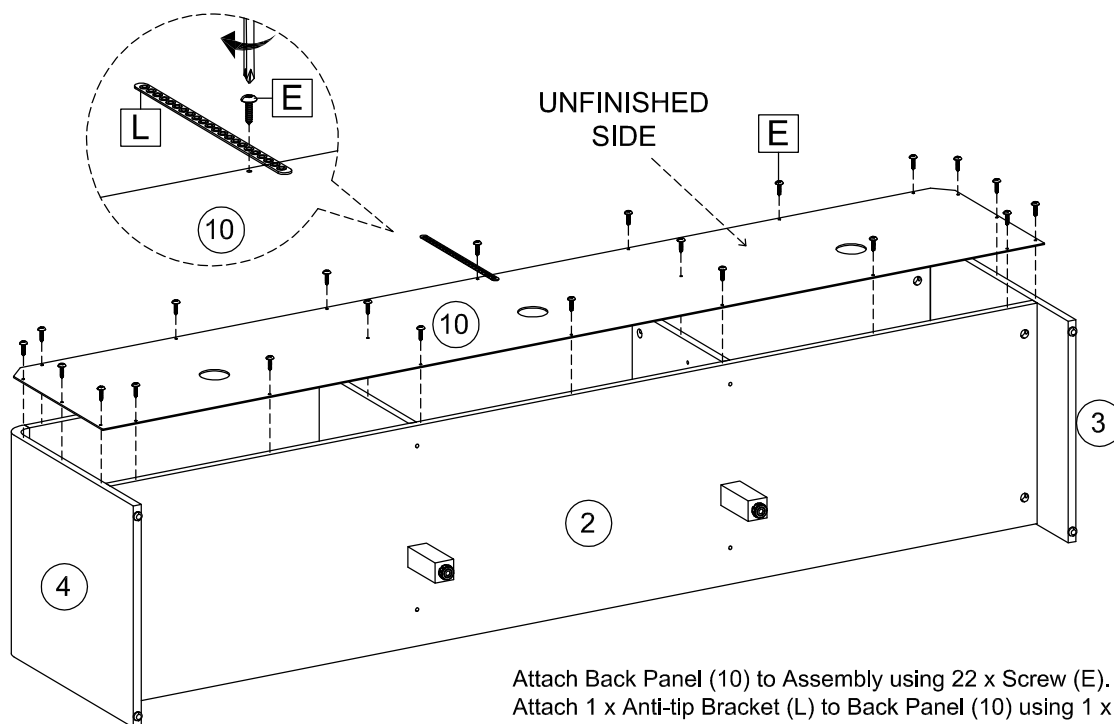
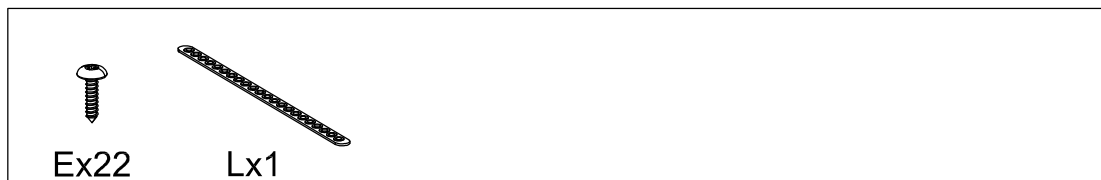

# 10

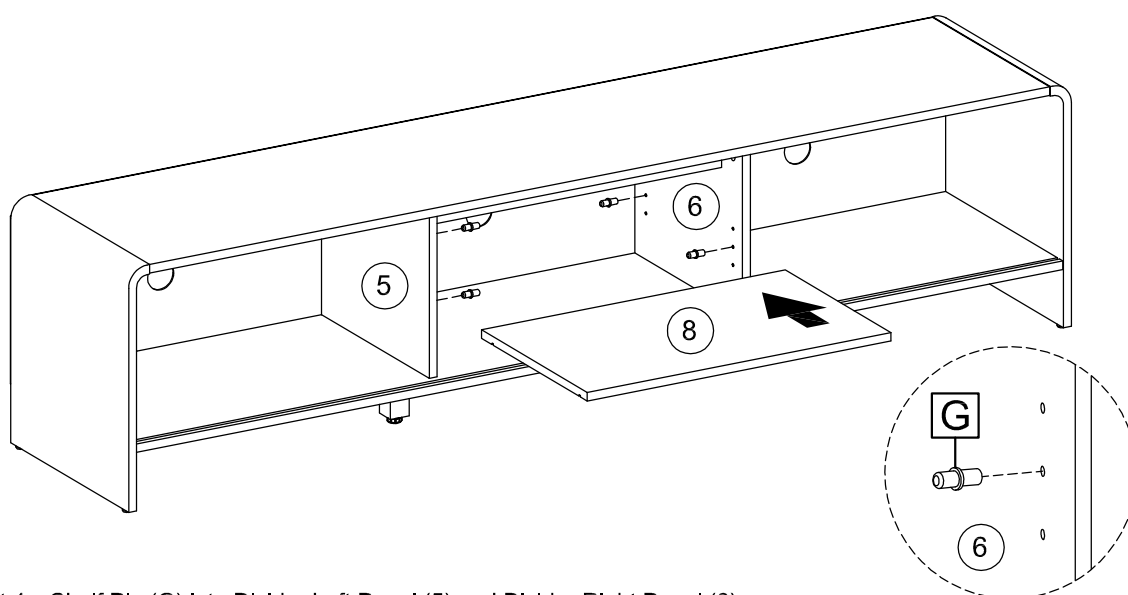

# 11

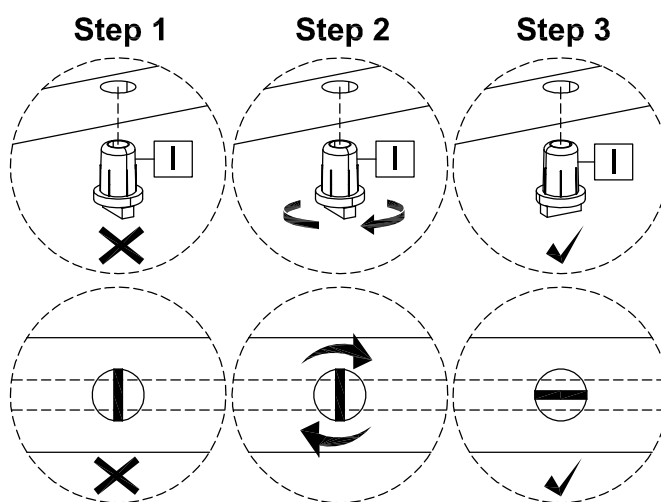
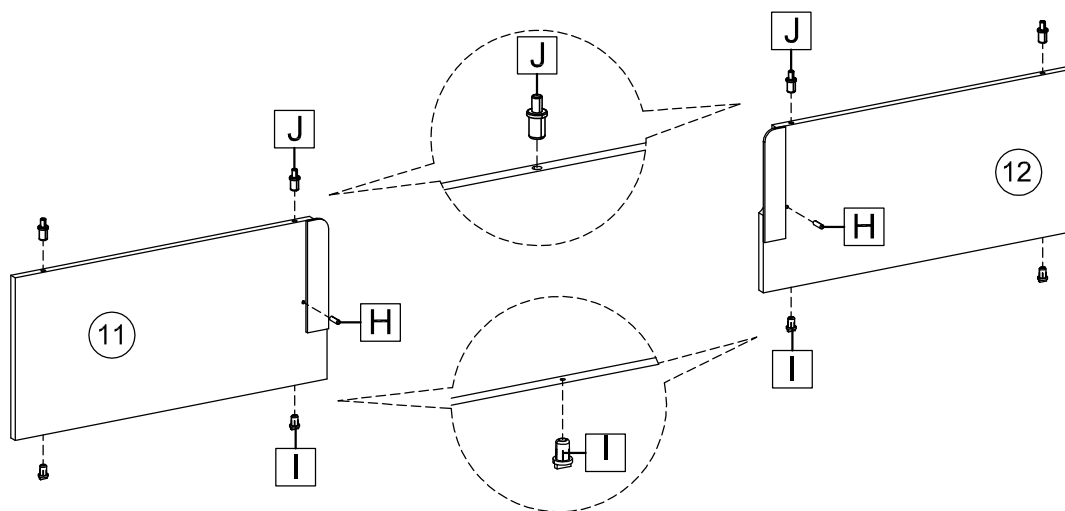
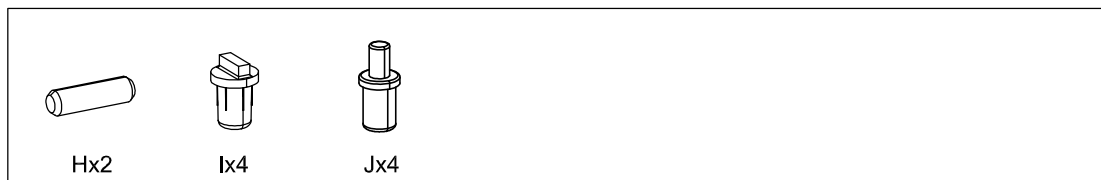

Insert 4 x Bottom Door Pin (I) into Left Door (11) and Right Door (12),  
 Insert 4 x Top Door Pin (J) into Left Door (11) and Right Door (12),  
 Insert 2 x Pin (H) into Left Door (11) and Right Door (12).  
 Turn flat head on Bottom Door Pin until line up with the door as shown.

# 12

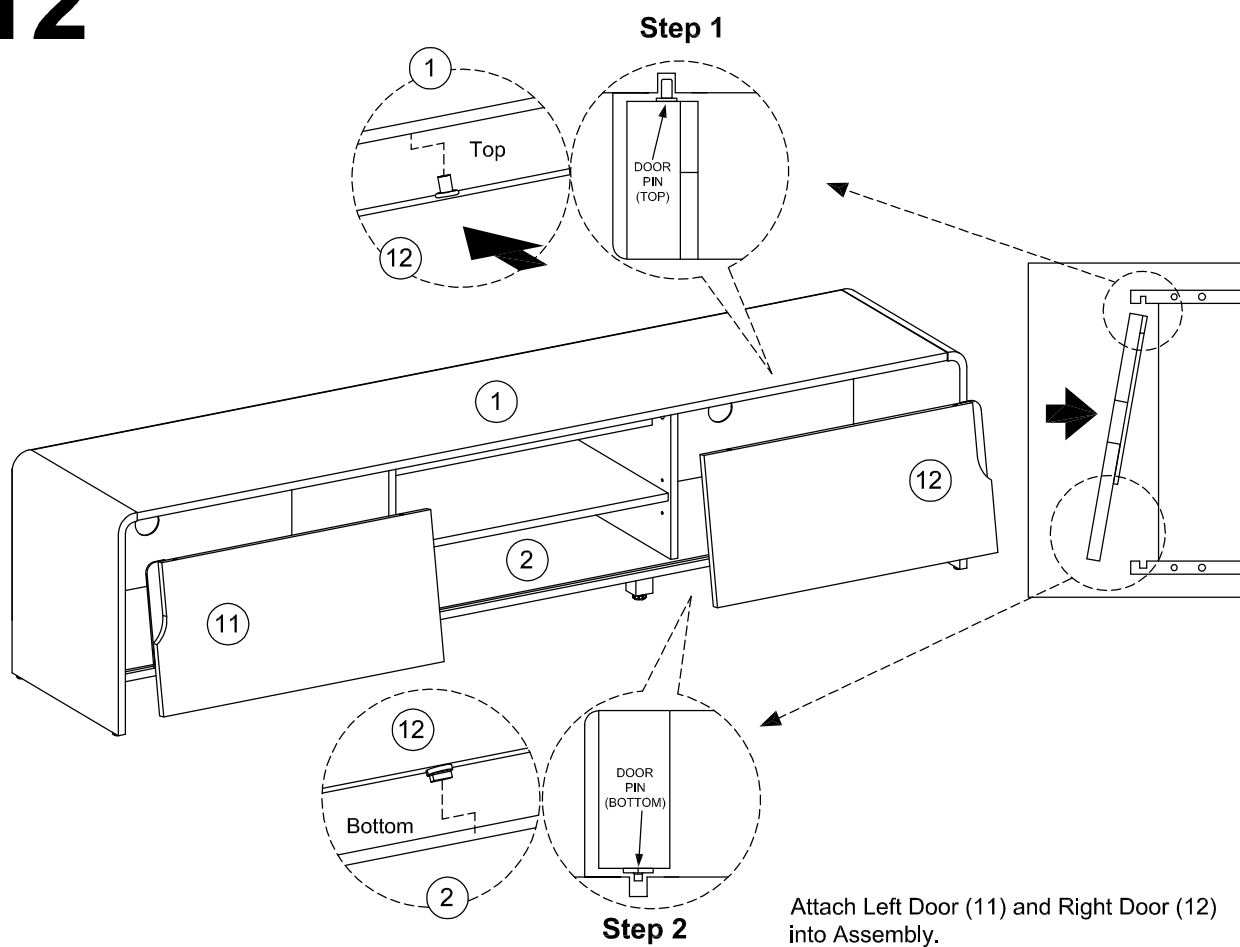

# 13

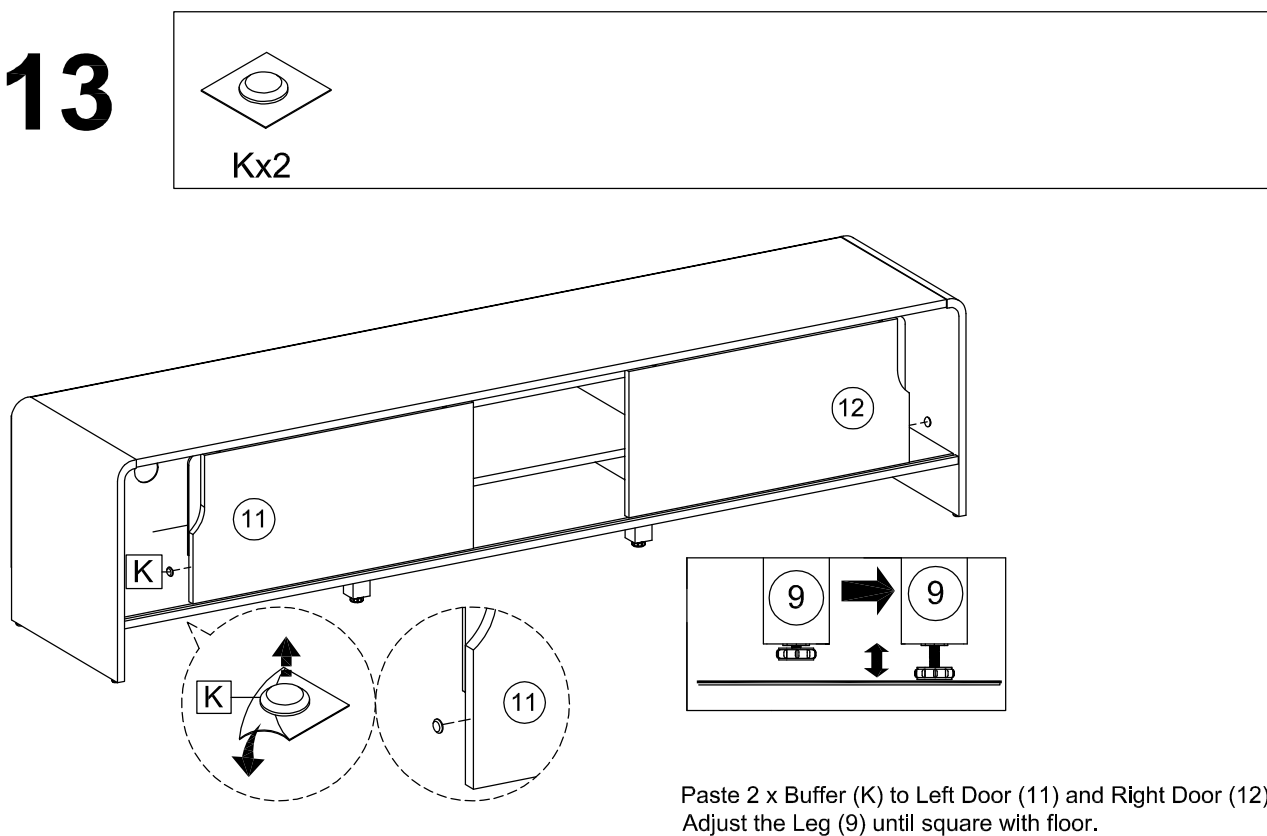

# 14

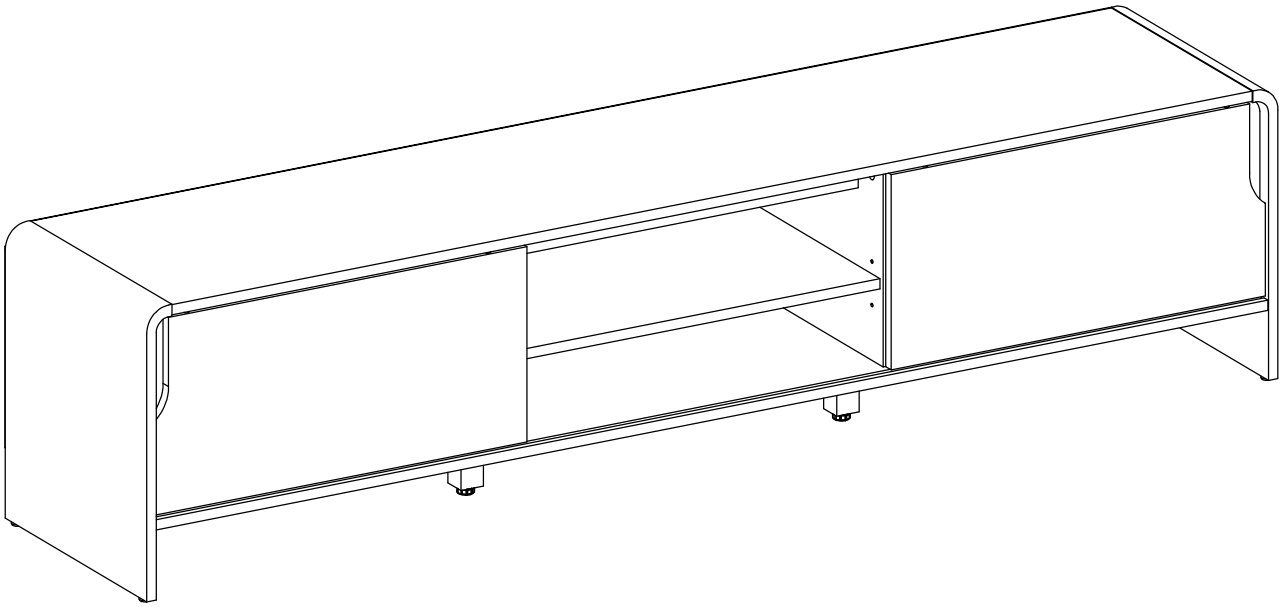

Assembly is complete.

Please dispose of all  
packaging thoughtfully.

# 12