

Heated Towel Rail Installation Instructions

Please read these instructions carefully before installation.

Hardwire Installation should be carried out by a qualified electrician

Check you've got everything:



Exposed Wired Leg x 1



Mounting Bracket
x 3

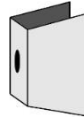

Exposed
Wiring
Mounting
Bracket x 1

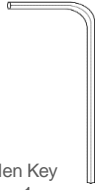

Allen Key
x 1



Concealed Wired Leg x 2



Countersunk
Screw x 4



Wall Plug x 4



Non - Wired Leg x 2

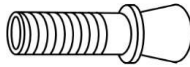

White Concealed Wiring
Sleeve



Machine Screw
x 2



Grub Screw
x 10 (in legs)

Please note these parts are
not to scale

You will also need:

- Cross Head Screwdriver
- Pencil
- Spirit Level
- Tape Measure
- Drill Bits (6mm & 15mm)
- Cordless Drill
- Electrical Supply

Concealed Wiring Installation

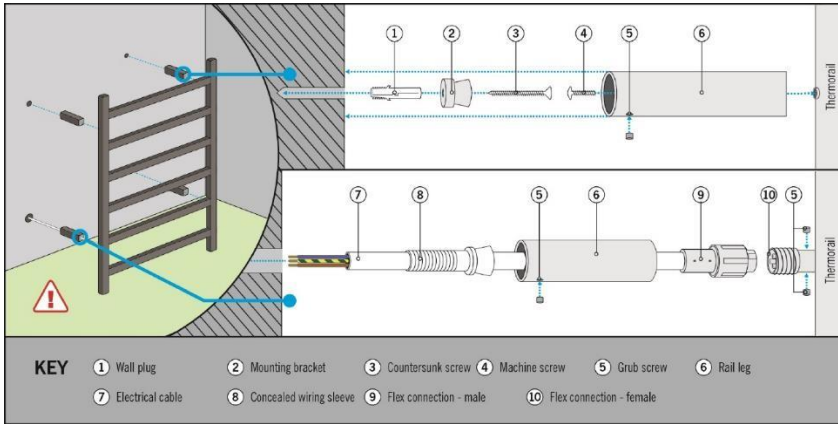

1. Collect the parts you need

Ensure that you have all the correct parts needed for concealed wiring installation of this towel rail. Any additional parts that are for exposed wiring will not be required.

2. Fix the legs to the rail

First, decide which side you want to connect the electrical supply to and then allocate the appropriate legs to each of the three remaining mounting points. Remove the mounting brackets from inside the legs by releasing the grub screws with the allen key provided. Attach the two non-wired legs to the rail using the machine screws and a cross head screw driver. Attach the third leg to the non-wired point at the bottom of the rail using two grub screws.

3. Plan and Measure Your Installation

Measure and mark out the four wall bracket positions making sure they are level. The easiest way to mark this is to put some masking tape or similar at the location of the four mounting positions and then hold the rail against the wall and once it is straight and level mark the four leg footprints on the tape. We recommend that the rail is installed onto a flat uniform wall at least 600mm from the floor, with a 300mm clearance from permanent fixtures. Where possible the Heated Towel Rail should be screwed into studs or if fixing to hollow walls suitable anchors should be used to ensure rail is secure.

4. Install the Wall Brackets

Drill a 6mm hole in the centre of each of the four marked mounting positions and insert the wall plugs provided into the three non-wired legs. Now fix the three wall brackets in place using the countersunk screws and a cross head screwdriver. In the fourth position, use the pilot hole to drill a larger hole (15mm) for the concealed wiring sleeve & electrical cable.

5. Connect Electrical Cable & Wall Bracket

Remove the 3 pin plug from the end of the lead. Connect the lead to the rail at your chosen position by unscrewing the screw cap (See Diagram 2a.), inserting the lead into the connection point ensuring that the pins match up correctly using the arrows marked (See Diagram 2b.) and tighten the screw cap (See Diagram 2c.). Slide the concealed wiring leg over the electrical cable (See Diagram 2d.) and fix in place using the grub screws provided (See Diagram 2e.).

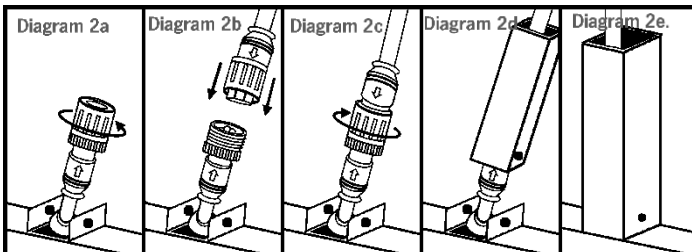

6. Connect to Main Supply

Ensure the mains power supply is switched off before carrying out any electrical work. Slide the concealed wiring sleeve over the exposed end of the electrical cable and insert into the hole in the wall. This will be tight fit so the sleeve will need to be hit in with a hammer. Connect the lead to the mains supply in accordance with current electrical regulations.

7. Fix Rail to the Wall

Fit the rail to the mounting brackets installed on the wall. Tighten using the grub screws and the allen key provided. Your installation is now complete.

Exposed Wiring Installation

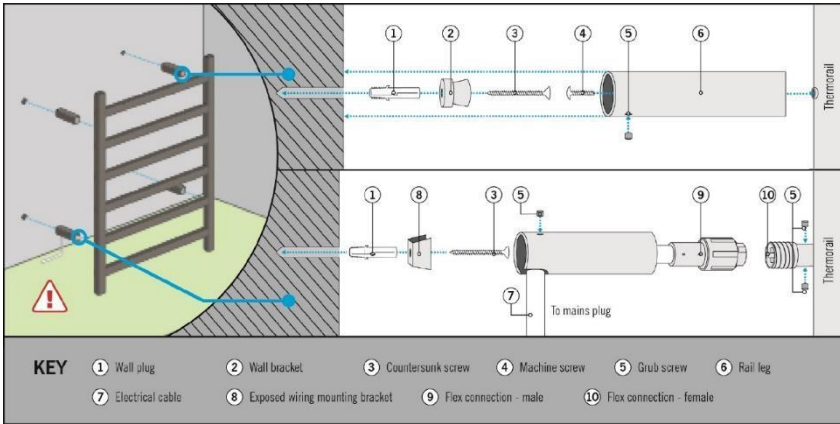

1. Collect the parts you need

Ensure that you have all the correct parts needed for exposed wiring installation of this towel rail. Any additional parts that are for concealed wiring will not be required.

2. Fix the legs to the rail

First, decide which side you want to connect the electrical supply to and then allocate the appropriate legs to each of the three non-wired remaining mounting points. Remove the mounting brackets from inside the legs by releasing the grub screws with the allen key provided. Attach the two non-wired legs to the rail using the machine screws and a cross head screw driver. Attach the third leg to the non-wired point at the bottom of the rail using the grub screws provided.

3. Plan and Measure Your Installation

Measure and mark out the four wall bracket positions making sure they are level. The easiest way to mark this is to put some masking tape or similar at the location of the four mounting positions and then hold the rail against the wall and once it is straight and level mark the four leg footprints on the tape. We recommend that the rail is installed onto a flat uniform wall at least 600mm from the floor, with a 300mm clearance from permanent fixtures. Where possible the Heated Towel Rail should be screwed into studs or if fixing to hollow walls suitable anchors should be used to ensure rail is secure

4. Install the Wall Brackets

Drill a 6mm hole in the centre of each of the four marked mounting positions and insert the wall plugs provided. Now fix the three wall brackets in place using the countersunk screws and a cross head screwdriver. In the fourth position attach the exposed wiring mounting bracket using a countersunk screw.

5. Connect Electrical Cable & Wall Bracket

Slide the exposed wired leg over the end of the lead and connect the lead to the rail at your chosen position by unscrewing the screw cap (See Diagram 2a.), inserting the lead into the connection point ensuring that the pins match up correctly using the arrows marked (See Diagram 2b.) and tighten the screw cap (See Diagram 2c.). Slide the exposed wired leg towards the rail (See Diagram 2d.) and fix in place using the grub screws provided (See Diagram 2e.).

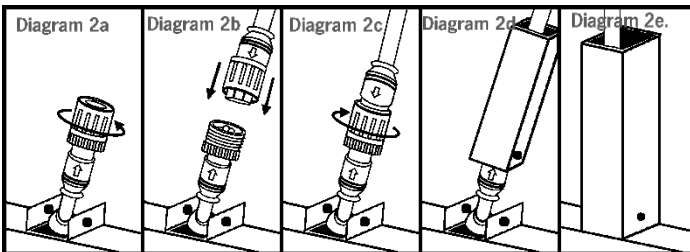

6. Fix rail to the Wall

Fit the rail to the mounting brackets installed on the wall. You may need assistance to hold the rail in place. Tighten using the grub screws and the allen key provided.

7. Power Up

Plug the lead into your power point to complete your installation.

Safety Information

Heated Towel Rails should be installed by a qualified electrician and in accordance with current local regulations. We recommend that the rail is installed onto a flat uniform wall at with a 300mm clearance from permanent fixtures. Where possible the Heated Towel Rail should be screwed into studs or if fixing to hollow walls suitable anchors should be used to ensure rail is secure.

Warning: In order to avoid a hazard for very young children, this appliance should be installed so that the lowest heated rail is at least 600mm above the floor.

Please read and understand this installation guide in full before commencing installation.

- Observe and adhere to electrical guidelines and IP ratings when placing your rail in wet areas
- Ensure any timers or switches used are installed in correct zones according to the IP rating of the timer/switch
- Ensure that your rail is protected by a suitably rated RCD circuit
- Do not use the towel rail to hold towels or other articles that have been in contact with oil, petroleum based products or dry cleaning fluids
- This appliance is not intended for use by persons (including children) with reduced physical, sensory or mental capabilities, or lack of experience and knowledge, unless they have been given supervision or instruction concerning use of the appliance by a person responsible for their safety.
- Children should be supervised to ensure that they do not play with the appliance.
- Do not immerse your rail in any liquid
- If the supply cord is damaged, it must be replaced by the manufacturer, its service agent or similarly qualified persons in order to avoid a hazard

Care Information

The finish of your Heated Towel Rail is hard-wearing and easy to maintain. However, any harsh scrubbing, scratching or acid-based cleaning products will damage the surface of your towel rail. Cleaning with a soft cloth and a non-abrasive cleaning agent will give the best results.

Warranty Information

This rail is covered with a 5 year replacement warranty for polished finishes and 2 year warranty for coloured finishes.

Our goods come with guarantees that cannot be excluded under the Australian Consumer Law. You are entitled to a replacement or refund for a major failure and compensation for any other reasonably foreseeable loss or damage. You are also entitled to have the goods repaired or replaced if the goods fail to be of acceptable quality and the failure does not amount to a major failure.

For full warranty terms and conditions please refer to the warranty section on our website: www.thebuild.com.au or www.templeandwebster.com.au.

Contact Information

Call us on 1300 461 911 or visit us at the below:

www.templeandwebster.com.au

www.thebuild.com.au

Code	Size	Finish	Wattage	Profile
TBR44PS	600x800	Polished	105W	Round
TBR44BR	600x800	Brushed	105W	Round
TBR44BK	600x800	Black	110W	Round
TBR44BB	600x800	Brushed Brass	105W	Round
TBS44PS	600x800	Polished	105W	Square
TBS44BK	600x800	Black	110W	Square