

## **ASSEMBLY INSTRUCTIONS**

**Vonn Oak Veneer Kitchen Island Bench - White Oak  
Top w/ Black Body**

**Vonn Oak Veneer Kitchen Island Bench - White**

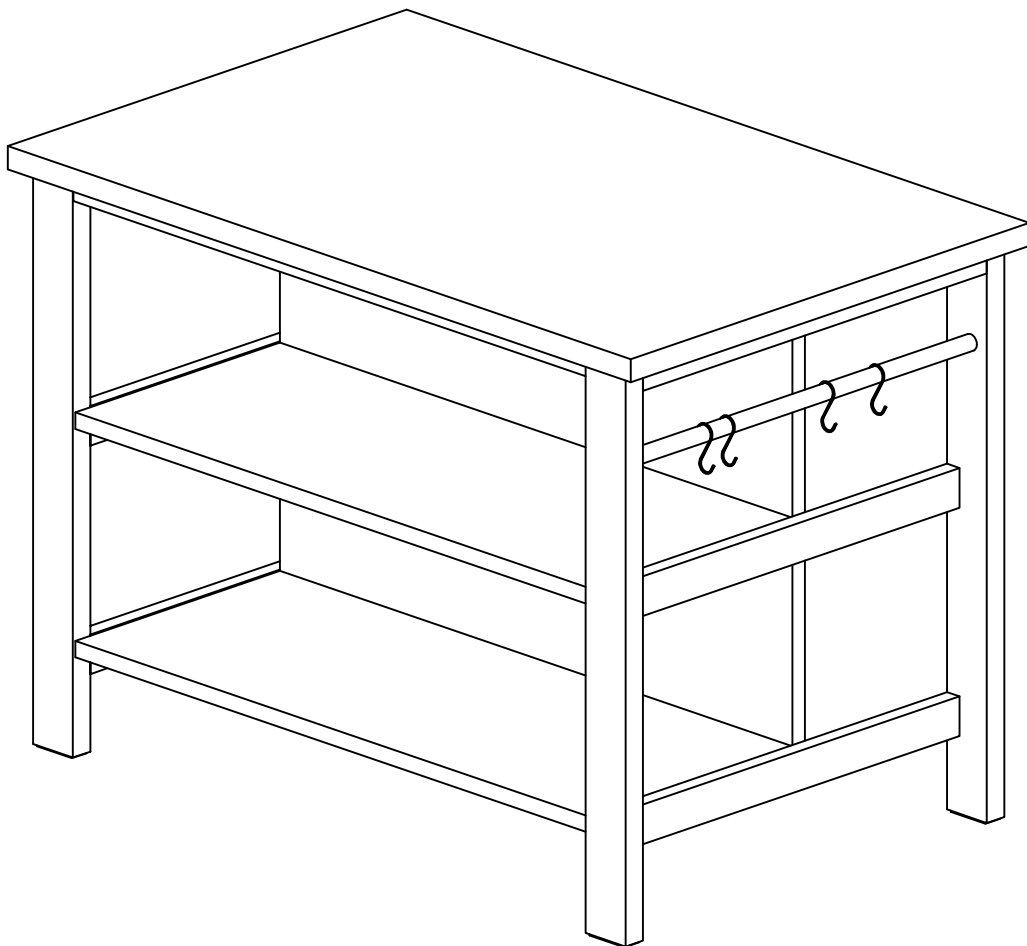

**Two people required**

**[www.templeandwebster.com.au](http://www.templeandwebster.com.au)**

## **Keep these instructions for future reference**

Assemble the furniture on a soft level surface to avoid damaging the furniture or your floor.

Parts of the assembly will be easier with 2 people.

We recommend furniture be assembled near where they will be placed, to avoid moving the product unnecessarily once assembled.

If there is a need to move the furniture, please remove all loose items and have extra hands to help lift the furniture to the desired location. Dragging the furniture will damage both the furniture and the floor.

Regularly check and re-tighten (if necessary) all bolts on furniture that you have assembled yourself.

## **Care and Maintenance of your Furniture**

Always use coasters or placemats to protect the table surface, remove any liquid spills immediately using a clean cloth or kitchen roll sheet & mild detergent.

## **Do not stand on the Furniture**

# Tools Required

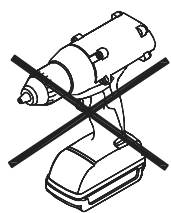

DO NOT USE

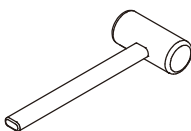

Mallet

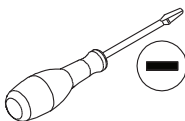

Flat head Screwdriver

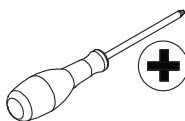

Cross Screwdriver

# Time Required

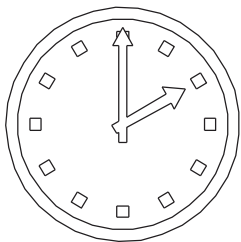

60 min

# Parts List

- Top Panel (P1);
- Left Side (P2);
- Right Side (P3);
- Back Panel (P4);
- Shelf (P5)x2.

# People Required



TWO PERSON RECOMMENDED

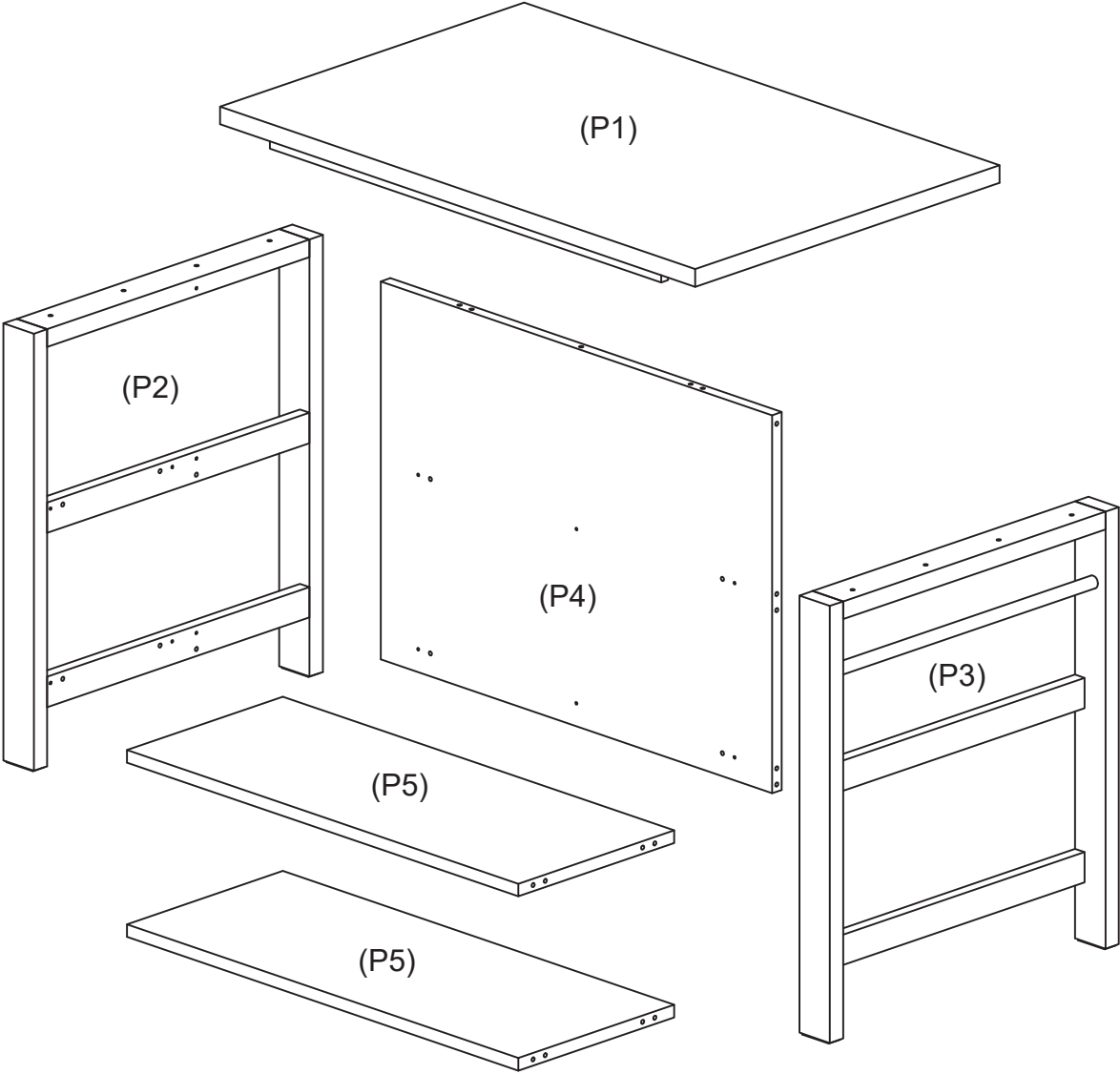

# Hardware/Fittings

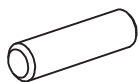

Ø8x30mm  
Wood Dowel x 18  
①

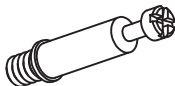

Ø6x44mm  
Connecting Bolt x 23  
②



Ø15x10mm  
Locking Nut x23  
③

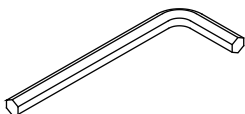

4mm Allen Key x 1  
④



M6x45mm Bolt x 8  
⑤



Spring Washer x 8  
⑥

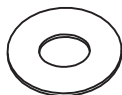

Ø16mm Washer x 8  
⑦



70x30mm  
Felt Pad x 4  
⑧



Hook x 4  
⑨

# 1

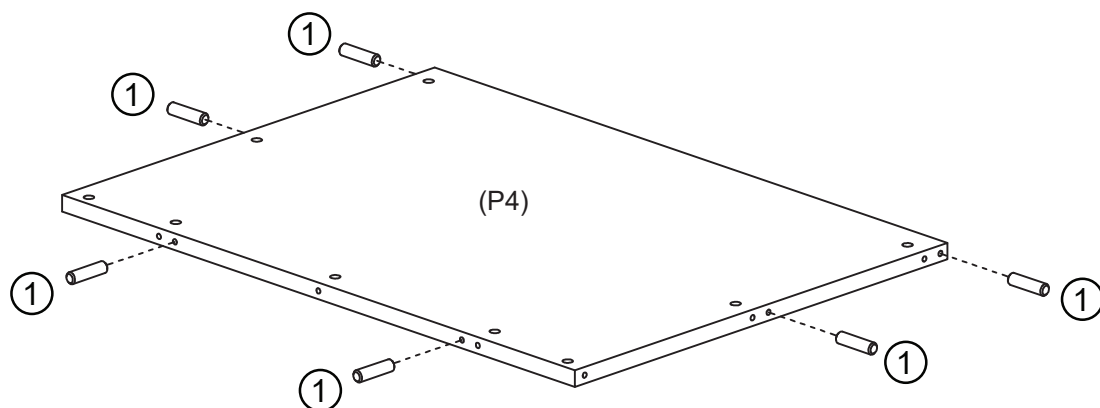
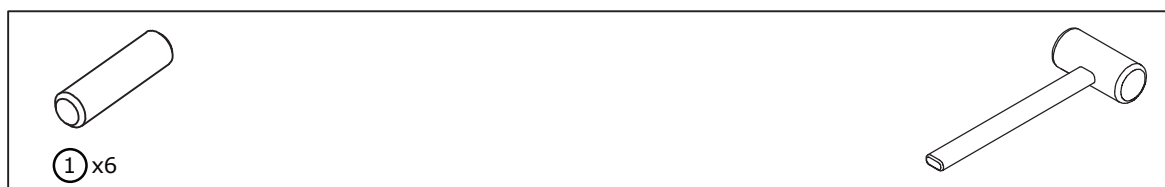

Insert 6 x Wood Dowels (1) into Back Panel (P4).

# 2

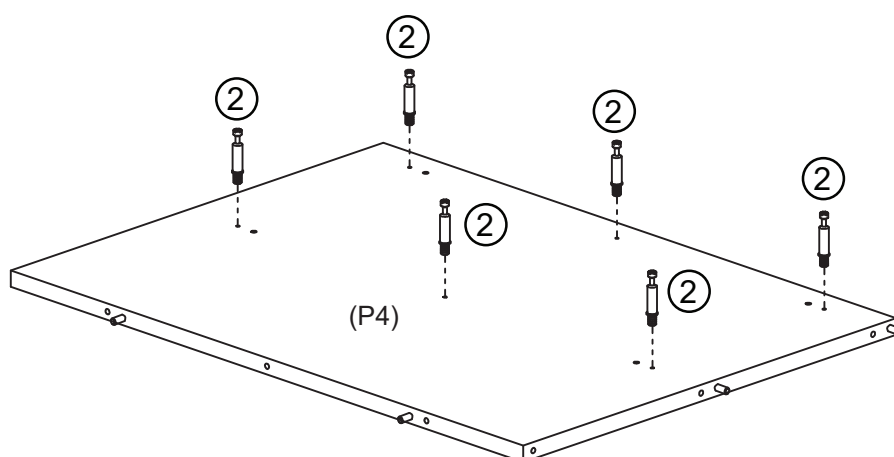

Screw 6 x Connecting Bolts (2) into Back Panel (P4).

# 3

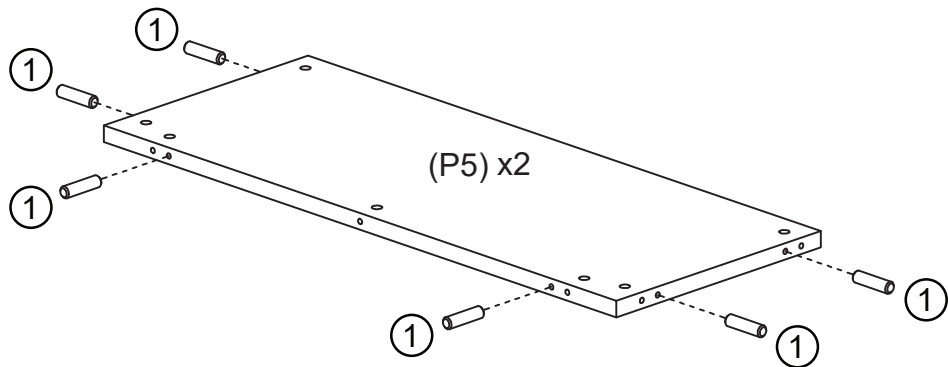

Insert 12 x Wood Dowels (1) into into 2 x Shelf (P5).

# 4

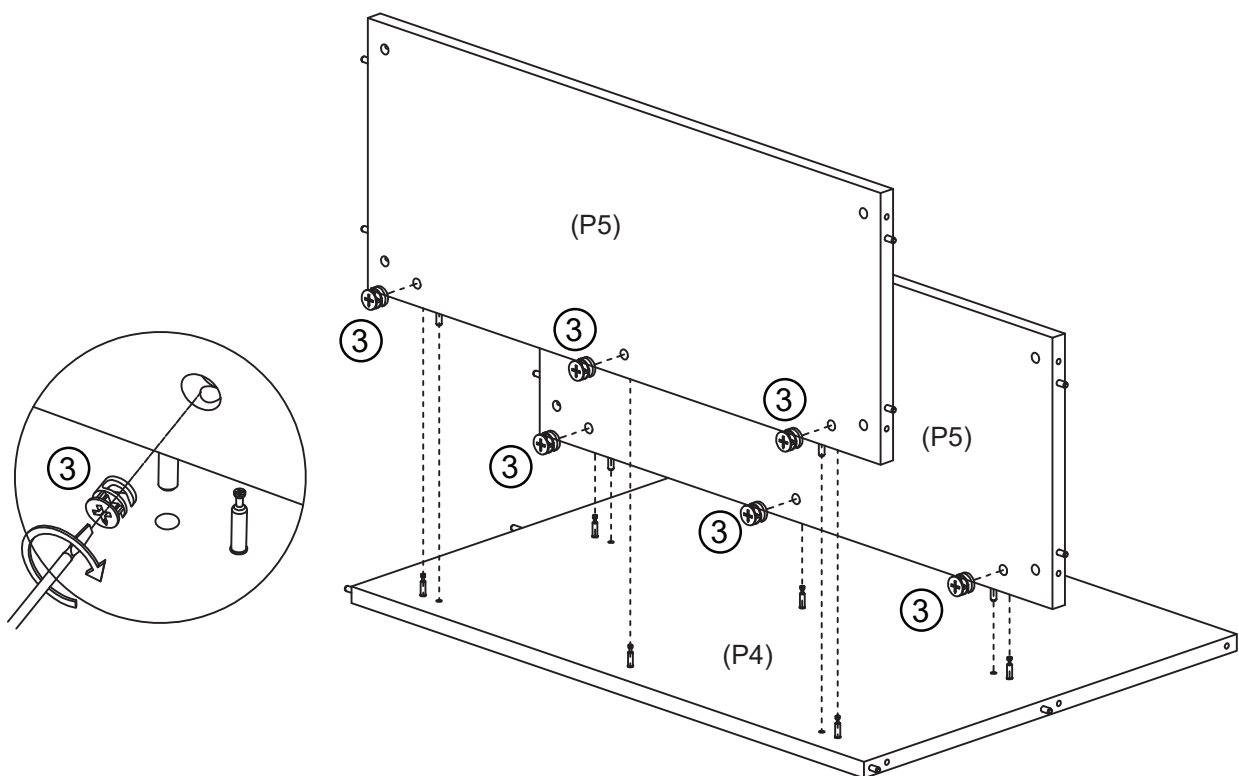
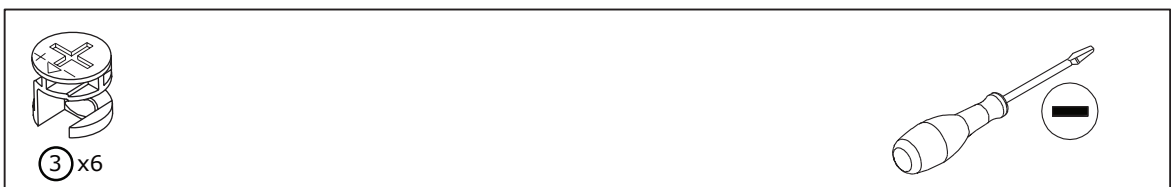

Position 1 x Shelf (P5) onto Back Panel (P4) as shown.

Insert 3 x Locking Nuts (3) into Shelf (P5).

Turn the Locking Nuts (3) clockwise to lock using a flat head screwdriver.

Repeat with the other Shelf (P5).

# 5

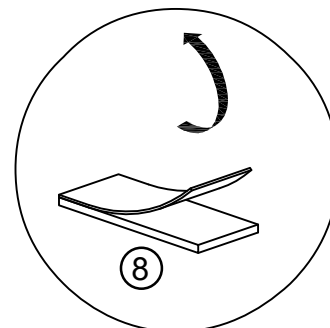
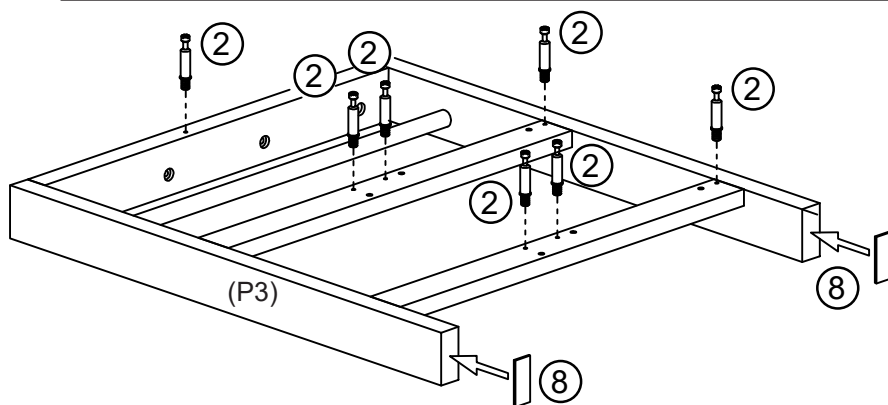

Screw 7 x Connecting Bolts (2) into Right Side (P3).  
Paste 2 x Felt Pads (8) to the Right Side (P3) as shown.

# 6

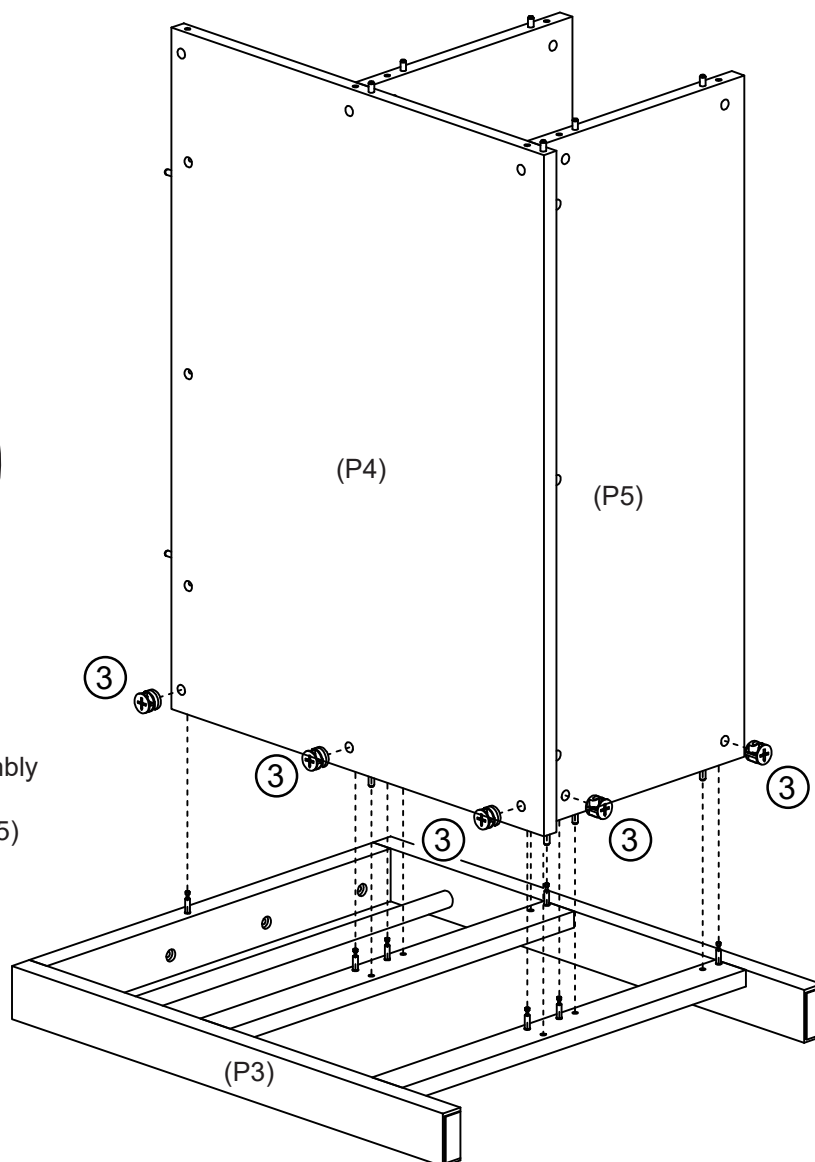
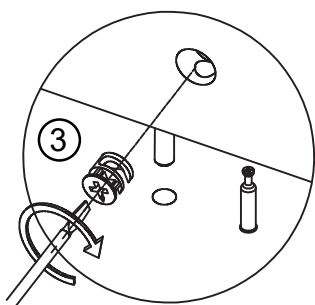

Position the shelf and back panel assembly onto Right Side (P3) as shown.  
Insert 7 x Locking Nuts (3) into Shelf (P5) and Back Panel (P4).  
Turn the Locking Nuts (3) clockwise to lock using a flat head screwdriver.

# 7

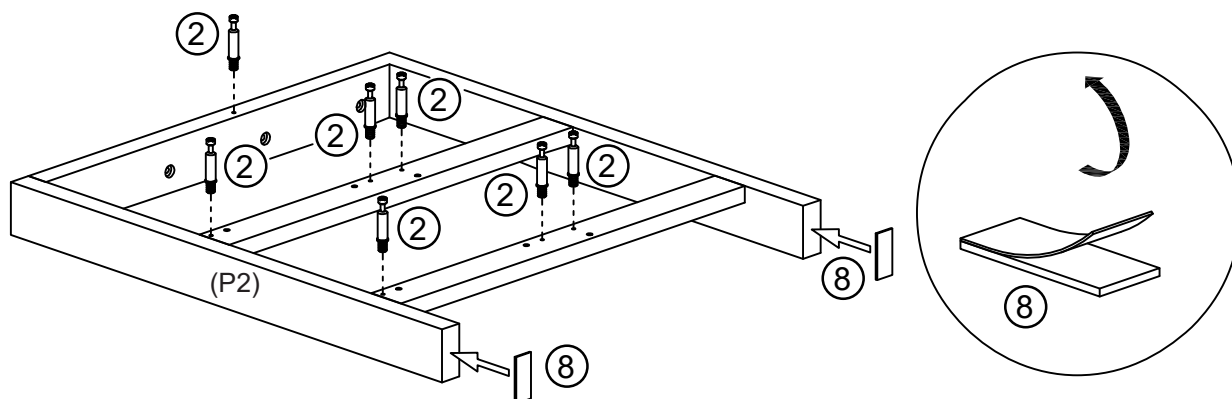
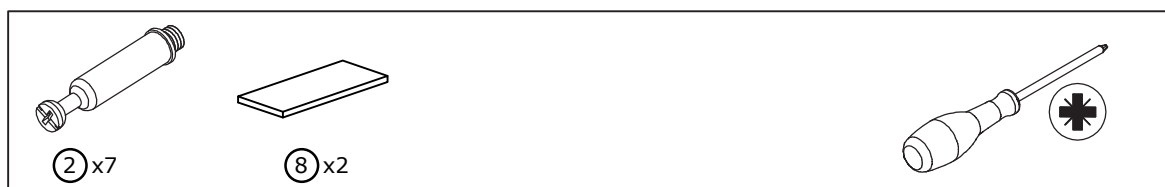

Screw 7 x Connecting Bolts (2) into Left Side (P2).  
Paste 2 x Felt Pads (8) to the Left Side (P2) as shown.

# 8

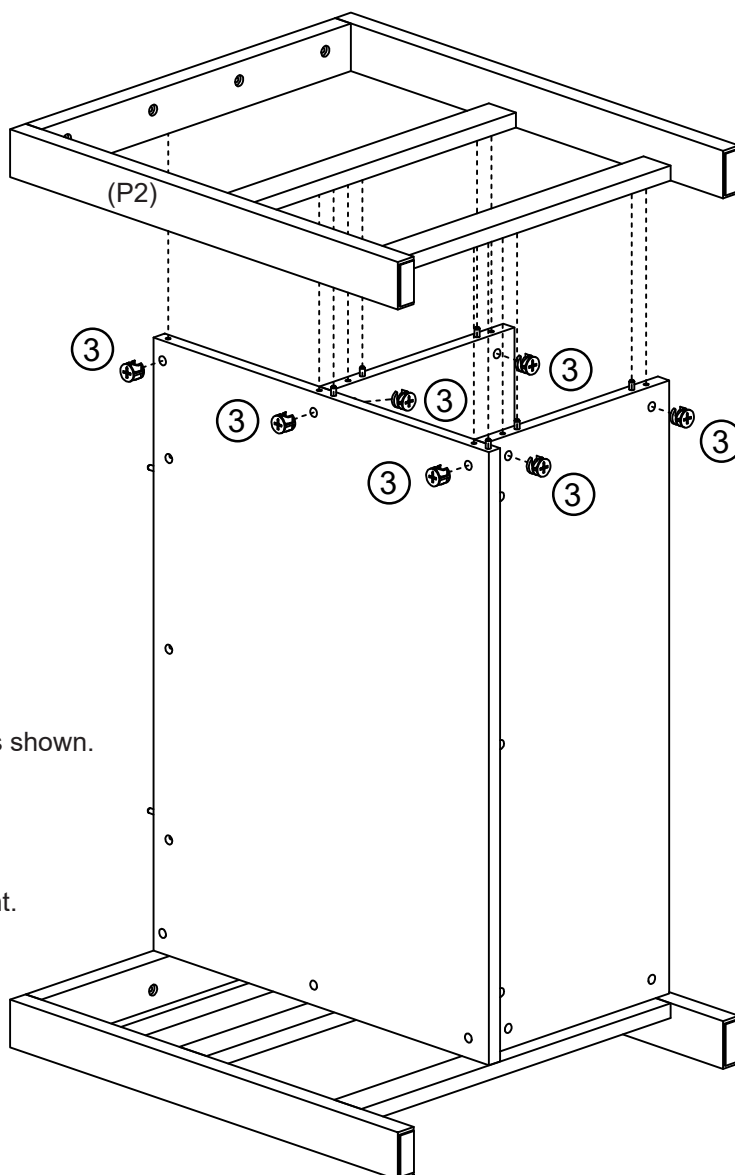
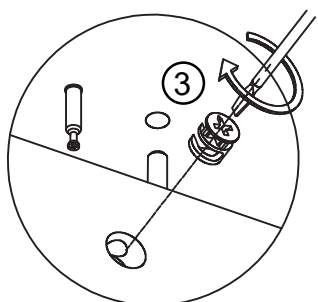
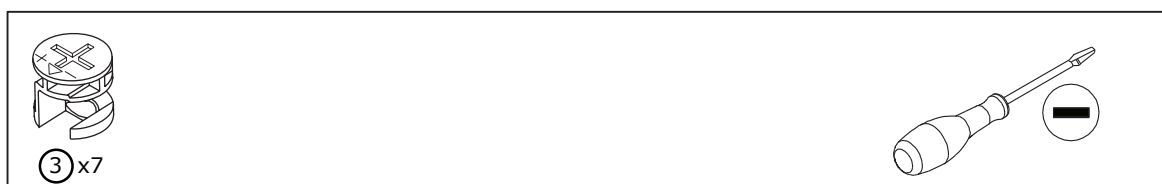

Position Left Side (P2) onto the assembled unit as shown.  
Insert 7 x Locking Nuts (3) into Shelf (P5) and  
Back Panel (P4).  
Turn the Locking Nuts (3) clockwise to lock  
using a flat head screwdriver.  
With help, carefully turn the assembled unit upright.



# 9

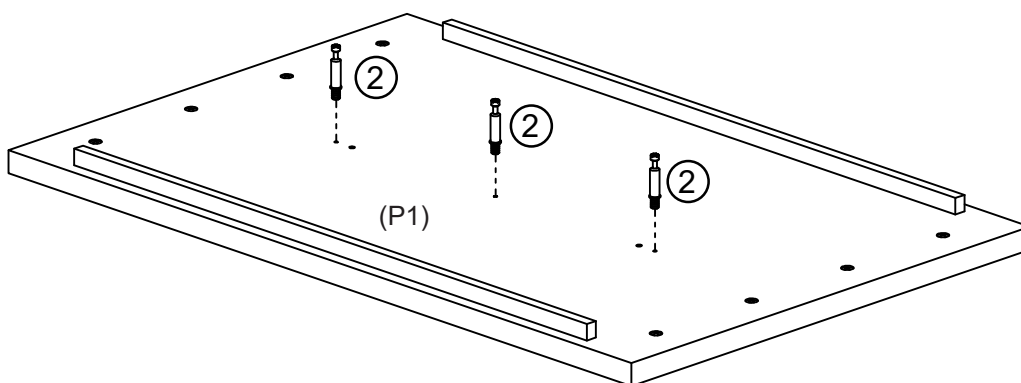
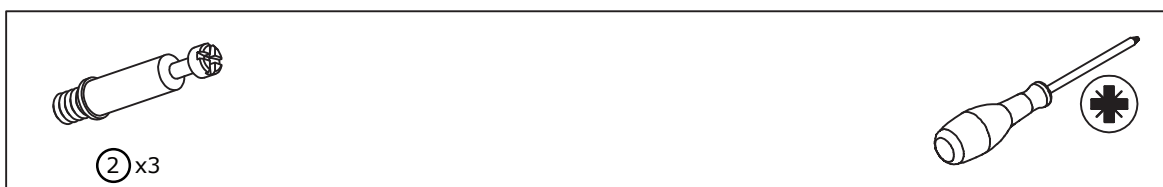

Screw 3 x Connecting Bolts (2) into Top Panel (P1).

# 10

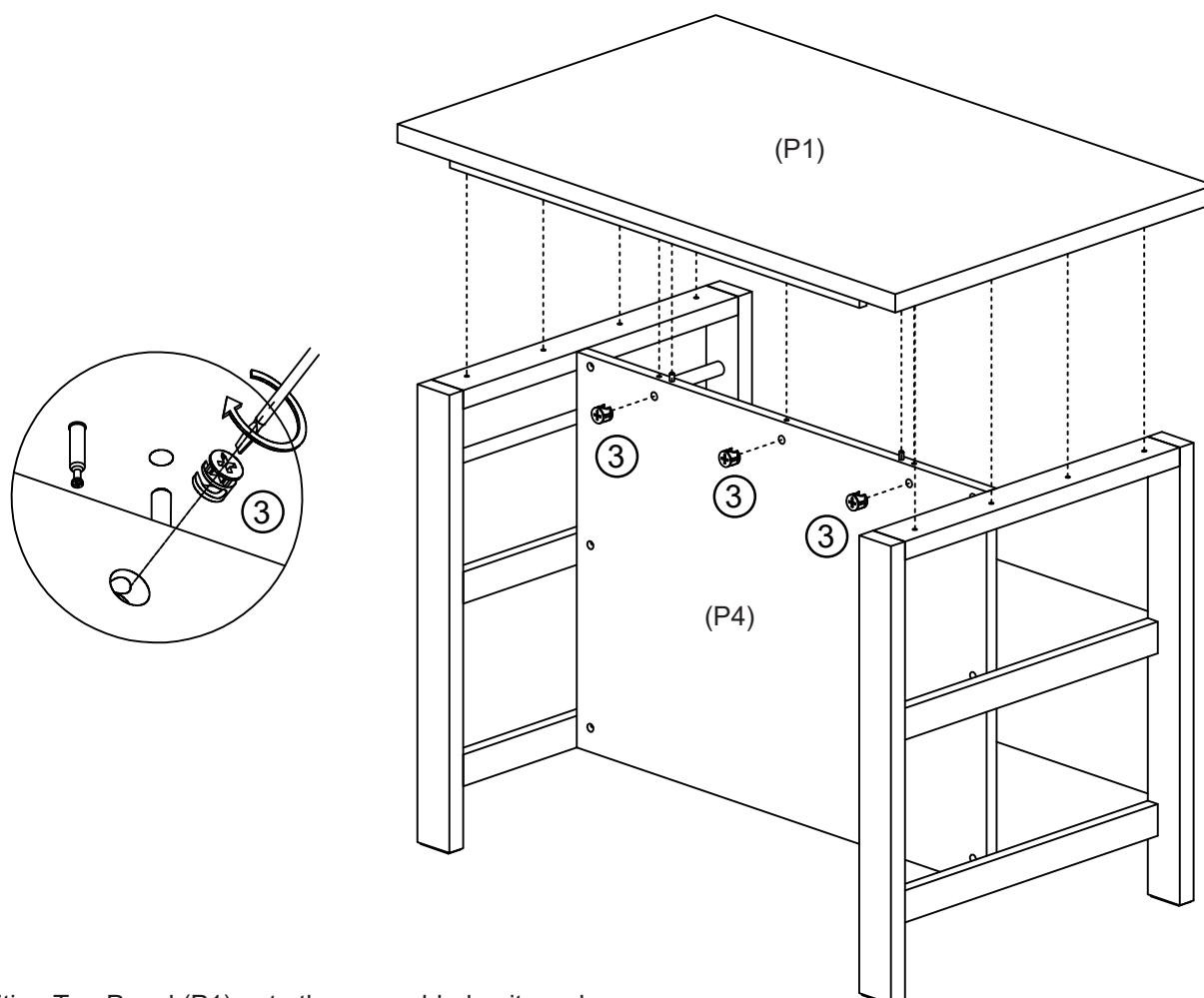

Position Top Panel (P1) onto the assembled unit as shown.

Insert 3 x Locking Nuts (3) into Back Panel (P4).

Turn the Locking Nuts (3) clockwise to lock using a flat head screwdriver.

# 11

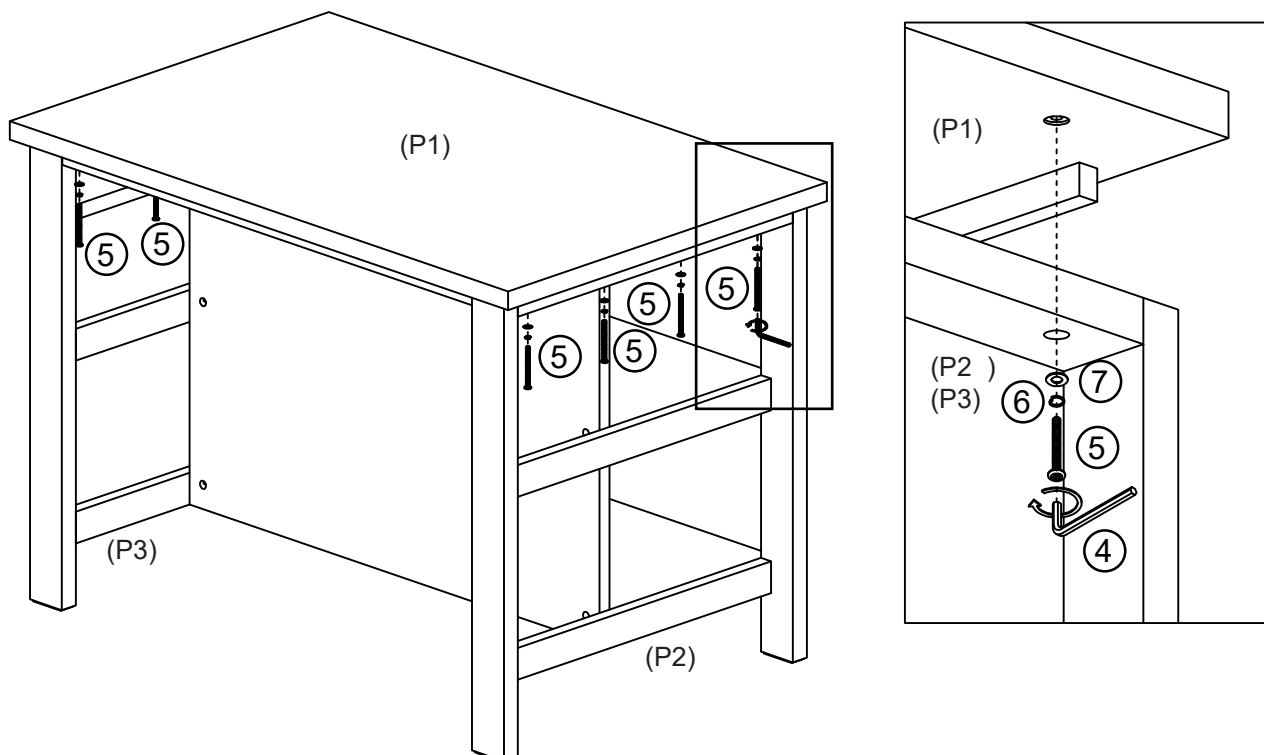
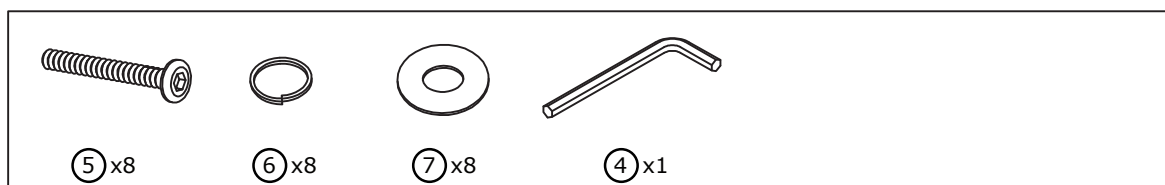

Attach Top Panel (P1) to Left Side (P2), Right Side (P3) with 8 x Bolts (5), 8 x Spring Washers (6) and 8 x Washers (7). Tighten the bolts with Allen Key (4).

# 12

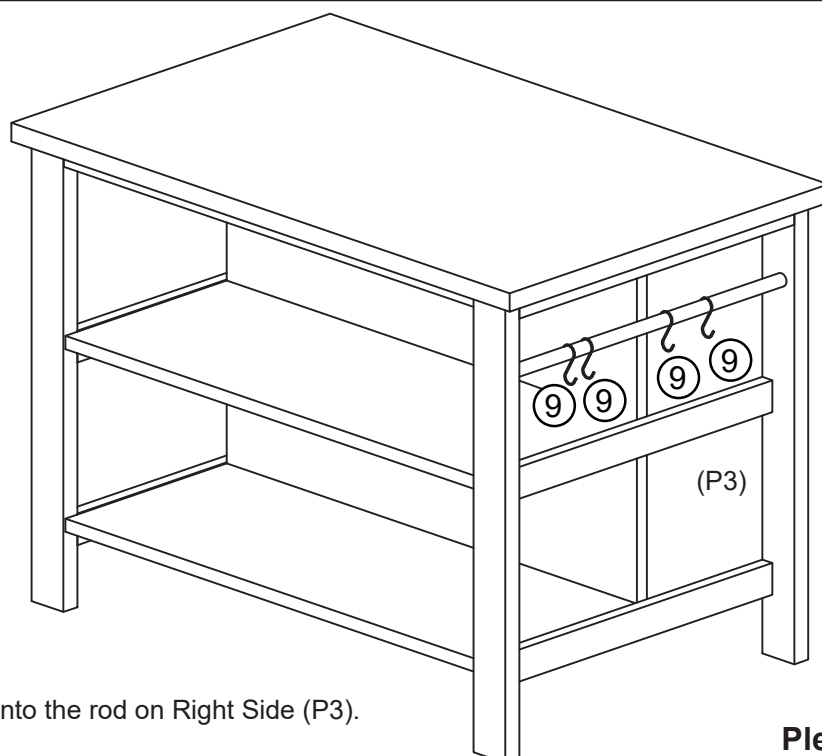

Hang 4 x Hooks (9) onto the rod on Right Side (P3). Assembly is complete.

**Please dispose of all packaging thoughtfully.**