

ASSEMBLY INSTRUCTIONS

PAGE: 1/6

MODEL : UH 8679

Before you begin, please follow assembly instructions carefully, then follow them step by step.

Read instruction carefully . See Furniture Parts list and Hardware List for guidance . Be sure you have all parts before you start assembling .
Place and assemble furniture on a clean flat soft surface , such as carpet or rug to prevent being scratched .

PART LIST		QTY
1	TOP PANEL	1 PC
2	BOTTOM PANEL	1 PC
3	SIDE PANEL (L)	1 PC
4	SIDE PANEL (R)	1 PC
5	CENTER PANEL (L)	1 PC
6	CENTER PANEL (R)	1 PC
7	SHELF PANEL	1 PC
8	DOOR PANEL	1 PC
9	BACK PANEL	1 PC
10	DRAWER FRONT (UP)	1 PC
11	DRAWER FRONT (DOWN)	1 PC
12	DRAWER BACK	2 PCS
13	DRAWER SIDE	4 PCS
14	DRAWER BOTTOM	2 PCS
15	METAL SIDE	2 PCS
16	METAL SUPPORT	4 PCS

HARDWARE				
A	MINI FIX	A1 A2 A3		8 SETS
B	M8 X 30MM WOOD DOWEL			16 PCS
C	M6 X 50MM CSK CAP WOOD SCREW			8 PCS
D	ALLEN KEY M4			1 PC
E	M3X 12MM C.B SCREW			2 PCS
F	M3.5 X 16MM C.B SCREW			36 PCS
G	M4 X 38MM C.B SCREW			16 PCS
H	5/8 NAIL			52 PCS
I	JCBC SCREW M6 X 30MM			8 PCS
J	JCBC SCREW M6 X 40MM			8 PCS
K	HANDLE 4020 L BAR 100MM			1 PC
L	METAL SHELF SUPPORT			4 PCS
M	SOFT CLOSING 5/8 HINGES			2 PCS
N	14" DRAWER SLIDE	N1 (L/R) N2 (L/R)		2 SETS
O	TIPPING PACK WITH AI	O1 O2 O3 O4		2 SETS
P	WALL PLUG (NOT INCLUDED)			-

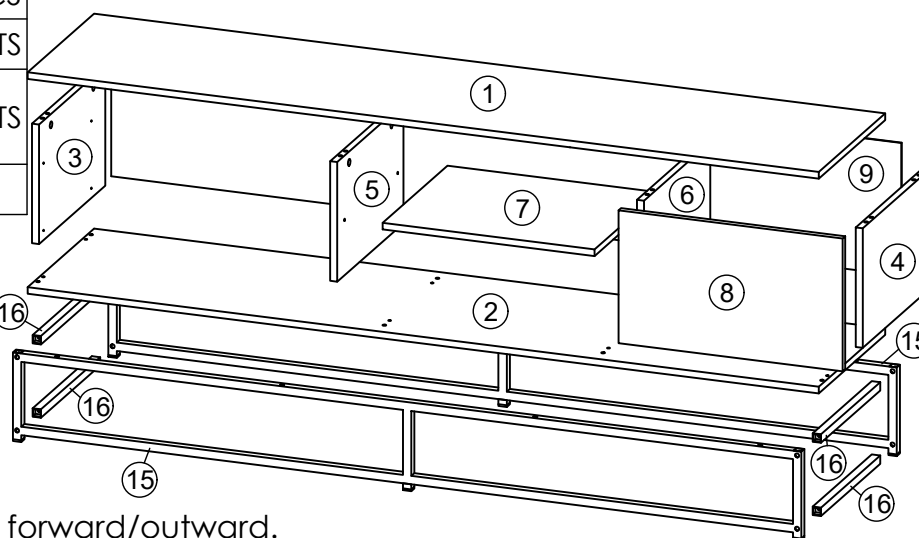
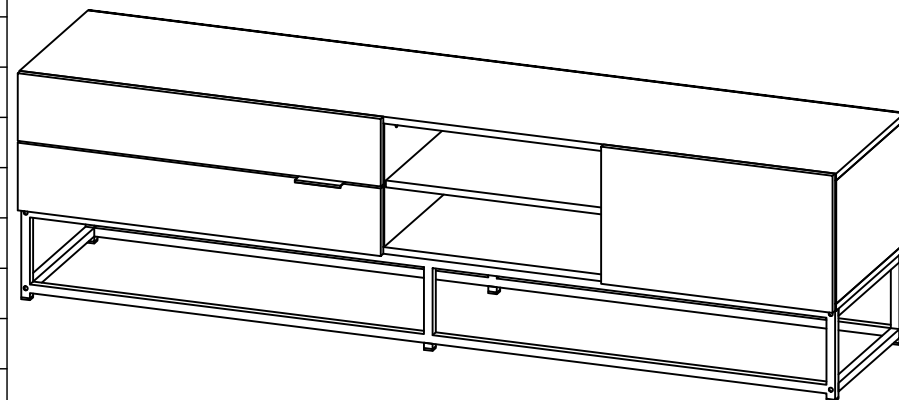

SELF-PREPARED TOOLS: Tools below are NOT included in package.



SCREWDRIVER



HAMMER

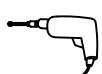

POWER DRILL

Reminder:

Please ensure that all surfaces and edges with colours/laminations are facing forward/outward.

ASSEMBLY INSTRUCTIONS

PAGE: 2/6

STEP 1

- Insert hardware **A1** onto panel (3), (4), (5) and (6).
(Repeat 8 times.)
- Insert hardware **A2** onto panel (1).
(Repeat 8 times.)
- Insert hardware **B** onto panel (3), (4), (5) and (6).
(Repeat 16 times.)

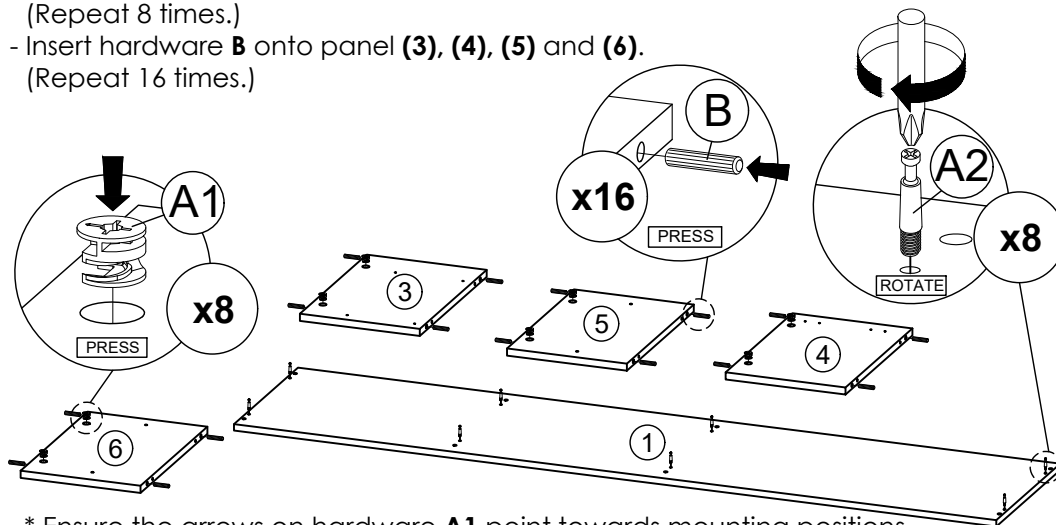

* Ensure the arrows on hardware **A1** point towards mounting positions.

STEP 3

- Attach panel (1) to panel (3), (4), (5) and (6).
- Insert all hardware **A2** into **A1**.
- Rotate all **A1** until tight.
- Apply **A3** onto all **A1**.
(Repeat 8 times.)



OR

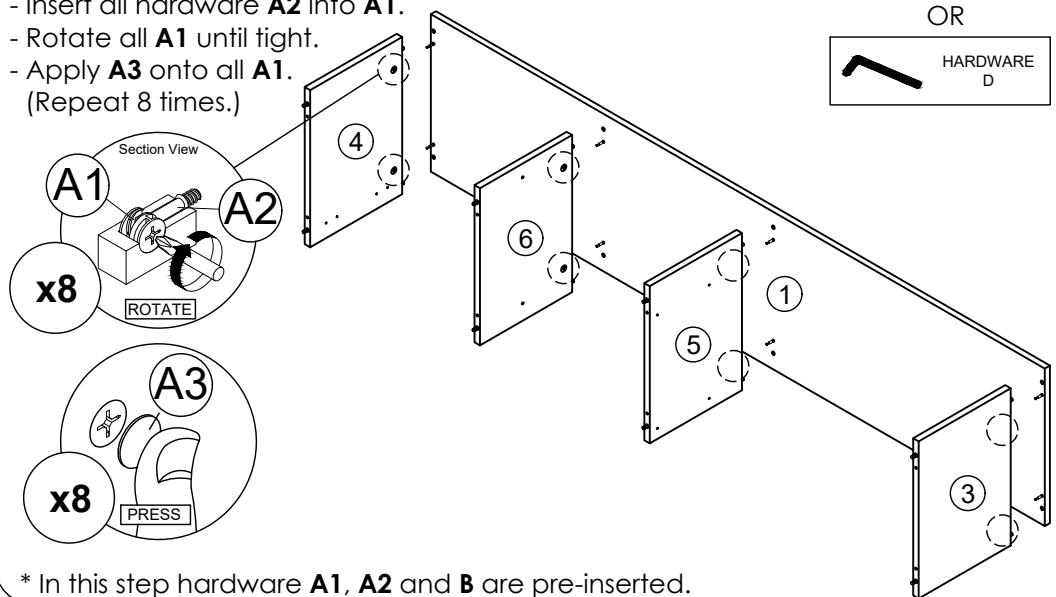

* In this step hardware **A1**, **A2** and **B** are pre-inserted.

MODEL : UH 8679

STEP 2

- Fix hardware **N1 (L/R)** into panel (3) and (5) with hardware **F**.
(Repeat 3 times for each hardware.)

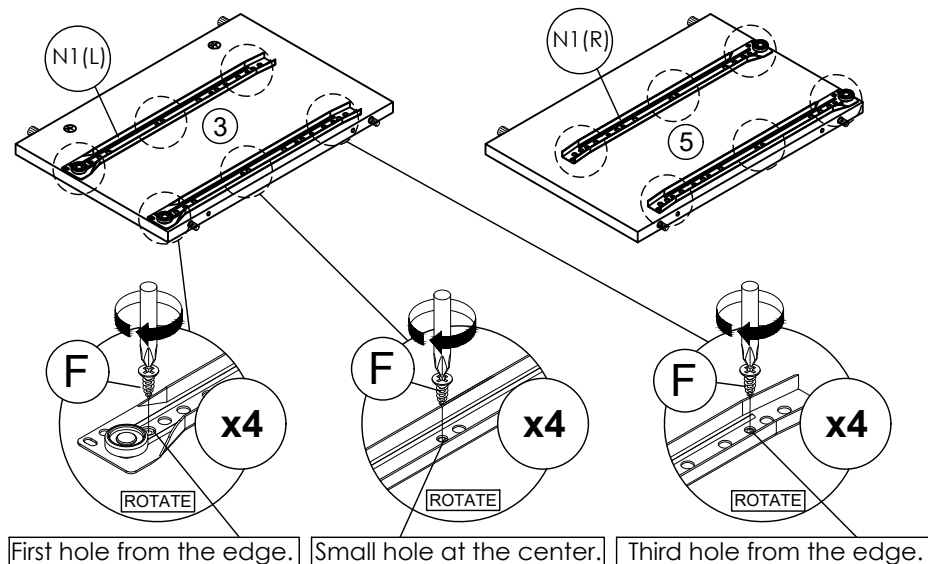

STEP 4

- Connect panel (2) to panel (3), (4), (5) and (6)
by using hardware **C** and **D**.
(Repeat 8 times.)

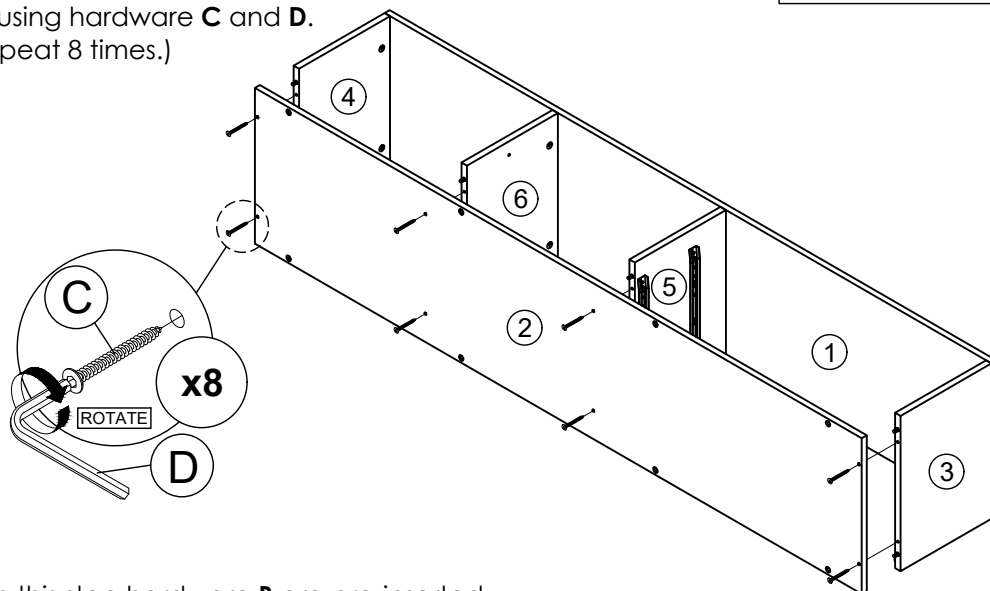

* In this step hardware **B** are pre-inserted.

ASSEMBLY INSTRUCTIONS

PAGE: 3/6

MODEL : UH 8679

STEP 5

Assemble panel **(9)** to entire body with hardware **H**.
(Repeat 28 times.)

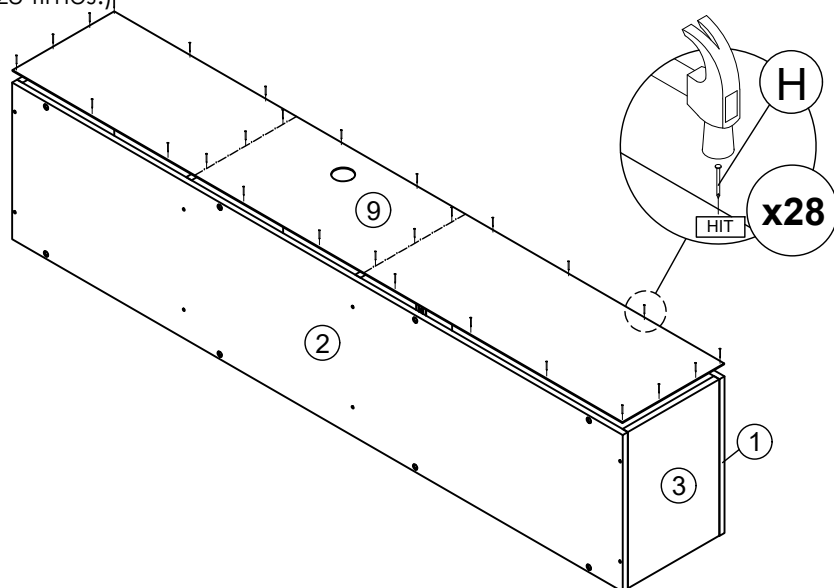

STEP 6

Connect Metal Side **(15)** to Metal Support **(16)** by using hardware **D** and **J**.
(Repeat 8 times.)

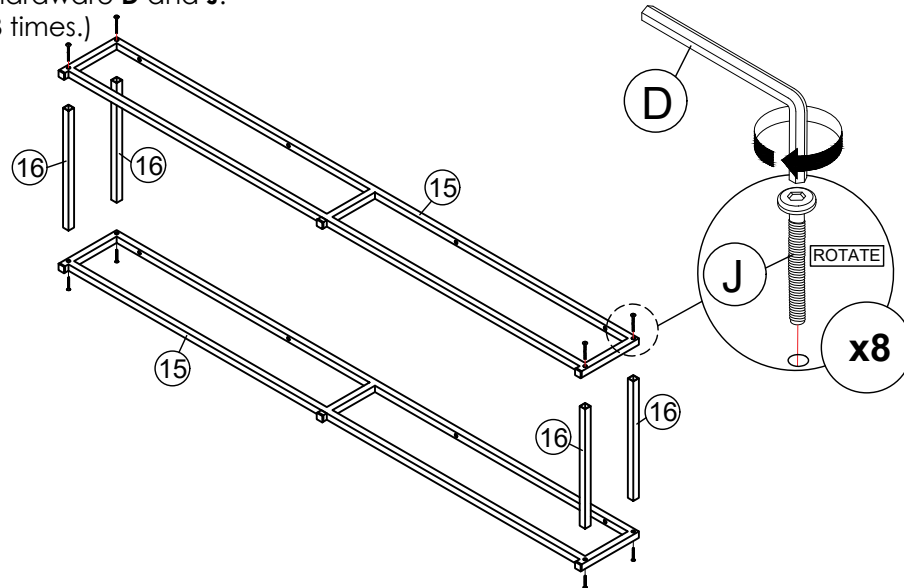
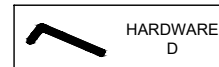

STEP 7

Connect Metal Side **(15)** to panel **(2)** by using hardware **D** and **I**.
(Repeat 8 times.)

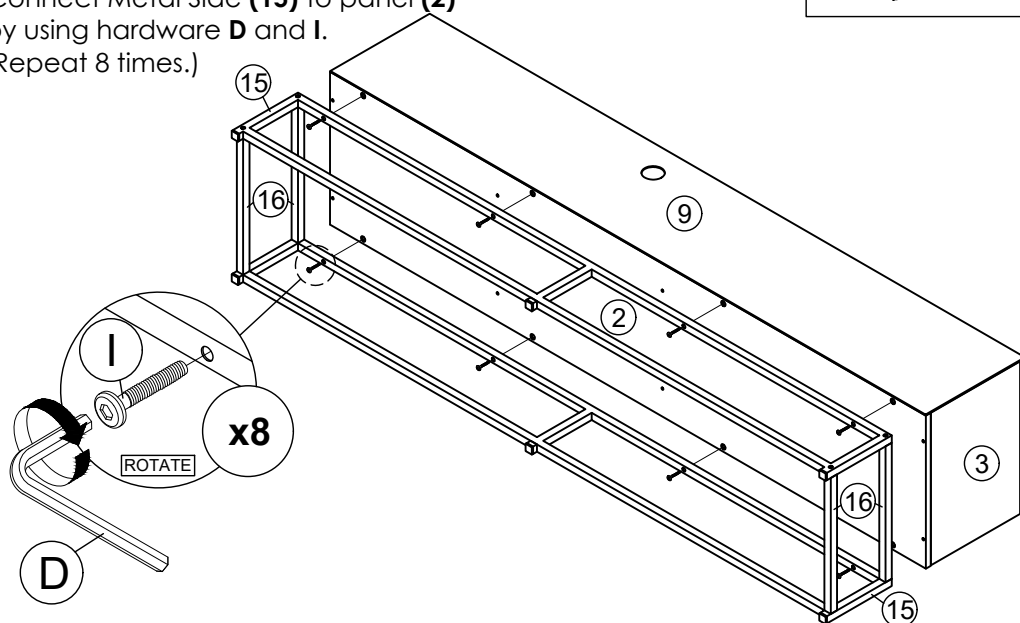

STEP 8

Insert hardware **L** into mounting positions on panel **(5)** and **(6)** by hand.
(Repeat 4 times.)

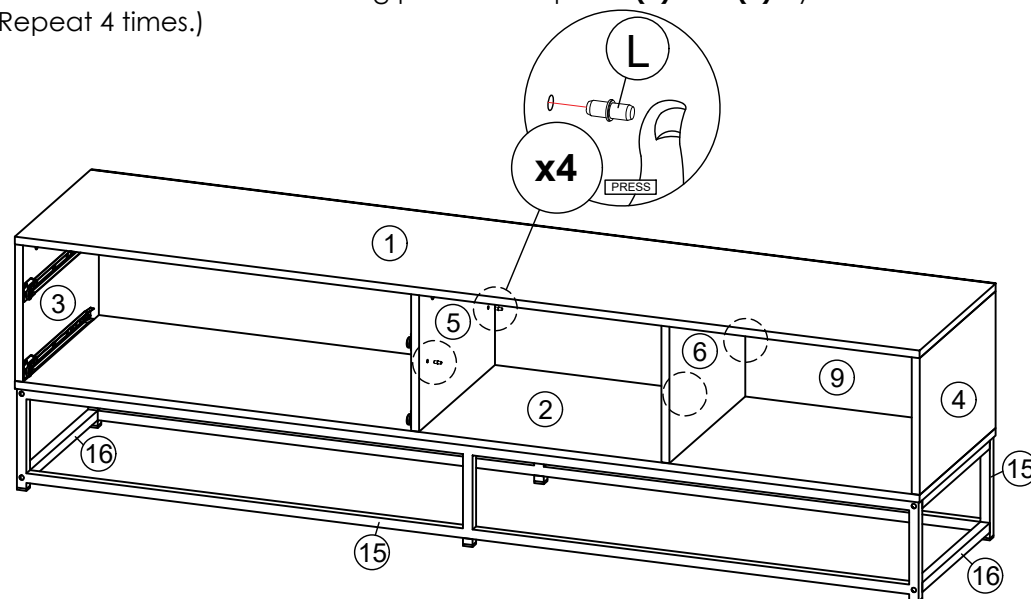

ASSEMBLY INSTRUCTIONS

PAGE: 4/6

MODEL : UH 8679

STEP 9

Assemble panel **(7)** into between panel **(5)** and **(6)**.
(Repeat 1 times.)

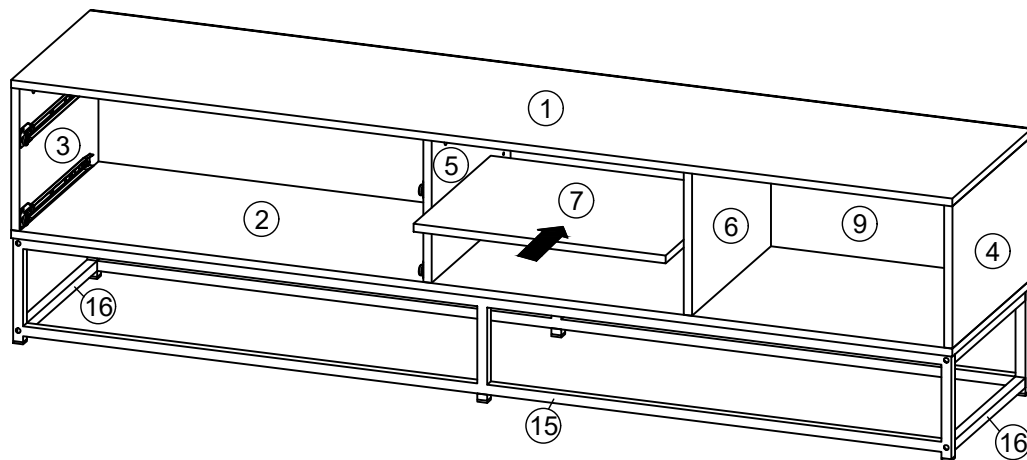

* In this step hardware **L** are pre-inserted.

STEP 11

- Fix hardware **M** into panel **(4)** by using hardware **F**.
(Repeat 4 times for each hardware.)
- Tighten or loosen the screw to adjust position of panel **(8)**.
(Do only when needed.)

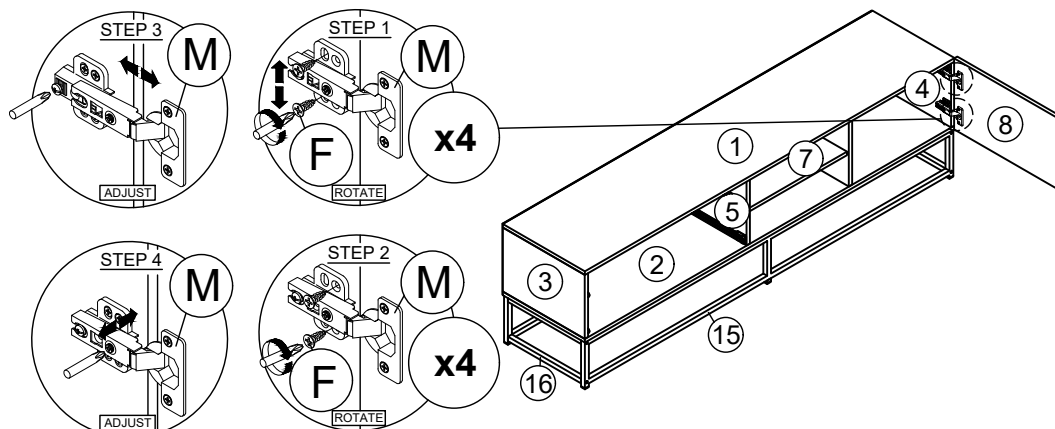

* In this step hardware **M** have been assembled in panel **(8)**.

STEP 10

Fix hardware **M** onto panel **(8)** by using hardware **F**.
(Repeat 2 times for each hardware.)

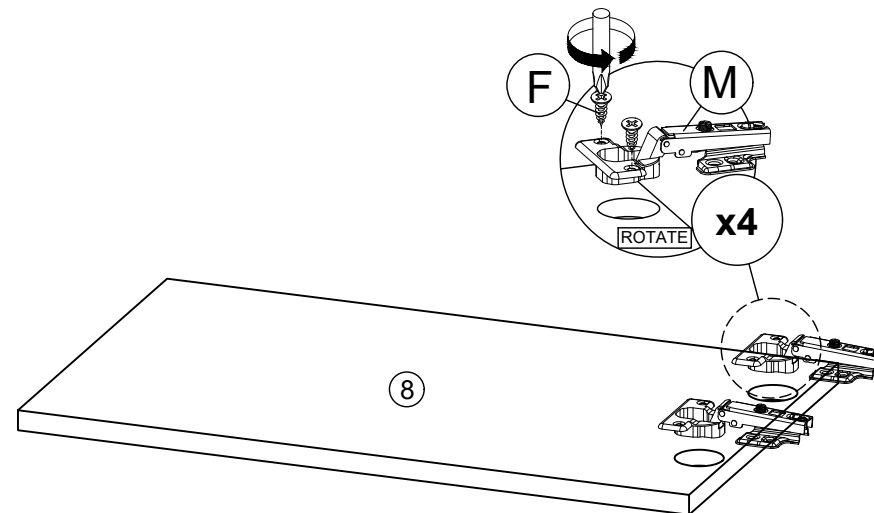

STEP 12

Fix hardware **K** onto panel **(11)** by using hardware **E**.
(Repeat 2 times.)

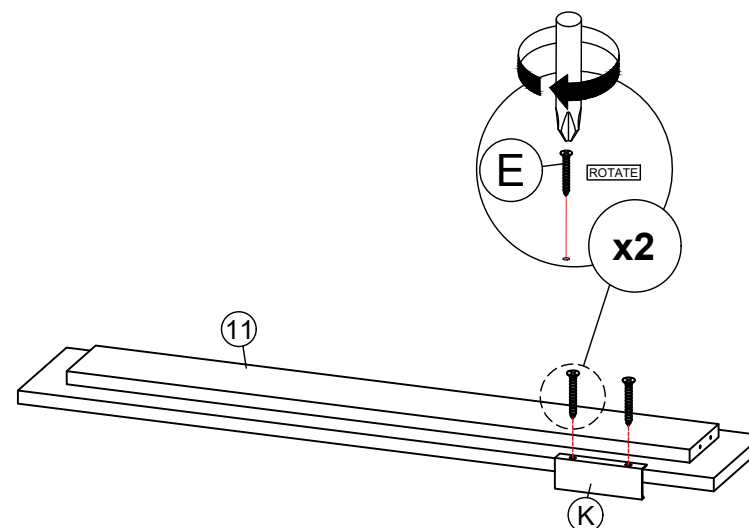

ASSEMBLY INSTRUCTIONS

PAGE: 5/6

STEP 13

Assemble panel **(13)** to panel **(10)** or **(11)** and **(12)** by using hardware **G**.
(Repeat 16 times.)

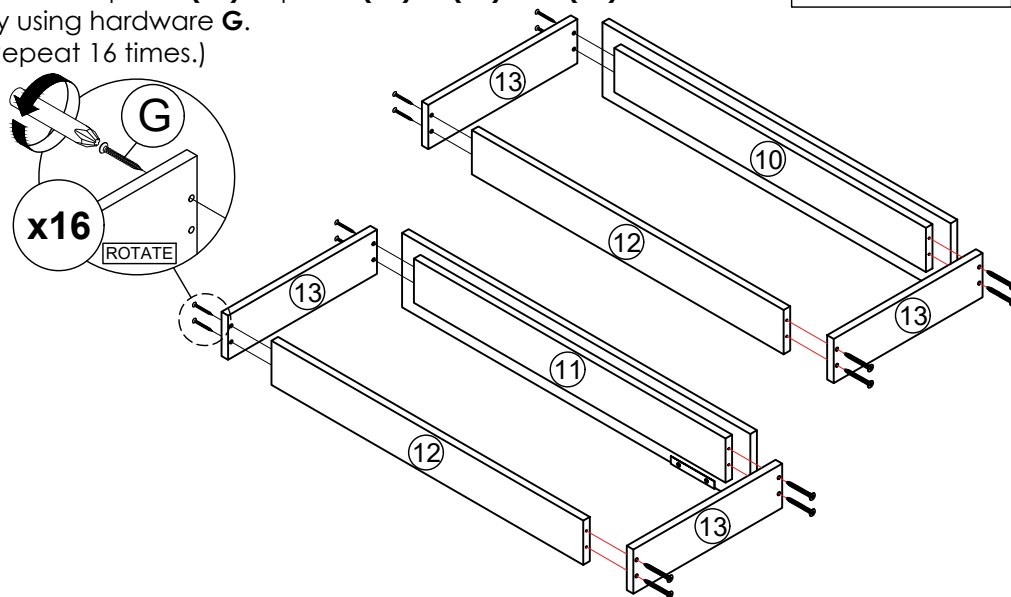

MODEL : UH 8679

STEP 14

Assemble panel **(14)** to entire body with hardware **H**.
(Repeat 24 times.)

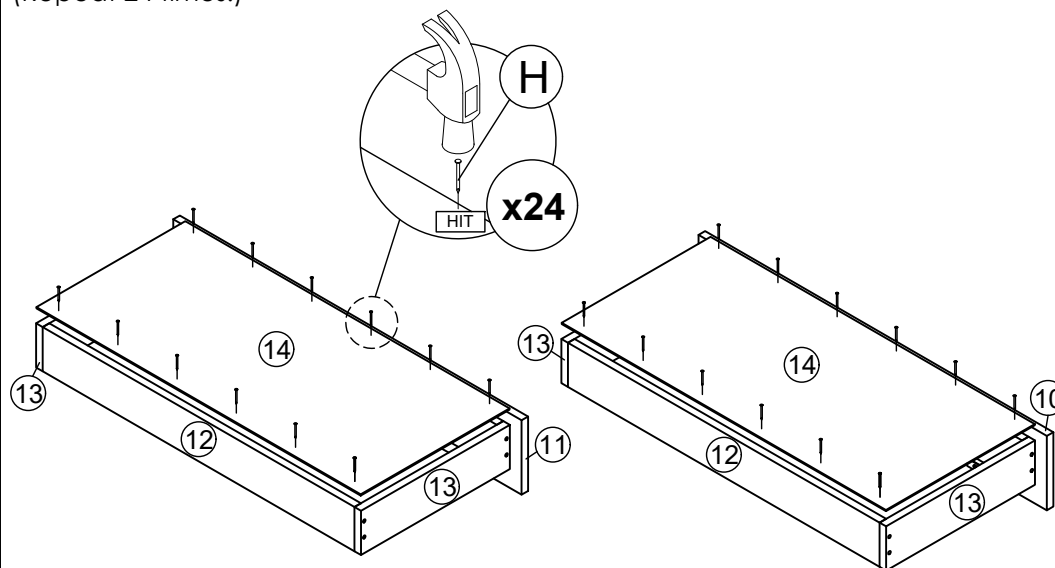

STEP 15

Assemble hardware **N2 (L/R)** to panel **(14)** by using hardware **F**.
(Repeat 3 times for each hardware.)

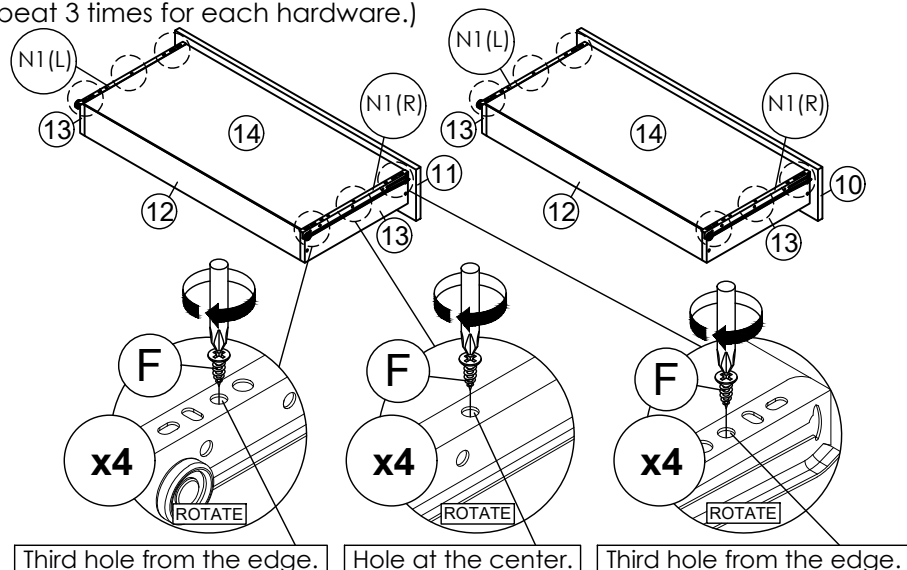

STEP 16

Put all the drawer in place along the drawer slides.

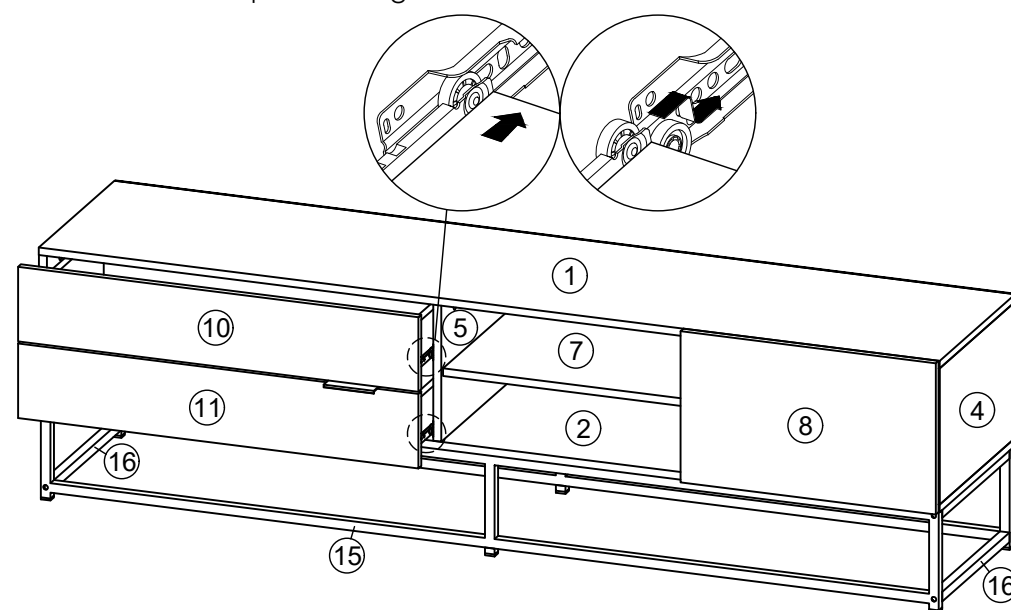

*Hardware **N2 (L/R)** shall be leaning against panel **(10)** or **(11)** when assembling.

ASSEMBLY INSTRUCTIONS

PAGE: 6/6

MODEL : UH 8679

STEP 17

Assemble hardware **O1** into panel **(1)** and **(9)** by using hardware **O2**.
(Repeat 2 times.)

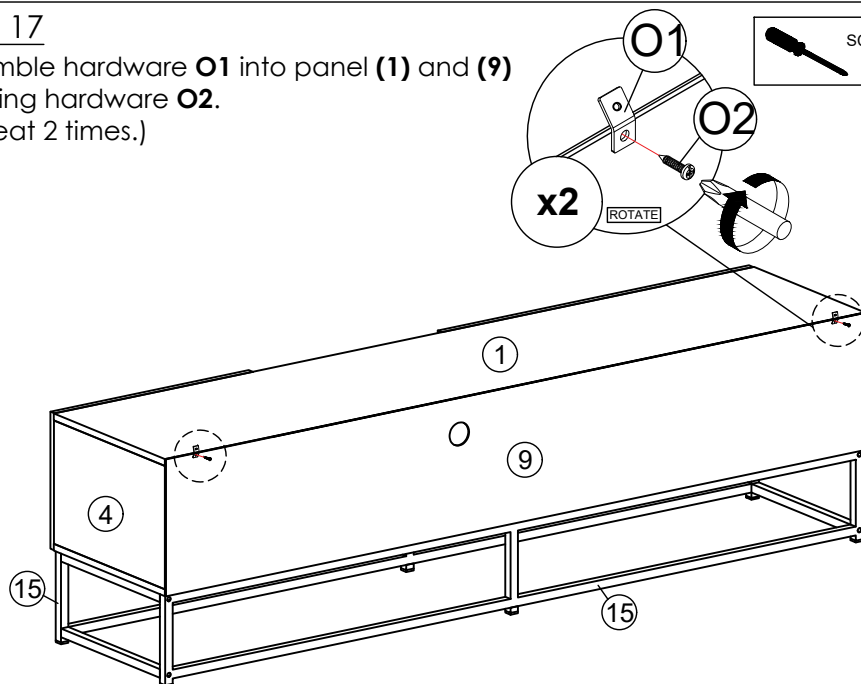

STEP 18

- Mark and use the power drill to drill a hole on the wall.
- Hit hardware **P** into the wall.
(Repeat 2 times.)

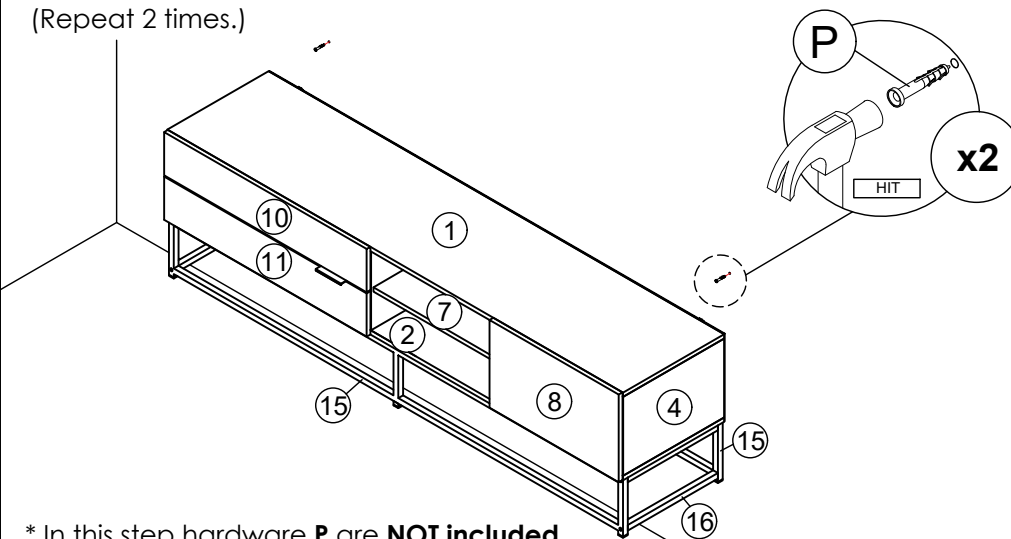

* In this step hardware **P** are **NOT included**.

STEP 19

- Assemble hardware **O1** into hardware **P** by using hardware **O3**.
(Repeat 2 times.)

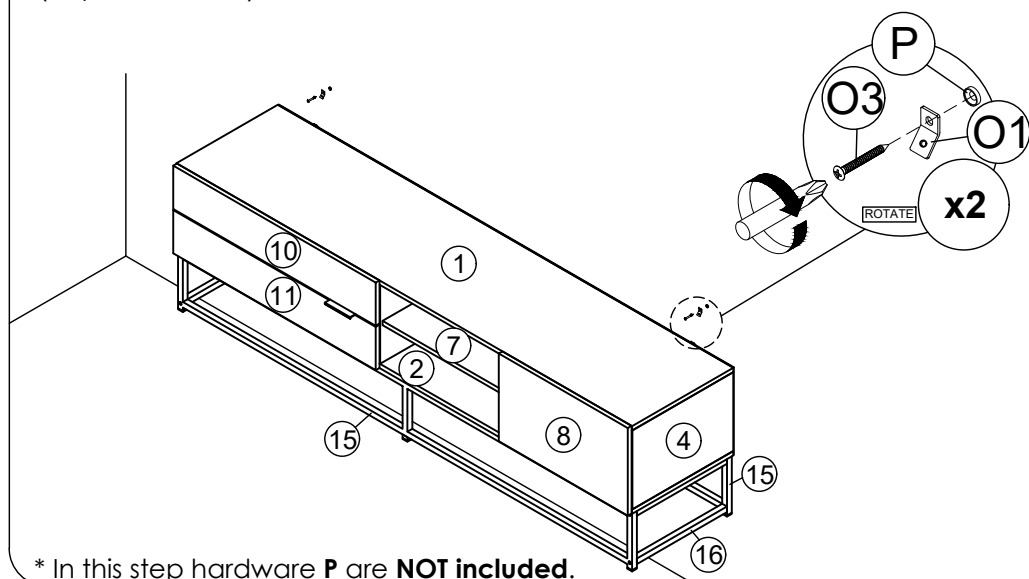

* In this step hardware **P** are **NOT included**.

STEP 20

- Connect both of the hardware **O1** by using hardware **O4**.
- Tighten the hardware **O4**.
(Repeat 2 times.)

