

ASSEMBLY INSTRUCTIONS

PAGE: 1/7

MODEL : UH 7155

Before you begin, please follow assembly instructions carefully, then follow them step by step.

Read instruction carefully . See Furniture Parts list and Hardware List for guidance . Be sure you have all parts before you start assembling . Place and assemble furniture on a clean flat soft surface , such as carpet or rug to prevent being scratched .

PART LIST		QTY
1	HEADBOARD TOP	1 PC
2	HEADBOARD PANEL	1 PC
3	HEADBOARD MIDDLE	1 PC
4	HEADBOARD SIDE (L)	1 PC
5	HEADBOARD SIDE (R)	1 PC
6	HEADBOARD CENTER (L)	1 PC
7	HEADBOARD CENTER (R)	1 PC
8	HEADBOARD BACK	3 PCS
9	HEADBOARD SHELF	1 PC
10	TAILSTOCK	1 PC
11	TAILSTOCK TOP	1 PC
12	BED SIDE (L)	1 PC
13	BED SIDE (R)	1 PC
14	BED CENTER	1 PC
15	BED MIDDLE (L)	2 PCS
16	BED MIDDLE (R)	2 PCS
17	BED PANEL	3 PCS

HARDWARE					
A	MINI FIX	A1	A2	A3	47 SETS
B	M8 X 30MM WOOD DOWEL				28 PCS
C	M6 X 50MM CSK CAP WOOD SCREW				4 PCS
D	ALLEN KEY M4				1 PC
E	M3.5 X 16MM C.B SCREW				72 PCS
F	METAL SHELF SUPPORT				4 PCS
G	BED BRACKET G1	G2	G3	G4	4 SETS
H	5/8 PVC NAIL LEG				19 PCS
I	ALLEN KEY M5				1 PC

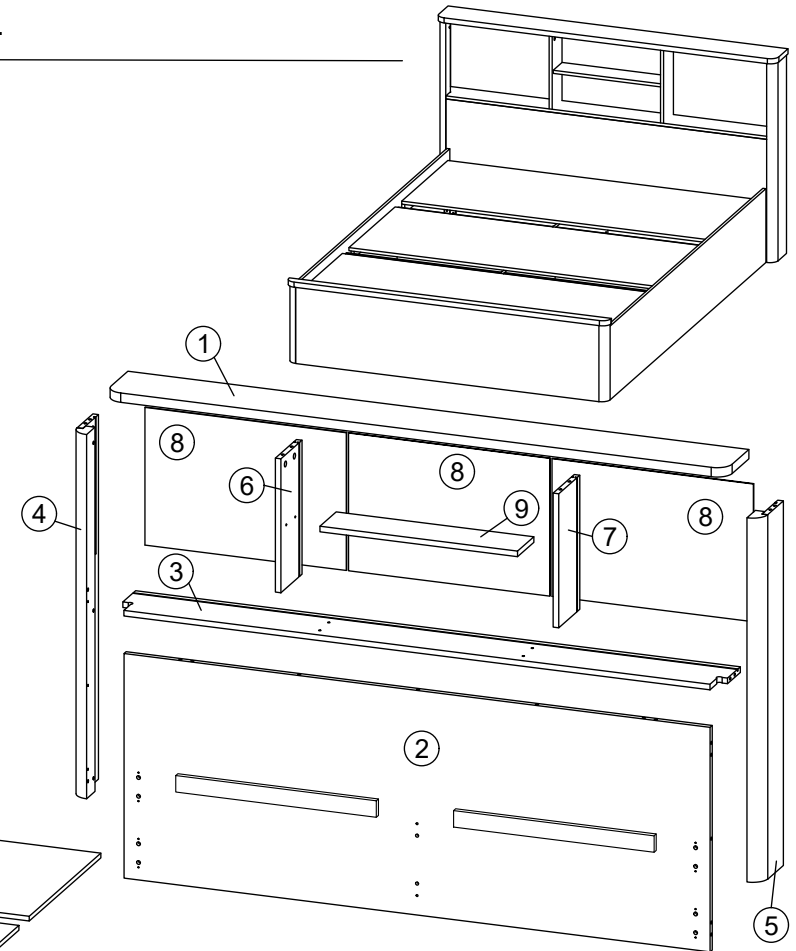
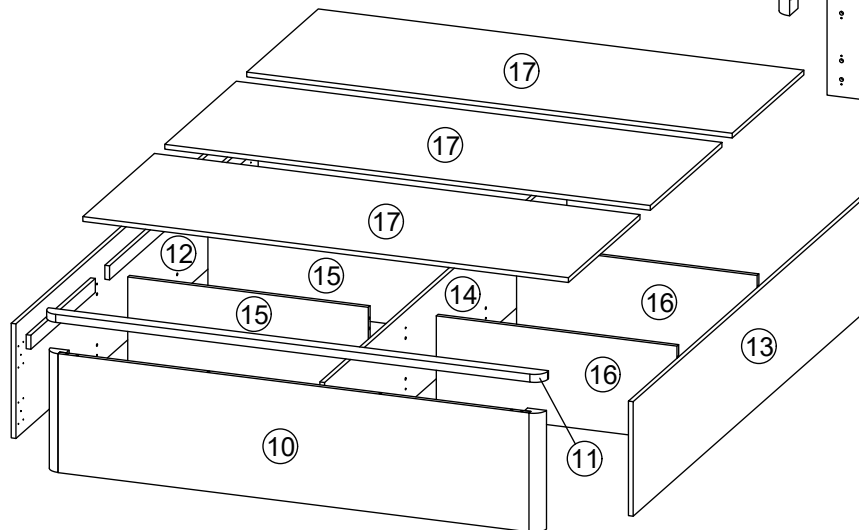

SELF-PREPARED TOOLS: Tools below are NOT included in package.



SCREWDRIVER



HAMMER

Reminder:

Please ensure that all surfaces and edges with colours/laminations are facing forward/outward.

ASSEMBLY INSTRUCTIONS

PAGE: 2/7

STEP 1

- Insert hardware **A1** onto panel **(3)**.
(Repeat 4 times.)
- Insert hardware **A2** onto panel **(1)** and **(3)**.
(Repeat 13 times.)

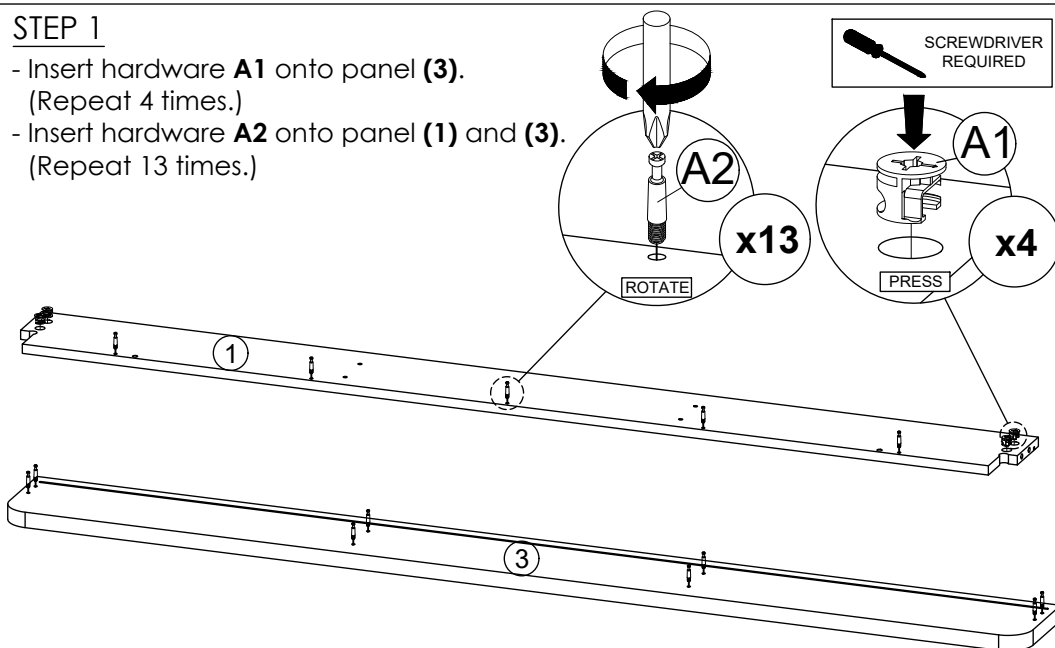

* Ensure the arrows on hardware **A1** point towards mounting positions.

STEP 3

- Insert hardware **A1** onto panel **(2), (6)** and **(7)**.
(Repeat 15 times.)
- Insert hardware **B** onto panel **(2)**.
(Repeat 6 times.)

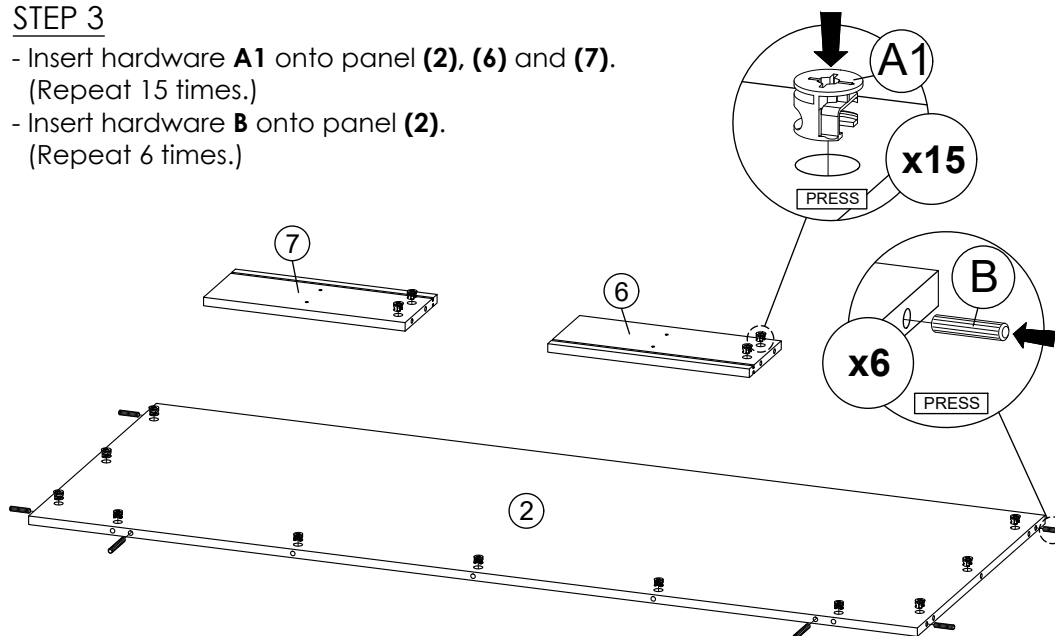

* Ensure the arrows on hardware **A1** point towards mounting positions.

MODEL : UH 7155

STEP 2

- Insert hardware **A1** onto panel **(4)** and **(5)**.
(Repeat 4 times.)
- Insert hardware **A2** onto panel **(4)** and **(5)**.
(Repeat 10 times.)

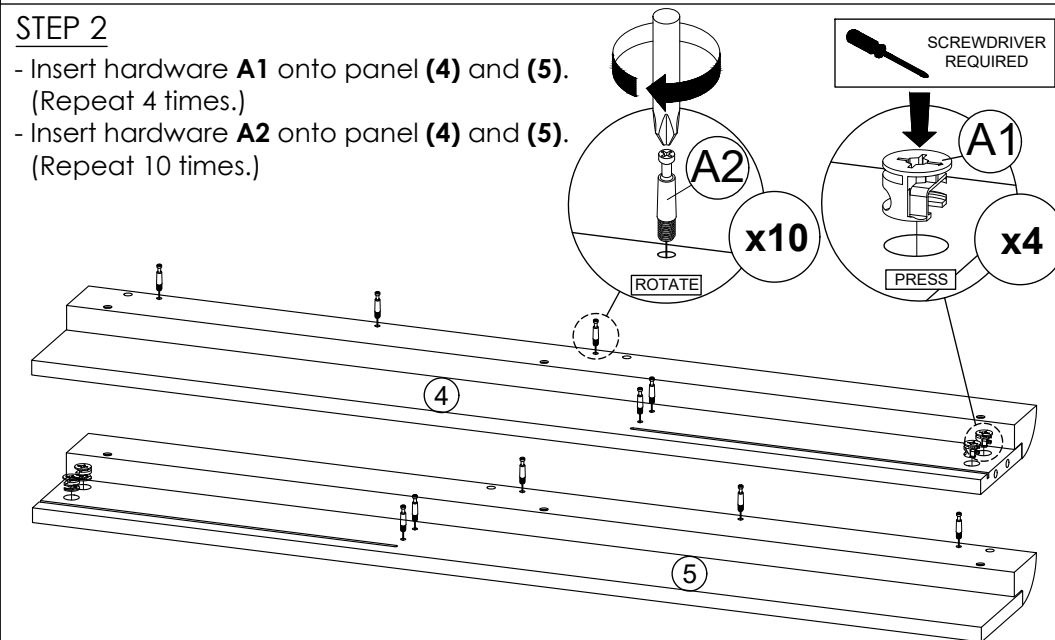

* Ensure the arrows on hardware **A1** point towards mounting positions.

STEP 4

- Attach panel **(3)** to panel **(2)**.
- Insert all hardware **A2** into **A1**.
- Rotate all **A1** until tight.
- Apply **A3** onto all **A1**.
(Repeat 5 times.)

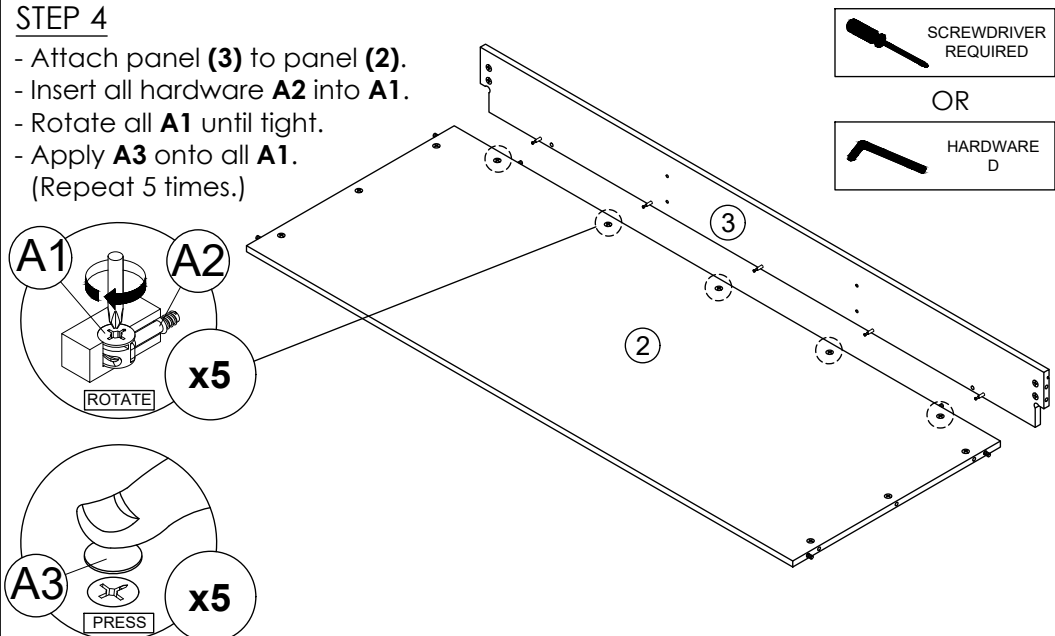

* In this step hardware **A1**, **A2** and **B** are pre-inserted.

ASSEMBLY INSTRUCTIONS

PAGE: 3/7

MODEL : UH 7155

STEP 5

- Attach panel **(4)** and **(5)** to panel **(2)** and **(3)**.
 - Insert all hardware **A2** into **A1**.
 - Rotate all **A1** until tight.
 - Apply **A3** onto all **A1**.
- (Repeat 10 times.)

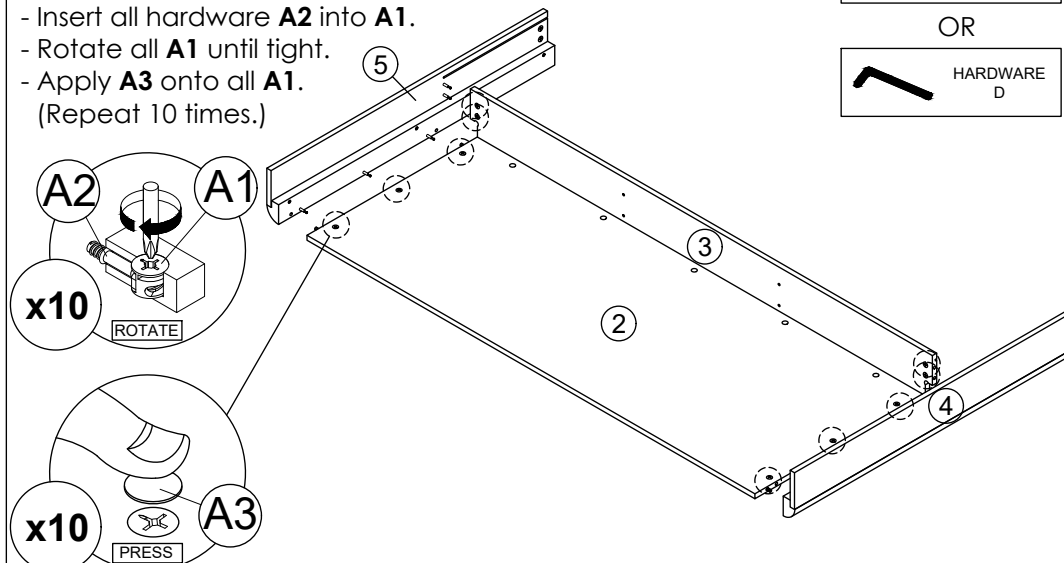

* In this step hardware **A1**, **A2** and **B** are pre-inserted.

STEP 7

- Insert the panel **(8)** along the slot.
- (Repeat 3 times.)

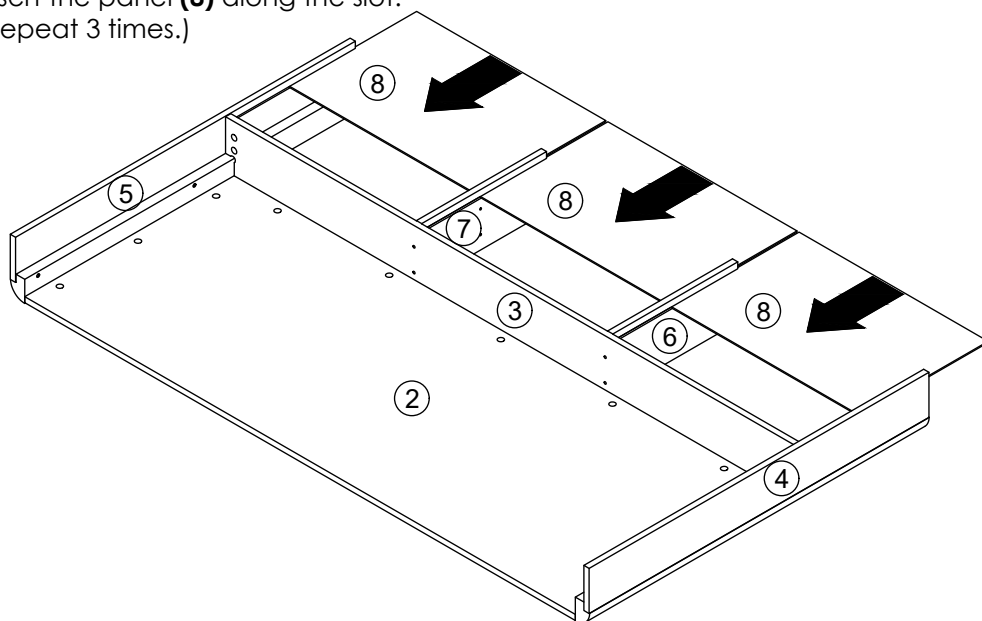

STEP 6

- Connect panel **(6)** and **(7)** to panel **(3)** by using hardware **C** and **D**.
- (Repeat 4 times.)

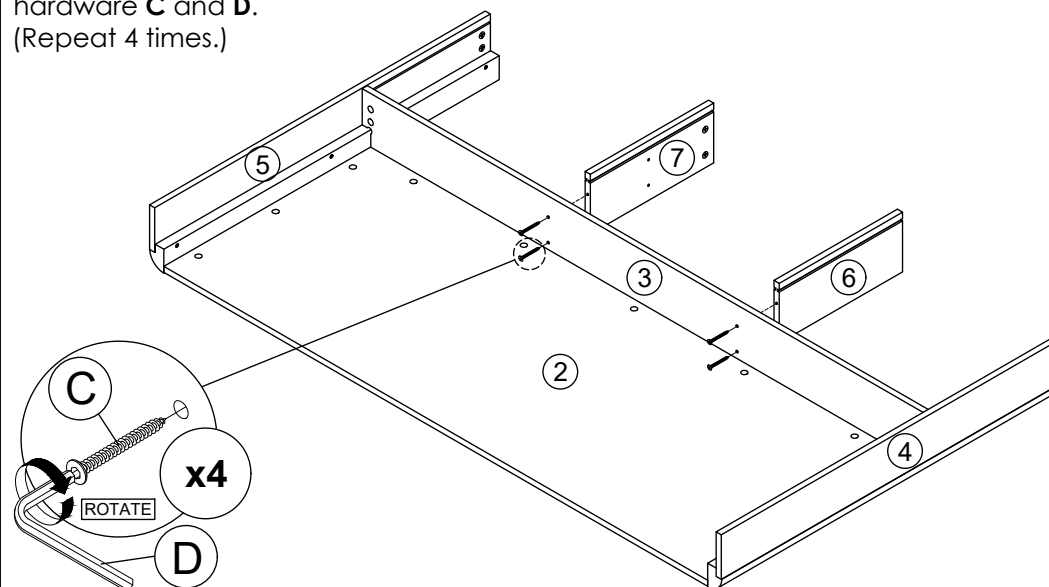

STEP 8

- Attach panel **(1)** to panel **(4)**, **(5)**, **(6)** and **(7)**.
 - Insert all hardware **A2** into **A1**.
 - Rotate all **A1** until tight.
 - Apply **A3** onto all **A1**.
- (Repeat 8 times.)

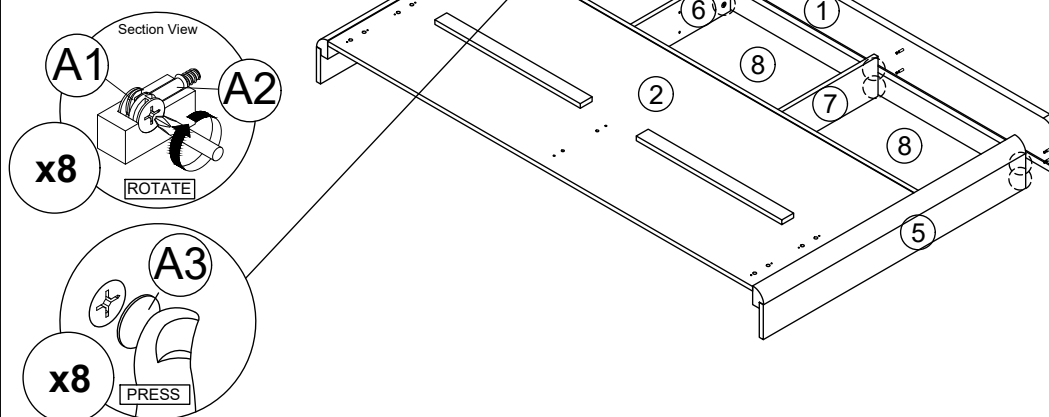

* In this step hardware **A1**, **A2** and **B** are pre-inserted.

ASSEMBLY INSTRUCTIONS

PAGE: 4/7

MODEL : UH 7155

STEP 9

Hit hardware **H** into bottom of panel **(2)** , **(4)** and **(5)**.
(Repeat 4 times.)

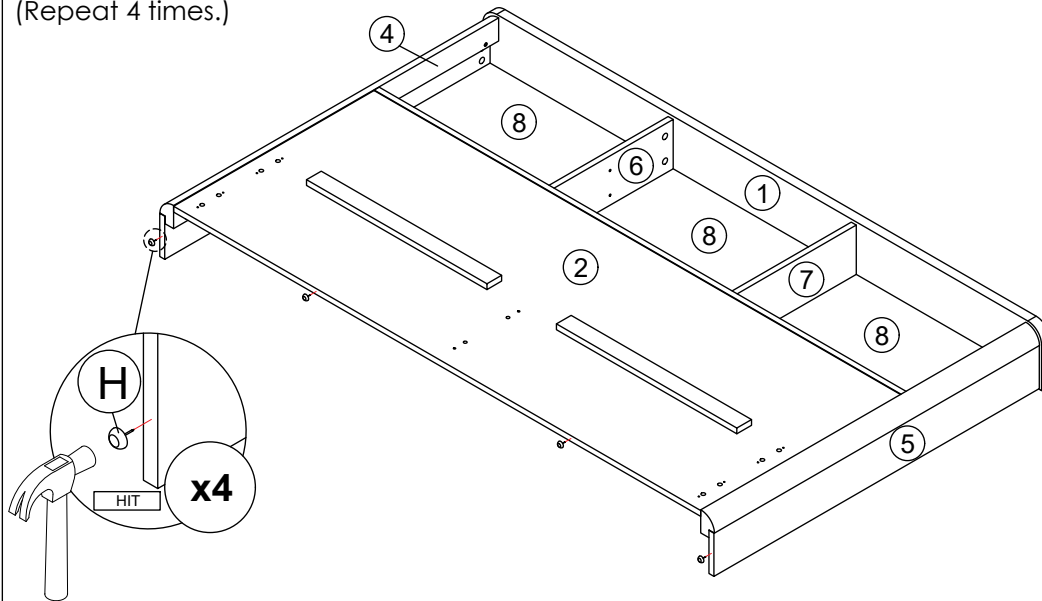

STEP 10

- Fix hardware **G3** onto Headboard **(2)** by using hardware **E**.
(Repeat 16 times.)
- Insert hardware **A2** onto Headboard **(2)**.
(Repeat 2 times.)

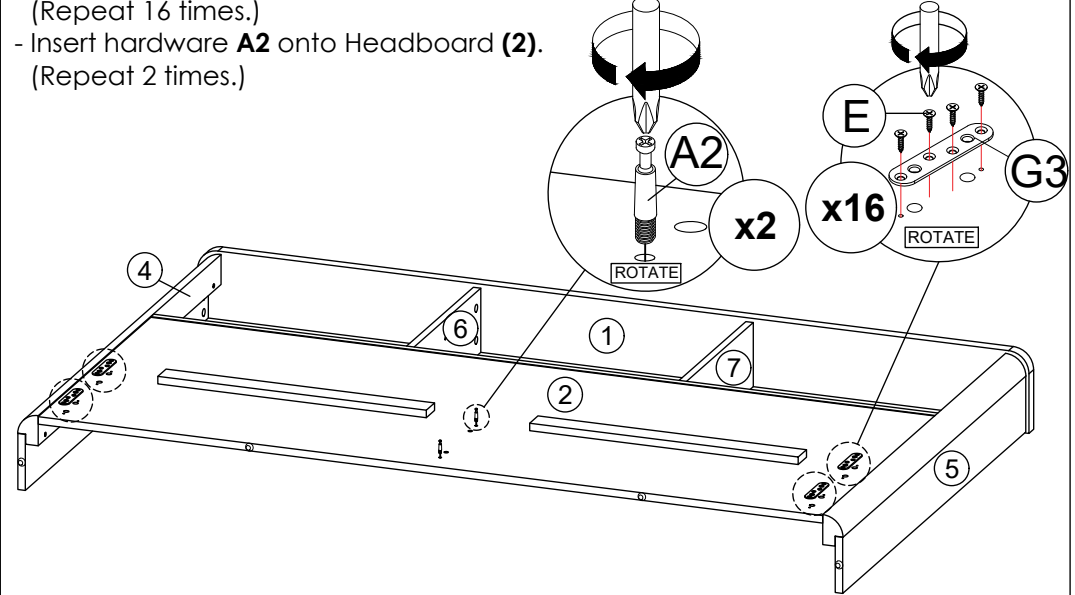

STEP 11

- Insert hardware **A2** onto panel **(12)**. (Repeat 4 times.)
- Fix hardware **G1** and **G2** onto panel **(12)** by using hardware **E**.
(Repeat 20 times.)
- Insert hardware **H** onto panel **(12)**. (Repeat 3 times.)

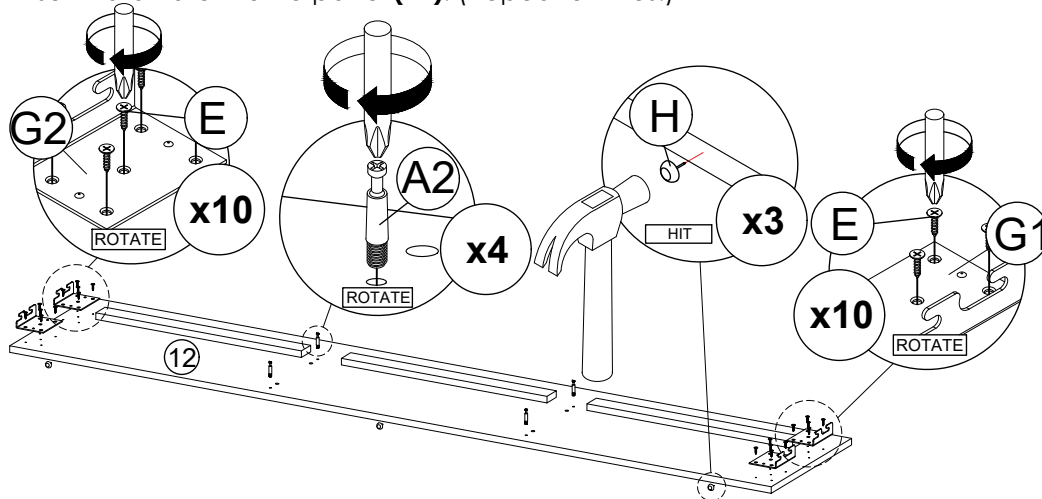
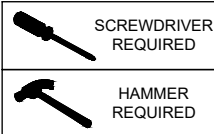

STEP 12

- Insert hardware **A2** onto panel **(13)**. (Repeat 4 times.)
- Fix hardware **G1** and **G2** onto panel **(13)** by using hardware **E**.
(Repeat 20 times.)
- Insert hardware **H** onto panel **(13)**. (Repeat 3 times.)

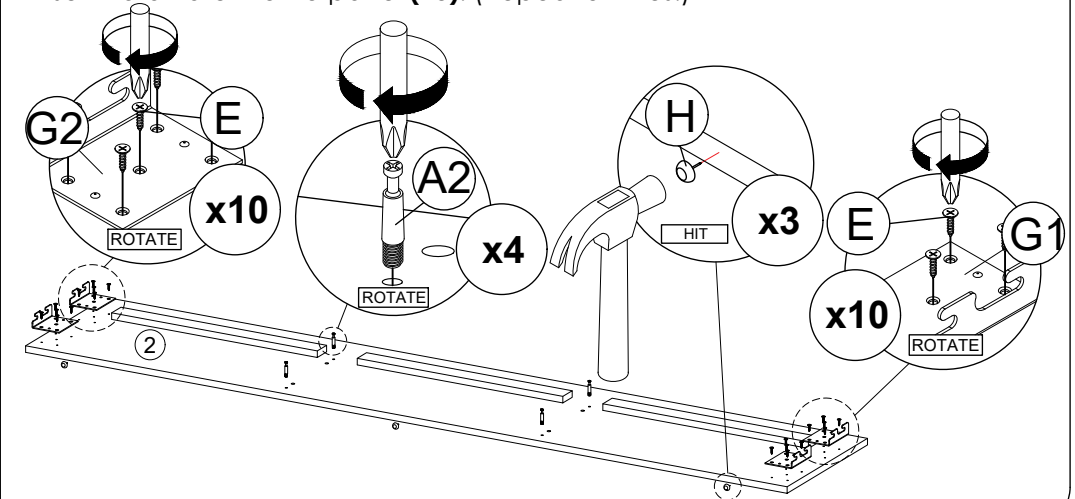
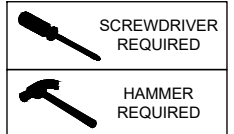

ASSEMBLY INSTRUCTIONS

PAGE: 5/7

MODEL : UH 7155

STEP 13

- Insert hardware **A1** onto panel (14). (Repeat 4 times.)
- Insert hardware **A2** onto panel (14). (Repeat 8 times.)
- Insert hardware **B** onto panel (14). (Repeat 4 times.)
- Insert hardware **H** onto panel (14). (Repeat 2 times.)

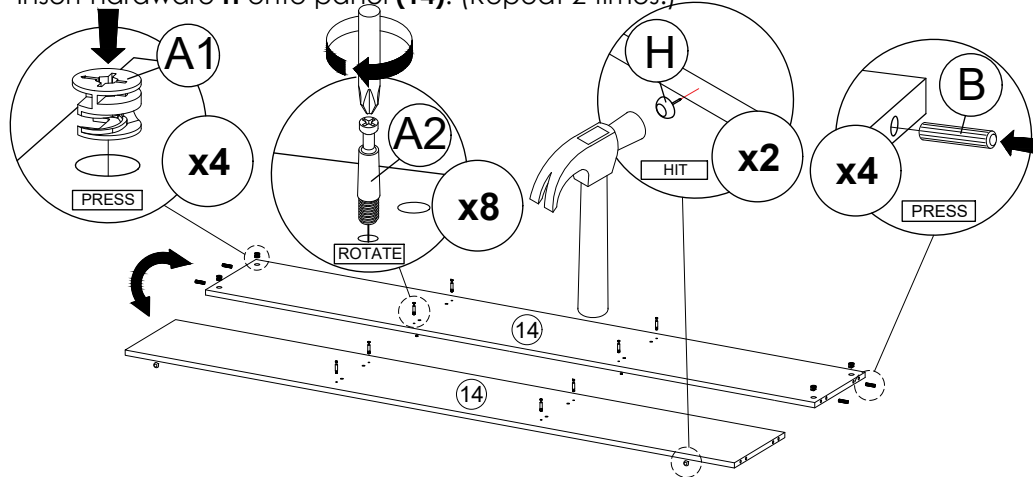
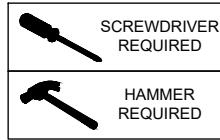

* Ensure the arrows on hardware **A1** point towards mounting positions.

STEP 14

- Insert hardware **A2** onto panel (11). (Repeat 4 times.)

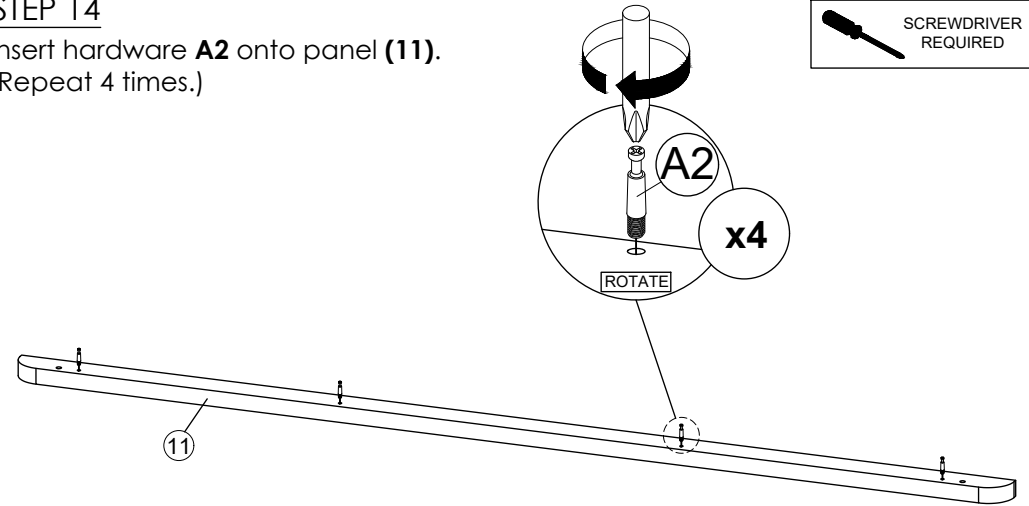

STEP 15

- Fix hardware **G3** onto panel (10) by using hardware **E**. (Repeat 16 times.)
- Insert hardware **A1** onto panel (10). (Repeat 4 times.)
- Insert hardware **A2** onto panel (10). (Repeat 2 times.)
- Insert hardware **B** onto panel (10). (Repeat 2 times.)
- Insert hardware **H** onto panel (10). (Repeat 3 times.)

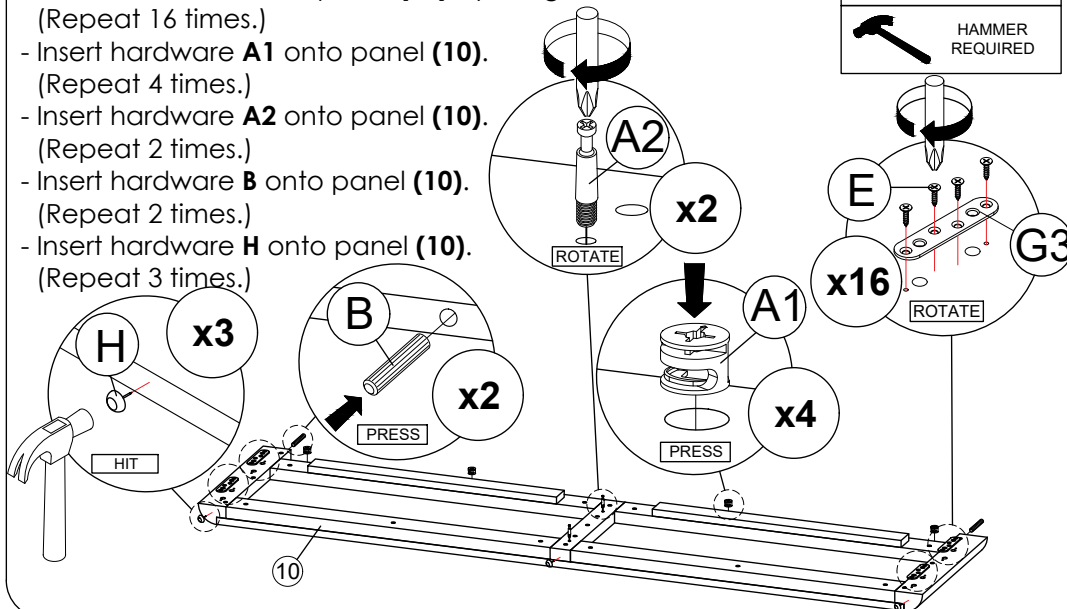
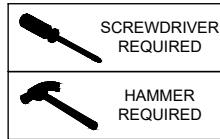

STEP 16

- Insert hardware **A1** onto panel (15) and (16). (Repeat 16 times.)
 - Insert hardware **B** onto panel (15) and (16). (Repeat 16 times.)
 - Insert hardware **H** onto panel (15) and (16). (Repeat 4 times.)
- * In this step only show one of the panel .

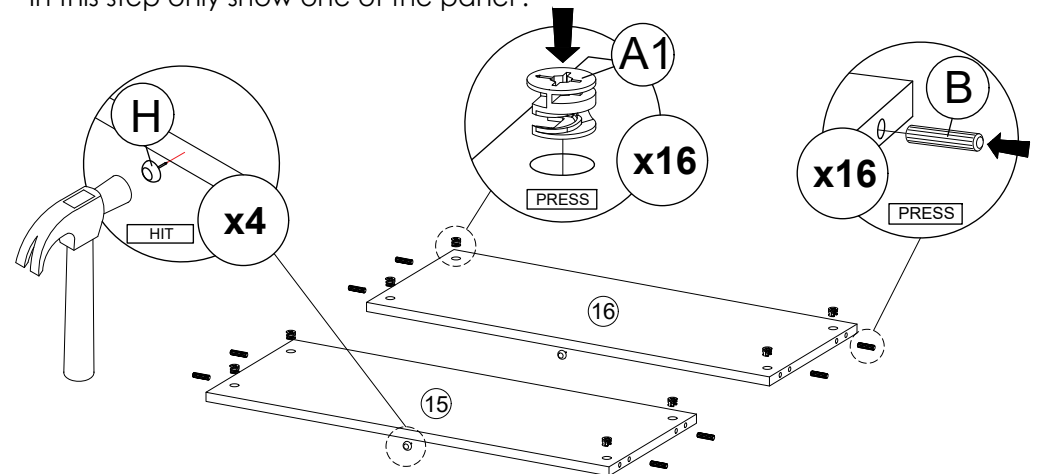
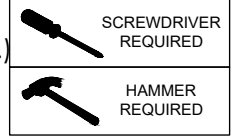

* Ensure the arrows on hardware **A1** point towards mounting positions.

ASSEMBLY INSTRUCTIONS

PAGE: 6/7

MODEL : UH 7155

STEP 17

- Attach panel (11) to panel (10).
 - Insert all hardware **A2** into **A1**.
 - Rotate all **A1** until tight.
 - Apply **A3** onto all **A1**.
- (Repeat 4 times.)

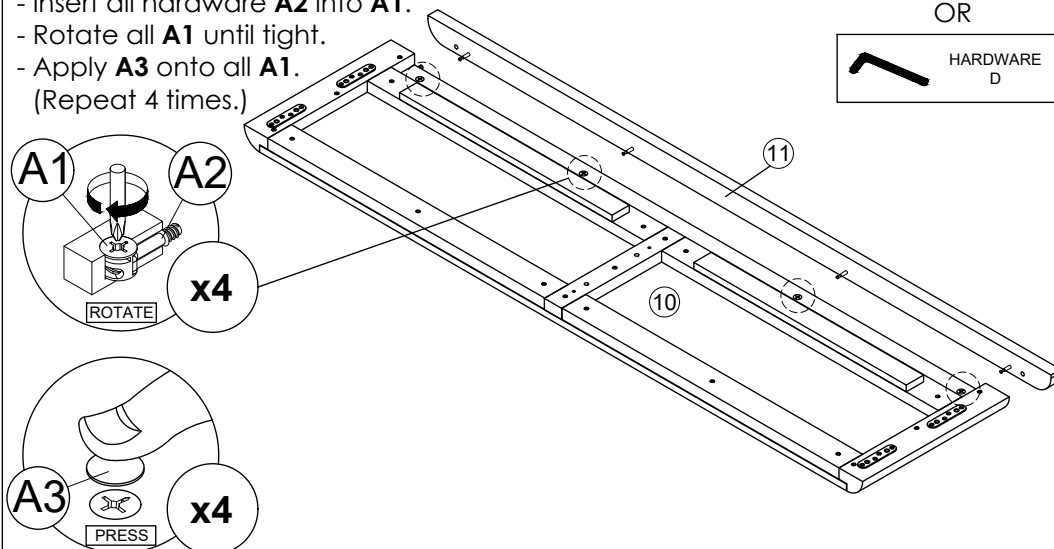

* In this step hardware **A1**, **A2** and **B** are pre-inserted.

STEP 19

- Attach panel (12) and (13) to panel (15) and (16).
 - Insert all hardware **A2** into **A1**.
 - Rotate all **A1** until tight.
 - Apply **A3** onto all **A1**.
- (Repeat 8 times.)

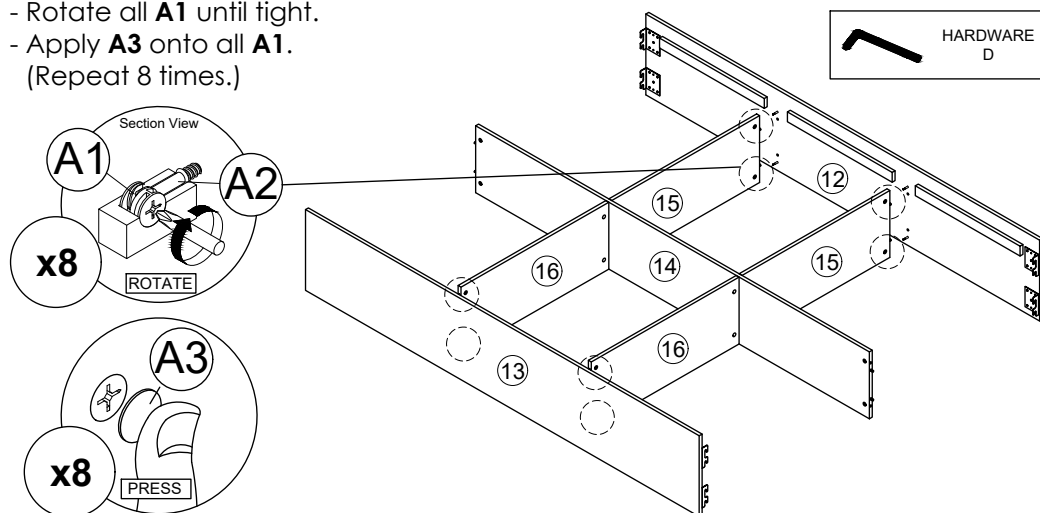

* In the step hardware **A1**, **A2** and **B** are pre-inserted.

STEP 18

- Attach panel (15) and (16) to panel (14).
 - Insert all hardware **A2** into **A1**.
 - Rotate all **A1** until tight.
 - Apply **A3** onto all **A1**.
- (Repeat 8 times.)

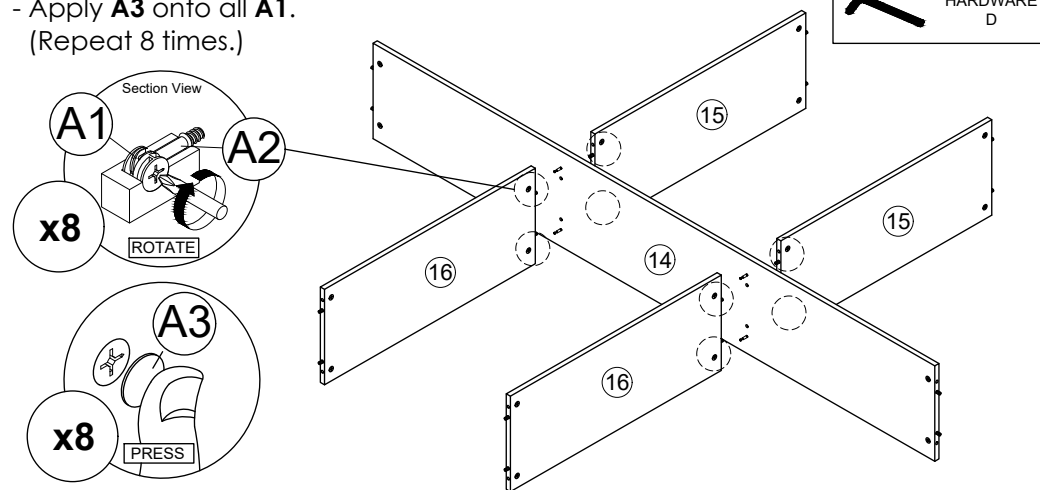

* In the step hardware **A1**, **A2** and **B** are pre-inserted.

STEP 20

- Fix hardware **G1** & **G2** and **G4** onto hardware **G3** by using hardware **E**.
 - Attach panel (10) to panel (14).
 - Insert all hardware **A2** into **A1**.
 - Rotate all **A1** until tight.
 - Apply **A3** onto all **A1**.
- (Repeat 2 times.)

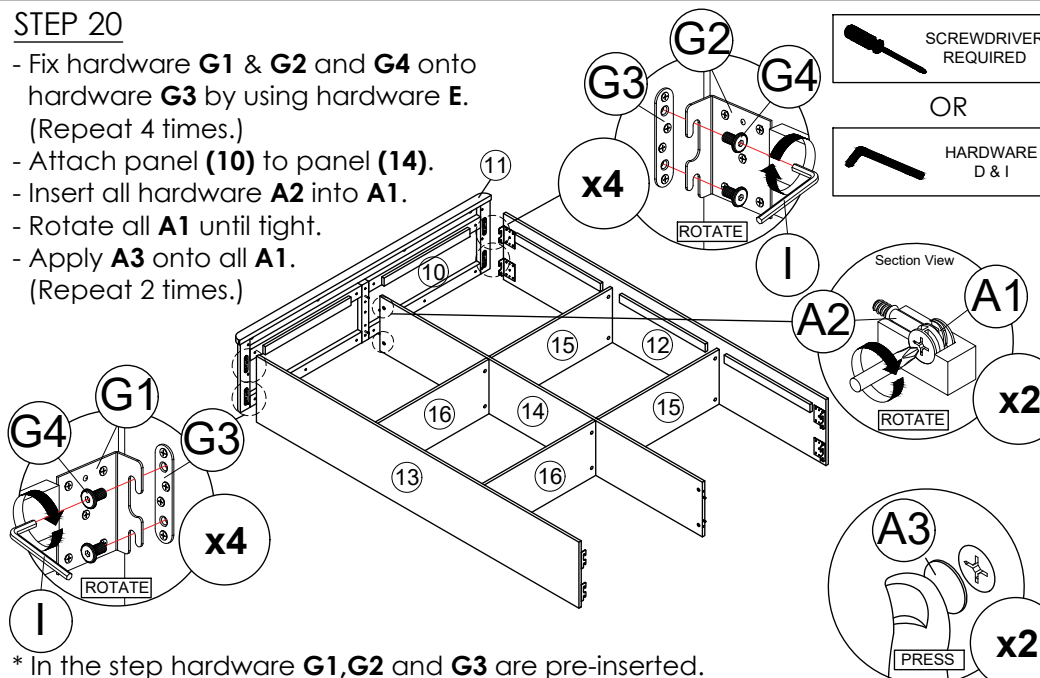

* In the step hardware **G1**, **G2** and **G3** are pre-inserted.

ASSEMBLY INSTRUCTIONS

PAGE: 7/7

MODEL : UH 7155

STEP 21

- Fix hardware **G1** & **G2** and **G4** onto hardware **G3** by using hardware **E**. (Repeat 4 times.)
- Attach panel **(2)** to panel **(14)**.
- Insert all hardware **A2** into **A1**.
- Rotate all **A1** until tight.
- Apply **A3** onto all **A1**. (Repeat 2 times.)

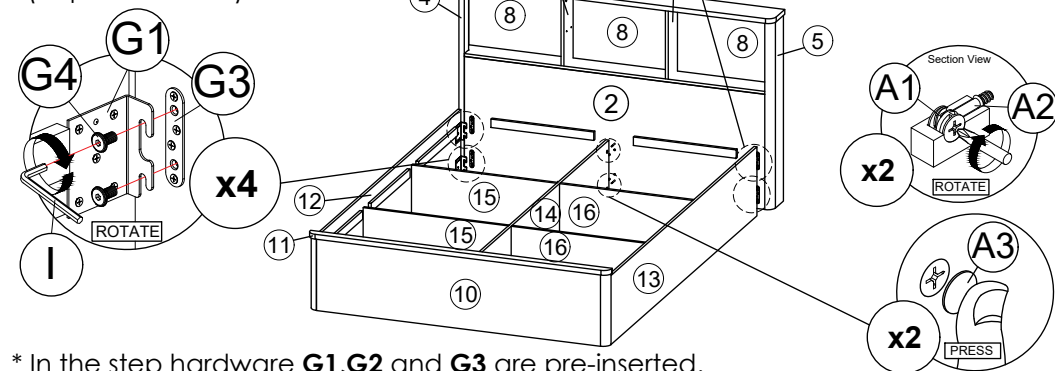

* In the step hardware **G1, G2** and **G3** are pre-inserted.

STEP 22

- Assemble the panel **(17)** into between panel **(12)**, and **(13)**. (Repeat 3 times)

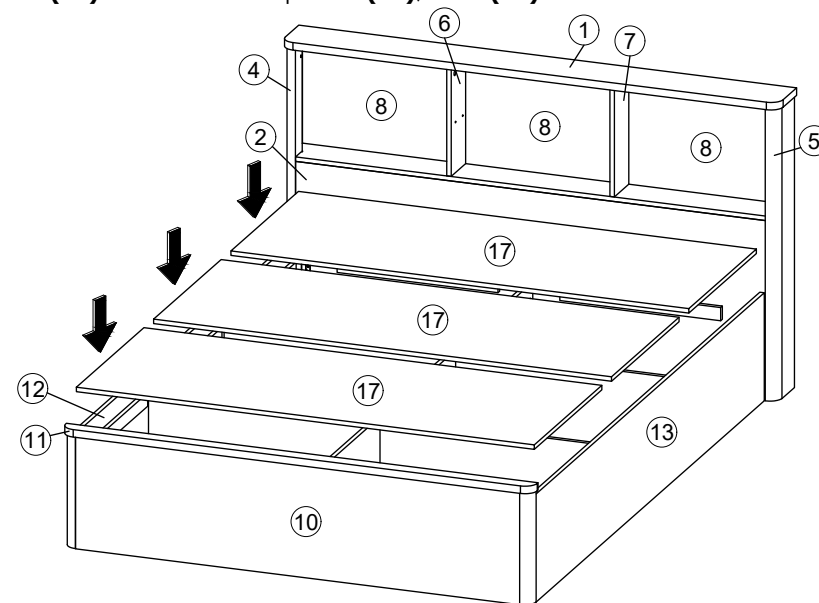

STEP 23

- Insert hardware **F** into mounting positions on panel **(6)** and **(7)** by hand. (Repeat 4 times.)

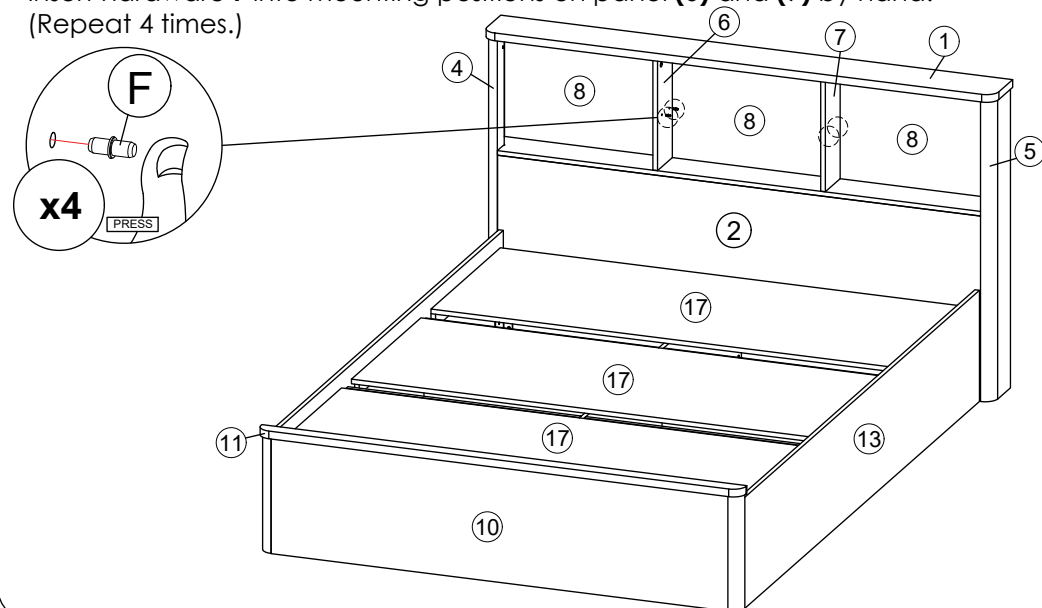

STEP 24

- Assemble the panel **(9)** into between panel **(6)** and **(7)**.

