

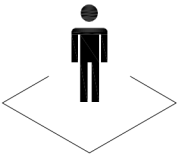

SORRENTO BUFFET WITH DRAWER & CUPBOARD

45 MIN APPROXIMATE ASSEMBLY TIME	 2 PERSON ASSEMBLY	FLOOR AREA 2.5M X 2.0M  REQUIRED ASSEMBLY SPACE
--	--	---

REQUIRED ASSEMBLY TOOLS			
 POZI SCREWDRIVER	 HAMMER	 MEASURING TAPE	 DRILL

ASSEMBLED DIMENSIONS

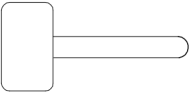
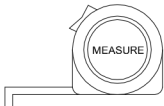
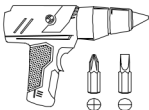
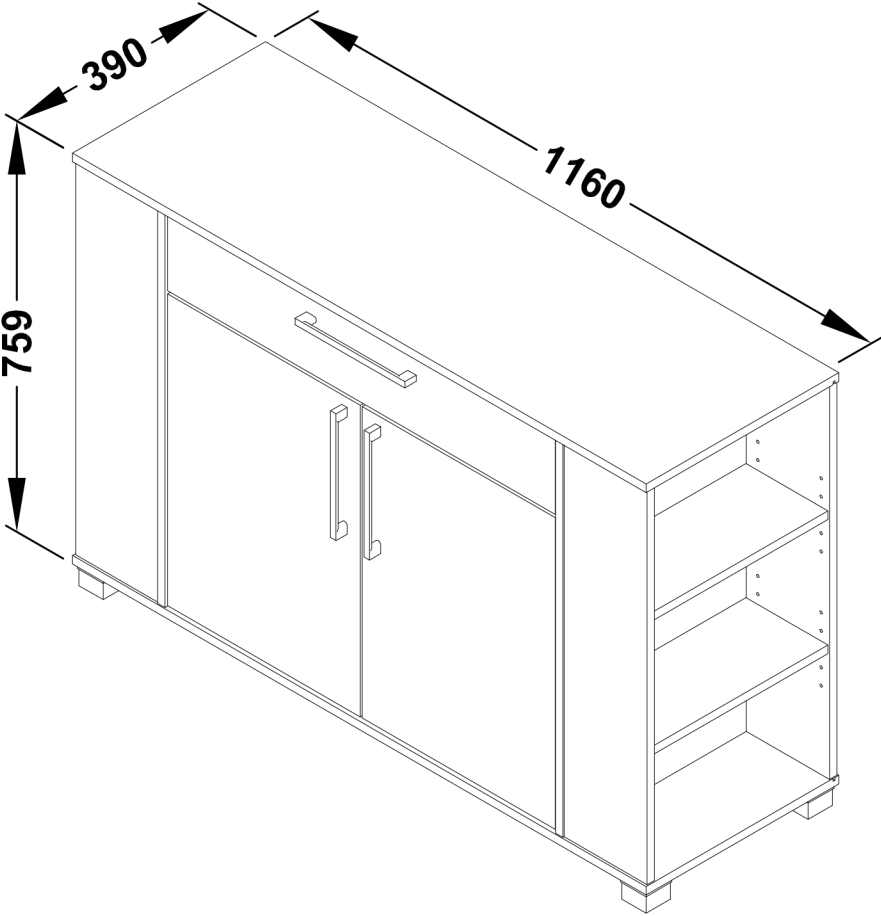

SORRENTO BUFFET WITH DRAWER & CUPBOARD

Tips before you start:

1. Please check that all parts are present before you start the assembly of your furniture.
2. For ease and speed of assembly, we recommend that before you commence each step of the assembly, that you identify all the parts required for that step.
3. For larger items, please ensure that you have sufficient space and people (as indicated on page 1) to assemble your product safely.
4. We recommend that, where possible, all items are assembled near to the area in which they will be placed in use, to avoid moving the product unnecessarily once assembled.
5. For the protection of your furniture, we recommend that the product is placed on a protected surface during assembly to prevent any damage.
6. During assembly please take care not to over-tighten any fittings, as this may damage the product.
7. Always place the product on a flat, steady and stable surface.
8. Do not stand on the product. Do not use the product as a stepladder.
9. This product is intended for indoor, household use only as it is non industrial product.

Care and Maintenance of your Furniture

- ☒ Please periodically check all fittings and re-tighten as necessary.
- ☒ To clean your item, please use a damp cloth and wipe clean.
- ☒ Never allow any kind of liquid to remain on your furniture. Absorption can cause wood to warp or finishes to de-laminate.
- ☒ Please do not place hot item (e.g. hot drinks) directly on to the wood surface.
- ☒ Please do not drag or pull your furniture.

SORRENTO BUFFET WITH DRAWER & CUPBOARD

Tips before you start:

QUICKFIT

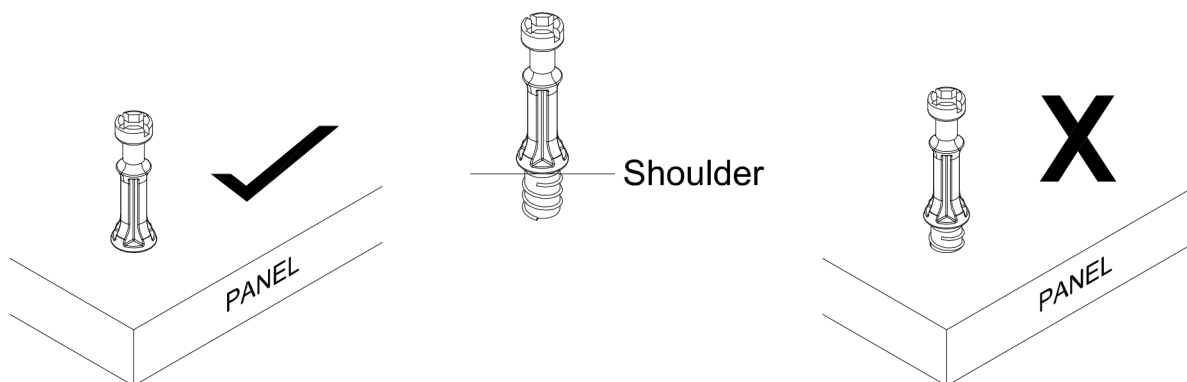

Tighten quickfit until shoulder is flush with panel. Do not overtighten or undertighten.

CAM LOCK

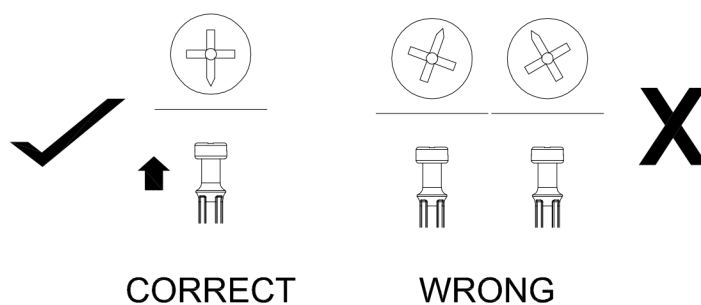

When fitting cam lock, ensure starting position is correct before you insert connecting quickfit.

Quickfit head should be in the centre of the cam lock when the two panels are joined.

Cam lock should be inserted before quickfit.

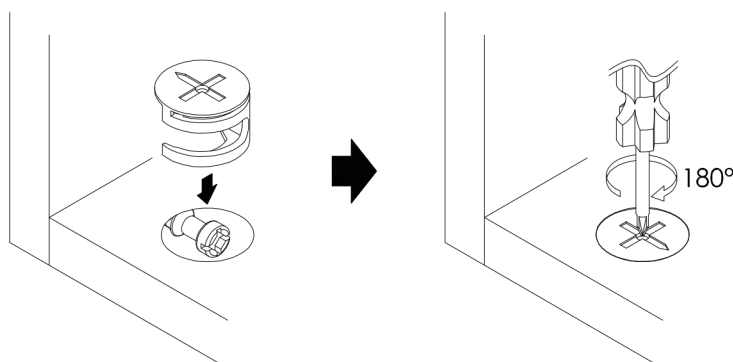

Turn camlock clockwise to tighten.

SORRENTO BUFFET WITH DRAWER & CUPBOARD

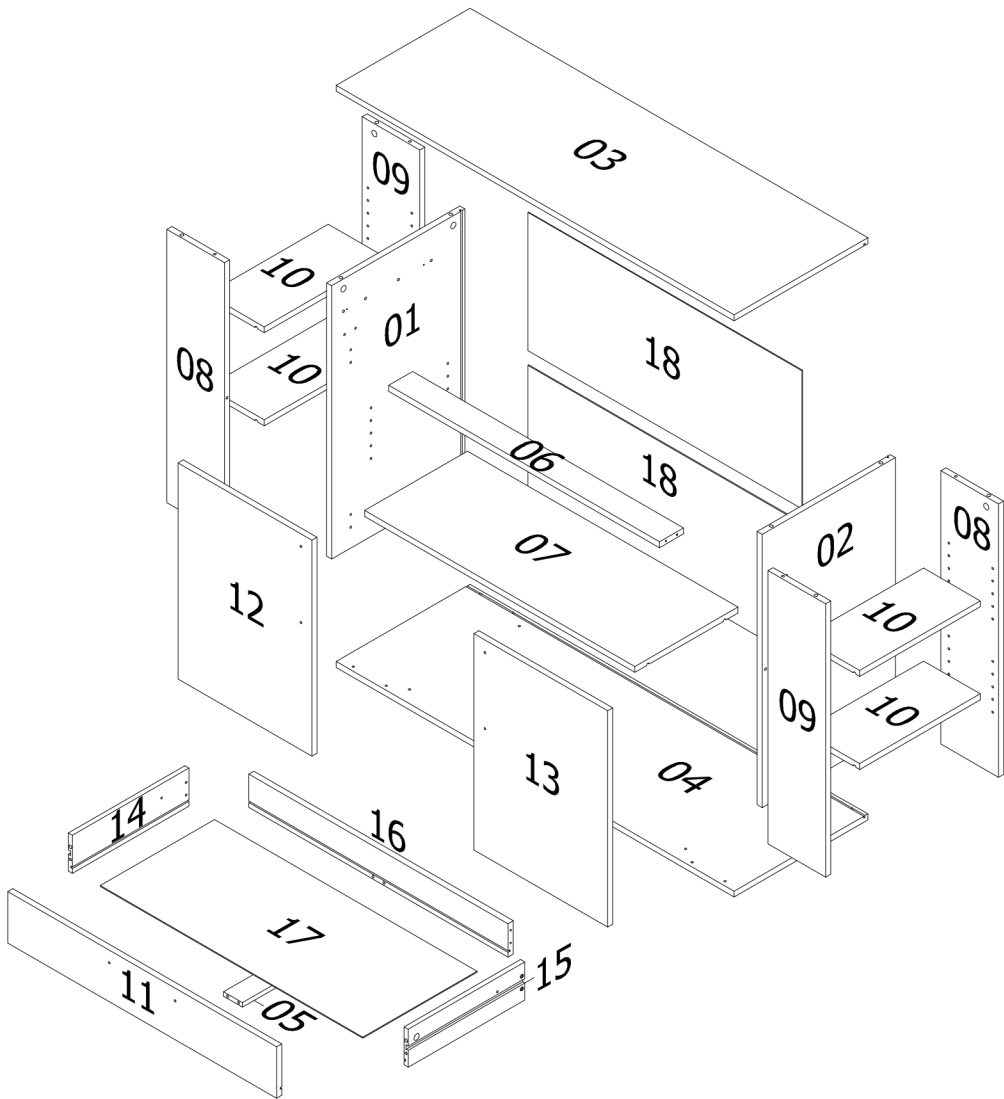

PART LIST:

NO.	PART NAME	QTY	NO.	PART NAME	QTY
1	SIDE PANEL (LEFT)	1	10	DIVIDER PANEL (SIDE)	4
2	SIDE PANEL (RIGHT)	1	11	DRAWER FRONT	1
3	TOP PANEL	1	12	DOOR PANEL (LEFT)	1
4	BOTTOM PANEL	1	13	DOOR PANEL (RIGHT)	1
5	DRAWER BOTTOM SUPPORT	1	14	DRAWER SIDE (LEFT)	1
6	RAIL PANEL	1	15	DRAWER SIDE (RIGHT)	1
7	DIVIDER PANEL (CENTER)	1	16	DRAWER BACK	1
8	FRONT PANEL (LEFT)	2	17	DRAWER BOTTOM	1
9	FRONT PANEL (RIGHT)	2	18	REAR PANEL	2

SORRENTO BUFFET WITH DRAWER & CUPBOARD

HARDWARE LIST

A X16



SCREW
M4.7 X 38MM

B X4

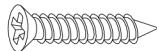

CSK SCREW
M4.5 X 32MM

C X17



CSK SCREW
M3.5 X 15MM

D X8



EURO SCREW
M6 X 13MM

E X10

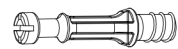

BOLT-9607 PARALEL
NECK DOWEL 24 X 8.5

F X10



CAM-9642 CAM
3000 12/13MM

G X14



WOOD DOWEL
Ø6 X 20MM

H X2



PLASTIC DRAWER
RUNNER WITH STOPPER
(290MM)

J X20



METAL ADJUSTABLE
SHELF STUD

K X1



H. PROFILE (789MM)

L X3



192MM PVC U SHAPE
HANDLE (1PC) WITH
SCREW (M3.5 X
25MM=2PCS)

M X4

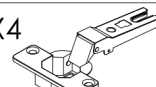

METAL HINGES
(7/8")W/SPRING

M2 X4

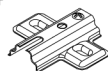

HINGES PLATE

N X5



PLASTIC SQUARE
LEG(H39MM) =1PC
WITH SCREW(M3.5 X
15)=4PCS

P X4



BACKPLY STOPPER

Q X4



PLASTIC HOLE PLUG
(Ø12MM)

R X4



ROUND STICKER
(Ø18MM)

S X1

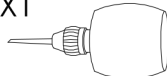

GLUE

T X1



WEBBING TAPE
1.2 X 12 X 145MM

SORRENTO BUFFET WITH DRAWER & CUPBOARD

STEP 1

Using glue (S) insert dowel (G) into pieces (5 , 8 , 9 , 14 & 15) as shown.

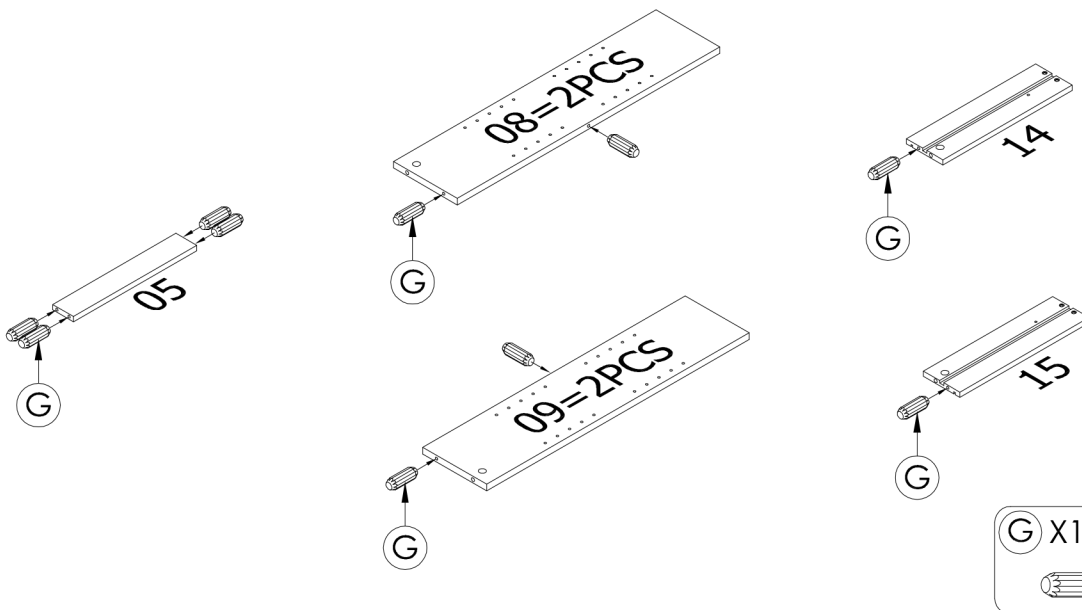
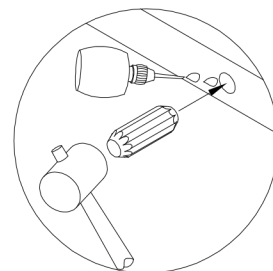

STEP 2

Take both panels (3 & 11) , using a drill on low speed / torque or a phillips head screw driver CAM PINS (E) as shown.

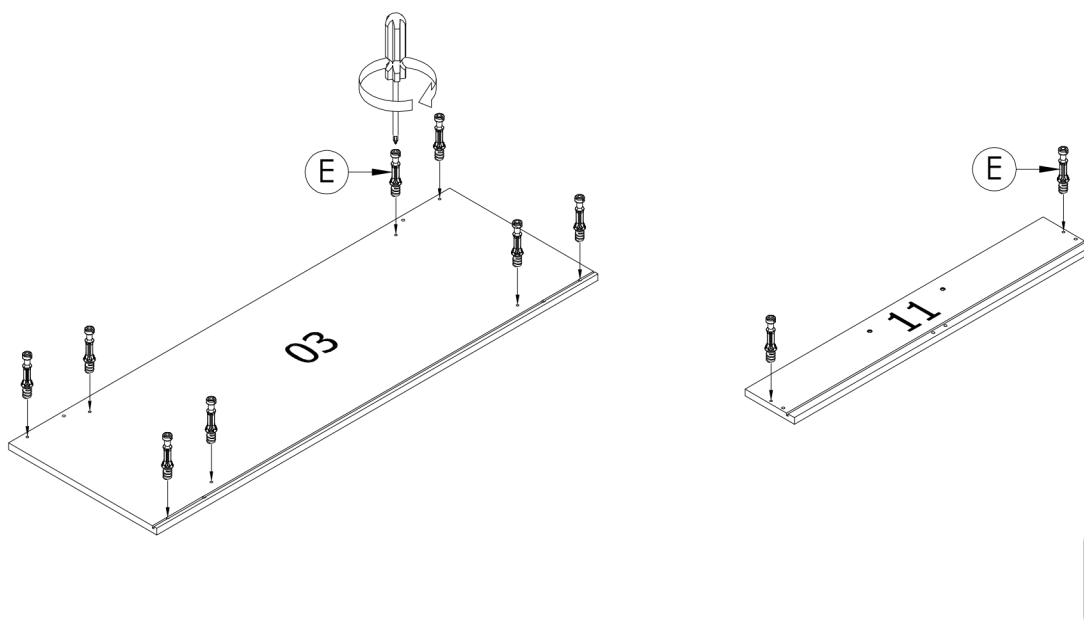

SORRENTO BUFFET WITH DRAWER & CUPBOARD

STEP 3

Attach drawer sides (14 & 15) to drawer backs (16) using 32mm screws (B).

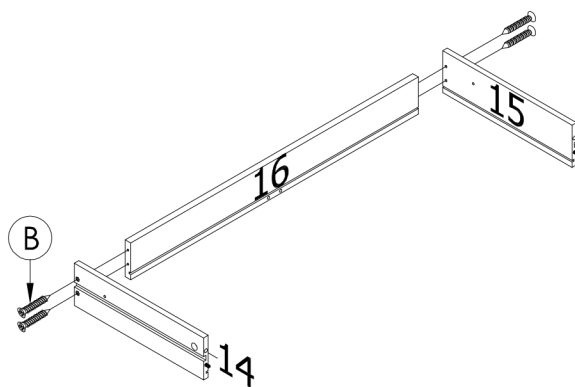

B X4

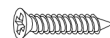

STEP 4

Using glue (S) attach panels (05) to drawer backs (16) .

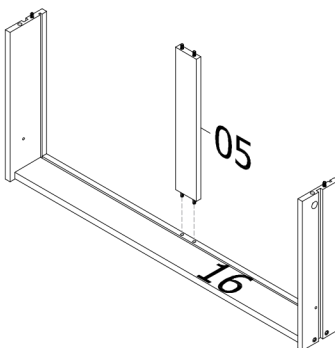

S

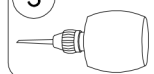

SORRENTO BUFFET WITH DRAWER & CUPBOARD

STEP 5

Slot drawer bottoms (17) into drawer frames.

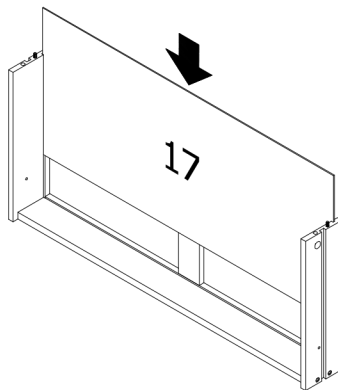

STEP 6

Attach drawer front (11) to side of the drawer using the glue (S).

Then insert the 13mm CAM LOCK (F) into holes on the sides of the drawer as shown.

Turn CAM LOCK using screw driver until they tighten into place.

NOTE: Don't over tighten as this may cause damage.

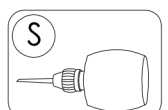
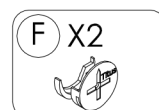
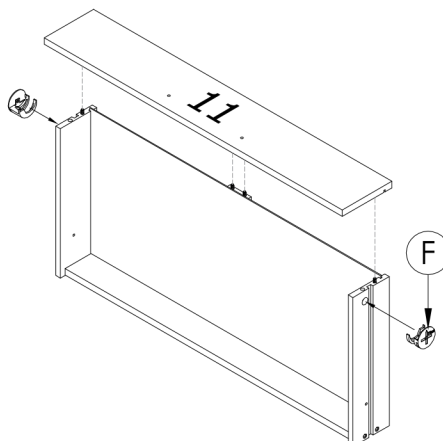
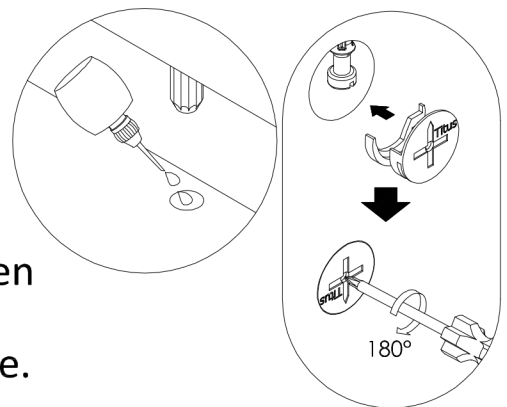

SORRENTO BUFFET WITH DRAWER & CUPBOARD

STEP 7

Affix the handle (L) to the drawer front (11) with the 25mm screw.

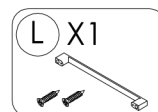
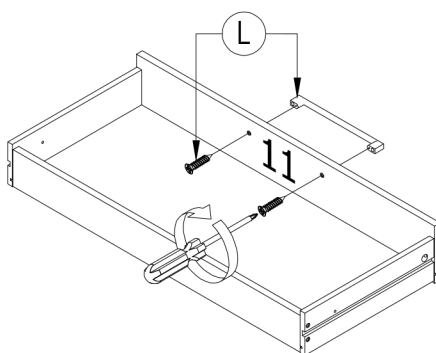

STEP 8

Attach plastic drawer runner (H) to panels (1 & 2) using screw 15mm (C) as shown.

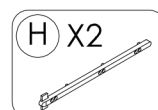
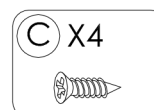
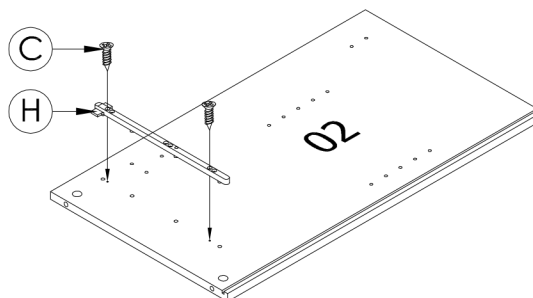
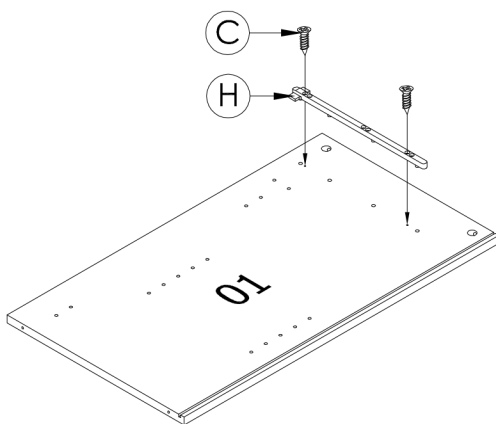
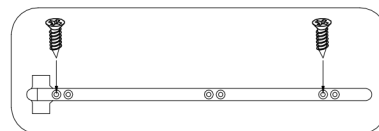

SORRENTO BUFFET WITH DRAWER & CUPBOARD

STEP 9

Affix the hinges plate (M2) with screw (D) to the side panel (1 & 2) .

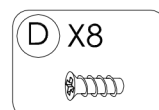
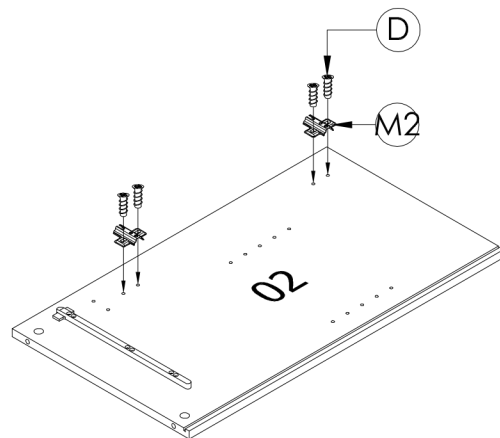
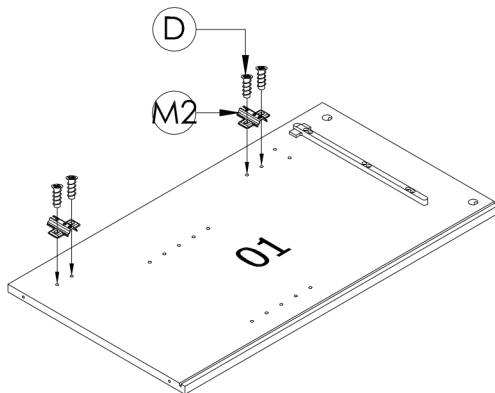
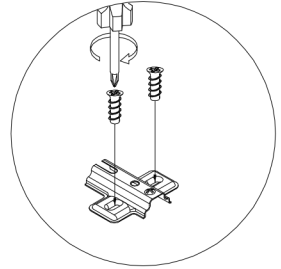
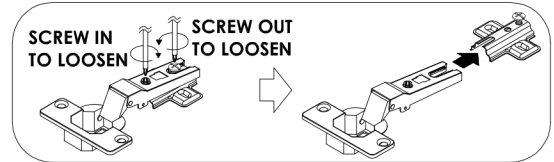

SORRENTO BUFFET WITH DRAWER & CUPBOARD

STEP 10

Lay panel (1 & 2) flat (on clean dry surface) with plastic drawer runner facing up.

Attach panel (1 & 2) to rail panel (6) using 38mm screw (A) .

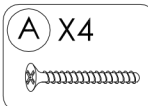
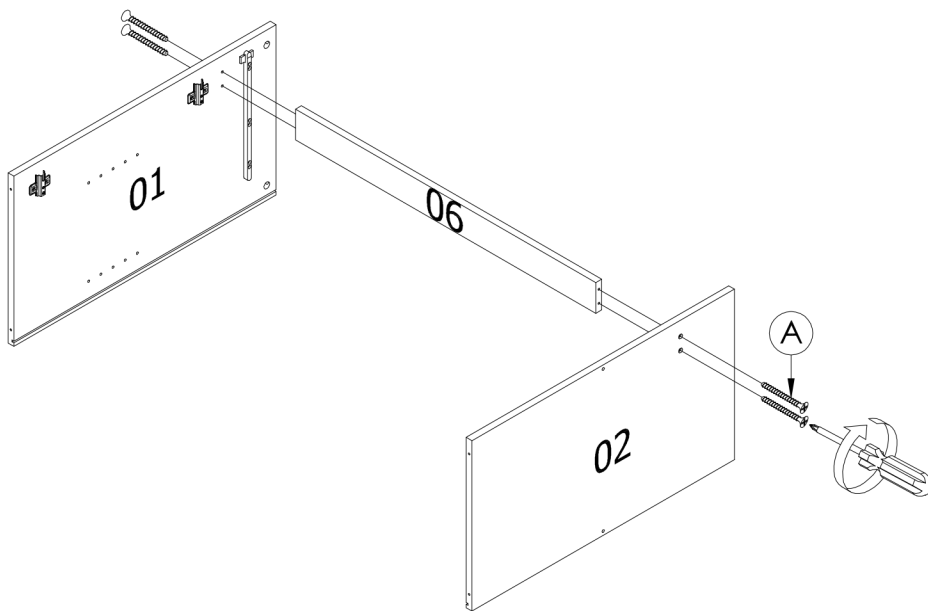

STEP 11

Then attach plastic hole plug (Q) to top of the screw.

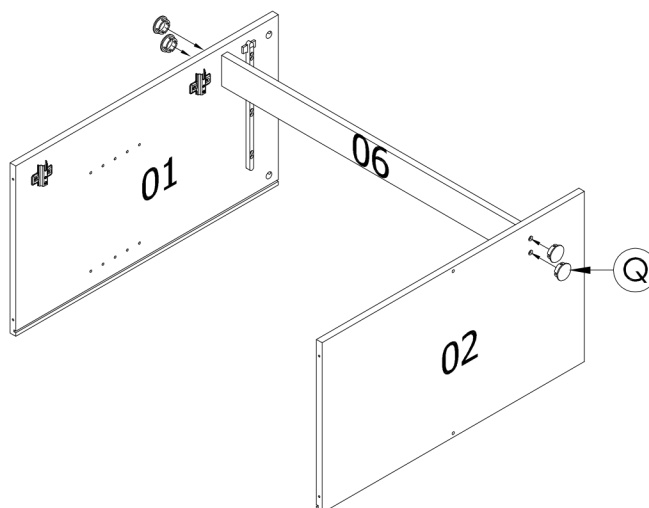
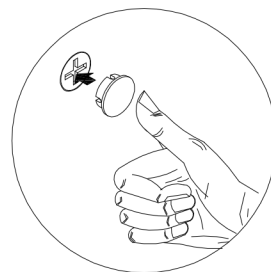

SORRENTO BUFFET WITH DRAWER & CUPBOARD

STEP 12

Using 38mm screws (A) attach panel 4 to panel (1 & 2) as shown.

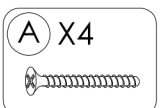
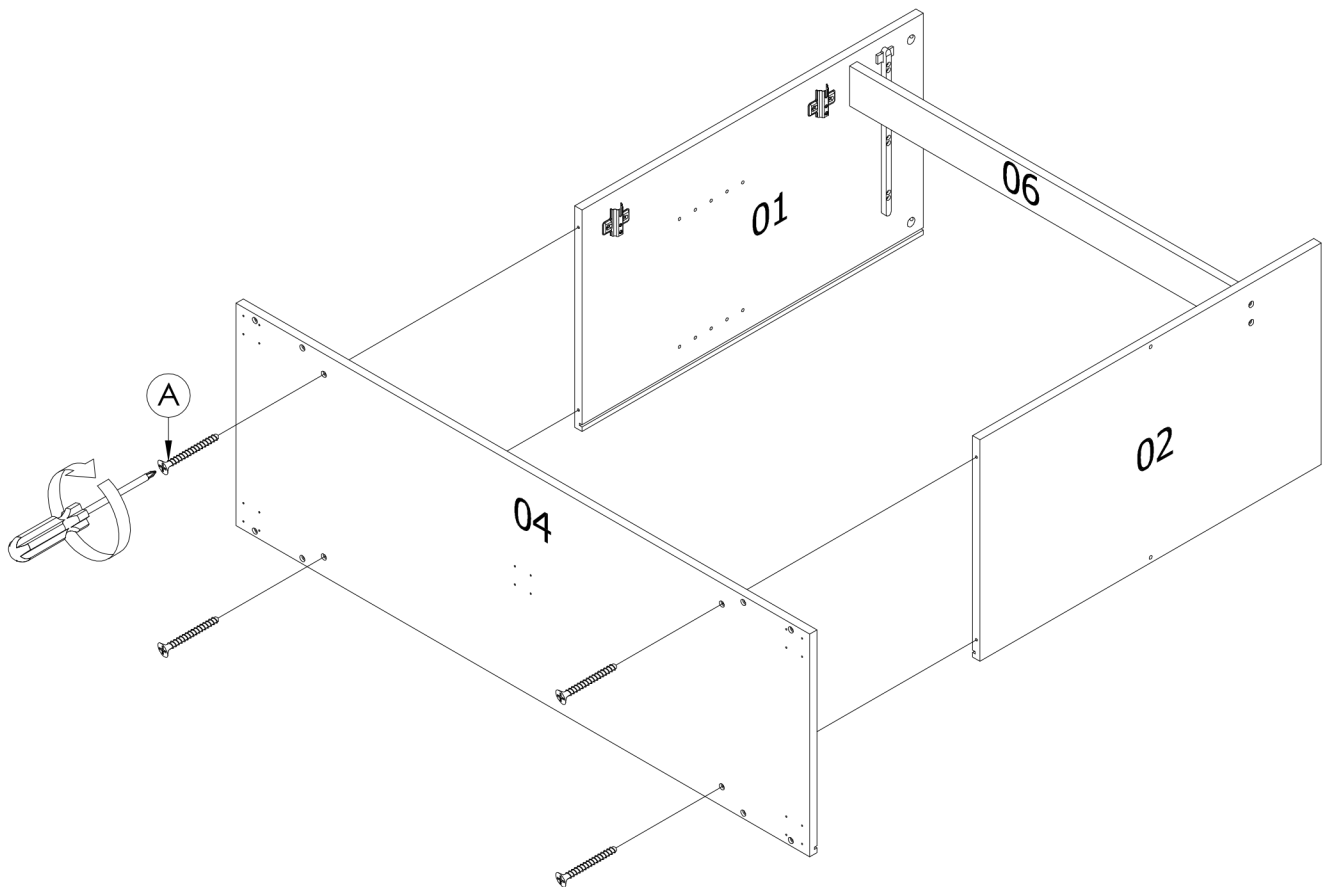

SORRENTO BUFFET WITH DRAWER & CUPBOARD

STEP 13

Attach panel (8 & 9) with glue (S) to side panel.
Then using 38mm screw (A) to attach panel (8 & 9) to
panel (4) as shown.

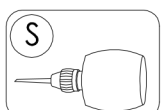
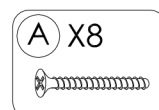
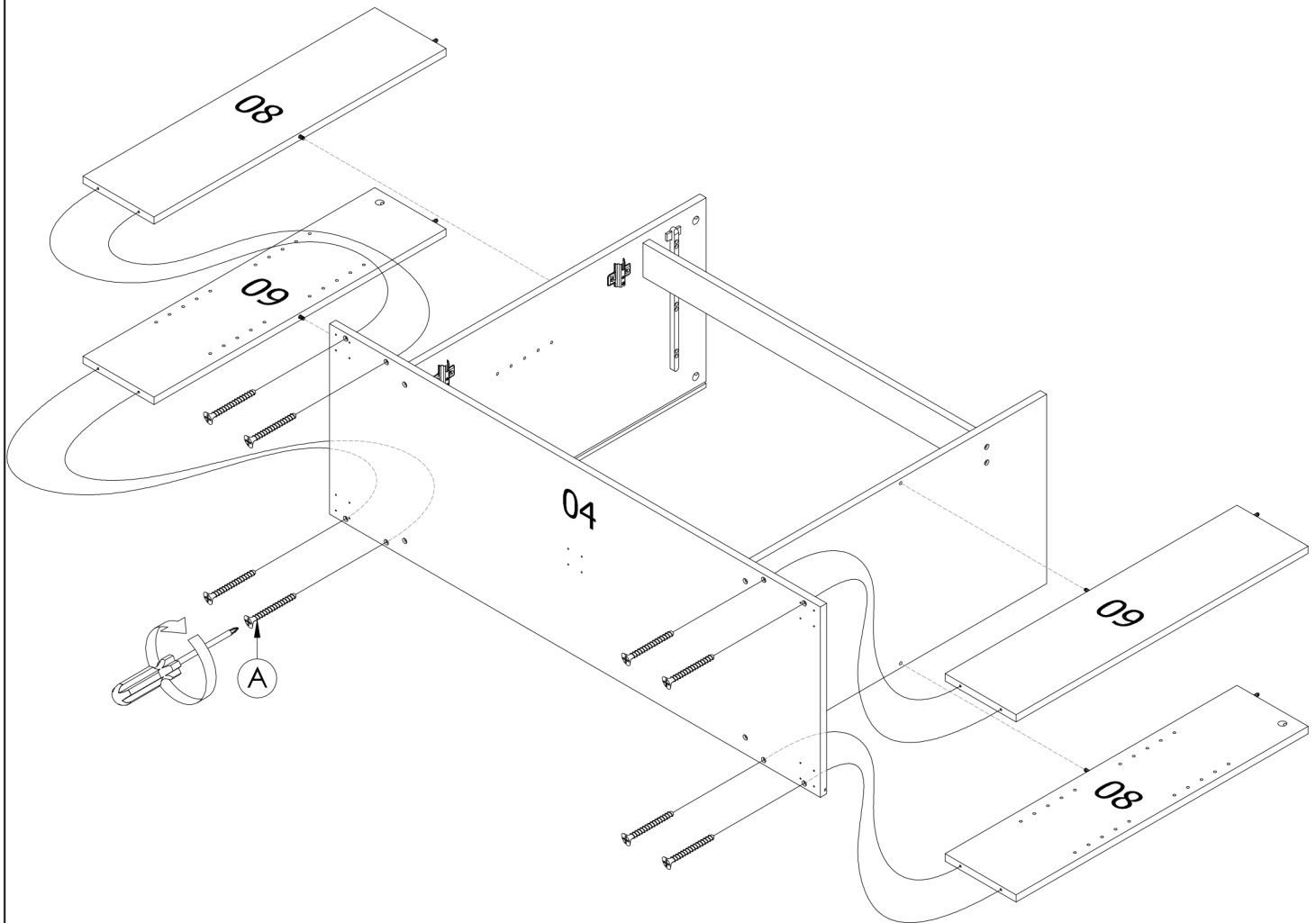
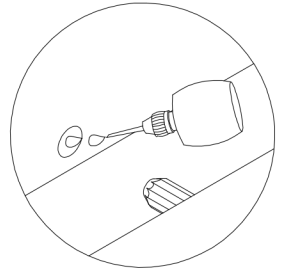

SORRENTO BUFFET WITH DRAWER & CUPBOARD

STEP 14

Attach plastic square leg (N) to bottom of chest as shown.

STEP 1

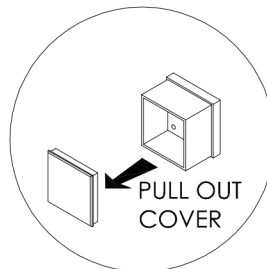

STEP 2

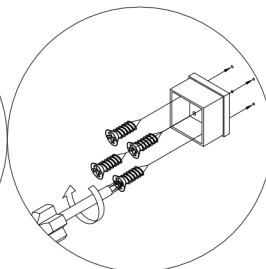

STEP 3

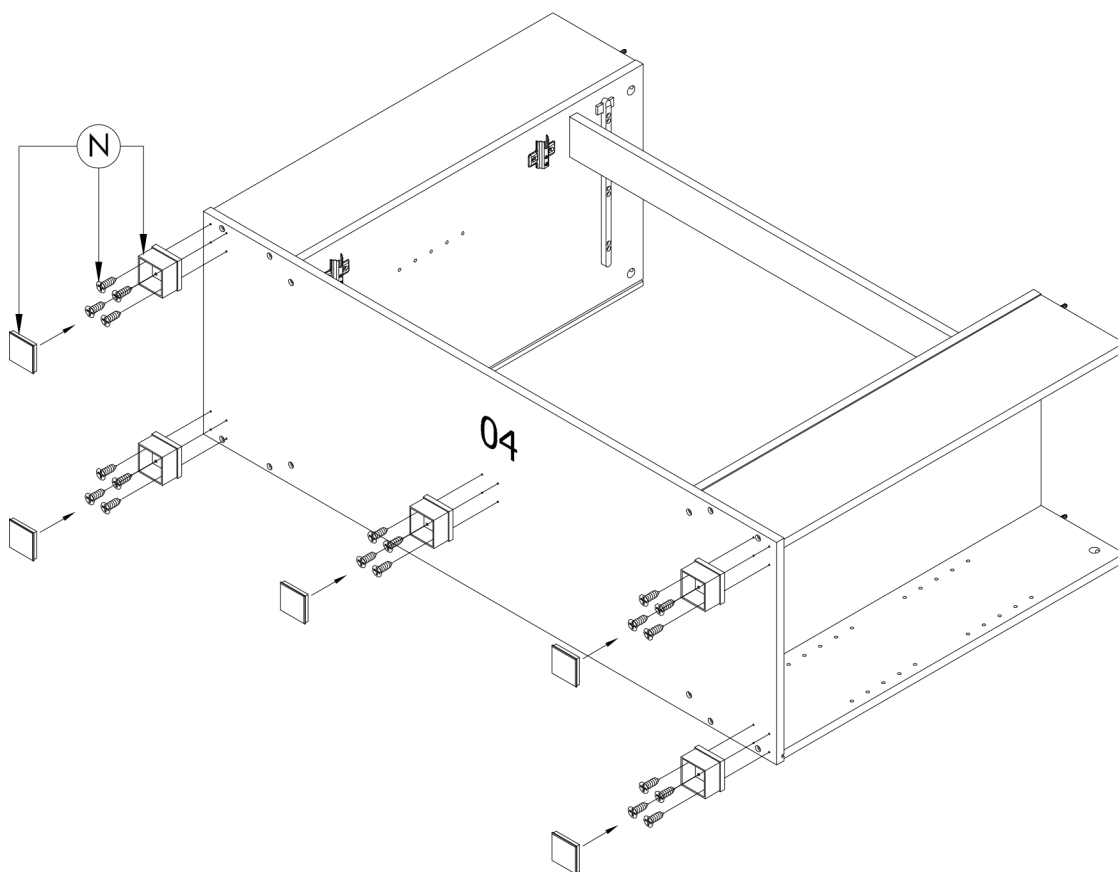
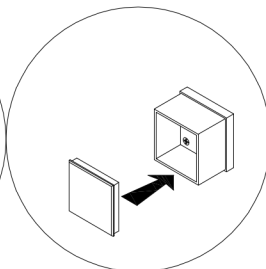

(N) X5

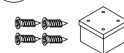

SORRENTO BUFFET WITH DRAWER & CUPBOARD

STEP 15

Slot panel (18) to frame by insert H-Profile (K) in between.

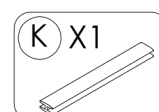
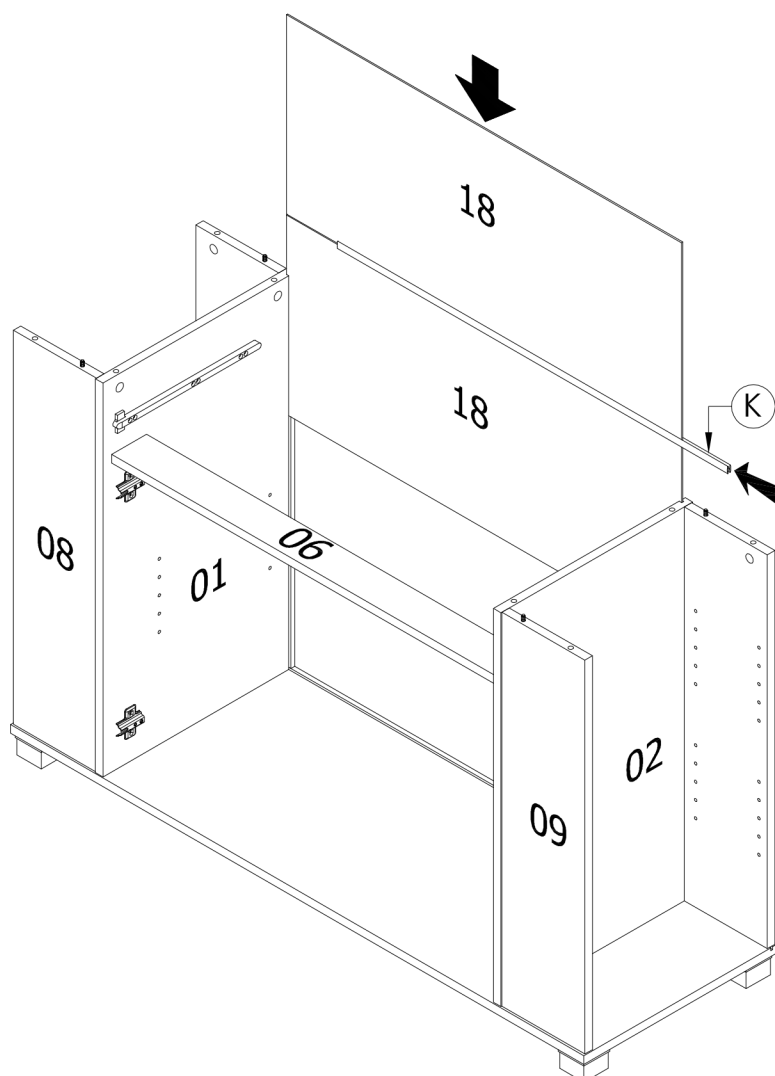
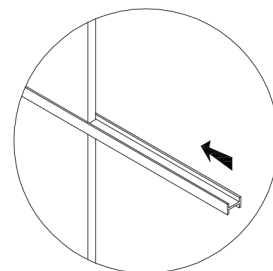

SORRENTO BUFFET WITH DRAWER & CUPBOARD

STEP 16

Using glue (S) attach top of the tall chest to frame.
Fasten into place using
CAM LOCKS (F) as shown.
Attach 18mm round sticker (R) to top
of the cam locks as shown.

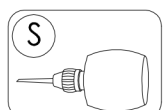
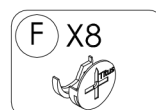
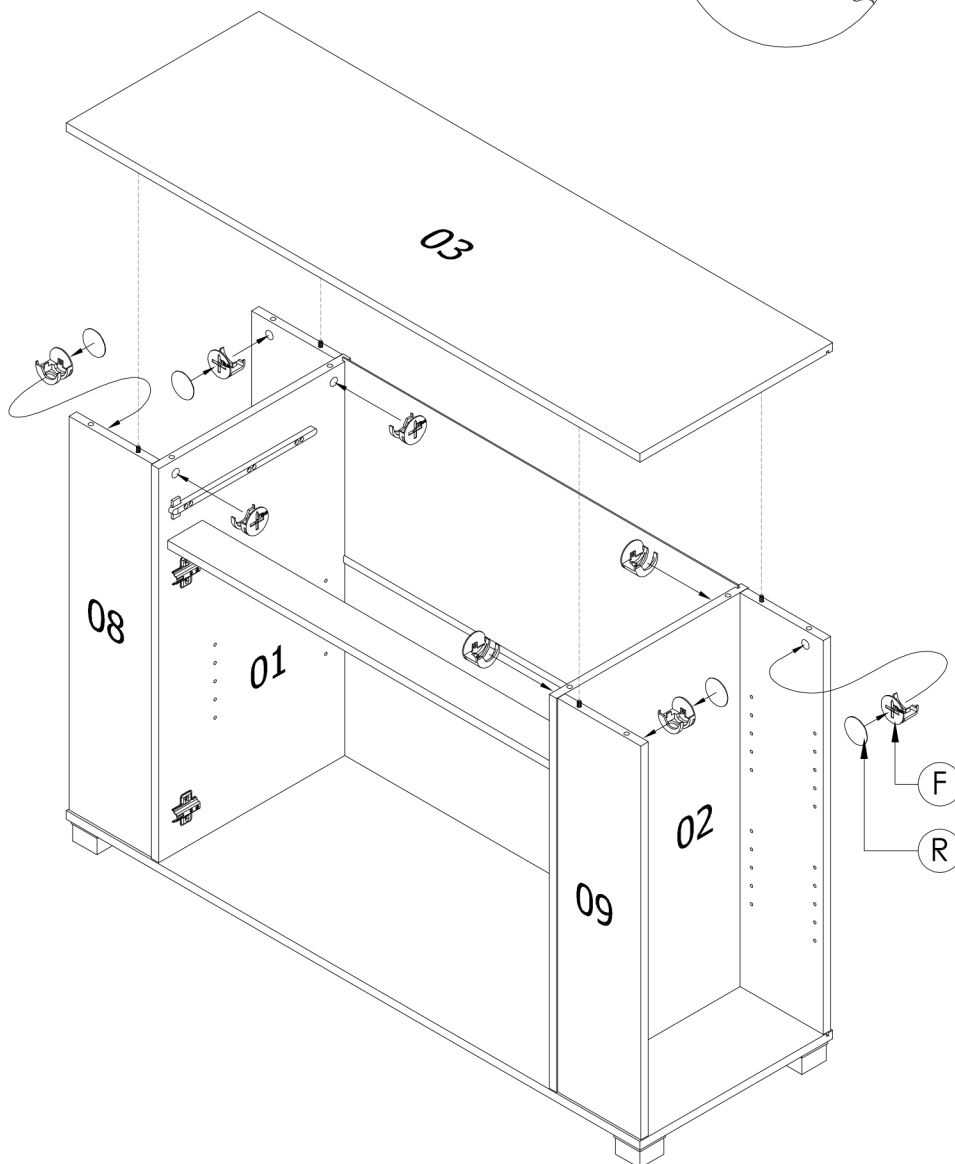
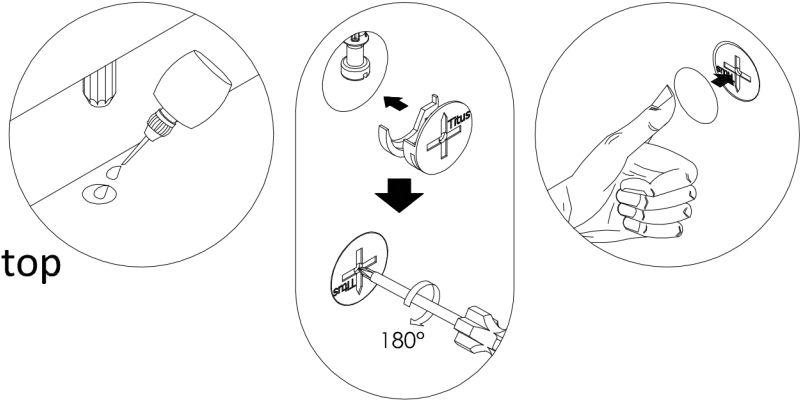

SORRENTO BUFFET WITH DRAWER & CUPBOARD

STEP 17

Slot the shelf panel (7 & 10) into the body as shown.
After fix in the metal adjustable shelf stud (J) into the holes.

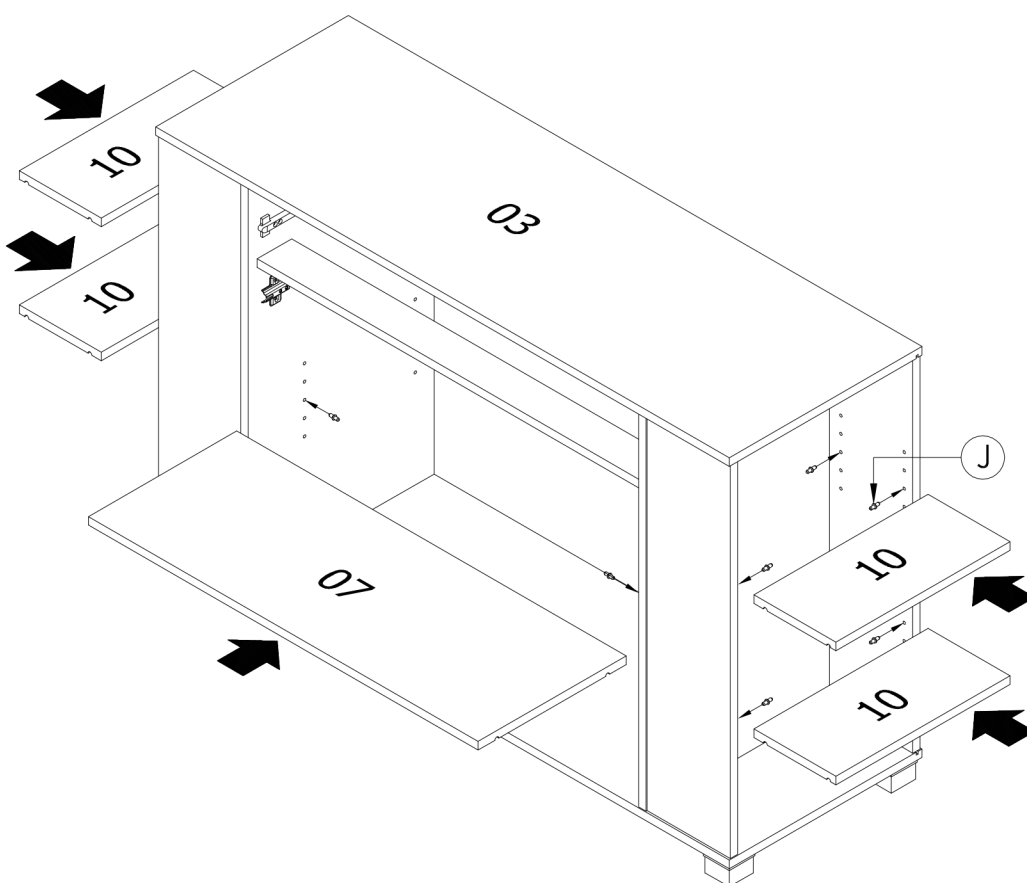
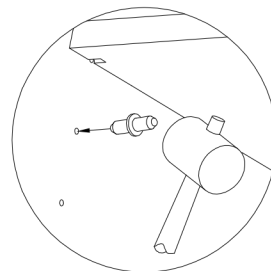

J X20



SORRENTO BUFFET WITH DRAWER & CUPBOARD

STEP 18

Affix the hinges (M1) with screw (C) and to the door panel (12 & 13).

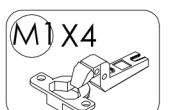
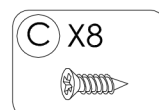
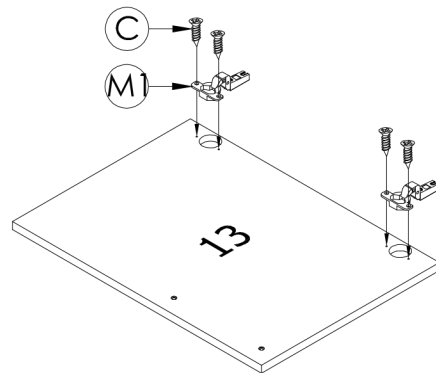
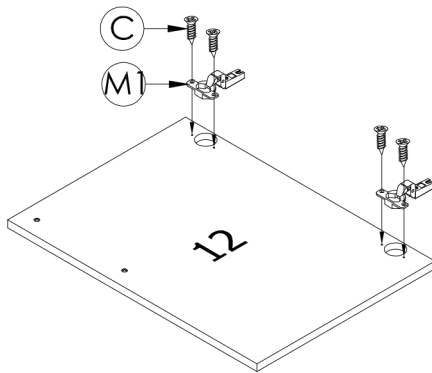
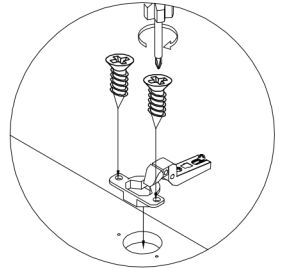

SORRENTO BUFFET WITH DRAWER & CUPBOARD

STEP 19

Attach the handle (L) to door panel (12) as shown. Then attach the door panel (12) to the side panel (1).

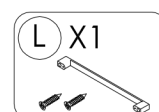
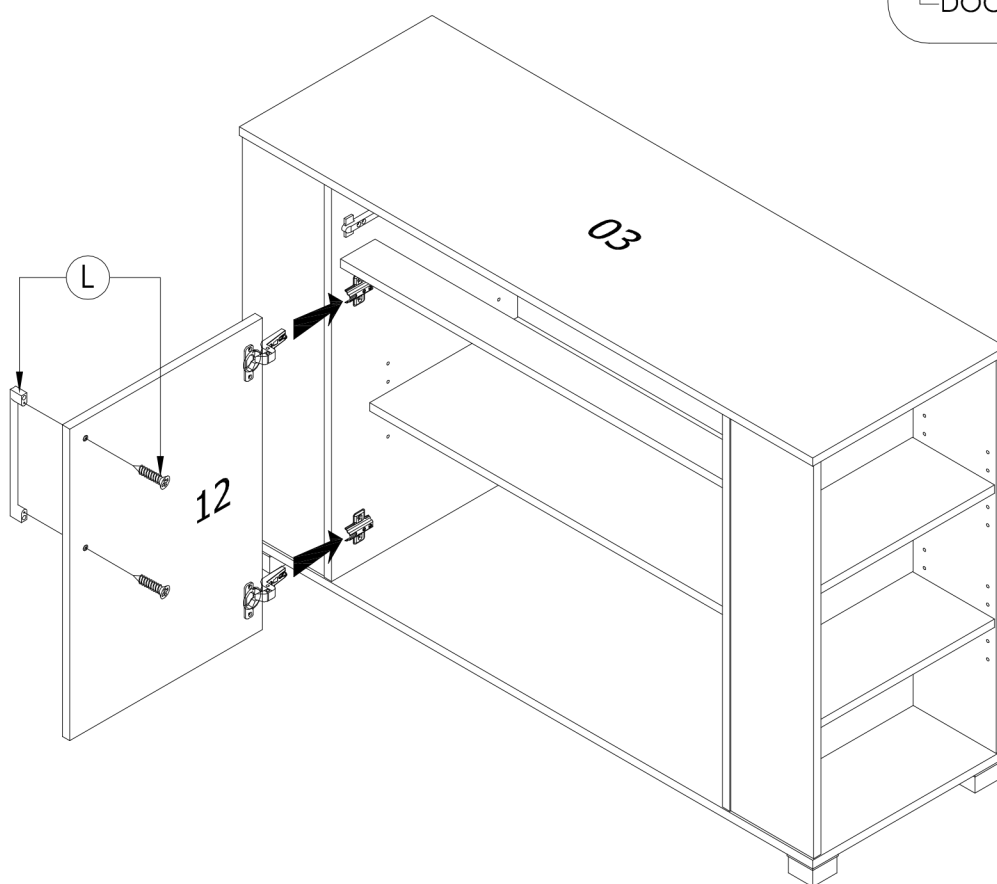
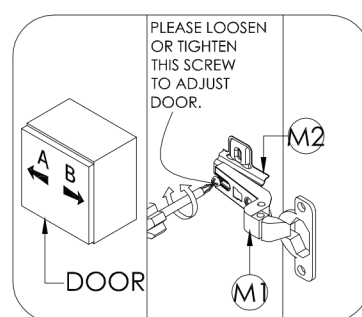
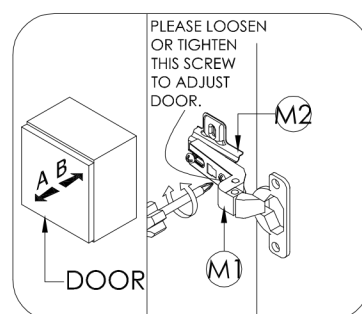
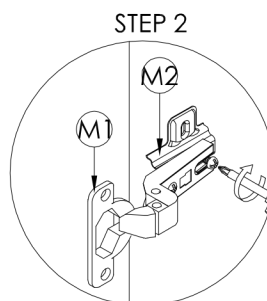
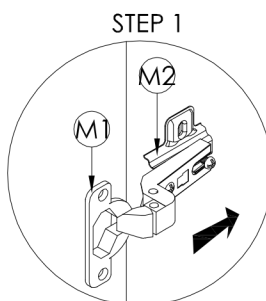

SORRENTO BUFFET WITH DRAWER & CUPBOARD

STEP 20

Attach the handle (L) to door panel (13) as shown. Then attach the door panel (13) to the side panel (2).

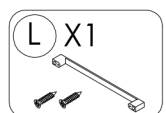
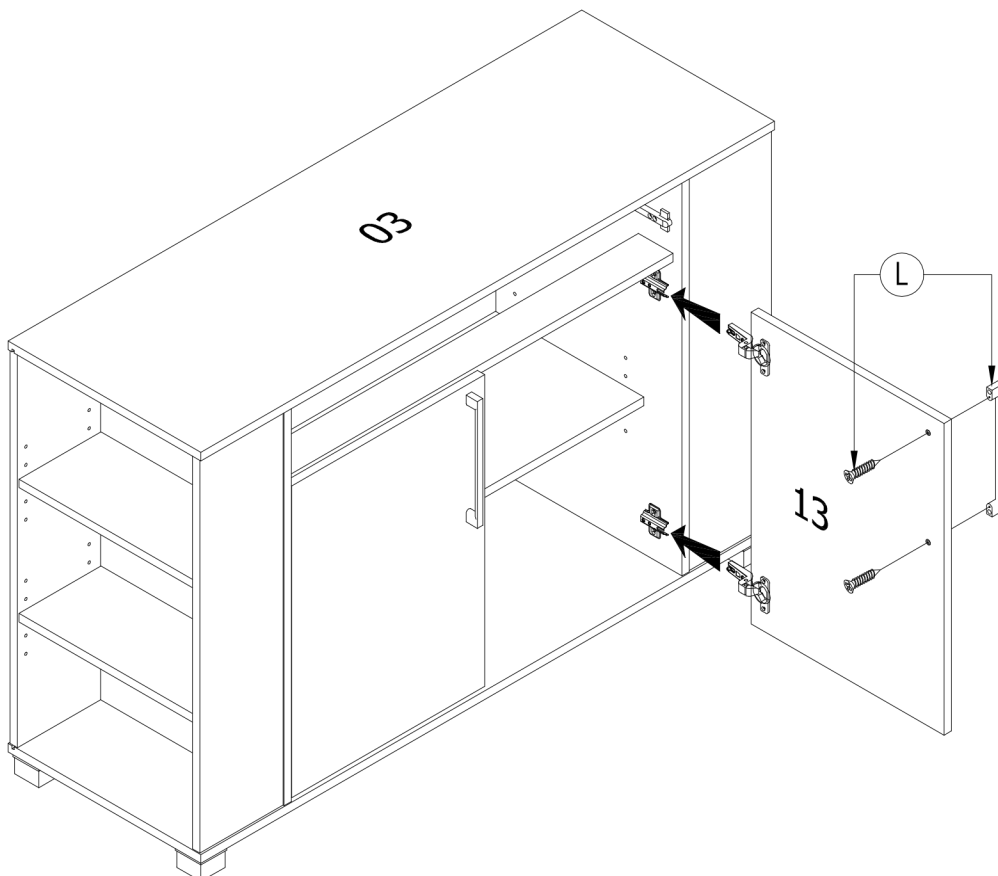
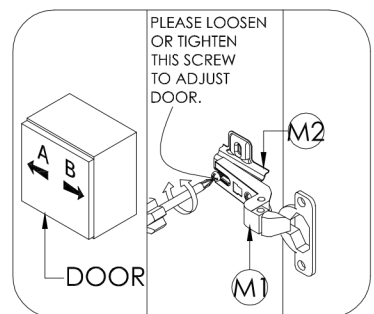
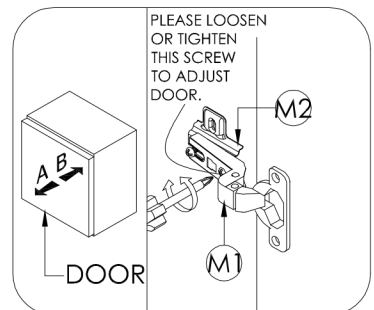
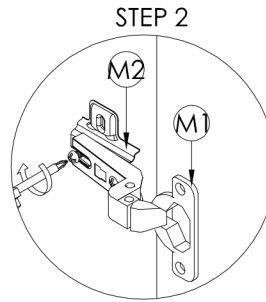
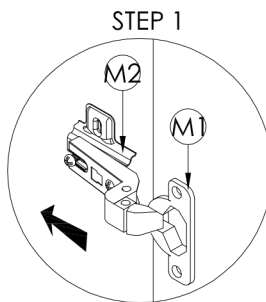

SORRENTO BUFFET WITH DRAWER & CUPBOARD

STEP 21

Insert the drawer to the cabinet and attach using plastic drawer runner stopper (H) into the drill hole at both drawer side panel as shown.

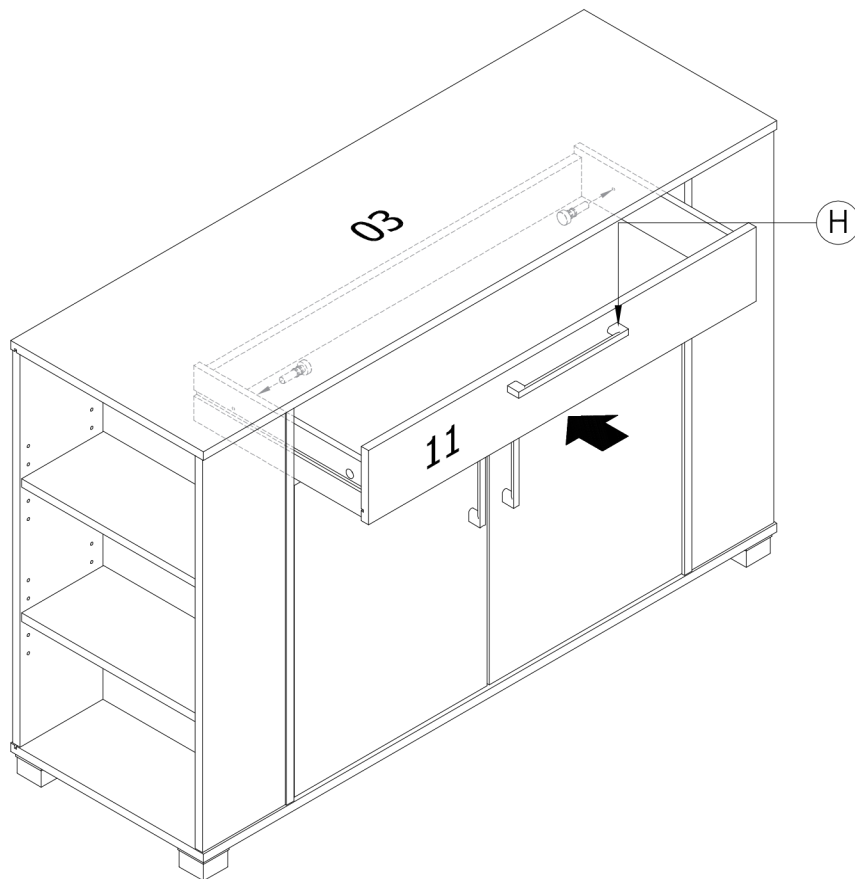
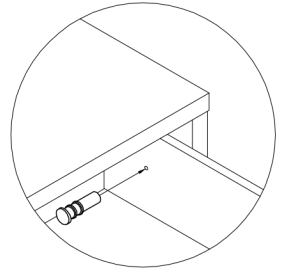

(H) X2



SORRENTO BUFFET WITH DRAWER & CUPBOARD

STEP 22

Attach the backply stoppers (P) to the rear panel (18) using 15mm screw (C). Then attach webbing tape (T) on top panel (3) using M3.5 x 15mm screw (C).

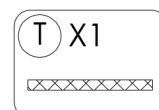
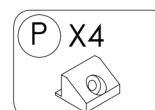
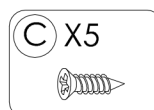
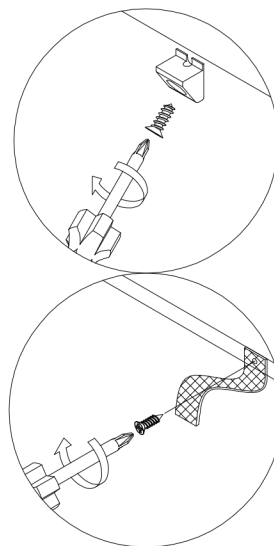
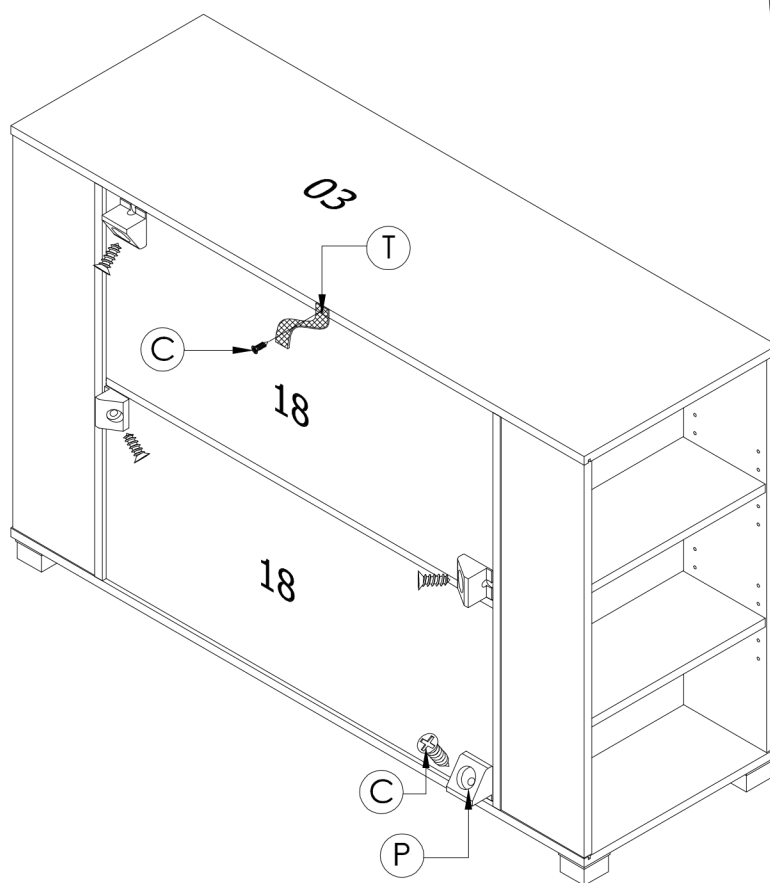

SORRENTO BUFFET WITH DRAWER & CUPBOARD

ASSEMBLY IS COMPLETE

NOTE :

WALL PLUG & SCREW ARE NOT SUPPLIED WITH THIS PRODUCT AS DIFFERENT WALL MATERIALS REQUIRE DIFFERENT TYPES OF FIXING HARDWARE & YOU MUST USE SUITABLE FIXING HARDWARE FOR TYPE OF WALL YOU INTEND TO MOUNT THIS PRODUCT TO WALL.

