

Model : IQ 7522 R4

Product Size : 940mm x 1930mm (Base Int Size)

Thank you for purchasing this product. Before starting assembly we suggest you spend a short time reading through this leaflet, then follow the simple step by step guide. Two people are needed to assemble this product.

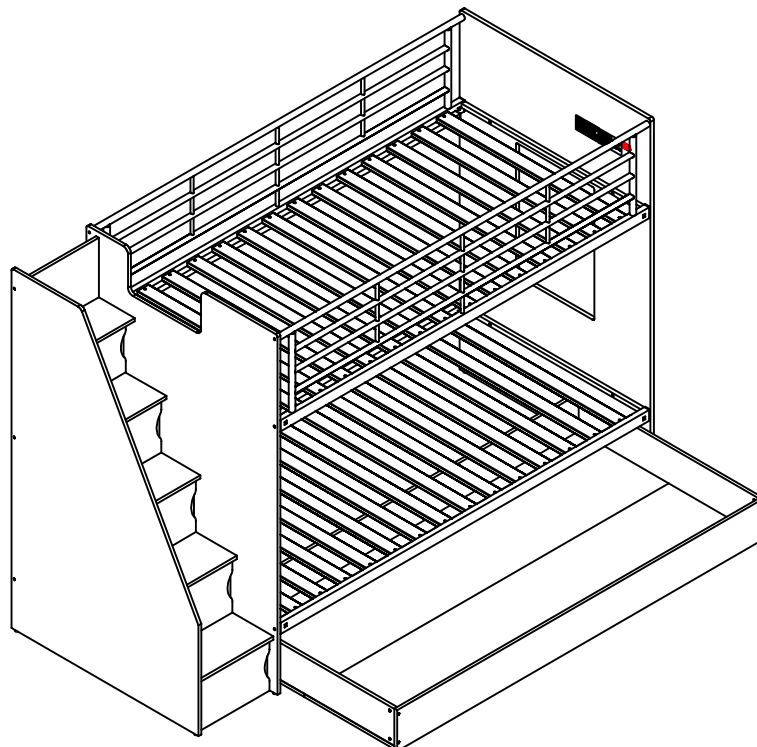
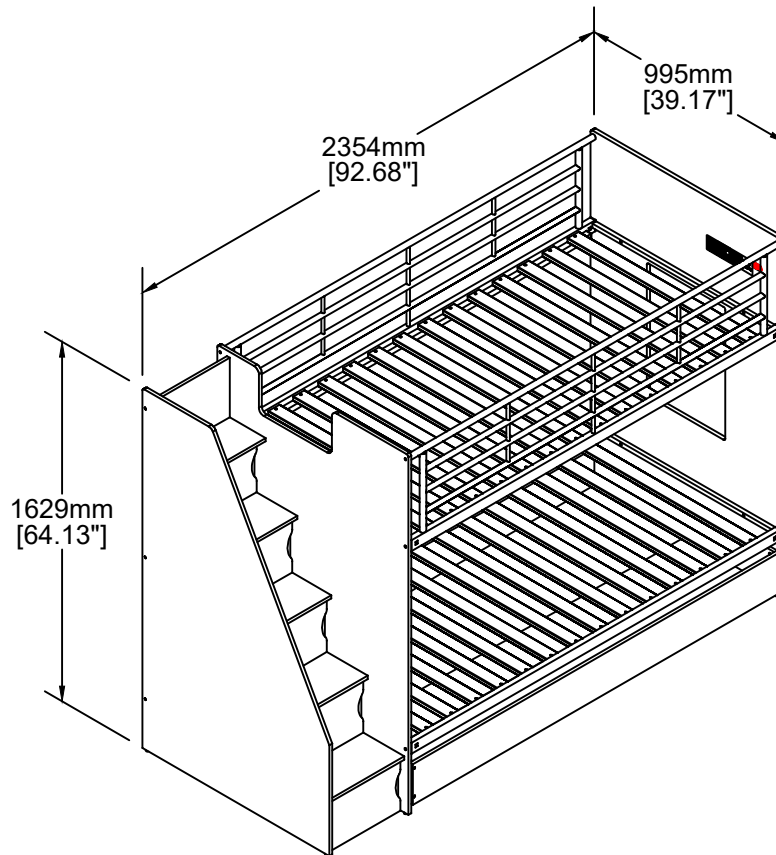

Model : IQ 7522 R4

Product Size : 940mm x 1930mm (Base Int Size)

TOP TIPS BEFORE YOU START !

IMPORTANT- READ CAREFULLY- RETAIN FOR FUTURE REFERENCE

1. Please check that all parts & hardware are present before you start the assembly of your furniture.
2. For ease and speed of assembly, we recommend that before you commence each step of the assembly, Please identify all the parts required for that step.
3. We recommend that where possible, all items are assembled near to the area in which they will be placed in use, to Avoid moving the product unnecessarily once assembled.
4. For the protection of your furniture, particularly items of high gloss finish, we recommend that the product is placed on a Protected surface during assembly to prevent any damage.
6. During assembly please take care not to over-tighten any fittings, as this may damage the product.

CARE AND MAINTENANCE OF YOUR FURNITURE

- Please periodically check all fittings and re-tighten as necessary.
- To clean your item, please use a damp cloth and wipe clean.
- Never allow any kind of liquid to remain on your furniture. Absorption can cause wood to warp or finishes to de-laminate.
- Please do not place hot items (e.g hot drinks) directly on the wood surface.
- Please do not drag or pull your furniture.

IMPORTANT INFORMATION

1. Thickness of mattress should not exceed 228mm.
2. Children should be discouraged from playing on top of this bunk bed.
3. The bunk bed should be checked periodically by the owner to ensure that the guardrail, ladder, and other components are maintained in the correct position and state of repair and that all connectors are tight.
4. A bunk bed is not to be placed near a ceiling fan unless the distance between the closest points on the ceiling fan bunk Bed is at least 2 metres.
5. Use guardrails on both sides of upper bunk.
6. Prohibit horseplay on or under bed(s).
7. Prohibit more than one person on upper bunk.
8. Use Ladder for entering and leaving upper bunk.
9. If the bunk bed will be placed next to the wall, the guardrail that runs the full length of the bed should be placed against The wall to prevent entrapment between the bed and the wall.

STRANGULATION HAZARD:

10. Never attach or hang items to any part of the bunk bed that are not designed for use with the bed for example, but not limited to hook, belt and jump ropes.

Guide To Assembly

Model : IQ 7522 R4

Tools Required For Assembly

Phillips Screw Driver

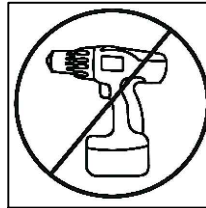
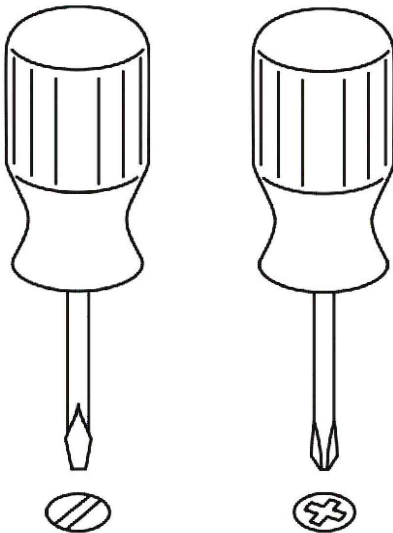

DO NOT USE POWER TOOLS TO ASSEMBLE THIS PRODUCT. USE OF POWER TOOLS WILL INVALIDATE ANY CLAIM AND MAY DAMAGE THIS PRODUCT MAKING IT UNSAFE.

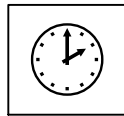

Approximately 3 hour

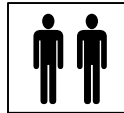

2 People Required

Rubber Hammer

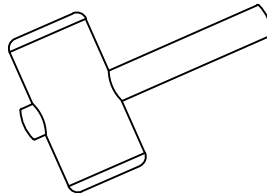

Tape Measure

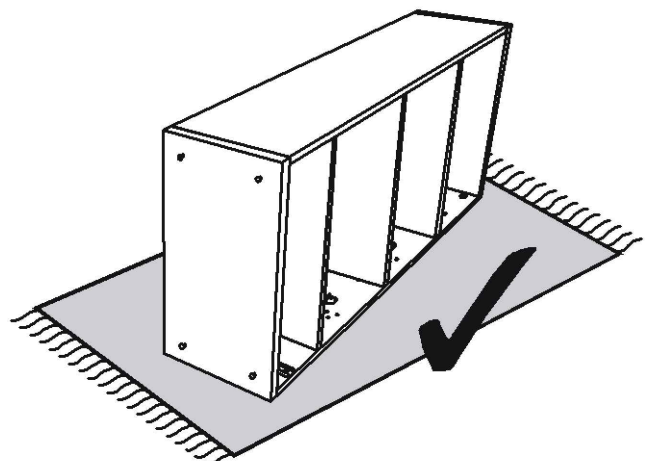
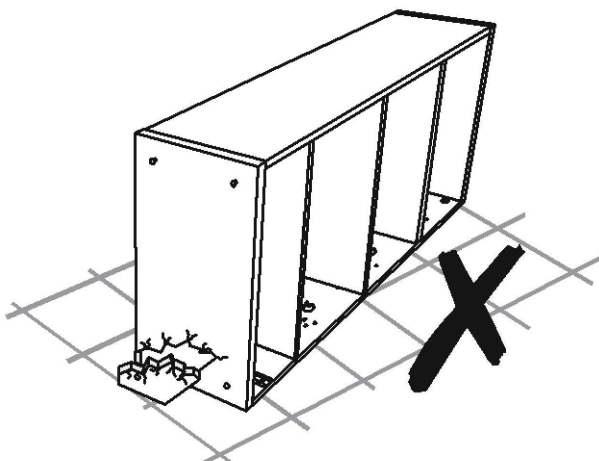
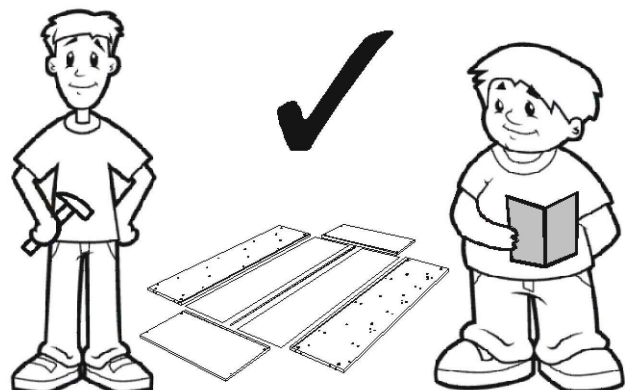
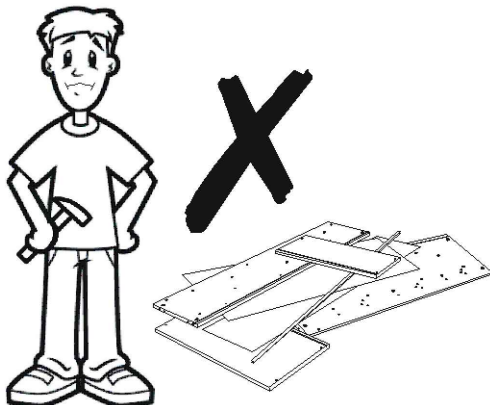
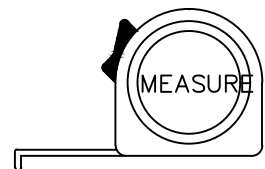

Part List

Model : IQ 7522 R4

Carton 1 of 5			Carton 3 of 5		
No.	Part Name	Pcs	No.	Part Name	Pcs
16	Ladder Bottom Panel	1	33	Ladder Left Panel	1
17	Left Panel (1st Step)	1	34	Ladder Door	1
18	Right Panel (1st Step)	1	35	Ladder Door	4
19	Ladder Step (1st Step)	1		LVL Slats	14
20	Left Panel (2nd Step)	1	Carton 4 of 5		
21	Right Panel (2nd Step)	1			
22	Ladder Step (2nd Step)	1	06	Side Rail	2
23	Left Panel (3rd Step)	1	07	Guardrail	2
24	Right Panel (3rd Step)	1	08	Support Rail	4
25	Ladder Step (3rd Step)	1	10	Back Support Rail	3
26	Left Panel (4th Step)	1		LVL Slats	14
27	Right Panel (4th Step)	1	Assembly Instructions + Fitting List		
28	Ladder Step (4th Step)	1			
29	Left Panel (5th Step)	1			
30	Right Panel (5th Step)	1	Carton 5 of 5		
31	Ladder Step (5th Step)	1	01	Bottom Panel (Back Trundle)	1
32	Ladder Back Panel	1	02	Back Panel (Trundle)	1
Carton 2 of 5			03	Right & Left Panel (Trundle)	2
			04	Bottom Panel (Front Trundle)	1
14	Right End Panel	1	05	Front Panel (Trundle)	1
15	Ladder Right Panel	1			

Part List

Model : IQ 7522 R4

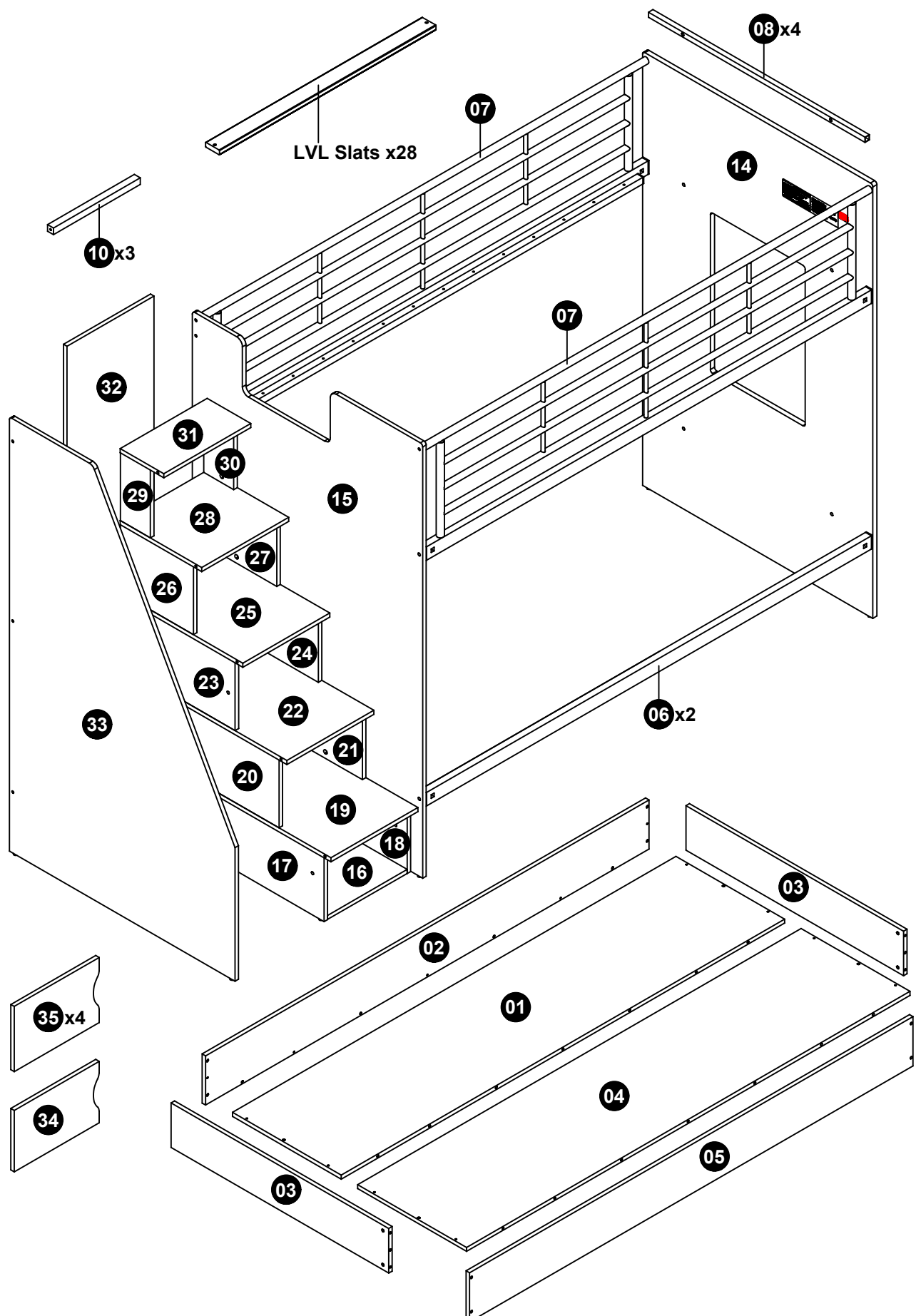

Fitting List

Model : IQ 7522 R4

Carton 4 of 5

Fitting List

No.	Part Name		Pcs
A	Cam Stud (small)		45
B	Cam		48
C	M8 x 25mm Wood Dowel		78
D	45mm Chipboard Screw		18
E	14mm Chipboard Screw		64
F	Hinges Arm		10 set
G	40mm White Nylon Caster		12
H	M6 Round Nut		4
J	M8 Square Nut		8
K	M8 x 60mm Allen Bolt		8
L	M6 x 50mm Allen Bolt		4
M	M6 x 40mm Allen Bolt		10
N	M6 x 30mm Allen Bolt		64
P	M6 x 25mm Allen Bolt		10
Q	M6 Allen Wrench		1
R	M8 Allen Wrench		1
S	Contractfic Dowel		3
T	M6 x 13mm Baller		3

Caution

There are many small components used in the construction of this unit. These loose items should be kept away from young children whilst assembling your unit. As an extra precaution, screw cover caps should be permanently fixed in position. (Where applicable)

USEFUL HINTS & TIPS

Two people will be required to assemble this unit

Please keep this assembly instruction for future reference

Guide To Assembly

Model : IQ 7522 R4

1



E x 20



F x 10

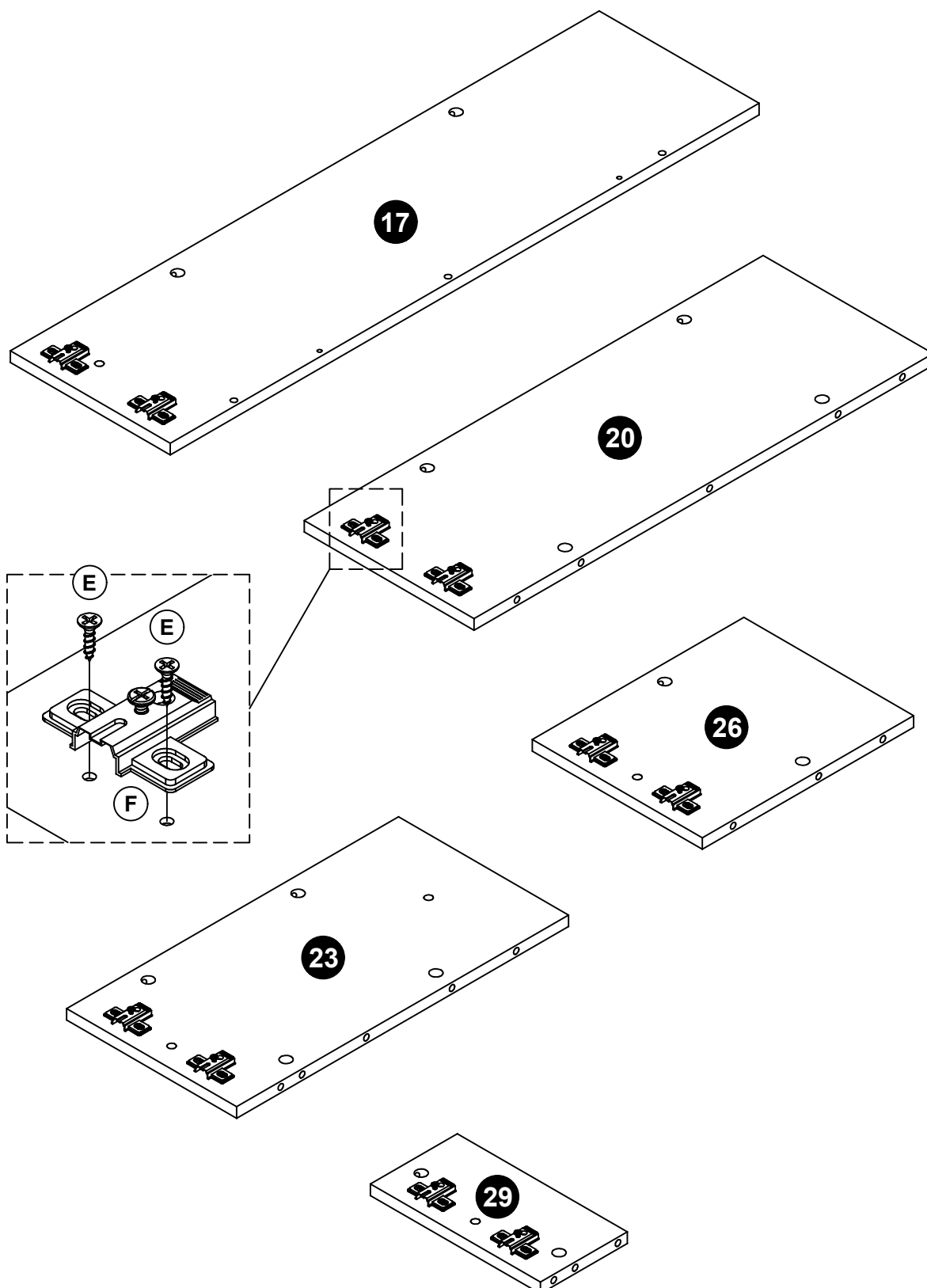

Guide To Assembly

Model : IQ 7522 R4

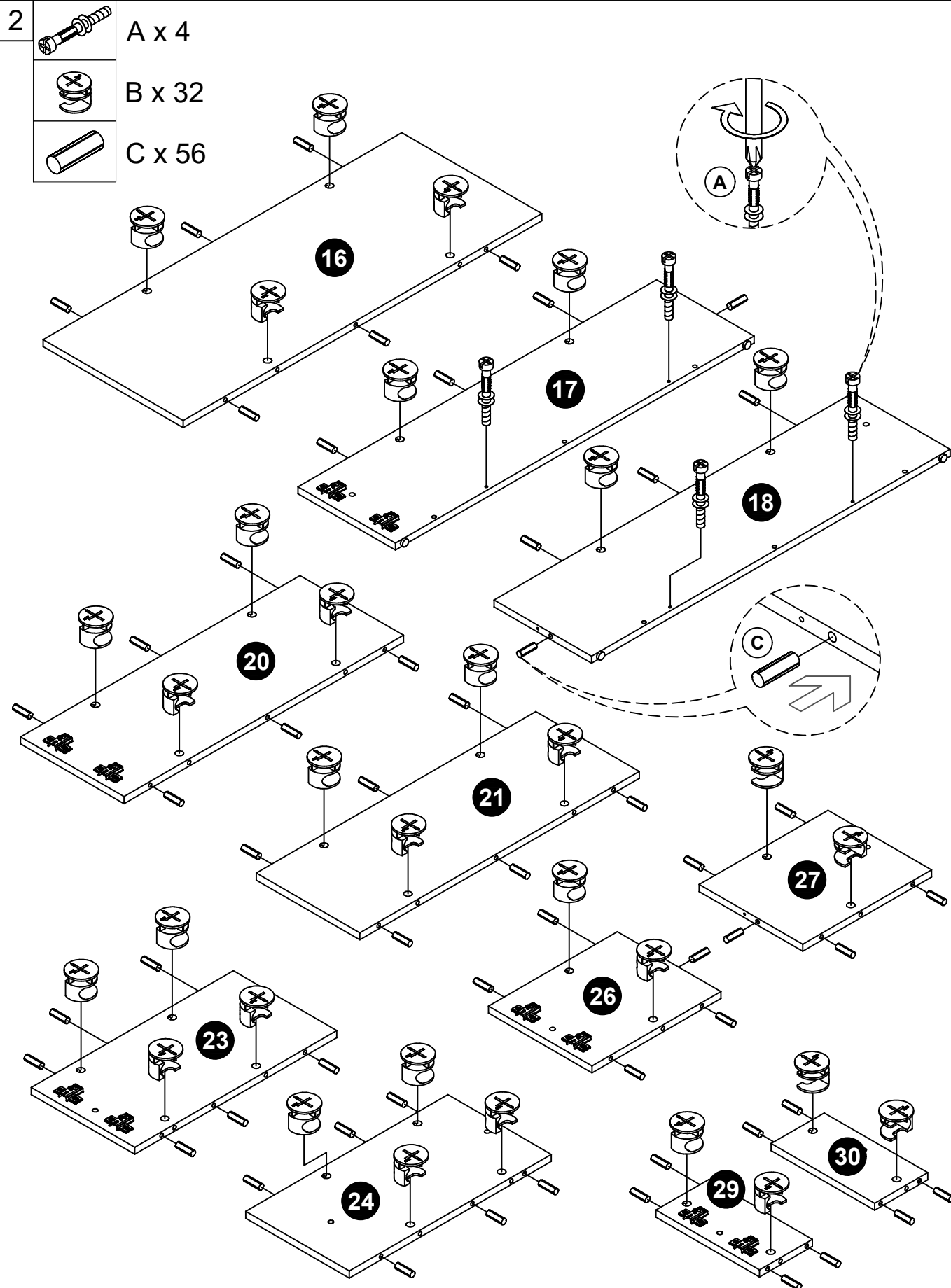

Guide To Assembly

Model : IQ 7522 R4

3



A x 16

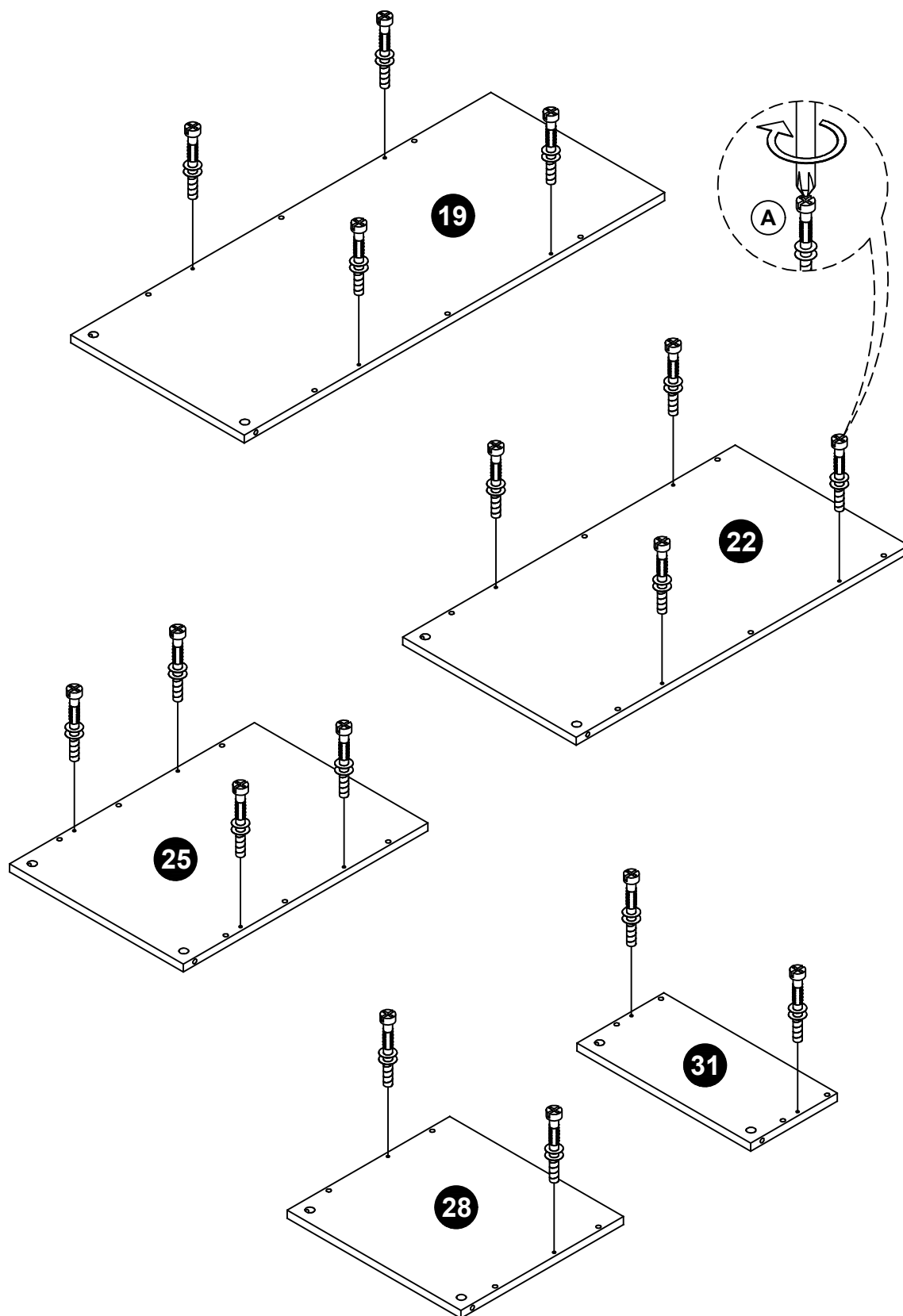

Guide To Assembly

Model : IQ 7522 R4

4

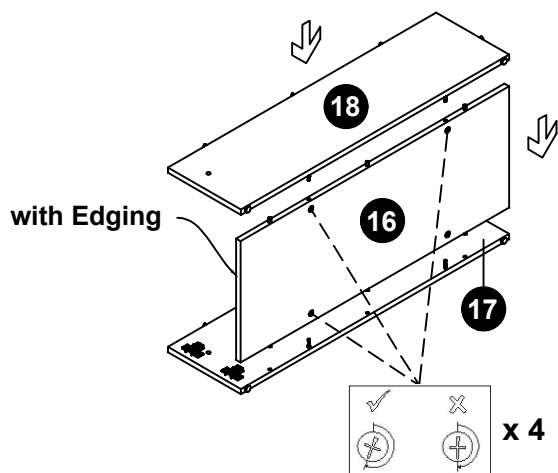

5

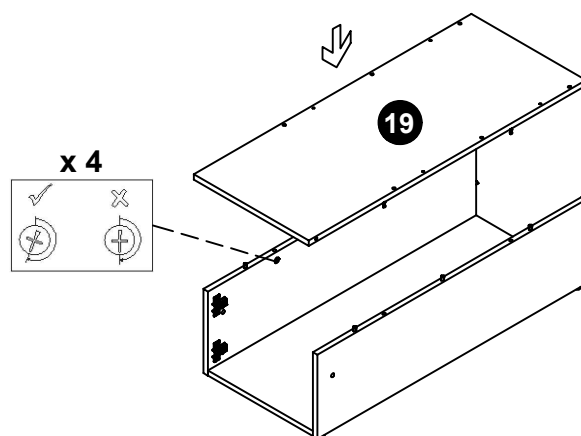

6

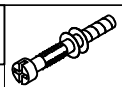

A x 4

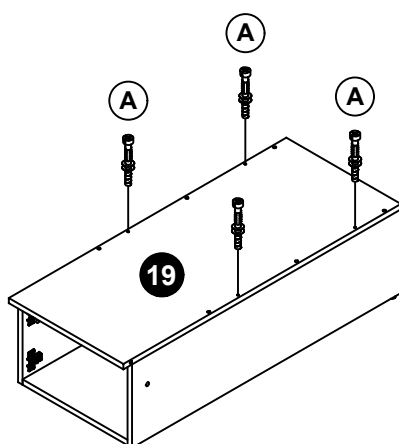

7

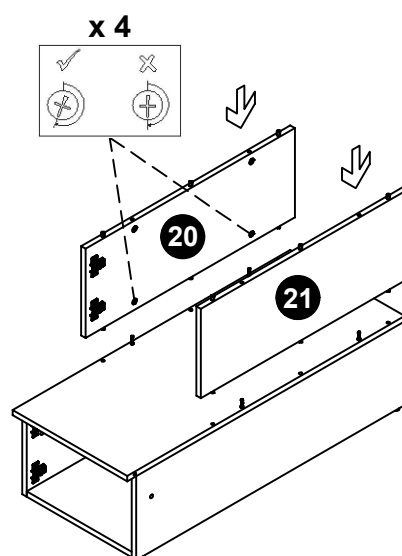

8

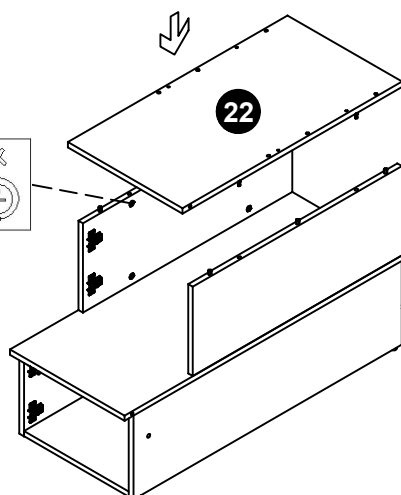
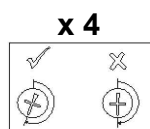

9

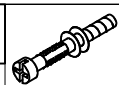

A x 4

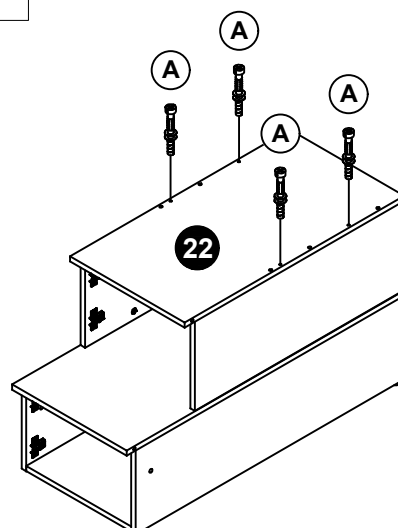

Guide To Assembly

Model : IQ 7522 R4

10

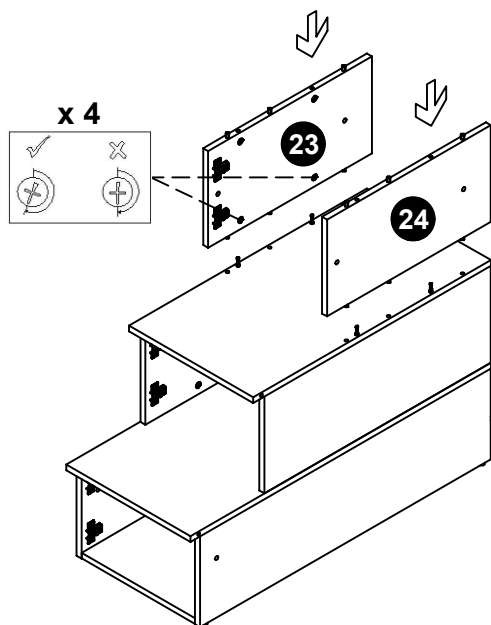

11

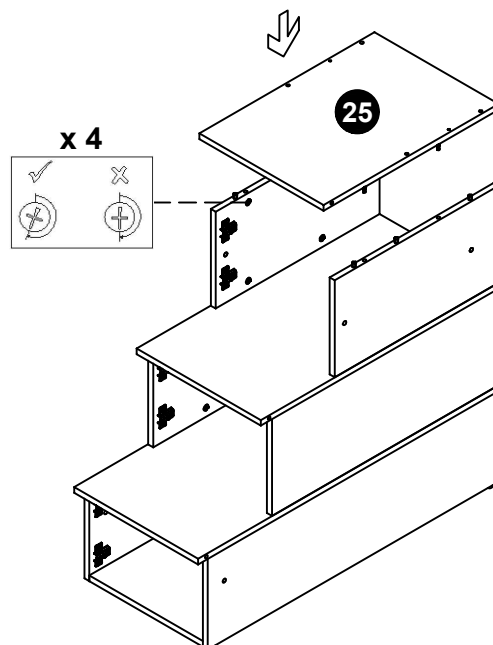

12

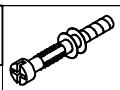

A x 2

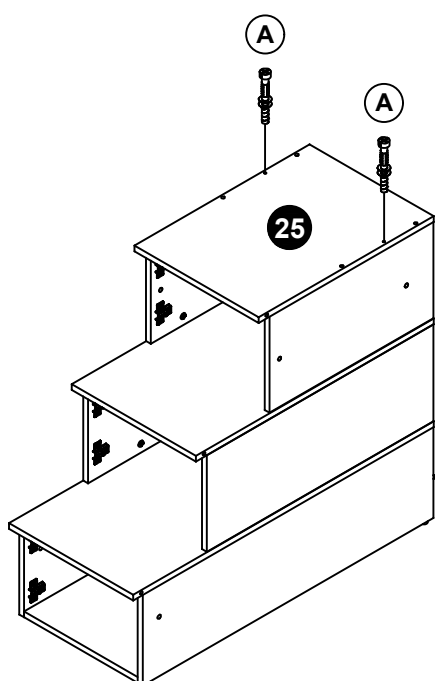

13

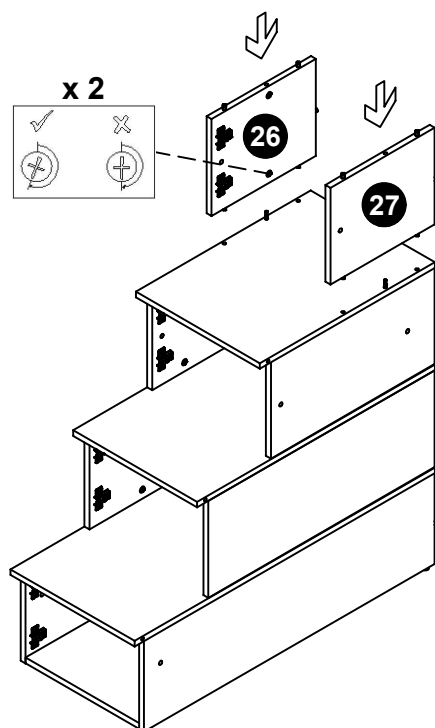

Guide To Assembly

Model : IQ 7522 R4

14

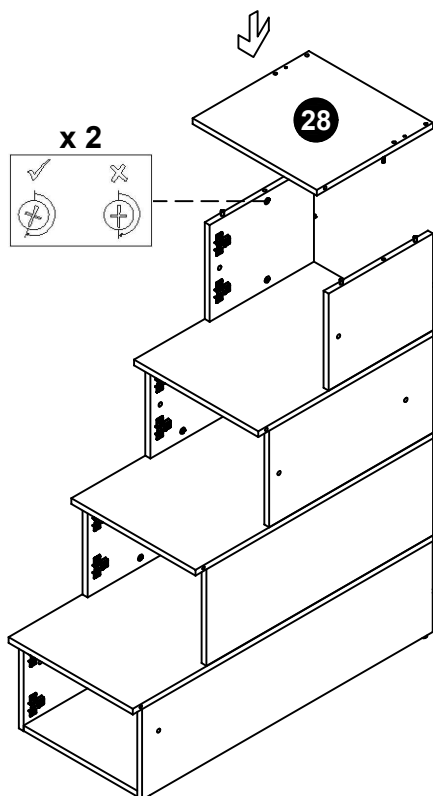

15

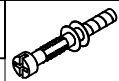

A x 2

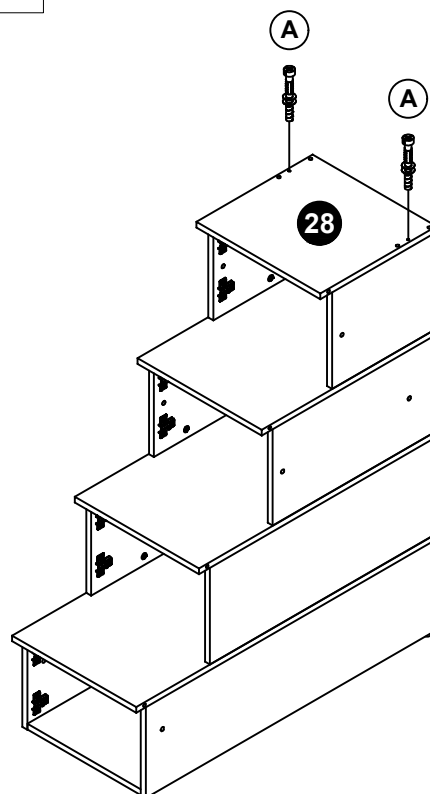

16

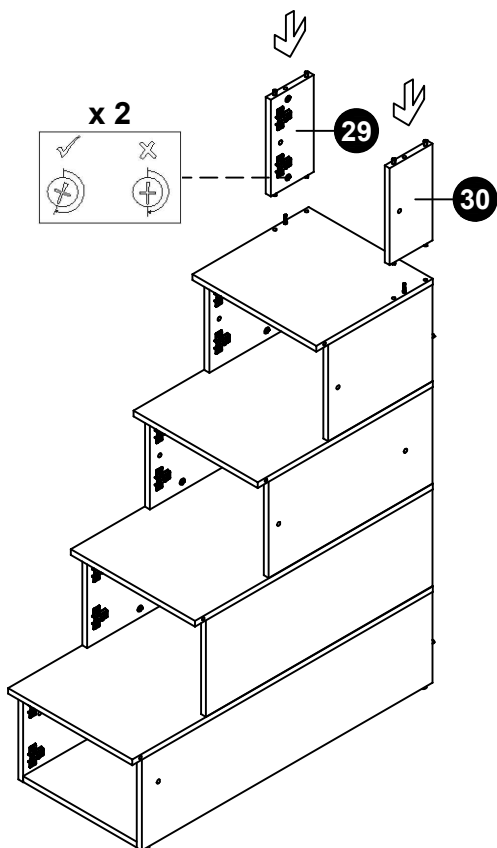

17

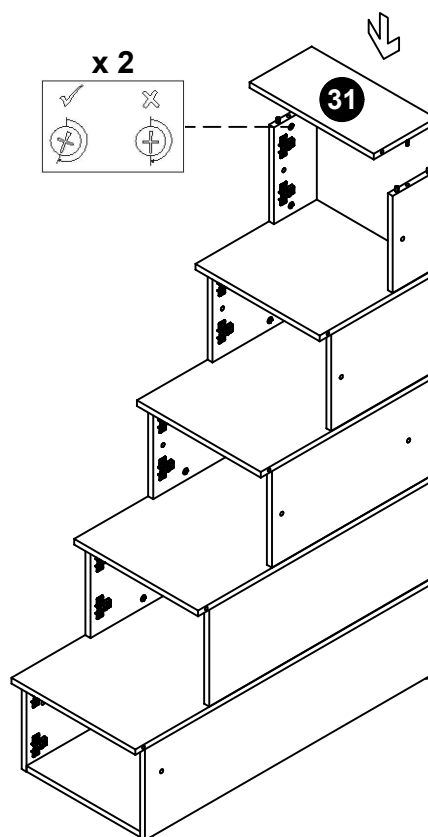

Guide To Assembly

Model : IQ 7522 R4

18



D x 5

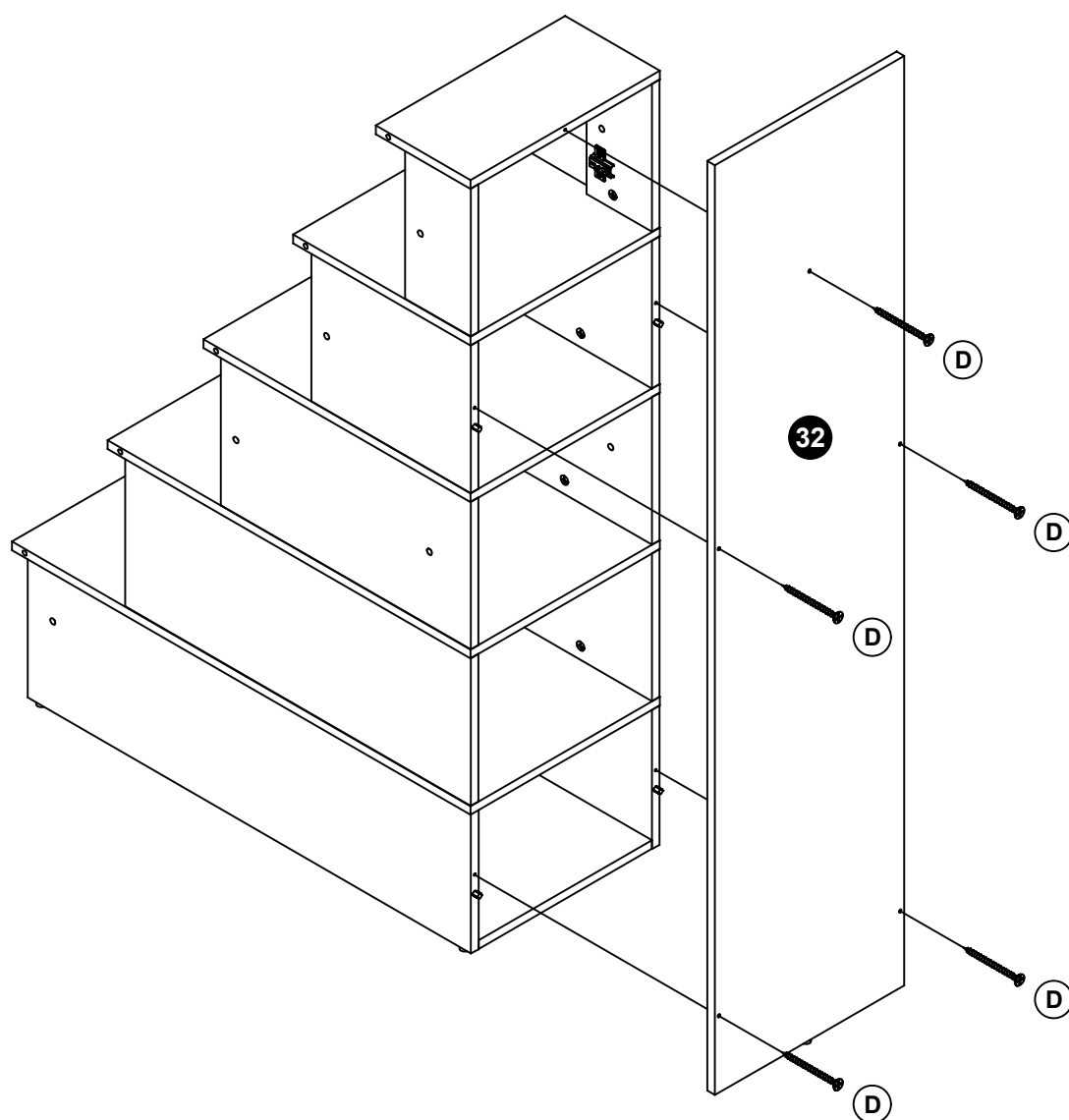

Guide To Assembly

Model : IQ 7522 R4

19



A x 10

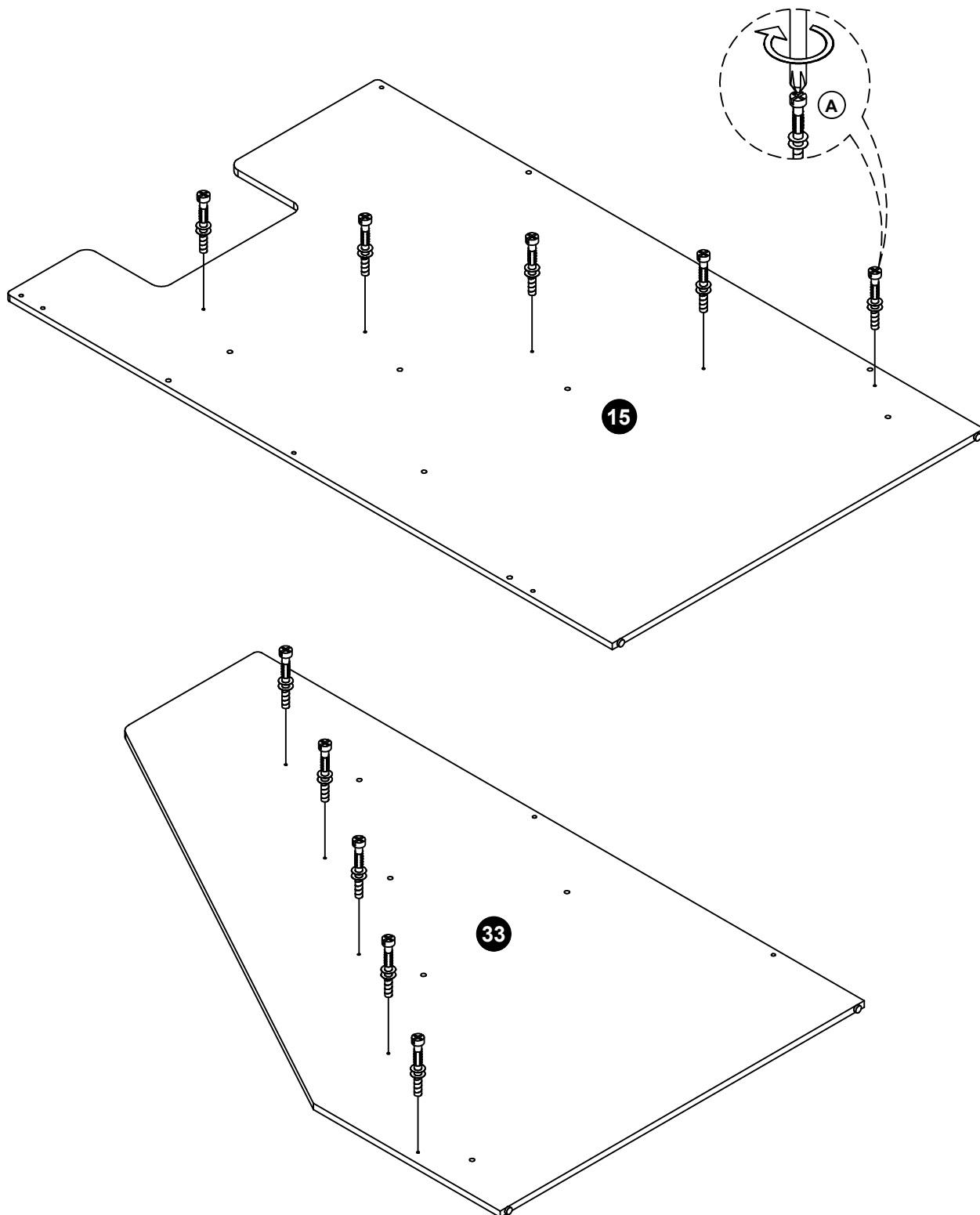

Guide To Assembly

Model : IQ 7522 R4

20



P x 5

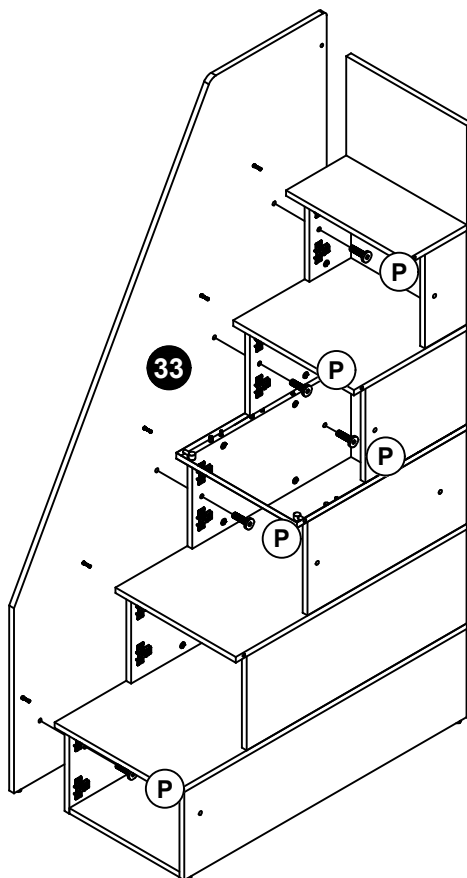

21



B x 5

x 5

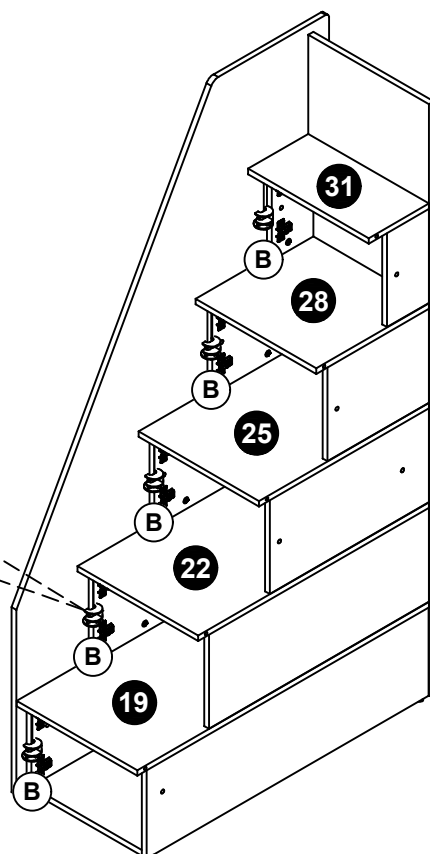
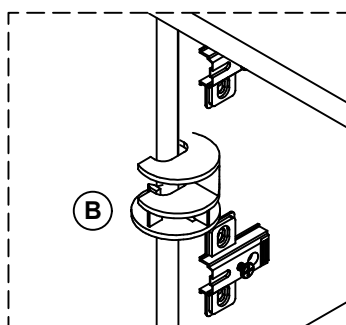
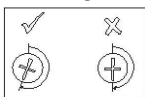

Guide To Assembly

Model : IQ 7522 R4

22



P x 5

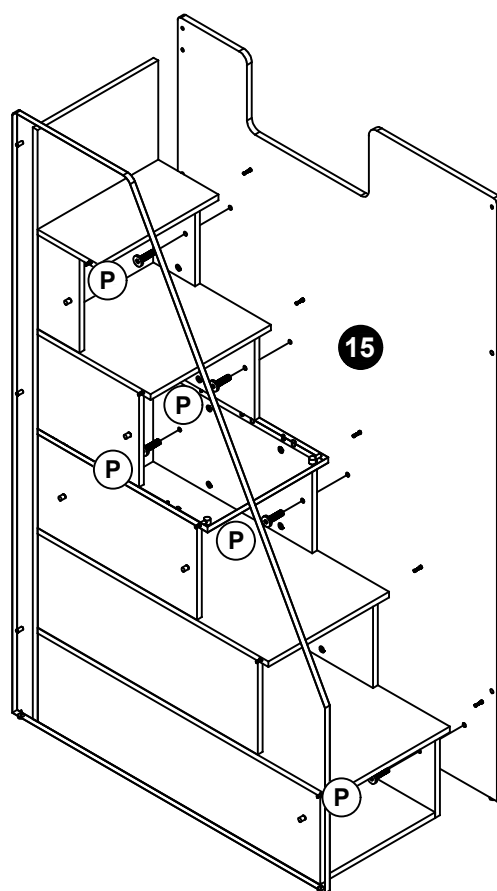

23



B x 5

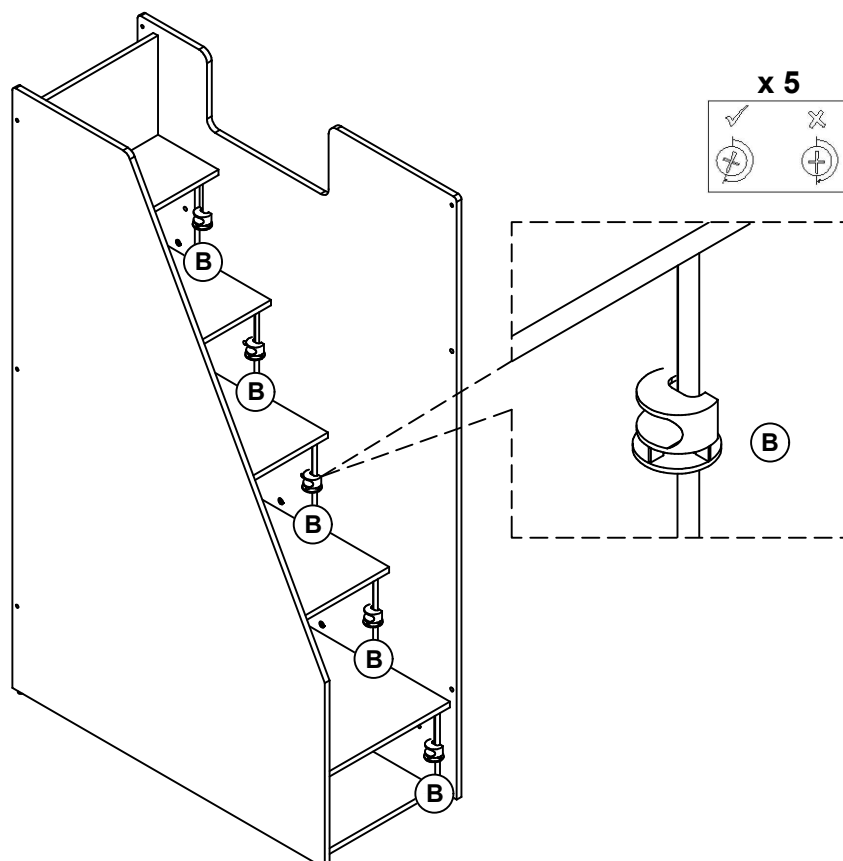

Guide To Assembly

Model : IQ 7522 R4

24



M x 6

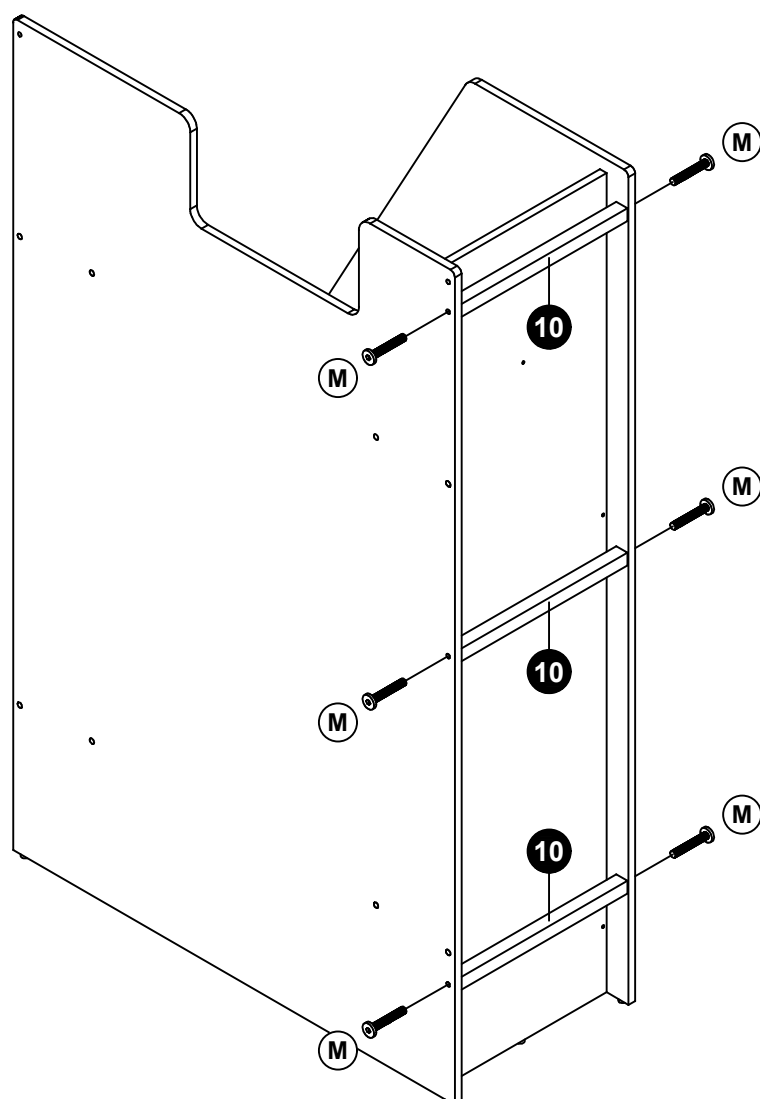

Guide To Assembly

Model : IQ 7522 R4

25



J x 4

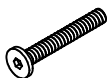

K x 4



M x 2

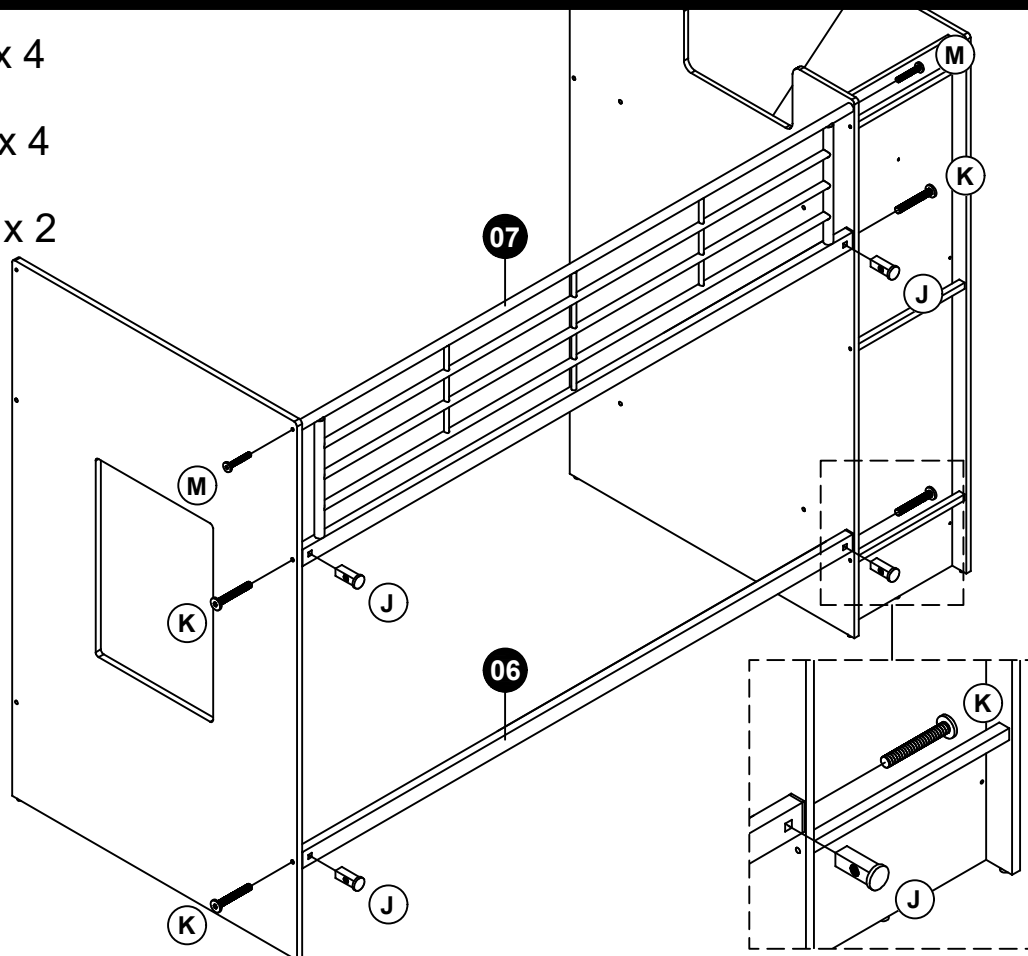

26



J x 4

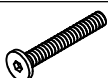

K x 4



M x 2

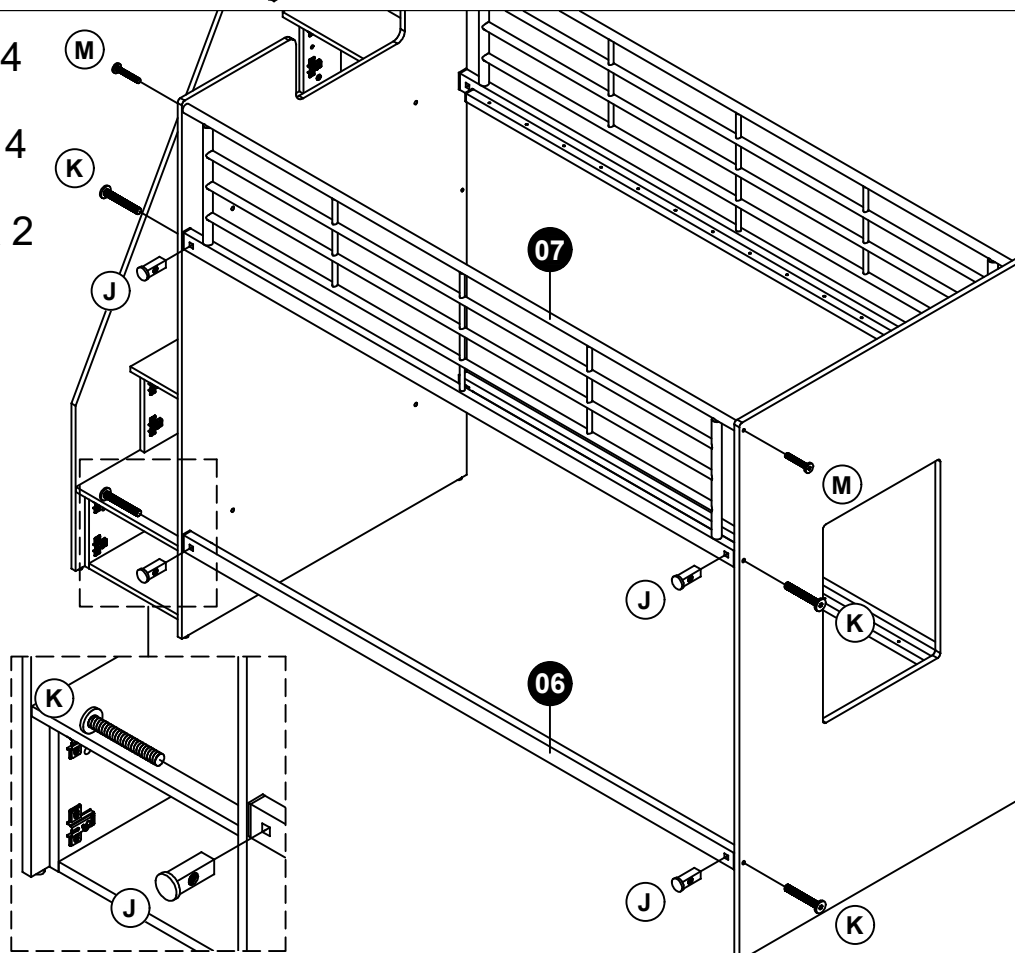

Guide To Assembly

Model : IQ 7522 R4

27



N x 4

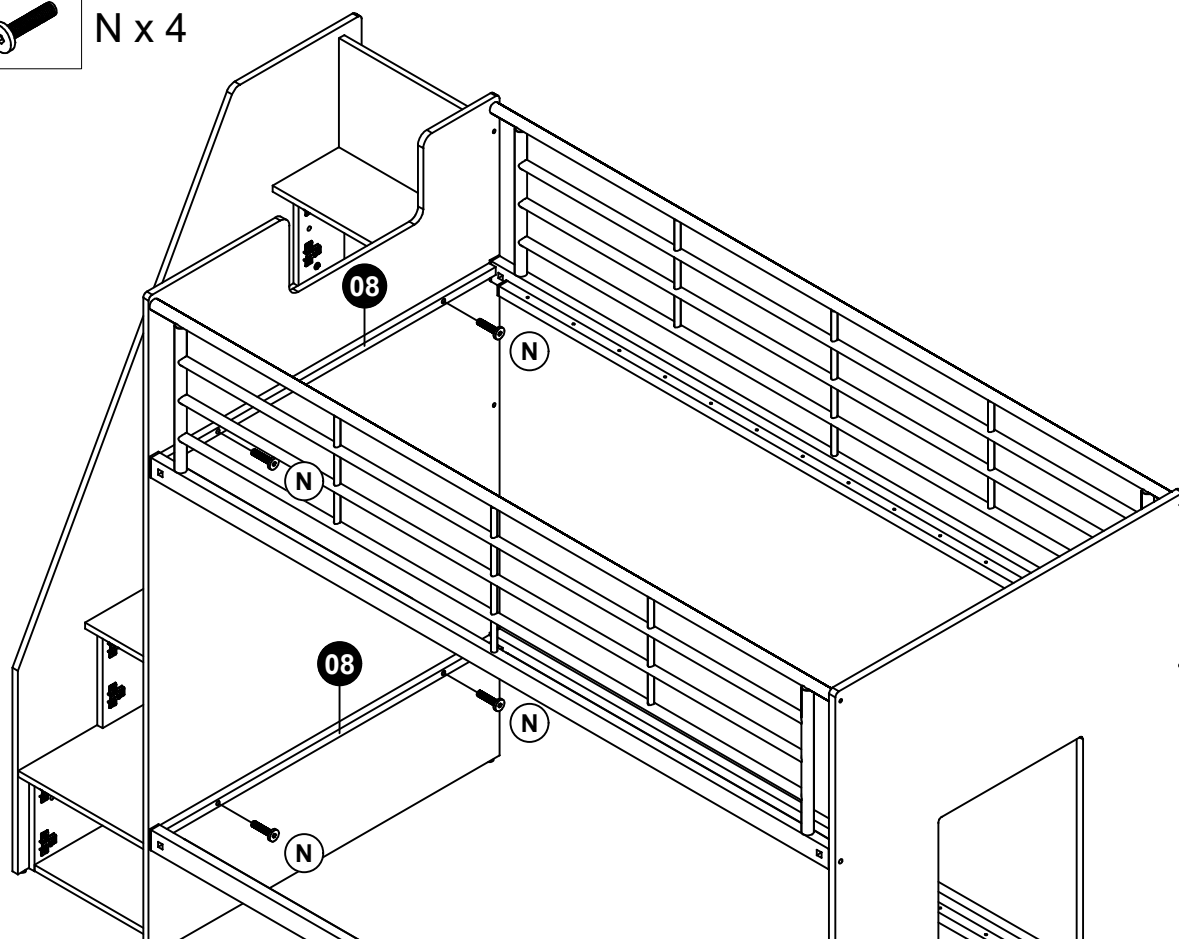

28



N x 4

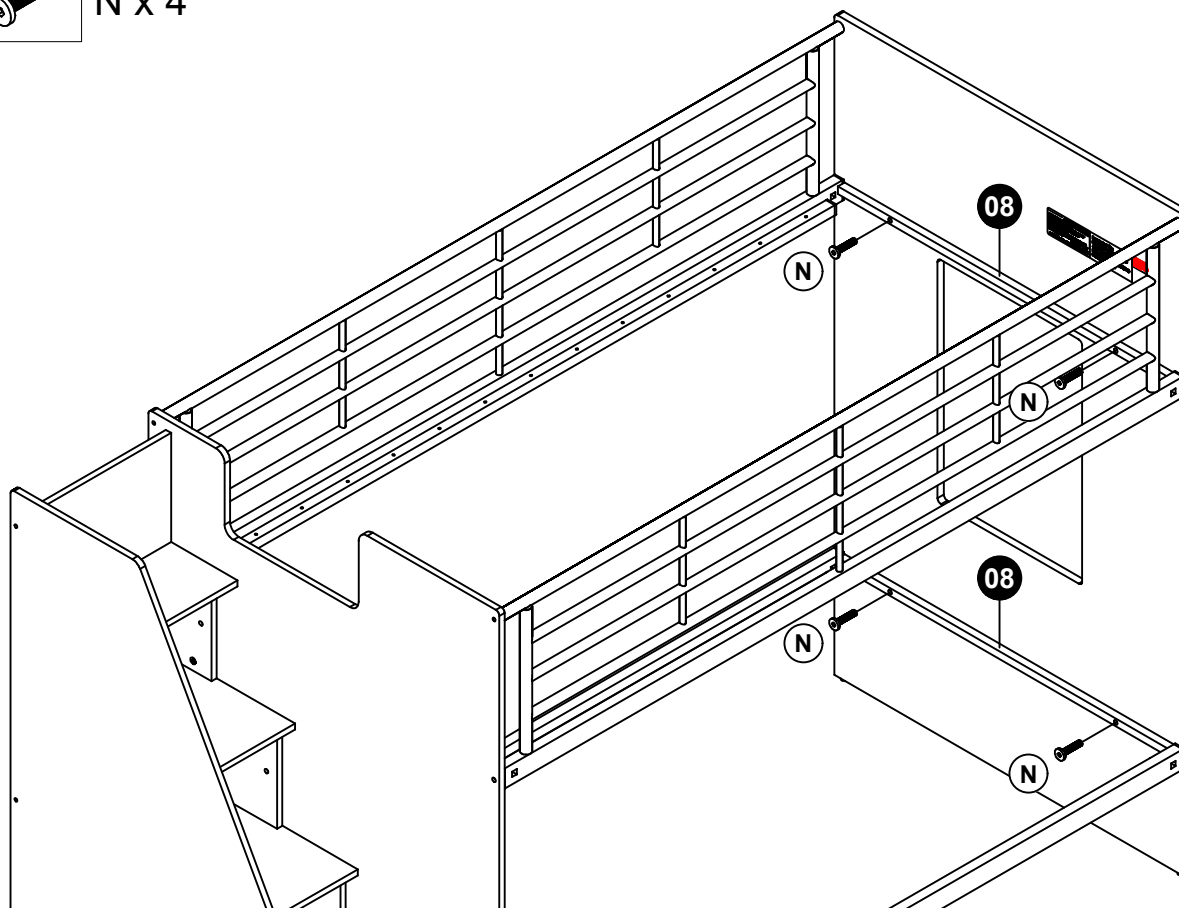

Guide To Assembly

Model : IQ 7522 R4

29



N x 56

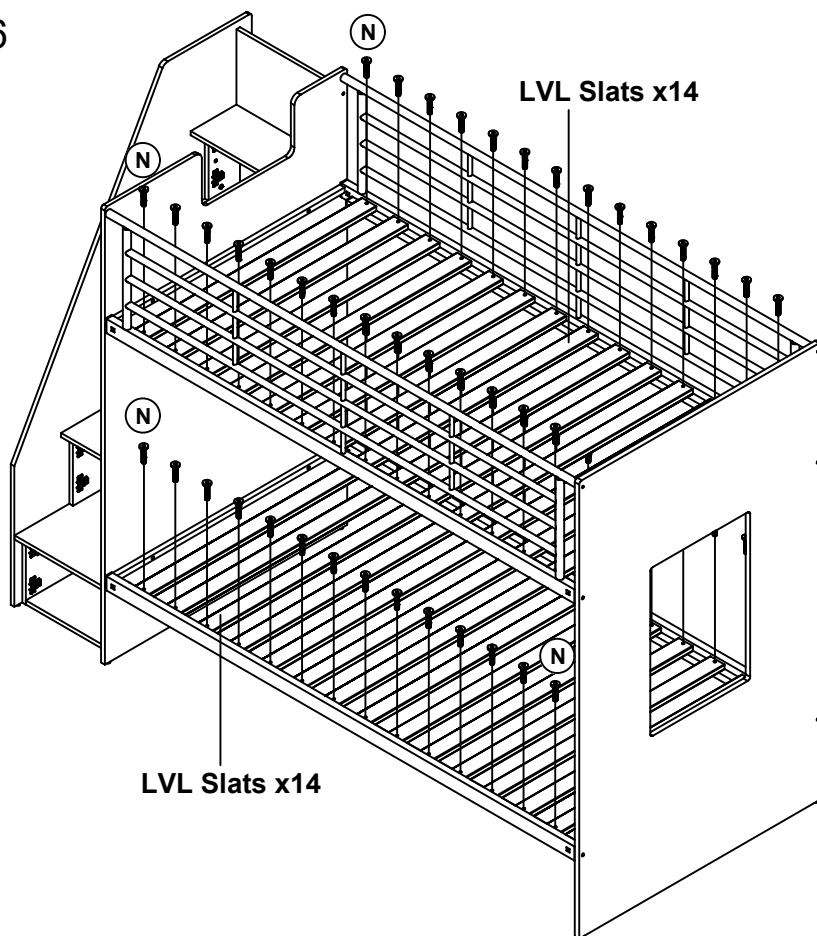

30



E x 20

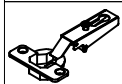

F x 10

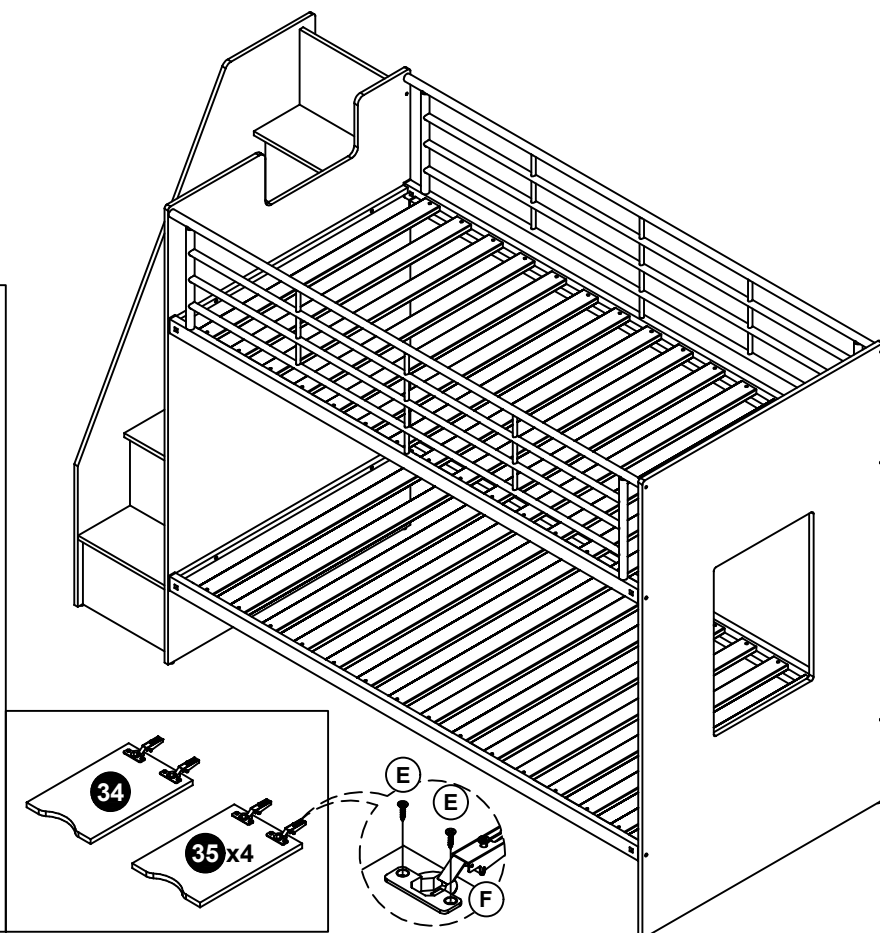
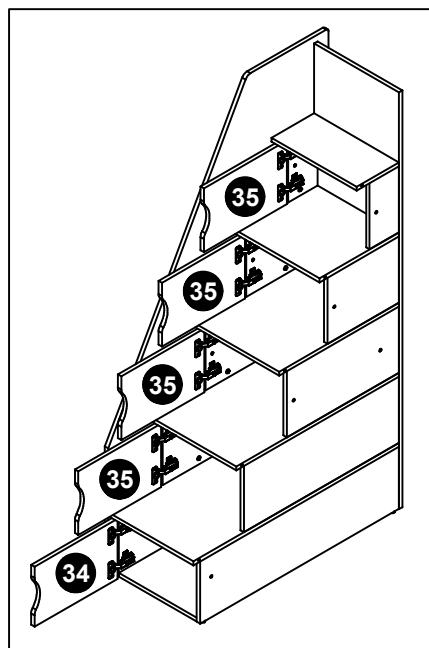

Guide To Assembly

Model : IQ 7522 R4

31



A x 3



B x 6

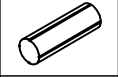

C x 22



S x 3



T x 3

WHEN FITTING CAMS

ENSURE STARTING POSITION IS CORRECT
BEFORE YOU INSERT CONNECTING BOLT
TURN CLOCKWISE UNTIL SECURE

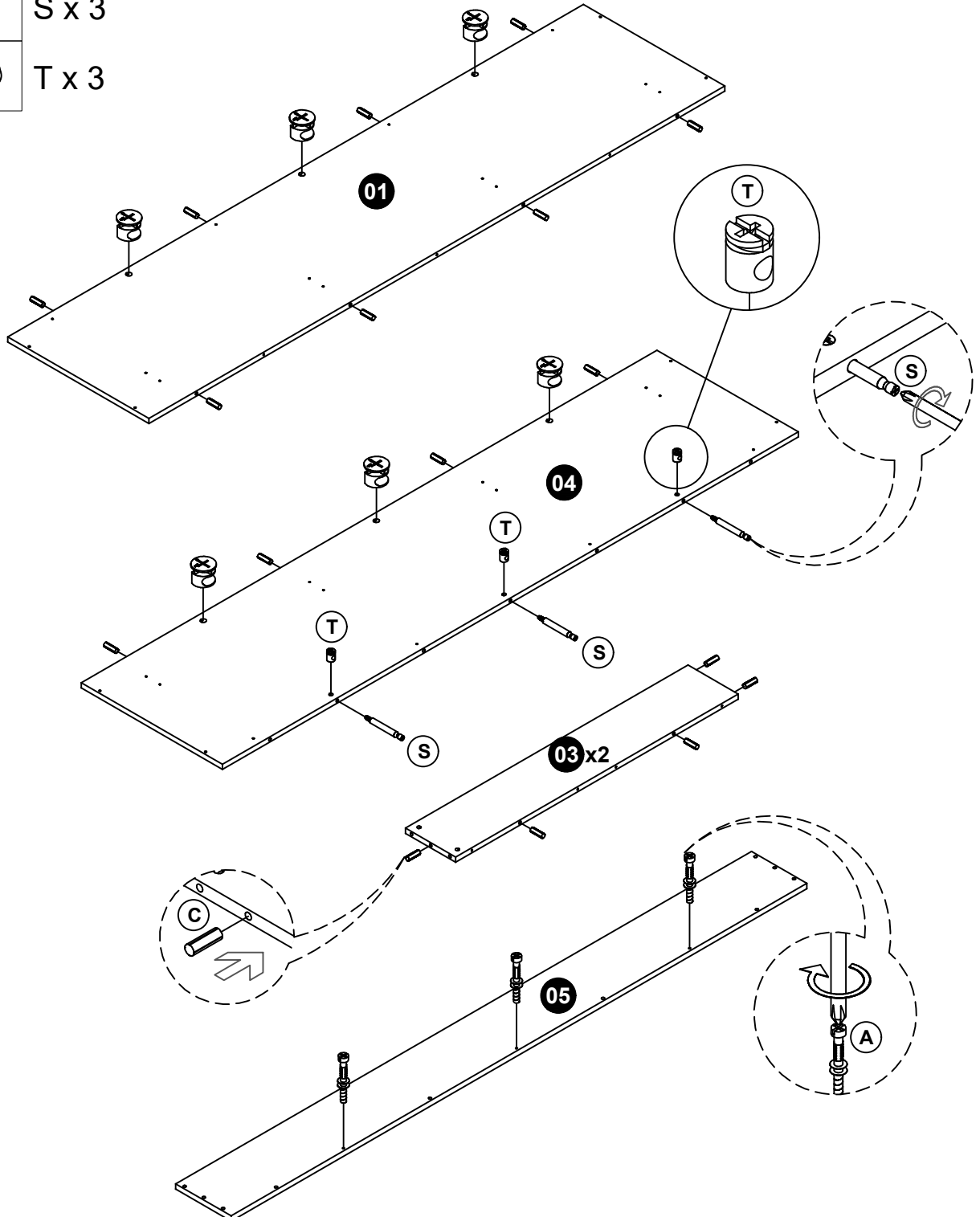
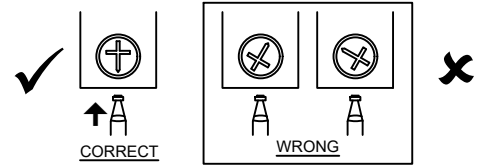

Guide To Assembly

Model : IQ 7522 R4

32

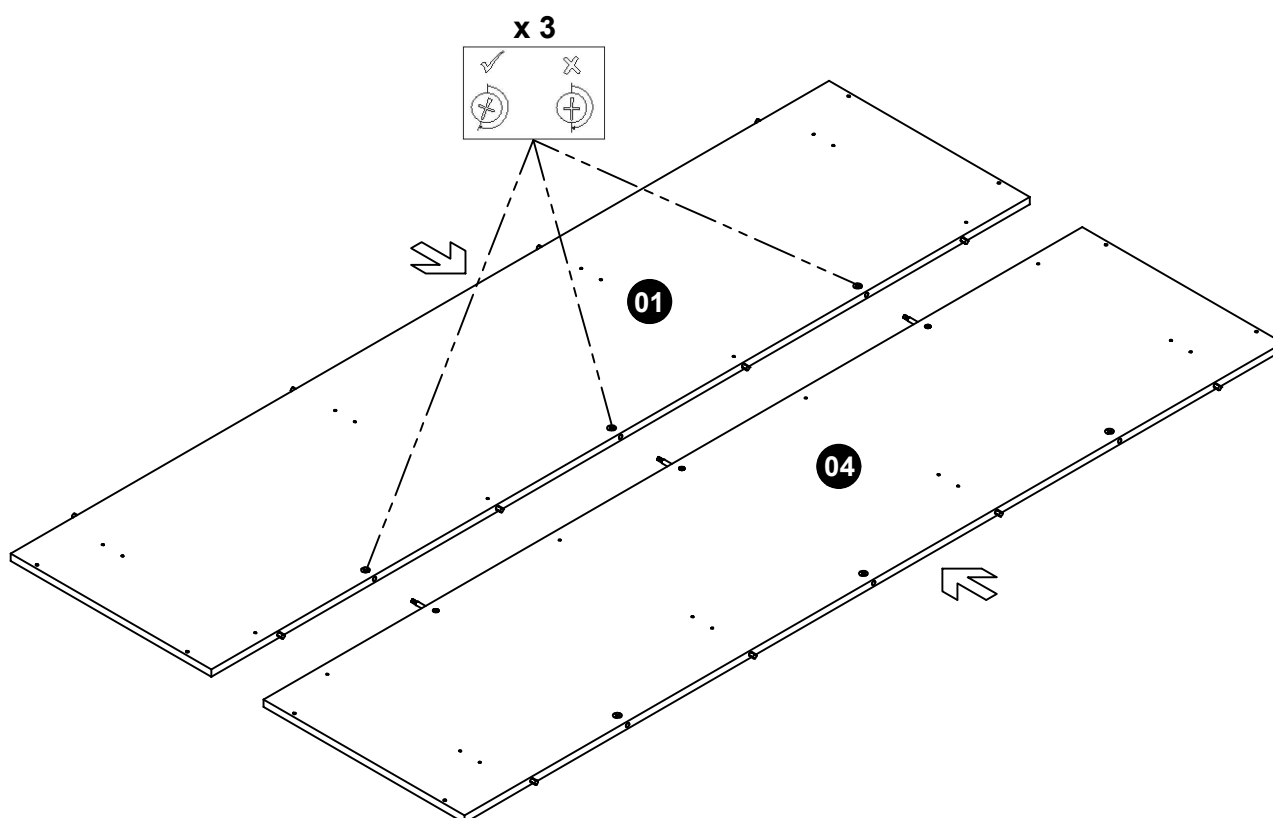

33



E x 24

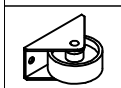

G x 12

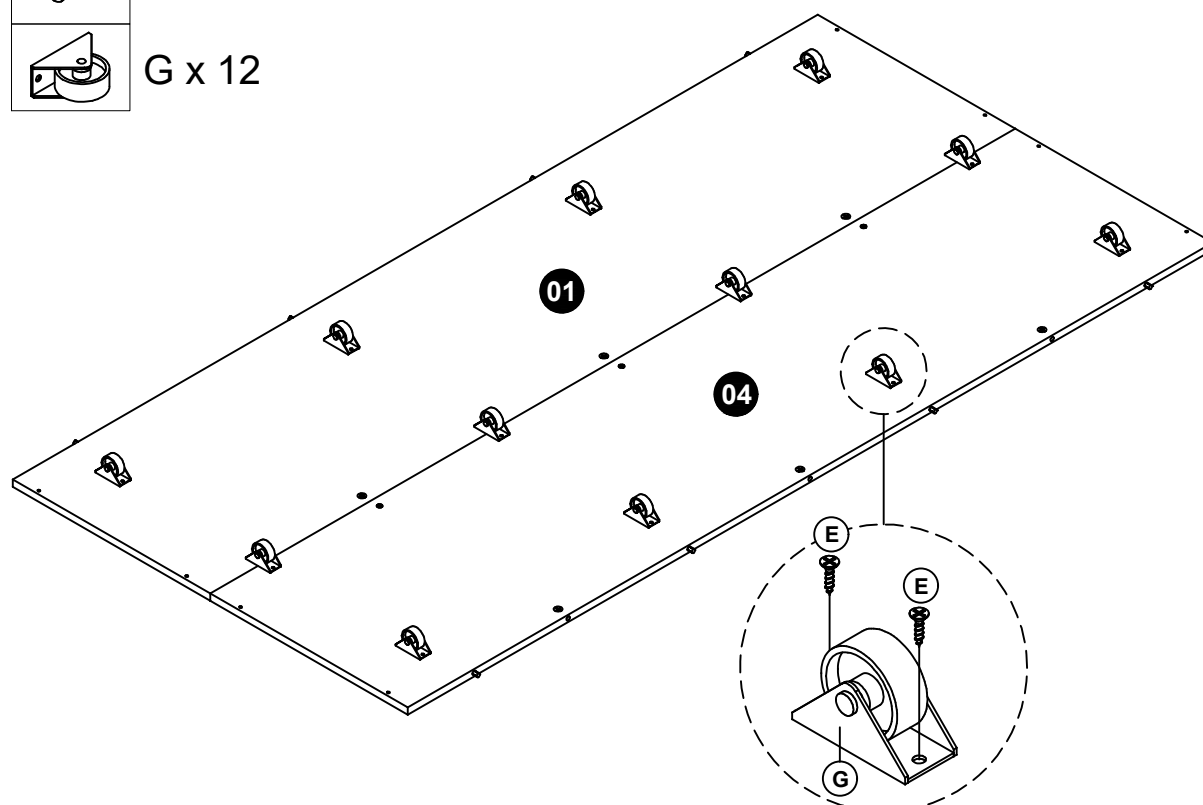

Guide To Assembly

Model : IQ 7522 R4

34



D x 8

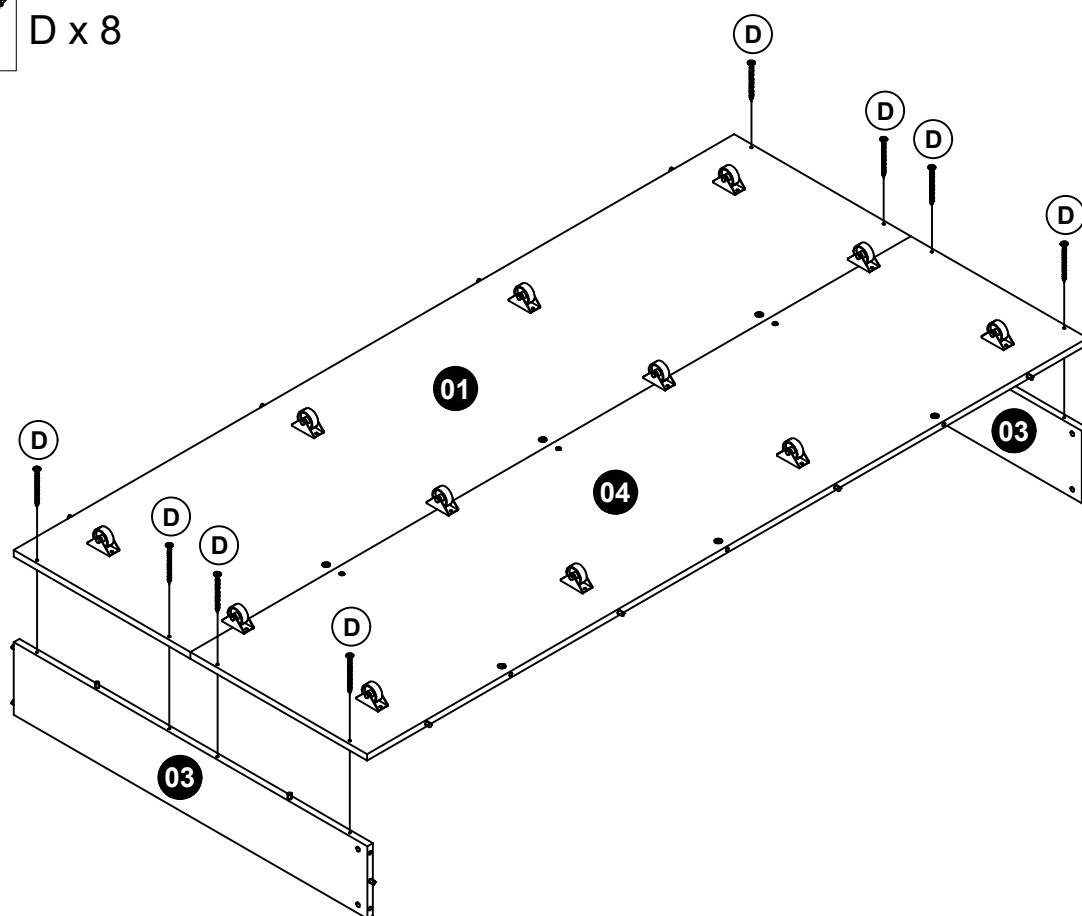

35



D x 5

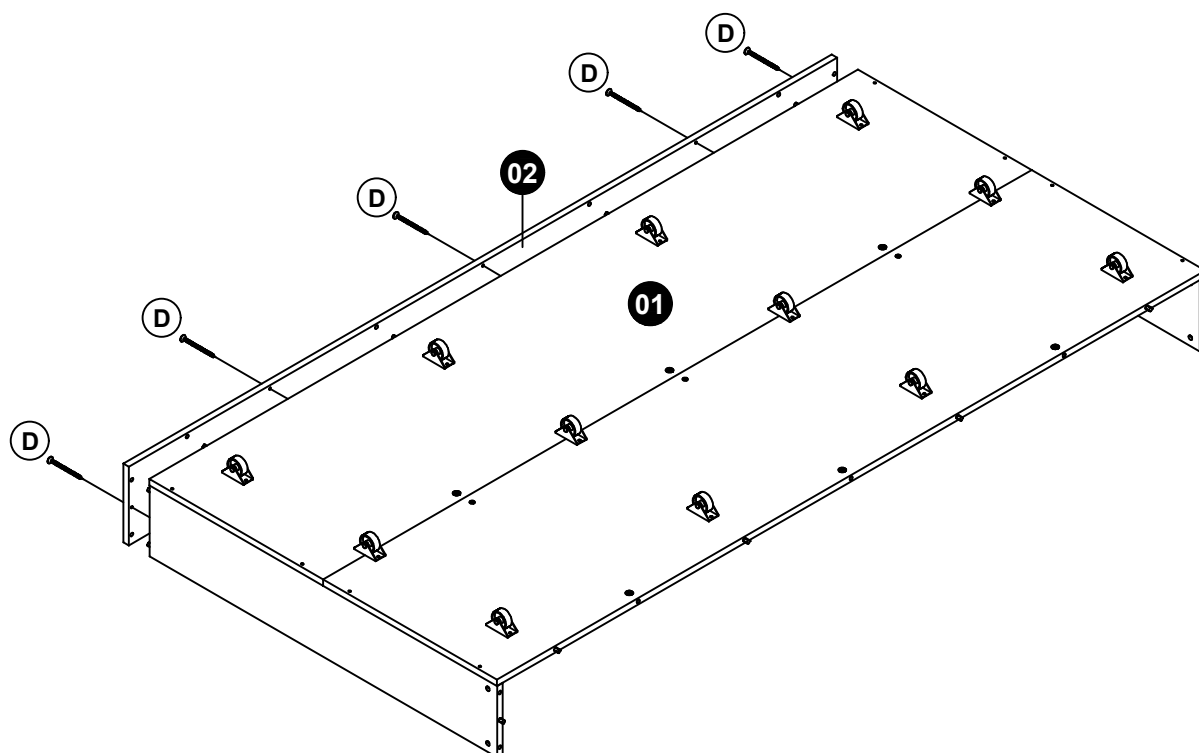

Guide To Assembly

Model : IQ 7522 R4

36

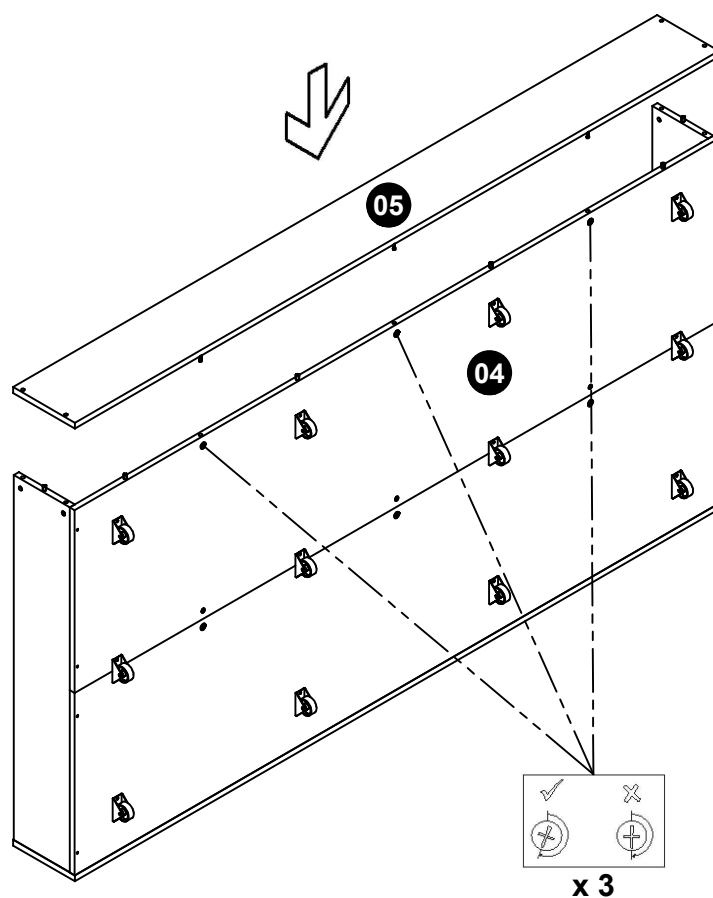

37

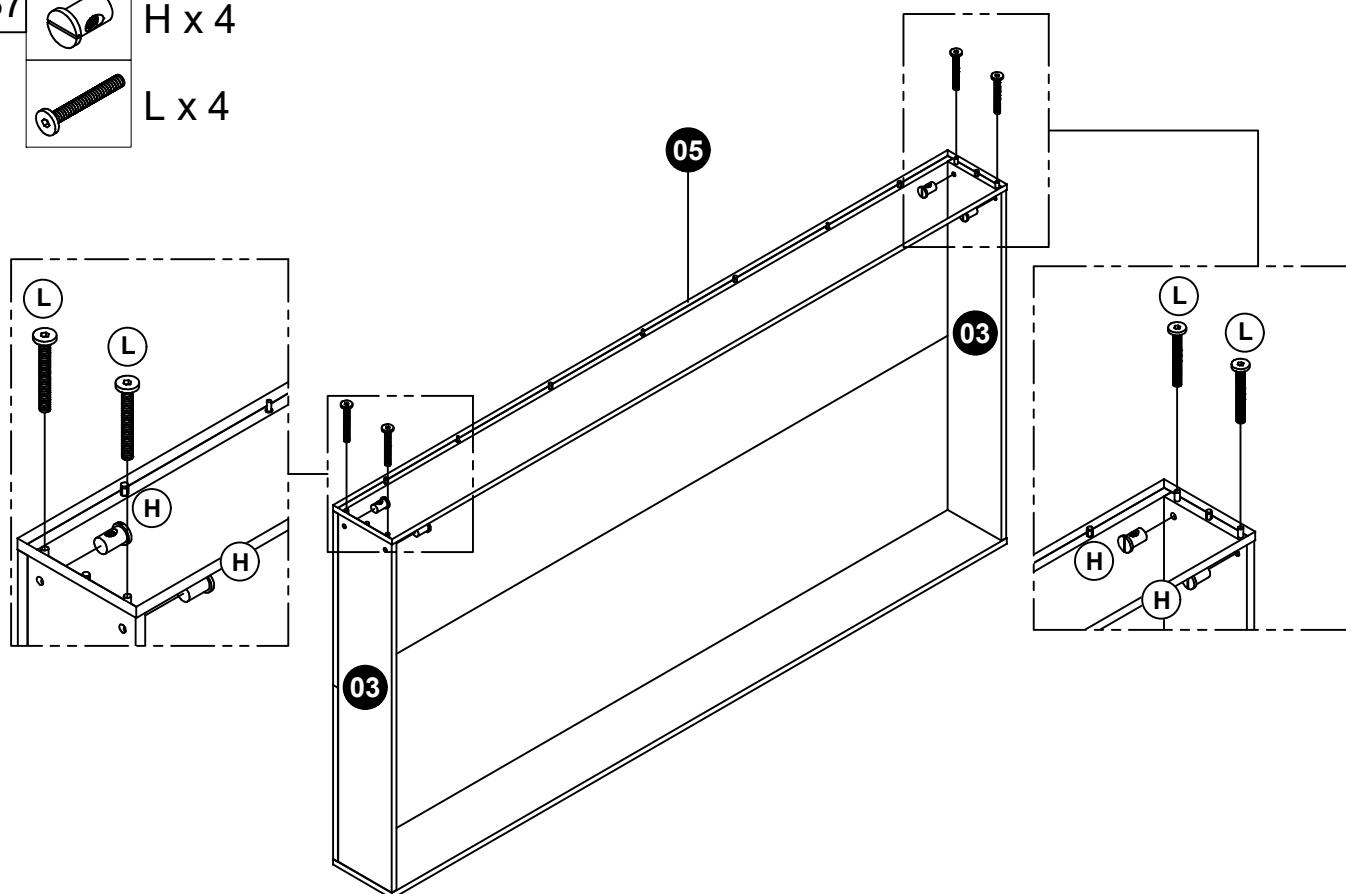
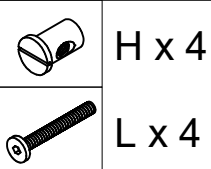

38

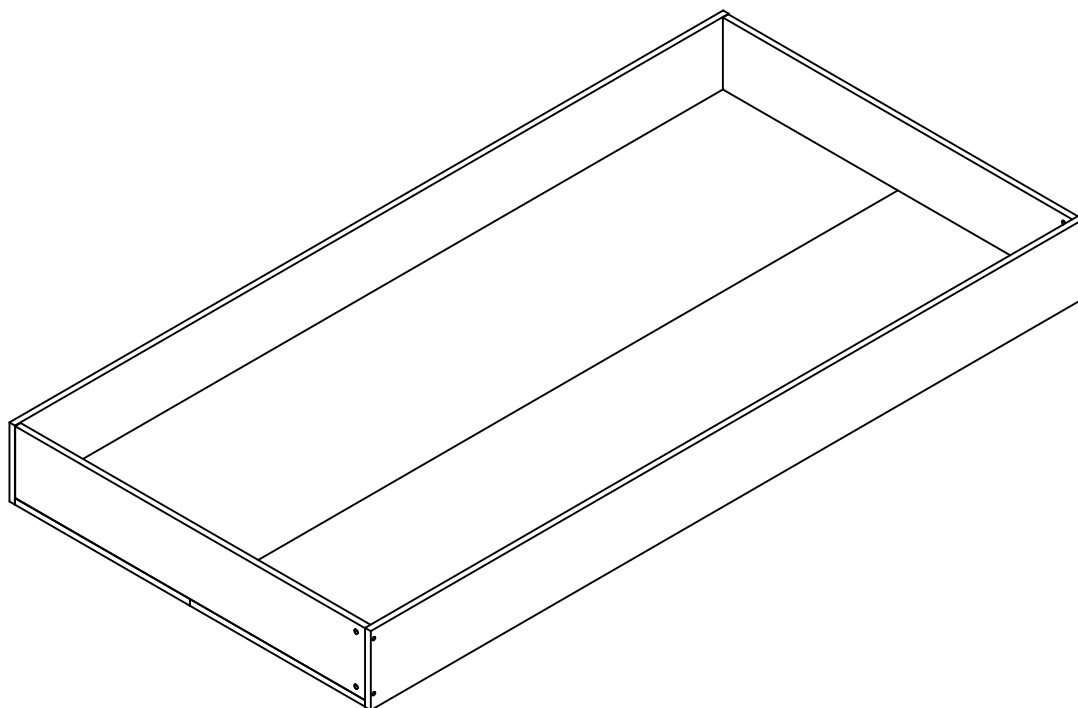

39

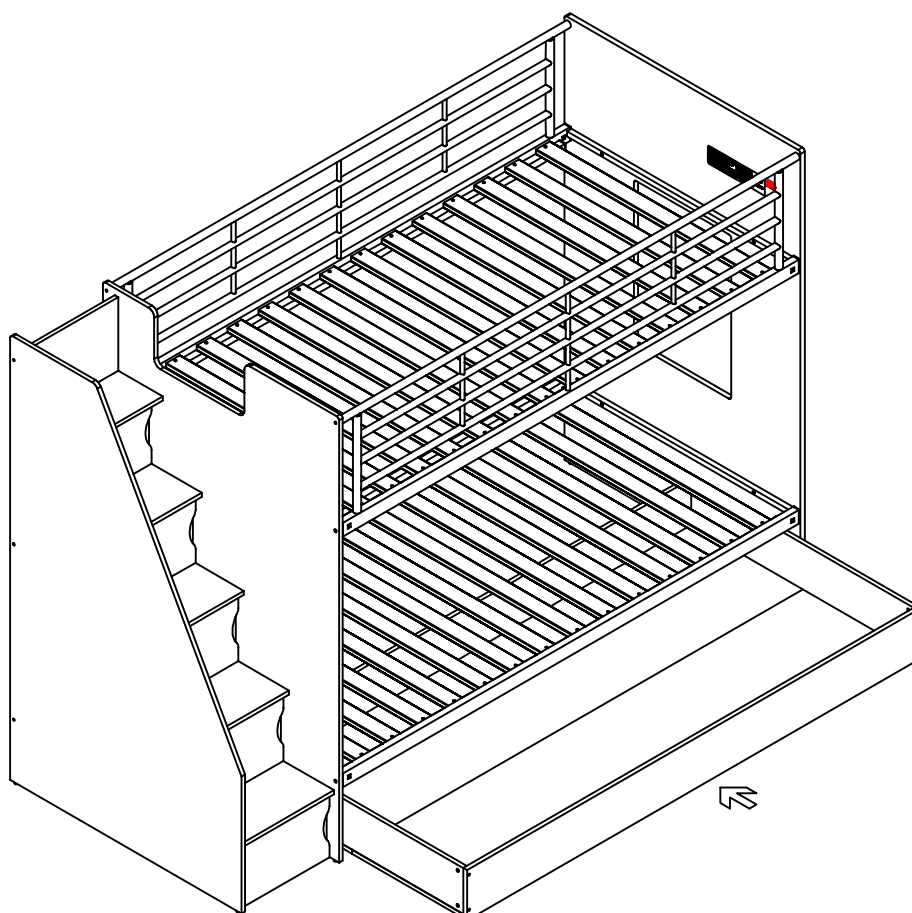

Adjusting Possibilities

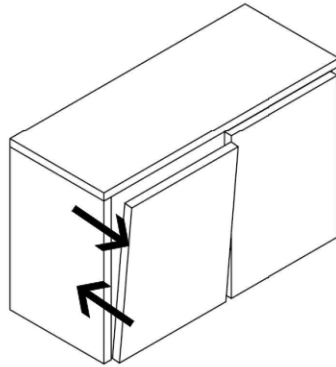
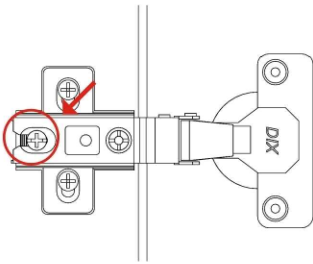

Depth Adjustment
after loosening the hinge
arm mounting screw

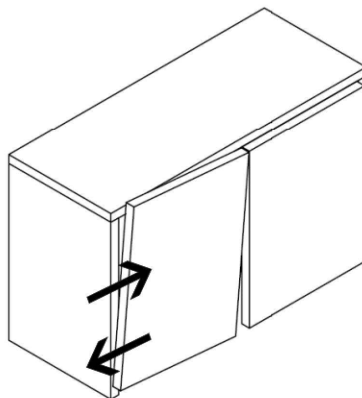
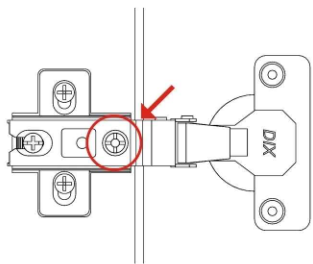

Lateral Adjustment
by adjusting screw

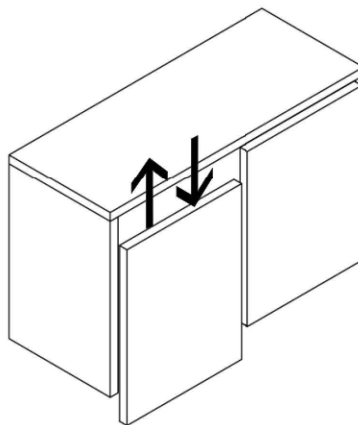
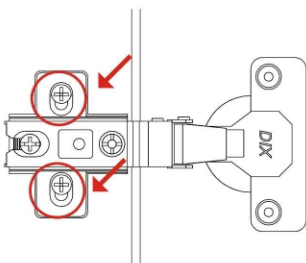

Vertical Adjustment
via mounting plate (via
slots or, if in two pieces,
via screw)

