

Thank you for purchasing this product. Before starting assembly we suggest you spend a short time reading through this leaflet, then follow the simple step by step guide.  
Two people are needed to assemble this product.

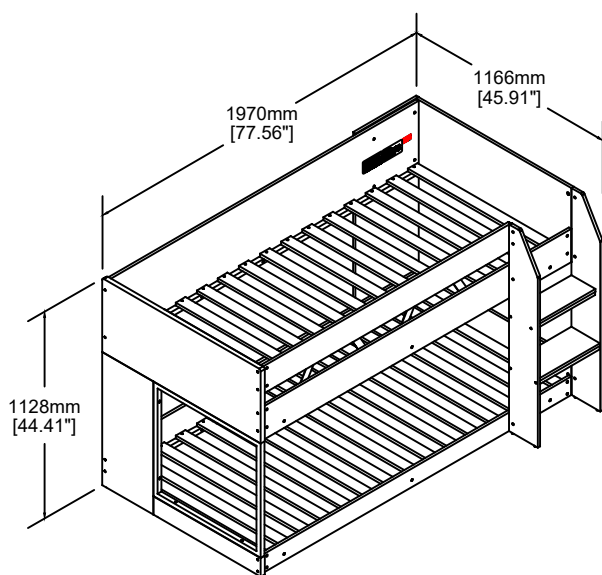

*Read these instruction and follow steps carefully to ensure you assemble the product correctly and avoid damages. Check that all parts and hardware have been provided before assembling the product. Place all contents on a clean, soft-flat surface to avoid scratching the product.*

**⚠ Caution:**

*Only tighten bolts to 80% at first. Once all parts have been assembled fully tighten all hardware. Use prevent damage to threads, do not use a power tool and do not overtighten belts. Use two people to lift and turn the product when assembling. Do not attempt with only one person and do not roll onto legs. Keep all hardware and small parts away from children.*



### **TOP TIPS BEFORE YOU START !**

### **IMPORTANT- READ CAREFULLY- RETAIN FOR FUTURE REFERENCE**

1. Please check that all parts & hardware are present before you start the assembly of your furniture.
2. For ease and speed of assembly, we recommend that before you commence each step of the assembly, Please identify all the parts required for that step.
3. We recommend that where possible, all items are assembled near to the area in which they will be placed in use, to Avoid moving the product unnecessarily once assembled.
4. For the protection of your furniture, particularly items of high gloss finish, we recommend that the product is placed on a Protected surface during assembly to prevent any damage.
6. During assembly please take care not to over-tighten any fittings, as this may damage the product.

### **CARE AND MAINTENANCE OF YOUR FURNITURE**

- Please periodically check all fittings and re-tighten as necessary.
- To clean your item, please use a damp cloth and wipe clean.
- Never allow any kind of liquid to remain on your furniture. Absorption can cause wood to warp or finishes to de-laminate.
- Please do not place hot items (e.g hot drinks) directly on the wood surface.
- Please do not drag or pull your furniture.

### **IMPORTANT INFORMATION**

1. Thickness of mattress should not exceed 170mm.
2. Children should be discouraged from playing on top of this bunk bed.
3. The bunk bed should be checked periodically by the owner to ensure that the guardrail, ladder, and other components are maintained in the correct position and state of repair and that all connectors are tight.
4. A bunk bed is not to be placed near a ceiling fan unless the distance between the closest points on the ceiling fan bunk Bed is at least 2 metres.
5. Use guardrails on both sides of upper bunk.
6. Prohibit horseplay on or under bed(s).
7. Prohibit more than one person on upper bunk.
8. Use Ladder for entering and leaving upper bunk.
9. If the bunk bed will be placed next to the wall, the guardrail that runs the full length of the bed should be placed against The wall to prevent entrapment between the bed and the wall.

### **STRANGULATION HAZARD:**

10. Never attach or hang items to any part of the bunk bed that are not designed for use with the bed for example, but not limited to hook, belt and jump ropes.

### Tools Required For Assembly

Phillips Screw Driver

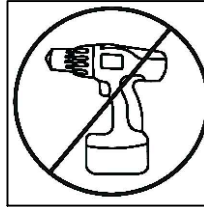
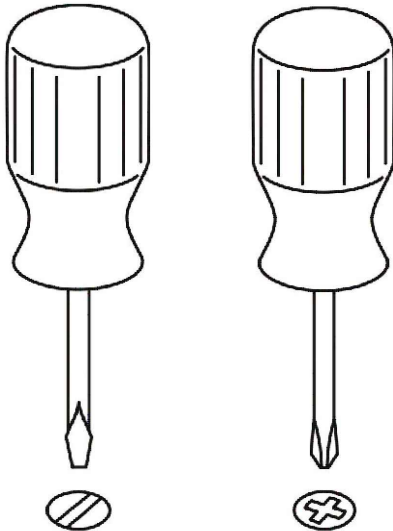

DO NOT USE POWER TOOLS TO ASSEMBLE THIS PRODUCT. USE OF POWER TOOLS WILL INVALIDATE ANY CLAIM AND MAY DAMAGE THIS PRODUCT MAKING IT UNSAFE.

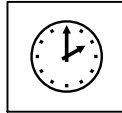

Approximately 1 hour 30 min



2 People Required

Rubber Hammer

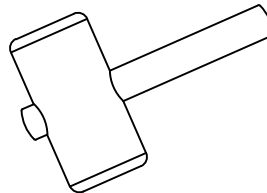

Measure

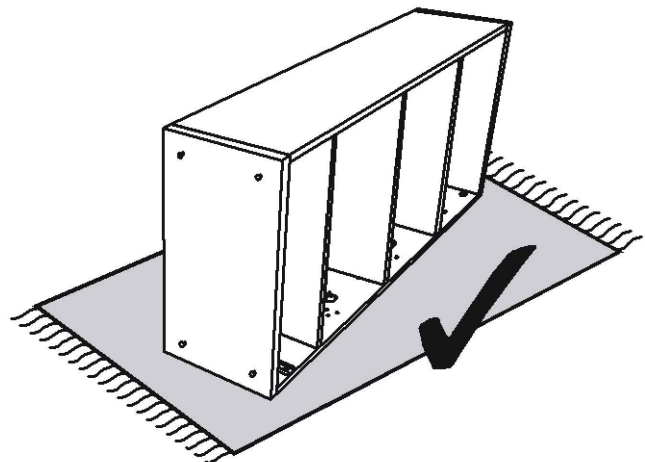
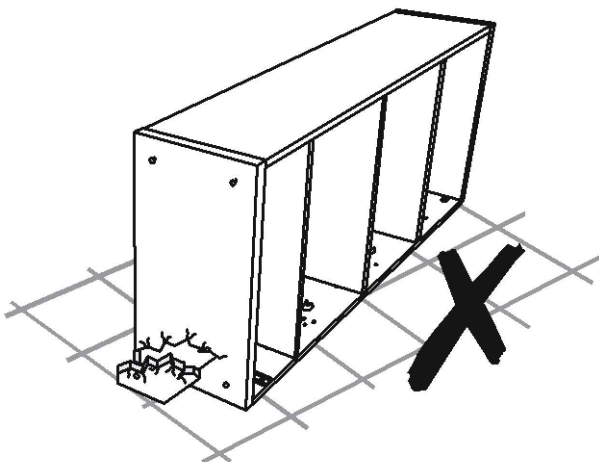
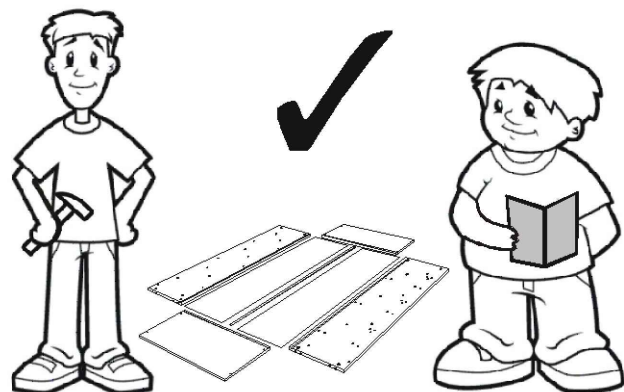
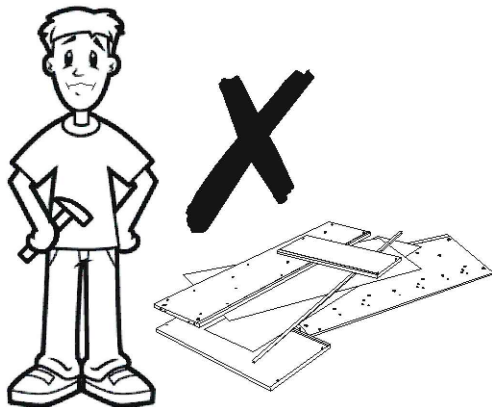
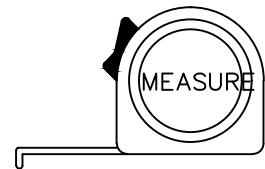

#### Carton 1 of 3

No.	Part List	Pcs
01	Right End Panel (Bottom)	1
02	Right End Panel (Upper)	1
03	Back Support Panel	1
04	1st Ladder Step	1
05	2nd Ladder Step	1
06	Left Ladder Panel	1
07	Right Ladder Panel	1
13	Left End Panel (Upper)	1
14	Left End Panel (Center)	1
15	Left End Panel (Bottom)	1

#### Carton 2 of 3

08	Front Panel	1
09	Front Panel	1
10	Back Panel (Bottom)	1
11	Back Panel (Upper)	1
12	Front Panel	1
17	Side Rail	4
19	Ladder Support Rail	4

#### Assembly Instructions + Fitting List

#### Carton 3 of 3

16	Center Support Rail	1
	LVL Slats	30

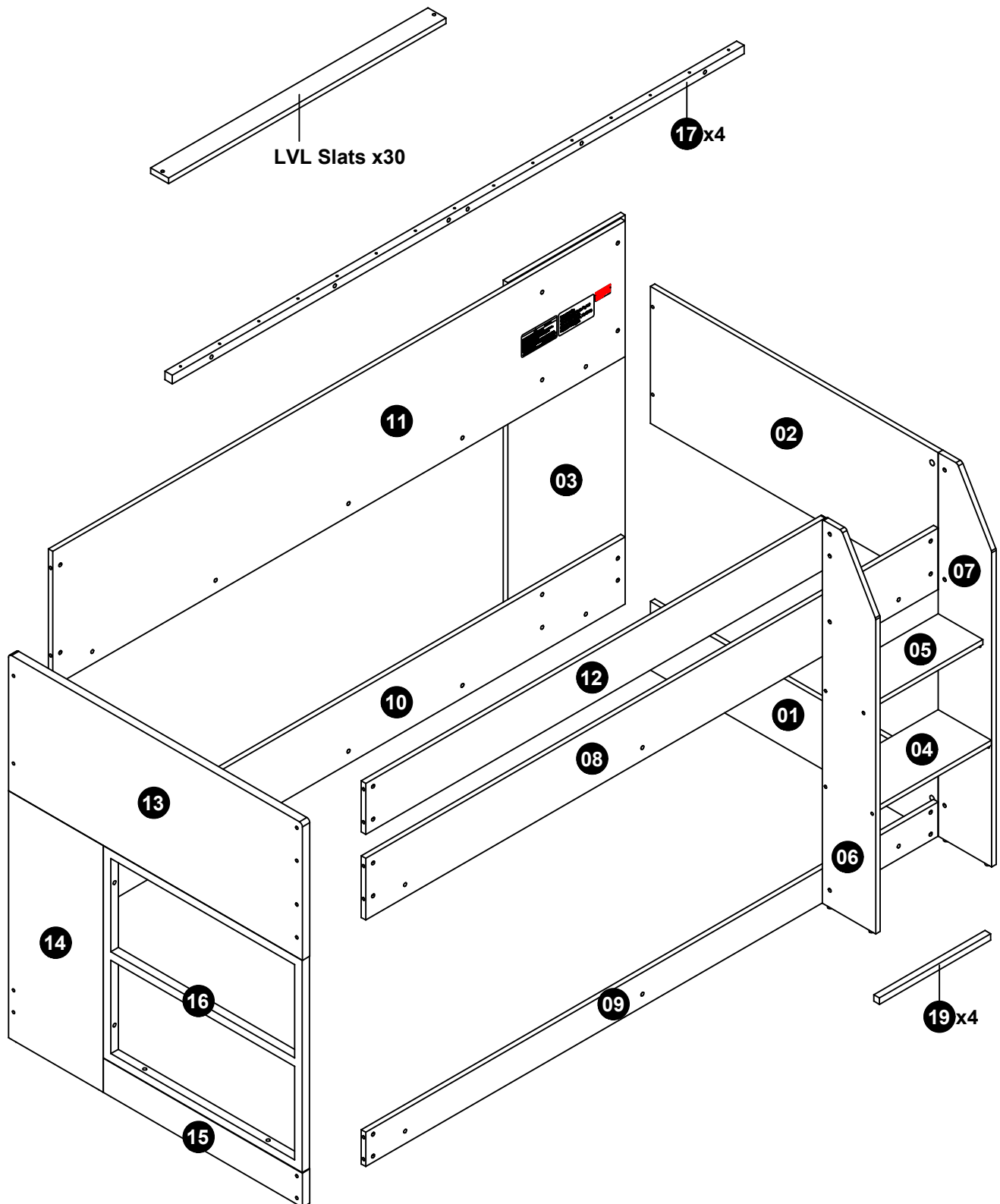

### Carton 2 of 3

### Fitting List

No.	Part Name		Pcs
A	Cam Stud (small)		4
B	Cam		7
C	M8 x 25mm Wood Dowel		15
D	M8 x 50mm Wood Dowel		7
E	45mm Chipboard Screw		4
F	M6 Round Nut		22
G	M6 x 60mm Allen Bolt		16
H	M6 x 50mm Allen Bolt		14
J	M6 x 40mm Allen Bolt		8
K	M6 x 35mm Allen Bolt		18
L	M6 x 30mm Allen Bolt		60
M	M6 x 25mm Allen Bolt		4
N	M6 x 12mm Allen Bolt		8
P	M6 JCN Nut		16
Q	Metal Plate (MG 024)		4
R	M6 Allen Wrench		2
S	M6 x 13mm Baller		9
T	Contractfix Dowel		3

### Caution

There are many small components used in the construction of this unit. These loose items should be kept away from young children whilst assembling your unit. As an extra precaution, screw cover caps should be permanently fixed in position. (Where applicable)

### USEFUL HINTS & TIPS

Two people will be required to assemble this unit

Please keep this assembly instruction for future reference

1

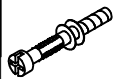

A x 4



S x 3



B x 7

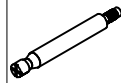

T x 3

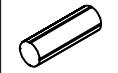

C x 15



F x 4

#### WHEN FITTING CAMS

ENSURE STARTING POSITION IS CORRECT  
BEFORE YOU INSERT CONNECTING BOLT  
TURN CLOCKWISE UNTIL SECURE

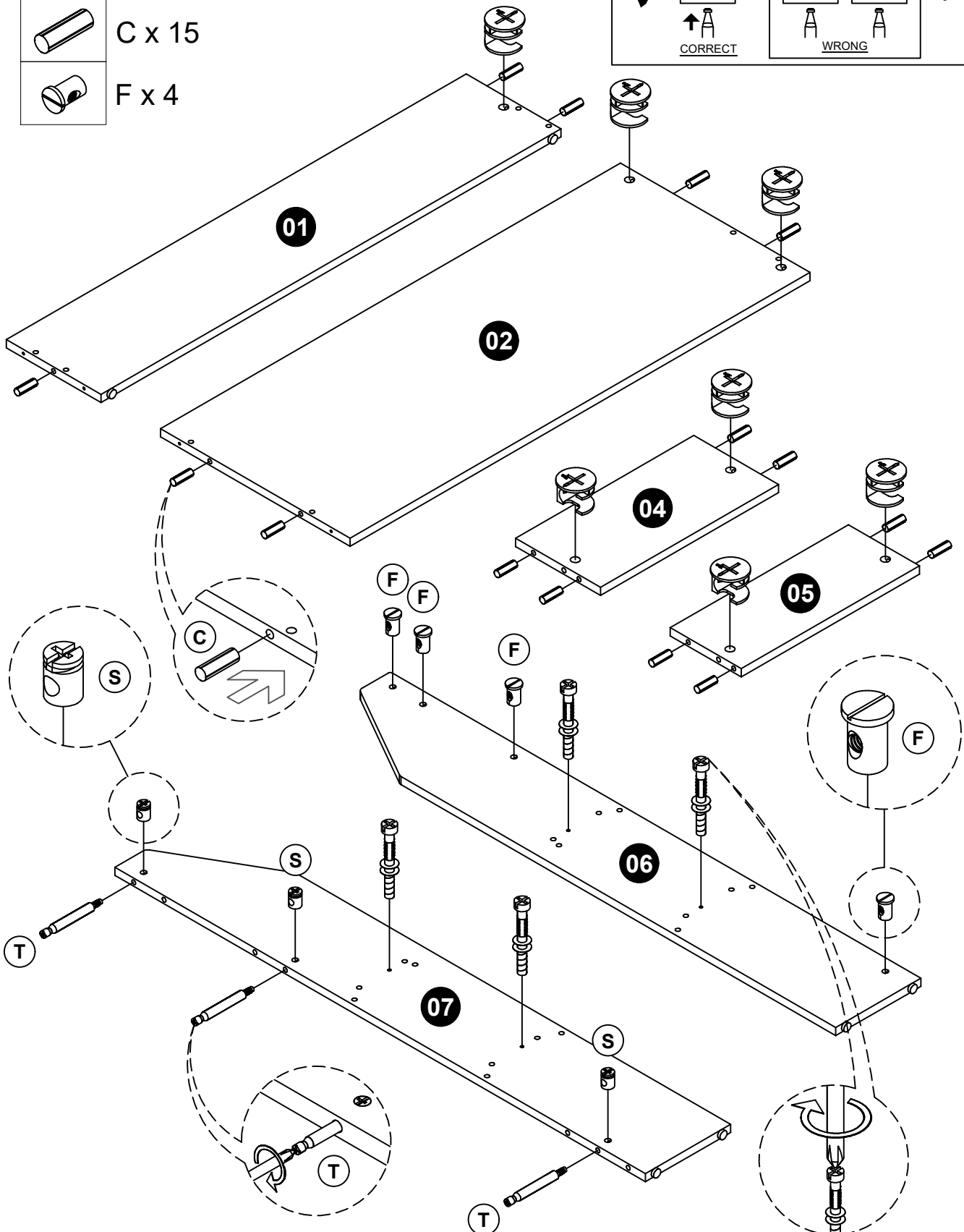
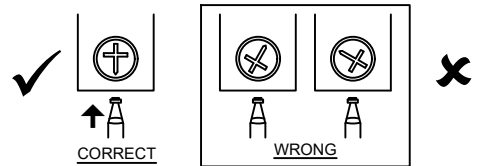

2

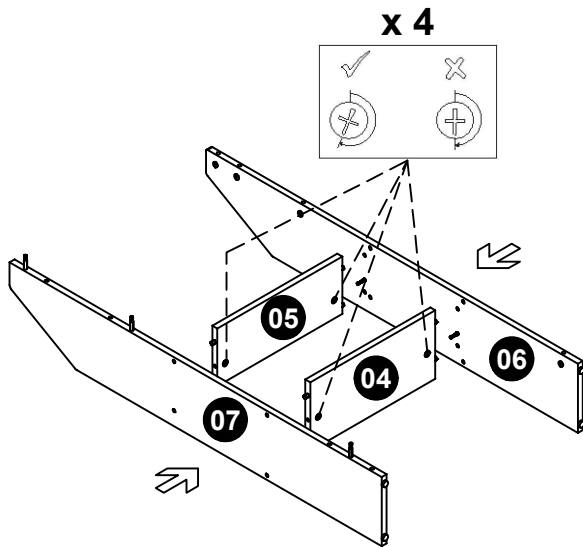

3

 **J x 8**

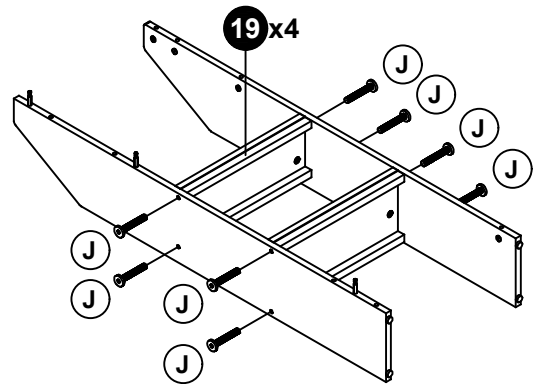

4

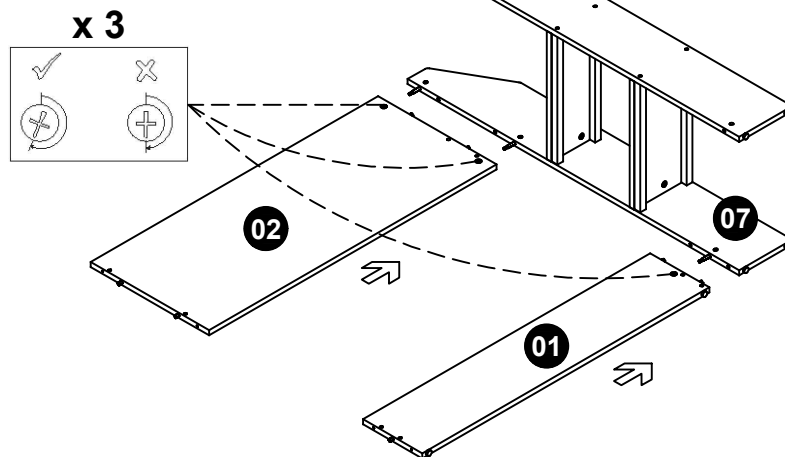

5

 **E x 4**

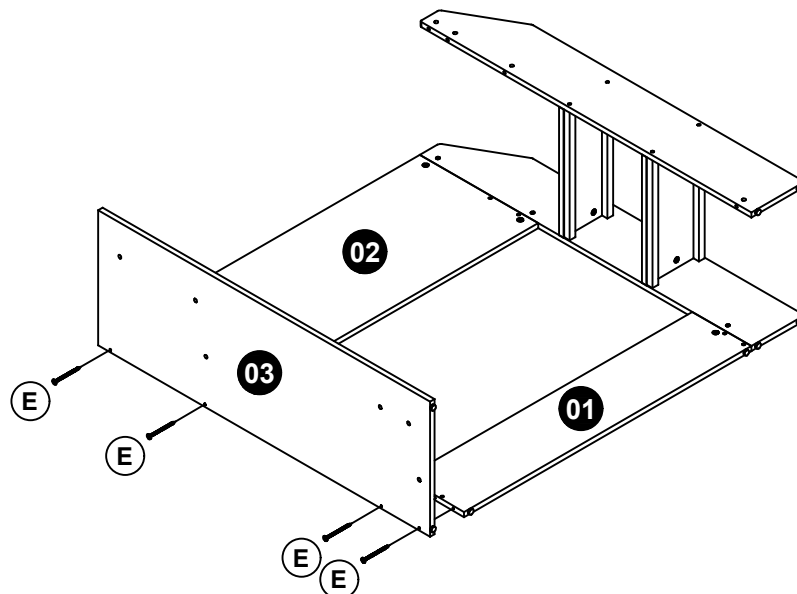

6

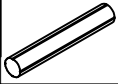

D x 7



S x 6

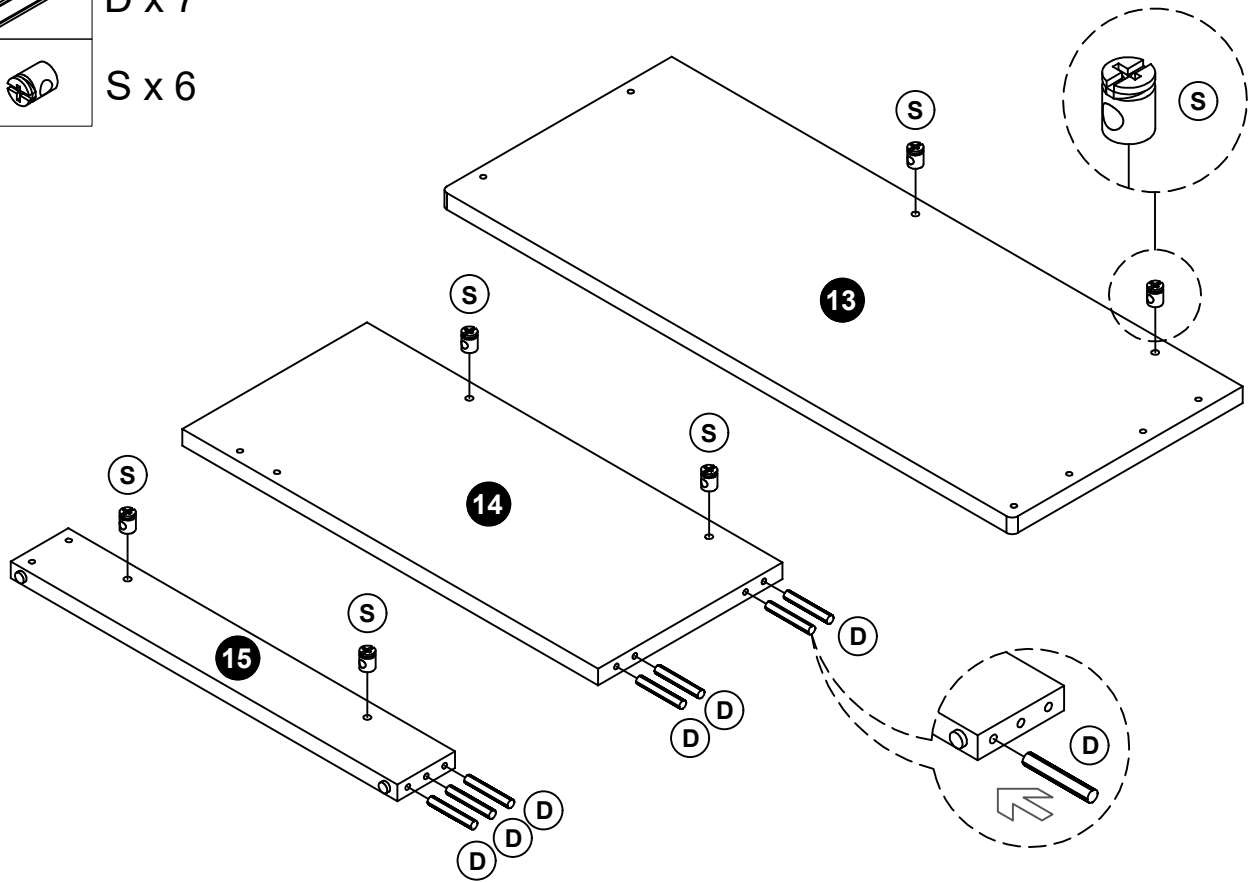

7

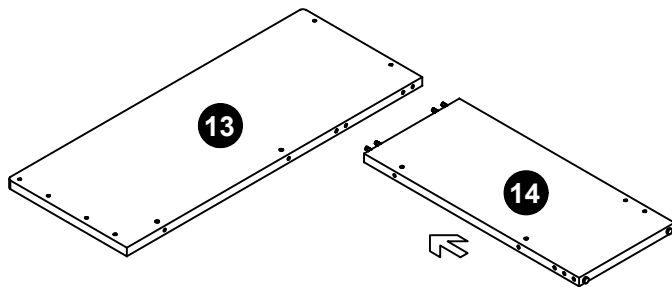

8

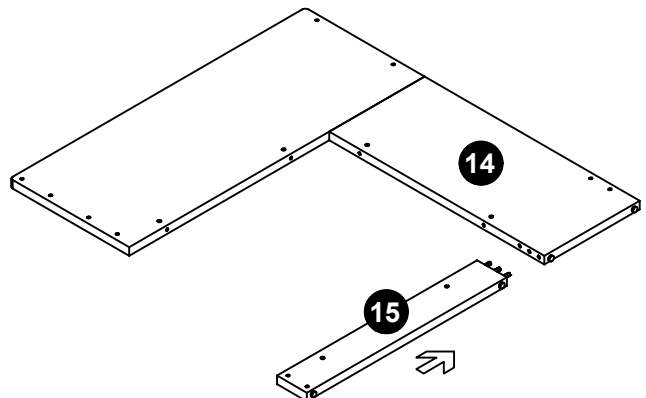



9



G x 2

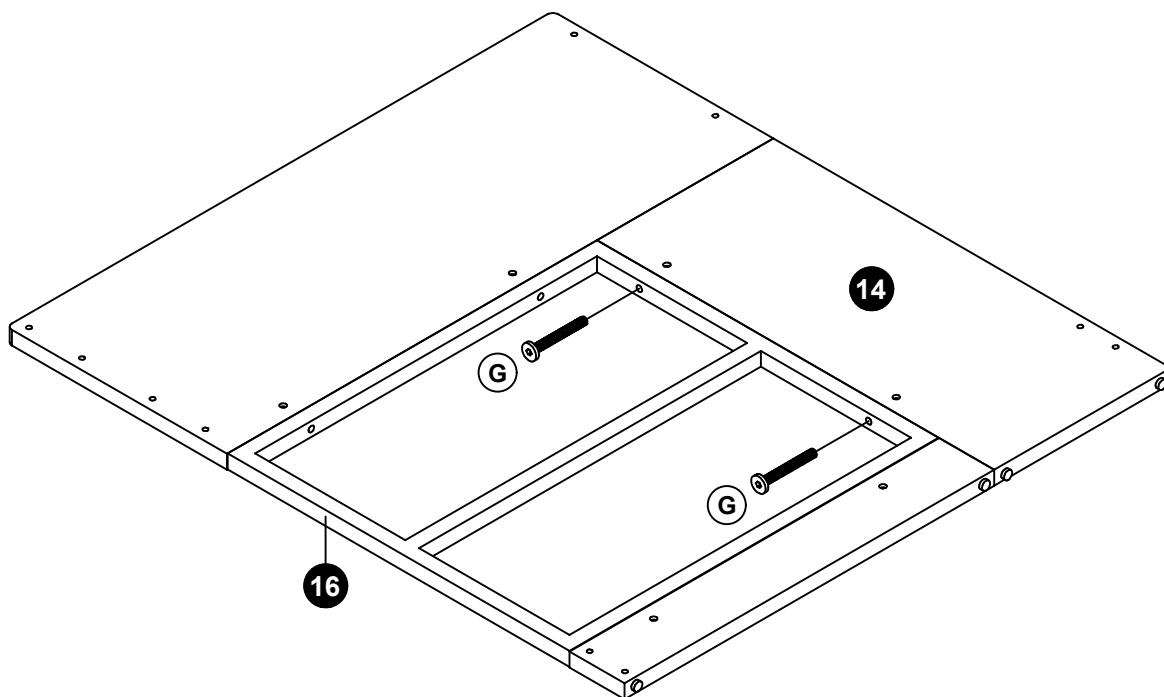

10



G x 4

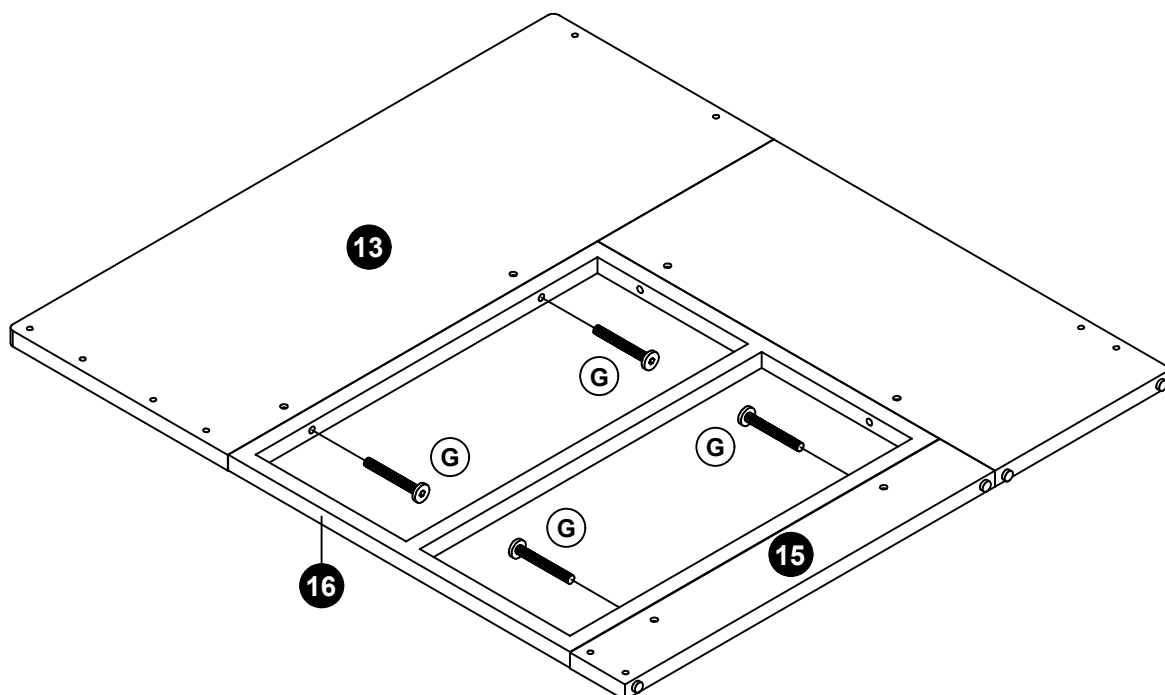

11



F x 18

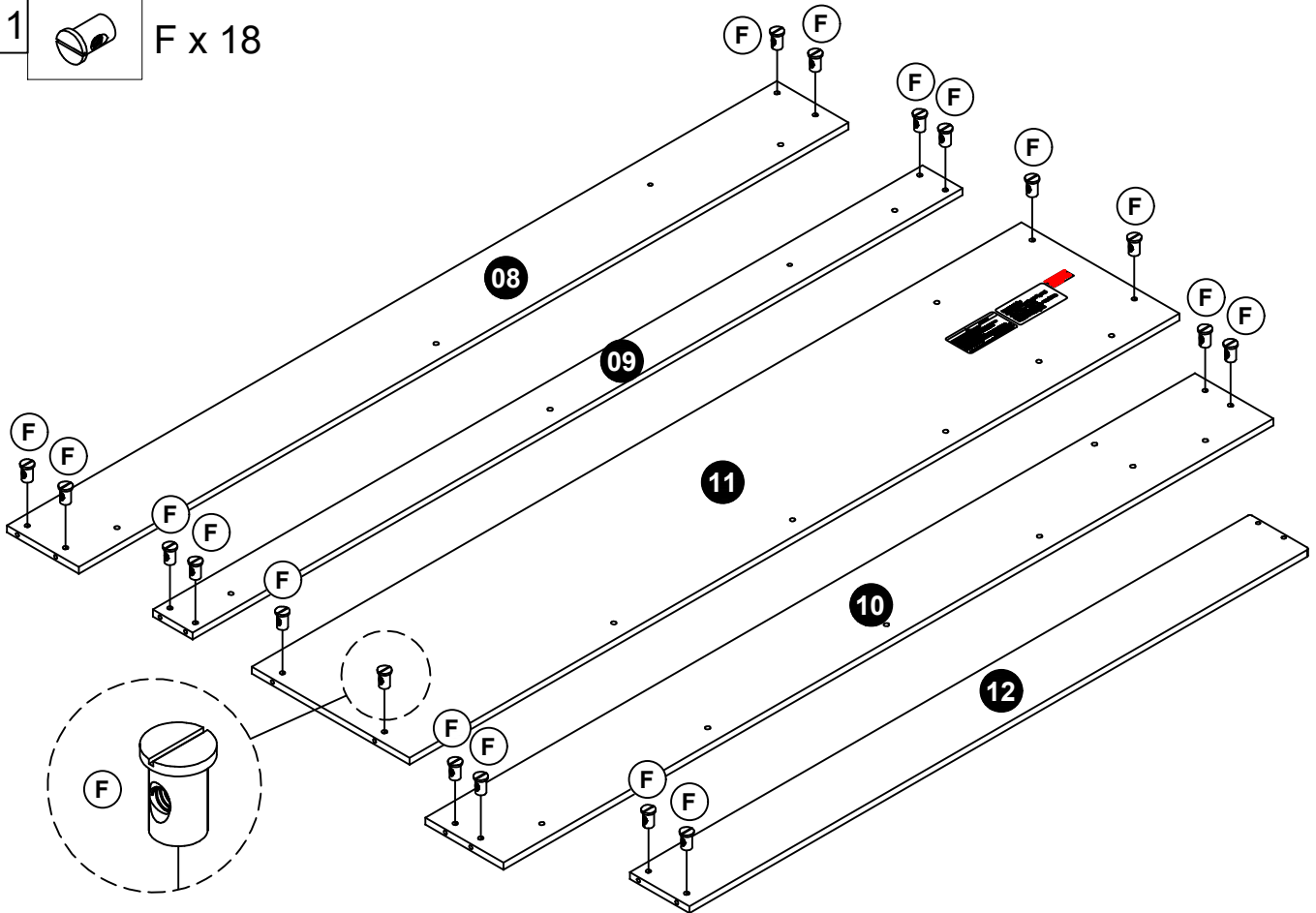

12

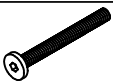

G x 4



H x 4



M x 4



P x 4

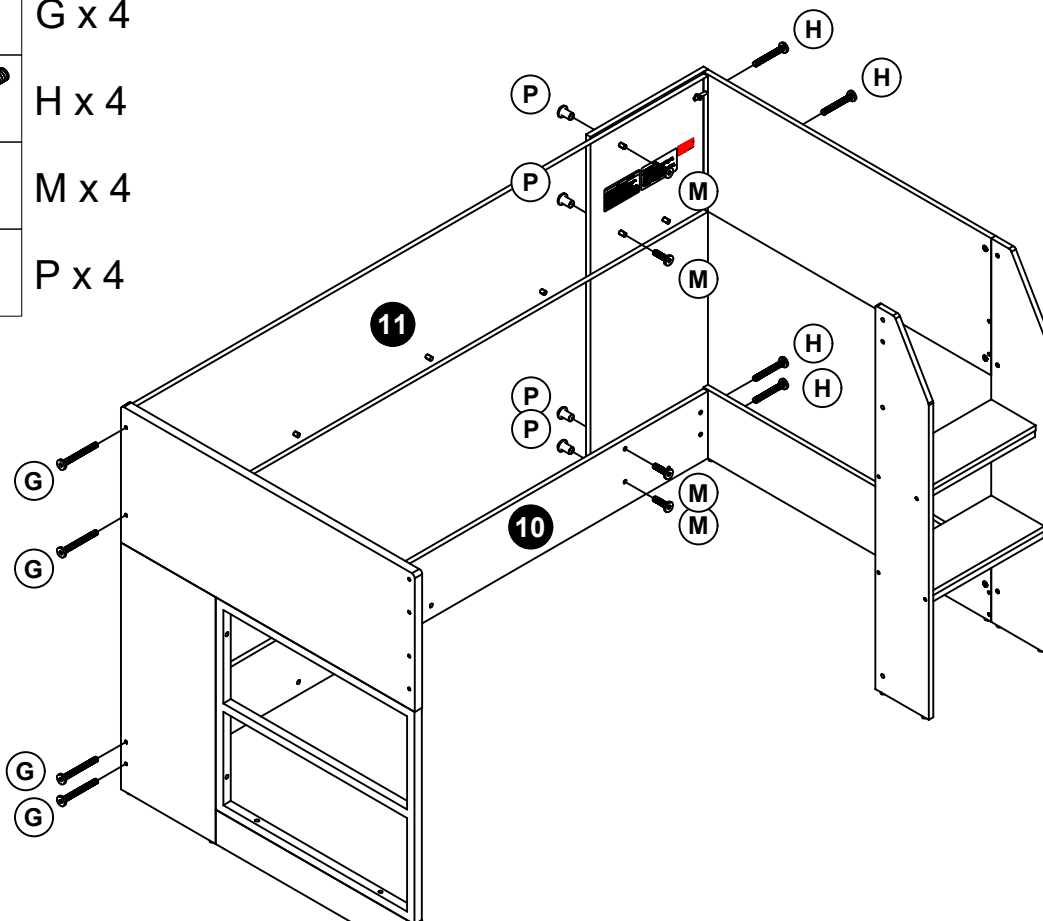

13



H x 2



K x 8



P x 6

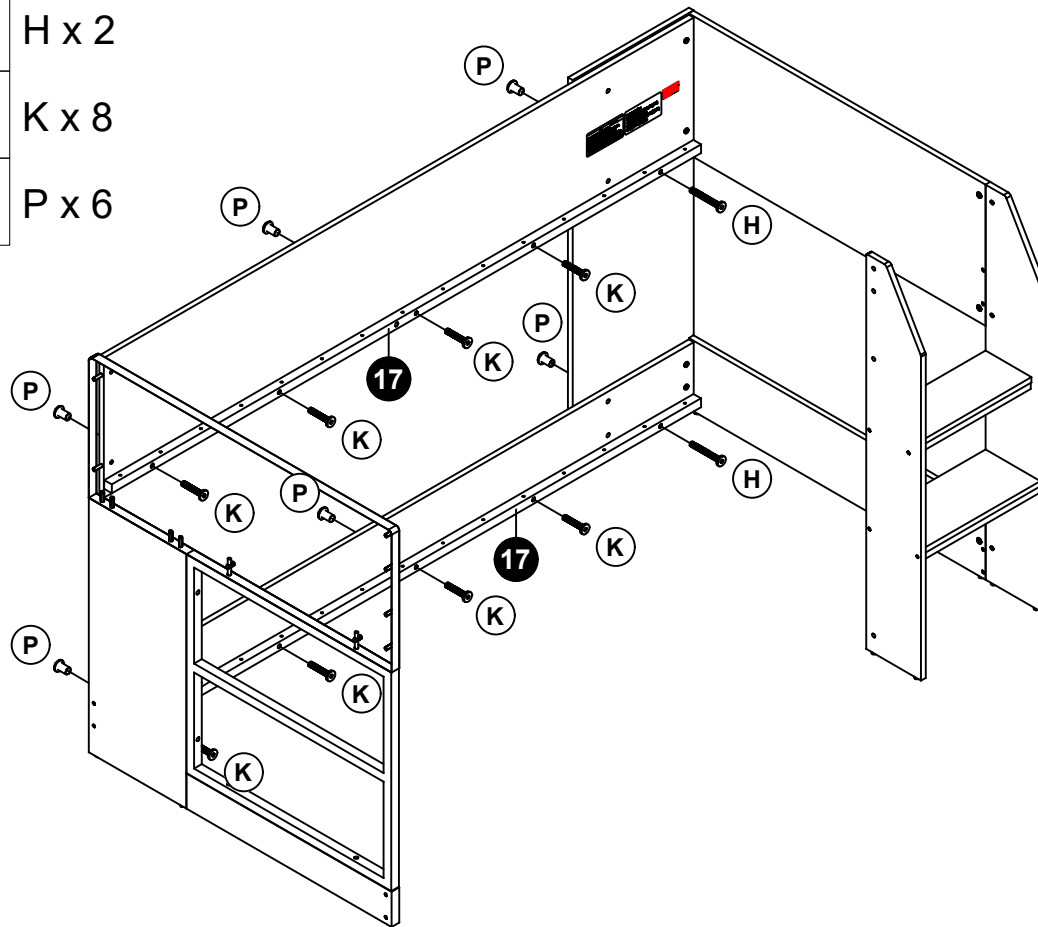

14



G x 6



H x 7

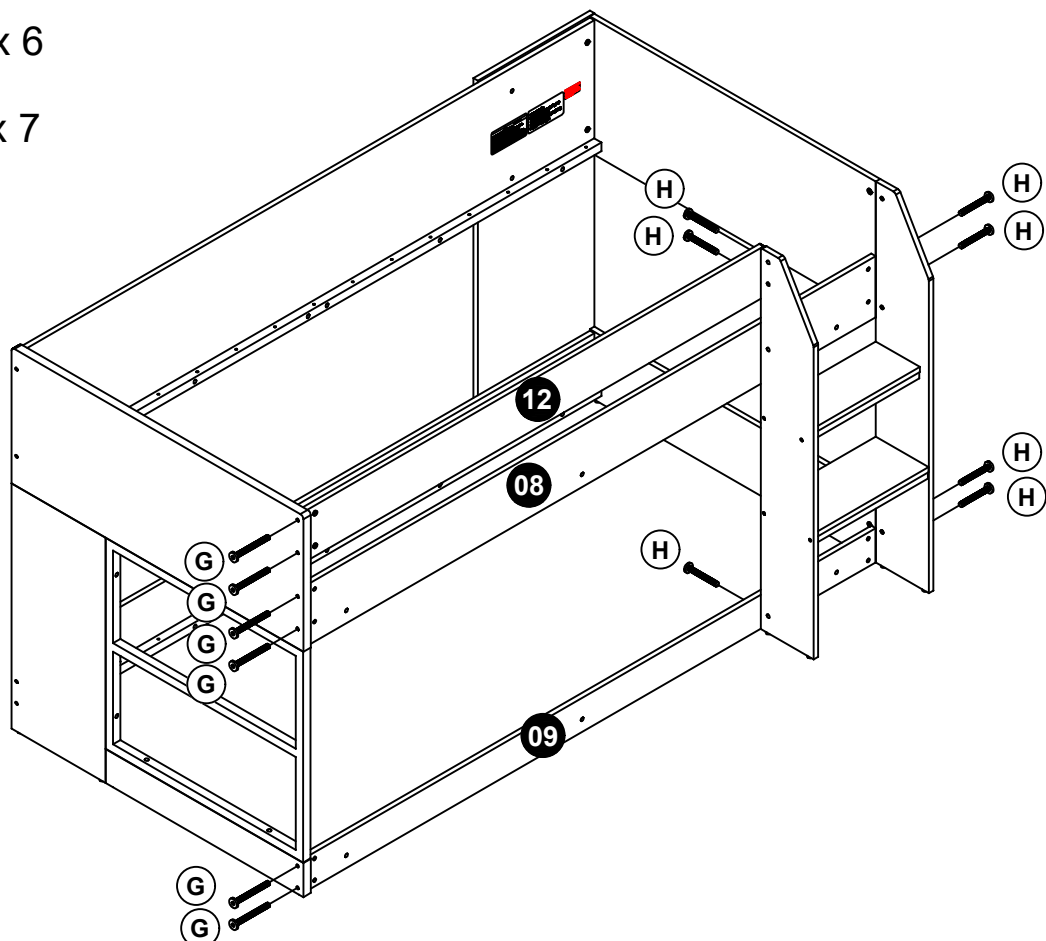

15



H x 1



N x 8

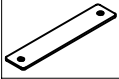

Q x 4

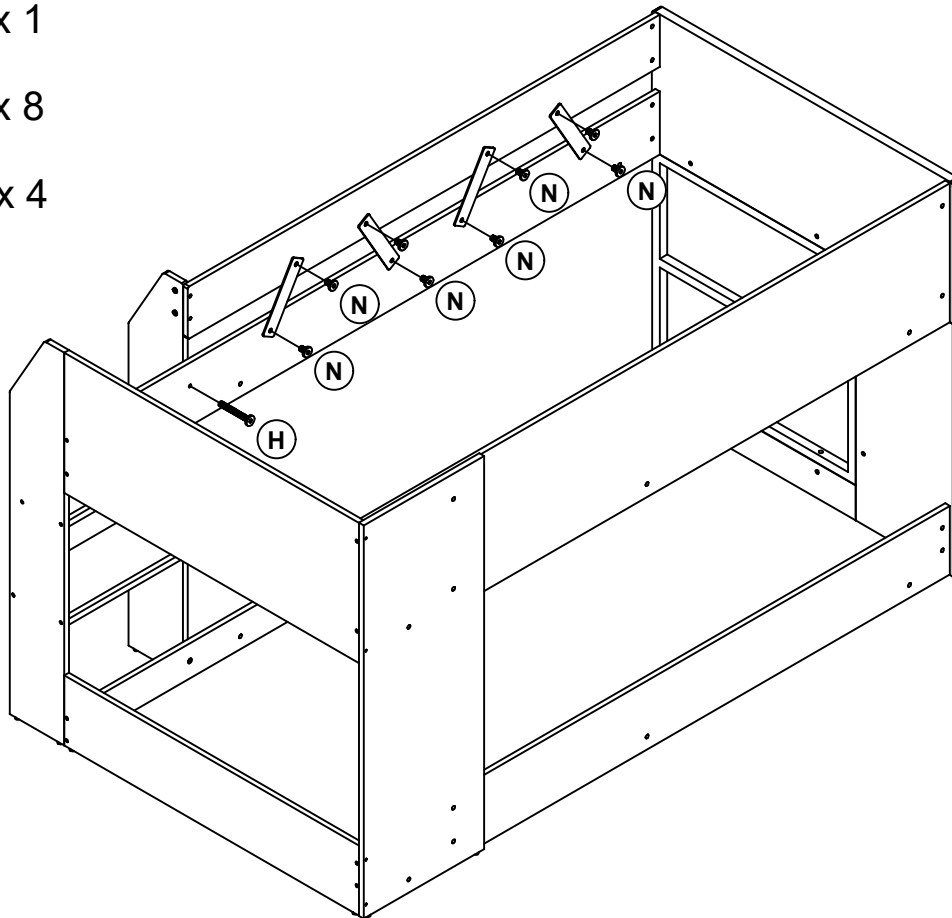

16



K x 10



P x 6

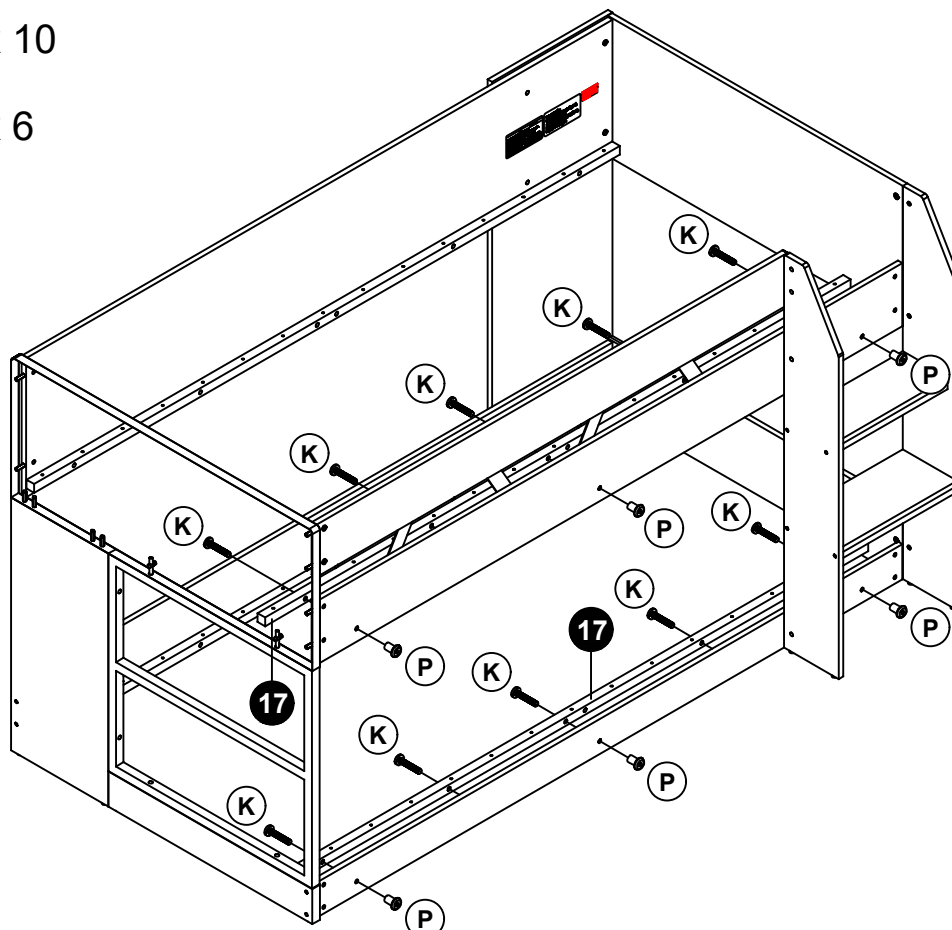

17



L x 60

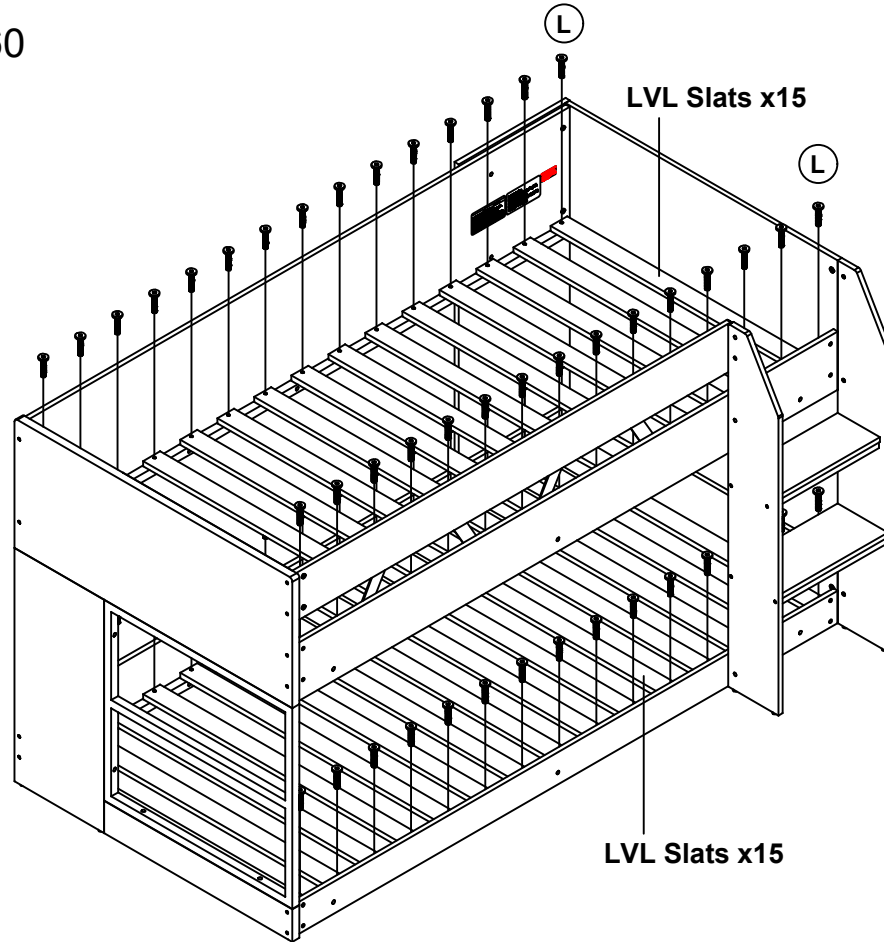

18

