

Azra Accent Chair

76 x 89 x 82cm

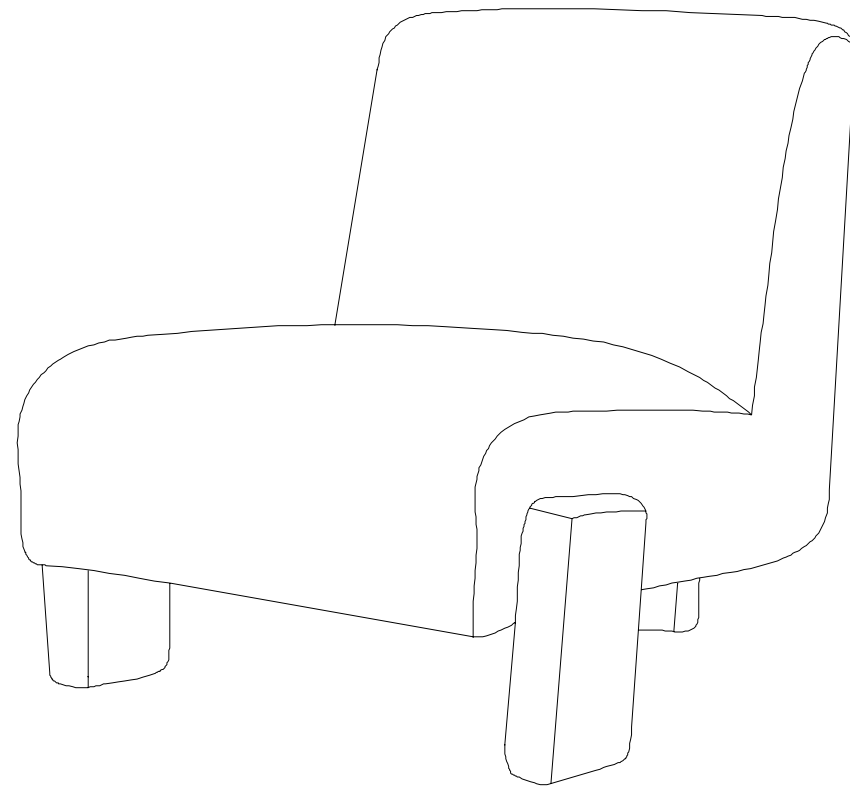

READ THE MANUAL
It will help you get the best out of your product.
ANY QUESTIONS?
Call (03) 9904 2900



Assembly Instructions

Hardware List

 A x2	 B x1	 C x1
-------------	-------------	-------------

 1 x10	 2 x10	 3 x10	 4 x10	 5 x1
--------------	--------------	--------------	--------------	-------------

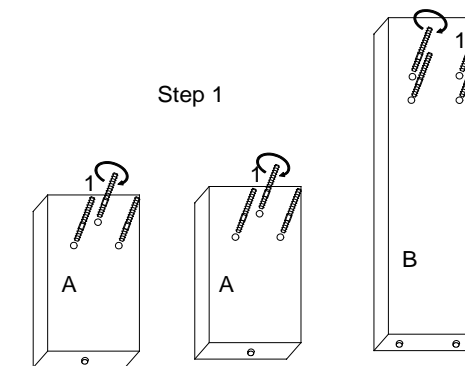

Step 1

Insert the short end of Bolt (1) into the holes on the Leg (B & C).
Turn the bolt clockwise until tight.

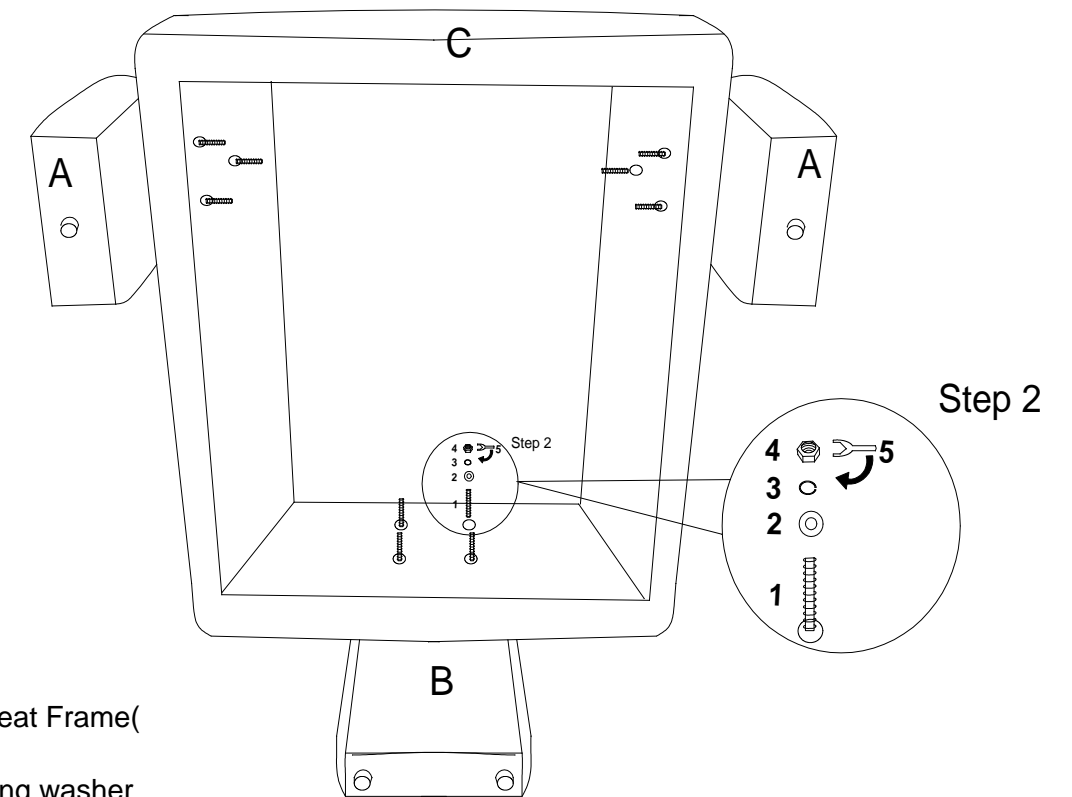

Step 2

Attach the Legs (A & B) the Seat Frame (C)
By using Flat washer (2), Spring washer (3), and Hexnut (4).
Tighten all Hexnuts (4) using Wrench (5).