

WARNING

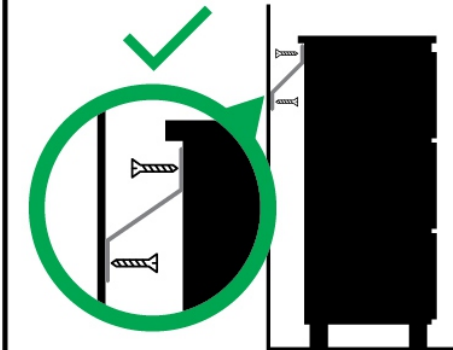

Children have died from furniture tipover.

- ALWAYS secure this furniture with an anchor device.
- NEVER allow children to stand, climb or hang on drawers, doors, or shelves.
- NEVER open more than one drawer at a time.
- Place heavy items down low.

NEVER put a TV on this furniture



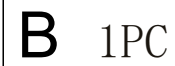

Assemble A and B, C and D according to the diagram's indication. Use appropriate screws to secure the connections.

Attach CR, DL, and DR to the appropriate sides of the structure. Secure them with screws to ensure stability.

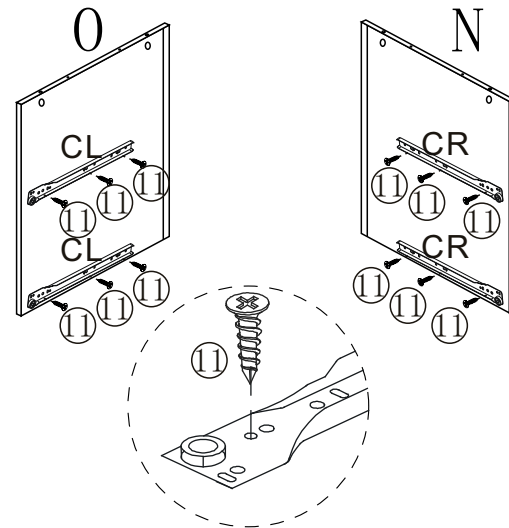

Install Side Panels

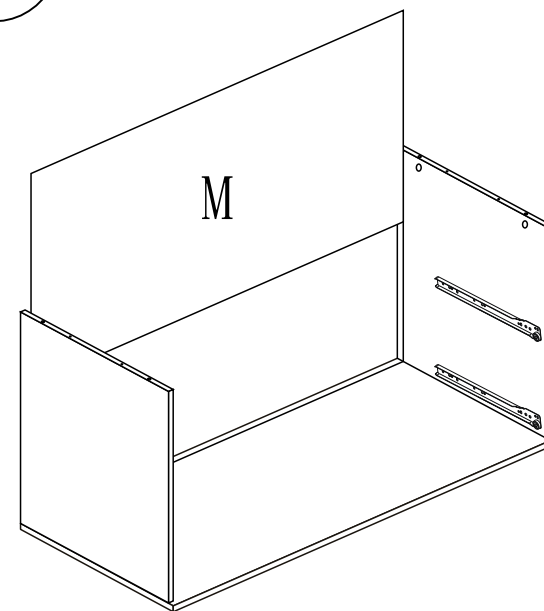

Use screws to secure the connections, ensuring they are level.

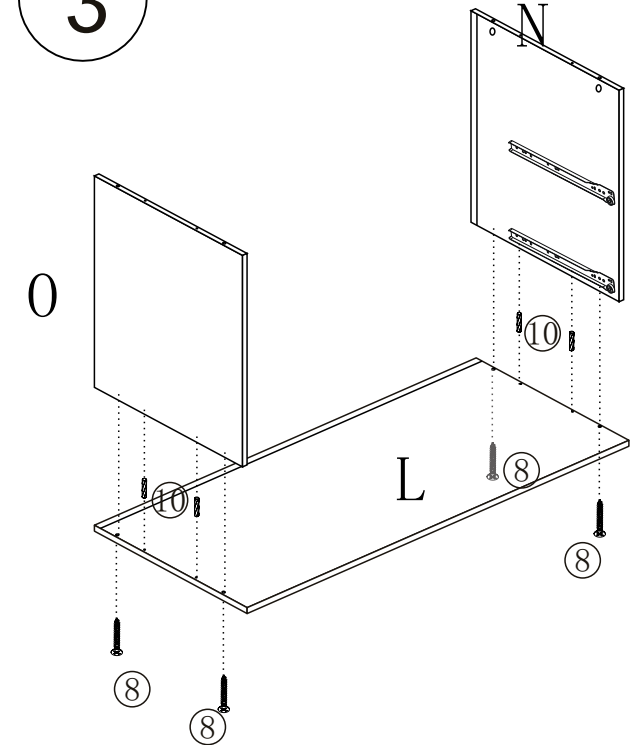

Use screws to secure the connections.

6

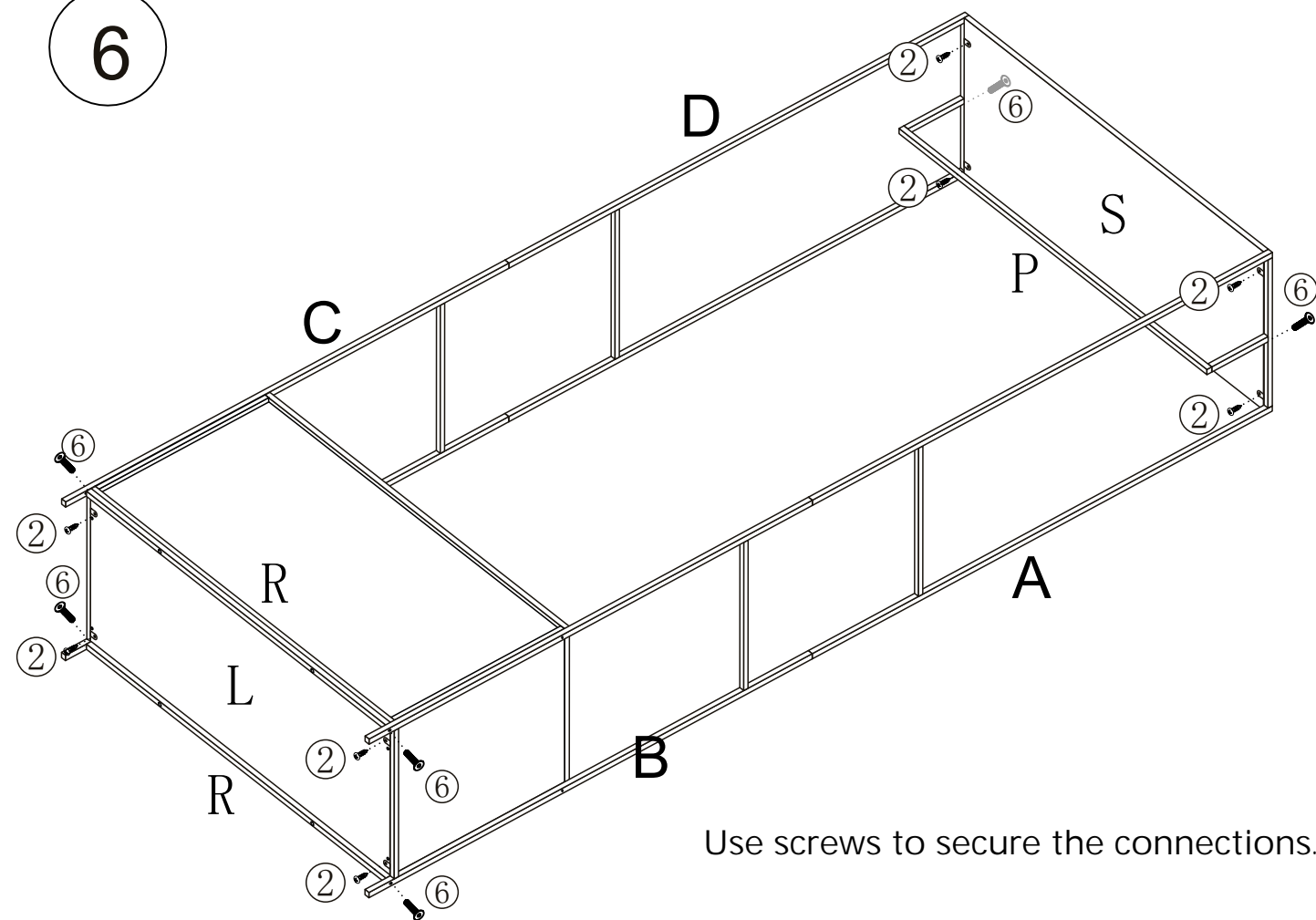

8

Assemble these componet shown in the diagram. Use screws to secure the connections, checking that they are firmly attached.

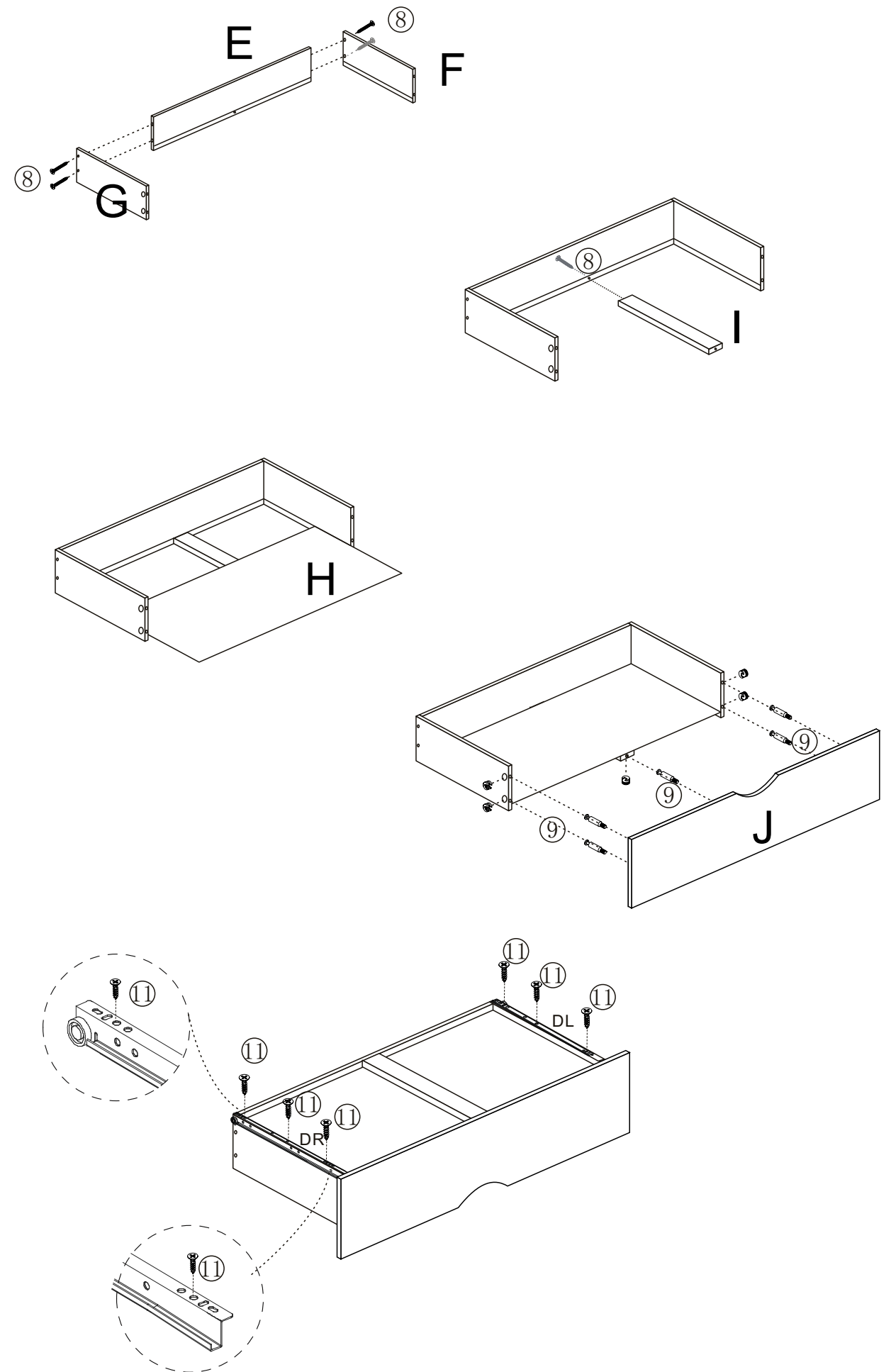

7

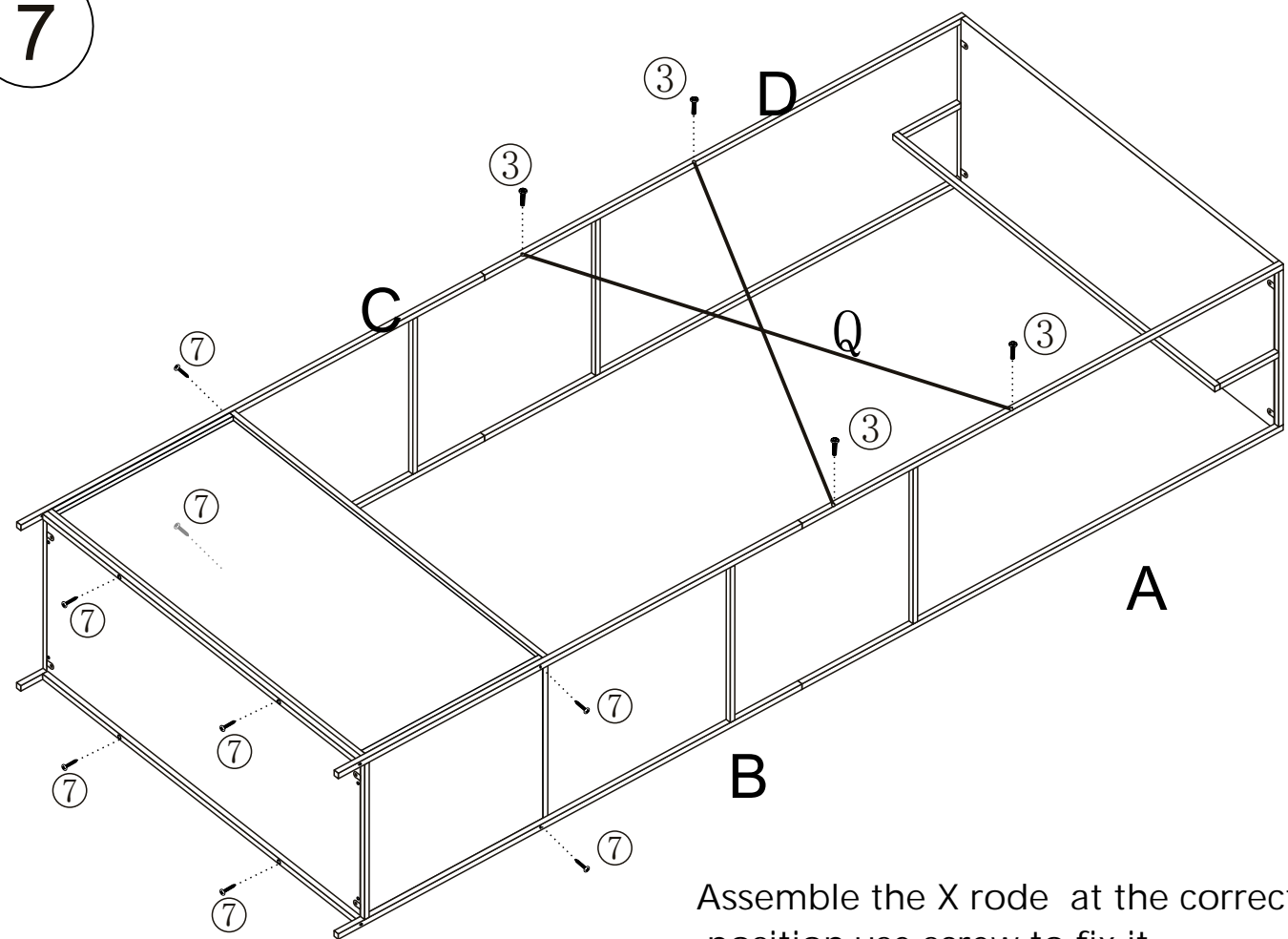

9

install the drawers into the main structure, ensuring they fit properly and can function smoothly.

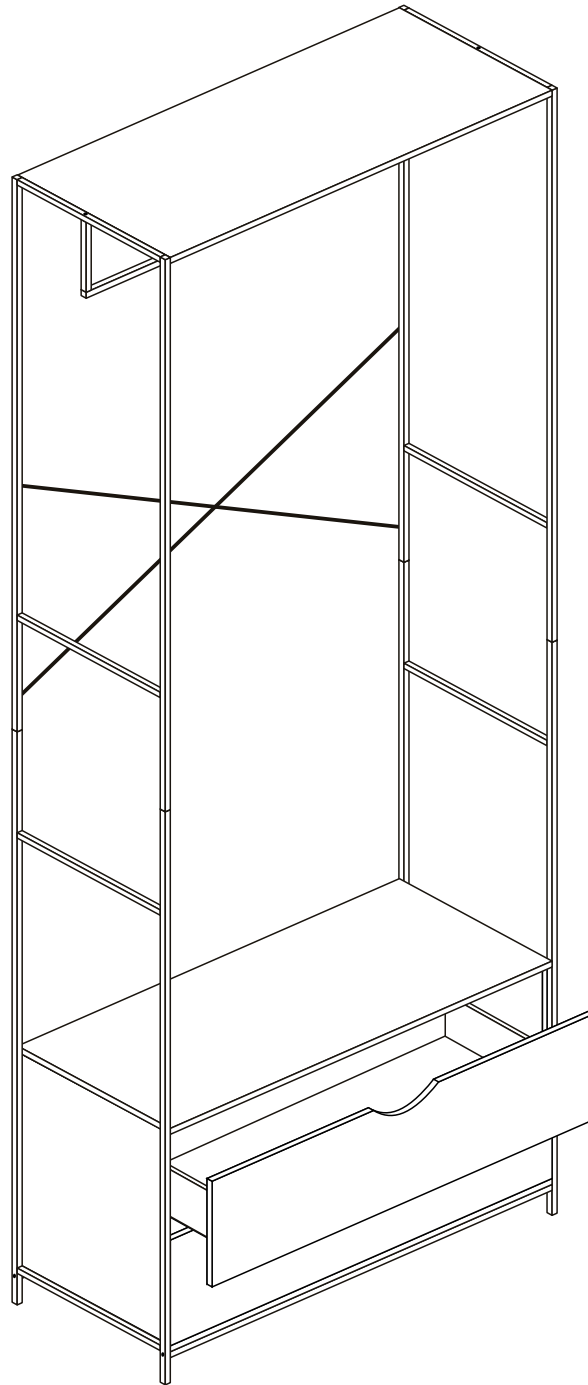

10

1. Mark the drilling holes.
2. Drill holes in the marked.
3. Install the anchor devices into the drilled holes.
4. Ensure the furniture is firmly anchored to the wall to prevent tipover.

