

WARNING

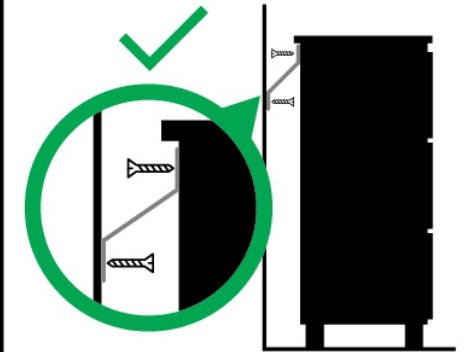

Children have died from furniture tipover.

- ALWAYS secure this furniture with an anchor device.
- NEVER allow children to stand, climb or hang on drawers, doors, or shelves.
- NEVER open more than one drawer at a time.
- Place heavy items down low.

**NEVER put a TV
on this furniture**



1

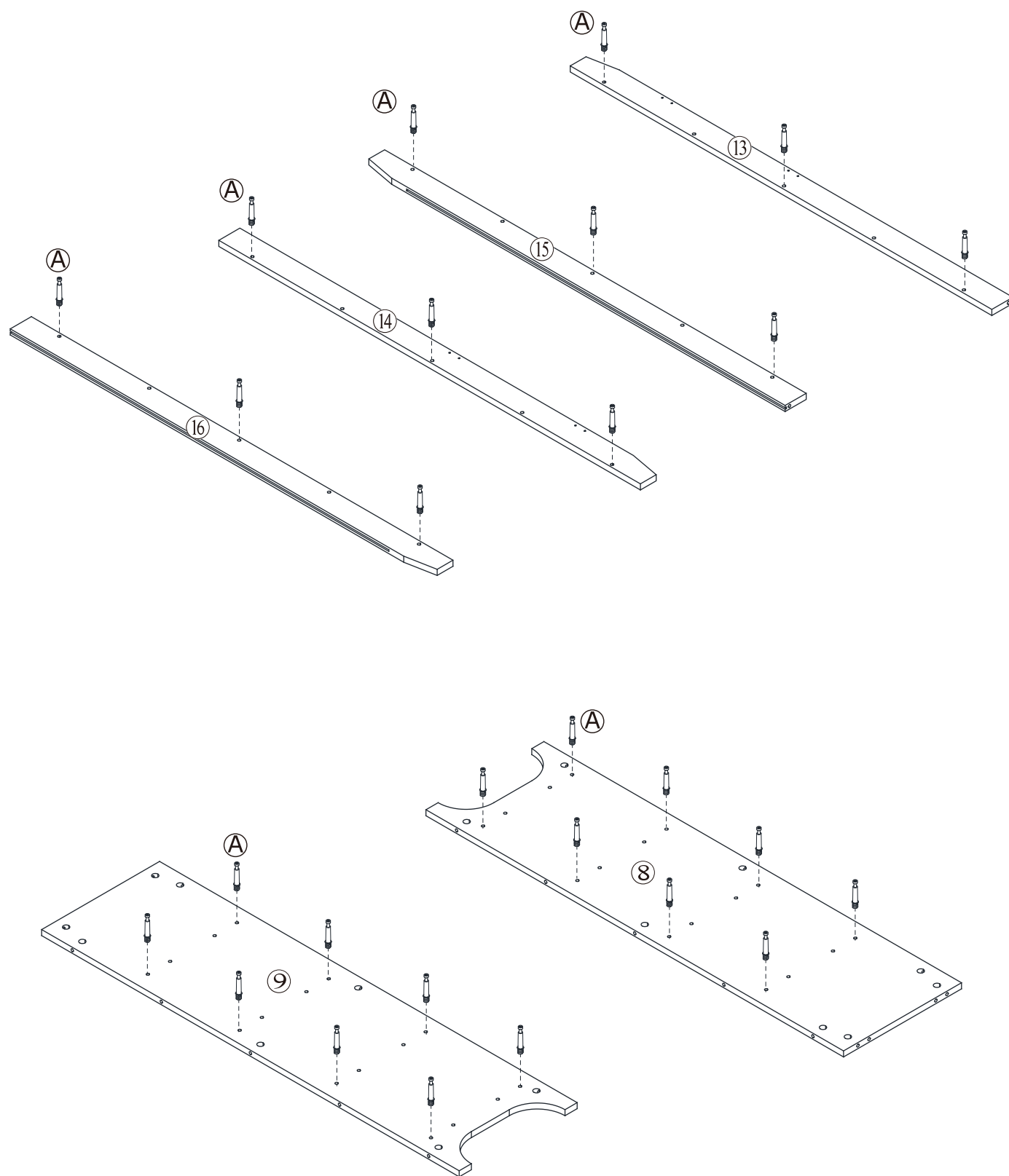

Assemble the parts in the manner shown. Use A screws to secure the connections.

2

Assemble the parts in the manner shown. Use screws to secure the connections.

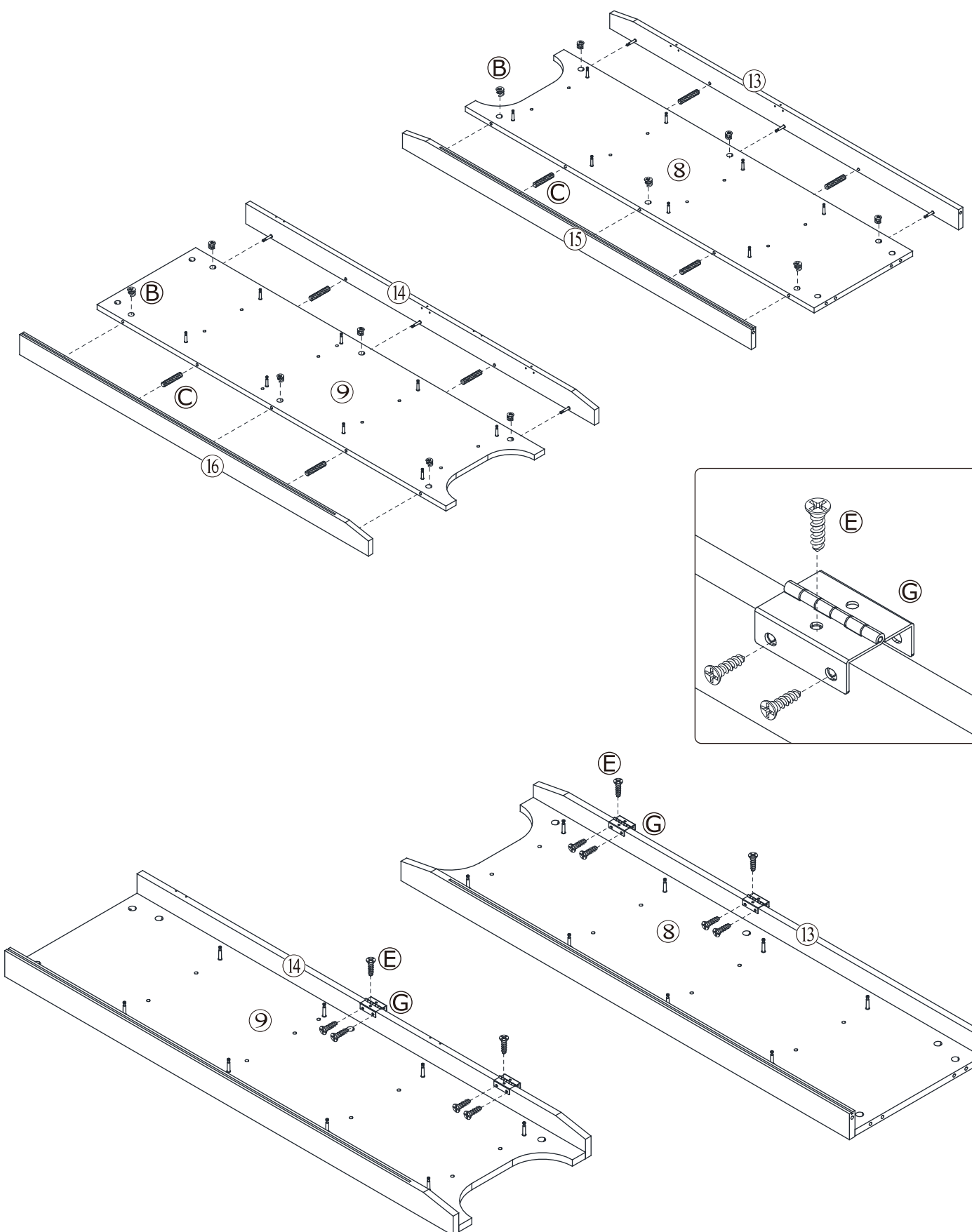

3

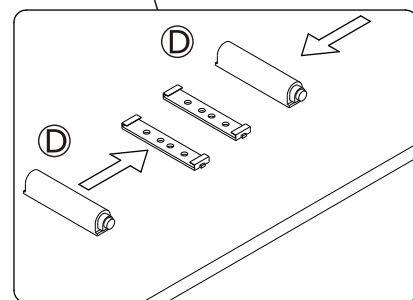
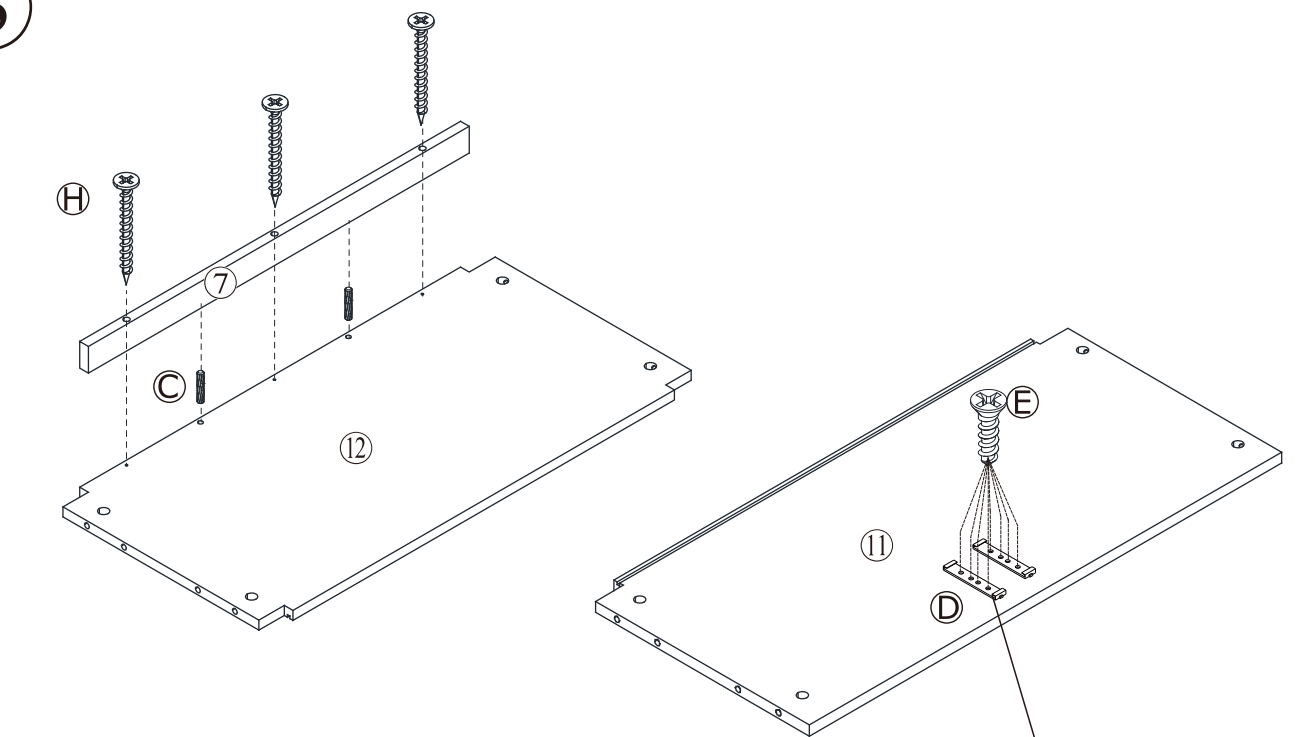

1. Take part D (2 PCS) and position them on both sides of the base structure assembled.
2. Secure D to the base structure using E screws.

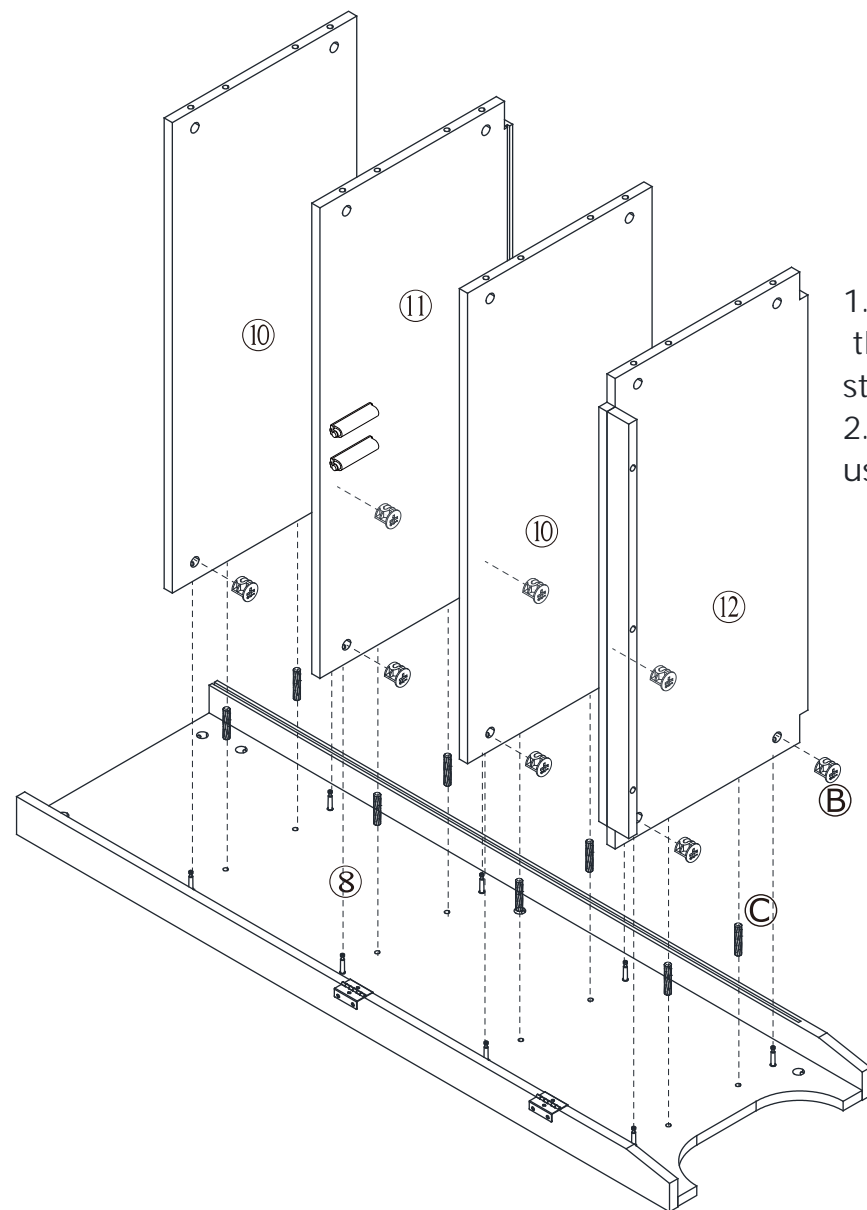

4

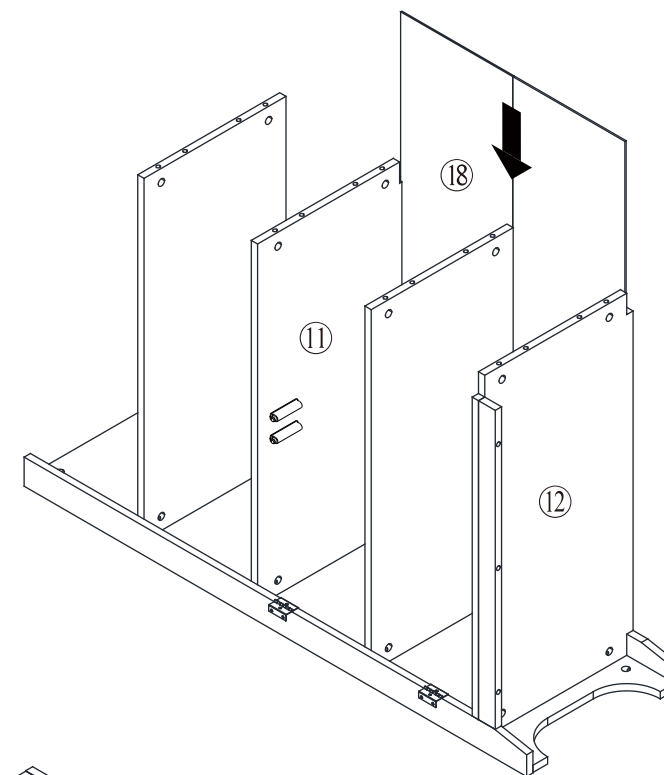

1. Install the components into the main structure. Ensure they can slide smoothly and are properly aligned.
2. Use screws to secure the connections.

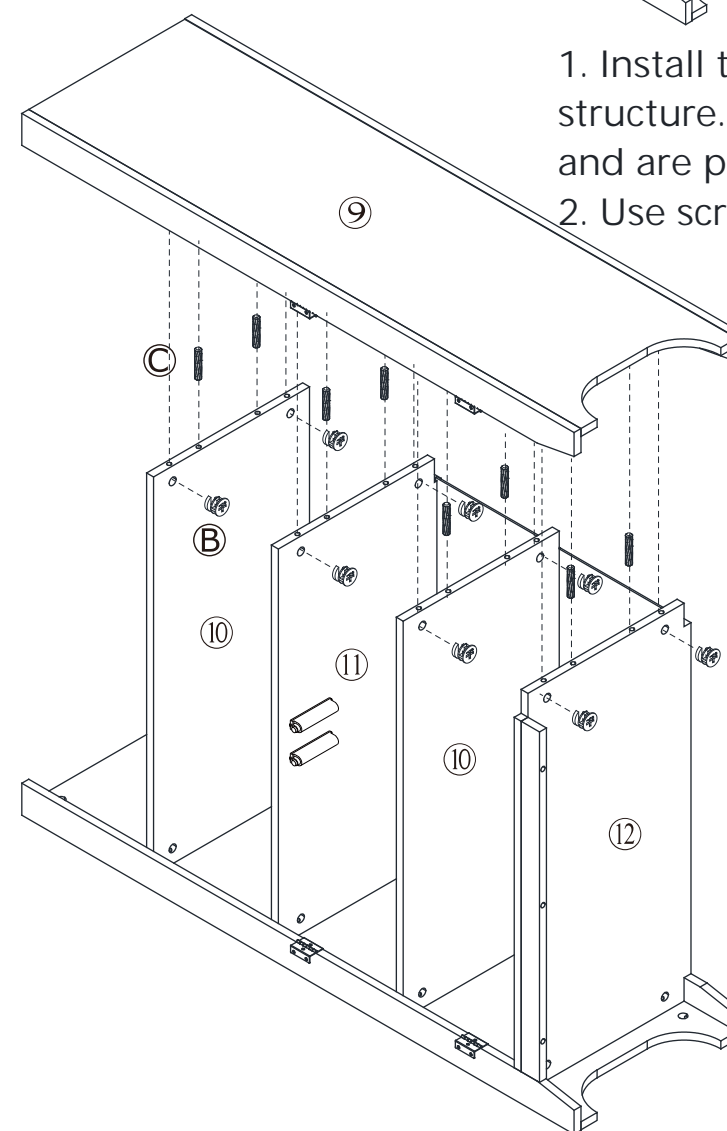

5

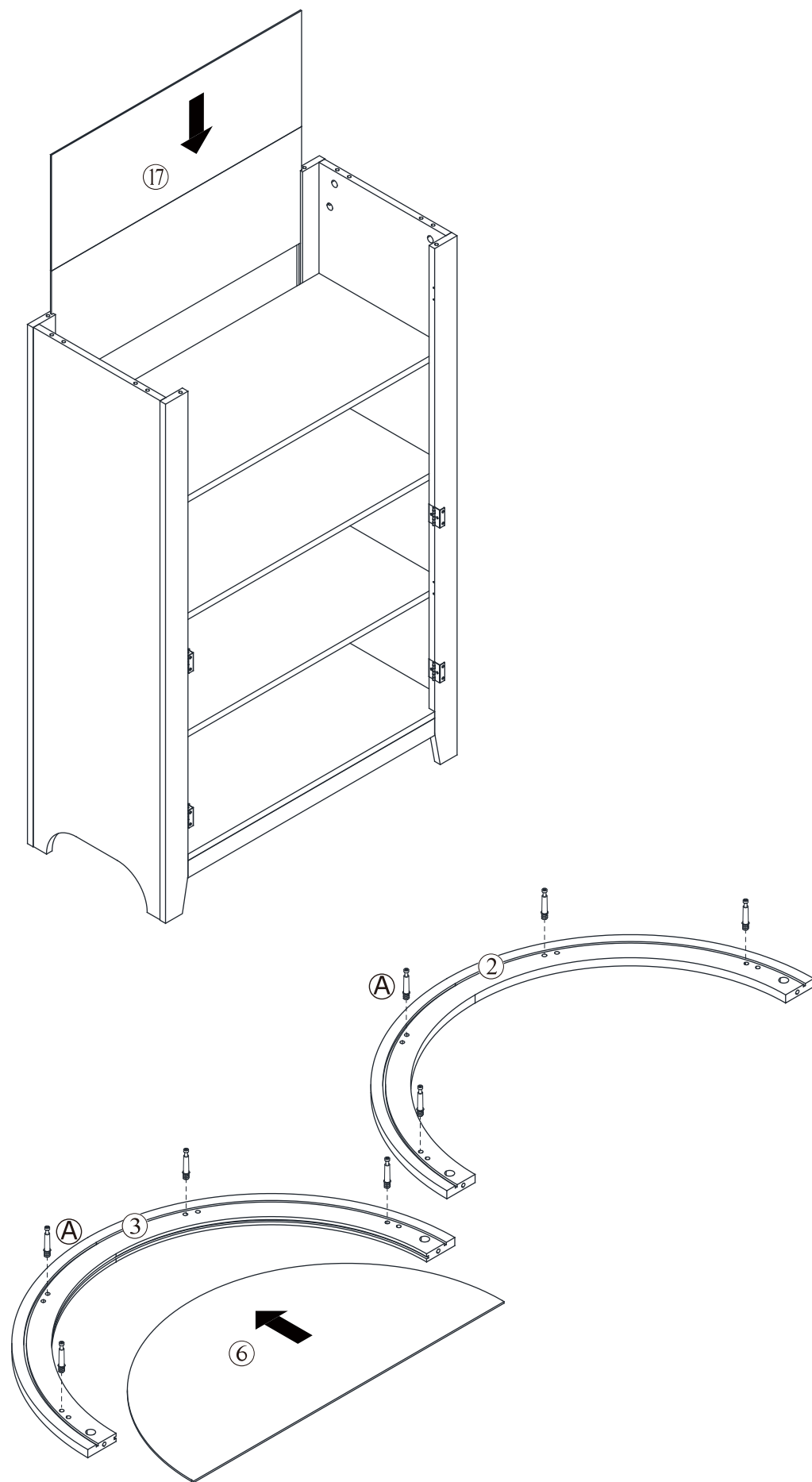

Install the components into the main structure. Ensure they can slide smoothly and are properly aligned. Use A screws to secure the connections.

6

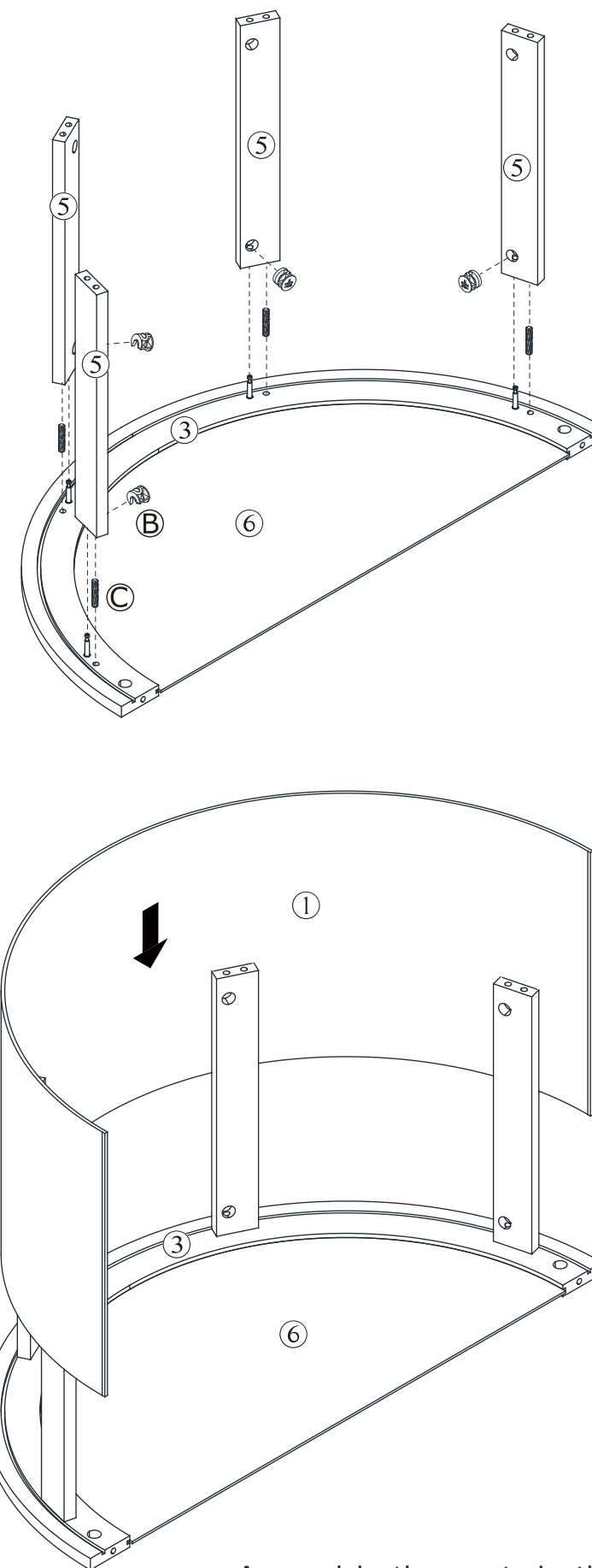

Assemble the parts in the manner shown. Use screws to secure the connections.

7

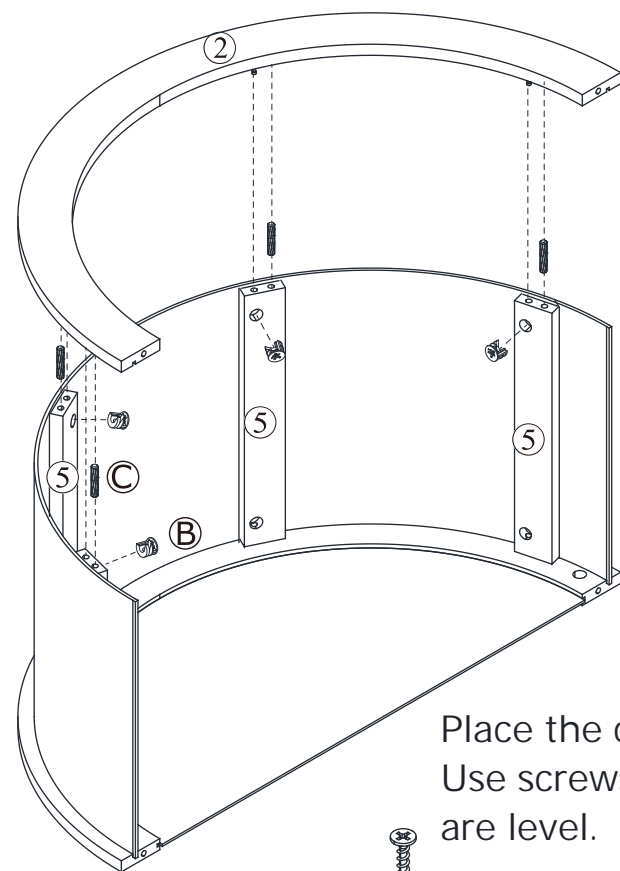

Place the components at the designated positions. Use screws to secure them, ensuring the shelves are level.

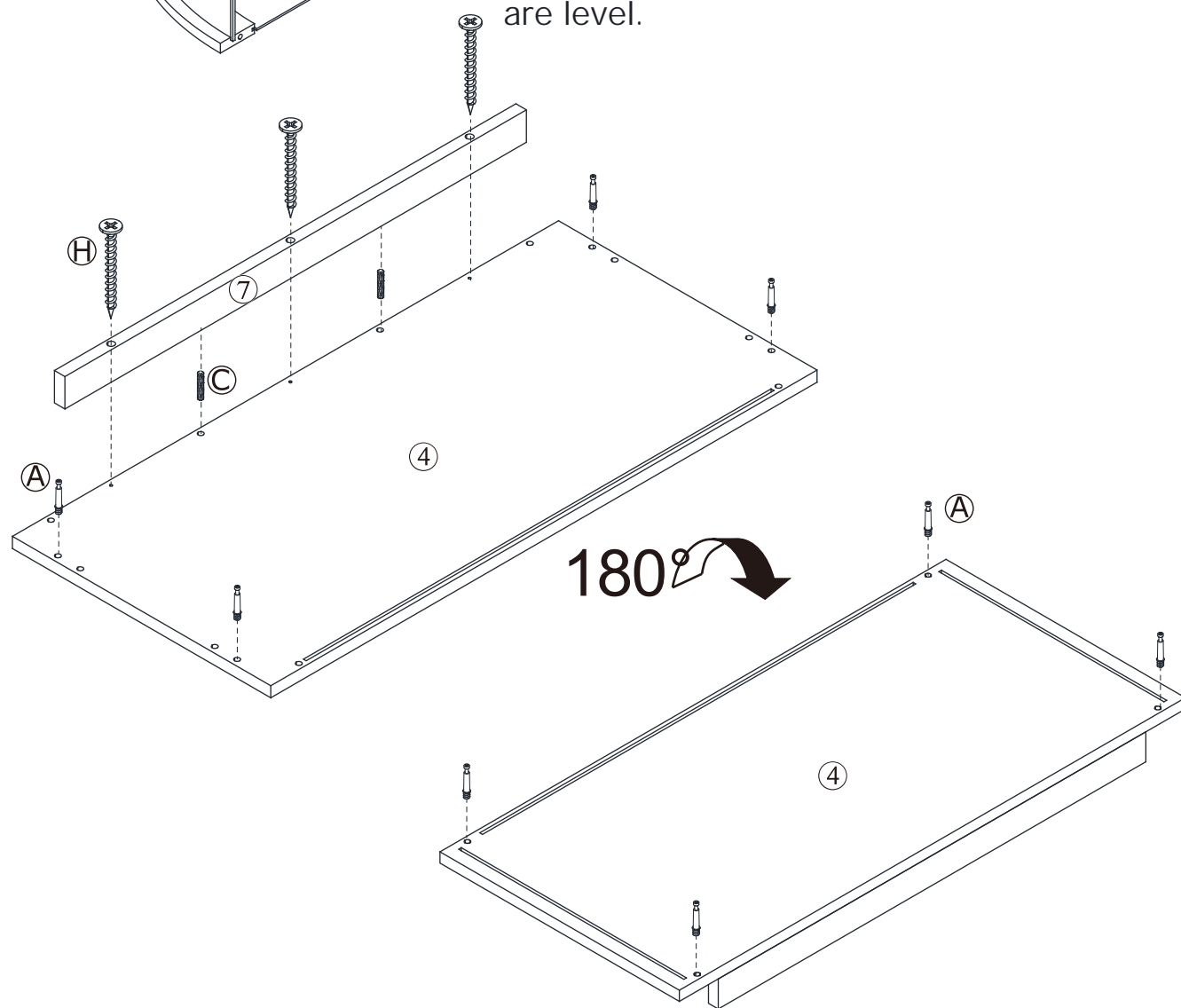

8

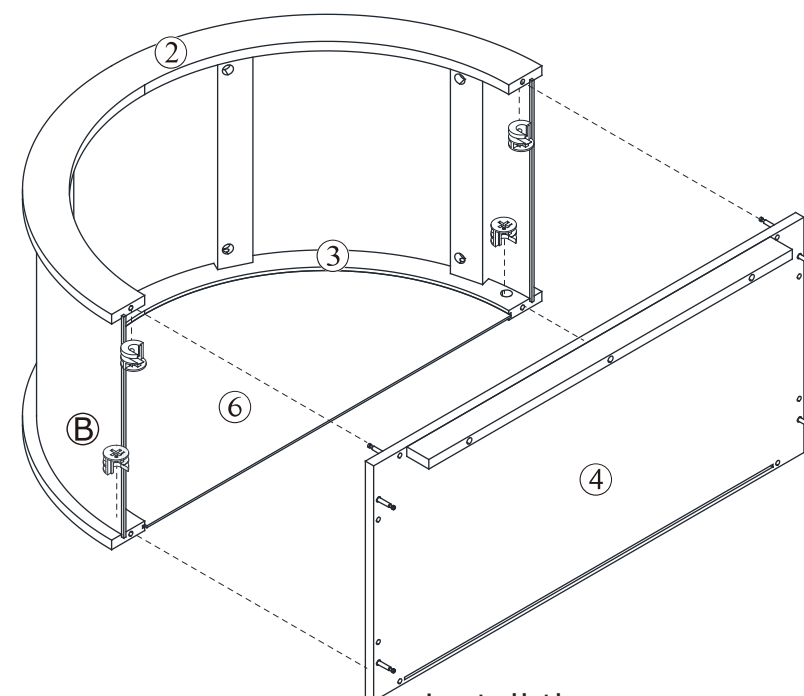

Install the components into the main structure, which finish in step 7. Ensure are properly aligned.

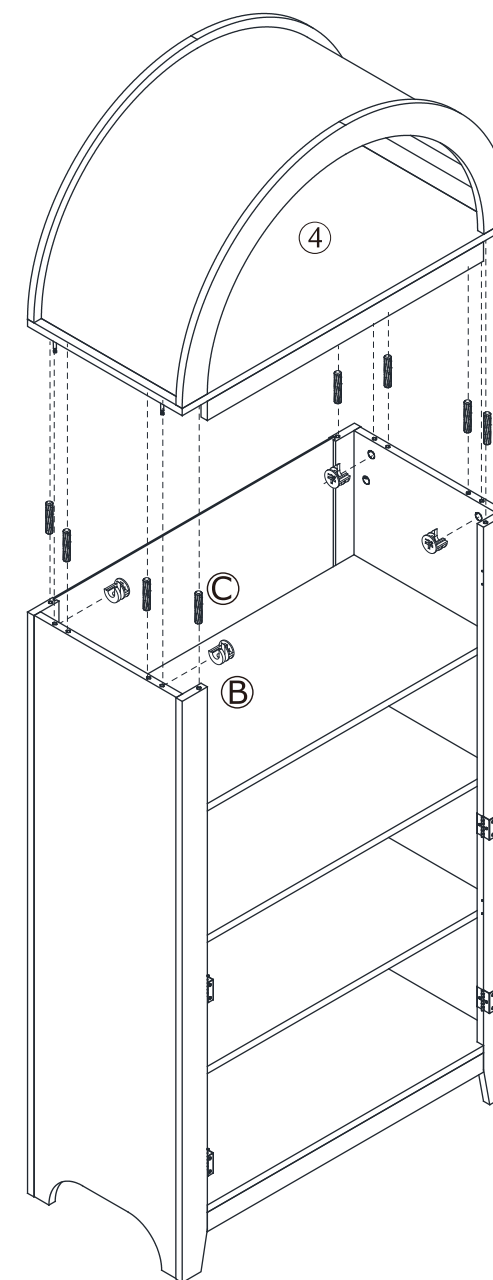

9

Position them on the structure as shown in the diagram

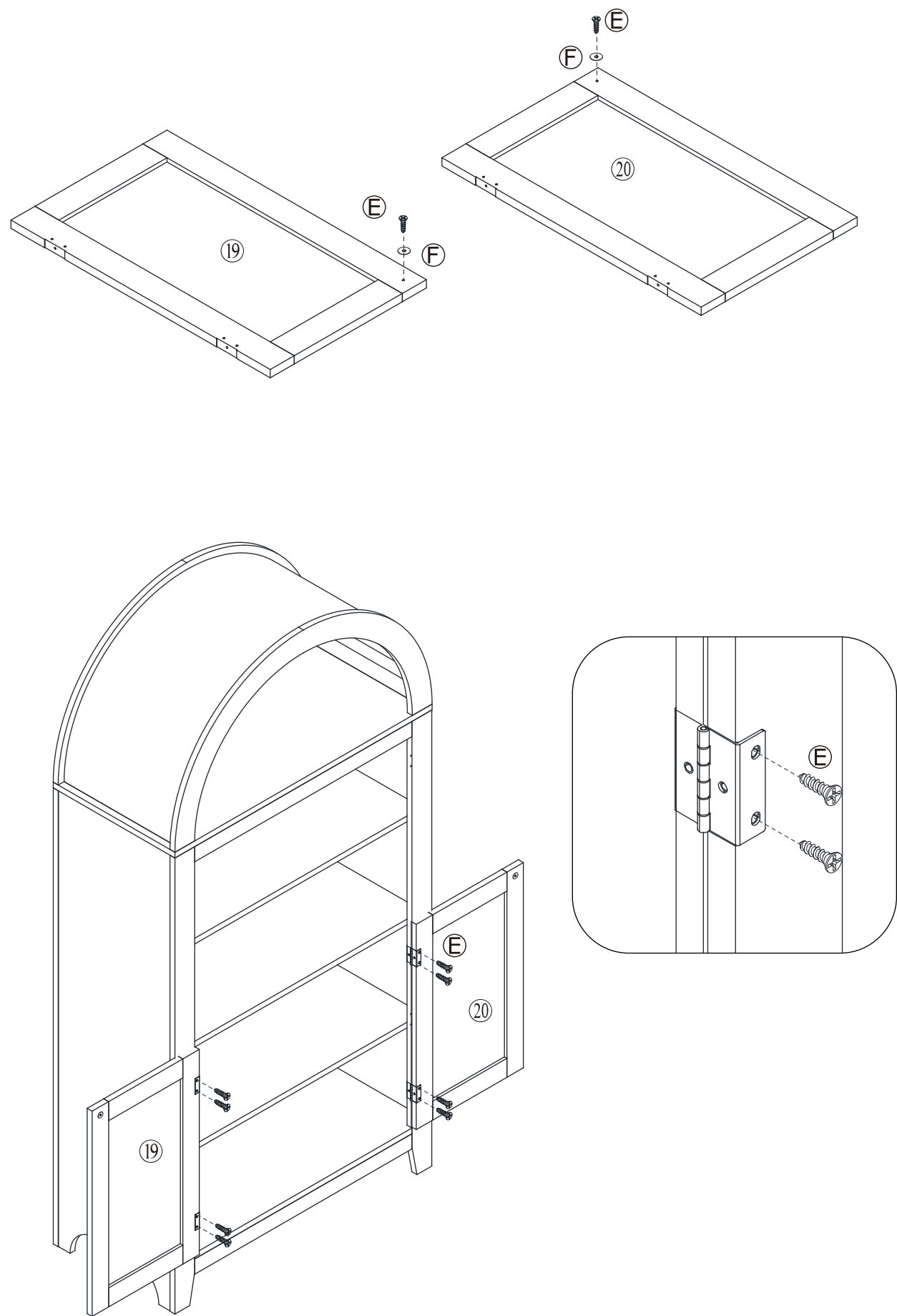

10

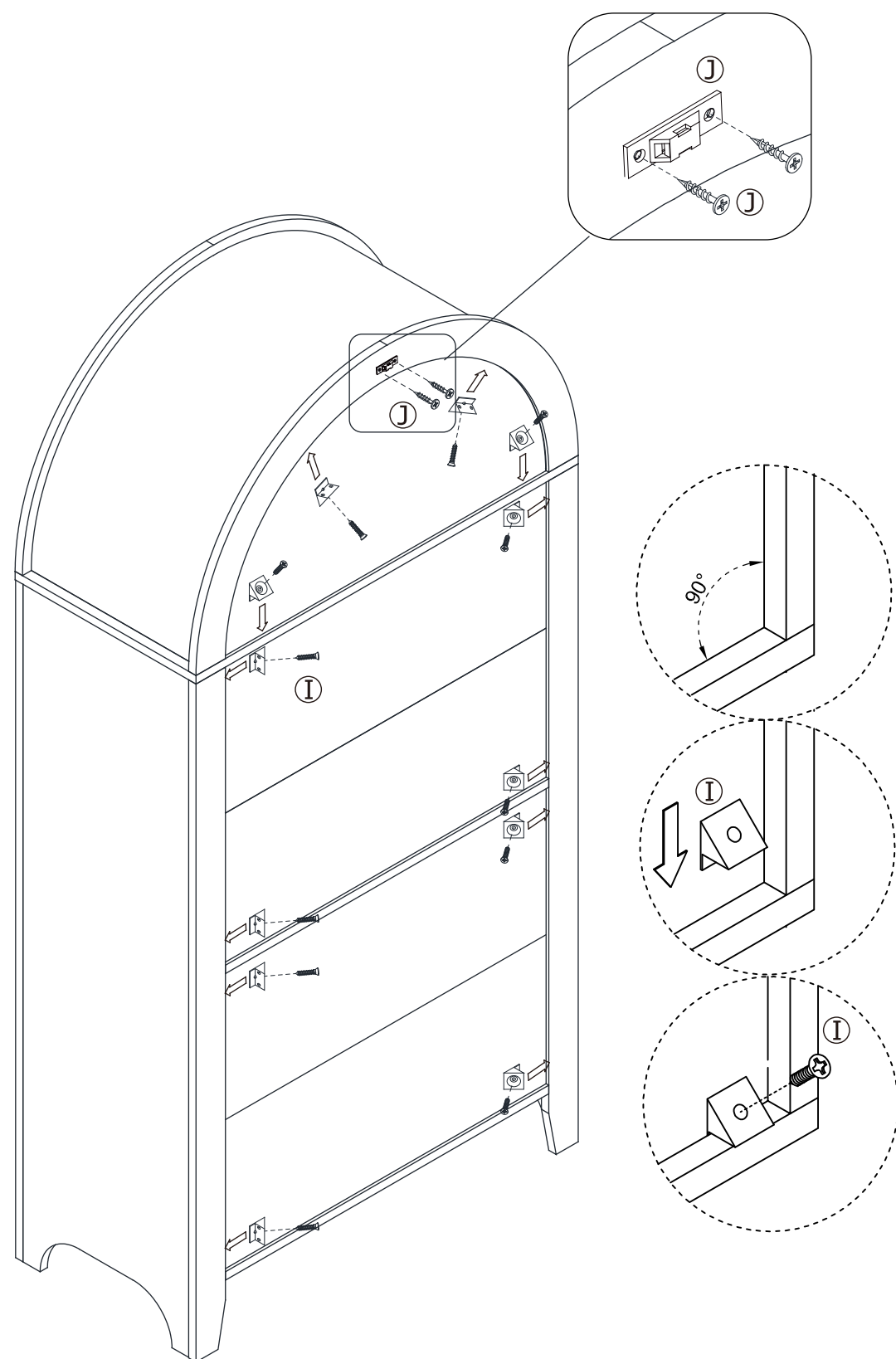

11

1. Mark the drilling holes.
2. Drill holes in the marked.
3. Install the anchor devices into the drilled holes.
4. Ensure the furniture is firmly anchored to the wall to prevent tipover.

