

ASSEMBLY INSTRUCTIONS

Read this instruction carefully. Refer hardware and furniture parts list for guidance. Be sure all parts are complete, before assembling. Place all wooden furniture part on a clean and flat soft surface to prevent scratches. Refer steps provided as assembling guide.

CAUTIONS :

1. Do not **FULLY-TIGHTEN** the nuts or nut bolts until all are in place.
2. To prevent thread damage. Ensure that nuts or nut bolts are not over-tighten.
3. Hardware are to be kept out of reach from children.

PART LIST			HARDWARE LIST		
ITEM	DESCRIPTION	QTY	ITEM	DESCRIPTION	QTY
A	TABLE TOP	1 PC	1	JCBC SCREW M6 x 50MM	12 PCS
B	TABLE LEG SUPPORT (TOP)	1 PC	2	JCBC BOLT M6 x 30MM	3 PCS
C	TABLE LEG SUPPORT (BOTTOM)	1 PC	3	SPRING WASHER 1/4"	15 PCS
D	TABLE LEG	3 PCS	4	WOOD DOWEL DIA 8 x 35MM	6 PCS
			5	ALLEN KEY M4	1 PC

STEP 1

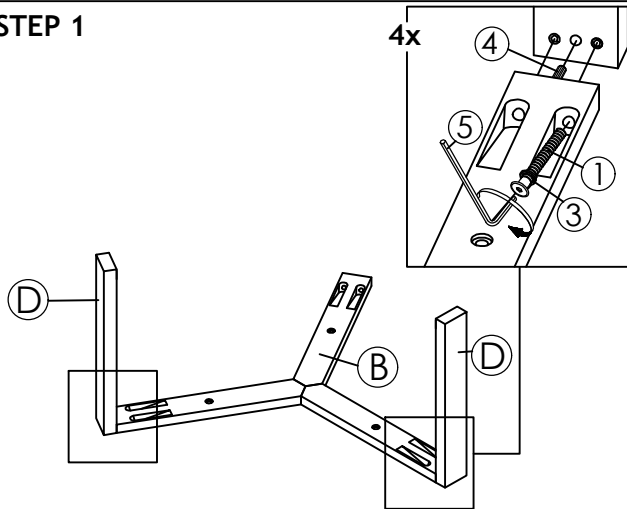

STEP 2

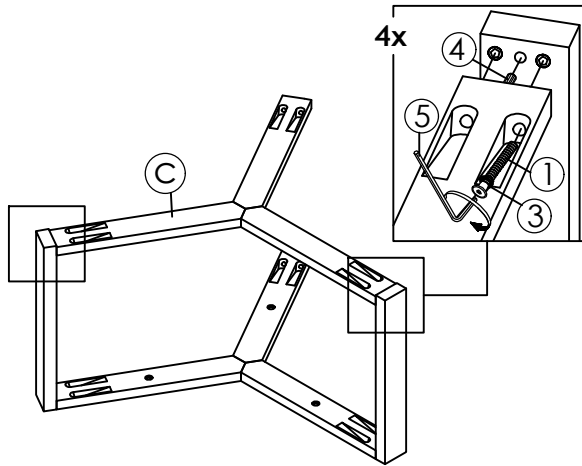

STEP 3

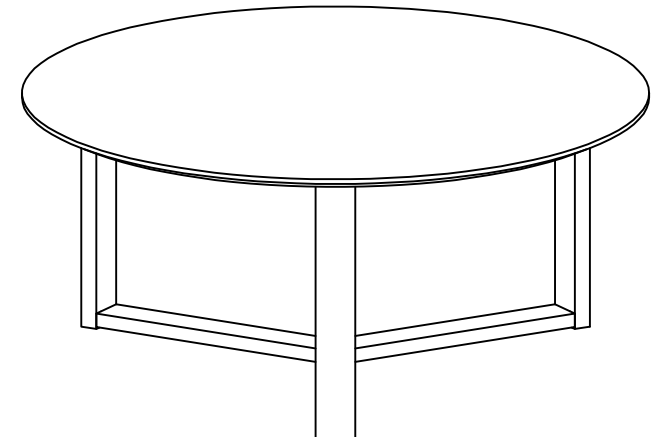
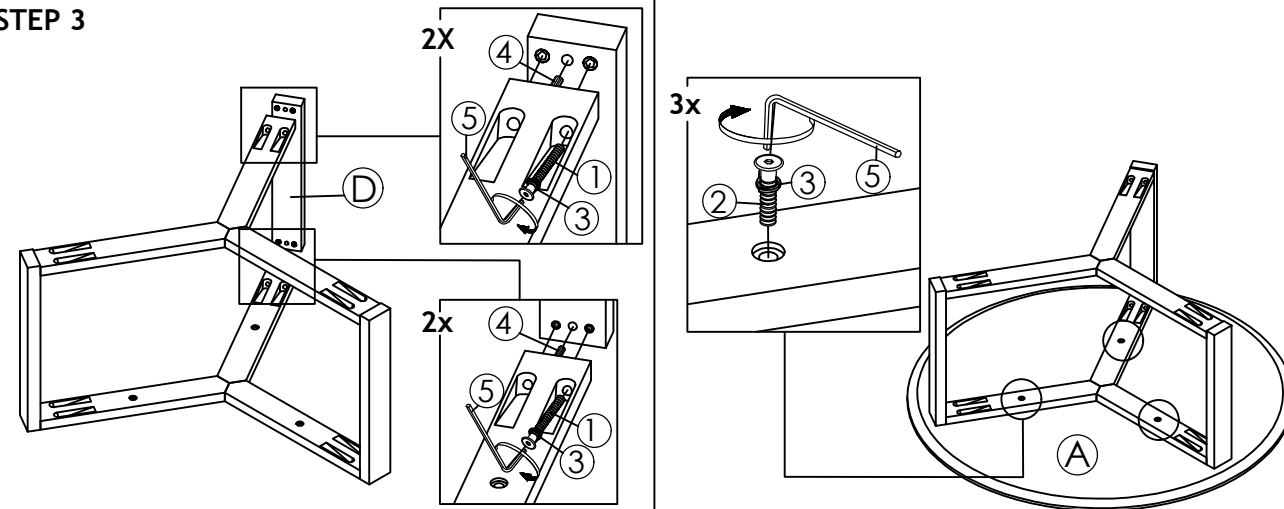

COMPLETED ASSEMBLY